



THE ATLANTIC REFINING COMPANY  
INCORPORATED - 1870  
PETROLEUM PRODUCTS

December 30, 1965

NORTH AMERICAN PRODUCING DEPARTMENT  
NEW MEXICO - ARIZONA DISTRICT

S. L. SMITH, DISTRICT MANAGER  
JACK BIARD, DISTRICT LANDMAN  
E. R. DOUGLAS, DISTRICT GEOLOGIST  
A. D. KLOXIN, DISTRICT DRG. & PROD. SUP'T.  
M. D. ROBERTS, DISTRICT GEOPHYSICIST  
W. P. TOMLINSON, DISTRICT ENGINEER  
B. R. WARE, DISTRICT ADMINISTRATIVE SUP'V.

JAN 5 AM 11

SECURITY NATIONAL BANK BLDG.

MAILING ADDRESS  
P. O. BOX 1978  
ROSWELL, NEW MEXICO

Mr. A. L. Porter, Jr., Secretary-Director  
New Mexico Oil Conservation Commission  
P. O. Box 2088  
Santa Fe, New Mexico

Re: Non-Standard Proration Unit for  
Atlantic's Walt Canyon Unit No. 2 Well,  
Indian Basin-Upper Pennsylvanian  
Gas Pool, Eddy County, New Mexico

Dear Sir:

The Atlantic Refining Company is the operator of the Walt Canyon Unit No. 2 Well, located in Section 4, T22S-R24E, on a tract of 691.84 acres. It is completed in the Indian Basin-Upper Pennsylvanian field pay. We respectfully request an administrative exception to the 640-acre proration unit requirement of Rule No. 2 of Order No. R-2440 and assignment of the entire 691.84 acres to our well for proration purposes.

It is our understanding that Rule No. 3 provides for administrative approval of non-standard proration units when such units are caused by location of wells at township boundaries.

Yours very truly,

THE ATLANTIC REFINING COMPANY

W. P. Tomlinson

WPT:rhs

cc: New Mexico Oil Conservation Commission  
P. O. Drawer DD  
Artesia, New Mexico

Mr. A. D. Kloxin - Roswell

*Appended  
5-26-64  
Rules Feb 28, 1963  
R-2870*

NEW MEXICO OIL CONSERVATION COMMISSION  
WELL LOCATION AND ACREAGE DEDICATION PLAT

Form C-102  
Supersedes C-128  
Effective 1-4-65

All distances must be from the outer boundaries of the Section.

Operator <b>THE ATLANTIC REFINING COMPANY</b>		Lease <b>Walt Canyon Unit</b>		Well No. <b>2</b>	
Unit Letter <b>D</b>	Section <b>4</b>	Township <b>22 South</b>	Range <b>24 East</b>	County <b>Eddy</b>	
Actual Footage Location of Well: <b>960</b> feet from the <b>North</b> line and <b>800</b> feet from the <b>West</b> line					
Ground Level Elev. <b>3970'</b>	Producing Formation <b>Cisco-Canyon</b>		Pool <b>Indian Basin-Upper Pennsylvanian</b>		Dedicated Acreage: <b>691.84</b> Acres

1. Outline the acreage dedicated to the subject well by colored pencil or hachure marks on the plat below.
2. If more than one lease is dedicated to the well, outline each and identify the ownership thereof (both as to working interest and royalty).
3. If more than one lease of different ownership is dedicated to the well, have the interests of all owners been consolidated by communitization, unitization, force-pooling, etc?

☒ Yes ☐ No If answer is "yes," type of consolidation Unitization

If answer is "no," list the owners and tract descriptions which have actually been consolidated. (Use reverse side of this form if necessary.)

No allowable will be assigned to the well until all interests have been consolidated (by communitization, unitization, forced-pooling, or otherwise) or until a non-standard unit, eliminating such interests, has been approved by the Commission.

R-24-E

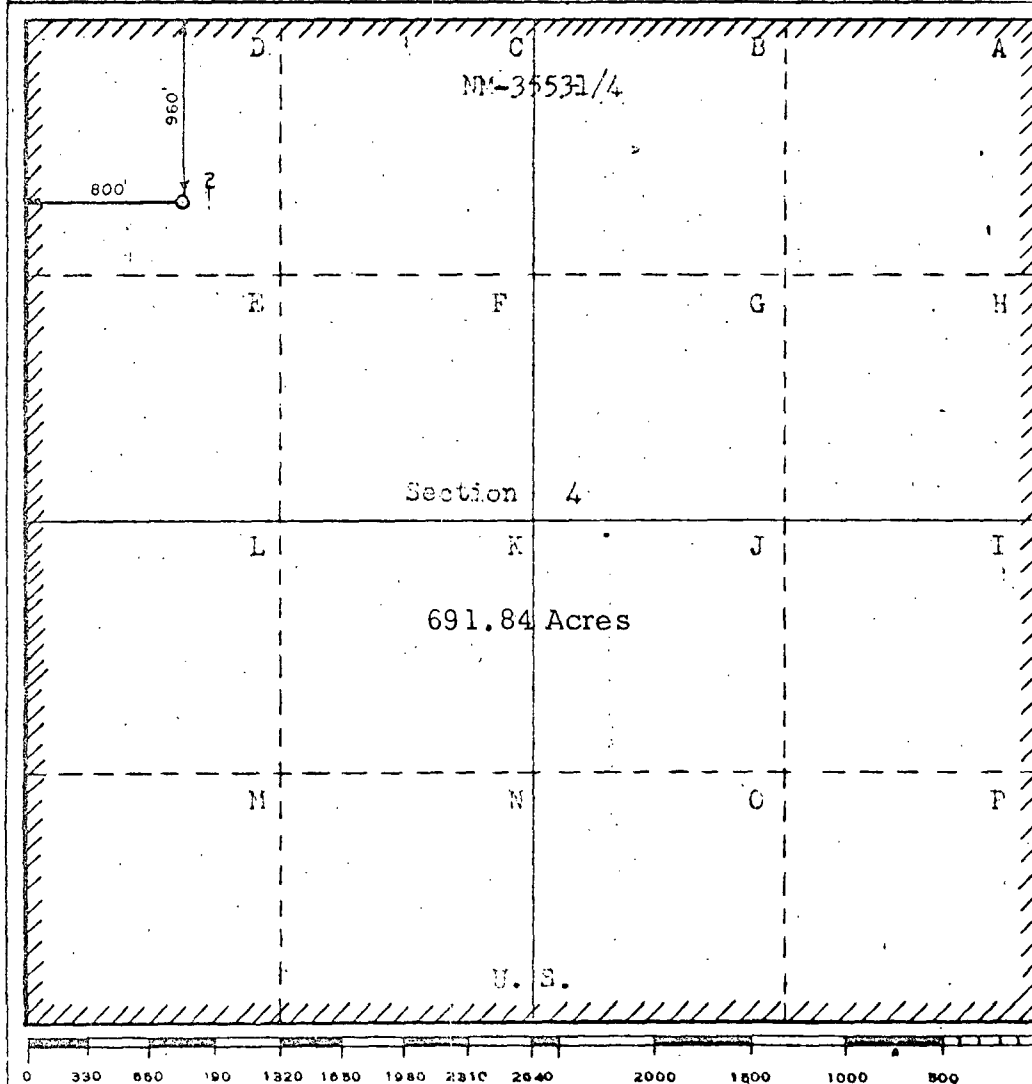

CERTIFICATION

I hereby certify that the information contained herein is true and complete to the best of my knowledge and belief.

*A. D. Kloxin*

Name  
**A. D. Kloxin**

Position  
**Dist. Drlg. & Prod. Supt.**

Company  
**The Atlantic Refining Co.**

Date  
**March 29, 1965**

I hereby certify that the well location shown on this plat was plotted from field notes of actual surveys made by me or under my supervision, and that the same is true and correct to the best of my knowledge and belief.

Date Surveyed  
**May 8, 1964**

R. A. Waterhouse, Surveyor  
The Atlantic Refining Company  
*R. A. Waterhouse*

PAIO-1380

