

District I

1625 N. French Dr., Hobbs, NM 88240

District II

1301 W. Grand Avenue, Artesia, NM 88210

District III

1000 Rio Brazos Road, Aztec, NM 87410

District IV

1220 S. St. Francis Dr., Santa Fe, NM 87505

State of New Mexico
Energy Minerals and Natural Resources

RECEIVED

Form C-141

Revised June 10, 2003

AUG 12 2009

Oil Conservation Division
1220 South St. Francis Dr.
Santa Fe, NM 87505

HOBBSOC

Submit 2 Copies to appropriate

District Office in accordance

with Rule 116 on back

side of form

Release Notification and Corrective Action

OPERATOR

☐ Initial Report ☒ Final Report

Name of Company	Apache Corporation	Contact	Natalie Gladden
Address	P.O. Box 1849	Telephone No.	575-390-4186
Facility Name	NEDU #220	Facility Type	Production Well

Surface Owner	State of NM	Mineral Owner	State of NM	API No.	30-025-06358
---------------	-------------	---------------	-------------	---------	--------------

LOCATION OF RELEASE

Unit Letter	Section	Township	Range	Feet from North Line	Feet from East Line	Longitude-W	Latitude-N	County
J	2	21S	37E	2886	2307	103.1392	32.5071	Lea

NATURE OF RELEASE

Type of Release	Volume of Release	Volume Recovered
Crude Oil w/ associated Produced Water	Greater than 5 bbl	0 bbl
Source of Release	Date and Hour of Occurrence	Date and Hour of Discovery
Wellhead valve	07/21/08 AM	07/21/08 7:00AM
Was Immediate Notice Given?	If YES, To Whom?	
<input checked="" type="checkbox"/> YES <input type="checkbox"/> NO <input checked="" type="checkbox"/> Not Required	Larry Johnson - NMOCD	
By Whom?	Date and Hour	
Natalie Gladden	07/21/08 9:00AM	
Was a Watercourse Reached?	If YES, Volume Impacting the Watercourse	
<input type="checkbox"/> YES <input checked="" type="checkbox"/> NO	NA	
If a Watercourse was Impacted, Describe Fully*		

Describe Cause of Problem and Remedial Action Taken. *

Valve on wellhead was left open, valve closed, saturated soil excavated and disposed of at Sundance Services.

Describe Area Affected and Cleanup Action Taken. *

A 1300-ft² area primarily south of the wellhead was contaminated with crude oil and produced water. Saturated soil was excavated and disposed of at Sundance Services. Remaining contamination (chlorides) was blended to achieve regulatory limit of 250-ppm. Well pad was backfilled and reconstructed with clean caliche. Remediation and restoration was completed by Ocotillo Environmental, LLC., Hobbs, NM.

I hereby certify that the information given above is true and complete to the best of my knowledge and understand that pursuant to NMOCD rules and regulations all operators are required to report and/or file certain release notifications and perform corrective actions for releases which may endanger public health or the environment. The acceptance of a C-141 report by the NMOCD marked as "Final Report" does not relieve the operator of liability should their operations have failed to adequately investigate and remediate contamination that pose a threat to ground water, surface water, human health or the environment. In addition, NMOCD acceptance of a C-141 report does not relieve the operator of responsibility for compliance with any other federal, state, or local laws and/or regulations.

Signature:	OIL CONSERVATION DIVISION		
Printed Name:	ENVIRONMENTAL ENGINEER		
Title:	Approved by District Supervisor: <i>Jeffrey Schum</i>		
E-Mail Address:	Approval Date: 09/21/09	Expiration Date: -	
Date:	Conditions of Approval:	IRP# 1925	<input type="checkbox"/> Attached
7/29/2009	Phone:	575-390-4186	



RECEIVED

AUG 12 2009

HOBBSOCD

NEDU #220

C141 CLOSURE REPORT

API 30-025-06358

UL-J (NW¼ OF THE SE¼) OF SECTION 2 T21S R37E

LATITUDE: N 32° 30.858' LONGITUDE: W 103° 7.981'

~5.43 MILES NNE (BEARING 15.3°) OF EUNICE

LEA COUNTY, NEW MEXICO

NMOCD 1RP #1925

July 29, 2009

PREPARED FOR APACHE CORPORATION BY:

OCOTILLO ENVIRONMENTAL, LLC

JOHN GOOD, PROJECT MANAGER/CONSULTANT

2125 FRENCH DR. HOBBS, NM 88241

OFFICE: (575) 393-6371 J. GOOD: (575) 631-3277

Table of Contents

1.0 Project Summary.....	3
2.0 Site Description	4
2.1 Geological Description	4
2.2 Ecological Description	4
2.3 Area Ground Water	4
2.4 Area Water Wells	4
2.5 Area Surface Water Features	4
3.0 Contaminant and Size of Area	4
4.0 NMOCD Site Ranking	4
5.0 Remediation Process	5

ATTACHMENTS 7-21

Plate 1: Site Location Map	7
Plate 2: Site Topography Map	8
Plate 3: Site Aerial Photograph	9
Plate 4: Ground Water Elevation Contour Map	10
Plate 5: Site Detail Drawing	11
Cardinal Laboratory Analytical Reports	12-13
Photographs	14-15
Initial NMOCD C-141 Form (09/12/08 IRP-1950)	16
Site Metrics Information	17
Final NMOCD C-141 Form	18

1.0 Project Summary

Release Site Name: NEDU #220
Operating Company: Apache Corporation
Company Representative: Natalie Gladden, Environmental Tech Phone: 575-390-4186
Address: PO Box 1849, Eunice, NM 88231 Email: Natalie.Gladden@usa.apachecorp.com
Remediation Company: Ocotillo Environmental - Hobbs Phone: 575-738-0138

SITE SPECIFIC DATA:

Legal Description: Lea County, New Mexico UL-J Section 2 T21S R37E
General Location: 5.43 miles NNE (15.3°) of Eunice, NM.
Latitude: N32° 30.858' Longitude: W103° 7.981' Elevation: 3,476-ft amsl
Land Ownership: State of NM
Ground Water Elevation: 70-ft bgs (Contour map)
Water Wells within 1000-ft: none Surface Water within 1000-ft: none

RELEASE SPECIFIC DATA:

Date and Time of Release(s): 07/21/08 –AM
Material Released: Crude oil and associated produced water
Volume Released: 5 to 10-bbl Volume Recovered: 0-bbl
Cause of Release: valve left open
Release Affected Area: ~1300-ft²
Depth of Contamination: 8-ft bgs
NMOCD Site Ranking: 10 (ground water 50-ft below lowest contamination)
Remediation Action Levels: TPH: 1000-ppm; Benzene: 10-ppm; BTEX: 50-ppm; Cl – 250-ppm

REMEDIATION SUMMARY:

Subsequent to the initial excavation/disposal of ~75-yd³ of saturated soil from the south extending flow path, an additional 150-yd³ of contaminated soil excavated and disposed of from the immediate area of the wellhead. Soil remaining at the wellhead and the release flow path was field tested for chlorides. Results indicated chloride concentrations in the 500-1000 ppm range. This remaining contaminated soil was blended with clean soil obtained from the lateral extents of the excavation(s). The resulting bottom and blended chloride concentrations were less than 250-ppm. The excavations were backfilled with clean caliche and the well pad was contoured and compacted.

2.0 Detailed Site Description

2.1 Geological Description

The United States Geological Survey (USGS) Ground-Water Report 6, "Geology and Ground-Water Conditions in Southern Lea County, New Mexico," A. Nicholson and A. Clebsch, 1961, describes the near surface geology of southern Lea County as "an inter-grade of the Quaternary Alluvium (QA) sediments, i.e., fine to medium sand, with the mostly eroded Cenozoic Ogallala (CO) formation. Typically, the QA and CO formations in the area are capped by a thick inter-bed of caliche and generally overlain by sandy soil." The release site is located in the Eunice Plain physiographic subdivision, described by Nicholson & Clebsch as "covered almost entirely by reddish-brown dune sand. In some places the underlying surface consists of alluvial sediments – most commonly calcareous silt in buried valleys or Quaternary lake basins. It has a general southeast slope toward Monument Draw." The sand cover is generally 2 to 5-ft thick, but can be 20 – 30-ft thick in localized drift areas."

2.2 Ecological Description

The area is typical of the Upper Chihuahuan Desert Biome consisting primarily of hummocky sand hills covered with Harvard Shin Oak (*Quercus harvardi*) interspersed with Honey Mesquite (*Prosopis glandulosa*) along with typical desert grasses, flowering annuals and flowering perennials. Mammals represented, include Orrd's and Merriam's Kangaroo Rat, Deer Mouse, White Throated Wood Rat, Cottontail Rabbit, Black Tailed Jackrabbit, Mule Deer, Bobcat, Red Fox and Coyote. Reptiles, Amphibians, and Birds are numerous and typical of the area. A survey of Listed, Threatened, or Endangered species was not conducted.

2.3 Area Ground Water

Extrapolation of the Chevron-Texaco water contour map (*Plate 4 of Attachments*) indicates that water in this area is 70' bgs.

2.4 Area Water Wells

There are no recorded or observed water wells within 1000 horizontal feet of the site.

2.5 Area Surface Water Features

No permanent surface water bodies exist within 1000 horizontal feet of the site.

3.0 Contaminant and Size of Area

The primary Contaminants of Concern (CoCs) were crude oil and total chlorides. The approximate areal extent of the release was 1300-ft².

4.0 NMOCD Site Ranking

Contaminant delineation and site evaluation work done at this site indicate that the chemical parameters of the soil and the physical parameters of the ground water were characterized consistent with the characterization and remediation/abatement goals and objectives set forth in the following New Mexico Oil Conservation Division (NMOCD) publications:

- *Guidelines for Remediation of Leaks, Spills and Releases (August 13, 1993)*
- *Unlined Surface Impoundment Closure Guidelines (February 1993)*

Acceptable thresholds for contaminants/constituents of concern (CoCs), i.e., TPH^{8015m}, Benzene, and the mass sum of Benzene, Toluene, Ethyl Benzene, and total Xylenes (BTEX⁸²⁶⁰), was determined based on the NMOCD Ranking Criteria as follows:

- *Depth to Ground water, i.e., distance from the lower most acceptable concentration to the ground water.*
- *Wellhead Protection Area, i.e., distance from fresh water supply wells.*
- *Distance to Surface Water Body, i.e., horizontal distance to all down gradient surface water bodies.*

Based on the proximity of the site to area water wells, surface water bodies, and depth to ground water from the lower most contamination, the NMOCD ranking score for the site is 10 points with the soil remedial goals highlighted in the Site Ranking Table.

SITE RANKING TABLE

1. GROUND WATER		2. WELLHEAD PROTECTION	3. DISTANCE TO SURFACE WATER
DEPTH TO GW <50 FEET: 20 POINTS		IF <1000' FROM WATER SOURCE, OR; <200' FROM PRIVATE DOMESTIC WATER SOURCE: 20 POINTS	<200 HORIZONTAL FEET: 20 POINTS
DEPTH TO GW 50 TO 99 FEET: 10 POINTS			200-1000 HORIZONTAL FEET: 10 POINTS
DEPTH TO GW >100 FEET: 0 POINTS		IF >1000' FROM WATER SOURCE, OR; >200' FROM PRIVATE DOMESTIC WATER SOURCE: 0 POINTS	>1000 HORIZONTAL FEET: 0 POINTS
GROUND WATER SCORE = 10		WELLHEAD PROTECTION SCORE= 0	SURFACE WATER SCORE= 0
SITE RANK (1+2+3) = 10 + 0 + 0 = 20 POINTS			
TOTAL SITE RANKING SCORE AND ACCEPTABLE REMEDIAL GOAL CONCENTRATIONS			
PARAMETER	20+	10	0
BENZENE	10 PPM	10 PPM	50 PPM
BTEX	50 PPM	50 PPM	50 PPM
TPH	100 PPM	1000 PPM	5000 PPM

5.0 Remediation Process

Subsequent to the initial excavation/disposal of ~75-yd³ of saturated soil from the south extending flow path, an additional 150-yd³ of contaminated soil excavated and disposed of from the immediate area of the wellhead. Soil remaining at the wellhead and the release flow path was field tested for chlorides. Results indicated chloride concentrations in the 500-1000 ppm range. This remaining contaminated soil was blended with clean soil obtained from the lateral extents of the excavation(s). The resulting bottom and blended chloride concentrations were less than 250-ppm. The excavations were backfilled with clean caliche and the well pad was contoured and compacted.

Based on the contents and data contained herein, Apache Corporation requests that NMOCD require “no further action” as regards the soil contamination resulting from the 07/21/08 NEDU #220 well location.

ATTACHMENTS

Plate 1: Site Location Map	7
Plate 2: Site Topography Map	8
Plate 3: Site Aerial Photograph	9
Plate 4: Ground Water Elevation Contour Map	10
Plate 5: Site Detail Drawing	11
Cardinal Laboratory Analytical Reports	12-13
Photographs	14-15
Initial NMOCD C-141 Form (09/12/08 IRP-1950)	16
Site Metrics Information	17
Final NMOCD C-141 Form	18

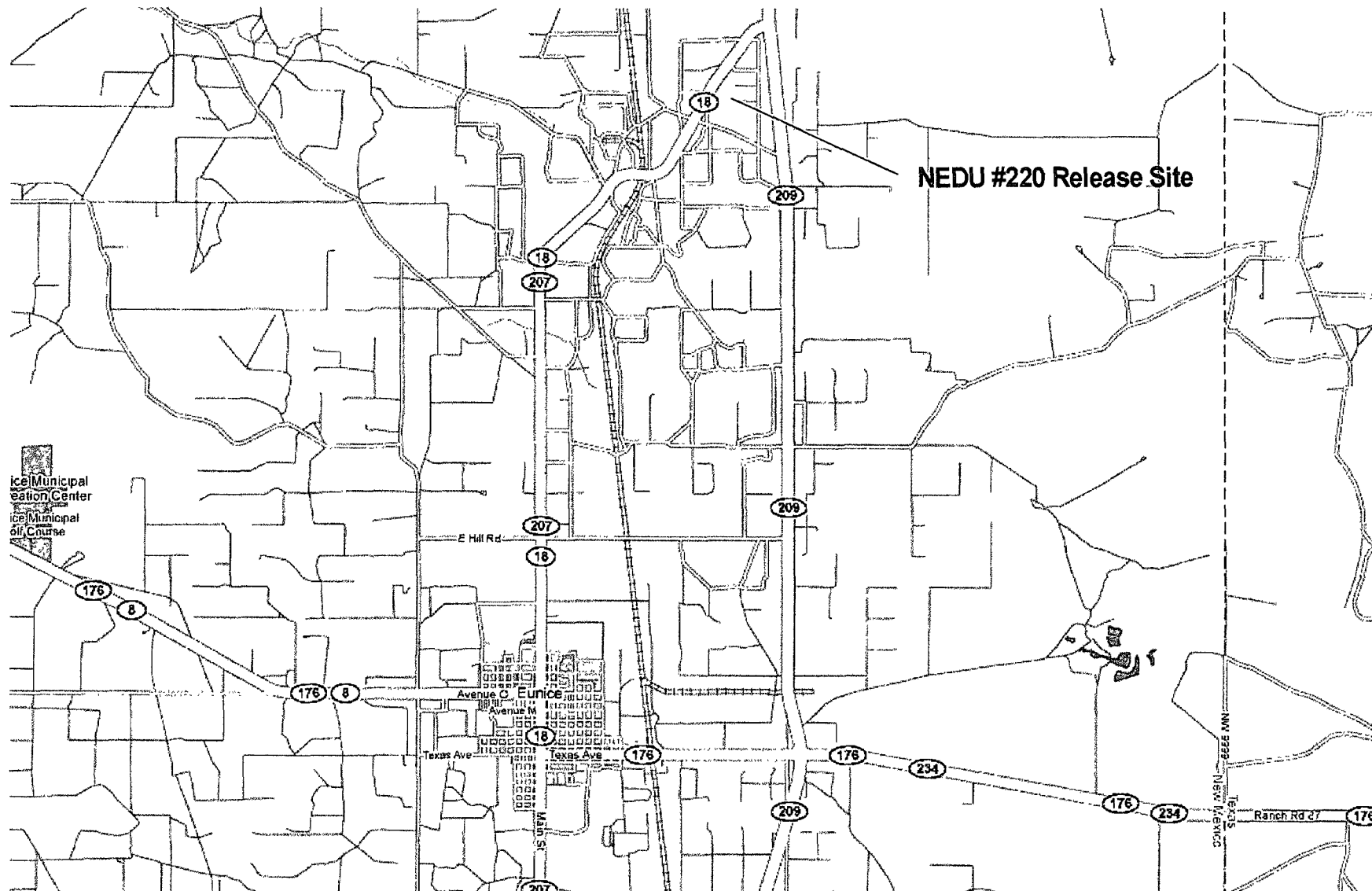

Plate 1
Release Site Location
Apache Corporation
NEDU #220

Lea County, New Mexico
UL-J Section 2 T21S R37E
N 32° 30.858', W 103° 7.981'
Elevation: ~3510-ft amsl

Drawing by: John Good
July - 2009

Rev.
1

SCALE:

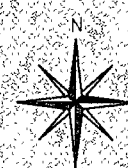

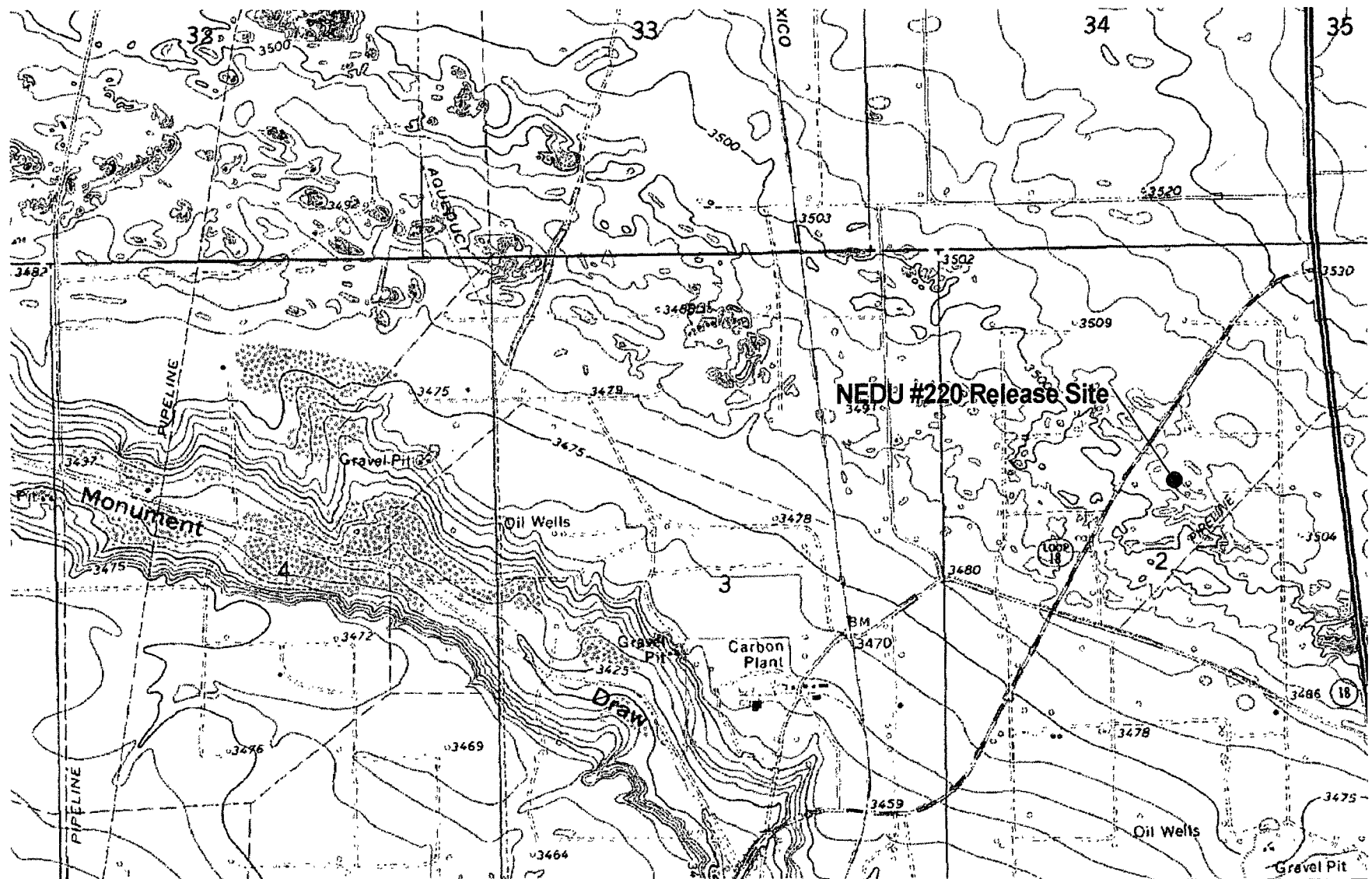

Plate 2
Release Site Topography (USGS)
Apache Corporation
NEDU #220

Lea County, New Mexico
UL-J Section 2 T21S R37E
N 32° 30.858', W 103° 7.981'
Elevation: ~3510-ft amsl

Drawing by: John Good
July - 2009

Rev.
1

SCALE:

0 Feet 3000

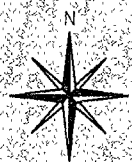

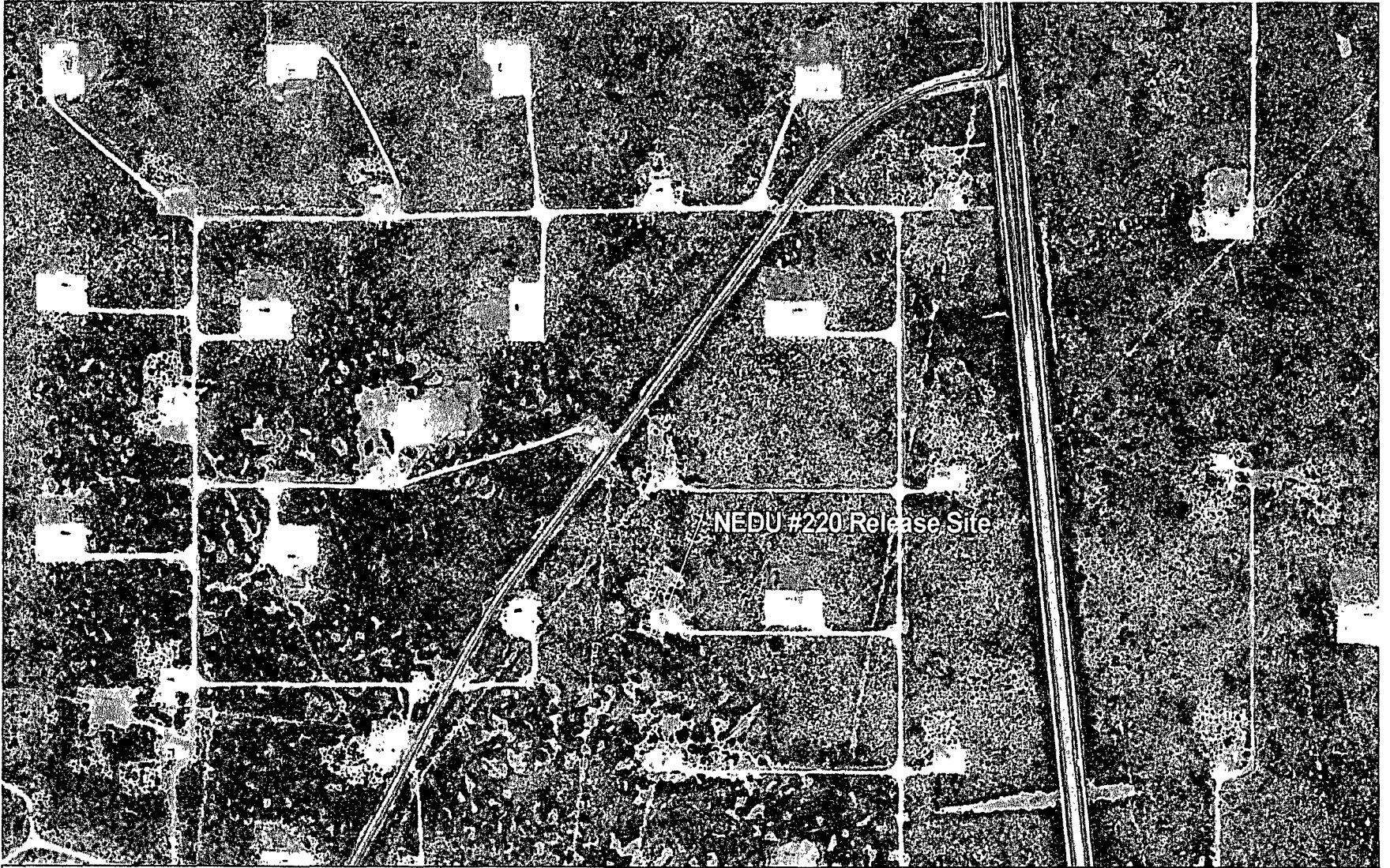

Plate 3
Release Site Aerial Photograph
Apache Corporation
NEDU #220

Lea County, New Mexico
UL-J Section 2 T21S R37E
N 32° 30.858' W 103° 7.981'
Elevation: ~3510-ft amsl

Drawing by: John Good
July - 2009

Rev:
1

SCALE

0 Feet 1200

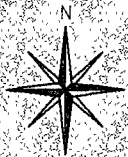

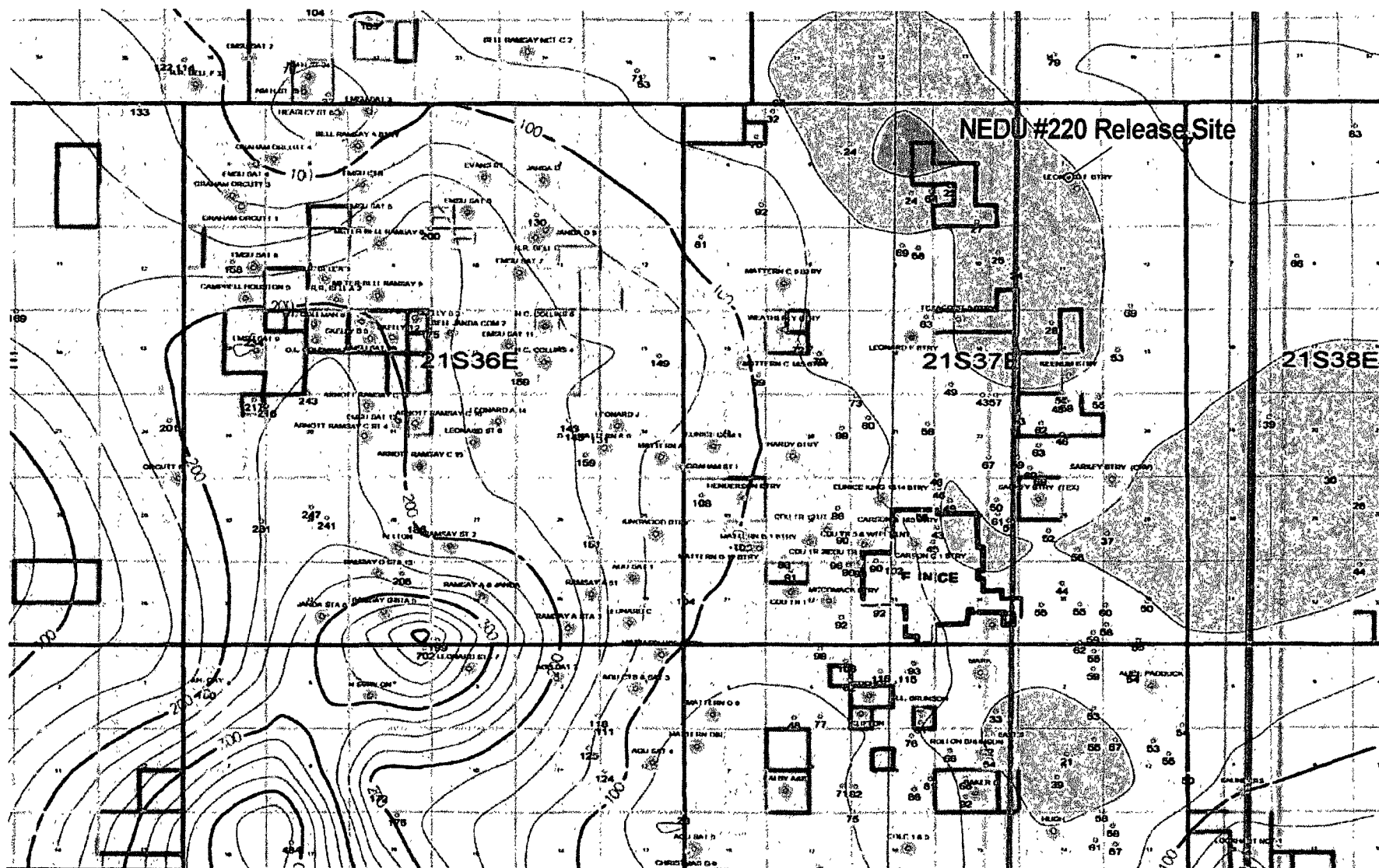

Plate 4
Release Site Water Depth Contour
Apache Corporation
NEDU #220

Lea County, New Mexico
UL-J Section 2 T21S R37E
N 32° 30.858' W 103° 7.981'
Elevation: ~3510-ft amsl

Drawing by: John Good
July - 2009

Rev.
1

SCALE

0 Miles 3

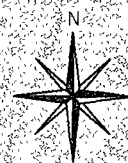

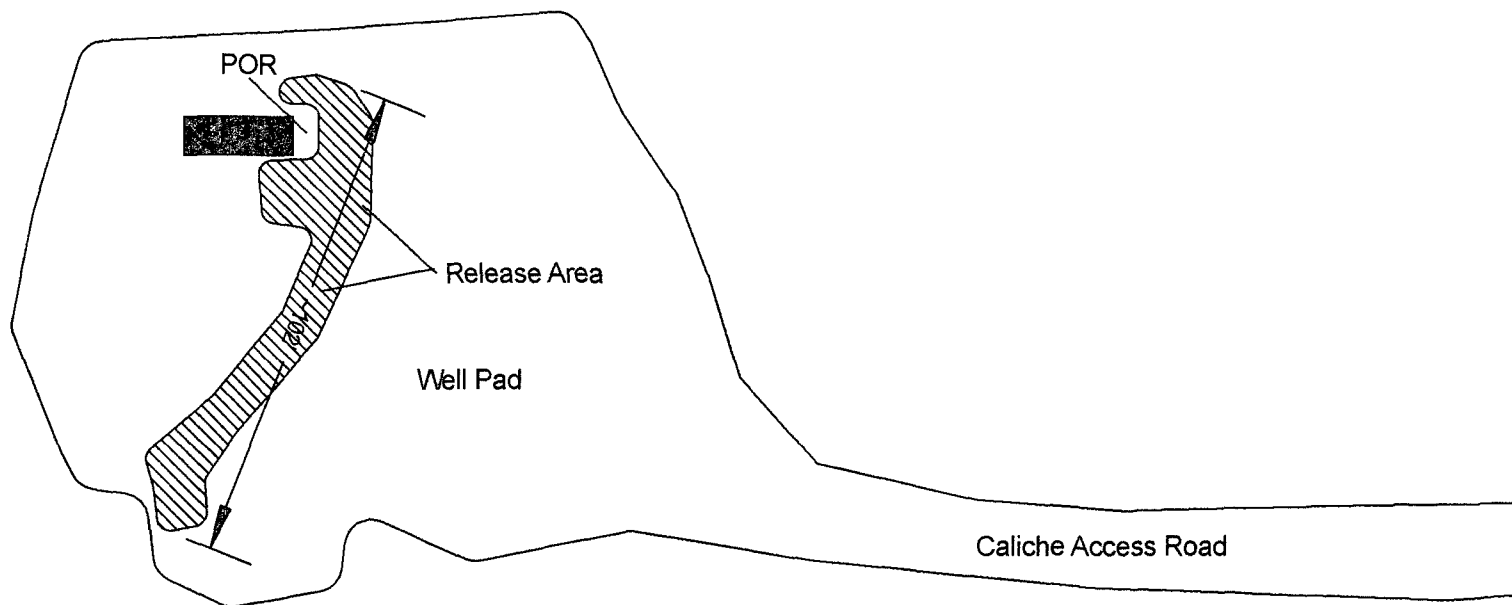

Plate 5
Release Site Diagram
Apache Corporation
NEDU #220

Lea County, New Mexico
UL-J Section 2 T21S R37E
N 32° 30.858', W 103° 7.981'
Elevation: ~3510-ft amsl

Drawing by: John Good
July - 2009

Rev.
1

SCALE:

0 Feet 75

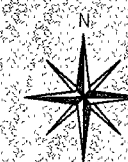



Sampling Date: 07/25/08
Sample Type: SOIL
Sample Condition: INTACT
Sample Received By: ML
Analyzed By: CK/HM/TR

*Analysis performed on a 1:4 w/v aqueous extract.

Date _____

PLEASE NOTE: Liability and Damages. Cardinal's liability and the firm's exclusive remedy for any claim arising, whether based in contract or tort, shall be limited to the amount paid by client for analyses. All claims, including those for negligence and any other cause whatsoever shall be deemed waived unless made in writing and received by Cardinal within thirty (30) days after completion of the applicable service. In no event shall Cardinal be liable for incidental or consequential damages, including, without limitation, business interruptions, lost of use, or loss of profits incurred by client, its subsidiaries, affiliates or successors arising out of or related to the performance of services hereunder; by Cardinal, regardless of whether such claim is based upon any of the above stated reasons or otherwise. Results relate only to the samples identified above. This report shall not be reproduced except in full with written approval of Cardinal Laboratories.



Sheet 1 of 1

PHONE (325) 673-7701 • 2111 BEECHWOOD • ABILENE, TX 79603
PHONE (505) 393-2326 • 701 E MARLAND • MORRIS NM 89240

PLEASE NOTE: Liability and Damages. Cardinal's liability and client's exclusive remedy for any claim arising whether based on contract or tort, shall be limited to the amount paid by the client for the analysis. All claims, including those for negligence and any other cause whatsoever, shall be deemed waived unless made in writing and received by Cardinal within 30 days after completion of the applicable service. In no event shall Cardinal be liable for incidental or consequential damages, including without limitation, business interruptions, loss of use, or loss of profits incurred by client, its subsidiaries, affiliates, or successors arising out of or related to the performance of services hereunder by Cardinal, regardless of whether such claim is based upon any of the above stated causes of damages.

Relinquished by: <i>John Good</i>		Date: 7/25/08	Received By: <i>Natlie L. But</i>	Phone Result: <input checked="" type="checkbox"/> Yes <input type="checkbox"/> No Add'l Phone#: 631-3277 (J. Good)
		Time: 2:20		Fax Result: <input type="checkbox"/> Yes <input checked="" type="checkbox"/> No Add'l Fax #:
Relinquished by:		Date:	Received By:	Remarks: J. Good or Natalie Gladden will pickup results when completed - - please do not fax or mail unless requested. Thanks.
		Time:		
Delivered By: (Circle One) <u>Sampler</u> - UPS - Bus - Other		Sample Condition Cool <input checked="" type="checkbox"/> Yes <input type="checkbox"/> No Intact <input checked="" type="checkbox"/> Yes <input type="checkbox"/> No	CHECKED BY: (Initials) <i>MLB</i>	Note: Cardinal cannot accept verbal changes. Please fax written changes to 575-393-2476.

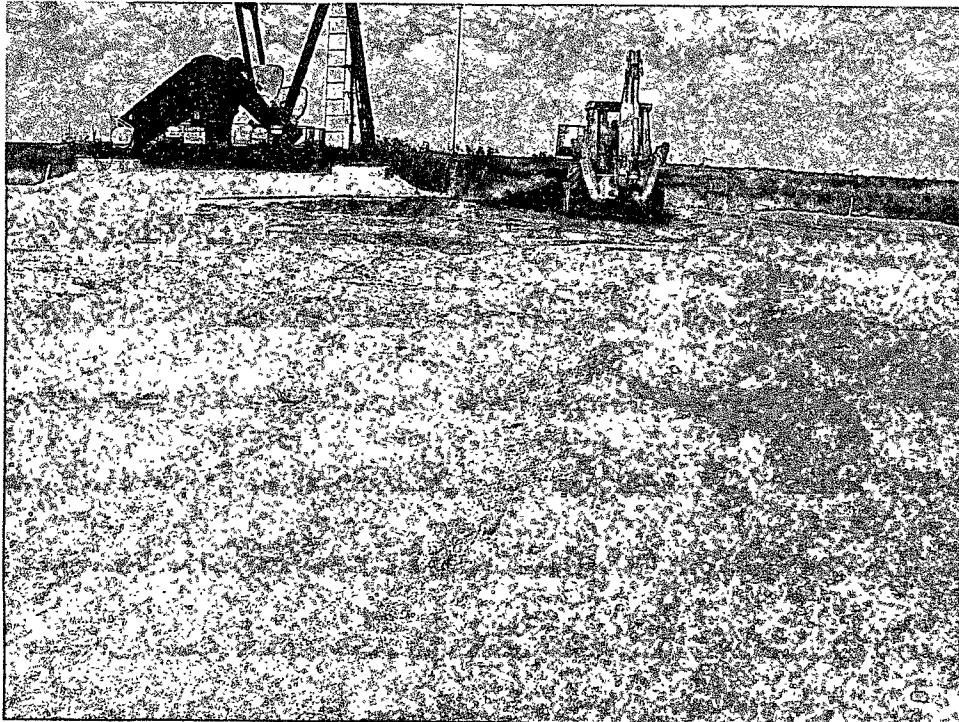

< 7/24/08 – Excavated
flow path south of well

7/24/08 – Oil and iron sulfide
near wellhead >



< 7/24/08 – Oil and iron
sulfide near wellhead



< 7/25/08 – Blended area
at wellhead and flow path south

7/25/08 – Blended area at south
terminus of flow path >

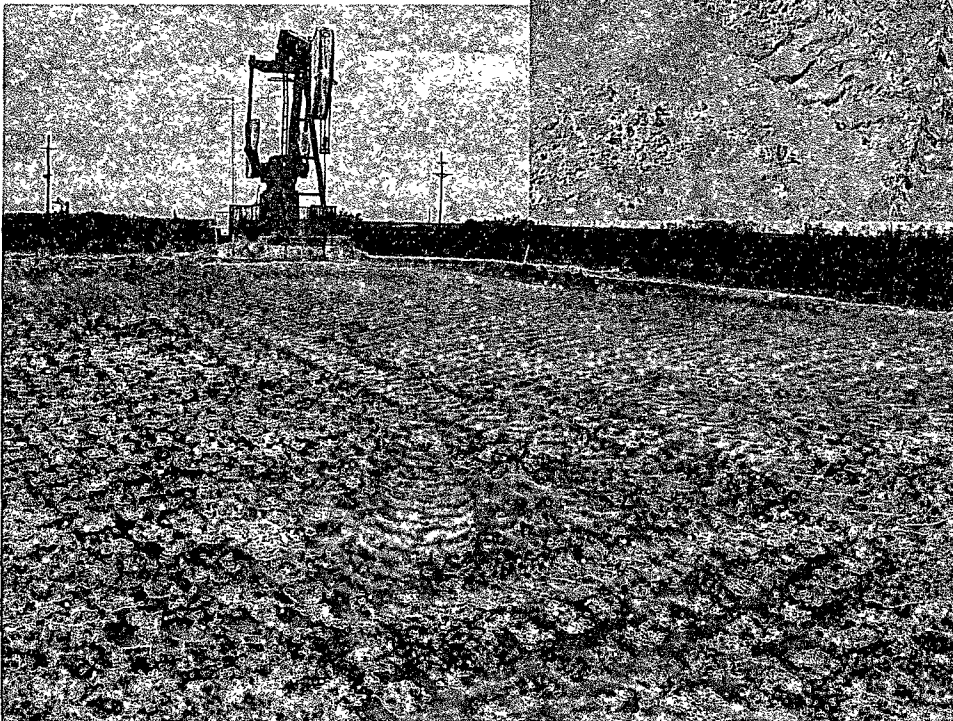

< 7/29/08 – Pad reconstructed
with clean caliche.

District I
1625 N. French Dr., Hobbs, NM 88240
District II
1301 W. Grand Avenue, Artesia, NM 88210
District III
1000 Rio Brazos Road, Aztec, NM 87410
District IV
1220 S. St. Francis Dr., Santa Fe, NM 87505

State of New Mexico
Energy Minerals and Natural Resources

Oil Conservation Division
1220 South St. Francis Dr.
Santa Fe, NM 87505

RECEIVED

Form C-141
Revised October 10, 2003

Submit 2 Copies to appropriate
Set Office in accordance
with Rule 116 on back
side of form

AUG 12 2008

HOBBS OGD

Release Notification and Corrective Action

OPERATOR

☒ Initial Report ☐ Final Report

Name of Company	Apache Corporation	Contact	Natalie Gladden
Address	P.O. Box 1849 Eunice NM 88231	Telephone No.	505-390-4186
Facility Name	Nedu #220	Facility Type	Production Well

Surface Owner	Page McNiel State of NM	Mineral Owner	State of NM	Lease No.	30-025-06358
---------------	-------------------------	---------------	-------------	-----------	--------------

LOCATION OF RELEASE

Unit Letter	Section	Township	Range	Feet from the	North/South Line	Feet from the	East/West Line	County
J	2	21S	37E	2886'	North Line	2307	East Line	Lea

Latitude _____ Longitude _____

NATURE OF RELEASE

Type of Release	Oil/Produced Water	Volume of Release	Over 5	Volume Recovered	0
Source of Release	Valve on wellhead was left open	07/21/08		7/21/08	7 am
Was Immediate Notice Given?	<input checked="" type="checkbox"/> Yes <input type="checkbox"/> No <input type="checkbox"/> Not Required	If YES, To Whom?	Larry Johnson		
By Whom?	Natalie Gladden	7/21/08	around 9am		
Was a Watercourse Reached?	<input type="checkbox"/> Yes <input checked="" type="checkbox"/> No	If YES, Volume Impacting the Watercourse.			

If a Watercourse was Impacted, Describe Fully.*

Describe Cause of Problem and Remedial Action Taken.*

Valve on wellhead was left open, visible contamination was scrapped up and hauled to Sundance immediately.

Describe Area Affected and Cleanup Action Taken.*

Proper procedures were followed, contaminated soil was hauled to Sundance and soil samples will be taken. All NMOCD guidelines will be followed. Closure document to follow.

I hereby certify that the information given above is true and complete to the best of my knowledge and understand that pursuant to NMOCD rules and regulations all operators are required to report and/or file certain release notifications and perform corrective actions for releases which may endanger public health or the environment. The acceptance of a C-141 report by the NMOCD marked as "Final Report" does not relieve the operator of liability should their operations have failed to adequately investigate and remediate contamination that pose a threat to ground water, surface water, human health or the environment. In addition, NMOCD acceptance of a C-141 report does not relieve the operator of responsibility for compliance with any other federal, state, or local laws and/or regulations.

Signature: <u>Natalie Gladden</u>	OIL CONSERVATION DIVISION	
Printed Name: Natalie Gladden	Approved by District <u>Larry Johnson</u> ENVIRONMENTAL ENGINEER	
Title: EH&S Environmental Tech	Approval Date: <u>8.12.08</u>	Expiration Date: <u>10.15.08</u>
E-mail Address: natalie.gladden@apachecorp.com	Conditions of Approval:	
Date: 7/24/08 Phone: 505-390-4186	<u>SUBMIT FINAL C-141 BY</u> Attached <input type="checkbox"/> <u>IRP # 1925</u>	

* Attach Additional Sheets If Necessary

FGRL 0822553649



Incident Date: 7/21/08 NMOCD Notified: 7/21/08

SITE: NEDU #220		API No. 30-025-06358	
Company: Apache Corporation			
Street Address: North Eunice Loop, Hwy 207			
Mailing Address: P.O. Box 1849			
City, State, Zip: Eunice, NM 88231			
Representative: Natalie Gladden			
Representative Telephone: 575-390-4186			
Telephone:			
Fluid Volume Released (bbl): > 5		Volume Recovered (bbl): 0	Net Release: > 5
>25 bbl: Notify NMOCD verbally within 24 hours and submit C-141 within 15 days.			
5-25 bbl: Submit Form C-141 within 15 days. (Also applies to unauthorized release of >50 mcf Natural Gas).			
Leak, Spill, or Pit (LSP) Name: NEDU #220			
Source of Contamination: Wellhead valve			
Land Owner, i.e. BLM, ST, Fee, Other: State of NM			
LSP Dimensions: ~ 100' X 13' (maximum dimensions)			
LSP Area ~ 1300 -ft ²			
Location of Reference Point (RP):			
Location distance and direction from RP:			
Latitude: North		32	30.427
Longitude: West		103	8.354
Elevation above mean sea level (amsl):		3510 feet	1070 meters
Distance from North Section Line (feet):		2886	
Distance from East Section Line (feet):		2307	
Location - Unit Letter and 1/4 1/4:		UL- J	NW 1/4 of SE 1/4
Location - Section		2	
Location - Township		21S	
Location - Range		37E	
Location - County		Lea	
Surface water body within 1000' radius of site:		0	
Surface water body within 1000' radius of site:		0	
Domestic water wells within 1000' radius of site:		0	
Domestic water wells within 1000' radius of site:		0	
Agricultural water wells within 1000' radius of site:		0	
Agricultural water wells within 1000' radius of site:		0	
Public water supply wells within 1000' radius of site:		0	
Public water supply wells within 1000' radius of site:		0	
Depth (feet) from land surface to Ground Water (DG):		70	
Depth (feet) of lowest contamination (DC):		10	
Depth (feet) to Ground Water (DG - DC = DtGW):		~ 60	
1. Ground Water		2. Wellhead Protection Area	3. Distance to Surface Water
If Depth to GW <50-feet: 20 points	If <1000' from water source, or, <200' from private domestic water source: 20 points If >1000' from water source, or, >200' from private domestic water source: 0 points	<200 horizontal feet: 20 points	
If Depth to GW 50 to 100-feet: 10 points		200-1000 horizontal feet: 10 points	
If Depth to GW >100-feet: 0 points		>1000 horizontal feet: 0 points	
Ground Water Score: 10		Wellhead Protection Score: 0	Surface Water Score: 0
Site Ranking (1 + 2 + 3): 10			
Total Site Ranking Score and Acceptable Concentrations			
Parameter	20 or >	10	0
Benzene ¹	10-ppm	10-ppm	10-ppm
BTEX ¹	50-ppm	50-ppm	50-ppm
TPH	100-ppm	1000-ppm	5000-ppm

District I

1625 N French Dr, Hobbs, NM 88240

District II

1301 W Grand Avenue, Artesia, NM 88210

District III

1000 Rio Brazos Road, Aztec, NM 87410

District IV

1220 S. St. Francis Dr, Santa Fe, NM 87505

State of New Mexico

Energy Minerals and Natural Resources

Form C-141

Revised June 10, 2003

RECEIVED

AUG 12 2009

HOBBSOCD

Oil Conservation Division

1220 South St. Francis Dr.

HOBBSOCD Santa Fe, NM 87505

RECEIVED

AUG 12 2009

HOBBSOCD

Submit 2 Copies to appropriate

District Office in accordance

with Rule 116 on back

side of form.

Release Notification and Corrective Action

OPERATOR

☐ Initial Report ☒ Final Report

Name of Company	Apache Corporation	Contact	Natalie Gladden
Address	P.O. Box 1849	Telephone No.	575-390-4186
Facility Name	NEDU #220	Facility Type	Production Well

Surface Owner	State of NM	Mineral Owner	State of NM	API No.	30-025-06358
---------------	-------------	---------------	-------------	---------	--------------

LOCATION OF RELEASE

Unit Letter	Section	Township	Range	Feet from North Line	Feet from East Line	Longitude-W	Latitude-N	County
J	2	21S	37E	2886	2307	103.1392	32.5071	Lea

NATURE OF RELEASE

Type of Release	Volume of Release	Volume Recovered
Crude Oil w/ associated Produced Water	Greater than 5 bbl	0 bbl
Source of Release	Date and Hour of Occurrence	Date and Hour of Discovery
Wellhead valve	07/21/08 AM	07/21/08 7:00AM
Was Immediate Notice Given?	If YES, To Whom?	
<input checked="" type="checkbox"/> YES <input type="checkbox"/> NO <input checked="" type="checkbox"/> Not Required	Larry Johnson - NMOCD	
By Whom?	Date and Hour	
Natalie Gladden	07/21/08 9:00AM	
Was a Watercourse Reached?	If YES, Volume Impacting the Watercourse	
<input type="checkbox"/> YES <input checked="" type="checkbox"/> NO	NA	

If a Watercourse was Impacted, Describe Fully*

Describe Cause of Problem and Remedial Action Taken. *

Valve on wellhead was left open, valve closed, saturated soil excavated and disposed of at Sundance Services.

Describe Area Affected and Cleanup Action Taken. *

A 1300-ft² area primarily south of the wellhead was contaminated with crude oil and produced water. Saturated soil was excavated and disposed of at Sundance Services. Remaining contamination (chlorides) was blended to achieve regulatory limit of 250-ppm. Well pad was backfilled and reconstructed with clean caliche. Remediation and restoration was completed by Ocotillo Environmental, LLC., Hobbs, NM.

I hereby certify that the information given above is true and complete to the best of my knowledge and understand that pursuant to NMOCD rules and regulations all operators are required to report and/or file certain release notifications and perform corrective actions for releases which may endanger public health or the environment. The acceptance of a C-141 report by the NMOCD marked as "Final Report" does not relieve the operator of liability should their operations have failed to adequately investigate and remediate contamination that pose a threat to ground water, surface water, human health or the environment. In addition, NMOCD acceptance of a C-141 report does not relieve the operator of responsibility for compliance with any other federal, state, or local laws and/or regulations.

Signature:	<u>OIL CONSERVATION DIVISION</u>		
Printed Name:	Natalie Gladden	Approved by District Supervisor:	
Title:	Environmental Tech - Permian Basin	Approval Date:	Expiration Date:
E-Mail Address:	Natalie.Gladden@usa.apachecorp.com	Conditions of Approval:	IRP# 1925
Date:	7/29/2009	Phone:	575-390-4186
			<input type="checkbox"/> Attached