

JASON W. KELLAHIN
ROBERT E. FOX
W. THOMAS KELLAHIN

KELLAHIN AND FOX
ATTORNEYS AT LAW
500 DON GASPAR AVENUE
POST OFFICE BOX 1769
SANTA FE, NEW MEXICO 87501

TELEPHONE 982-4315
AREA CODE 505

NSP - 901
104 D II
No Waiting

December 19, 1972

New Mexico Oil Conservation Commission
P. O. Box 2088
Santa Fe, New Mexico 87501

Attention: Mr. A. L. Porter, Director

Gentlemen:

On behalf of Dorchester Exploration, Inc., I would like to request approval, by administrative action, of a non-standard proration unit, as follows:

The unit shall consist of Lots 1, 2, 3, 4, 5, 6, 7, and 8, Section 3, Township 21 South, Range 27 East, N.M.P.M., Eddy County, New Mexico, containing 276.5 acres, more or less, according to the governmental survey.

Applicant proposes to drill a well to the Pennsylvanian formation at a location 660 feet from the South line and 1980 feet from the East line of the section. The non-standard unit is occasioned by a variation in the governmental survey of the section, and the entire unit is covered by one Federal oil and gas lease.

Your approval of this application will be appreciated. Applicant's address is as follows:

Dorchester Exploration, Inc.
1204 Vaughn Building
Midland, Texas 79701

Yours very truly,

Jason W. Kellahin
Jason W. Kellahin

JWK:ss
cc: Mr. Charles Koch

Federal NM 7068 Well No. 1

4	3	2	1	
← 116.50 →				
5	6	7	8	275
40	40	40	40	
12	11	10	9	
40	40	40	40	
13	14	15	16	
40	40	40	40	✓
160		320		
160		160		

Monsanto

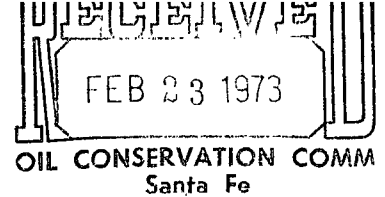

MONSANTO POLYMERS & PETROCHEMICALS CO.
317 First Savings & Loan Building
101 North Marienfeld
Midland, Texas 79701
Phone: (915) 683-3306

February 22, 1973

Oil Conservation Commission
P.O. Box 2088
Santa Fe, New Mexico 87501

Attn: Mr. A. L. Porter, Jr.
Secretary-Director

RE: Administrative Order NSP-901
Dorchester Exploration, Inc.
Undesignated - Morrow Field
Eddy County, New Mexico

Gentlemen:

As requested by your office on February 22, 1973 by phone, please find enclosed a copy of the approved USGS Application to Drill.

As of this date, we have filed Form C-104 showing change of ownership with your District Office. If any additional information is required please notify us.

Yours very truly,

MONSANTO COMPANY

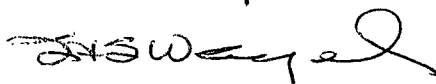
H. S. Weigel
Engineer

HSW:mm

Encl.

cc to: New Mexico Oil Conservation Commission
P.O. Drawer DD
Artesia, New Mexico 88210
Attn: Bill Gresset

With Enclosure

Monsanto

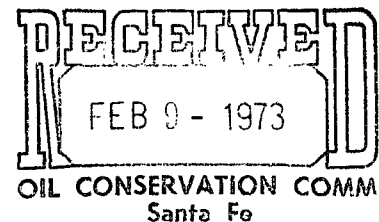

MONSANTO POLYMERS & PETROCHEMICALS CO.

317 First Savings & Loan Building
101 North Marienfeld
Midland, Texas 79701
Phone: (915) 683-3306

February 8, 1973

Oil Conservation Commission
P.O. Box 2088
Santa Fe, New Mexico 87501

Attn: Mr. A. L. Porter, Jr.
Secretary - Director

RE: Administrative Order NSP-901
Dorchester Exploration, Inc.
Undesignated - Morrow Field
Eddy County, New Mexico

Gentlemen:

Monsanto Company respectfully requests Administrative Order NSP-901 be changed to denote Monsanto Company as Operator of the non-standard unit described in the order.

Monsanto Company has entered into an agreement with the lessee of record, Mr. Duncan Miller, and has filed for permit to drill a well in lot 7. Enclosed are copies of the forms submitted for the permit.

Yours very truly,

MONSANTO COMPANY

A handwritten signature in cursive script that reads "A. W. Wood".

A. W. Wood
District Production Manager

AWW:EMS:mm
Encl.

cc to: E. H. Muhlbach
Houston, Texas

OIL CONSERVATION COMMISSION
P. O. BOX 2038
SANTA FE, NEW MEXICO 87501

RECEIVED
FEB 9 - 1973
OIL CONSERVATION COMM
Santa Fe

R

December 21, 1972

DEC 20 1972

O. C. C.
ARTESIA, OFFICE

Dorchester Exploration, Inc.
1204 Vaughn Building
Midland, Texas 79701

Administrative Order NSP-901
Corrected Copy

Gentlemen:

Reference is made to your application for approval of a 276.5-acre non-standard gas proration unit in an Undesignated Morrow Gas pool consisting of the following acreage:

EDDY COUNTY, NEW MEXICO
TOWNSHIP 21 SOUTH, RANGE 27 EAST, NMPM
Section 3: Lots 1, 2, 3, 4, 5, 6, 7, and 8

It is understood that this unit is to be dedicated to your Federal NM 7668 Well No. 1, to be located 660 feet from the South and East lines of Lot 7 of said Section 3.

By authority granted me under the provisions of Rule 104 D II you are hereby authorized to operate the above-described acreage as a non-standard gas proration unit.

Very truly yours,

A. L. PORTER, Jr.
Secretary-Director

ALP/JBK/dr

cc: Oil Conservation Commission - Artesia
Oil & Gas Engineering Committee - Hobbs
Proration Department, OCC - Santa Fe
U. S. Geological Survey - Artesia

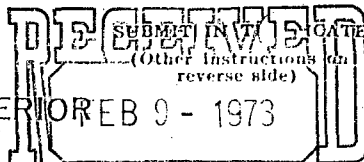
UNITED STATES
DEPARTMENT OF THE INTERIOR
GEOLOGICAL SURVEYForm approved.
Budget Bureau No. 42-R1425.

APPLICATION FOR PERMIT TO DRILL, DEEPEN, OR PLUG BACK

1a. TYPE OF WORK

DRILL ☒DEEPEN ☐PLUG BACK ☐

b. TYPE OF WELL

OIL
WELL ☐GAS
WELL ☒

OTHER

SINGLE
ZONE ☒MULTIPLE
ZONE ☐

2. NAME OF OPERATOR

MONSANTO COMPANY

3. ADDRESS OF OPERATOR

101 North Marienfeld, Midland, Texas 79701

4. LOCATION OF WELL (Report location clearly and in accordance with any State requirements.)*

At surface

1600' FNL & 1980' FEL Section 3

At proposed prod. zone

14. DISTANCE IN MILES AND DIRECTION FROM NEAREST TOWN OR POST OFFICE*

5 Miles N.E. of Carlsbad, New Mexico

15. DISTANCE FROM PROPOSED*

LOCATION TO NEAREST
PROPERTY OR LEASE LINE, FT.
(Also to nearest drlg. unit line, if any)

1600'

18. DISTANCE FROM PROPOSED LOCATION*
TO NEAREST WELL, DRILLING, COMPLETED,
OR APPLIED FOR, ON THIS LEASE, FT.

2638'

16. NO. OF ACRES IN LEASE

276.50

19. PROPOSED DEPTH

11,600'

17. NO. OF ACRES ASSIGNED
TO THIS WELL

276.50

20. ROTARY OR CABLE TOOLS

Rotary

21. ELEVATIONS (Show whether DF, RT, GR, etc.)

Will furnish later

22. APPROX. DATE WORK WILL START*

2/12/73

23.

PROPOSED CASING AND CEMENTING PROGRAM

SIZE OF HOLE	SIZE OF CASING	WEIGHT PER FOOT	SETTING DEPTH	QUANTITY OF CEMENT
17 1/2"	13 3/8"	48#	600'	750 Sx.
12 1/4"	9 5/8"	36#	3000'	1250 Sx.

Drill 17 1/2" hole to 600'; Set 13 3/8" 48# Csg. & cement to surface.

Drill 12 1/4" hole to 3000'; Set 9 5/8" 36# Csg. & cement to surface.

Drill 8 3/4" hole to 11,600' & log.

If production is indicated set 5 1/2" Csg. and cement.

Perforate and treat if necessary.

BOP - Series 1500 double hydraulic w/ series 900 annular preventer.

IN ABOVE SPACE DESCRIBE PROPOSED PROGRAM: If proposal is to deepen or plug back, give data on present productive zone and proposed new productive zone. If proposal is to drill or deepen directionally, give pertinent data on subsurface locations and measured and true vertical depths. Give blowout preventer program, if any.

24.

SIGNED

TITLE

Dist. Prod. Manager

DATE

2/2/73

(This space for Federal or State office use)

PERMIT NO.

APPROVAL DATE

APPROVED BY

TITLE

DATE

CONDITIONS OF APPROVAL, IF ANY:

NEW MEXICO OIL CONSERVATION COMMISSION
WELL LOCATION AND ACREAGE DEDICATION

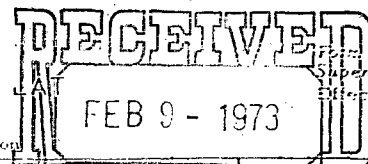

Form O-122
Supersedes O-122
Effective 1-1-65

All distances must be from the outer boundaries of the Section

Operator MONSANTO COMPANY		Location MILLER FEDERAL		Oil Conservation Comm Santa Fe 1	
Unit Letter G	Section 3	Township 21-S	Range 27-E	County EDDY	
Actual Postage Location of Well:					
1600 feet from the North line and 1980 feet from the East line					
Ground Level Elev:	Producing Formation MORROW	Pool UNDESIGNATED	Dedicated Acreage: Acres		

1. Outline the acreage dedicated to the subject well by colored pencil or hachure marks on the plat below.
2. If more than one lease is dedicated to the well, outline each and identify the ownership thereof (both as to working interest and royalty).
3. If more than one lease of different ownership is dedicated to the well, have the interests of all owners been consolidated by communitization, unitization, force-pooling, etc?

☐ Yes ☐ No If answer is "yes," type of consolidation _____

If answer is "no," list the owners and tract descriptions which have actually been consolidated. (Use reverse side of this form if necessary.) _____

No allowable will be assigned to the well until all interests have been consolidated (by communitization, unitization, forced-pooling, or otherwise) or until a non-standard unit, eliminating such interests, has been approved by the Commission.

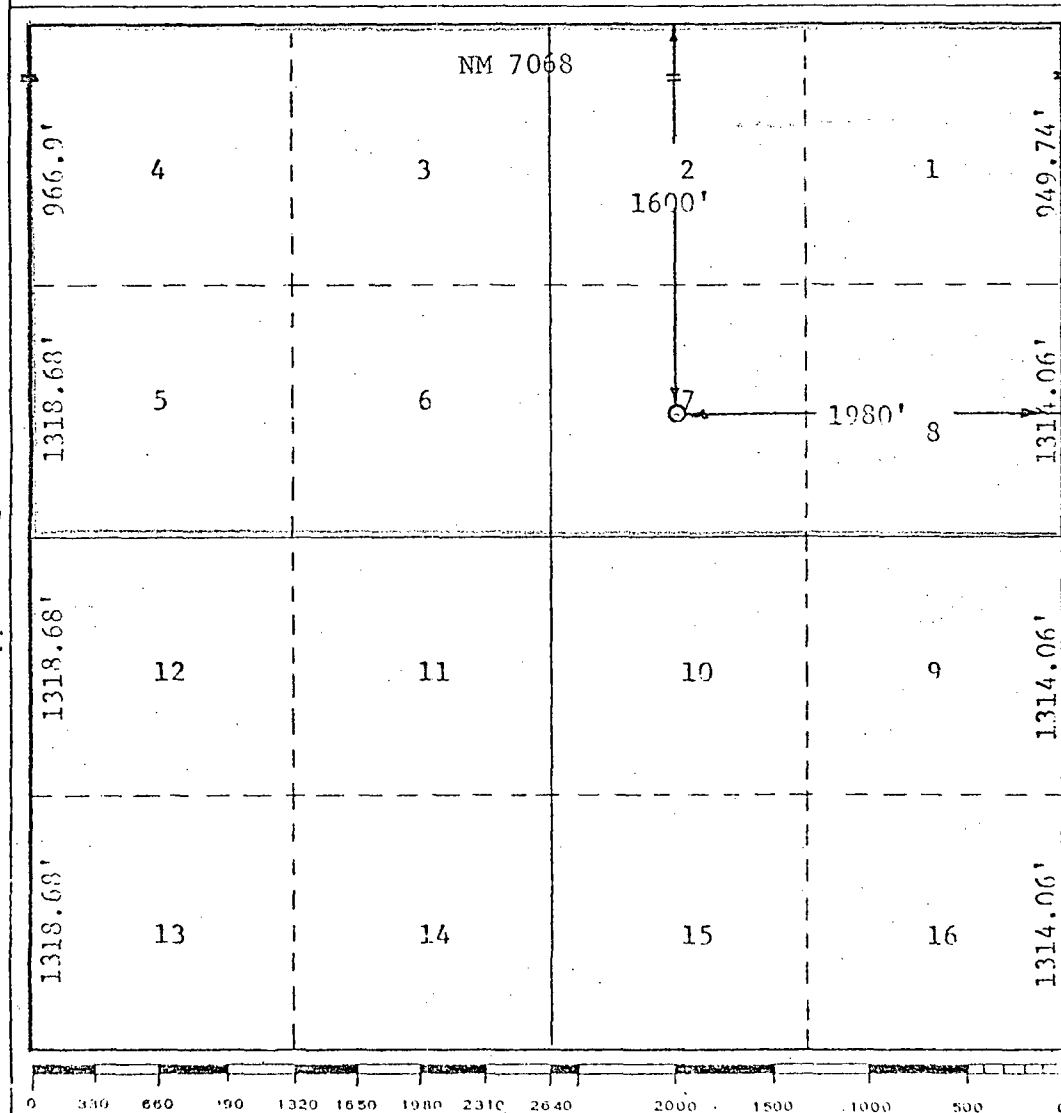

CERTIFICATION

I hereby certify that the information contained herein is true and complete to the best of my knowledge and belief.

A. W. Wood

Name
A. W. Wood
Position
Dist. Prod. Manager
Company
MONSANTO COMPANY
Date
February 2, 1973

I hereby certify that the well location shown on this plat was plotted from field notes of actual surveys made by me or under my supervision, and that the same is true and correct to the best of my knowledge and belief.

REGISTERED LAND SURVEYOR
STATE OF NEW MEXICO
No. **4882**
Richard B. Duntley
Registered Professional Engineer
and Professional Surveyor
Richard B. Duntley
Certificate No. **4882**

- Approx. 1 1/2 Mile -