

PHONES: 748-2831  
748-2840

# CHASE WELL SERVICE

P. O. BOX 637

ARTESIA, NEW MEXICO 88210

GEORGE A. CHASE  
OWNER

December 22, 1972

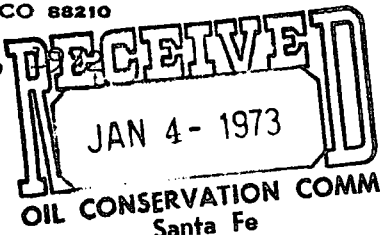

New Mexico Oil Conservation Commission  
P. O. Box 2088  
Santa Fe, New Mexico 88501

*NSP - 903*

Gentlemen:

*R-4434 Rule 3*

I am requesting an exception to Rule 2 of Order R-3981-A ammended by R-4434, and an application under Rule 3 for a non-standard proration unit comprising the E $\frac{1}{2}$  NW $\frac{1}{4}$  and SW $\frac{1}{4}$  NE $\frac{1}{4}$  of Section 5, T-15-S, R-30-E, NMPM Chaves County, New Mexico. The acreage stipulations are met and the unit shall be assigned to the Martha No. 1.

*due Feb 3*

By certified mail a copy of this application is being mailed to Jack L. McClellan, P. O. Box 848, Roswell, N. M. 88201; Cities Service Oil Company, P. O. Box 69, Hobbs, N. M. 88240; and to Amerada Hess Corporation, P. O. Drawer 817, Seminole, Texas 79360, as the offset operators.

Very truly yours,

  
George A. Chase

cc: New Mexico Oil Conservation Commission  
Hobbs, N. M.

NEW MEXICO OIL CONSERVATION COMMISSION  
WELL LOCATION AND ACREAGE DEDICATION PLAT

**RECEIVED**  
OIL CONSERVATION COMM.  
Santa Fe

Form C-102  
Supersedes C-128  
Effective 1-1-65

All distances must be from the outer boundaries of the Section

Operator <b>George A. Chase</b>		Lease <b>Martha</b>		Well No. <b>1</b>	
Unit Letter <b>2</b>	Section <b>5</b>	Township <b>17N</b>	Range <b>30E</b>	County <b>Chaves</b>	
Actual Footage Location of Well: <b>2310</b> feet from the <b>North</b> line and <b>1650</b> feet from the <b>West</b> line					
Ground Level Elev: <b>3925</b>	Producing Formation <b>Guadalupe</b>		Pool <b>Double L Queen Associated</b>		Dedicated Acreage: <b>120</b> Acres

1. Outline the acreage dedicated to the subject well by colored pencil or hachure marks on the plat below.
2. If more than one lease is dedicated to the well, outline each and identify the ownership thereof (both as to working interest and royalty).
3. If more than one lease of different ownership is dedicated to the well, have the interests of all owners been consolidated by communitization, unitization, force-pooling, etc?

☐ Yes ☒ No If answer is "yes," type of consolidation \_\_\_\_\_

If answer is "no," list the owners and tract descriptions which have actually been consolidated. (Use reverse side of this form if necessary.) \_\_\_\_\_

No allowable will be assigned to the well until all interests have been consolidated (by communitization, unitization, forced-pooling, or otherwise) or until a non-standard unit, eliminating such interests, has been approved by the Commission.

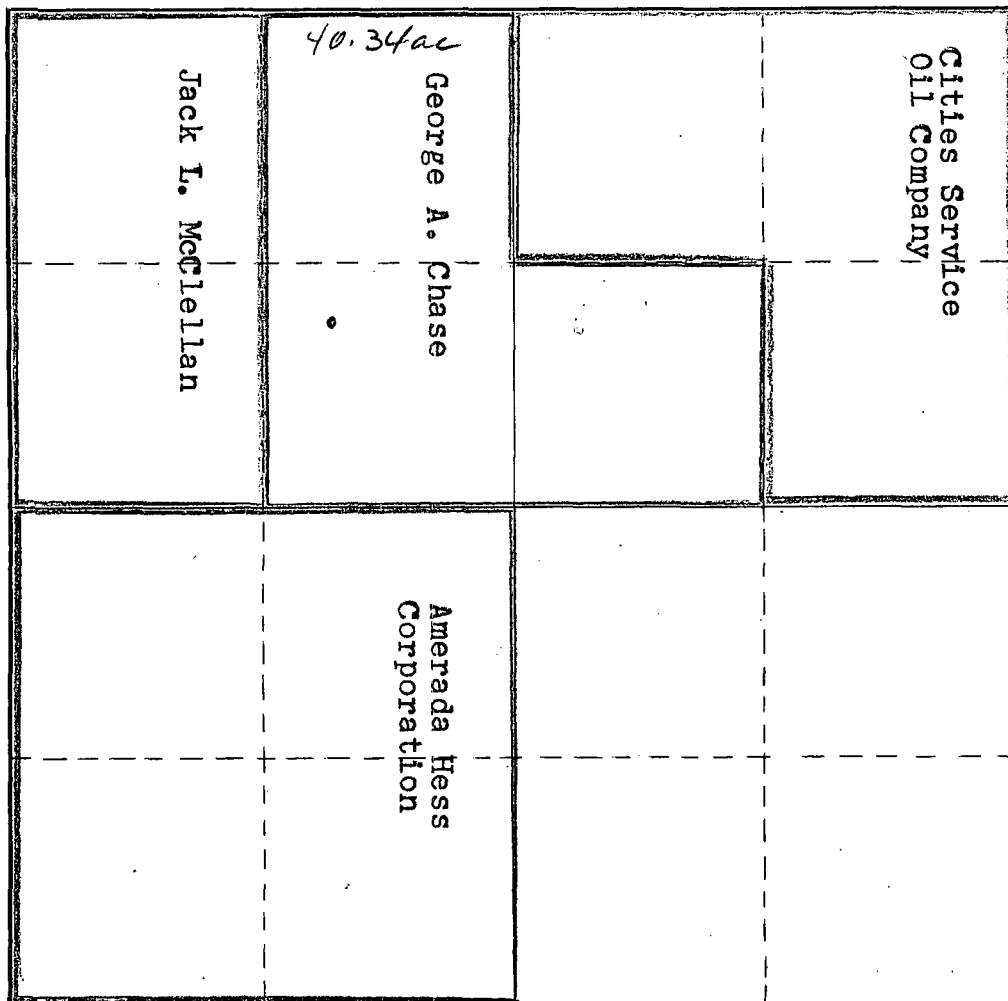

CERTIFICATION

I hereby certify that the information contained herein is true and complete to the best of my knowledge and belief.

Name

Position

**Owner**

Company

**George A. Chase**

Date

**December 23, 1972**

I hereby certify that the well location shown on this plat was plotted from field notes of actual surveys made by me or under my supervision, and that the same is true and correct to the best of my knowledge and belief.

Date Surveyed

Registered Professional Engineer and/or Land Surveyor

Certificate No.