

ABOVE THIS LINE FOR DIVISION USE ONLY

NEW MEXICO OIL CONSERVATION DIVISION
- Engineering Bureau -
1220 South St. Francis Drive, Santa Fe, NM 87505



OXY USA
Fed 29 #5

ADMINISTRATIVE APPLICATION CHECKLIST

THIS CHECKLIST IS MANDATORY FOR ALL ADMINISTRATIVE APPLICATIONS FOR EXCEPTIONS TO DIVISION RULES AND REGULATIONS WHICH REQUIRE PROCESSING AT THE DIVISION LEVEL IN SANTA FE

Application Acronyms:

[NSL-Non-Standard Location] [NSP-Non-Standard Proration Unit] [SD-Simultaneous Dedication]
[DHC-Downhole Commingling] [CTB-Lease Commingling] [PLC-Pool/Lease Commingling]
[PC-Pool Commingling] [OLS - Off-Lease Storage] [OLM-Off-Lease Measurement]
[WFX-Waterflood Expansion] [PMX-Pressure Maintenance Expansion]
[SWD-Salt Water Disposal] [IPI-Injection Pressure Increase]
[EOR-Qualified Enhanced Oil Recovery Certification] [PPR-Positive Production Response]

- [1] **TYPE OF APPLICATION** - Check Those Which Apply for [A]
[A] Location - Spacing Unit - Simultaneous Dedication
☒ NSL ☐ NSP ☐ SD

Check One Only for [B] or [C]

- [B] Commingling - Storage - Measurement
☐ DHC ☐ CTB ☐ PLC ☐ PC ☐ OLS ☐ OLM

- [C] Injection - Disposal - Pressure Increase - Enhanced Oil Recovery
☐ WFX ☐ PMX ☐ SWD ☐ IPI ☐ EOR ☐ PPR

- [D] Other: Specify _____

- [2] **NOTIFICATION REQUIRED TO:** - Check Those Which Apply, or ☐ Does Not Apply
[A] ☒ Working, ~~Royalty~~ or ~~Overriding Royalty~~ Interest Owners
[B] ☒ ~~Offset Operators~~, Leaseholders or ~~Surface Owner~~
[C] ☐ Application is One Which Requires Published Legal Notice
[D] ☒ Notification and/or Concurrent Approval by BLM or SLO
U.S. Bureau of Land Management - Commissioner of Public Lands, State Land Office
[E] ☐ For all of the above, Proof of Notification or Publication is Attached, and/or,
[F] ☐ Waivers are Attached

- [3] **SUBMIT ACCURATE AND COMPLETE INFORMATION REQUIRED TO PROCESS THE TYPE OF APPLICATION INDICATED ABOVE.**

[4] **CERTIFICATION:** I hereby certify that the information submitted with this application for administrative approval is **accurate** and **complete** to the best of my knowledge. I also understand that **no action** will be taken on this application until the required information and notifications are submitted to the Division.

~~Note: Statement must be completed by an individual with managerial and/or supervisory capacity.~~

David Stewart
Print or Type Name

[Signature]
Signature

SR. Reg. Analyst
Title

9/15/09
7/23/09
Date

david_stewart@oxy.com
e-mail Address

Federal 29 #5

RECEIVED OCD
2009 SEP 17 A 11:23



OXY USA Inc.

**PO Box 50250
Midland, TX 79710-0250**

9/15/09
~~July 23, 2009~~

New Mexico Oil Conservation Division
1220 South St. Francis Dr.
Santa Fe, NM 87505

Attention: Richard Ezeanyim

Re: *Application for Administrative Approval of Non-Standard Location –
Sand Dunes Delaware, West
Federal 29 #5
Surface/Penetration Point – 330 FNL 2460 FWL Ut C
Bottom Hole – 332 FNL 376 FWL Ut D
Section 29 T23S R31E
Eddy County, New Mexico*

Dear Mr. Ezeanyim:

OXY USA Inc. respectfully requests administrative approval under Rule 104 (F) of this application for the subject non-standard well location on the Federal 29 #5. The #1 well is proposed in the Delaware with a TVD of 8300'. The kickoff point for the well is at approximately 4200' and the top of the Delaware formation is expected at 4035', which is above the kickoff point. The wellbore will be at an orthodox location when it penetrates the Delaware Brushy Canyon reservoir, but will not be orthodox at the top of the Delaware. The non-standard location is necessary for reasons of topography, as required by the BLM.

The #1 encroaches on the east (B) 29-23S-31E, and (C) 29-23S-31E, 40-acre spacing unit. All of the interest owners have joined in the drilling of the #5 and waivers have been attached.

To support this request, the following information has been submitted for your review:

1. Application for Permit to Drill.
2. NMOCD C-102 Plat for the proposed well with offsetting well and affected spacing units.
3. List of affected offset parties that adjoin the non-standard well and the spacing unit being encroached upon, along with a copy of the certified returned receipts and signed waivers. Copies of the signed certified receipts will be furnished upon request.
4. Proposed Directional Survey

If you need any additional information, please call me at 432-685-5717.

Sincerely,

David Stewart
Sr. Regulatory Analyst
OXY USA Inc.

Attachments

CC: NMOCD-Artesia, BLM-Carlsbad, Service List

UNITED STATES
DEPARTMENT OF THE INTERIOR
BUREAU OF LAND MANAGEMENT

FORM APPROVED
OMB NO. 1004-0136
Expires: November 30, 2000

APPLICATION FOR PERMIT TO DRILL OR REENTER

1a. Type of Work <input checked="" type="checkbox"/> DRILL <input type="checkbox"/> REENTER		5. Lease Serial No. NMNM0545035
1b. Type of Well <input checked="" type="checkbox"/> Oil Well <input type="checkbox"/> Gas Well <input type="checkbox"/> Other <input checked="" type="checkbox"/> Single Zone <input type="checkbox"/> Multiple Zone		6. If Indian, Allottee or Tribe Name
2. Name of Operator OXY USA Inc.		7. Unit or CA Agreement Name and No.
3a. Address P.O. Box 50250 Midland, TX 79710-0250	3b. Phone No. (include area code) 16696 432-685-5717	8. Lease Name and Well No. Federal 29 #5
4. Location of Well (Report location clearly and in accordance with any State requirements)* At surface 330 FNL 2460 FWL NENW(C) At proposed prod. zone 332 FNL 376 FWL WNW(C)		9. API Well No. 30-015-
14. Distance in miles and direction from nearest town or post office* 20 miles northeast from Loving, NM		10. Field and Pool, or Exploratory Sand Dunes Delaware, West
15. Distance from proposed* location to nearest property or lease line, ft. (Also to nearest drg. unit line, if any) 332'	16. No. of Acres in lease 320	11. Sec., T., R., M., or Blk. and Survey or Area Sec 23 T23S R31E
18. Distance from proposed location* to nearest well, drilling, completed, applied for, on this lease, ft. 2134'	19. Proposed Depth 8700'M 8300'V	12. County or Parish Eddy
21. Elevations (Show whether DF, KDB, RT, GL, etc.) 3340.1' GL	22. Approximate date work will start* 8/09	13. State NM
17. Spacing Unit dedicated to this well 40		
20. BLM/BIA Bond No. on file ES0136		
23. Estimated duration 45		

24. Attachments

The following, completed in accordance with the requirements of Onshore Oil and Gas Order No. 1; shall be attached to this form:

- | | |
|---|--|
| 1. Well plat certified by a registered surveyor. | 4. Bond to cover the operations unless covered by an existing bond on file (see Item 20 above). |
| 2. A Drilling Plan | 5. Operator certification. |
| 3. A Surface Use Plan (if the location is on National Forest System Lands, the SUPO shall be filed with the appropriate Forest Service Office). | 6. Such other site specific information and/or plans as may be required by the authorized officer. |

25. Signature 	Name (Printed/Typed) David Stewart	Date 5/15/09
Title Sr. Regulatory Analyst		
Approved by (Signautre)	Name (Printed/Typed)	Date
Title	Office	

Application approval does not warrant or certify that the applicant holds legal or equitable title to those rights in the subject lease which would entitle the applicant to conduct operations thereon.
Conditions of approval, if any, are attached.

Title 18 U.S.C. Section 1001 and Title 43 U.S.C. Section 1212, make it a crime for any person knowingly and willfully to make to any department or agency of the United States any false, fictitious or fraudulent statements or representations as to any matter within its jurisdiction.

*(Instructions on Reverse)

District I
1625 N. French Dr., Hobbs, NM 88240
District II
1301 W. Grand Avenue, Artesia, NM 88210
District III
1000 Rio Brazos Rd., Aztec, NM 87410
District IV
1220 S. St. Francis Dr., Santa Fe, NM 87505

State of New Mexico
Energy, Minerals & Natural Resources Department
OIL CONSERVATION DIVISION
1220 South St. Francis Dr.
Santa Fe, NM 87505

Form C-102
Revised October 12, 2005
Submit to Appropriate District Office
State Lease- 4 Copies
Fee Lease- 3 Copies

☐ AMENDED REPORT

WELL LOCATION AND ACREAGE DEDICATION PLAT

API Number 30-015-	Pool Code 53815	Pool Name Sand Dunes Delaware, West
Property Code 304820	Property Name FEDERAL 29	Well Number 5
OGRID No. 16696	Operator Name OXY USA INC.	Elevation 3340.1'

Surface Location

UL or lot no. C	Section 29	Township 23 SOUTH	Range 31 EAST, N.M.P.M.	Lot Idn	Feet from the 330'	North/South line NORTH	Feet from the 2460'	East/West line WEST	County EDDY
---------------------------	----------------------	-----------------------------	-----------------------------------	---------	------------------------------	----------------------------------	-------------------------------	-------------------------------	-----------------------

Bottom Hole Location If Different From Surface

UL or lot no. D	Section 29	Township 23 SOUTH	Range 31 EAST, N.M.P.M.	Lot Idn	Feet from the 332'	North/South line NORTH	Feet from the 376'	East/West line WEST	County EDDY
---------------------------	----------------------	-----------------------------	-----------------------------------	---------	------------------------------	----------------------------------	------------------------------	-------------------------------	-----------------------

Dedicated Acres	Joint or Infill	Consolidation Code	Order No.
-----------------	-----------------	--------------------	-----------

No allowable will be assigned to this completion until all interests have been consolidated or a non-standard unit has been approved by the division.

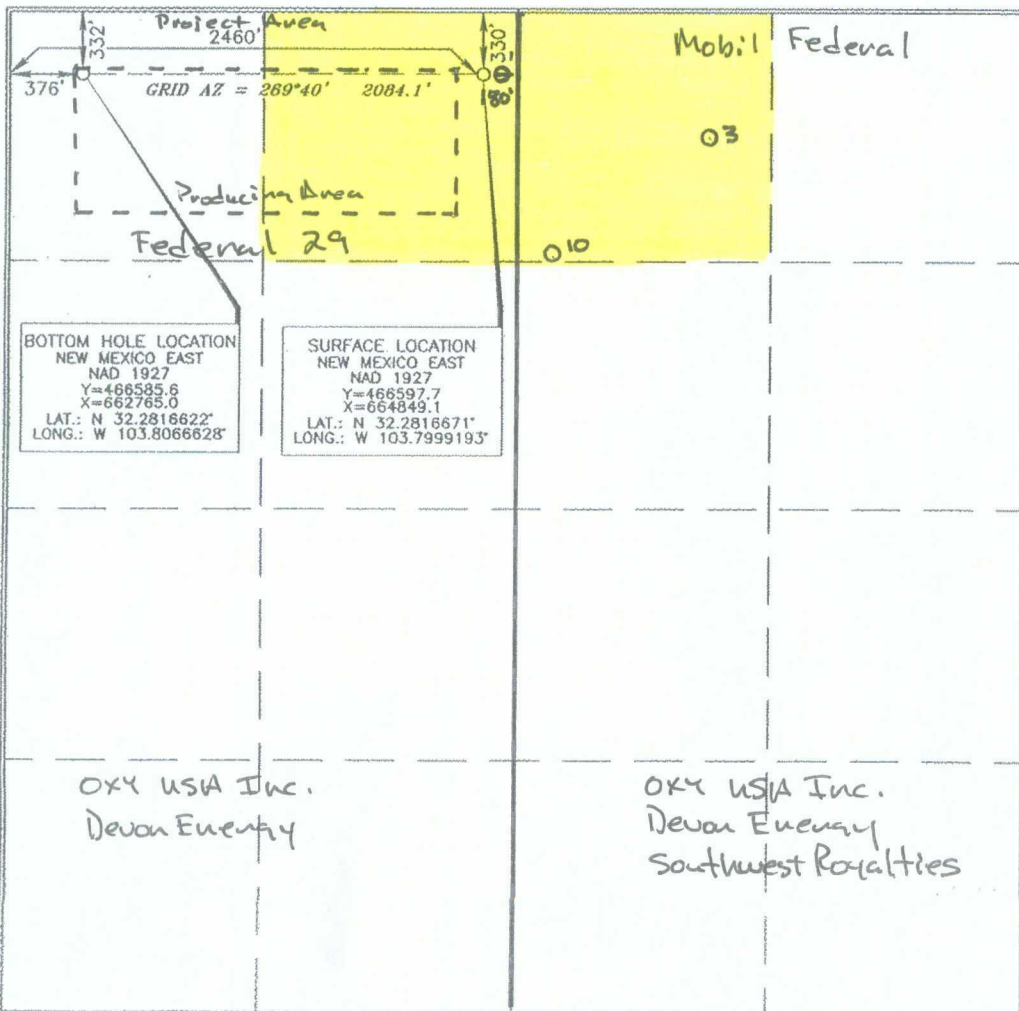

OPERATOR CERTIFICATION

I hereby certify that the information contained herein is true and complete to the best of my knowledge and belief, and that this organization either owns a working interest or unleased mineral interest in the land including the proposed bottom hole location or has a right to drill this well at this location pursuant to a contract with an owner of such a mineral or working interest, or to a voluntary pooling agreement or a compulsory pooling order heretofore entered by the division.

Signature _____ Date _____

Printed Name _____

SURVEYOR CERTIFICATION

I hereby certify that the well location shown on this plat was plotted from field notes or actual surveys made by me or under my supervision, and that the same is true and correct to the best of my belief.

15079

FEBRUARY 26, 2009

Date of Survey

Signature and Seal of Professional Surveyor

Terry J. Paul 5/14/2009

Certificate Number 15079

District I
1625 N. French Dr., Hobbs, NM 88240
District II
1301 W. Grand Avenue, Artesia, NM 88210
District III
1000 Rio Brazos Rd., Aztec, NM 87410
District IV
1220 S. St. Francis Dr., Santa Fe, NM 87505

State of New Mexico
Energy, Minerals & Natural Resources Department
OIL CONSERVATION DIVISION
1220 South St. Francis Dr.
Santa Fe, NM 87505

Form C-102
Revised October 12, 2005
Submit to Appropriate District Office
State Lease- 4 Copies
Fee Lease- 3 Copies
☐ AMENDED REPORT

WELL LOCATION AND ACREAGE DEDICATION PLAT

API Number 30-015-	Pool Code 53815	Pool Name Sand Dunes Delaware, West
Property Code 304820	Property Name FEDERAL 29	Well Number 5
OGRID No. 16696	Operator Name OXY USA INC.	Elevation 3340.1'

Surface Location

UL or lot no. C	Section 29	Township 23 SOUTH	Range 31 EAST, N.M.P.M.	Lot Idn	Feet from the 330'	North/South line NORTH	Feet from the 2460'	East/West line WEST	County EDDY
---------------------------	----------------------	-----------------------------	-----------------------------------	---------	------------------------------	----------------------------------	-------------------------------	-------------------------------	-----------------------

Bottom Hole Location If Different From Surface

UL or lot no. D	Section 29	Township 23 SOUTH	Range 31 EAST, N.M.P.M.	Lot Idn	Feet from the 332'	North/South line NORTH	Feet from the 376'	East/West line WEST	County EDDY
---------------------------	----------------------	-----------------------------	-----------------------------------	---------	------------------------------	----------------------------------	------------------------------	-------------------------------	-----------------------

Dedicated Acres 40	Joint or Infill N	Consolidation Code	Order No.
------------------------------	-----------------------------	--------------------	-----------

No allowable will be assigned to this completion until all interests have been consolidated or a non-standard unit has been approved by the division.

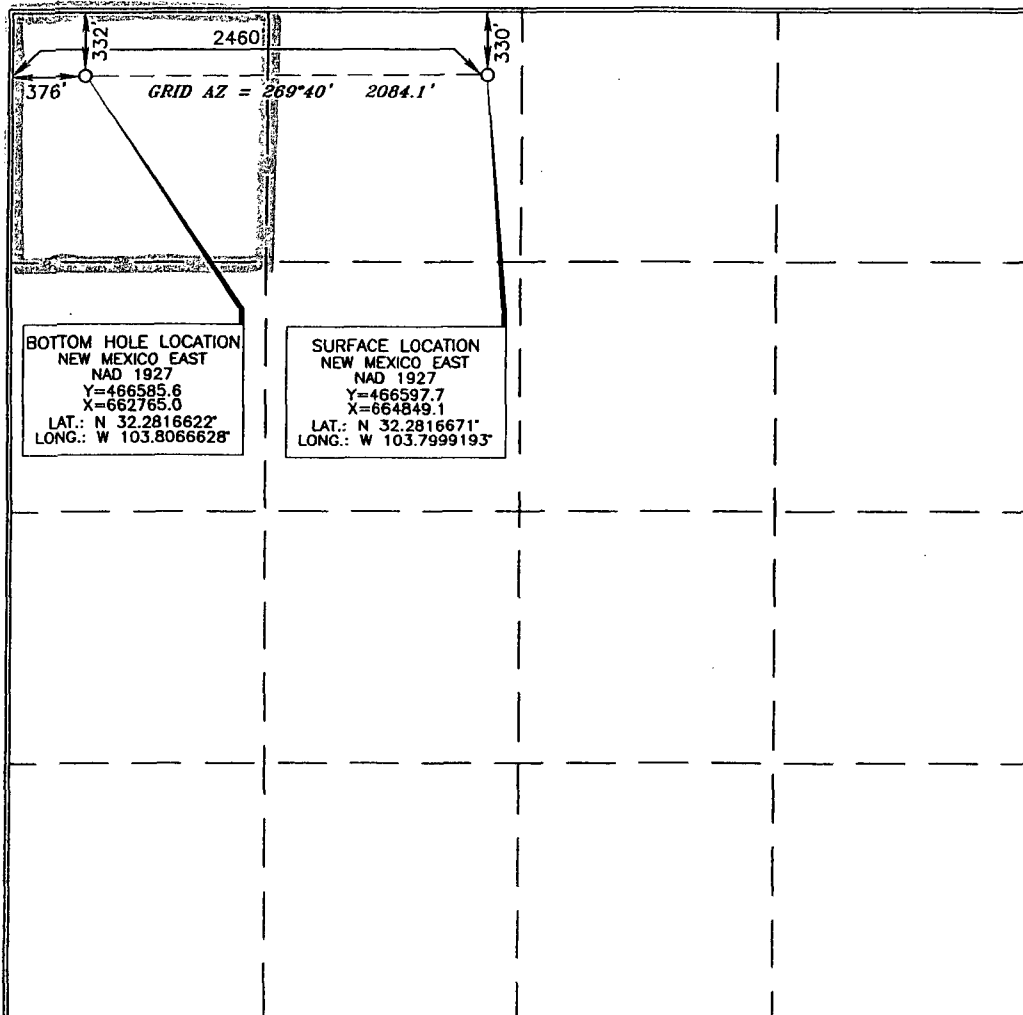

OPERATOR CERTIFICATION

I hereby certify that the information contained herein is true and complete to the best of my knowledge and belief, and that this organization either owns a working interest or unleased mineral interest in the land including the proposed bottom hole location or has a right to drill this well at this location pursuant to a contract with an owner of such a mineral or working interest, or to a voluntary pooling agreement or a compulsory pooling order heretofore entered by the division.

David Stewart
Signature Date

David Stewart
Printed Name

SURVEYOR CERTIFICATION

I hereby certify that the well location shown on this plat was plotted from field notes of actual surveys made by me or under my supervision, and that the same is true and correct to the best of my belief.

FEBRUARY 26, 2009
Date of Survey

Signature and Seal of Professional Surveyor

Terry J. Paul 5/14/2009
Certificate Number 15079

WO# 080828WL-f (Rev. B) (KA)

LOCATION VERIFICATION MAP

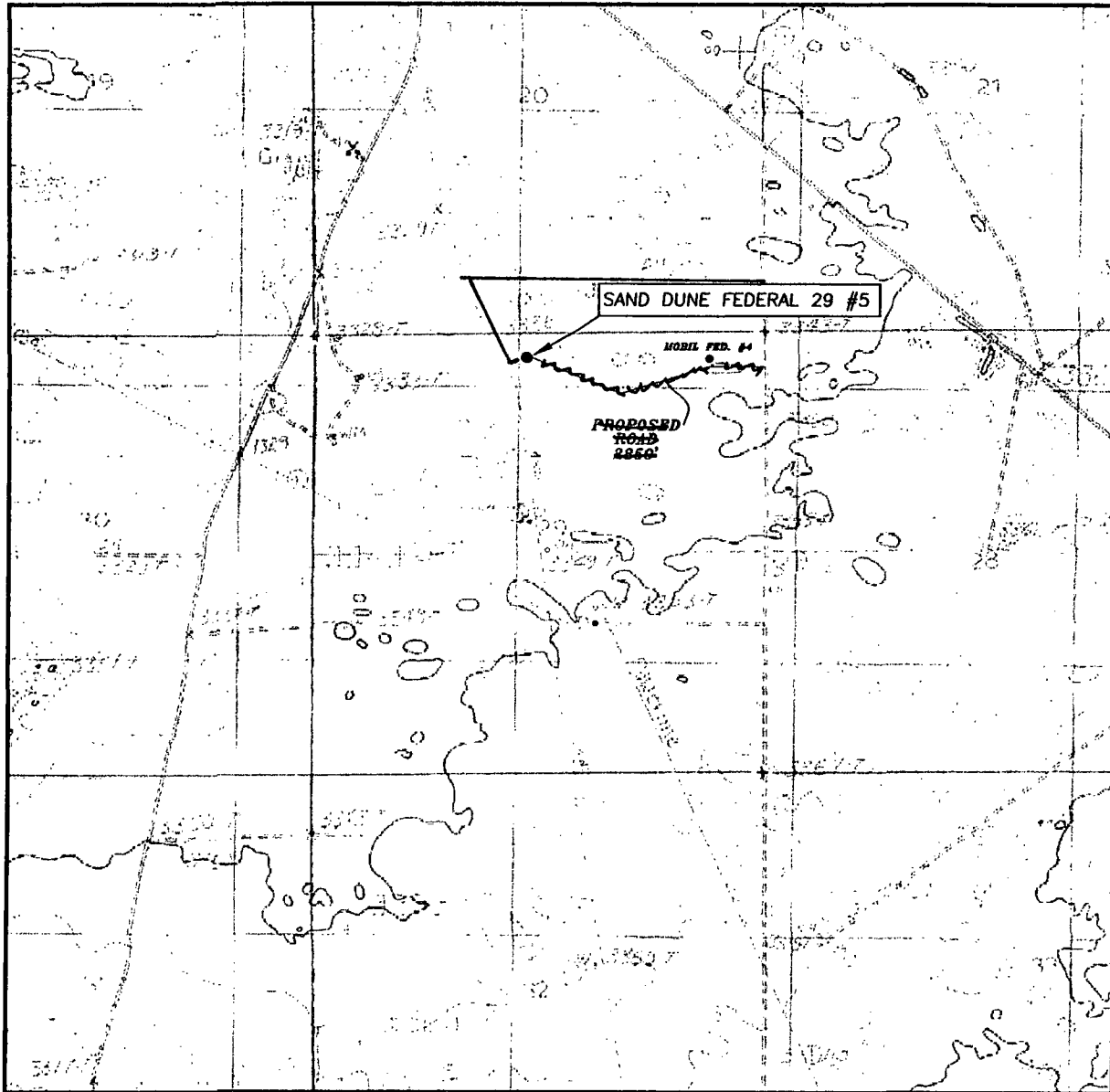

SCALE: 1" = 2000'

CONTOUR INTERVAL: 10'

SEC. 29 TWP. 23-S RGE. 31-E

SURVEY N.M.P.M.

COUNTY EDDY

DESCRIPTION 330' FNL & 2460' FWL

ELEVATION 3340.1'

OPERATOR OXY USA INC.

LEASE SAND DUNE FEDERAL 29 #5

U.S.G.S. TOPOGRAPHIC MAP
LOS MEDANOS, N.M.

DIRECTIONS:

BEGINNING AT THE INTERSECTION OF N.M. STATE HWY. #128 AND EDDY COUNTY ROAD #798 (RED ROAD), GO NORTHWEST ON N.M. STATE HWY. #128 FOR 3.9 MILES, TURN LEFT AND GO SOUTH ON LEASE ROAD FOR 0.5 MILES, TURN RIGHT ON PROPOSED ROAD AND GO WEST FOR 0.5 MILES TO LOCATION.

Asel Surveying

P.O. BOX 393 - 310 W. TAYLOR
HOBBS, NEW MEXICO - 575-393-9146

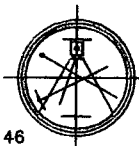



OXY USA Inc.

A subsidiary of Occidental Petroleum Corporation

5 Greenway Plaza, Suite 110, Houston, Texas 77046-0521
P.O. Box 27570, Houston, Texas 77227-7570
Phone 713.215.7000

July 13, 2009

Ken Gray
Devon Energy Production Company, LP
20 North Broadway
Oklahoma City, OK 73102

RE: **Federal 29 #5**
330' FNL & 2460' FWL (surface location) (NE NW)
332' FNL & 376' FWL (bottom hole location) (NW NW)
Section 29-23S-31E
Eddy County, New Mexico

Gentlemen:

The location for the directional Federal 29 #5 well 330' FNL and 2460' FWL of Section 29-23S-31E, Eddy County, NM is an unorthodox location where the well penetrates portions of the Delaware formation.

OXY is filing an application with the New Mexico Oil Conservation Division (OCD) for administrative approval of this non-standard location (NSL). The owners of the Mobil Federal lease covering the E/2 of Section 29-23S-31E are the only affected parties entitled to notice. Your execution of this waiver will facilitate administrative approval of OXY's NSL application. OXY requests that you waive any protest or objection to the NSL for the referenced well.

Your favorable consideration and early reply will be appreciated. Please return a signed copy of this waiver letter to me at the address shown above.

Very truly yours,

OXY USA Inc.

Donna G Havins
Land Negotiator
Dir: (713) 215-7232
Cell: (713) 202-7559
Fax: (713) 985-1818
email: donna_havins@oxy.com

Devon Energy Production Company, LP hereby waives any protest or objection to the non-standard location of the Federal 29 #5 well.

Devon Energy Production Company, LP

By

Dated

7/21/09



OXY USA Inc.

A subsidiary of Occidental Petroleum Corporation

5 Greenway Plaza, Suite 110, Houston, Texas 77046-0521
P.O. Box 27570, Houston, Texas 77227-7570
Phone 713.215.7000

July 13, 2009

Randy Howard
Southwest Royalties Inc.
#6 Desta Drive, Suite 2100
Midland, TX 79705

RE: **Federal 29 #5**
330' FNL & 2460' FWL (surface location) **(NE NW)**
332' FNL & 376' FWL (bottom hole location) **(NW NW)**
Section 29-23S-31E
Eddy County, New Mexico

Gentlemen:

The location for the directional Federal 29 #5 well 330' FNL and 2460' FWL of Section 29-23S-31E, Eddy County, NM is an unorthodox location where the well penetrates portions of the Delaware formation.

OXY is filing an application with the New Mexico Oil Conservation Division (OCD) for administrative approval of this non-standard location (NSL). The owners of the Mobil Federal lease covering the E/2 of Section 29-23S-31E are the only affected parties entitled to notice. Your execution of this waiver will facilitate administrative approval of OXY's NSL application. OXY requests that you waive any protest or objection to the NSL for the referenced well.

Your favorable consideration and early reply will be appreciated. Please return a signed copy of this waiver letter to me at the address shown above.

Very truly yours,

OXY USA Inc.

Donna G Havins
Land Negotiator
Dir: (713) 215-7232
Cell: (713) 202-7559
Fax: (713) 985-1818
email: donna_havins@oxy.com

Southwest Royalties Inc hereby waives any protest or objection to the non-standard location of the Federal 29 #5 well.

Southwest Royalties Inc.

By

Randy Howard
Vice President

Dated

7/15/09

Service List – NSL
OXY USA Inc.
Federal 29 #5
Sec 29 T23S R31E

United States Dept of Interior
Bureau of Land Management
620 E. Greene Street
Carlsbad, NM 88220-6292

New Mexico Oil Conservation Division
1301 W. Grand Ave.
Artesia, NM 88210

New Mexico Oil Conservation Division
1220 South St. Francis Dr.
Santa Fe, NM 87505

Affected Offset Parties:

Devon Energy Production Co., LP
Attn: Mr. Ken Gray
20 N. Broadway
Oklahoma City, OK 73102

Southwest Royalties Inc.
Attn: Mr. Randy Howard
6 Desta Drive, Suite 2100
Midland, TX 79705



OXY Permian
Eddy County, NM
Sand Dune Federal 29 Unit
Well #5
OH

Plan: Plan #3

Global X&Y Report

07 May, 2009

PATHFINDER®

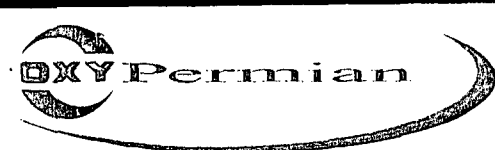

Azimuths to Grid North
True North: -0.28°
Magnetic North: 7.65°

Magnetic Field
Strength: 48890.3snT
Dip Angle: 60.27°
Date: 5/4/2009
Model: IGRF200510



Project: Eddy County, NM
Site: Sand Dune Federal 29 Unit
Well: Well #5
Wellbore: OH
Plan: Plan #3 (Well #5/OH)

WELL DETAILS: Well #5

Ground Elevation: 3340.10
RKB Elevation: Est RKB @ 3356.60ft (Flex 4 Rig)
Rig Name: Flex 4 Rig

+N/-S	+E/-W	Northing	Easting	Latitude	Longitude	Slot
0.00	0.00	466597.70	664849.10	32° 16' 54.00175 N	103° 47' 59.70915 W	

PROJECT DETAILS: Eddy County, NM
Geodetic System: US State Plane 1927 (Exact solution)
Datum: NAD 1927 (NADCON CONUS)
Ellipsoid: Clarke 1866
Zone: New Mexico East 3001

System Datum: Mean Sea Level
Local North: Grid

SECTION DETAILS

Sec	MD	Inc	Azi	TVD	+N/-S	+E/-W	DLeg	TFace	VSec	Target
1	0.00	0.00	0.00	0.00	0.00	0.00	0.00	0.00	0.00	
2	4200.00	0.00	0.00	4200.00	0.00	0.00	0.00	0.00	0.00	
3	6031.43	36.63	269.65	5909.20	-3.45	-565.73	2.00	269.65	565.74	
4	8252.43	36.63	269.65	7691.60	-11.52	-1890.81	0.00	0.00	1890.85	Sand Dune Fed 29 BC A Target
5	8576.41	36.63	269.65	7951.60	-12.70	-2084.10	0.00	0.00	2084.14	Sand Dune Fed 29 Bone Sprin
6	8599.34	36.63	269.65	7970.00	-12.78	-2097.78	0.00	0.00	2097.82	

WELLBORE TARGET DETAILS (MAP CO-ORDINATES)

Name	TVD	+N/-S	+E/-W	Northing	Easting	Shape
Sand Dune Fed 29 Delaware	4141.60	0.00	0.00	466597.70	664849.10	Point
Sand Dune Fed 29 BC A Target	7691.60	-11.52	-1890.81	466586.18	662958.29	Circle (Radius: 50.0)
Sand Dune Fed 29 Bone Springs	7951.60	-12.70	-2084.10	466585.00	662765.00	Point

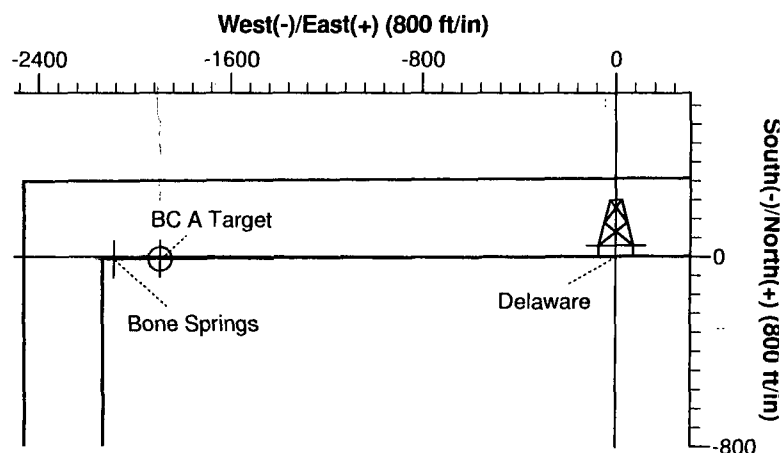
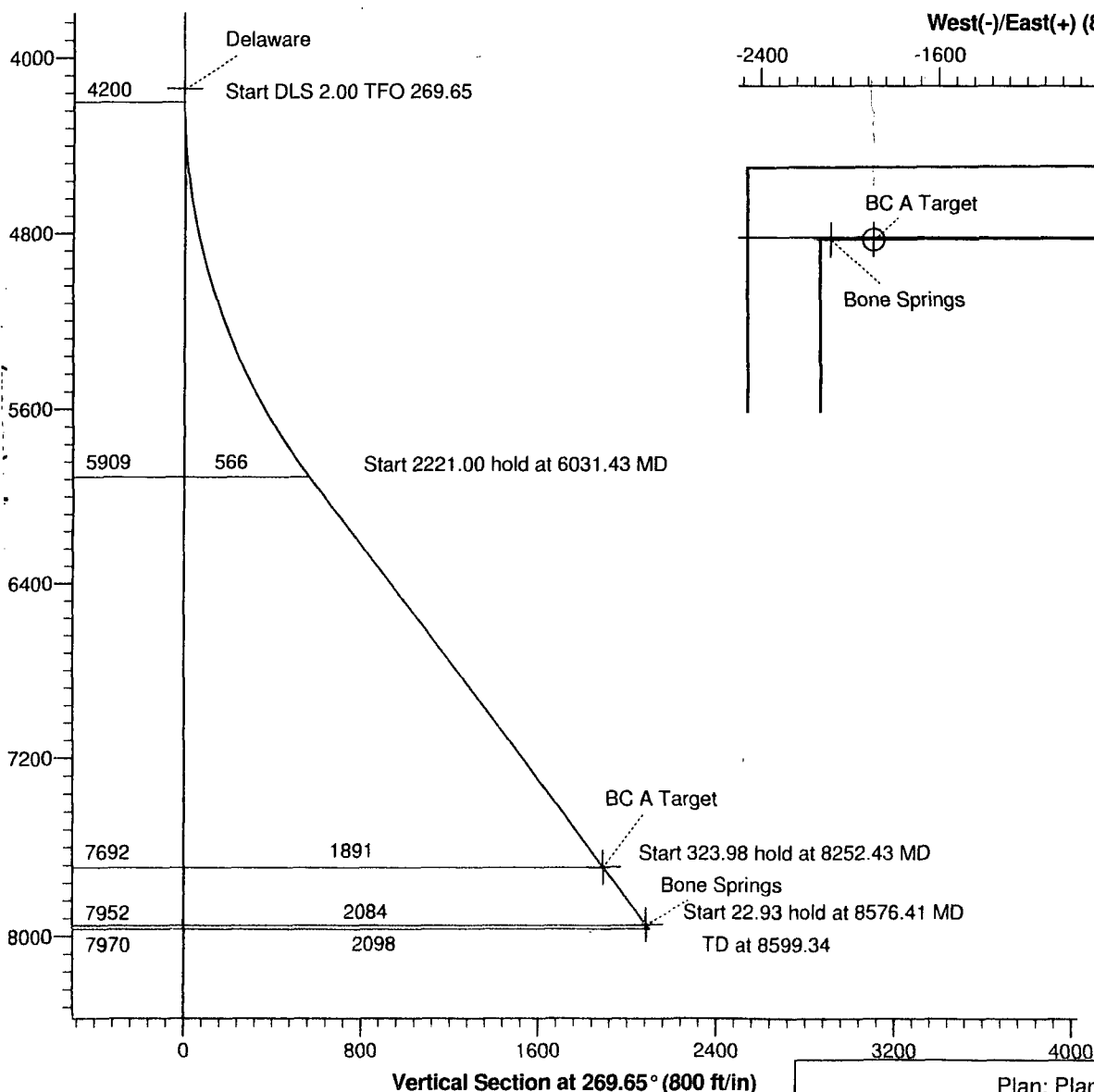



PathFinder Energy Services

Global X&Y Report



Company	OXY Permian	Local Co-ordinate Reference	Site Sand Dune Federal 29 Unit
Project	Eddy County, NM	TVD Reference	Est RKB @ 3356.60ft (Flex 4 Rig)
Site	Sand Dune Federal 29 Unit	MD Reference	Est RKB @ 3356.60ft (Flex 4 Rig)
Well	Well #5	North Reference	Grid
Wellbore	OH	Survey/Calculation Method	Minimum Curvature
Design	Plan #3	Database	2003.16 NWDB

Project	Eddy County, NM	System Datum	Mean Sea Level
Map System	US State Plane 1927 (Exact solution)		
Geo Datum	NAD 1927 (NADCON CONUS)		
Map Zone	New Mexico East 3001		

Site	Sand Dune Federal 29 Unit		
Site Position:		Northing:	466,597.70 ft
From:	Map	Easting:	664,849.10 ft
Position Uncertainty:	0.00 ft	Slot Radius:	"
		Latitude:	32° 16' 54.00175 N
		Longitude:	103° 47' 59.70915 W
		Grid Convergence:	0.28 °

Well	Well #5		
Well Position	+N/-S	0.00 ft	Northing:
	+E/-W	0.00 ft	Easting:
Position Uncertainty	0.00 ft		Wellhead Elevation:
			ft
			Latitude:
			Longitude:
			Ground Level:

Wellbore	OH		
Magnetics	Model Name	Sample Date	Declination
	IGRF200510	5/4/2009	7.94
			Dip Angle
			60.27
			Field Strength
			48.890

Design	Plan #3		
Audit Notes:			
Version:	Phase:	PROTOTYPE	Tie On Depth:
			0.00
Vertical Section:	Depth From (TVD)	+N/-S	+E/-W
	(ft)	(ft)	(ft)
	0.00	0.00	0.00
			Direction
			269.65

Survey Tool Program	Date	5/7/2009	
From	To		
(ft)	(ft)	Survey (Wellbore)	Tool Name
0.00	8,599.34	Plan #3 (OH)	MWD
			MWD - Standard

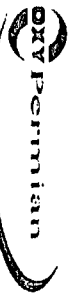

PathFinder Energy Services
Global X&Y Report



Company: OXY Permian
Project: Eddy County, NM
Site: Sand Dune Federal 29 Unit
Well: Well #5
Wellbore: OH
Design: Plan #3

Local Co-ordinate Reference
TVD Reference:
MD Reference:
North Reference:
Survey Calculation Method:
Database:
Site Sand Dune Federal 29 Unit
Est RKB @ 3356.60ft (Flex 4 Rig)
Est RKB @ 3356.60ft (Flex 4 Rig)
Grid
Minimum Curvature
2003.16 NWDB

Planned Survey

MD (ft)	Inc (°)	Azi (°)	TVD (ft)	TVDSS (ft)	V. Sec (ft)	Northing (ft)	Eastng (ft)	Dleg (°/100ft)
4,100.00	0.00	0.00	4,100.00	-743.40	0.00	466,597.70	664,849.10	0.00
4,141.60	0.00	0.00	4,141.60	-785.00	0.00	466,597.70	664,849.10	0.00
Sand Dune Fed 29 Delaware								
4,200.00	0.00	0.00	4,200.00	-843.40	0.00	466,597.70	664,849.10	0.00
4,300.00	2.00	269.65	4,299.98	-943.38	1.75	466,597.69	664,847.35	2.00
4,400.00	4.00	269.65	4,399.84	-1,043.24	6.98	466,597.66	664,842.12	2.00
4,500.00	6.00	269.65	4,499.45	-1,142.85	15.69	466,597.60	664,833.41	2.00
4,600.00	8.00	269.65	4,598.70	-1,242.10	27.88	466,597.53	664,821.22	2.00
4,700.00	10.00	269.65	4,697.47	-1,340.87	43.52	466,597.43	664,805.58	2.00
4,800.00	12.00	269.65	4,795.62	-1,439.02	62.60	466,597.32	664,786.50	2.00
4,900.00	14.00	269.65	4,893.06	-1,536.46	85.10	466,597.18	664,764.00	2.00
5,000.00	16.00	269.65	4,989.64	-1,633.04	110.98	466,597.02	664,738.12	2.00
5,100.00	18.00	269.65	5,085.27	-1,728.67	140.21	466,596.85	664,708.89	2.00
5,200.00	20.00	269.65	5,179.82	-1,823.22	172.77	466,596.65	664,676.33	2.00
5,300.00	22.00	269.65	5,273.17	-1,916.57	208.60	466,596.43	664,640.50	2.00
5,400.00	24.00	269.65	5,365.21	-2,008.61	247.67	466,596.19	664,601.43	2.00
5,500.00	26.00	269.65	5,455.84	-2,099.24	289.93	466,595.93	664,559.17	2.00
5,600.00	28.00	269.65	5,544.94	-2,188.34	335.33	466,595.66	664,513.78	2.00
5,700.00	30.00	269.65	5,632.39	-2,275.79	383.81	466,595.36	664,465.30	2.00
5,800.00	32.00	269.65	5,718.11	-2,361.51	435.31	466,595.05	664,413.80	2.00
5,900.00	34.00	269.65	5,801.97	-2,445.37	489.77	466,594.72	664,359.34	2.00
6,000.00	36.00	269.65	5,883.88	-2,527.28	547.13	466,594.37	664,301.98	2.00
6,031.43	36.63	269.65	5,909.20	-2,552.60	565.74	466,594.25	664,283.37	2.00
6,100.00	36.63	269.65	5,964.23	-2,607.63	606.65	466,594.00	664,242.46	0.00
6,200.00	36.63	269.65	6,044.49	-2,687.89	666.31	466,593.64	664,182.80	0.00
6,300.00	36.63	269.65	6,124.74	-2,768.14	725.98	466,593.28	664,123.14	0.00
6,400.00	36.63	269.65	6,204.99	-2,848.39	785.64	466,592.91	664,063.48	0.00

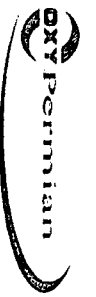

PathFinder Energy Services

Global X&Y Report



Company: OXY Permian
Project: Eddy County, NM
Site: Sand Dune Federal 29 Unit
Well: Well #5
Wellbore: OH
Design: Plan #3

Local Co-ordinate Reference:
TVD Reference:
MD Reference:
North Reference:
Survey Calculation Method:
Database:
Site Sand Dune Federal 29 Unit
Est RKB @ 3356.60ft (Flex 4 Rig)
Est RKB @ 3356.60ft (Flex 4 Rig)
Grid
Minimum Curvature
2003.16 NWDB

Planned Survey

MD (ft)	Inc (°)	Azi (°)	TVD (ft)	TVDSS (ft)	V. Sec (ft)	Northing (ft)	Eastings (ft)	Dleg (°/100ft)
6,500.00	36.63	269.65	6,285.24	-2,928.64	845.30	466,592.55	664,003.81	0.00
6,600.00	36.63	269.65	6,365.49	-3,008.89	904.96	466,592.19	663,944.15	0.00
6,700.00	36.63	269.65	6,445.75	-3,089.15	964.63	466,591.82	663,884.49	0.00
6,800.00	36.63	269.65	6,526.00	-3,169.40	1,024.29	466,591.46	663,824.83	0.00
6,900.00	36.63	269.65	6,606.25	-3,249.65	1,083.95	466,591.10	663,765.17	0.00
7,000.00	36.63	269.65	6,686.50	-3,329.90	1,143.61	466,590.73	663,705.51	0.00
7,100.00	36.63	269.65	6,766.75	-3,410.15	1,203.28	466,590.37	663,645.85	0.00
7,200.00	36.63	269.65	6,847.01	-3,490.41	1,262.94	466,590.01	663,586.18	0.00
7,300.00	36.63	269.65	6,927.26	-3,570.66	1,322.60	466,589.64	663,526.52	0.00
7,400.00	36.63	269.65	7,007.51	-3,650.91	1,382.26	466,589.28	663,466.86	0.00
7,500.00	36.63	269.65	7,087.76	-3,731.16	1,441.93	466,588.92	663,407.20	0.00
7,600.00	36.63	269.65	7,168.01	-3,811.41	1,501.59	466,588.55	663,347.54	0.00
7,700.00	36.63	269.65	7,248.27	-3,891.67	1,561.25	466,588.19	663,287.88	0.00
7,800.00	36.63	269.65	7,328.52	-3,971.92	1,620.91	466,587.82	663,228.22	0.00
7,900.00	36.63	269.65	7,408.77	-4,052.17	1,680.58	466,587.46	663,168.55	0.00
8,000.00	36.63	269.65	7,489.02	-4,132.42	1,740.24	466,587.10	663,108.89	0.00
8,100.00	36.63	269.65	7,569.27	-4,212.67	1,799.90	466,586.73	663,049.23	0.00
8,200.00	36.63	269.65	7,649.53	-4,292.93	1,859.57	466,586.37	662,989.57	0.00
8,252.43	36.63	269.65	7,691.60	-4,335.00	1,890.85	466,586.18	662,958.29	0.00
Sand Dune Fed 29 BC A Target								
8,300.00	36.63	269.65	7,729.78	-4,373.18	1,919.23	466,586.01	662,929.91	0.00
8,400.00	36.63	269.65	7,810.03	-4,453.43	1,978.89	466,585.64	662,870.25	0.00
8,500.00	36.63	269.65	7,890.28	-4,533.68	2,038.55	466,585.28	662,810.58	0.00
8,576.41	36.63	269.65	7,951.60	-4,595.00	2,084.14	466,585.00	662,765.00	0.00
Sand Dune Fed 29 Bone Springs								
8,599.34	36.63	269.65	7,970.00	-4,613.40	2,097.82	466,584.92	662,751.32	0.00

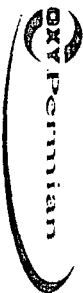

PathFinder Energy Services
Global X&Y Report



Company: OXY Permian
Project: Eddy County, NM
Site: Sand Dune Federal 29 Unit
Well: Well #5
Wellbore: OH
Design: Plan #3

Local Co-ordinate Reference:
TVD Reference:
MD Reference:
North Reference:
Survey Calculation Method:
Database:
Site Sand Dune Federal 29 Unit
Est RKB @ 3356.60ft (Flex 4 Rig)
Est RKB @ 3356.60ft (Flex 4 Rig)
Grid:
Minimum Curvature
2003.16 NWDB

Targets	Target Name	Dip Angle (°)	Dip Dir (°)	TVD (ft)	+N/S (ft)	+E/W (ft)	Northing (ft)	Easting (ft)	Latitude	Longitude
	Sand Dune Fed 29 Dc - hit/miss target - Point	0.00	0.00	4,141.60	0.00	0.00	466,597.70	664,849.10	32° 16' 54.00175 N	03° 47' 59.70915 W
	Sand Dune Fed 29 Bc - plan hits target center - Point	0.00	0.00	7,951.60	-12.70	-2,084.10	466,585.00	662,765.00	32° 16' 53.97798 N	03° 48' 23.98621 W
	Sand Dune Fed 29 Bc - plan hits target center - Circle (radius 50.00)	0.00	0.00	7,691.60	-11.52	-1,890.81	466,586.18	662,958.29	32° 16' 53.98026 N	03° 48' 21.73463 W

Checked By: _____

Approved By: _____

Date: _____



OXY USA Inc.

PO Box 50250
Midland, TX 79710-0250

July 23, 2009

CERTIFIED MAIL – RETURN RECEIPT REQUESTED

Devon Energy Production Co., LP
Attn: Ken Gray
20 N. Broadway
Oklahoma City, OK 73102

Re: *Application for Administrative Approval of Non-Standard Location –
Sand Dunes Delaware, West
Federal 29 #5
Surface/Penetration Point – 330 FNL 2460 FWL Ut C
Bottom Hole – 332 FNL 376 FWL Ut D
Section 29 T23S R31E
Eddy County, New Mexico*

Ladies and Gentlemen:

Enclosed is a copy of an application, filed with the New Mexico Oil Conservation Division by OXY USA Inc., requesting administrative approval under Rule 104 (F) of an unorthodox well location. As an affected party, notice is being provided to you pursuant to Rule 104 (F). The well is located in the NENW/4 of Section 29 T23S R31E, Eddy County, NM. If you object to the well's location, you must notify the Division in writing no later than 20 days from the date the application is received by the NMOCD (1220 South St. Francis Drive, Santa Fe, NM 87505; Attention: Richard Ezeanyim).

If you need any additional information, please call me at 432-685-5717.

Sincerely,

A handwritten signature in black ink, appearing to read "D. Stewart", is written over the word "Sincerely,".

David Stewart
Sr. Regulatory Analyst
OXY USA WTP LP

Attachments



OXY USA Inc.

**PO Box 50250
Midland, TX 79710-0250**

July 23, 2009

CERTIFIED MAIL – RETURN RECEIPT REQUESTED

Southwest Royalties Inc.
Attn: Mr. Randy Howard
6 Desta Drive, Suite 2100
Midland, TX 79705

Re: *Application for Administrative Approval of Non-Standard Location –
Sand Dunes Delaware, West
Federal 29 #5
Surface/Penetration Point – 330 FNL 2460 FWL Ut C
Bottom Hole – 332 FNL 376 FWL Ut D
Section 29 T23S R31E
Eddy County, New Mexico*

Ladies and Gentlemen:

Enclosed is a copy of an application, filed with the New Mexico Oil Conservation Division by OXY USA Inc., requesting administrative approval under Rule 104 (F) of an unorthodox well location. As an affected party, notice is being provided to you pursuant to Rule 104 (F). The well is located in the NENW/4 of Section 29 T23S R31E, Eddy County, NM. If you object to the well's location, you must notify the Division in writing no later than 20 days from the date the application is received by the NMOCD (1220 South St. Francis Drive, Santa Fe, NM 87505; Attention: Richard Ezeanyim).

If you need any additional information, please call me at 432-685-5717.

Sincerely,

A handwritten signature in black ink, appearing to read "David Stewart".

David Stewart
Sr. Regulatory Analyst
OXY USA WTP LP

Attachments

SENDER: COMPLETE THIS SECTION

- Complete items 1, 2, and 3. Also complete item 4 if Restricted Delivery is desired.
- Print your name and address on the reverse so that we can return the card to you.
- Attach this card to the back of the mailpiece, or on the front if space permits.

1. Article Addressed to:

UNITED STATES DEPT OF
INTERIOR
BUREAU OF LAND MANAGEMENT
620 E. GREENE STREET
CARLSBAD, NM 88220-6292

2. Article Number

(Transfer from service label)

7005 0390 0002 9910 6524

PS Form 3811, February 2004

Domestic Return Receipt

102595-02-M-1540

COMPLETE THIS SECTION ON DELIVERY

A. Signature

X

☐ Agent☐ Addressee

B. Received by (Printed Name)

C. Date of Delivery

- D. Is delivery address different from item 1? ☐ Yes
If YES, enter delivery address below: ☐ No

3. Service Type

☒ Certified Mail☐ Express Mail☐ Registered☐ Return Receipt for Merchandise☐ Insured Mail☐ C.O.D.

4. Restricted Delivery? (Extra Fee)

☐ Yes

SENDER: COMPLETE THIS SECTION

- Complete items 1, 2, and 3. Also complete item 4 if Restricted Delivery is desired.
- Print your name and address on the reverse so that we can return the card to you.
- Attach this card to the back of the mailpiece, or on the front if space permits.

1. Article Addressed to:

STATE OF NEW MEXICO
ENERGY & MINERALS DEPARTMENT
OIL CONSERVATION DIVISION
1301 W. GRAND AVE.
ARTESIA, NM 88210

2. Article Number

(Transfer from service label)

7005 0390 0002 9910 6500

PS Form 3811, February 2004

Domestic Return Receipt

102595-02-M-1540

COMPLETE THIS SECTION ON DELIVERY

A. Signature

X

☐ Agent☐ Addressee

B. Received by (Printed Name)

C. Date of Delivery

- D. Is delivery address different from item 1? ☐ Yes
If YES, enter delivery address below: ☐ No

3. Service Type

☒ Certified Mail☐ Express Mail☐ Registered☐ Return Receipt for Merchandise☐ Insured Mail☐ C.O.D.

4. Restricted Delivery? (Extra Fee)

☐ Yes

SENDER: COMPLETE THIS SECTION

- Complete items 1, 2, and 3. Also complete item 4 if Restricted Delivery is desired.
- Print your name and address on the reverse so that we can return the card to you.
- Attach this card to the back of the mailpiece, or on the front if space permits.

1. Article Addressed to:

STATE OF NEW MEXICO
ENERGY & MINERALS DEPARTMENT
OIL CONSERVATION DIVISION
1220 SOUTH ST. FRANCIS DR.
SANTA FE, NM 87505

2. Article Number

(Transfer from service label)

7005 0390 0002 9910 6517

PS Form 3811, February 2004

Domestic Return Receipt

102595-02-M-1540

COMPLETE THIS SECTION ON DELIVERY

A. Signature

X

☐ Agent☐ Addressee

B. Received by (Printed Name)

C. Date of Delivery

- D. Is delivery address different from item 1? ☐ Yes
If YES, enter delivery address below: ☐ No

3. Service Type

☒ Certified Mail☐ Express Mail☐ Registered☐ Return Receipt for Merchandise☐ Insured Mail☐ C.O.D.

4. Restricted Delivery? (Extra Fee)

☐ Yes

SENDER: COMPLETE THIS SECTION

- Complete items 1, 2, and 3. Also complete item 4 if Restricted Delivery is desired.
- Print your name and address on the reverse so that we can return the card to you.
- Attach this card to the back of the mailpiece, or on the front if space permits.

1. Article Addressed to:

Devon Energy Prod. Co. LP
ATTN: Ken Gray
20 N. Broadway
Oklahoma City, OK 73102

2. Article Number

(Transfer from service label)

7005 0390 0002 9910 6531

PS Form 3811, February 2004

Domestic Return Receipt

102595-02-M-1540

COMPLETE THIS SECTION ON DELIVERY

A. Signature

X

- ☐ Agent
☐ Addressee

B. Received by (Printed Name)

C. Date of Delivery

- D. Is delivery address different from item 1? ☐ Yes
If YES, enter delivery address below: ☐ No

3. Service Type

- ☒ Certified Mail ☐ Express Mail
☐ Registered ☐ Return Receipt for Merchandise
☐ Insured Mail ☐ C.O.D.

4. Restricted Delivery? (Extra Fee)

- ☐ Yes

SENDER: COMPLETE THIS SECTION

- Complete items 1, 2, and 3. Also complete item 4 if Restricted Delivery is desired.
- Print your name and address on the reverse so that we can return the card to you.
- Attach this card to the back of the mailpiece, or on the front if space permits.

1. Article Addressed to:

Southwest Royalties Inc.
Attn: Randy Howard
6 Deste Drive, Suite 2100
Midland, TX 79705

2. Article Number

(Transfer from service label)

7005 0390 0002 9910 6548

PS Form 3811, February 2004

Domestic Return Receipt

102595-02-M-1540

COMPLETE THIS SECTION ON DELIVERY

A. Signature

X

- ☐ Agent
☐ Addressee

B. Received by (Printed Name)

C. Date of Delivery

- D. Is delivery address different from item 1? ☐ Yes
If YES, enter delivery address below: ☐ No

3. Service Type

- ☒ Certified Mail ☐ Express Mail
☐ Registered ☐ Return Receipt for Merchandise
☐ Insured Mail ☐ C.O.D.

4. Restricted Delivery? (Extra Fee)

- ☐ Yes

Brooks, David K., EMNRD

From: Brooks, David K., EMNRD
Sent: Tuesday, September 22, 2009 10:26 AM
To: 'david_stewart@oxy.com'
Subject: Federal 29 #5 NSL Application

Dear Mr. Stewart

In addition to the encroachment toward the NW/4 NE/4 of Section 29, this proposed location also encroaches diagonally toward the SW/4 SE/4 of Section 21, to the northeast. See definition of "adjoining spacing unit. 19.15.2.7.A(5) NMAC.

According to NMOCD records, it seems that OXY is operator of the Delaware well in the SW/4 SE/4 of Section 21. However, if there are other working interest owners who own no interest in the proposed Federal 29 #5 well, or own a smaller interest in the well than there interest in the SW/4 SE/4 of Section 21, notice of this application to those working interest owners will be required.

Sincerely

David K. Brooks
Legal Examiner
505-476-3450

Brooks, David K., EMNRD

From: David_Stewart@oxy.com
Sent: Tuesday, September 22, 2009 12:31 PM
To: Brooks, David K., EMNRD
Subject: RE: Federal 29 #5 NSL Application - Federal 29 #1

Dear Mr. Brooks

I was going by 19.15.4.12.A(2)(c) where it talks about adjoining spacing units that are being encroached upon by the unorthodox location. So I calculated the distance from the proposed surface location and came up with well #1 being +/- 354' and #5 being +/- 376' from the spacing unit in the SW/4SE/4 of Sec 21. If this is not correct, please let me know and I will get with our land department to find out about that spacing unit. I appreciate the help.

Thanks,
David Stewart
Sr. Regulatory Analyst
OXY Permian
432-685-5717
Fax-432-685-5742

From: Brooks, David K., EMNRD [mailto:david.brooks@state.nm.us]
Sent: Tuesday, September 22, 2009 11:26 AM
To: Stewart, David
Subject: Federal 29 #5 NSL Application

Dear Mr. Stewart

In addition to the encroachment toward the NW/4 NE/4 of Section 29, this proposed location also encroaches diagonally toward the SW/4 SE/4 of Section 21, to the northeast. See definition of "adjoining spacing unit. 19.15.2.7.A(5) NMAC.

According to NMOCD records, it seems that OXY is operator of the Delaware well in the SW/4 SE/4 of Section 21. However, if there are other working interest owners who own no interest in the proposed Federal 29 #5 well, or own a smaller interest in the well than there interest in the SW/4 SE/4 of Section 21, notice of this application to those working interest owners will be required.

Sincerely

David K. Brooks
Legal Examiner
505-476-3450

Confidentiality Notice: This e-mail, including all attachments is for the sole use of the intended recipient(s) and may contain confidential and privileged information. Any unauthorized review, use, disclosure or distribution is prohibited unless specifically provided under the New Mexico Inspection of Public Records Act. If you are not the intended recipient, please contact the sender and destroy all copies of this message. -- This email has been scanned by the Sybari - Antigen Email System.

Confidentiality Notice: This e-mail, including all attachments is for the sole use of the intended recipient(s) and may contain confidential and privileged information. Any unauthorized review, use, disclosure or distribution is prohibited unless specifically provided under the New Mexico Inspection of Public Records Act. If you are not the intended recipient, please contact the sender and destroy all copies of this message. -- This email has been scanned by the MessageLabs Email Security System.

This inbound email has been scanned by the MessageLabs Email Security System.

Brooks, David K., EMNRD

From: David_Stewart@oxy.com
Sent: Wednesday, September 23, 2009 12:16 PM
To: Brooks, David K., EMNRD
Subject: FW: OXY USA Inc. - Federal 29 #1, 5 NSL Applications
Attachments: img-923125630-0001.pdf

Dear Mr. Brooks

First I would like to apologize for any inconvenience this may have caused and will remember this interpretation for further NSL applications.

Per our land department, OXY USA Inc. has 100% of the working interest in the SW/4SE/4 of Section 21 which is the Pure Gold A Federal #11, API No. 30-015-35301. Please see attached for a couple of new plats that show the affected adjoining spacing units.

If you need any additional information, please let know and I appreciate your help in this manner.

Thanks,
David Stewart
Sr. Regulatory Analyst
OXY Permian
432-685-5717
Fax-432-685-5742

From: Havins, Donna
Sent: Wednesday, September 23, 2009 9:42 AM
To: Stewart, David
Subject: RE: Federal 29 #5 NSL Application - Federal 29 #1

David
OXY owns 100% of the working interest in the Pure Gold A Federal #11 well (and in all of Section 21 from surface to the base of the Delaware).

Donna G Havins
Land Negotiator
Occidental Permian Ltd
OXY USA WTP LP
5 Greenway Plaza, Suite 110
Houston, TX 77046
P.O. Box 27757 (77227-7757)
Dir: (713) 215-7232
Cell: (713) 202-7559
Fax: (713) 985-1818
email: donna_havins@oxy.com

From: Stewart, David
Sent: Wednesday, September 23, 2009 8:28 AM

To: Havins, Donna

Subject: FW: Federal 29 #5 NSL Application - Federal 29 #1

Donna, need some help, according to the NMOCD calculations the spacing unit to the northeast is also being encroached upon, it would be the SW/4SE/4 of Section 21. OXY operates the well, which is the Pure Gold A Federal #11, API No. 42-015-35301, 660 FSL 1980 FEL. I need to know the working interest owners in the well and if they are different than whom we previously notified on the applications, we will need to get a waiver from them for these applications. If you have any questions, please let me know and as always I appreciate your help.

Thanks, David S.
432-685-5717

From: Brooks, David K., EMNRD [mailto:david.brooks@state.nm.us]

Sent: Tuesday, September 22, 2009 2:56 PM

To: Stewart, David

Subject: RE: Federal 29 #5 NSL Application - Federal 29 #1

Dear Mr. Stewart

Our interpretation is that, in the case of a diagonal encroachment, a proposed non-standard location encroaches if it is closer to the common corner than the nearest standard location. Since the nearest standard location to the common corner would be 330 feet from each unit boundary, it would be the square root of two time 330 feet squared, or 467 feet from the common corner.

Sincerely

David K. Brooks
Legal Examiner
505-476-3450

From: David_Stewart@oxy.com [mailto:David_Stewart@oxy.com]

Sent: Tuesday, September 22, 2009 12:31 PM

To: Brooks, David K., EMNRD

Subject: RE: Federal 29 #5 NSL Application - Federal 29 #1

Dear Mr. Brooks

I was going by 19.15.4.12.A(2)(c) where it talks about adjoining spacing units that are being encroached upon by the unorthodox location. So I calculated the distance from the proposed surface location and came up with well #1 being +/- 354' and #5 being +/- 376' from the spacing unit in the SW/4SE/4 of Sec 21. If this is not correct, please let me know and I will get with our land department to find out about that spacing unit. I appreciate the help.

Thanks,
David Stewart
Sr. Regulatory Analyst
OXY Permian
432-685-5717
Fax-432-685-5742

From: Brooks, David K., EMNRD [mailto:david.brooks@state.nm.us]

Sent: Tuesday, September 22, 2009 11:26 AM

To: Stewart, David
Subject: Federal 29 #5 NSL Application

Dear Mr. Stewart

In addition to the encroachment toward the NW/4 NE/4 of Section 29, this proposed location also encroaches diagonally toward the SW/4 SE/4 of Section 21, to the northeast. See definition of "adjoining spacing unit. 19.15.2.7.A(5) NMAC.

According to NMOCD records, it seems that OXY is operator of the Delaware well in the SW/4 SE/4 of Section 21. However, if there are other working interest owners who own no interest in the proposed Federal 29 #5 well, or own a smaller interest in the well than there interest in the SW/4 SE/4 of Section 21, notice of this application to those working interest owners will be required.

Sincerely

David K. Brooks
Legal Examiner
505-476-3450

Confidentiality Notice: This e-mail, including all attachments is for the sole use of the intended recipient(s) and may contain confidential and privileged information. Any unauthorized review, use, disclosure or distribution is prohibited unless specifically provided under the New Mexico Inspection of Public Records Act. If you are not the intended recipient, please contact the sender and destroy all copies of this message. -- This email has been scanned by the Sybari - Antigen Email System.

Confidentiality Notice: This e-mail, including all attachments is for the sole use of the intended recipient(s) and may contain confidential and privileged information. Any unauthorized review, use, disclosure or distribution is prohibited unless specifically provided under the New Mexico Inspection of Public Records Act. If you are not the intended recipient, please contact the sender and destroy all copies of this message. -- This email has been scanned by the MessageLabs Email Security System.

This inbound email has been scanned by the MessageLabs Email Security System.

This email and any files transmitted with it are confidential and intended solely for the use of the individual or entity to whom they are addressed. If you have received this email in error please notify the system manager. This message contains confidential information and is intended only for the individual named. If you are not the named addressee you should not disseminate, distribute or copy this e-mail.

Confidentiality Notice: This e-mail, including all attachments is for the sole use of the intended recipient(s) and may contain confidential and privileged information. Any unauthorized review, use, disclosure or distribution is prohibited unless specifically provided under the New Mexico Inspection of Public Records Act. If you are not the intended recipient, please contact the sender and destroy all copies of this message. -- This email has been scanned by the MessageLabs Email Security System.

This inbound email has been scanned for malicious software and transmitted safely to you using Webroot Email Security.

District I
1625 N. French Dr., Hobbs, NM 88240
District II
1301 W. Grand Avenue, Artesia, NM 88210
District III
1000 Rio Brazos Rd., Aztec, NM 87410
District IV
1220 S. St. Francis Dr., Santa Fe, NM 87505

State of New Mexico
Energy, Minerals & Natural Resources Department
OIL CONSERVATION DIVISION
1220 South St. Francis Dr.
Santa Fe, NM 87505

Form C-102
Revised October 12, 2005
Submit to Appropriate District Office
State Lease - 4 Copies
Fee Lease - 3 Copies

☐ AMENDED REPORT

WELL LOCATION AND ACREAGE DEDICATION PLAT

API Number 30-015-		Pool Code 53815		Pool Name Sand Dunes Delaware, West	
Property Code 304820		Property Name Federal 29			Well Number 5
OGRID No. 16696		Operator Name OXY USA INC.			Elevation 3340.1

¹⁰ Surface Location

UL or lot no. C	Section 29	Township 23S	Range 31E	Lot Idn	Feet from the	North/South line North	Feet from the	East/West line West	County Eddy
--------------------	---------------	-----------------	--------------	---------	---------------	---------------------------	---------------	------------------------	----------------

¹¹ Bottom Hole Location If Different From Surface

UL or lot no. D	Section 29	Township 23S	Range 31E	Lot Idn	Feet from the	North/South line North	Feet from the	East/West line West	County Eddy
--------------------	---------------	-----------------	--------------	---------	---------------	---------------------------	---------------	------------------------	----------------

Dedicated Acres	Joint or Infill	Consolidation Code	Order No.
-----------------	-----------------	--------------------	-----------

No allowable will be assigned to this completion until all interests have been consolidated or a non-standard unit has been approved by the division.

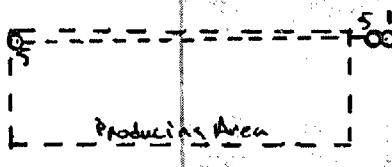
16			21	¹⁷ OPERATOR CERTIFICATION I hereby certify that the information contained herein is true and complete to the best of my knowledge and belief, and that this organization either owns a working interest or unleased mineral interest in the land including the proposed bottom hole location or has a right to drill this well at this location pursuant to a contract with an owner of such a mineral or working interest, or to a voluntary pooling agreement or a compulsory pooling order heretofore entered by the division. Signature _____ Date _____ David Stewart Printed Name
		Pure Gold H Fed. OXY USA INC. 11		
	3			¹⁸ SURVEYOR CERTIFICATION I hereby certify that the well location shown on this plat was plotted from field notes of actual surveys made by me or under my supervision, and that the same is true and correct to the best of my belief. Date of Survey _____ Signature and Seal of Professional Surveyor: _____ Certificate Number _____
			29	
Federal 29 OXY USA INC Devon Energy			Mobil Federal OXY USA INC. Devon Energy Southwest Royalties	