

Getty Oil Company

MID-CONTINENT EXPLORATION AND PRODUCTION DIVISION

~~North American Exploration and Production Division~~

P.O. Box 249  
Hobbs, New Mexico 88240

November 17, 1975

New Mexico Oil Conservation Commission  
P.O. Box 2088  
Santa Fe, New Mexico 87501

Attn: Mr. Joe D. Ramey

*NSP - 1008*  
*104 P II*  
*due Dec 19*  
Re: 80'-Acre Non-Standard Gas Proration  
Unit - Getty's Percy Hardy Wells  
Nos. 2 (Unit O) and 3 (Unit N)  
Section 17, T-21-S, R-37-E  
Lea County, New Mexico

Gentlemen:

On May 26, 1958, Administrative Order No. R-1176 (Case No. 1426) was approved by the NMOCC for the establishment of a 120 Acre Non-Standard Blinebry Gas Unit consisting of the S/2 SE/4 and SE/4 SW/4 of Section 17, T-21-S, R-37-E, Lea County, New Mexico. Percy Hardy Well No. 1 in Unit P was designated as the Unit Well for the above described Unit.

The Percy Hardy Wells Nos. 1 and 3 were reclassified to Blinebry Gas Wells effective January 1, 1972. In order to comply with provisions of Order No. 1670 pertaining to the Blinebry Gas Pool, Getty requested a 40 Acre Non-Standard Gas Unit for Percy Hardy Well No. 3 located in Unit N. This 40 Acre Non-Standard Unit was granted by Administrative Order No. NSP-855 on January 21, 1972. Percy Hardy Well No. 1 was shut-in.

On March 14, 1972, Getty requested Administrative Approval of this 120 Acres being reassigned to our Percy Hardy Wells Nos. 1 and 3. Percy Hardy Well No. 2 was shut-in. This Application was granted by Administrative Order NSP-877 on April 18, 1972.

Remedial work was done on Percy Hardy Well No. 2 in January and February, 1975 and Well No. 2 was classified as a Blinebry Gas Well.

Getty Oil Company requested that this 120 Acre Non-Standard Gas Proration Unit being S/2 SE/4 and SE/4 SW/4 of Section 17, T-21-S, R-37-E, be allocated to the Percy Hardy Well No. 1 (Unit P); Well No. 2 (Unit O); and Well No. 3 (Unit N) located in Section 17, the allowable from which to be produced from any well in any proportion. This Application was granted by NMOCC Administrative Order NSP-994.

On November 14, 1975 the NMOCC reclassified Percy Hardy Well No. 1 (Unit P, Section 17, T-21-S, R-37-E) to an oil well. (See Attached - No. 2)

NMOCC-SANTA FE  
Mr. Joe D. Ramey  
Percy Hardy Wells Nos. 2 & 3  
November 17, 1975

PAGE NO. 2

Getty Oil Company respectfully requests an 80-Acre Non-Standard Gas Proration Unit being SW/4 SE/4 and SE/4 SW/4 of Section 17, T-1-S, R-37-E, as outlined in "Red" on the attached C-102's. to be allocated to the Percy Hardy Well No. 2 (Unit O), and Well No. 3 (Unit N) located in Section 17, the allowable from which to be produced from any well in any proportion.

The Offset Operators have been furnished with copies of this letter with attachments.

Very truly yours,  
GETTY OIL COMPANY

*C. L. Wade*  
C. L. Wade  
Area Superintendent

HBS/bh  
ATTACHMENTS

OFFSET OPERATORS

PERCY HARDY WELLS NOS. 1, 2, and 3  
Section 17, T-21-S, R-37-E  
Lea County, New Mexico

COPIES:

NEW MEXICO OIL CONSERVATION COMMISSION  
P.O. BOX 1980  
HOBBS, NEW MEXICO 88240

ATLANTIC RICHFIELD OIL COMPANY  
P.O. BOX 1710  
HOBBS, NEW MEXICO 88240

CONTINENTAL OIL COMPANY  
P. O. BOX 460  
HOBBS, NEW MEXICO 88240

PERRY, J. W.  
P.O. BOX 401  
MIDLAND, TEXAS 79701

SUN OIL COMPANY  
P.O. BOX 1861  
MIDLAND, TEXAS 79701

FILE

AMERADA HESS CORPORATION  
DRAWER 817  
SEMINOLE, TEXAS 79360

CAMPBELL AND HENDRICK  
P.O. BOX 401  
MIDLAND, TEXAS 79701

HUNT, N. B.  
29th FLOOR  
1401 ELM  
DALLAS, TEXAS 75202

SOHIO PETROLEUM COMPANY  
P.O. BOX 3167  
MIDLAND, TEXAS 79701

GETTY OIL COMPANY  
P.O. BOX 1231  
MIDLAND, TEXAS 79701



## OIL CONSERVATION COMMISSION

STATE OF NEW MEXICO  
P. O. BOX 1980 - HOBBS

88240

LAND COMMISSIONER

PHIL R. LUCERO

November 14, 1975

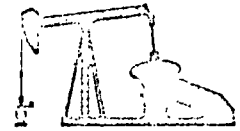

STATE GEOLOGIST  
EMERY C. ARNOLD

DIRECTOR  
JOE D. RAMEY

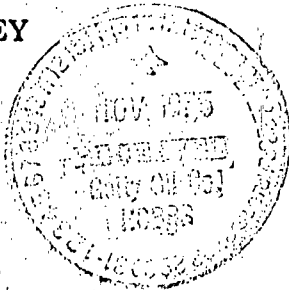

Getty Oil Company  
P. O. Box 249  
Hobbs, New Mexico

Gentlemen:

After review of production data, gas-oil ratio tests, and other pertinent data, your Percy Hardy Well No. 1 located in Unit P of Section 17, T-21-S, R-37-E, will be reclassified as an oil well in the Blinebry Oil & Gas Pool effective January 1, 1976.

If you have evidence to support a request for reconsideration of this reclassification, such request must be made within 10 days following this notification as outlined in Commission Order No. R-1670-N.

Yours very truly,

OIL CONSERVATION COMMISSION

Jerry Sexton  
Supervisor, District 1

mc

<input checked="" type="checkbox"/> CLW <u>41</u>	<input checked="" type="checkbox"/> EJM
<input checked="" type="checkbox"/> WLK <u>12</u>	<input type="checkbox"/> SDS
<input type="checkbox"/> HEW	<input type="checkbox"/> TCW
<input checked="" type="checkbox"/> JCC	<input type="checkbox"/> HBS
<input type="checkbox"/> ECF	<input type="checkbox"/> Circ.
<input type="checkbox"/> WWC	<input type="checkbox"/> Eng
<input type="checkbox"/> CSD	<input type="checkbox"/> File
<input type="checkbox"/> Destroy	

ATTACHMENT II

RANGE 37 EAST

SECTION 7

SECTION 8

SECTION 9

SECTION 18

SECTION 17

SECTION 16

T

21

S

PEERY

SUN

CONT'L.

AMERADA

WEATHERLY

LOCKHART

"DA"

GETTY



SUNRAY

LOCKHART

P. HARDY

STATE

SUNRAY

CAMPBELL AND  
HENDRICK

SINCLAIR. HUNT, ET AL

ELLIOTT

LEE

YORK

MITTIE WEATHERLY

SECTION 19

SECTION 20

SECTION 21

GETTY OIL COMPANY  
PERCY HARDY LEASE  
BLINEBRY POOL  
LEA COUNTY, NEW MEXICO

NEW MEXICO OIL CONSERVATION COMMISSION  
WELL LOCATION AND ACREAGE DEDICATION PLAT

Form C-102  
Supersedes C-128  
Effective 1-1-65

All distances must be from the outer boundaries of the Section.

Operator <b>GETTY OIL COMPANY</b>			Lease <b>PERCY HARDY</b>		Well No. <b>2</b>
Unit Letter <b>O</b>	Section <b>17</b>	Township <b>21-S</b>	Range <b>37-E</b>	County <b>LEA</b>	
Actual Footage Location of Well: <b>660</b> feet from the <b>SOUTH</b> line and <b>1980</b> feet from the <b>EAST</b> line					
Ground Level Elev. <b>3478 GR</b>	Producing Formation <b>BLINEBRY</b>	Pool <b>BLINEBRY</b>		Dedicated Acreage: <b>80</b> Acres	

1. Outline the acreage dedicated to the subject well by colored pencil or hachure marks on the plat below.
2. If more than one lease is dedicated to the well, outline each and identify the ownership thereof (both as to working interest and royalty):
3. If more than one lease of different ownership is dedicated to the well, have the interests of all owners been consolidated by communitization, unitization, force-pooling, etc?

☐ Yes    ☐ No    If answer is "yes," type of consolidation \_\_\_\_\_

If answer is "no," list the owners and tract descriptions which have actually been consolidated. (Use reverse side of this form if necessary.) \_\_\_\_\_

No allowable will be assigned to the well until all interests have been consolidated (by communitization, unitization, forced-pooling, or otherwise) or until a non-standard unit, eliminating such interests, has been approved by the Commission.

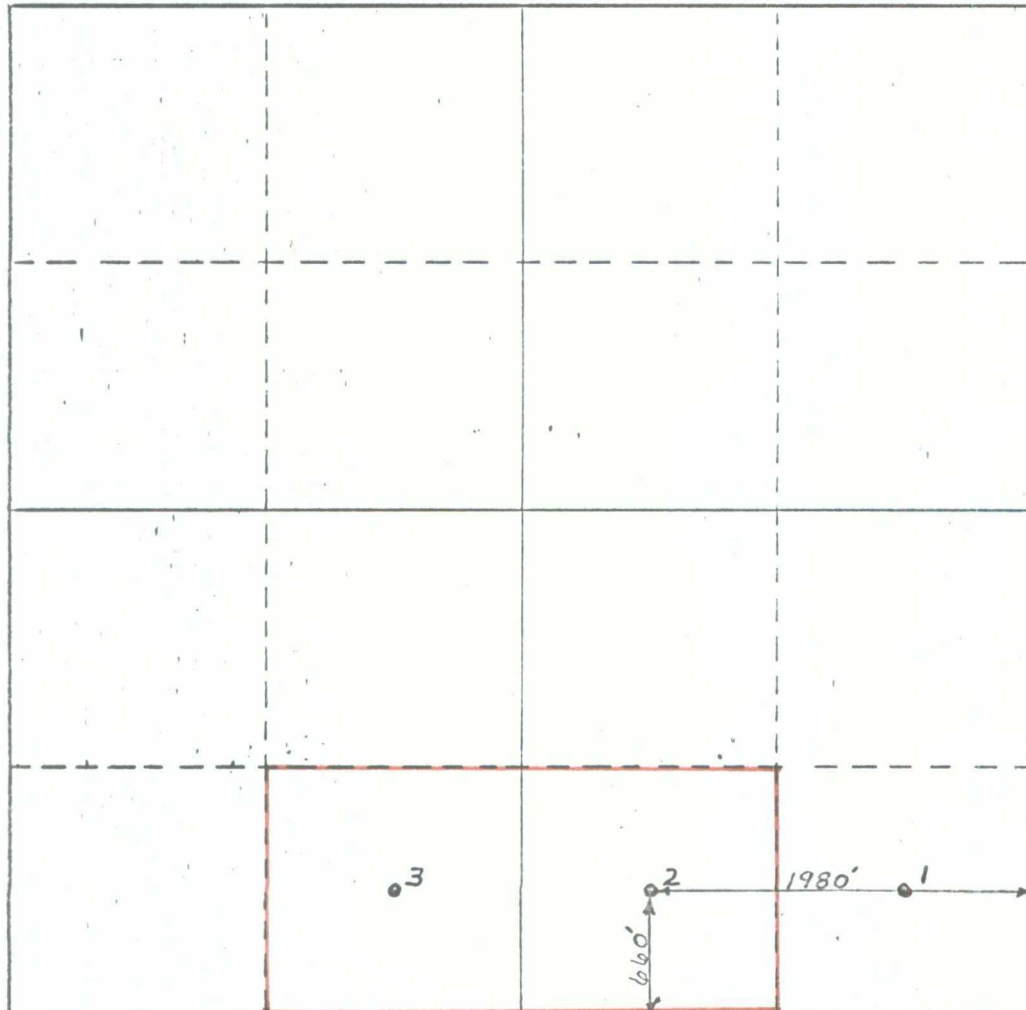

**CERTIFICATION**

*I hereby certify that the information contained herein is true and complete to the best of my knowledge and belief.*

*C. L. Wade*

Name  
**C. L. WADE**

Position  
**AREA SUPERINTENDENT**

Company  
**GETTY OIL COMPANY**

Date  
**NOVEMBER 17, 1975**

*I hereby certify that the well location shown on this plat was plotted from field notes of actual surveys made by me or under my supervision, and that the same is true and correct to the best of my knowledge and belief.*

Date Surveyed:

Registered Professional Engineer and/or Land Surveyor

Certificate No.



NEW MEXICO OIL CONSERVATION COMMISSION  
WELL LOCATION AND ACREAGE DEDICATION PLAT

Form C-102  
Supersedes C-128  
Effective 1-1-65

All distances must be from the outer boundaries of the Section.

Operator <b>GETTY OIL COMPANY</b>			Lease <b>PERCY HARDY</b>		Well No. <b>3</b>
Unit Letter <b>N</b>	Section <b>17</b>	Township <b>21-S</b>	Range <b>37-E</b>	County <b>LEA</b>	
Actual Footage Location of Well: <b>660</b> feet from the <b>SOUTH</b> line and <b>1980</b> feet from the <b>WEST</b> line					
Ground Level Elev. <b>3499 D.F.</b>	Producing Formation <b>BLINEBRY</b>		Pool <b>BLINEBRY</b>		Dedicated Acreage: <b>80</b> Acres

1. Outline the acreage dedicated to the subject well by colored pencil or hachure marks on the plat below.
2. If more than one lease is dedicated to the well, outline each and identify the ownership thereof (both as to working interest and royalty).
3. If more than one lease of different ownership is dedicated to the well, have the interests of all owners been consolidated by communitization, unitization, force-pooling, etc?

☐ Yes ☐ No If answer is "yes," type of consolidation \_\_\_\_\_

If answer is "no," list the owners and tract descriptions which have actually been consolidated. (Use reverse side of this form if necessary.) \_\_\_\_\_

No allowable will be assigned to the well until all interests have been consolidated (by communitization, unitization, forced-pooling, or otherwise) or until a non-standard unit, eliminating such interests, has been approved by the Commission.



**CERTIFICATION**

I hereby certify that the information contained herein is true and complete to the best of my knowledge and belief.

*C.L. Wade*

Name

C.L. Wade:

Position

AREA SUPERINTENDENT

Company

GETTY OIL COMPANY

Date

NOVEMBER 17, 1975

I hereby certify that the well location shown on this plat was plotted from field notes of actual surveys made by me or under my supervision, and that the same is true and correct to the best of my knowledge and belief.

Date Surveyed

Registered Professional Engineer and/or Land Surveyor

Certificate No.

OIL CONSERVATION COMMISSION  
Hobbs DISTRICT

OIL CONSERVATION COMMISSION  
BOX 2088  
SANTA FE, NEW MEXICO

DATE November 21, 1975

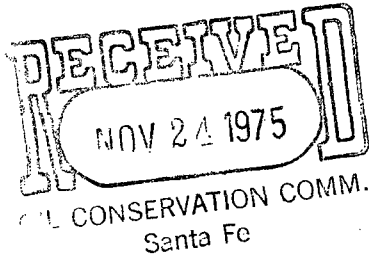

RE: Proposed MC \_\_\_\_\_  
Proposed DHC \_\_\_\_\_  
Proposed NSL \_\_\_\_\_  
Proposed SWD \_\_\_\_\_  
Proposed WFX \_\_\_\_\_  
Proposed PMX \_\_\_\_\_  
NSP X

Gentlemen:

I have examined the application dated \_\_\_\_\_  
for the Getty Oil Co. Percy Hardy #2-0 & 3-N 17-21-37  
Operator Lease and Well No. Unit, S-T-R

and my recommendations are as follows:

O.K.---J.S.

O.K.---J.W.R.

Yours very truly,

Jerry Sexton