

GW-401

**General
Correspondence**

YEAR(S): 2009 - 2014

Lowe, Leonard, EMNRD

From: Pablo, Alberta [Alberta.Pablo@Exterran.com]
Sent: Wednesday, January 12, 2011 1:52 PM
To: Lowe, Leonard, EMNRD
Subject: RE: Integrity Testing Report for GW-401, Exterran HSE Farmington
Attachments: Facility Sump revised.pdf

I have made comments below and a revised facility map is attached. Thank You.

From: Lowe, Leonard, EMNRD [mailto:Leonard.Lowe@state.nm.us]
Sent: Wednesday, January 12, 2011 11:05 AM
To: Pablo, Alberta
Subject: Integrity Testing Report for GW-401, Exterran HSE Farmington

Ms. Alberta Pablo,

Greetings and good morning.

OCD has received your recently conducted Drain line Integrity testing results for the Farmington Exterran GW-401 facility, OCD has a few questions.

1. Exterran's submittal identified the areas for testing: Area #1 (Main shop), Area #2 (Main Shop), Area #3 (Exterior Sump Drain Discharge line) and Area # 4 (Wash bay 1 & 2 and Sump # 3). OCD cannot identify any of these locations on the submitted attached drawing for the Exterran facility. OCD does not want to assume these areas, please submit another drawing or give information on which lines were identified within the drawing.
1. See attached revised facility map.
2. Please annotate the operating pressure for these lines tested, or note if they operate under atmospheric pressure.
2. Atmospheric testing
3. OCD does not understand pressure testing of a sump to 3 lbs/sqr inch., explain.
3. The drain lines we're pressure tested and sump in the shops and below grade tanks were hydrostatic/ atmospheric tested.

OCD has not processed your submitted discharge plan application due to litigation from the oil and gas field. OCD appreciates Exterran's efforts in performing such test. I have attached and EXAMPLE of what your permit will read like. Due to the litigation at this moment, OCD is separating all of its permits for Compressor Stations, Gas plants, Refineries and Service Companies. OCD is still working on this task. In due time we hope to process your application so that we may commence your permit approval. The attachment will read differently for a Service Company, but will have the majority of the same conditions. This is just for information ONLY. NOTE the difference between a SUMP and a Below Grade Tank and monitoring of them.

Thank you again for your efforts. Please

llowe

Leonard Lowe
Environmental Engineer
Oil Conservation Division/EMNRD
1220 S. St. Francis Drive
Santa Fe, N.M. 87505
Office: 505-476-3492

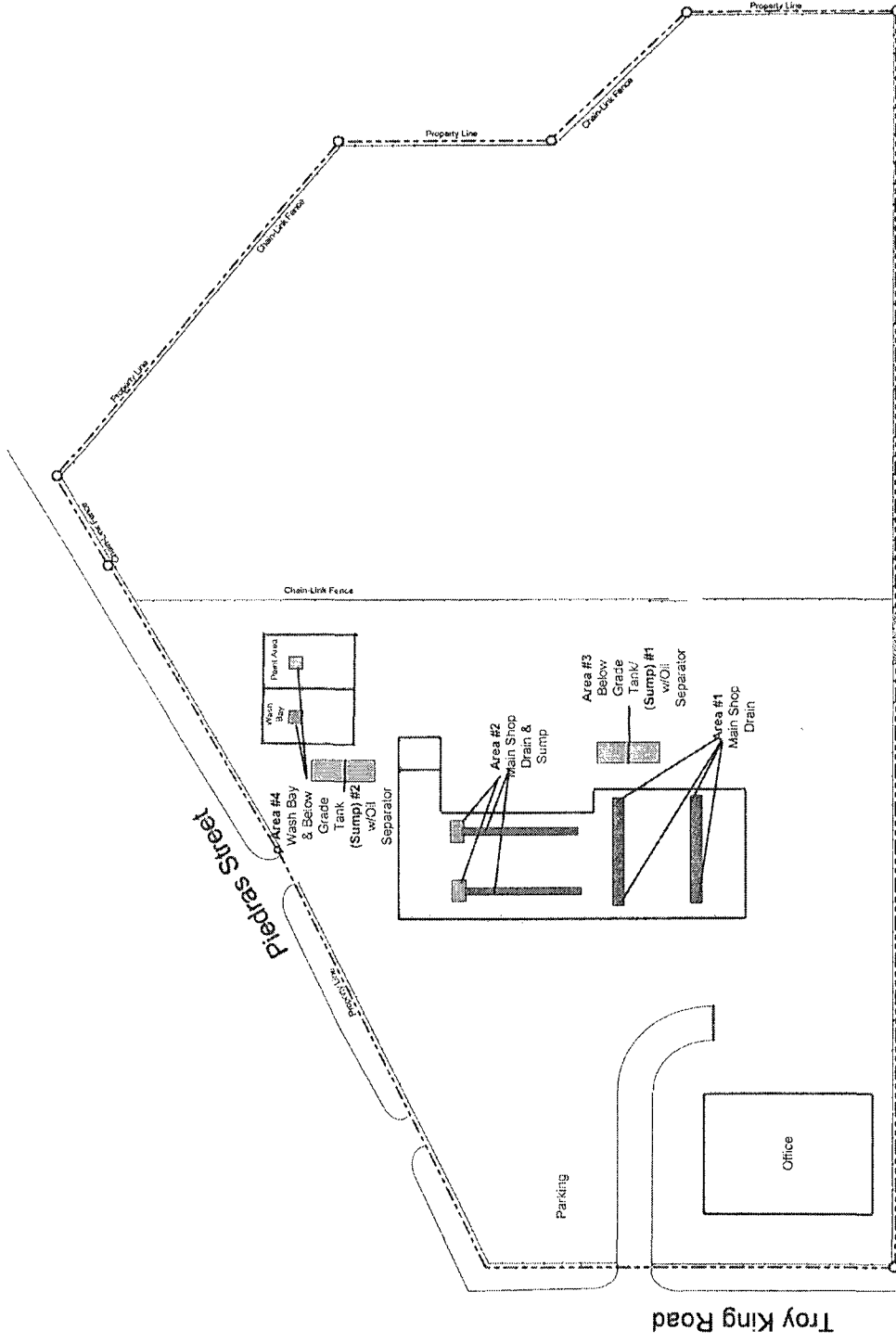

1280 Troy King Road
Farmington, NM 87401

EXTERRAN Farmington

Lowe, Leonard, EMNRD

From: Lowe, Leonard, EMNRD
Sent: Wednesday, January 12, 2011 11:05 AM
To: 'Pablo, Alberta'
Subject: Integrity Testing Report for GW-401, Exterran HSE Farmington
Attachments: 8.OLD EXAMPLE Draft Permit.pdf

Ms. Alberta Pablo,

Greetings and good morning.

OCD has received your recently conducted Drain line Integrity testing results for the Farmington Exterran GW-401 facility, OCD has a few questions.

1. Exterran's submittal identified the areas for testing: Area #1 (Main shop), Area #2 (Main Shop), Area #3 (Exterior Sump Drain Discharge line) and Area # 4 (Wash bay 1 & 2 and Sump # 3). OCD cannot identify any of these locations on the submitted attached drawing for the Exterran facility. OCD does not want to assume these areas, please submit another drawing or give information on which lines were identified within the drawing.
2. Please annotate the operating pressure for these lines tested, or note if they operate under atmospheric pressure.
3. OCD does not understand pressure testing of a sump to 3 lbs/sqr inch., explain.

OCD has not processed your submitted discharge plan application due to litigation from the oil and gas field. OCD appreciates Exterran's efforts in performing such test. I have attached an EXAMPLE of what your permit will read like. Due to the litigation at this moment, OCD is separating all of its permits for Compressor Stations, Gas plants, Refineries and Service Companies. OCD is still working on this task. In due time we hope to process your application so that we may commence your permit approval. The attachment will read differently for a Service Company, but will have the majority of the same conditions. This is just for information ONLY. NOTE the difference between a SUMP and a Below Grade Tank and monitoring of them.

Thank you again for your efforts. Please

llowe

Leonard Lowe

Environmental Engineer
Oil Conservation Division/EMNRD
1220 S. St. Francis Drive
Santa Fe, N.M. 87505
Office: 505-476-3492
Fax: 505-476-3462
E-mail: leonard.lowe@state.nm.us
Website: <http://www.emnrd.state.nm.us/ocd/>



Exterran
1280 Troy King Road
Farmington, New Mexico 87401 U.S.A.

Main 505.325.3220
Fax 505.325.2997
www.etterran.com

January 6, 2011

Mr. Leonard Lowe
Oil Conservation Division
1220 South St. Francis Drive
Santa Fe, New Mexico 87505

Re: Discharge Plan Submittal Request (Designated GW-401)
Integrity Testing report.
Exterran, 1280 Troy King Road, Farmington, N.M. 87401
Section 12, Township 29 North, Range 14 West NMPM

Dear Mr. Lowe:

This letter is being provided with the Integrity testing report completed by Roto Rooter of Farmington, New Mexico. Attached also is a map of all drain lines on the facility along with pictures and video of the testing while it was being completed.

Exterran is committed to environmental compliance and appreciates the OCD's assistance. If you should have any questions, please do not hesitate to contact me at 505-325-3220.

Sincerely,

A handwritten signature in cursive script that reads "Alberto Pablo".

Alberta Pablo
Exterran HSE-Farmington Facility

cc: Mr. Don Johnson - Exterran HSE Specialist Sr. - Farmington
Mr. Bryan Richardson - Exterran West Region HSE Manager
Ms. Nina McAfee - Exterran Sr. Environmental Manager



Roto-Rooter of Farmington
601 S. Behrend Ave.
Farmington, NM 87401
505.325.3395 Phone
505.324.0053 Fax

September 2, 2010

GW-401

Alberta Pablo
Exterran Facility Environmental Coordinator
1280 Troy King Road
Farmington, NM 87401

RECEIVED OCD
2011 JAN 11 P 2:29

Ms. Pablo,

Per proposal # 148, Rotor Rooter of Farmington inspected the integrity of all drain lines which included jetting lines prior to inspection to allow for optimal viewing, hydrostatic testing to three pounds per square inch, and inspection of oil sumps. The following observations were made:

All pipelines are schedule 40 PVC material.
All lines and sumps were tested at 3 pounds per square inch for two hours.
All pumping of sumps was done by others.

Area # 1(Main Shop):

There are four drains located in this area. All four drains were hydro-jetted from the clean outs to the building drains and then to the building sump. A camera was then run through these drains. No leaks, breaks, or any other damage were detected during this process. After performing the hydrostatic testing of this area, it was determined that the lines, drains and sump are in optimal condition without any leaks or damage.

Area # 2 (Main Shop):

There are two drains and two sumps located in this area. Both drains were hydro-jetted from the clean outs to the building drains and then to the two building sumps. A camera was then run through these drains. No leaks, breaks, or any other damage were detected during this process. After performing the hydrostatic testing of this area, it was determined that the lines, drains and sumps are in optimal condition without any leaks or damage.



Roto-Rooter of Farmington
601 S. Behrend Ave.
Farmington, NM 87401
505.325.3395 Phone
505.324.0053 Fax

Area # 3 (Exterior Sump Drain Discharge Line):

There is not an existing drain in this area. The sump in this area is below grade. Therefore, the sump in Area 1 pumps into the sump in Area 3. The line from the sump in Area 1 was hydro-jetted, inspected with camera and pressure tested for two hours. This line is in optimal condition.

Area # 4 (Wash Bay 1 & 2 and Sump # 2):

Both wash bays in this area were hydro-jetted, inspected with the camera and pressure tested for two hours. We did not detect any leaks, breaks or any other damage in this area.

Overall, it has been determined that the areas of concern at the above stated facility are in favorable operating condition and not in need of any repairs.

Michael Kennedy

A handwritten signature in black ink, appearing to read "M. Kennedy", written over the printed name and title.

Field Supervisor
Roto Rooter of Farmington

GW=401

Area # 1 ?
Area # 2 ?
Area # 3 ?
Area # 4 ?

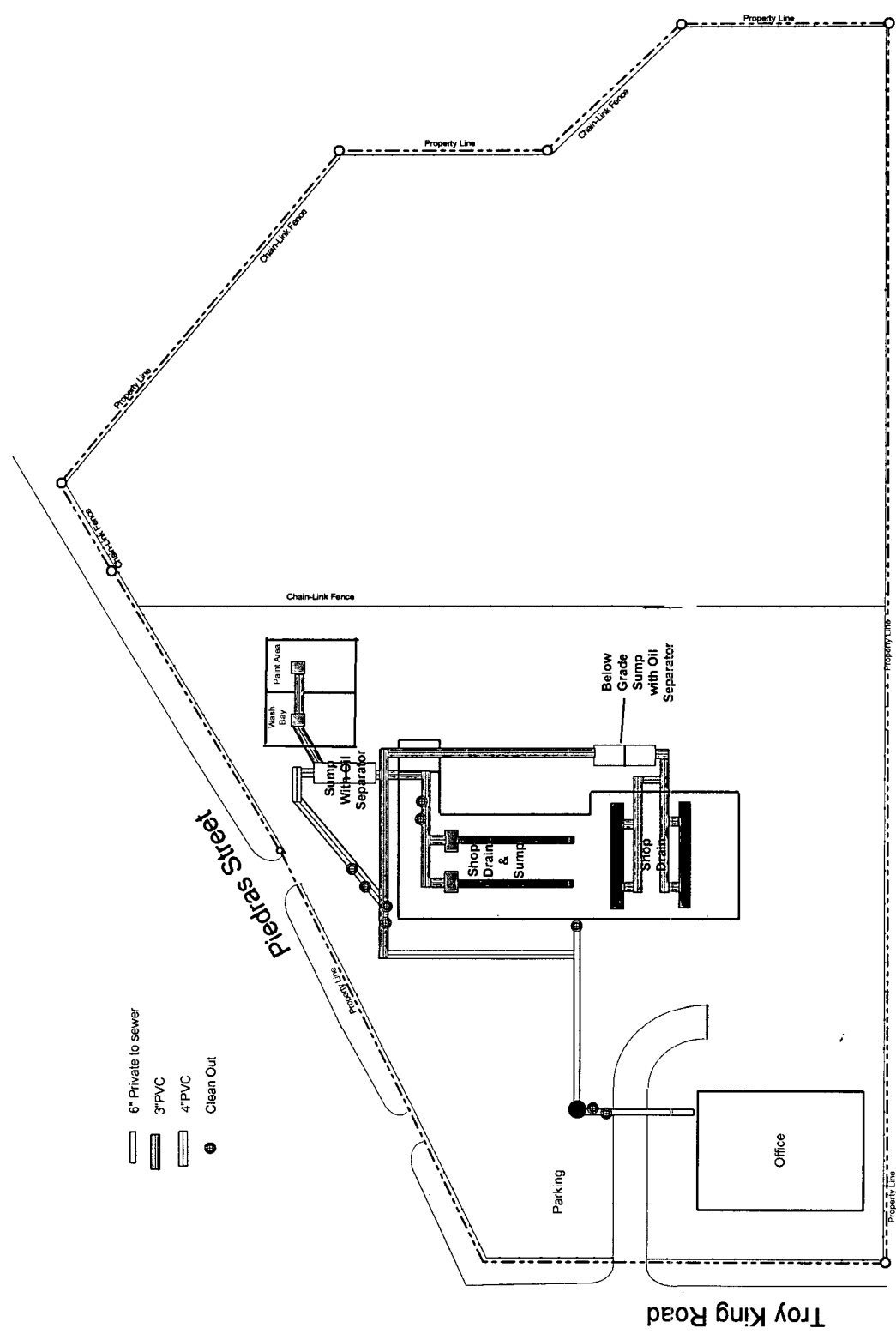

EXTERREN_™ Farmington

1280 Troy King Road
Farmington, NM 87401

EXTERRAN™

Alberta Pablo
Facility Environmental Coordinator

Direct 505.566.5220 ext. 108
Cell 505.215.3839
Fax 505.566.5232
alberta.pablo@exterran.com
www.exterran.com

597-9908

325-2997

Exterr
1280 Troy King Road
Farmington, New Mexico 87401 U.S.A.