

⑤ C-103 7-24-00. (6-29-01) ○

DHC No. Assigned 6-29-01

	Order Number	API Number	Operator	County
	DI0036	30-025-34945	Texaco Exploration + Production Inc.	Lea
	Order Date	Well Name	Number	Location
		State BA	015	C 36 17S 34E UL Sec T (+Dir) R (+Dir)
			Oil %	Gas %
Pool 1	62340	Vacuum Wolfcamp	80%	80%
Pool 2	62320	Vacuum Upper Penn	20%	20%
Pool 3				
Pool 4				
Comments: Work completed effective _____ Work cancelled effective _____ Supplement _____				

9-3392
 Pasted to
 R B D M A

Chevron-Texaco
DOWNHOLE COMMINGLE CALCULATIONS:

30-025-34945
DI-0036

OPERATOR: Texaco Exploration + Production Inc.

PROPERTY NAME: State BA

WNULSTR: 15-C, 36-17-34

	SECTION I:	ALLOWABLE AMOUNT
62340	POOL NO. 1 <u>Vacuum Wolfcamp</u>	<u>355</u> <u>710</u> MCF <u>2000</u>
62320	POOL NO. 2 <u>Vacuum Upper Penn</u>	<u>400</u> <u>800</u> MCF <u>2000</u>
	POOL NO. 3 _____	_____ MCF
	POOL NO. 4 _____	_____ MCF
	POOL TOTALS	<u>755</u> <u>1510</u>

SECTION II:

AVAC65000	POOL NO. 1 <u>Vacuum Wolfcamp</u>	80% X 755 = 604
AVAC54000	POOL NO. 2 <u>Vacuum Upper Penn</u>	20%

POOL NO. 3 _____

POOL NO. 4 _____

OIL

GAS

SECTION III:

355 ÷ 80% = 284

SECTION IV:

284 X 80% = 227.20 (227)
284 X 20% = 56.80 (57)

DISTRICT I

P.O. Box 1980, Hobbs, NM 88240

DISTRICT II

P.O. Box Drawer DD, Artesia, NM 88210

DISTRICT III

1000 Rio Brazos Rd., Aztec, NM 87410

OIL CONSERVATION DIVISION

P.O. Box 2088

Santa Fe, New Mexico 87504-2088

WELL API NO	30-025-34945	
5. Indicate Type of Lease	STATE <input checked="" type="checkbox"/>	FEE <input type="checkbox"/>
6. State Oil / Gas Lease No.		
7. Lease Name or Unit Agreement Name	STATE BA	
8. Well No	15	
9. Pool Name or Wildcat	VACUUM UPPER PENN/VAC WOLFCAMP	

SUNDY NOTICES AND REPORTS ON WELLS
(DO NOT USE THIS FORM FOR PROPOSALS TO DRILL OR TO DEEPEN OR PLUG BACK TO
DIFFERENT RESERVOIR. USE "APPLICATION FOR PERMIT"
(FORM C-101) FOR SUCH PROPOSALS.

1 Type of Well	OIL WELL <input checked="" type="checkbox"/>	GAS WELL <input type="checkbox"/>	OTHER <input type="checkbox"/>
2. Name of Operator	TEXACO EXPLORATION & PRODUCTION INC.		
3 Address of Operator	PO Box 3109, Midland, TX 79702		
4 Well Location	Unit Letter C : 612 Feet From The NORTH Line and 2135 Feet From The WEST Line Section 36 Township 17S Range 34E NMPM LEA COUNTY		
10 Elevation (Show whether DF, RKB, RT, GR, etc)	4000'		

11. Check Appropriate Box to Indicate Nature of Notice, Report, or Other Data

NOTICE OF INTENTION TO:

SUBSEQUENT REPORT OF:

PERFORM REMEDIAL WORK <input type="checkbox"/>	PLUG AND ABANDON <input type="checkbox"/>	REMEDIAL WORK <input type="checkbox"/>	ALTERING CASING <input type="checkbox"/>
TEMPORARILY ABANDON <input type="checkbox"/>	CHANGE PLANS <input type="checkbox"/>	COMMENCE DRILLING OPERATION <input type="checkbox"/>	PLUG AND ABANDONMENT <input type="checkbox"/>
PULL OR ALTER CASING <input type="checkbox"/>		CASING TEST AND CEMENT JOB <input type="checkbox"/>	
OTHER <input type="checkbox"/>	DNHLE COMMINGLING FOR PRE-APPROVED POOLS <input checked="" type="checkbox"/>	OTHER: <input type="checkbox"/>	

12. Describe Proposed or Completed Operations (Clearly state all pertinent details, and give pertinent dates, including estimated date of starting any proposed work) SEE RULE 1103.

TEXACO INTENDS TO DOWNHOLE COMMINGLE THE PRODUCTION FROM THE FOLLOWING POOLS (PRE-APPROVED AS OF APRIL 26, 2000):

{VACUUM UPPER PENN – 62320
AND
VACUUM WOLFCAMP – 62340}

PERFORATIONS ARE AS FOLLOWS: UPPER PENN: 10,092 – 10,194 AND WOLFCAMP: 9,278 – 10,030

EACH ZONE HAS BEEN TESTED SEPARATELY AND THE COMMINGLING OF THESE ZONES WILL NOT REDUCE THE VALUE OF THE TOTAL REMAINING PRODUCTION

DIVISION ORDER #R-11363

SPLITS ARE AS FOLLOWS: WOLFCAMP 80%, UPPER PENN 20%

WOLFCAMP: OIL – 64, MCF – 111, WATER – 134
UPPER PENN: OIL – 16, MCF – 28, WATER – 33

A COPY OF THE DIVISION FORM C-103 HAS BEEN SENT TO THE COMMISSIONER OF PUBLIC LANDS FOR THE STATE OF NEW MEXICO ON 6-26-01.

DI DHC Order No. 0036

I hereby certify that the information above is true and complete to the best of my knowledge and belief

SIGNATURE John Ayers TITLE Admin Supr DATE 6/26/01
TYPE OR PRINT NAME John Ayers Telephone No 915 688-4580

(This space for State Use)

APPROVED Paul Blantz TITLE DATE

DISTRICT I

P.O. Box 1980, Hobbs, NM 88240

DISTRICT II

P.O. Box Drawer DD, Artesia, NM 88210

DISTRICT III

1000 Rio Brazos Rd., Aztec, NM 87410

OIL CONSERVATION DIVISION

P.O. Box 2088

Santa Fe, New Mexico 87504-2088

WELL API NO	30-025-34945
5. Indicate Type of Lease	STATE <input checked="" type="checkbox"/> FEE <input type="checkbox"/>
6 State Oil / Gas Lease No.	
7. Lease Name or Unit Agreement Name	STATE BA
8 Well No.	15
9. Pool Name or Wildcat	VACUUM UPPER PENN/WOLFCAMP
10 Elevation (Show whether DF, RKB, RT,GR, etc.)	4000'

SUNDRY NOTICES AND REPORTS ON WELLS (DO NOT USE THIS FORM FOR PROPOSALS TO DRILL OR TO DEEPEN OR PLUG BACK TO DIFFERENT RESERVOIR. USE "APPLICATION FOR PERMI (FORM C-101) FOR SUCH PROPOSALS.	
1. Type of Well:	OIL WELL <input checked="" type="checkbox"/> GAS WELL <input type="checkbox"/> OTHER <input type="checkbox"/>
2. Name of Operator	TEXACO EXPLORATION & PRODUCTION INC.
3. Address of Operator	205 E. Bender, HOBBS, NM 88240
4 Well Location	Unit Letter <u>C</u> : <u>612</u> Feet From The <u>NORTH</u> Line and <u>2135</u> Feet From The <u>WEST</u> Line Section <u>36</u> Township <u>17S</u> Range <u>34E</u> NMPM <u>LEA</u> COUNTY
10 Elevation (Show whether DF, RKB, RT,GR, etc.) <u>4000'</u>	

11 Check Appropriate Box to Indicate Nature of Notice, Report, or Other Data

NOTICE OF INTENTION TO:

PERFORM REMEDIAL WORK ☐
TEMPORARILY ABANDON ☐
PULL OR ALTER CASING ☐
OTHER: ☐PLUG AND ABANDON ☐
CHANGE PLANS ☐REMEDIAL WORK ☐
COMMENCE DRILLING OPERATION ☐
CASING TEST AND CEMENT JOB ☐
OTHER: ☐

SUBSEQUENT REPORT OF:

ALTERING CASING ☐
PLUG AND ABANDONMENT ☐
COMPLETION REPORT ☒

12. Describe Proposed or Completed Operations (Clearly state all pertinent details, and give pertinent dates, including estimated date of starting any proposed work) SEE RULE 1103.

5-24-00/7-17-00: MIRUSU 5-26-00. NUBOP. PU BIT & DC'S. SPOT REV EQPT & HU LINES. TIH W/2 7/8" TBG TAG @ 6870. DRILL FR 6870-6980. DRILL HARD CMT 6980-7028. DV TOOL @ 7036'. DRILL THRU DV TOOL. FELL THRU @ 7041' TAG TBG @ 10227'. RU REV UNIT. DRILL CMT 10352-52'. DISPL WELLBORE W/2% KCL @ 10350. PERF REPORT: UPPER PENN: 10092-10100, 10122-10136, 10144-10194 (6-01-00) TIH W/TBG & PKR. END OF TBG @ 10217. PKR @ 10123. SPOT 500 GALS 15% HCL ACR PERFS 10092-10194. NDBOPS. TBG @ 10061, PKR @ 9967 SN @ 9928'. RU TO SWAB. 5 RUNS. RECVD 38 BBLS FLUID. MADE 30 SWAB RUNS 6-03-00. 32 BBLS RECVD. 22 SWAB RUNS 6-05-00. RECVD 28 BBLS. 16 SWAB RUNS 6-06-00. RECVD 17 BBLS FLUID. NDTREE. NUBOPS. PU 5 1/2" TBG. RBP SET @ 10070, TIH & DUMP 1 SX SAND ON TOP OF PLUG PBTD @ 10062. PERF LOWER WOLFCAMP 9910-9968, & 10016-10030. PU TBG, PKR, SN. TIH W/TBG TO 9811. ACIDIZED LOWER WOLFCAMP 9910-10030 W/10,000 GALS 15% HCL ACID. RU SWAB. NDTREE. NUBOP. REL PKR @ 9779. TIH W/2 7/8" TBG. TIH W/RBP & TBG. SET BP @ 9883. REL RUNNING TOOL. PERF UPPER WOLFCAMP 9646-9650, 9660-9664, 9700-9714, 9726-9744, 9790-9800, 9846-9852. RUN #2 GUN. TIH W/TBG. RETR TRT PKR, SN. EOT @ 9624. SPOT 500 GALS 15% HCL ACR UPPER WOLFCAMP 9646-9852. DISPL W/2% KCL. SET PKR @ 9459. ACIDIZE UPPER WOLFCAMP W/9500 GALS 15% HCL. NDTREE. NUBOP. REL PKR. TIH & SET RBP @ 9597.80'. DMP 1 SX SAND ON BP @ 9597.80'. RU WL UNIT. PERF UPPER WOLFCAMP 9278-9532. TIH W/TP, PKR, TBG, SN & REMAINING TBG. EOT @ 9218.75'. SPOT 500 GALS 15% HCL ACR PERFS 9278-9532. SET PKR @ 9125. ACIDIZE UPPER WOLFCAMP SECTION 1 9278-9532 W/9500 GALS 15% HCL. NDTREE. NUBOP. TIH W/2 7/8" TO 9597'. COULD NOT RETR RBP. TIH W/TBG. TIH W/TBG. SET PKR @ 9125. SN @ 9093 TP @ 9218. NDTREE. RU SWAB. 6-27-00. STARTED FLOWING ON 32/64 CHOKE. REL PKR @ 9125. TIH W/TBG TO 9218. PU MA, PERF SUB, SN, & TBG. TIH TO 6552'. PU GAS ANCHOR, PMP & RDS 6-28-00.

ON 24 HR OPT, PUMPED 80 BO, 139 MCF, & 167 BW. 7-16-00
SPLITS ARE AS FOLLOWS: WOLFCAMP 80%, UPPER PENN 20%WOLFCAMP
UPPER PENNOIL - 64,
OIL - 16MCF - 111
MCF - 28WATER - 134
WATER - 33

FINAL REPORT

I hereby certify that the information above is true and complete to the best of my knowledge and belief

SIGNATURE J. Denise Leake TITLE Engineering AssistantDATE 7/24/00TYPE OR PRINT NAME J. Denise LeakeTelephone No. 397-0405

(This space for State Use)

APPROVED [Signature]CONDITIONS OF APPROVAL IF ANY: TITLE DATE

DISTRICT I

P.O. Box 1980, Hobbs, NM 88240

DISTRICT II

P.O. Box Drawer DD, Artesia, NM 88210

DISTRICT III

1000 Rio Brazos Rd., Aztec, NM 87410

OIL CONSERVATION DIVISION

P.O. Box 2088

Santa Fe, New Mexico 87504-2088

WELL API NO	30-025-34945
5 Indicate Type of Lease	STATE <input checked="" type="checkbox"/> FEE <input type="checkbox"/>
6 State Oil / Gas Lease No.	

<p align="center">SUNDRY NOTICES AND REPORTS ON WELLS (DO NOT USE THIS FORM FOR PROPOSALS TO DRILL OR TO DEEPEN OR PLUG BACK TO DIFFERENT RESERVOIR. USE "APPLICATION FOR PERMIT" (FORM C-101) FOR SUCH PROPOSALS.)</p>		<p>7 Lease Name or Unit Agreement Name STATE BA</p>	
1 Type of Well.	OIL WELL <input checked="" type="checkbox"/> GAS WELL <input type="checkbox"/> OTHER HORIZONTAL	8 Well No	15
2 Name of Operator	TEXACO EXPLORATION & PRODUCTION INC.	9 Pool Name or Wildcat	NORTH VACUUM ABO
3 Address of Operator	PO BOX 3109, MIDLAND, TX 79702		
4 Well Location	<p>Unit Letter <u>C</u> : <u>612</u> Feet From The <u>NORTH</u> Line and <u>2135</u> Feet From The <u>WEST</u> Line</p> <p>Section <u>36</u> Township <u>17S</u> Range <u>34E</u> NMPM <u>LEA</u> COUNTY</p>		
10. Elevation (Show whether DF, RKB, RT, GR, etc)		4000'	

11. Check Appropriate Box to Indicate Nature of Notice, Report, or Other Data

NOTICE OF INTENTION TO:		SUBSEQUENT REPORT OF:	
PERFORM REMEDIAL WORK <input type="checkbox"/>	PLUG AND ABANDON <input type="checkbox"/>	REMEDIAL WORK <input type="checkbox"/>	ALTERING CASING <input type="checkbox"/>
TEMPORARILY ABANDON <input type="checkbox"/>	CHANGE PLANS <input type="checkbox"/>	COMMENCE DRILLING OPERATION <input type="checkbox"/>	PLUG AND ABANDONMENT <input type="checkbox"/>
PULL OR ALTER CASING <input type="checkbox"/>		CASING TEST AND CEMENT JOB <input type="checkbox"/>	
OTHER: <input type="checkbox"/>		OTHER: <input type="checkbox"/>	HORIZONTAL COMPLETION <input checked="" type="checkbox"/>

12. Describe Proposed or Completed Operations (Clearly state all pertinent details, and give pertinent dates, including estimated date of starting any proposed work) SEE RULE 1103.

8-23-01: MIRUSU. NUBOP. REL TAC. TIH /CSG SCRAPER & BIT TO 9002. 8-25-01: TIH W/CIBP & SET. TOP OF PLUG @ 9098. TIH W/TBG. TEST PLUG TO 1000 PSI. 8-28-01: MIRU KEY #118 RIG. 8-29-01: TIH W/MILLS ON 2 7/8" DP. TAG CIBP. MADE 2.22 CORRECTION. TIH W/WHIPSTOCK. TIH W/GYRO. 8-30-01: MILL 9086-9095,9117,9151,9296,9310,9320,9428,9487,9530,9573,9604,9636,9683,9690,9720,9730,9763,9081,9837,9875,9914,9983,10060,10100,10154,10162,10230,10281,10295,10376,10381,10439,10454,10485,10500,10515,10592. TD @ MIDNIGHT 9-04-01. 9-05-01: TIH W/RBP & SET @ 9000. RIG RELEASED @ 0200 HRS 9-05-01. 9-07-01: MIRU KEY #291. TIH W/3 1/2" FRAC TBG. PU 288 JTS -8911'. 9-08-01: REL RBP. TAG CIBP @ 9098'. SET PKR. NU FRAC TREE. 9-11-01: ACIDIZE FORMATION W/60,000 GALS 20% HCL. REL PKR. 9-13-01: TIH W/MUD JOINT, PERF SUB, SN, 2 7/8" TBG, TA. 9-14-01: PU TBG OFF RACKS. 285 JTS TBG @ 8970, TAC @ 8983. SN @ 9053. PERF SUB @ 4.10'. TIH W/PMP & RDS. 9-18-01: TIE IN & HU ELECTRICAL UNIT TO PUMP UNIT. 9-21-01: NEW OIL TODAY. 87 BO, 134 BW, 104 MCF.

9-25-01: ON 24 HR OPT. PUMPING 87 BO, 86 BLW, & 100 MCF. FLUID LEVEL IS 5972' ABOVE PUMP.

TOP OF WINDOW: 9086 BOTTOM OF WINDOW: 9092'. SN @ 9052. CIBP @ 9098'

FINAL REPORT

WILL DHC ALL 3 ZONES UPON APPROVAL FROM THE OCD.

I hereby certify that the information above is true and complete to the best of my knowledge and belief

SIGNATURE <u>J. Denise Leake</u>	TITLE <u>Engineering Assistant</u>	DATE <u>10/5/01</u>
TYPE OR PRINT NAME <u>J. Denise Leake</u>	ORIGINAL SIGNED BY <u>PAUL F. KAUTZ</u>	Telephone No <u>915-688-4752</u>
(This space for State Use)		
APPROVED <u>BY</u>	TITLE <u>PETROLEUM ENGINEER</u>	DATE <u>JUL 18 2002</u>
CONDITIONS OF APPROVAL, IF ANY: _____		

1A Vacuum Hammer & ...



NEW MEXICO ENERGY, MINERALS
& NATURAL RESOURCES DEPARTMENT

OIL CONSERVATION DIVISION
DISTRICT I HOBBS
1625 French Dr, Hobbs, NM 88240
(505) 393-6161
FAX (505) 393-0720

November 26, 2001

Texaco Expl & Prod Inc
ATT: Denise Leake
P O Box 3109
Midland, TX 79702

RE: Property/Well State BA #15-C, 36-17s-34e API #30-025-34945

The enclosed forms are being returned to your company due to lack of sufficient or correct data required to properly process the forms. ALL DATA CIRCLED IN RED should be supplied or amended. Revised forms should be resubmitted ATTACHED TO THIS FORM to the address above with fifteen (15) days.

- C-101 ☐ ☐ Plugging bond is not in place for OGRID reflected on form. Contact Dorothy Phillips in OCD Santa Fe office: (505) 827-7137
- ☐ OGRID number does not exist for Operator as designated
- ☐ Proposed Bottom Hole location omitted
- ☐ Ground Level Elevation omitted
- ☐ Proposed casing record incomplete or unacceptable
- ☐ BOP schematic not included or attached
- ☐ Other: _____
- _____
- _____
- C-102 ☐ ☐ Form is not properly signed and dated
- ☐ Directional Drill: Project area, producing interval, kickoff point, surface location, and bottom hole location should be designated
- ☐ Acreage to be dedicated to well should be outlined
- ☐ Non-standard location. Approved order from Santa Fe not on file
- ☐ Non-standard proration. Approved order from Santa Fe not on file
- ☐ Other: _____
- _____
- C-103 xx ☐ API number omitted
- ☐ Proper well identification omitted
- ☐ Location data incorrect or insufficient
- ☐ Date(s) work performed omitted
- ☐ Tubing size and depth and/or packer setting omitted
- xx Other: Returning this form. Information needs to go on Form C-107. DHC (3) zones has to be approved in Santa Fe.

OIL CONSERVATION DIVISION

COPIES
APPROPRIATE
OFFICE

DISTRICT I
P.O. Box 1980, Hobbs, NM 88240

DISTRICT II
P.O. Box Drawer DD, Artesia, NM 88210

DISTRICT III
1000 Rio Brazos Rd., Aztec, NM 87410

P.O. Box 2088
Santa Fe, New Mexico 87504-2088

WELL API NO.	30-025-34945
5. Indicate Type of Lease	STATE <input checked="" type="checkbox"/> FEE <input type="checkbox"/>
6. State Oil / Gas Lease No.	
7. Lease Name or Unit Agreement Name	STATE BA
8. Well No	15
9. Pool Name or Wildcat	N VAC ABO/VAC WOLFCAMP/VAC UP PENN
10. Elevation (Show whether DF, RKB, RT, GR, etc.)	4000'

SUNDRY NOTICES AND REPORTS ON WELLS
(DO NOT USE THIS FORM FOR PROPOSALS TO DRILL OR TO DEEPEN OR PLUG BACK TO
DIFFERENT RESERVOIR. USE "APPLICATION FOR PERMITS
(FORM C-101) FOR SUCH PROPOSALS.

1. Type of Well. OIL WELL ☒ GAS WELL ☐ OTHER ☐

2. Name of Operator
TEXACO EXPLORATION & PRODUCTION INC.

3. Address of Operator
PO BOX 3109, MIDLAND, TX 79702

4. Well Location
Unit Letter C : 612 Feet From The NORTH Line and 2135 Feet From The WEST Line
Section 36 Township 17S Range 34E NMPM LEA COUNTY

10. Elevation (Show whether DF, RKB, RT, GR, etc.) 4000'

11. Check Appropriate Box to Indicate Nature of Notice, Report, or Other Data

NOTICE OF INTENTION TO:

PERFORM REMEDIAL WORK ☐ PLUG AND ABANDON ☐
TEMPORARILY ABANDON ☐ CHANGE PLANS ☐
PULL OR ALTER CASING ☐
OTHER: DHC ☒

SUBSEQUENT REPORT OF:

REMEDIAL WORK ☐ ALTERING CASING ☐
COMMENCE DRILLING OPERATION ☐ PLUG AND ABANDONMENT ☐
CASING TEST AND CEMENT JOB ☐
OTHER: ☐

12. Describe Proposed or Completed Operations (Clearly state all pertinent details, and give pertinent dates, including estimated date of starting any proposed work) SEE RULE 1103.

TEXACO EXPLORATION & PRODUCTION INC. RESPECTFULLY REQUESTS APPROVAL TO DOWNHOLE COMMINGLE THE NORTH VACUUM ABO, VACUUM WOLFCAMP AND THE VACUUM UPPER PENN WITHIN THE SUBJECT WELLBORE. THE PLUG BETWEEN THE INTERVALS WILL BE CLEANED OUT UPON APPROVAL OF THE DHC.

THE ROYALTY IS COMMON IN ALL ZONES. THE PROPOSED DOWNHOLE COMMINGLING WILL PROVIDE A MORE ECONOMICAL MEANS OF PRODUCTION. THIS WILL EXTEND THE PRODUCTIVE LIFE OF ALL THREE COMPLETIONS THEREBY PREVENTING WASTE.

THE SUBJECT WELL MEETS ALL OF THE REQUIREMENTS AS SET FORTH BY RULE 303 (C). IT SHOULD BE NOTED THAT IT IS COMMON PRACTICE TO COMMINGLE THESE POOLS WITH NO FLUID COMPATIBILITY PROBLEMS. THIS DOWNHOLE COMMINGLING IS PRE-APPROVED BY DIVISION ORDER R-11363.

ALLOCATION OF PRODUCTION FOR EACH ZONE WILL BE BASED ON THE WELL TESTS OBTAINED FROM THE POOLS BEFORE DHC. THE TESTS SHOWED THE FOLLOWING:

NORTH VACUUM ABO - POOL CODE - 61760 87 OIL, 86 BW, & 100 MCF PERFS: 9086-9092 70% OIL, 37% MCF
VACUUM WOLFCAMP - POOL CODE - 62340 64 OIL, 134 BW, & 111 MCF PERFS: 9278-10,030 23% OIL, 50% MCF
VACUUM UPPER PENN - POOL CODE - 62320 16 OIL, 33 BW, & 28 MCF PERFS: 10,092-10,194 7% OIL, 13% MCF

A COPY WILL BE SENT TO THE COMMISSIONER OF PUBLIC LANDS OF NEW MEXICO.

(NOTE. COMMINGLING FOR THE WOLFCAMP & UPPER PENN WAS APPROVED PREVIOUSLY BY DHC ORDER # 0036) ADDING THE ABO.

I hereby certify that the information above is true and complete to the best of my knowledge and belief

SIGNATURE J. Denise Leake TITLE Engineering Assistant

DATE 10/3/01

TYPE OR PRINT NAME J. Denise Leake

Telephone No. 915-688-4752







(This space for State Use)

APPROVED

CONDITIONS OF APPROVAL IF ANY _____ TITLE _____ DATE _____

HOB-0036

30-025-34945

				Preview/Print Permit																										
Basic Application and Log-In Data																														
Application No		Application Type		Order No		Amd #		R-Order No		County		Lea		Approvals																
11363		Downhole Commingling		36		0		11363		04/26/2000		Reviewer		Kautz																
Applicant		TEXACO EXPLORATION & PRODUCTION INC		06/26/2001		06/26/2003		District		Hobbs		BLM?		<input type="checkbox"/>																
Contact		JOHN AYERS		IssuingOff		Hobbs		SLO?		<input type="checkbox"/>																				
Notes				Addl CC																										
Permit Level Actions and/or Data																														
<table border="1"><thead><tr><th>PoolNo</th><th>GasPrct</th><th>OilPrct</th><th>Notes</th><th>Pool Rules</th></tr></thead><tbody><tr><td>VACUUM;UPPER PENN</td><td>20.00%</td><td>20.00%</td><td>SINGLE IN VACUUM ABO, NORTH EFF. 09-21-2001</td><td></td></tr><tr><td>VACUUM,WOLFCAMP</td><td>80.00%</td><td>80.00%</td><td>THE DHC WAS NEVER SET UP ON THIS WELL</td><td></td></tr></tbody></table>																PoolNo	GasPrct	OilPrct	Notes	Pool Rules	VACUUM;UPPER PENN	20.00%	20.00%	SINGLE IN VACUUM ABO, NORTH EFF. 09-21-2001		VACUUM,WOLFCAMP	80.00%	80.00%	THE DHC WAS NEVER SET UP ON THIS WELL	
PoolNo	GasPrct	OilPrct	Notes	Pool Rules																										
VACUUM;UPPER PENN	20.00%	20.00%	SINGLE IN VACUUM ABO, NORTH EFF. 09-21-2001																											
VACUUM,WOLFCAMP	80.00%	80.00%	THE DHC WAS NEVER SET UP ON THIS WELL																											
Well Specific and Technical Data																														

DISTRICT I

P O Box 1980, Hobbs, NM 88240

DISTRICT II

P O Box Drawer DD, Artesia, NM 88210

DISTRICT III

1000 Rio Brazos Rd, Aztec, NM 87410

OIL CONSERVATION DIVISION

P.O. Box 2088
Santa Fe, New Mexico 87504-2088

WELL API NO

30-025-34945

5 Indicate Type of Lease

STATE ☒ FEE

6 State Oil / Gas Lease No

7 Lease Name or Unit Agreement Name

STATE BA

8 Well No

15

9 Pool Name or Wildcat

VACUUM UPPER PENN/VAC WOLFCAMP

SUNDRY NOTICES AND REPORTS ON WELLS
(DO NOT USE THIS FORM FOR PROPOSALS TO DRILL OR TO DEEPEN OR PLUG BACK TO
DIFFERENT RESERVOIR. USE "APPLICATION FOR PERMIT
(FORM C-101) FOR SUCH PROPOSALS

1 Type of Well

OIL
WELL ☒

GAS
WELL

OTHER

2 Name of Operator

TEXACO EXPLORATION & PRODUCTION INC

3 Address of Operator

PO Box 3109, Midland, TX 79702

4 Well Location

Unit Letter C 612 Feet From The NORTH Line and 2135 Feet From The WEST Line

Section 36

Township 17S

Range 34E

NMPM

LEA COUNTY

10 Elevation (Show whether DF, RKB RT GR, etc)

4000'

Check Appropriate Box to Indicate Nature of Notice, Report, or Other Data

NOTICE OF INTENTION TO:

SUBSEQUENT REPORT OF:

PERFORM REMEDIAL WORK

PLUG AND ABANDON

REMEDIAL WORK

ALTERING CASING

TEMPORARILY ABANDON

CHANGE PLANS

COMMENCE DRILLING OPERATION

PLUG AND ABANDONMENT

PULL OR ALTER CASING

CASING TEST AND CEMENT JOB

OTHER

DNHLE COMMINGLING FOR PRE-APPROVED POOLS

OTHER ☒

12 Describe Proposed or Completed Operations (Clearly state all pertinent details, and give pertinent dates, including estimated date of starting any proposed work) SEE RULE 1103

TEXACO INTENDS TO DOWNHOLE COMMINGLE THE PRODUCTION FROM THE FOLLOWING POOLS (PRE-APPROVED AS OF APRIL 25 2000)

{VACUUM UPPER PENN - 62320

AND

VACUUM WOLFCAMP - 62340}

PERFORATIONS ARE AS FOLLOWS. UPPER PENN: 10,092 - 10,194 AND WOLFCAMP: 9,278 - 10,030

EACH ZONE HAS BEEN TESTED SEPARATELY AND THE COMMINGLING OF THESE ZONES WILL NOT REDUCE THE VALUE OF THE TOTAL REMAINING PRODUCTION

DIVISION ORDER #R-11363

SPLITS ARE AS FOLLOWS WOLFCAMP 80%, UPPER PENN 20%

WOLFCAMP: OIL - 64, MCF - 111, WATER - 134

UPPER PENN OIL - 16, MCF - 28, WATER - 33

DI DHC Order No. HOB-0036

A COPY OF THE DIVISION FORM C-103 HAS BEEN SENT TO THE COMMISSIONER OF PUBLIC LANDS FOR THE STATE OF NEW MEXICO ON 5-25-01

I hereby certify that the information above is true and complete to the best of my knowledge and belief

SIGNATURE

John Ayers

TITLE Admin Supr

DATE 6/26/01

Telephone No 915 688 45

TYPE OR PRINT NAME

John Ayers

This space for State Use

APPROVED

CONDITIONS OF APPROVAL IF ANY

TITLE

Original
Part

DATE

Division/Minerals 1-2-93 ver 1.0

DISTRICT I

P O Box 1980, Hobbs, NM 88240

DISTRICT II

Box Drawer DD, Artesia, NM 88210

DISTRICT III

1000 Rio Brazos Rd, Aztec, NM 87410

OIL CONSERVATION DIVISION

P.O. Box 2088

Santa Fe, New Mexico 87504-2088

WELL API NO	30-025-34945
5 Indicate Type of Lease	STATE <input checked="" type="checkbox"/> FEE <input type="checkbox"/>
6 State Oil / Gas Lease No	
7 Lease Name or Unit Agreement Name	STATE BA
8 Well No	15
9 Pool Name or Wildcat	VACUUM UPPER PENN/WOLFCAMP

SUNDRY NOTICES AND REPORTS ON WELLS (DO NOT USE THIS FORM FOR PROPOSALS TO DRILL OR TO DEEPEN OR PLUG BACK TO DIFFERENT RESERVOIR. USE "APPLICATION FOR PERMIT (FORM C-101) FOR SUCH PROPOSALS			
1 Type of Well	OIL WELL <input checked="" type="checkbox"/> GAS WELL <input type="checkbox"/> OTHER <input type="checkbox"/>		
2 Name of Operator	TEXACO EXPLORATION & PRODUCTION INC		
3 Address of Operator	205 E. Bender, HOBBS, NM 88240		
4 Well Location			
Unit Letter	C	612 Feet From The NORTH Line and 2135 Feet From The WEST Line	
Section	36	Township 17S Range 34E NMPM	LEA COUNTY
10 Elevation (Show whether DF, RKB, RT, GR etc) 4000'			

11

Check Appropriate Box to Indicate Nature of Notice, Report, or Other Data

NOTICE OF INTENTION TO:

SUBSEQUENT REPORT OF:

PERFORM REMEDIAL WORK

PLUG AND ABANDON

REMEDIAL WORK

ALTERING CASING

TEMPORARILY ABANDON

CHANGE PLANS

COMMENCE DRILLING OPERATION

PLUG AND ABANDONMENT

PULL OR ALTER CASING

CASING TEST AND CEMENT JOB

OTHER

OTHER

COMPLETION REPORT ☒

12 Describe Proposed or Completed Operations (Clearly state all pertinent details, and give pertinent dates, including estimated date of starting any proposed work) SEE RULE 1103

5-24-00/7-17-00 MIRUSU 5-26-00 NUBOP. PU BIT & DC'S. SPOT REV EQPT & HU LINES. TIH W/2 7/8" TBG TAG @ 6870 DRILL FR 6870-6980 DRILL HARD CMT 6980-7028. DV TOOL @ 7036'. DRILL THRU DV TOOL FELL THRU @ 7041'. TAG TBG @ 10227'. RU REV UNIT DRILL CMT 10352-52' DISPL WELLBORE W/2% KCL @ 10350. PERF REPORT. UPPER PENN: 10092-10100, 10122-10136, 10144-10194 (6-01-00) TIH W/TBG & PKR END OF TBG @ 10217. PKR @ 10123. SPOT 500 GALS 15% HCL ACR PERFS 10092-10194 NDBOPS TBG @ 10061, PKR @ 9967 SN @ 9928' RU TO SWAB 5 RUNS. RECVD 38 BBLs FLUID. MADE 30 SWAB RUNS 6-03-00 32 BBLs RECVD. 22 SWAB RUNS 6-05-00. RECVD 28 BBLs 16 SWAB RUNS 6-06-00 RECVD 17 BBLs FLUID. NDTREE NUBOPS. PU 5 1/2" TBG RBP SET @ 10070, TIH & DUMP 1 SX SAND ON TOP OF PLUG. PBD @ 10062. PERF LOWER WOLFCAMP 9910-9968, & 10016-10030. PU TBG, PKR, SN. TIH W/TBG TO 9811. ACIDIZED LOWER WOLFCAMP 9910-10030 W/10,000 GALS 15% HCL ACID RU SWAB NDTREE. NUBOP. REL PKR @ 9779 TIH W/2 7/8" TBG. TIH W/RBP & TBG SET BP @ 9883. REL RUNNING TOOL. PERF UPPER WOLFCAMP 9646-9650, 9660-9664, 9700-9714, 9726-9744, 9790-9800, 9846-9852. RUN #2 GUN TIH W/TBG, RETR TRT PKR, SN EOT @ 9624. SPOT 500 GALS 15% HCL ACR UPPER WOLFCAMP 9646-9852. DISPL W/2% KCL SET PKR @ 9459. ACIDIZE UPPER WOLFCAMP W/9500 GALS 15% HCL NDTREE NUBOP REL PKR. TIH & SET RBP @ 9597 80' DMP 1 SX SAND ON BP @ 9597. 80' RU WL UNIT PERF UPPER WOLFCAMP 9278-9532 TIH W/TP, PKR, TBG, SN & REMAINING TBG EOT @ 9218 75'. SPOT 500 GALS 15% HCL ACR PERFS 9278-9532 SET PKR @ 9125. ACIDIZE UPPER WOLFCAMP SECTION 1 9278-9532 W/9500 GALS 15% HCL. NDTREE. NUBOP TIH W/2 7/8" TO 9597' COULD NOT RETR RBP TIH W/TBG TIH W/TBG SET PKR @ 9125 SN @ 9093 TP @ 9218 NDBOP NUTREE RU SWAB. 6-27-00 STARTED FLOWING ON 32/64 CHOKE. REL PKR @ 9125 TIH W/TBG TO 9218 PU MA, PERF SUB, SN, & TBG TIH TO 6552' PU GAS ANCHOR, PMP & RDS 6-28-00

ON 24 HR OPT, PUMPED 80 BO, 139 MCF, & 167 BW 7-16-00
SPLITS ARE AS FOLLOWS WOLFCAMP 80%, UPPER PENN 20%

WOLFCAMP	OIL - 64,	MCF - 111	WATER - 134
UPPER PENN	OIL - 16	MCF - 28	WATER - 33

DI DHC Order No. HOB-0036
FINAL REPORT

I hereby certify that the information above is true and complete to the best of my knowledge and belief

SIGNATURE J Denise Leake TITLE Engineering Assistant

DATE 7/24/00

TYPE OR PRINT NAME J Denise Leake

Telephone No 397-0405

(This space for State Use)

APPROVED

CONDITIONS OF APPROVAL, IF ANY

TITLE

DATE

DISTRICT I

P O Box 1980, Hobbs, NM 88241-1980

DISTRICT II

P O Box Drawer DD, Artesia, NM 88211-0719

DISTRICT III

1000 Rio Brazos Rd., Aztec, NM 87410

DISTRICT IV

P O Box 2088, Santa Fe, NM 87504-2088

State of New Mexico

Energy, Minerals and Natural Resources Department

Form C-102

Revised February 10, 199

Instructions on back

Submit to Appropriate District Office

State Lease - 4 Copie

Fee Lease - 3 Copie

✓ AMENDED REPORT

OIL CONSERVATION DIVISION

P O Box 2088

Santa Fe, New Mexico 87504-2088

WELL LOCATION AND ACREAGE DEDICATION PLAT

1 API Number 30-025-34945	2 Pool Code 62340	3 Pool Name VACUUM WOLFCAMP
4 Property Code 11096	5 Property Name STATE BA	6 Well No 15
7 OGRID Number 022351	8 Operator Name TEXACO EXPLORATION & PRODUCTION INC	9 Elevation 4000'

10 Surface Location

UI or lot no	Section	Township	Range	Lot Idn	Feet From The	North/South Line	Feet From The	East/West Line	County
C	36	17S	34E		612	NORTH	2135	WEST	LEA

11 Bottom Hole Location If Different From Surface

UI or lot no	Section	Township	Range	Lot Idn	Feet From The	North/South Line	Feet From The	East/West Line	County
G	36	17S	34E		1799'	NORTH	2225	EAST	LEA

12 Dedicated Acre 180' 80'	13 Joint or Infill No	14 Consolidation Code	15 Order No
-------------------------------	--------------------------	-----------------------	-------------

NO ALLOWABLE WILL BE ASSIGNED TO THIS COMPLETION UNTIL ALL INTERESTS HAVE BEEN CONSOLIDATED
OR A NON-STANDARD UNIT HAS BEEN APPROVED BY THE DIVISION

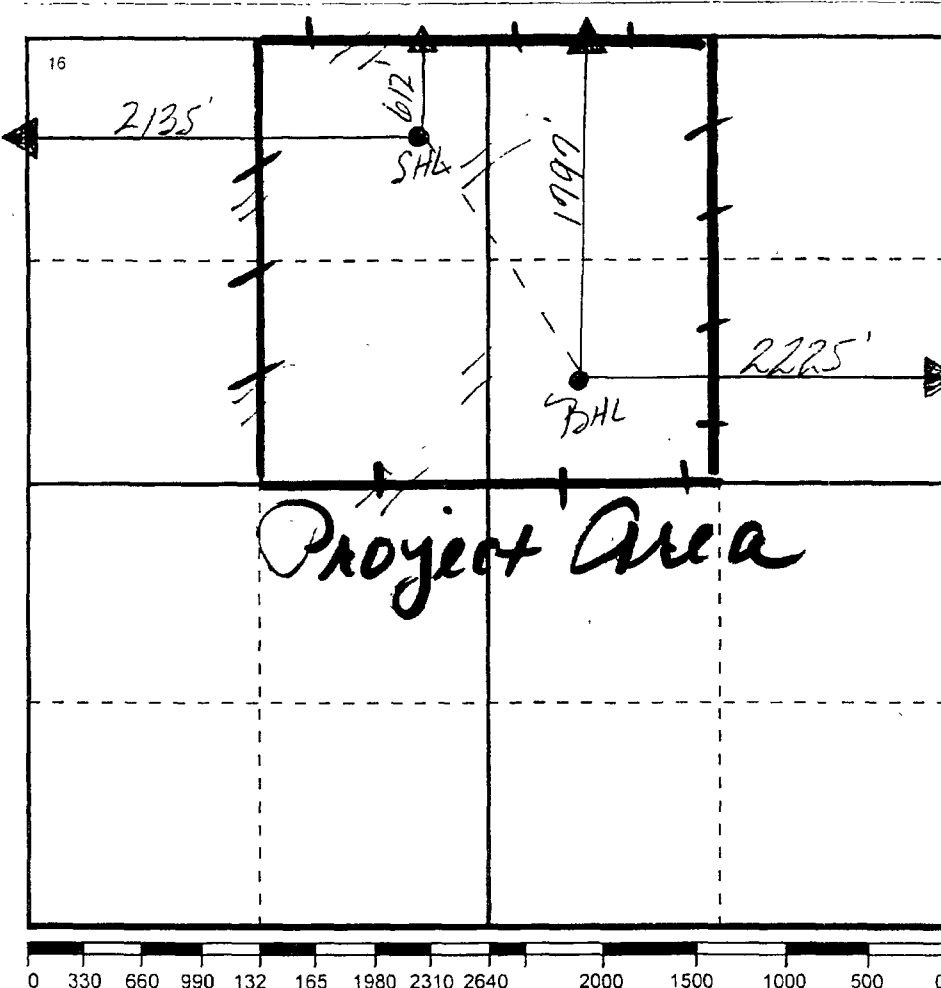

17 OPERATOR CERTIFICATION

I hereby certify that the information
contained herein is true and complete to the
best of my knowledge and belief

Signature

Printed Name

J. Denise Leake

Positio

Engineering Assistant

Date

10/30/01

18 SURVEYOR CERTIFICATION

I hereby certify that the well location shown
on this plat was plotted from field notes of
actual surveys made by me or under my
supervision and that the same is true and
correct to the best of my knowledge and
belief

Date Surveyed

Signature & Seal of

Professional Surveyor

Certificate No

DISTRICT I

P O Box 1980, Hobbs, NM 88241-1980

DISTRICT II

P O Box Drawer DD, Artesia, NM 88211-0719

DISTRICT III

1000 Rio Brazos Rd, Aztec, NM 87410

DISTRICT IV

P O Box 2088, Santa Fe, NM 87504-2088

State of New Mexico

Energy, Minerals and Natural Resources Department

Form C-10.2

Revised February 10, 1999

Instructions on back

Submit to Appropriate District Office

State Lease - 4 Copies

Fee Lease - 3 Copies

✓ AMENDED REPORT

OIL CONSERVATION DIVISION

P O. Box 2088

Santa Fe, New Mexico 87504-2088

WELL LOCATION AND ACREAGE DEDICATION PLAT

1 API Number 30-025-34945	2 Pool Code 62320	3 Pool Name VACUUM UPPER PENN
4 Property Code 11096	5 Property Name STATE BA	6 Well No 15
7 OGRID Number 022351	8 Operator Name TEXACO EXPLORATION & PRODUCTION INC	9 Elevation 4000'

10 Surface Location

Ul or lot no	Section	Township	Range	Lot Idn	Feet From The	North/South Line	Feet From The	East/West Line	County
C	36	17S	34E		612	NORTH	2135	WEST	LEA

11 Bottom Hole Location If Different From Surface

Ul or lot no	Section	Township	Range	Lot Idn	Feet From The	North/South Line	Feet From The	East/West Line	County
G	36	17S	34E		1799'	NORTH	2225	EAST	LEA

12 Dedicated Acre 80	13 Joint or Infill No	14 Consolidation Code	15 Order No.
-------------------------	--------------------------	-----------------------	--------------

NO ALLOWABLE WILL BE ASSIGNED TO THIS COMPLETION UNTIL ALL INTERESTS HAVE BEEN CONSOLIDATED
OR A NON-STANDARD UNIT HAS BEEN APPROVED BY THE DIVISION

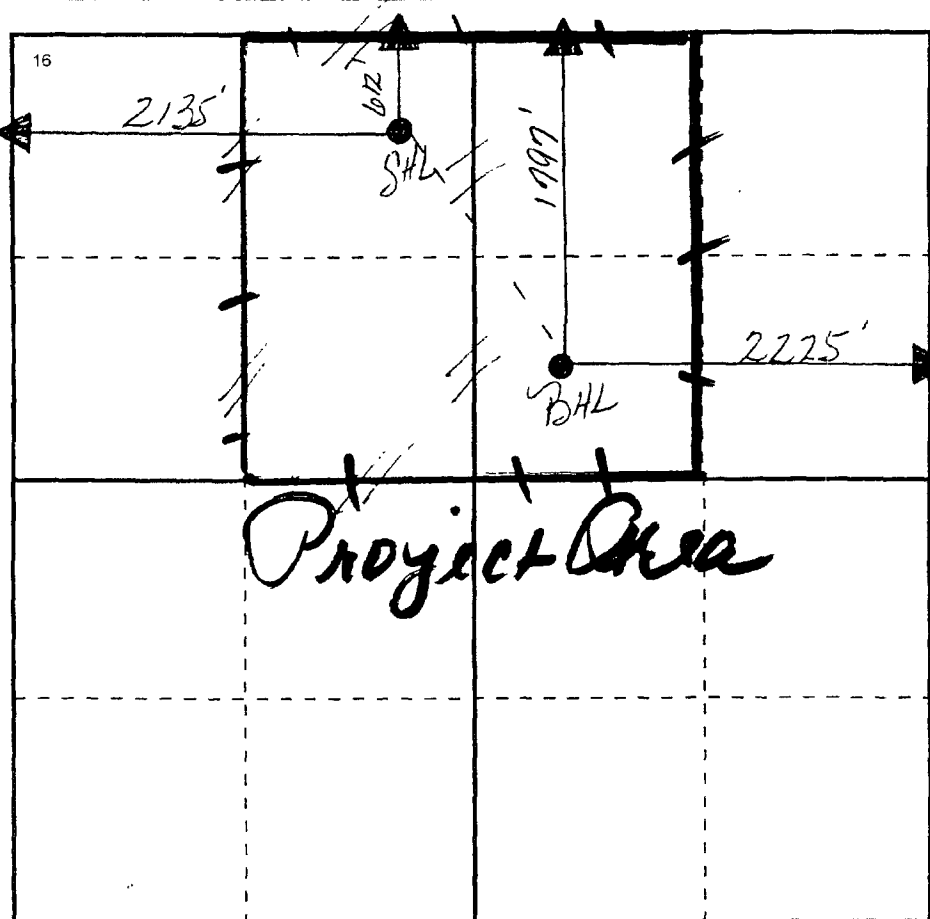

17 OPERATOR CERTIFICATION

I hereby certify that the information
contained herein is true and complete to the
best of my knowledge and belief

Signature

J. Denise Leake

Printed Name

J. Denise Leake

Position

Engineering Assistant

Date

10/30/01

18 SURVEYOR CERTIFICATION

I hereby certify that the well location shown
on this plat was plotted from field notes of
actual surveys made by me or under my
supervision, and that the same is true and
correct to the best of my knowledge and
belief.

Date Surveyed

Signature & Seal of

Professional Surveyor

Certificate No

DISTRICT I
P O Box 1980, Hobbs, NM 88241-1980
DISTRICT II
P O Box Drawer DD Artesia, NM 88211-0719
DISTRICT III
1000 Rio Brazos Rd, Aztec, NM 87410
DISTRICT IV
P O Box 2088, Santa Fe NM 87504-2088

State of New Mexico
Energy, Minerals and Natural Resources Department
OIL CONSERVATION DIVISION
P O Box 2088
Santa Fe, New Mexico 87504-2088

Form C-104
Revised February 10, 199
Instructions on back
Submit to Appropriate District Office
5 Copies
AMENDED REPORT

REQUEST FOR ALLOWABLE AND AUTHORIZATION TO TRANSPORT

¹ Operator Name and Address TEXACO EXPLORATION & PRODUCTION INC PO BOX 3109, MIDLAND, TX 79702		² OGRID Number 022351
⁴ API Number 30-025-34945		⁵ Pool Name NORTH VACUUM ABO
⁷ Property Code 11096	⁸ Property Name STATE BA	⁶ Pool Code 61760
		⁹ Well No 15

¹⁰ Surface Location									
UI or lot no	Section	Township	Range	Lot Idn	Feet From The	North/South Line	Feet From The	East/West Line	County
C	36	17S	34E		612	NORTH	2135	WEST	LEA

¹¹ Bottom Hole Location EXACT									
UI or lot no	Section	Township	Range	Lot Idn	Feet From The	North/South Line	Feet From The	East/West Line	County
G	36	17S	34E		1747	NORTH	2225-3055	EAST W	LEA
¹² Lse Code S	¹³ Producing Method Code P	¹⁴ Gas Connection Date 7/10/00		¹⁵ C-129 Permit Number	¹⁶ C-129 Effective Date	¹⁷ C-129 Expiration Date			

^{III} Oil and Gas Transporters				
¹⁸ Transporter OGRID	¹⁹ Transporter Name and Address	²⁰ POD	²¹ O/G	²² POD ULSTR Location and Description
037480	EOTT	2828963	O	C-36-17S-34E LEA COUNTY, NM
024650	DYNEGY	2828964	G	C-36-17S-34E LEA COUNTY, NM METER #83-830050

^{IV} Produced Water	
²³ POD 2828965	²⁴ POD ULSTR Location and Description C-36-17S-34E, LEA COUNTY, NM

^V Well Completion Data				
²⁵ Spud Date 8/23/01	²⁶ Ready Date 9/11/01	²⁷ Total Depth 10592'	²⁸ PBTD	²⁹ Perforations 9086-9092' ABO
³⁰ HOLE SIZE	³¹ CASING & TUBING SIZE	³² DEPTH SET	³³ SACKS CEMENT	
14 3/4"	11 3/4"	1514'	830 SX	
11"	8 5/8"	3725'	1330 SX	
7 7/8"	5 1/2"	10500	1715 SX	

^{VI} Well Test Data					
³⁴ Date New Oil 9/21/01	³⁵ Gas Delivery Date 9-21-01	³⁶ Date of Test 9-25-01	³⁷ Length of Test 24 HRS	³⁸ Tubing Pressure	³⁹ Casing Pressure
⁴⁰ Choke Size	⁴¹ Oil - Bbls 87	⁴² Water - Bbls 86	⁴³ Gas - MCF 100	⁴⁴ AOF	⁴⁵ Test Method P
⁴⁶ I hereby certify that the rules and regulations of the Oil Conservation Division have been complied with and that the information given above is true and complete to the best of my knowledge and belief.			OIL CONSERVATION DIVISION		
Signature <i>J. Denise Leake</i>			Approved By ORIGINAL SIGNED BY PAUL F. KAUTZ		
Printed Name J. Denise Leake			Title PETROLEUM ENGINEER		
Title Engineering Assistant			Approval Date JUL 13 2002		
Date 10/5/01			Telephone 915-688-4752		

⁴⁷ If this is a change of operator fill in the OGRID number and name of the previous operator			
Previous Operator Signature	Printed Name	Title	Date

DISTRICT I
P O Box 1980, Hobbs NM 88241-1980
DISTRICT II
P O Box Drawer DD, Artesia, NM 88211-0719
DISTRICT III
1000 Rio Brazos Rd Aztec, NM 87410
DISTRICT IV
P O Box 2088, Santa Fe, NM 87504 2088

State of New Mexico
Energy, Minerals and Natural Resources Department

OIL CONSERVATION DIVISION

P O Box 2088
Santa Fe, New Mexico 87504 2088

Form C-104
Revised February 10, 1994

Instructions on back
Submit to Appropriate District Office
5 Copies

AMENDED REPORT

REQUEST FOR ALLOWABLE AND AUTHORIZATION TO TRANSPORT

¹ Operator Name and Address TEXACO EXPLORATION & PRODUCTION INC 205 E Bender, HOBBS, NM 88240		² OGRID Number 022351
⁴ API Number 30-025-34945		³ Reason for Filing Code NW
⁷ Property Code 11096	⁵ Pool Name VACUUM WOLF CAMP	⁶ Pool Code 62340
	⁸ Property Name STATE BA	⁹ Well No 15

¹⁰ Surface Location									
Ul or lot no	Section	Township	Range	Lot Idn	Feet From The	North/South Line	Feet From The	East/West Line	County
C	36	17S	34E		612	NORTH	2135	WEST	LEA

¹¹ Bottom Hole Location									
Ul or lot no	Section	Township	Range	Lot Idn	Feet From The	North/South Line	Feet From The	East/West Line	County
¹² Lse Code S	¹³ Producing Method Code P	¹⁴ Gas Connection Date 7/10/00	¹⁵ C-129 Permit Number	¹⁶ C-129 Effective Date	¹⁷ C-129 Expiration Date				

¹⁸ Transporter OGRID 037480				¹⁹ Transporter Name and Address EOTT		²⁰ POD 2828963		²¹ O/G O		²² POD ULSTR Location and Description C-36-17S-34E LEA COUNTY, NM	
024650				DYNEGY		2828964		G		C-36-17S-34E LEA COUNTY, NM METER #83-830050	

²³ POD 2828965		²⁴ POD ULSTR Location and Description C-36-17S-34E, LEA COUNTY, NM	
------------------------------	--	--	--

²⁵ Spud Date 4/21/00		²⁶ Ready Date 6/20/00		²⁷ Total Depth 10,500		²⁸ PBD 10 070		²⁹ Perforations 9278-10030 WOLF CAMP	
³⁰ HOLE SIZE 14 3/4 11" 7 7/8"		³¹ CASING & TUBING SIZE 11 3/4" 8 5/8" 5 1/2"		³² DEPTH SFT 1509' 3725' 10498'		³³ SACKS CEMENT 830 SX 1930 SX 1315 SX			

³⁴ Date New Oil 7/7/00		³⁵ Gas Delivery Date 7-10-00		³⁶ Date of Test 7-16-00		³⁷ Length of Test 24 HRS		³⁸ Tubing Pressure		³⁹ Casing Pressure	
⁴⁰ Choke Size 80/64		⁴¹ Oil - Bbls 80/64		⁴² Water - Bbls 167/134		⁴³ Gas - MCF 139/111		⁴⁴ AOF		⁴⁵ Test Method P	

⁴⁶ I hereby certify that the rules and regulations of the Oil Conservation Division have been complied with and that the information given above is true and complete to the best of my knowledge and belief				OIL CONSERVATION DIVISION			
Signature <i>J Denise Leake</i>				Approved By			
Printed Name J Denise Leake				Title			
Title Engineering Assistant				Approval Date			
Date 7/24/00				Telephone 397-0405			

⁴⁷ If this is a change of operator fill in the OGRID number and name of the previous operator							
Previous Operator Signature		Printed Name		Title		Date	

DISTRICT I
P O Box 1980, Hobbs NM 88241-1980
DISTRICT II
P O Box Drawer DD, Artesia, NM 88211-0719
DISTRICT III
1000 Rio Brazos Rd Aztec, NM 87410
DISTRICT IV
P O Box 2088, Santa Fe, NM 87504-2088

State of New Mexico
Energy, Minerals and Natural Resources Department
OIL CONSERVATION DIVISION
P O Box 2088
Santa Fe, New Mexico 87504-2088

Form C-104
Revised February 10, 1994
Instructions on back
Submit to Appropriate District Office
5 Copies
AMENDED REPORT

REQUEST FOR ALLOWABLE AND AUTHORIZATION TO TRANSPORT

¹ Operator Name and Address TEXACO EXPLORATION & PRODUCTION INC 205 E Bender, HOBBS, NM 88240		² OGRID Number 022351
⁴ API Number 30-025-34945		³ Reason for Filing Code NW
⁷ Property Code 11096	⁵ Pool Name VACUUM UPPER PENN	⁶ Pool Code 62320
	⁸ Property Name STATE BA	⁹ Well No 15

¹⁰ Surface Location									
Ul or lot no	Section	Township	Range	Lot Idn	Feet From The	North/South Line	Feet From The	East/West Line	County
C	36	17S	34E		612	NORTH	2135	WEST	LEA

¹¹ Bottom Hole Location									
Ul or lot no	Section	Township	Range	Lot Idn	Feet From The	North/South Line	Feet From The	East/West Line	County
¹² Lse Code S	¹³ Producing Method Code P	¹⁴ Gas Connection Date 7/10/00		¹⁵ C-129 Permit Number	¹⁶ C-129 Effective Date	¹⁷ C-129 Expiration Date			

¹¹ Oil and Gas Transporters				
¹⁸ Transporter OGRID 037480	¹⁹ Transporter Name and Address EDTT	²⁰ POD 2828963	²¹ O/G O	²² POD ULSTR Location and Description C-36-17S-34E LEA COUNTY, NM
024650	DYNEGY	2828964	G	C-36-17S-34E LEA COUNTY, NM METER #83-830050

¹³ Produced Water	
²³ POD 2828965	²⁴ POD ULSTR Location and Description C-36-17S-34E, LEA COUNTY, NM

¹⁴ Well Completion Data				
²⁵ Spud Date 4/21/00	²⁶ Ready Date 6/20/00	²⁷ Total Depth 10,500	²⁸ PHTD 10.070	²⁹ Perforations 10092-10194 PENN
³⁰ HOLE SIZE 14 3/4	³¹ CASING & TUBING SIZE 11 3/4	³² DEPTH SET 1509'	³³ SACKS CEMENT 830 SX	
			1930 SX	
			13 1/2 SX	

¹⁵ Well Test Data					
³⁴ Date New Oil 1/7/00	³⁵ Gas Delivery Date 7-10-00	³⁶ Date of Test 7-16-00	³⁷ Length of Test 24 HRS	³⁸ Tubing Pressure	³⁹ Casing Pressure
⁴⁰ Choke Size	⁴¹ Oil - Bbls 80/16	⁴² Water - Bbls 167/33	⁴³ Gas - MCF 139/28	⁴⁴ AOF	⁴⁵ Test Method P

⁴⁶ I hereby certify that the rules and regulations of the Oil Conservation Division have been complied with and that the information given above is true and complete to the best of my knowledge and belief	OIL CONSERVATION DIVISION
Signature <i>J Denise Leake</i>	Approved By
Printed Name J Denise Leake	Title
Title Engineering Assistant	Approval Date JUL 2000
Date 7/24/00	Telephone 397-0405

⁴⁷ If this is a change of operator fill in the OGRID number and name of the previous operator			
Previous Operator Signature	Printed Name	Title	Date