

PNRM0621551645

C-103 Received 7-31-2006

DHC No. Assigned 8-2-2006

Order Number	API Number	Operator	County	
HOB-0157	30-025-34642	Capataz Operating Inc.	Lea	
Order Date	Well Name	Number	Location	
	Kool	001	B UL	14 Sec
			205 T (+Dir)	38E R (+Dir)
		Oil %	Gas %	
Pool 1	06660	BLinebry Oil + Gas (Oil)	30%	87%
Pool 2	78760	House Tubb	10%	5%
Pool 3	33250	House Drinkard	60%	8%
Pool 4				
Comments: Work completed effective _____ Work cancelled effective _____ Supplement _____				

Posted to
RBDYM &
8-3-2006

C

30-025-34642

HOB-0157

DOWNHOLE COMMINGLE CALCULATIONS:OPERATOR: Capataz Operating Inc.PROPERTY NAME: KoolWNULSTR: 1-B, 14-20-38

06660 SECTION I:
 POOL NO. 1 Blinebry Oil+Gas (Oil) ALLOWABLE AMOUNT
 107 428 MCF 4000

78760 POOL NO. 2 House Tubb 142 284 MCF 2000

33250 POOL NO. 3 House Drinkard 142 284 MCF 2000

POOL NO. 4 _____ MCF

POOL TOTALS 391 996

SECTION II:
 POOL NO. 1 Blinebry Oil+Gas (Oil) Oil Gas
 30% 87%

POOL NO. 2 House Tubb 10% 5%

POOL NO. 3 House Drinkard 60% $391 \times 60\% = 234.60$ 8%

POOL NO. 4 _____

OILGASSECTION III:
 $107 \div 60\% = 178.33 (179)$ SECTION IV:
 $179 \times 30\% = 53.70 (54)$
 $179 \times 10\% = 17.90 (18)$
 $179 \times 60\% = 107.40 (107)$

Submit 3 Copies to Appropriate District Office
District I
1625 N. French Dr., Hobbs, NM 88240
District II
1301 W. Grand Ave., Artesia, NM 88210
District III
1000 Rio Brazos Rd., Aztec, NM 87410
District IV
S. St. Francis Dr., Santa Fe, NM 87505

State of New Mexico
Energy, Minerals and Natural Resources

OIL CONSERVATION DIVISION
1220 South St. Francis Dr.
Santa Fe, NM 87505

Form C-103
May 27, 2004

SUNDRY NOTICES AND REPORTS ON WELLS (DO NOT USE THIS FORM FOR PROPOSALS TO DRILL OR TO DEEPEN OR PLUG BACK TO A DIFFERENT RESERVOIR. USE "APPLICATION FOR PERMIT" (FORM C-101) FOR SUCH PROPOSALS.)		WELL API NO. 30-025-34642
1. Type of Well: Oil Well <input checked="" type="checkbox"/> Gas Well <input type="checkbox"/> Other <input type="checkbox"/>		5. Indicate Type of Lease STATE <input type="checkbox"/> FEE <input checked="" type="checkbox"/>
2. Name of Operator Capataz Operating, Inc		6. State Oil & Gas Lease No. N/A
3. Address of Operator PO Box 10549 Midland, TX 79702		7. Lease Name or Unit Agreement Name Kool
4. Well Location Unit Letter B : 660 feet from the North line and 1650 feet from the East line Section 14 Township 20S Range 38E NMPM County Lea		8. Well Number 1
11. Elevation (Show whether DR, RKB, RT, GR, etc.) 3572 GR		9. OGRID Number 3659
Pit or Below-grade Tank Application <input type="checkbox"/> or Closure <input type="checkbox"/>		
Pit type _____ Depth to Groundwater _____ Distance from nearest fresh water well _____ Distance from nearest surface water _____		
Pit Liner Thickness: _____ mil Below-Grade Tank: Volume _____ bbls; Construction Material _____		

12. Check Appropriate Box to Indicate Nature of Notice, Report or Other Data

NOTICE OF INTENTION TO:

PERFORM REMEDIAL WORK ☐ PLUG AND ABANDON ☐
TEMPORARILY ABANDON ☐ CHANGE PLANS ☐
PULL OR ALTER CASING ☐ MULTIPLE COMPL ☐

SUBSEQUENT REPORT OF:

REMEDIAL WORK ☐ ALTERING CASING ☐
COMMENCE DRILLING OPNS. ☐ P AND A ☐
CASING/CEMENT JOB ☐

OTHER: ☐ OTHER: DHC: Blinebry, Tubb, Drinkard ☒

13. Describe proposed or completed operations. (Clearly state all pertinent details, and give pertinent dates, including estimated date of starting any proposed work). SEE RULE 1103. For Multiple Completions: Attach wellbore diagram of proposed completion or recompletion. *Per R. 11363*

Pool Names: Blinebry Oil & Gas (6660), House; Tubb (78760), House; Drinkard (33250)

Perforations:

Blinebry 5970-76, 84-92, 6020-48, 6080-6100' 1 JSPF
Tubb 6740-46, 48-49, 54, 60-61, 72, 76-77' 1 JSPF
Drinkard 6983-89, 92-97, 7000-12, 7018-22, 7028-31, 7033-37' 1 JSPF

The allocation method will be as follows:

	Oil	%	Water	%	Gas	%
Blinebry	3	30	8	29	52	87
Tubb	1	10	2	7	3	5
Drinkard	6	60	18	64	5	8
	10	100	28	100	60	100

Downhole commingling will not reduce the value of the pools.

Ownership is the same for each of these pools.

DHC Order No. H08-0157

I hereby certify that the information above is true and complete to the best of my knowledge and belief. I further certify that any pit or below-grade tank has been/will be constructed or closed according to NMOC guidelines ☐, a general permit ☐ or an (attached) alternative OCD-approved plan ☐.

SIGNATURE [Signature] TITLE Agent DATE 07/26/2006

or print name H Scott Davis
For State Use Only

E-mail address: Capataz1@sbcglobal.net Telephone No. (432)620-8820

APPROVED BY: [Signature] TITLE PETROLEUM ENGINEER DATE AUG 02 2006
Conditions of Approval (if any):

DISTRICT I
P. O. Box 1980
Hobbs, NM 88241-1980

DISTRICT II
P. O. Drawer DD
Artesia, NM 88211-0719

DISTRICT III
1000 Rio Brazos Rd.
Aztec, NM 87410

DISTRICT IV
P. O. Box 2088
Santa Fe, NM 87507-2088

State of New Mexico
Energy, Minerals, and Natural Resources Department

Form C-102
Revised 02-10-94

Instructions on back

Submit to the Appropriate
District Office
State Lease - 4 copies
Fee Lease - 3 copies

OIL CONSERVATION DIVISION

P. O. Box 2088
Santa Fe, New Mexico 87504-2088

☐ AMENDED REPORT

WELL LOCATION AND ACREAGE DEDICATION PLAT

1 API Number 30-025-34642		2 Pool Code 06660		3 Pool Name Blinebry Oil & Gas					
4 Property Code 24693		5 Property Name KOOL						6 Well Number 1	
7 OGRID No. 3659		8 Operator Name CAPATAZ OPERATING, INC.						9 Elevation 3572'	
10 SURFACE LOCATION									
UL or lot no. B	Section 14	Township 20 SOUTH	Range 38 EAST, N.M.P.M.	Lot Ida	Feet from the 660'	North/South line NORTH	Feet from the 1650'	East/West line EAST	County LEA
11 BOTTOM HOLE LOCATION IF DIFFERENT FROM SURFACE									
UL or lot no.	Section	Township	Range	Lot Ida	Feet from the	North/South line	Feet from the	East/West line	County
12 Dedicated Acres		13 Joint or Infill		14 Consolidation Code		15 Order No.			

NO ALLOWABLE WELL BE ASSIGNED TO THIS COMPLETION UNTIL ALL INTERESTS HAVE BEEN CONSOLIDATED OR A NON-STANDARD UNIT HAS BEEN APPROVED BY THE DIVISION

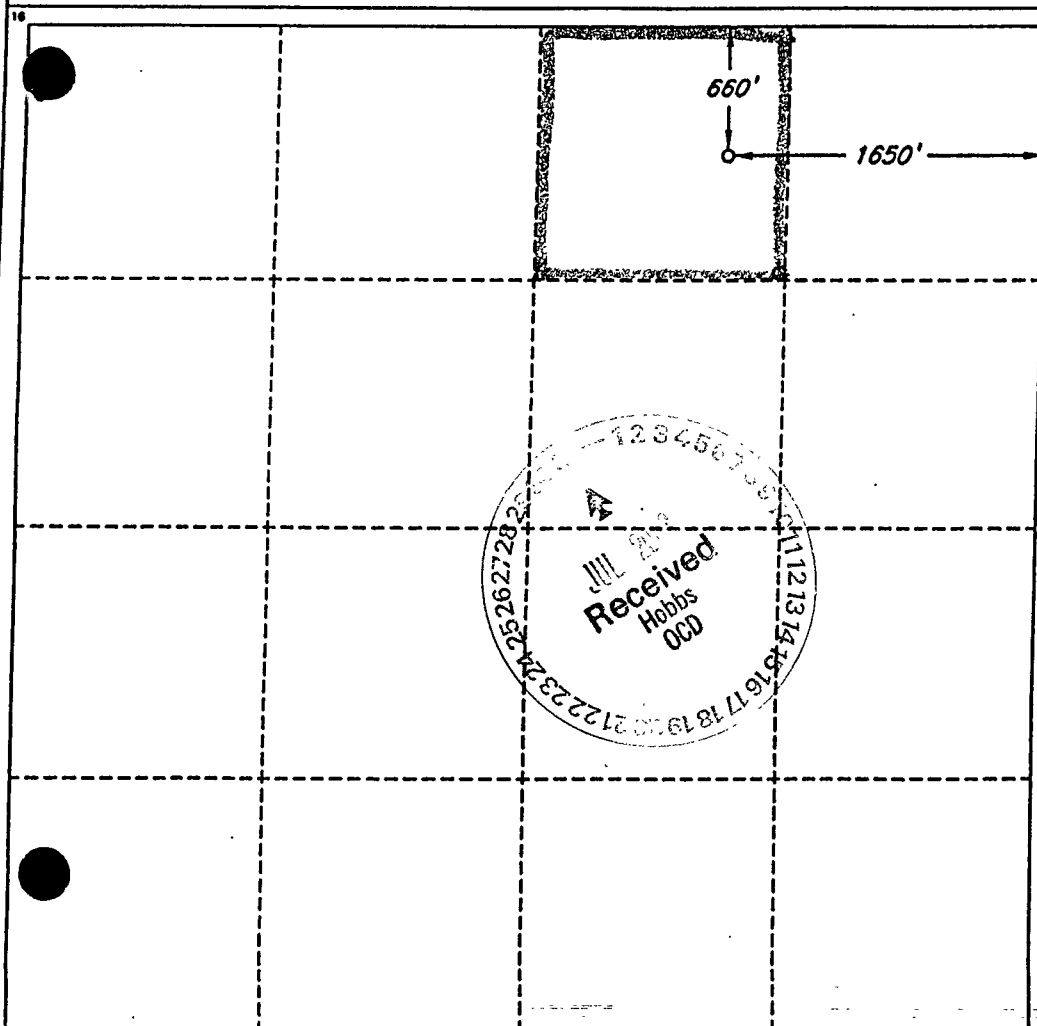

OPERATOR CERTIFICATION

I hereby certify that the information contained herein is true and complete to the best of my knowledge and belief.

Signature

Printed Name

H. SCOTT DAVIS

Title

AGENT

Date

5/28/99

SURVEYOR CERTIFICATION

I hereby certify that the well location shown on this plat was plotted from field notes of actual surveys made by me or under my supervision, and that the same is true and correct to the best of my belief.

Date of Survey

MAY 26, 1999

Signature and Seal of
Professional Surveyor

ROGER M. ROBBINS
NEW MEXICO
REGISTERED SURVEYOR
12128
ROGER M. ROBBINS
JOB #63718 V.H.B.

DISTRICT I
P. O. Box 1980
Hobbs, NM 88241-1980

State of New Mexico
Energy, Minerals, and Natural Resources Department

Form C-102
Revised 02-10-94

Instructions on back

DISTRICT II
P. O. Drawer DD
Alamosa, NM 88211-0719

OIL CONSERVATION DIVISION

P. O. Box 2088
Santa Fe, New Mexico 87504-2088

Submit to the Appropriate
District Office
State Lease - 4 copies
Fee Lease - 3 copies

☐ AMENDED REPORT

DISTRICT III
1000 Rio Brazos Rd.
Aztec, NM 87410

DISTRICT IV
P. O. Box 2088
Santa Fe, NM 87507-2088

WELL LOCATION AND ACREAGE DEDICATION PLAT

1 API Number 30-025-34642		2 Pool Code 78760		3 Pool Name House Tubb					
4 Property Code 24693		5 Property Name KOOL						6 Well Number 1	
7 OGRID No. 3659		8 Operator Name CAPATAZ OPERATING, INC.						9 Elevation 3572'	
10 SURFACE LOCATION									
UL or lot no. B	Section 14	Township 20 SOUTH	Range 38 EAST, N.M.P.M.	Lot Ida	Feet from the 660'	North/South line NORTH	Feet from the 1650'	East/West line EAST	County LEA
11 BOTTOM HOLE LOCATION IF DIFFERENT FROM SURFACE									
UL or lot no.	Section	Township	Range	Lot Ida	Feet from the	North/South line	Feet from the	East/West line	County
12 Dedicated Acres		13 Joint or Infill		14 Consolidation Code		15 Order No.			

NO ALLOWABLE WELL BE ASSIGNED TO THIS COMPLETION UNTIL ALL INTERESTS HAVE BEEN
CONSOLIDATED OR A NON-STANDARD UNIT HAS BEEN APPROVED BY THE DIVISION

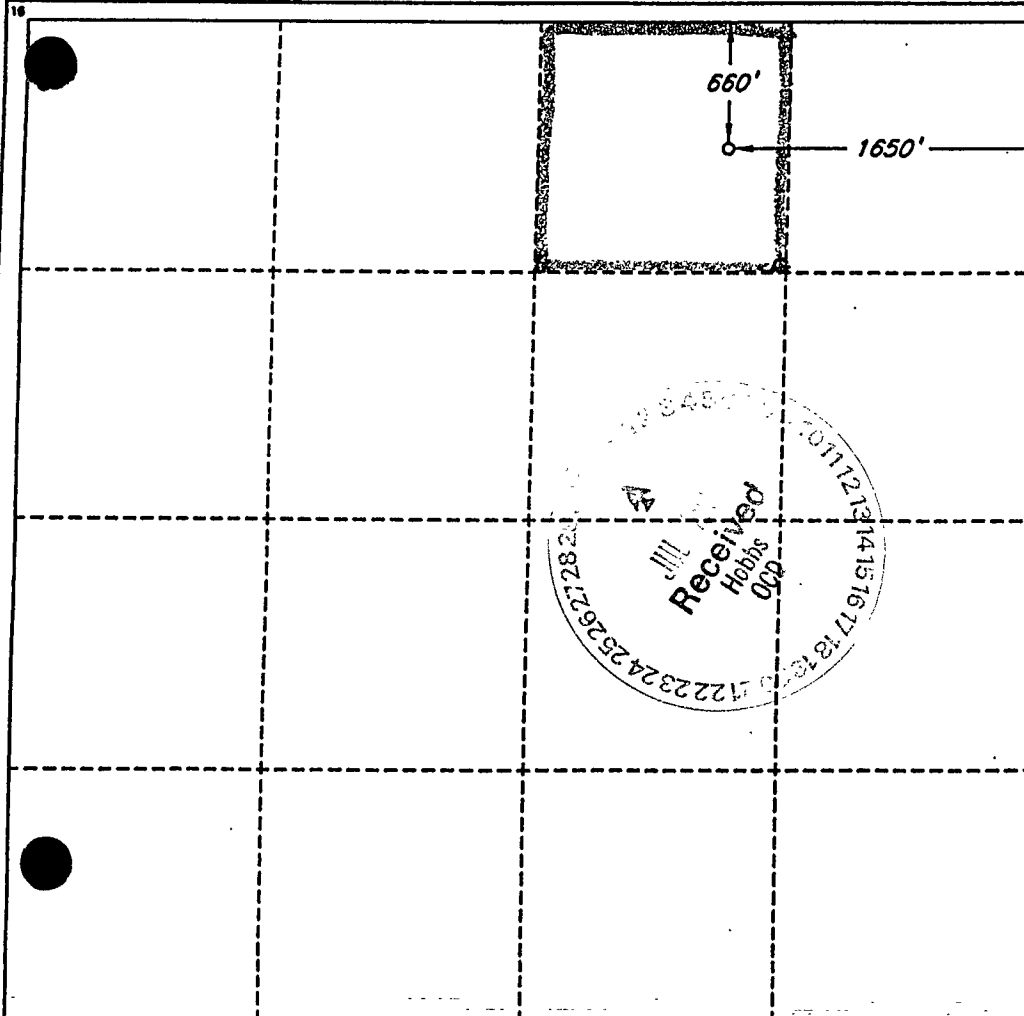

OPERATOR CERTIFICATION

I hereby certify that the information
contained herein is true and complete
to the best of my knowledge and belief.

Signature

Printed Name

H. SCOTT DAVIS

Title

AGENT

Date

5/28/99

SURVEYOR CERTIFICATION

I hereby certify that the well
location shown on this plat was
plotted from field notes of actual
surveys made by me or under
my supervision, and that the
same is true and correct to the
best of my belief.

Date of Survey

MAY 26, 1999

Signature and Seal
Professional Surveyor

ROGER M. ROBBINS
NEW MEXICO
REGISTERED
12128
ROGER M. ROBBINS
JOB #63718 V.H.B.

DISTRICT I
P. O. Box 1980
Hobbs, NM 88241-1980

State of New Mexico
Energy, Minerals, and Natural Resources Department

Form C-102
Revised 02-10-94

Instructions on back

Submit to the Appropriate
District Office
State Lease - 4 copies
Fee Lease - 3 copies

DISTRICT II
P. O. Drawer DD
Artesia, NM 88211-0719

OIL CONSERVATION DIVISION

P. O. Box 2088
Santa Fe, New Mexico 87504-2088

☐ AMENDED REPORT

DISTRICT III
1000 Rio Brazos Rd.
Aztec, NM 87410

DISTRICT IV
P. O. Box 2088
Santa Fe, NM 87507-2088

WELL LOCATION AND ACREAGE DEDICATION PLAT

1 API Number 30-025-34642		2 Pool Code 33250		3 Pool Name House; Drinkard					
4 Property Code 24693		5 Property Name KOOL						6 Well Number 1	
7 OGRID No. 3659		8 Operator Name CAPATAZ OPERATING, INC.						9 Elevation 3572'	
10 SURFACE LOCATION									
UL or lot no. B	Section 14	Township 20 SOUTH	Range 38 EAST, N.M.P.M.	Lot Ida	Feet from the 660'	North/South line NORTH	Feet from the 1650'	East/West line EAST	County LEA
11 BOTTOM HOLE LOCATION IF DIFFERENT FROM SURFACE									
UL or lot no.	Section	Township	Range	Lot Ida	Feet from the	North/South line	Feet from the	East/West line	County
12 Dedicated Acres		13 Joint or Infill		14 Consolidation Code		15 Order No.			

NO ALLOWABLE WELL BE ASSIGNED TO THIS COMPLETION UNTIL ALL INTERESTS HAVE BEEN CONSOLIDATED OR A NON-STANDARD UNIT HAS BEEN APPROVED BY THE DIVISION

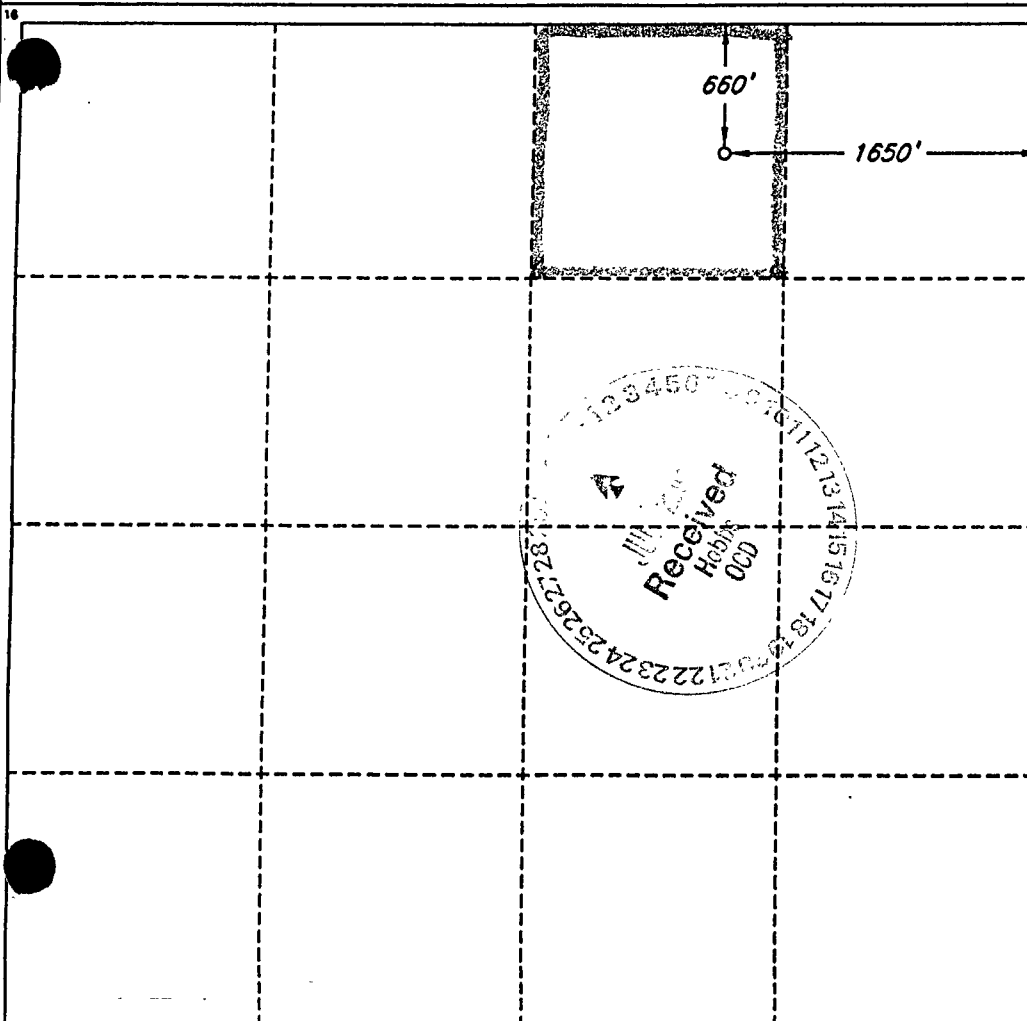

OPERATOR CERTIFICATION

I hereby certify that the information contained herein is true and complete to the best of my knowledge and belief.

Signature *[Signature]*

Printed Name **H. SCOTT DAVIS**

Title **AGENT**

Date **5/20/99**

SURVEYOR CERTIFICATION

I hereby certify that the well location shown on this plat was plotted from field notes of actual surveys made by me or under my supervision, and that the same is true and correct to the best of my belief.

Date of Survey **MAY 26, 1999**

Signature and Seal *[Signature]*

Professional Surveyor
ROGER M. ROBBINS
NEW MEXICO
REGISTERED
12128
CERTIFICATE NO. **12128**
JOB #63718 V.H.B.