

PNRM 0709430934

C-103 Received 3-29-2007
DHC No. Assigned 4-4-2007

Order Number		API Number		Operator		County	
HOB-0198		30-025-25110		John H. Hendrix Corp.		Lea	
Order Date		Well Name		Number		Location	
		Whitaker + Perkins		002		UL 12 22S 37E	
						T (+Dir) R (+Dir)	
Pool 1		06660		Blinebry Oil & Gas (Oil)		Oil % 27% Gas % 31%	
Pool 2		60240		Tubb Oil & Gas (Oil)		Oil % 26% Gas % 31%	
Pool 3		07900		Brunson Drinkard Abg, South		Oil % 20% Gas % 31%	
Pool 4		62730		Wantz Granite Wash		Oil % 27% Gas % 7%	
Comments: Work completed effective _____ Work cancelled effective _____ Supplement _____							

Posted to
RBDMA
4-4-2007

Previously
DHC-706

30-025-25110

HOB-0198

DOWNHOLE COMMINGLE CALCULATIONS:OPERATOR: John H. Hendrix Corp.PROPERTY NAME: Whitaker & PerkinsWNULSTR: 2-C; 12-22-37

	SECTION I:		ALLOWABLE	AMOUNT	
06660	POOL NO. 1	<u>Blinbry Oil & Gas (Oil)</u>	<u>107</u>	<u>428</u>	MCF 1000
60240	POOL NO. 2	<u>Tubb Oil & Gas (Oil)</u>	<u>142</u>	<u>284</u>	MCF 2000
07900	POOL NO. 3	<u>Brunson Drinkard Abo, S.</u>	<u>142</u>	<u>852</u>	MCF 6000
62730	POOL NO. 4	<u>Wantz Granite Wash</u>	<u>187</u>	<u>374</u>	MCF 2000
		POOL TOTALS	<u>578</u>	<u>1938</u>	

	SECTION II:		Oil	Gas
	POOL NO. 1	<u>Blinbry Oil & Gas (Oil)</u>	<u>27% X 578 = 156.06</u>	<u>31%</u>
	POOL NO. 2	<u>Tubb Oil & Gas (Oil)</u>	<u>26%</u>	<u>31%</u>
	POOL NO. 3	<u>Brunson Drinkard Abo, S.</u>	<u>20%</u>	<u>31%</u>
	POOL NO. 4	<u>Wantz Granite Wash</u>	<u>27%</u>	<u>7%</u>

OILGAS

SECTION III:

$$107 \div 27\% = 396.296 (397)$$

SECTION IV:

$$397 \times 27\% = 107.19 (107)$$

$$397 \times 26\% = 103.22 (103)$$

$$397 \times 20\% = 79.40 (80)$$

$$397 \times 27\% = 107.19 (107)$$

Submit 3 Copies To Appropriate District
Office
District I
1625 N French Dr, Hobbs, NM 88240
District II
1301 W. Grand Ave., Artesia, NM 88210
District III
1000 Rio Brazos Rd., Aztec, NM 87410
District IV
1000 S. St. Francis Dr., Santa Fe, NM 87505

State of New Mexico
Energy, Minerals and Natural Resources

Form C-103
May 27, 2004

OIL CONSERVATION DIVISION
1220 South St. Francis Dr.
Santa Fe, NM 87505

WELL API NO.	30-025-25110
5. Indicate Type of Lease STATE <input type="checkbox"/> FEE <input checked="" type="checkbox"/>	
6. State Oil & Gas Lease No.	
7. Lease Name or Unit Agreement Name Whitaker & Perkins	
8. Well Number	2
9. OGRID Number	012024
10. Pool name or Wildcat Blbry-Tubb-Brunson Dr., Abo, S. & Wantz GW	

SUNDRY NOTICES AND REPORTS ON WELLS
(DO NOT USE THIS FORM FOR PROPOSALS TO DRILL OR TO DEEPEN OR PLUG BACK TO A DIFFERENT RESERVOIR. USE "APPLICATION FOR PERMIT" (FORM C-101) FOR SUCH PROPOSALS.)

1. Type of Well: Oil Well ☒ Gas Well ☐ Other

2. Name of Operator
John H. Hendrix Corporation

3. Address of Operator
P. O. Box 3040
Midland, TX 79702-3040

4. Well Location
Unit Letter C : 760 feet from the North line and 1780 feet from the West line
Section 12 Township 22S Range 37E NMPM County Lea

11. Elevation (Show whether DR, RKB, RT, GR, etc.)
3358' KB

Pit or Below-grade Tank Application ☐ or Closure ☐

Pit type _____ Depth to Groundwater _____ Distance from nearest fresh water well _____ Distance from nearest surface water _____

Pit Liner Thickness: _____ mil Below-Grade Tank: Volume _____ bbls; Construction Material _____

12. Check Appropriate Box to Indicate Nature of Notice, Report or Other Data

NOTICE OF INTENTION TO:

PERFORM REMEDIAL WORK ☐ PLUG AND ABANDON ☐
TEMPORARILY ABANDON ☐ CHANGE PLANS ☐
PULL OR ALTER CASING ☐ MULTIPLE COMPL ☐

SUBSEQUENT REPORT OF:

REMEDIAL WORK ☐ ALTERING CASING ☐
COMMENCE DRILLING OPNS. ☐ P AND A ☐
CASING/CEMENT JOB ☐

OTHER: DHC Blbry-Tubb-Brunson Dr. Abo, S. - Wantz GW ☒

OTHER: ☐

13. Describe proposed or completed operations. (Clearly state all pertinent details, and give pertinent dates, including estimated date of starting any proposed work). SEE RULE 1103. For Multiple Completions: Attach wellbore diagram of proposed completion or recompletion.

This is a request to DHC Blinebry Oil & Gas (to be perforated), Tubb Oil & Gas (to be perforated) and already perforated Brunson Drinkard Abo, S. and Wantz Granite Wash in the subject well. It is noted that Brunson Dr. Abo, S. & Wantz Granite Wash DHC was approved by DHC #706.

DHC Order No. HOB-0198

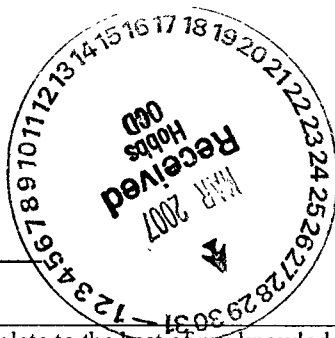

I hereby certify that the information above is true and complete to the best of my knowledge and belief. I further certify that any pit or below-grade tank has been/will be constructed or closed according to NMOCD guidelines ☐, a general permit ☐ or an (attached) alternative OCD-approved plan ☐.

SIGNATURE Ronnie H. Westbrook TITLE Vice President DATE 03/19/2007

or print name Ronnie H. Westbrook E-mail address: _____ Telephone No. (432)684-6631

For State Use Only

APPROVED BY: Chris Williams OC DISTRICT SUPERVISOR/GENERAL MANAGER DATE APR 04 2007

Conditions of Approval (if any): _____

WHITAKER & PERKINS NO. 2

**UNIT C, SEC. 12, T22S – R37E
LEA COUNTY, NEW MEXICO**

1. Division Order that established pre-approved pools. Order No. R-11363.
2. Pools to be commingled – Blinebry Oil & Gas (6660), Tubb Oil & Gas (60240), Brunson Drinkard Abo, S. (7900) and Wantz Granite Wash (62730).
3. Blinebry Perfs. – 5444 – 5836' – To be perforated
Brunson-Drinkard Abo, S. – 6286' – 7001'
Tubb Perfs. – 5930 – 6161' – To be perforated
Wantz Granite Wash Perfs. – 7194 – 7349'
4. All zones are intermediate crude and commingling will not reduce the value Of the production.
5. Ownership between pools is identical.
6. Current production, production prior to TA or anticipated production.

Blinebry Oil & Gas	2 BOPD	50 MCFPD
Brunson Drinkard Abo, S.	1.5 BOPD	50 MCFPD
Tubb Oil & Gas	2 BOPD	50 MCFPD
Wantz Granite Wash	2 BOPD	10 MCFPD
Total	7.5 BOPD	160 MCFPD

7. The proposed allocation to be as follows:

	Oil%	Gas%
Blinebry Oil & Gas	27%	31%
Brunson Drinkard Abo, S.	20%	31%
Tubb Oil & Gas	26%	31%
Wantz Granite Wash	27%	7%
Total	100%	100%

District I

1625 N. French Dr., Hobbs, NM 88240

District II

1301 W. Grand Avenue, Artesia, NM 88210

District III

Rio Brazos Rd., Aztec, NM 87410

District IV

1220 S. St. Francis Dr., Santa Fe, NM 87505

State of New Mexico

Energy, Minerals & Natural Resources Department

OIL CONSERVATION DIVISION

1220 South St. Francis Dr.

Santa Fe, NM 87505

Form C-102

Revised October 12, 2005

Submit to Appropriate District Office

State Lease - 4 Copies

Fee Lease - 3 Copies

☐ AMENDED REPORT

WELL LOCATION AND ACREAGE DEDICATION PLAT

* API Number 30-025-25110		* Pool Code 06660	* Pool Name Blinebry Oil & Gas
* Property Code 005238	* Property Name Whitaker & Perkins		* Well Number 2
* OGRID No. 012024	* Operator Name John H. Hendrix Corporation		* Elevation 3358' KB

¹⁰ Surface Location

UL or lot no.	Section	Township	Range	Lot 14a	Feet from the	North/South line	Feet from the	East/West line	County
C	12	22S	37E		760	North	1780	West	Lea

¹¹ Bottom Hole Location If Different From Surface

UL or lot no.	Section	Township	Range	Lot 14a	Feet from the	North/South line	Feet from the	East/West line	County
* Dedicated Acres 40	* Joint or Infill	* Consolidation Code		* Order No.					

No allowable will be assigned to this completion until all interests have been consolidated or a non-standard unit has been approved by the division.

	17 OPERATOR CERTIFICATION I hereby certify that the information contained herein is true and complete to the best of my knowledge and belief, and that this organization either owns a working interest or released mineral interest in the land including the proposed bottom hole location or has a right to drill this well at this location pursuant to a contract with an owner of such a mineral or working interest, or to a voluntary pooling agreement or a compulsory pooling order hereby entered by the division. Signature _____ Date 02/19/2007 Ronnie H. Westbrook Printed Name
	18 SURVEYOR CERTIFICATION I hereby certify that the well location shown on this plat was plotted from field notes of actual surveys made by me or under my supervision, and that the same is true and correct to the best of my belief.
	Date of Survey _____ Signature and Seal of Professional Surveyor: _____
	Certificate Number _____

ADDRESS I

1625 N. French Dr., Hobbs, NM 88240

District II

1301 W. Grand Avenue, Artesia, NM 88210

District III

1890 Rio Brazos Rd., Aztec, NM 87410

District IV

1220 S. St. Francis Dr., Santa Fe, NM 87505

State of New Mexico

Energy, Minerals & Natural Resources Department

OIL CONSERVATION DIVISION

1220 South St. Francis Dr.

Santa Fe, NM 87505

Form C-102

Revised October 12, 2005

Submit to Appropriate District Office

State Lease - 4 Copies

Fee Lease - 3 Copies

☐ AMENDED REPORT

WELL LOCATION AND ACREAGE DEDICATION PLAT

API Number 30-025-25110		Pool Code 60240		Pool Name Tubb Oil & Gas	
Property Code 005238		Property Name Whitaker & Perkins			Well Number 2
OGRID No. 012024		Operator Name John H. Hendrix Corporation			Elevation 3358' KB

10 Surface Location

UL or lot no.	Section	Township	Range	Lot Idn	Feet from the	North/South line	Feet from the	East/West line	County
C	12	22S	37E		760	North	1780	West	Lea

11 Bottom Hole Location If Different From Surface

UL or lot no.	Section	Township	Range	Lot Idn	Feet from the	North/South line	Feet from the	East/West line	County

Dedicated Acres 40	Joint or Infill	Consolidation Code	Order No.
-----------------------	-----------------	--------------------	-----------

No allowable will be assigned to this completion until all interests have been consolidated or a non-standard unit has been approved by the division.

16 	17 OPERATOR CERTIFICATION I hereby certify that the information contained herein is true and complete to the best of my knowledge and belief, and that this organization either owns a working interest or retained mineral interest in the land including the proposed bottom hole location or has a right to drill this well at this location pursuant to a contract with an owner of such a mineral or working interest, or to a voluntary pooling agreement or a compulsory pooling order heretofore entered by this division. 02/29/007 Signature Date Ronnie H. Westbrook Printed Name		
	18 SURVEYOR CERTIFICATION I hereby certify that the well location shown on this plat was plotted from field notes of actual surveys made by me or under my supervision, and that the same is true and correct to the best of my belief. Date of Survey Signature and Seal of Professional Surveyor: Certificate Number		

Exxon Lse. No. _____ NEW MEXICO OIL CONSERVATION COMMISSION
State Lse. No. _____ WELL LOCATION AND ACREAGE DEDICATION PLAT
Federal Lse. No. _____ All distances must be from the outer boundaries of the Section.

Form C-102
Supersedes C-128
Effective 1-1-65

Operator Exxon Corporation		Lease WHITAKER & PERKINS			Well No. 2
Unit Letter C	Section 12	Township 22 SOUTH	Range 37 EAST	County LEA	
Actual Footage Location of Well: 760 feet from the NORTH line and 1780 feet from the WEST line					
Ground Level Elev.	Producing Formation Granite Wash & Drinkard		Pool Wantz Granite Wash & Drinkard		Dedicated Acreage: 40 Acres

1. Outline the acreage dedicated to the subject well by colored pencil or hatchure marks on the plat below.
2. If more than one lease is dedicated to the well, outline each and identify the ownership thereof (both as to working interest and royalty).
3. If more than one lease of different ownership is dedicated to the well, have the interests of all owners been consolidated by communitization, unitization, force-pooling, etc?

☐ Yes ☐ No If answer is "yes," type of consolidation _____

If answer is "no," list the owners and tract descriptions which have actually been consolidated. (Use reverse side of this form if necessary.) _____

No allowable will be assigned to the well until all interests have been consolidated (by communitization, unitization, forced-pooling, or otherwise) or until a non-standard unit, eliminating such interests, has been approved by the Commission.

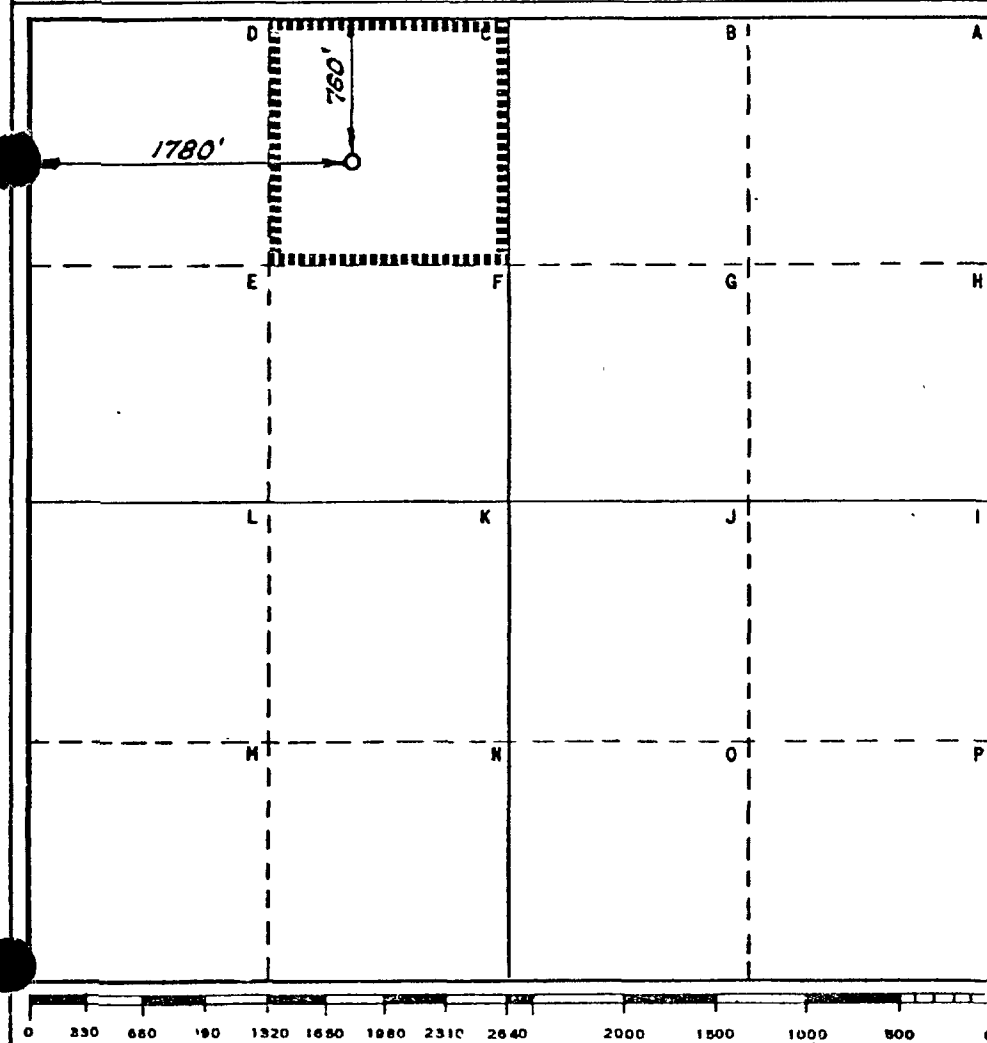

CERTIFICATION

I hereby certify that the information contained herein is true and complete to the best of my knowledge and belief.

Name
Melba Knippling
Position
Proration Specialist
Company **Exxon Corporation**
Box 1600 Midland, Texas
Date
8-29-'75

I hereby certify that the well location shown on this plat was plotted from field notes of actual surveys made by me or under my supervision, and that the same is true and correct to the best of my knowledge and belief.

Date Surveyed
8-28-'75
Registered Professional Engineer
and/or Land Surveyor

[Signature]
Certificate No.
Texas 1345

3 Miles S.E. of **Eunice**, New Mexico

C.E. Sec. File No. **A-6871**