

**LEWIS B. BURLESON, INC.**  
OIL & GAS PROPERTIES

LEWIS B. BURLESON  
PRESIDENT  
STEVEN L. BURLESON  
VICE-PRESIDENT  
WAYNE JARVIS  
SUPERINTENDENT

July 21, 1997

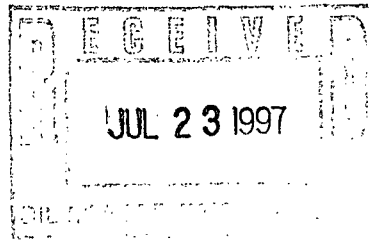

Mr. William LeMay, Director  
State of New Mexico  
Oil Conservation Division  
2040 South Pacheco  
Santa Fe, NM 87505

RE: Administrative Application for Non-Standard Proration Unit, and Simultaneous Dedication for Lewis B. Burleson Inc.'s Farney A-5 #8 well, located 1780' FNL & 660' FEL of Section 5, T-23-S, R-36-E, Lea County, New Mexico

Dear Mr. LeMay:

Enclosed is a copy of the letter sent to off-set operators, per your request, with the returned receipts showing a delivery date of July 9, 1997. All requirements have been made within the specified waiting period.

We would like to know the status of the application. Your attention is appreciated.

Yours truly,

Lewis B. Burleson

LBB/jt

Enclosures

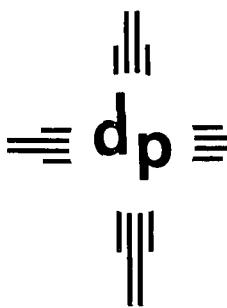

dugan production corp.

RECEIVED

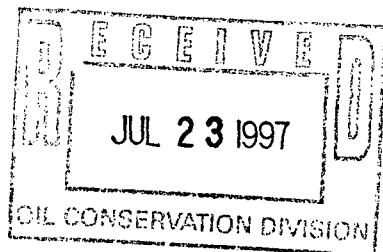

JUL 07 1997  
CENTRAL RESOURCES, INC.

Certified Mail

June 30, 1997

Central Resources  
1775 Sherman St., Suite 2600  
Denver, CO 80203-4313

**Subject:** *Administrative Approval of Unorthodox Location  
Dugan Production Corp.  
Bisti State #1  
1980' FNL & 660' FWL Sec. 2, T25N, R13W, NMPM  
San Juan County, NM  
Basin Fruitland Coal*

SIGN & RETURN  
THIS COPY  
to New Mexico Oil Cons. Div.  
Santa Fe, NM

Gentlemen:

Dugan Production Corp. has filed with the New Mexico Oil Conservation Division (NMOCD) an Application for Administrative Approval for an Unorthodox Location for its Bisti State #1 well. A copy of the application has been attached for your review.

If you have no objection to this unorthodox location, please sign the three copies of the attached waiver. Return one executed copy to the NMOCD in Santa Fe, NM, one copy to our office, and retain one copy for your files. Self-addressed, stamped envelopes are enclosed.

Your assistance and cooperation in this matter are appreciated.

Sincerely,

Kurt Fagrelus

KF/cg

---

WAIVER

Central Resources hereby waives objection to the above referenced Application for Unorthodox Location for Dugan Production Corp's Bisti State #1 well.

By:

Date:

7-15-97

~~NSP~~ (SD) 7/31/97

**LEWIS B. BURLESON, INC.**  
OIL & GAS PROPERTIES

LEWIS B. BURLESON  
PRESIDENT  
STEVEN L. BURLESON  
VICE-PRESIDENT  
WAYNE JARVIS  
SUPERINTENDENT

July 8, 1997

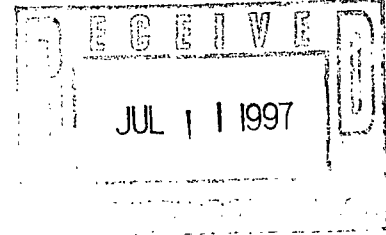

Mr. William LeMay, Director  
State of New Mexico  
Oil Conservation Division  
2040 South Pacheco  
Santa Fe, New Mexico 87505

RE: Administrative Application for Non-Standard Proration Unit, and Simultaneous Dedication for Lewis B. Burleson, Inc.'s Farney A-5 #8 well, located 1780' FNL & 660' FEL of Section 5, T-23-S, R-36-E, Lea County, New Mexico

Dear Mr. LeMay:

Lewis B. Burleson, Inc. requests administrative approval of a non-standard proration unit, and simultaneous dedication for its Farney A-5 #8 well which is proposed to be completed in the Jalmat Gas Pool. We have notified by Certified Letter, all offset operators as shown in Exhibit "B" so that they may object to these variances within the specified waiting period.

Non-Standard Unit and Simultaneous Dedication:

A 322.76 acre Non-Standard Gas Proration Unit (E/2, Section 5, T-23-S, R-36-E) was previously approved for the Farney #4 by Administrative Order NSP 1525(L). We plan to complete the #8 well located 1780' FNL and 660' FEL, in Section 5 as a Jalmat Gas well, and simultaneously dedicate both wells to the 322.76 acre unit. The Farney A-5 #8 tested the 7-Rivers oil zone as non-commercial. Upon approval, we plan to plug this well back to the Jalmat Gas Pool.

This notice and all attachments are true and correct to the best of our knowledge and belief.

Yours truly,

Lewis B. Burleson

LBB/jrt  
Enclosures

NSP1

**EXHIBIT "B"**

**LEWIS B. BURLESON, INC.  
Farney A-5  
Well No. 8**

**Simultaneous Dedication Application  
Jalmat Gas Pool  
1780' FNL and 660' FEL  
Section 5, T-23-S, R-36-E  
Lea County, New Mexico**

**OFFSET OPERATORS**

Conoco Inc.  
Attention: Jerry W. Hoover  
Conservation/Proration Dept.  
10 Desta Drive #100W  
Midland, Texas 79705-4500

Clayton Williams  
Attn: Conservation Manager  
6 Desta Drive, Suite 3000  
Midland, Texas 79705

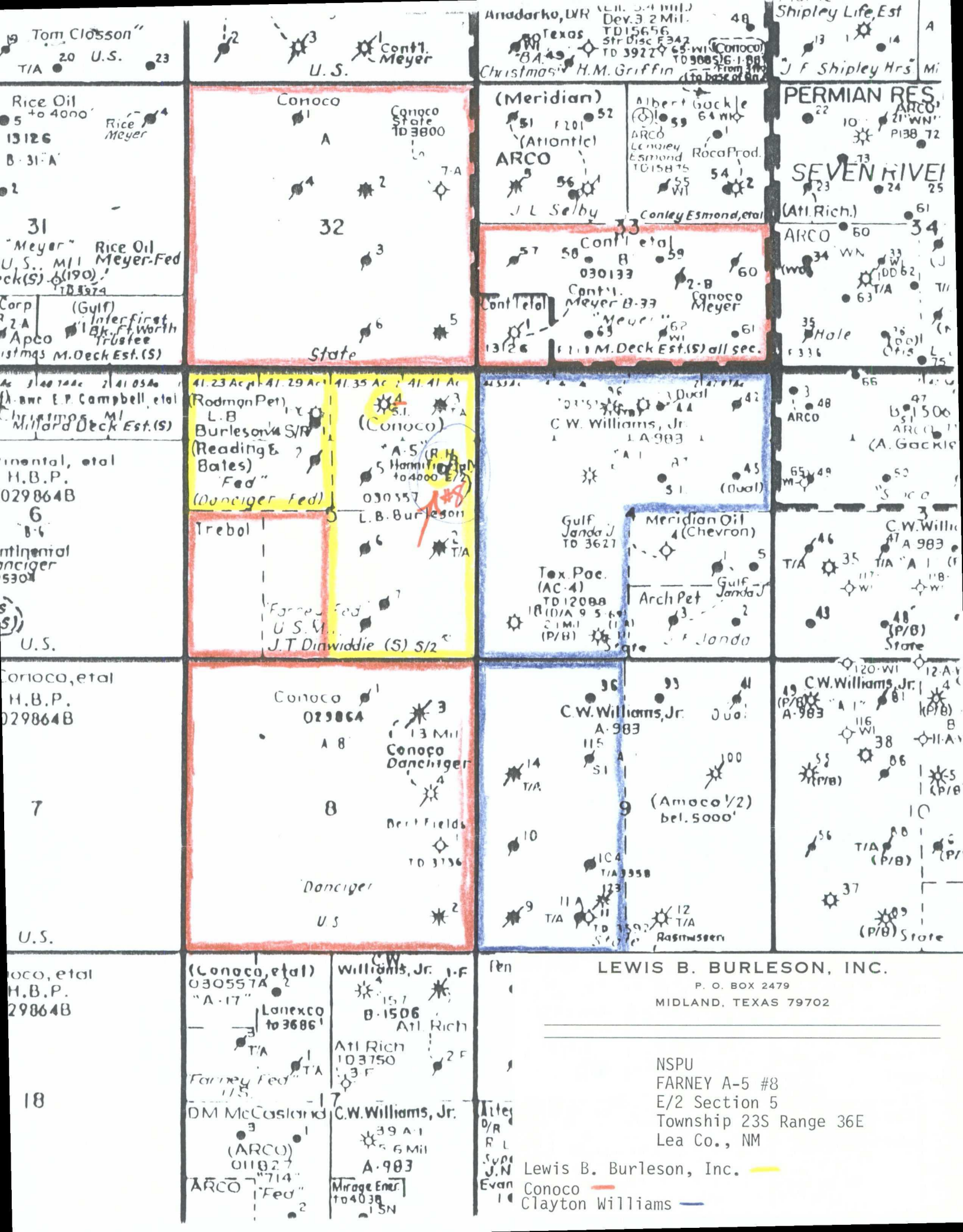

Tom Closson  
T/A 20 U.S. 23

Rice Oil  
5 + 4000  
13126  
B-31-A

31  
"Meyer" Rice Oil  
U.S. M.I. Meyer-Fed  
ck(S) 6(190)  
183979

Corp (Gulf)  
2A Interfirst  
Apco 1st Bk. F. Worth  
Trustee  
istmq M. Deck Est. (S)

Ac 2140744c 2141034c  
A. B. E. P. Campbell, et al  
Miford Deck Est. (S)

Continental, et al  
H.B.P.  
029864B

6  
B-6  
Continental  
Danciger  
5304

(S)  
U.S.

Conoco, et al  
H.B.P.  
029864B

7

U.S.

Conoco, et al  
H.B.P.  
29864B

18

12 3 1  
U.S. Cont'l Meyer

Conoco  
1  
A  
Conoco  
State  
103800  
7-A

32

State

41.23 Ac 41.29 Ac 41.35 Ac 41.41 Ac  
(Rodman Per)  
L.B.  
Burleson S/R  
(Reading &  
Bates)  
"Fed"  
(Danciger Fed)

Trebol

Farney Fed  
U.S. M.I.  
J.T. Dinwiddie (S) 5/2

Conoco  
029864  
A 8  
13 Mil  
Conoco  
Danciger  
4  
Nest Fields  
1  
103136

Danciger  
U.S.

(Conoco, et al)  
030557A  
"A-17"  
Lanexco  
to 3686'

T/A

Farney Fed  
U.S.

DM McCasland

(ARCO)  
011027  
"714"  
"Fed"

ARCO

Williams, Jr. I-F  
157  
B-1506  
Atl Rich  
103750  
3 F

C.W. Williams, Jr.  
39 A-1  
5.6 Mil  
A-903  
Mirage Ener  
to 4038  
1 SN

Anadarko, D/R  
Texas  
Christmas  
H.M. Griffin  
Dev. 3.2 Mil.  
TD 15656  
Str Disc E342  
TD 39229  
65-WI (Conoco)  
TD 90856  
1-88  
From 310  
(to base of an)

(Meridian)  
51 1201 52  
(Atlantic)  
ARCO  
56  
J.L. Selby

Albert Gucke  
64 WK  
ARCO  
Lenorey  
Esmond  
TD 15875  
55 WI  
Roca Prod.  
54 12  
Conley Esmond, et al

57 50 Cont'l et al  
030133  
Cont'l Meyer B-33  
Meyer  
62 WI  
61  
13126

Cont'l et al  
Meyer B-33  
Conoco Meyer  
62 WI  
61  
13126

57 50 Cont'l et al  
030133  
Cont'l Meyer B-33  
Meyer  
62 WI  
61  
13126

Gulf Janda J  
TO 3627

Tex. Poe.  
(AC-4)  
TD 12088  
18 (D/A 9 5  
2 MI  
(P/B)

Meridian Oil  
(Chevron)  
4  
Gulf Janda J  
Arch Pet  
3  
J. J. Janda

C.W. Williams, Jr.  
A-983  
115  
S1  
14  
T/A

(Amoco 1/2)  
bel. 5000'

104  
T/A 3558  
123  
11 A  
T/A  
12  
T/A  
Rasmussen

10  
9  
11 A  
T/A  
12  
T/A  
Rasmussen

10  
9  
11 A  
T/A  
12  
T/A  
Rasmussen

10  
9  
11 A  
T/A  
12  
T/A  
Rasmussen

10  
9  
11 A  
T/A  
12  
T/A  
Rasmussen

10  
9  
11 A  
T/A  
12  
T/A  
Rasmussen

Shipley Life, Est  
J.F. Shipley Hrs  
Mi

PERMIAN RES.  
22 10  
ARCO  
21 WI  
P188 72

SEVEN RIVER  
23 24 25  
(Atl. Rich.)  
ARCO  
60 34  
WN  
33  
100 62  
T/A  
63  
35  
Hale  
336  
36  
37  
38  
39  
40  
41  
42  
43  
44  
45  
46  
47  
48  
49  
50  
51  
52  
53  
54  
55  
56  
57  
58  
59  
60  
61  
62  
63  
64  
65  
66  
67  
68  
69  
70  
71  
72  
73  
74  
75  
76  
77  
78  
79  
80  
81  
82  
83  
84  
85  
86  
87  
88  
89  
90  
91  
92  
93  
94  
95  
96  
97  
98  
99  
100

ARCO  
60 34  
WN  
33  
100 62  
T/A  
63  
35  
Hale  
336  
36  
37  
38  
39  
40  
41  
42  
43  
44  
45  
46  
47  
48  
49  
50  
51  
52  
53  
54  
55  
56  
57  
58  
59  
60  
61  
62  
63  
64  
65  
66  
67  
68  
69  
70  
71  
72  
73  
74  
75  
76  
77  
78  
79  
80  
81  
82  
83  
84  
85  
86  
87  
88  
89  
90  
91  
92  
93  
94  
95  
96  
97  
98  
99  
100

ARCO  
60 34  
WN  
33  
100 62  
T/A  
63  
35  
Hale  
336  
36  
37  
38  
39  
40  
41  
42  
43  
44  
45  
46  
47  
48  
49  
50  
51  
52  
53  
54  
55  
56  
57  
58  
59  
60  
61  
62  
63  
64  
65  
66  
67  
68  
69  
70  
71  
72  
73  
74  
75  
76  
77  
78  
79  
80  
81  
82  
83  
84  
85  
86  
87  
88  
89  
90  
91  
92  
93  
94  
95  
96  
97  
98  
99  
100

ARCO  
60 34  
WN  
33  
100 62  
T/A  
63  
35  
Hale  
336  
36  
37  
38  
39  
40  
41  
42  
43  
44  
45  
46  
47  
48  
49  
50  
51  
52  
53  
54  
55  
56  
57  
58  
59  
60  
61  
62  
63  
64  
65  
66  
67  
68  
69  
70  
71  
72  
73  
74  
75  
76  
77  
78  
79  
80  
81  
82  
83  
84  
85  
86  
87  
88  
89  
90  
91  
92  
93  
94  
95  
96  
97  
98  
99  
100

ARCO  
60 34  
WN  
33  
100 62  
T/A  
63  
35  
Hale  
336  
36  
37  
38  
39  
40  
41  
42  
43  
44  
45  
46  
47  
48  
49  
50  
51  
52  
53  
54  
55  
56  
57  
58  
59  
60  
61  
62  
63  
64  
65  
66  
67  
68  
69  
70  
71  
72  
73  
74  
75  
76  
77  
78  
79  
80  
81  
82  
83  
84  
85  
86  
87  
88  
89  
90  
91  
92  
93  
94  
95  
96  
97  
98  
99  
100

ARCO  
60 34  
WN  
33  
100 62  
T/A  
63  
35  
Hale  
336  
36  
37  
38  
39  
40  
41  
42  
43  
44  
45  
46  
47  
48  
49  
50  
51  
52  
53  
54  
55  
56  
57  
58  
59  
60  
61  
62  
63  
64  
65  
66  
67  
68  
69  
70  
71  
72  
73  
74  
75  
76  
77  
78  
79  
80  
81  
82  
83  
84  
85  
86  
87  
88  
89  
90  
91  
92  
93  
94  
95  
96  
97  
98  
99  
100

ARCO  
60 34  
WN  
33  
100 62  
T/A  
63  
35  
Hale  
336  
36  
37  
38  
39  
40  
41  
42  
43  
44  
45  
46  
47  
48  
49  
50  
51  
52  
53  
54  
55  
56  
57  
58  
59  
60  
61  
62  
63  
64  
65  
66  
67  
68  
69  
70  
71  
72  
73  
74  
75  
76  
77  
78  
79  
80  
81  
82  
83  
84  
85  
86  
87  
88  
89  
90  
91  
92  
93  
94  
95  
96  
97  
98  
99  
100

ARCO  
60 34  
WN  
33  
100 62  
T/A  
63  
35  
Hale  
336  
36  
37  
38  
39  
40  
41  
42  
43  
44  
45  
46  
47  
48  
49  
50  
51  
52  
53  
54  
55  
56  
57  
58  
59  
60  
61  
62  
63  
64  
65  
66  
67  
68  
69  
70  
71  
72  
73  
74  
75  
76  
77  
78  
79  
80  
81  
82  
83  
84  
85  
86  
87  
88  
89  
90  
91  
92  
93  
94  
95  
96  
97  
98  
99  
100

ARCO  
60 34  
WN  
33  
100 62  
T/A  
63  
35  
Hale  
336  
36  
37  
38  
39  
40  
41  
42  
43  
44  
45  
46  
47  
48  
49  
50  
51  
52  
53  
54  
55  
56  
57  
58  
59  
60  
61  
62  
63  
64  
65  
66  
67  
68  
69  
70  
71  
72  
73  
74  
75  
76  
77  
78  
79  
80  
81  
82  
83  
84  
85  
86  
87  
88  
89  
90  
91  
92  
93  
94  
95  
96  
97  
98  
99  
100

ARCO  
60 34  
WN  
33  
100 62  
T/A  
63  
35  
Hale  
336  
36  
37  
38  
39  
40  
41  
42  
43  
44  
45  
46  
47  
48  
49  
50  
51  
52  
53  
54  
55  
56  
57  
58  
59  
60  
61  
62  
63  
64  
65  
66  
67  
68  
69  
70  
71  
72  
73  
74  
75  
76  
77  
78  
79  
80  
81  
82  
83  
84  
85  
86  
87  
88  
89  
90  
91  
92  
93  
94  
95  
96  
97  
98  
99  
100

ARCO  
60 34  
WN  
33  
100 62  
T/A  
63  
35  
Hale  
336  
36  
37  
38  
39  
40  
41  
42  
43  
44  
45  
46  
47  
48  
49  
50  
51  
52  
53  
54  
55  
56  
57  
58  
59  
60  
61  
62  
63  
64  
65  
66  
67  
68  
69  
70  
71  
72  
73  
74  
75  
76  
77  
78  
79  
80  
81  
82  
83  
84  
85  
86  
87  
88  
89  
90  
91  
92  
93  
94  
95  
96  
97  
98  
99  
100

ARCO  
60 34  
WN  
33  
100 62  
T/A  
63  
35  
Hale  
336  
36  
37  
38  
39  
40  
41  
42  
43  
44  
45  
46  
47  
48  
49  
50  
51  
52  
53  
54  
55  
56  
57  
58  
59  
60  
61  
62  
63  
64  
65  
66  
67  
68  
69  
70  
71  
72  
73  
74  
75  
76  
77  
78  
79  
80  
81  
82  
83  
84  
85  
86  
87  
88  
89  
90  
91  
92  
93  
94  
95  
96  
97  
98  
99  
100

ARCO  
60 34  
WN  
33  
100 62  
T/A  
63  
35  
Hale  
336  
36  
37  
38  
39  
40  
41  
42  
43  
44  
45  
46  
47  
48  
49  
50  
51  
52  
53  
54  
55  
56  
57  
58  
59  
60  
61  
62  
63  
64  
65  
66  
67  
68  
69  
70  
71  
72  
73  
74  
75  
76  
77  
78  
79  
80  
81  
82  
83  
84  
85  
86  
87  
88  
89  
90  
91  
92  
93  
94  
95  
96  
97  
98  
99  
100

ARCO  
60 34  
WN  
33  
100 62  
T/A  
63  
35  
Hale  
336  
36  
37  
38  
39  
40  
41  
42  
43  
44  
45  
46  
47  
48  
49  
50  
51  
52  
53  
54  
55  
56  
57  
58  
59  
60  
61  
62  
63  
64  
65  
66  
67  
68  
69  
70  
71  
72  
73  
74  
75  
76  
77  
78  
79  
80  
81  
82  
83  
84  
85  
86  
87  
88  
89  
90  
91  
92  
93  
94  
95  
96  
97  
98  
99  
100

ARCO  
60 34  
WN  
33  
100 62  
T/A  
63  
35  
Hale  
336  
36  
37  
38  
39  
40  
41  
42  
43  
44  
45  
46  
47  
48  
49  
50  
51  
52  
53  
54  
55  
56  
57  
58  
59  
60  
61  
62  
63  
64  
65  
66  
67  
68  
69  
70  
71  
72  
73  
74  
75  
76  
77  
78  
79  
80  
81  
82  
83  
84  
85  
86  
87  
88  
89  
90  
91  
92  
93  
94  
95  
96  
97  
98  
99  
100

LEWIS B. BURLESON, INC.  
P. O. BOX 2479  
MIDLAND, TEXAS 79702

NSPU  
FARNEY A-5 #8  
E/2 Section 5  
Township 23S Range 36E  
Lea Co., NM

Lewis B. Burleson, Inc.  
Conoco  
Clayton Williams

CMD :  
OG5SECT

ONGARD  
INQUIRE LAND BY SECTION

07/17/97 08:06:09  
OGOMES -EMD6  
PAGE NO: 1

Sec : 05 Twp : 23S Rng : 36E Section Type : NORMAL

4 41.23  Federal owned	3 41.29  Federal owned A	2 41.35  Federal owned A	1 41.41  Federal owned A
E 40.00  Federal owned	F 40.00  Federal owned	G 40.00  Federal owned A	H 40.00  Federal owned A

PF01 HELP	PF02	PF03 EXIT	PF04 GoTo	PF05	PF06
PF07 BKWD	PF08 FWD	PF09 PRINT	PF10 SDIV	PF11	PF12

CMD :  
OG5SECT

ONGARD  
INQUIRE LAND BY SECTION

07/17/97 08:06:15  
OGOMES -EMD6  
PAGE NO: 2

Sec : 05 Twp : 23S Rng : 36E Section Type : NORMAL

L 40.00	K 40.00	J 40.00	I 40.00
Federal owned	Federal owned	Federal owned	Federal owned
			A
M 40.00	N 40.00	O 40.00	P 40.00
Federal owned	Federal owned	Federal owned	Federal owned

PF01 HELP	PF02	PF03 EXIT	PF04 GoTo	PF05	PF06
PF07 BKWD	PF08 FWD	PF09 PRINT	PF10 SDIV	PF11	PF12

LEWIS B. BURLESON, INC.  
OIL & GAS PROPERTIES

LEWIS B. BURLESON  
PRESIDENT  
STEVEN L. BURLESON  
VICE-PRESIDENT  
WAYNE JARVIS  
SUPERINTENDENT

July 8, 1997

Clayton Williams  
Attn: Conservation Manager  
6 Desta Drive, Suite 3000  
Midland, Texas 79705

Certified Mail P389 510 600  
RETURN RECEIPT REQUESTED

Re: Administrative application for Non-Standard Proration Unit, and simultaneous Dedication for Lewis B. Burleson, Inc.'s Farney A-5 #8 well, located 1780' FNL & 660' FEL of Section 5, T-23-S, R-36-E, Lea County, New Mexico

Gentlemen:

Enclosed is a copy of the letter to the State of New Mexico Oil Conservation Division in application for a non-standard proration unit, and simultaneous dedication for Lewis B. Burleson, Inc.'s Farney A-5 #8 well, located 1780' FNL & 660' FEL of Section 5, T-23-S, R-36-E, Lea County, New Mexico.

Should you have an objection, call me or file an objection with the State of New Mexico Oil Conservation Division.

Yours truly,

  
Lewis B. Burleson

LBB/jrt  
Enclosure

NSP2

P 389 510 600

US Postal Service  
**Receipt for Certified Mail**  
No Insurance Coverage Provided.  
Do not use for International Mail (See reverse)

Sent to Clayton Williams	
Street & Number Conserv Manager	
Post Office, State, & ZIP Code 6 Desta Dr Ste 3000 Midland TX	
Postage	\$ .32
Certified Fee	135
Special Delivery Fee	
Restricted Delivery Fee	
Return Receipt Showing to Whom & Date Delivered	
Return Receipt Showing to Whom, Date, & Addressee's Address	1/10
Postage & Fees	\$ 272

I also wish to receive the following services (for an extra fee): 1. <input type="checkbox"/> Addressee's Address 2. <input type="checkbox"/> Restricted Delivery Consult postmaster for fee.	
3. Article Addressed to: Clayton Williams Attn: Conservation Manager 6 Desta Drive, Suite 3000 Midland, Texas 79705	4a. Article Number P389 510 600
4b. Service Type <input type="checkbox"/> Registered <input checked="" type="checkbox"/> Certified <input type="checkbox"/> Express Mail <input type="checkbox"/> Insured <input type="checkbox"/> Return Receipt for Merchandise <input type="checkbox"/> COD	
7. Date of Delivery 7997	
8. Addressee's Address (Only if requested and fee is paid)	

Domestic Return Receipt

Thank you for using Return Receipt Service.

U.S. POSTAL SERVICE  
JUL 10 1997  
MIDLAND, TX



LEWIS B. BURLESON, INC.  
OIL & GAS PROPERTIES

Our copy  
LEWIS B. BURLESON  
PRESIDENT  
STEVEN L. BURLESON  
VICE-PRESIDENT  
WAYNE JARVIS  
SUPERINTENDENT

July 8, 1997

Conoco Inc.  
Attention: Jerry W. Hoover  
Conservation/Proration Dept.  
10 Desta Drive #100W  
Midland, Texas 79705-4500

Certified Mail #P389 510 599  
RETURN RECEIPT REQUESTED

Re: Administrative application for Non-Standard Proration Unit, and simultaneous Dedication for Lewis B. Burleson, Inc.'s Farney A-5 #8 well, located 1780' FNL & 660' FEL of Section 5, T-23-S, R-36-E, Lea County, New Mexico

Gentlemen:

Enclosed is a copy of the letter to the State of New Mexico Oil Conservation Division in application for a non-standard proration unit, and simultaneous dedication for Lewis B. Burleson, Inc.'s Farney A-5 #8 well, located 1780' FNL & 660' FEL of Section 5, T-23-S, R-36-E, Lea County, New Mexico.

Should you have an objection, call me or file an objection with the State of New Mexico Oil Conservation Division.

Yours truly,

  
Lewis B. Burleson

LBB/jrt  
Enclosures

NSP2

P 389 510 599

US Postal Service

Receipt for Certified Mail

No Insurance Coverage Provided.

Do not use for International Mail (See reverse)

Sent to	
Conoco Inc. Attn: Jerry Hoover	
Street & Number	
10 Desta Drive #100W	
Post Office, State, & ZIP Code	
Midland, TX 79705	
Postage	\$ .32
Certified Fee	1.35
Special Delivery Fee	
Restricted Delivery Fee	
Return Receipt Showing to Whom & Date Delivered	
Return Receipt Showing to Whom, Date of Addressed Address	
Postage & Fees	\$ 2.77
Restricted or Insured	

PS Form 3800, April 1995

VER:

Complete items 1 and/or 2 for additional services.

Complete items 3, 4a, and 4b.

Write your name and address on the reverse of this form so that we can return this to you.

Attach this form to the front of the mailpiece, or on the back if space does not

allow.

Mark "Return Receipt Requested" on the mailpiece below the article number.

The Return Receipt will show to whom the article was delivered and the date delivered.

3. Article Addressed to:

Conoco Inc.

Jerry Hoover  
Conservation/Proration Dept  
Drive #100W  
Texas 79705-4500

Print Name



December 1994

4a. Article Number

P389 510 599

4b. Service Type

☐ Registered

☒ Certified

☐ Express Mail

☐ Insured

☐ Return Receipt for Merchandise

☐ COD

7. Date of Delivery

7-9-97

8. Addressee's Address (Only if requested and fee is paid)

Domestic Return Receipt

Thank you for using Return Receipt Service.