

DATE IN 5-12-10	SUSPENSE	ENGINEER WJ	LOGGED IN 5-12-10	TYPE SWD	APP NO. 1013252482
-----------------	----------	-------------	-------------------	----------	--------------------

ABOVE THIS LINE FOR DIVISION USE ONLY

NEW MEXICO OIL CONSERVATION DIVISION
 - Engineering Bureau -
 1220 South St. Francis Drive, Santa Fe, NM 87505



RECEIVED OGD
 OGA Resources
 2010 MAY 12 P 1:14

ADMINISTRATIVE APPLICATION CHECKLIST 30-015-25742

THIS CHECKLIST IS MANDATORY FOR ALL ADMINISTRATIVE APPLICATIONS FOR EXCEPTIONS TO DIVISION RULES AND REGULATIONS WHICH REQUIRE PROCESSING AT THE DIVISION LEVEL IN SANTA FE

Application Acronyms:

[NSL-Non-Standard Location] [NSP-Non-Standard Proration Unit] [SD-Simultaneous Dedication]
 [DHC-Downhole Commingling] [CTB-Lease Commingling] [PLC-Pool/Lease Commingling]
 [PC-Pool Commingling] [OLS - Off-Lease Storage] [OLM-Off-Lease Measurement]
 [WFX-Waterflood Expansion] [PMX-Pressure Maintenance Expansion]
 [SWD-Salt Water Disposal] [IPI-Injection Pressure Increase]
 [EOR-Qualified Enhanced Oil Recovery Certification] [PPR-Positive Production Response]

EXXON State #1

[1] **TYPE OF APPLICATION** - Check Those Which Apply for [A]

[A] Location - Spacing Unit - Simultaneous Dedication
☐ NSL ☐ NSP ☐ SD

Check One Only for [B] or [C]

[B] Commingling - Storage - Measurement
☐ DHC ☐ CTB ☐ PLC ☐ PC ☐ OLS ☐ OLM

[C] Injection - Disposal - Pressure Increase - Enhanced Oil Recovery
☐ WFX ☐ PMX ☒ SWD ☐ IPI ☐ EOR ☐ PPR

[D] Other: Specify _____

[2] **NOTIFICATION REQUIRED TO:** - Check Those Which Apply, or ☐ Does Not Apply

[A] ☐ Working, Royalty or Overriding Royalty Interest Owners

[B] ☒ Offset Operators, Leaseholders or Surface Owner

[C] ☒ Application is One Which Requires Published Legal Notice

[D] ☒ Notification and/or Concurrent Approval by BLM or SLO
 U.S. Bureau of Land Management - Commissioner of Public Lands, State Land Office - *certified copy w/fee*

[E] ☒ For all of the above, Proof of Notification or Publication is Attached, and/or,

[F] ☐ Waivers are Attached

[3] **SUBMIT ACCURATE AND COMPLETE INFORMATION REQUIRED TO PROCESS THE TYPE OF APPLICATION INDICATED ABOVE.**

[4] **CERTIFICATION:** I hereby certify that the information submitted with this application for administrative approval is **accurate** and **complete** to the best of my knowledge. I also understand that **no action** will be taken on this application until the required information and notifications are submitted to the Division.

Note: Statement must be completed by an individual with managerial and/or supervisory capacity.

Ann E Ritchie

[Signature]

Regulatory Agent

5/4/10

Print or Type Name

Signature

Title

Date

ann.wtor@gmail.com
 e-mail Address

APPLICATION FOR AUTHORIZATION TO INJECT

- I. PURPOSE: _____ Secondary Recovery _____ Pressure Maintenance _____ ☒ Disposal _____ Storage
Application qualifies for administrative approval? _____ ☒ Yes _____ No
- II. OPERATOR: _____ OGX Resources, LLC _____ 217955 _____
ADDRESS: _____ c/o P.O. Box 953, Midland, TX 79702 _____
CONTACT PARTY: _____ Ann Ritchie, Regulatory Agent _____ PHONE: _____ 432 684-6381 _____
- III. WELL DATA: Complete the data required on the reverse side of this form for each well proposed for injection.
Additional sheets may be attached if necessary.
- IV. Is this an expansion of an existing project? _____ Yes _____ ☒ No
If yes, give the Division order number authorizing the project: _____
- V. Attach a map that identifies all wells and leases within two miles of any proposed injection well with a one-half mile radius circle drawn around each proposed injection well. This circle identifies the well's area of review.
- VI. Attach a tabulation of data on all wells of public record within the area of review which penetrate the proposed injection zone. Such data shall include a description of each well's type, construction, date drilled, location, depth, record of completion, and a schematic of any plugged well illustrating all plugging detail.
- VII. Attach data on the proposed operation, including:
1. Proposed average and maximum daily rate and volume of fluids to be injected;
 2. Whether the system is open or closed;
 3. Proposed average and maximum injection pressure;
 4. Sources and an appropriate analysis of injection fluid and compatibility with the receiving formation if other than reinjected produced water; and,
 5. If injection is for disposal purposes into a zone not productive of oil or gas at or within one mile of the proposed well, attach a chemical analysis of the disposal zone formation water (may be measured or inferred from existing literature, studies, nearby wells, etc.).
- *VIII. Attach appropriate geologic data on the injection zone including appropriate lithologic detail, geologic name, thickness, and depth. Give the geologic name, and depth to bottom of all underground sources of drinking water (aquifers containing waters with total dissolved solids concentrations of 10,000 mg/l or less) overlying the proposed injection zone as well as any such sources known to be immediately underlying the injection interval.
- IX. Describe the proposed stimulation program, if any.
- *X. Attach appropriate logging and test data on the well. (If well logs have been filed with the Division, they need not be resubmitted).
- *XI. Attach a chemical analysis of fresh water from two or more fresh water wells (if available and producing) within one mile of any injection or disposal well showing location of wells and dates samples were taken.
- XII. Applicants for disposal wells must make an affirmative statement that they have examined available geologic and engineering data and find no evidence of open faults or any other hydrologic connection between the disposal zone and any underground sources of drinking water.
- XIII. Applicants must complete the "Proof of Notice" section on the reverse side of this form.
- XIV. Certification: I hereby certify that the information submitted with this application is true and correct to the best of my knowledge and belief.
- NAME: _____ Ann E. Ritchie _____ TITLE: _____ Regulatory Agent _____
SIGNATURE: _____  _____ DATE: _____ 5/3/10 _____
E-MAIL ADDRESS: _____ ann.wtor@gmail.com _____
- * If the information required under Sections VI, VIII, X, and XI above has been previously submitted, it need not be resubmitted. Please show the date and circumstances of the earlier submittal: _____

III. WELL DATA

A. The following well data must be submitted for each injection well covered by this application. The data must be both in tabular and schematic form and shall include:

- (1) Lease name; Well No.; Location by Section, Township and Range; and footage location within the section.
- (2) Each casing string used with its size, setting depth, sacks of cement used, hole size, top of cement, and how such top was determined.
- (3) A description of the tubing to be used including its size, lining material, and setting depth.
- (4) The name, model, and setting depth of the packer used or a description of any other seal system or assembly used.

Division District Offices have supplies of Well Data Sheets which may be used or which may be used as models for this purpose. Applicants for several identical wells may submit a "typical data sheet" rather than submitting the data for each well.

B. The following must be submitted for each injection well covered by this application. All items must be addressed for the initial well. Responses for additional wells need be shown only when different. Information shown on schematics need not be repeated.

- (1) The name of the injection formation and, if applicable, the field or pool name.
- (2) The injection interval and whether it is perforated or open-hole.
- (3) State if the well was drilled for injection or, if not, the original purpose of the well.
- (4) Give the depths of any other perforated intervals and detail on the sacks of cement or bridge plugs used to seal off such perforations.
- (5) Give the depth to and the name of the next higher and next lower oil or gas zone in the area of the well, if any.

XIV. PROOF OF NOTICE

All applicants must furnish proof that a copy of the application has been furnished, by certified or registered mail, to the owner of the surface of the land on which the well is to be located and to each leasehold operator within one-half mile of the well location.

Where an application is subject to administrative approval, a proof of publication must be submitted. Such proof shall consist of a copy of the legal advertisement which was published in the county in which the well is located. The contents of such advertisement must include:

- (1) The name, address, phone number, and contact party for the applicant;
- (2) The intended purpose of the injection well; with the exact location of single wells or the Section, Township, and Range location of multiple wells;
- (3) The formation name and depth with expected maximum injection rates and pressures; and,
- (4) A notation that interested parties must file objections or requests for hearing with the Oil Conservation Division, 1220 South St. Francis Dr., Santa Fe, New Mexico 87505, within 15 days.

NO ACTION WILL BE TAKEN ON THE APPLICATION UNTIL PROPER PROOF OF NOTICE HAS BEEN SUBMITTED.

NOTICE: Surface owners or offset operators must file any objections or requests for hearing of administrative applications within 15 days from the date this application was mailed to them.

WELL LOCATION: 530' FSL & 330' FEL

29E

Surface Casing

Intermediate Casing

Production Casing

3500'	feet to	4800'	Perf'd

(Perforated or Open Hole; indicate which)

INJECTION WELL DATA SHEET

Tubing Size: 2 7/8" Lining Material: plastic coated

Type of Packer: Baker AD-1 Tension

Packer Setting Depth: 3450' +/- (50' above top perf @ 3500')

Other Type of Tubing/Casing Seal (if applicable): _____

Additional Data

1. Is this a new well drilled for injection? _____ Yes X No

If no, for what purpose was the well originally drilled? Producer (was P&A 1987)

2. Name of the Injection Formation: Delaware

3. Name of Field or Pool (if applicable): Brushy Draw Delaware

4. Has the well ever been perforated in any other zone(s)? List all such perforated intervals and give plugging detail, i.e. sacks of cement or plug(s) used. N/A

5. Give the name and depths of any oil or gas zones underlying or overlying the proposed injection zone in this area: N/A

CURRENT WELLBORE

Spud: 4/11/87

API: 30-015-25742

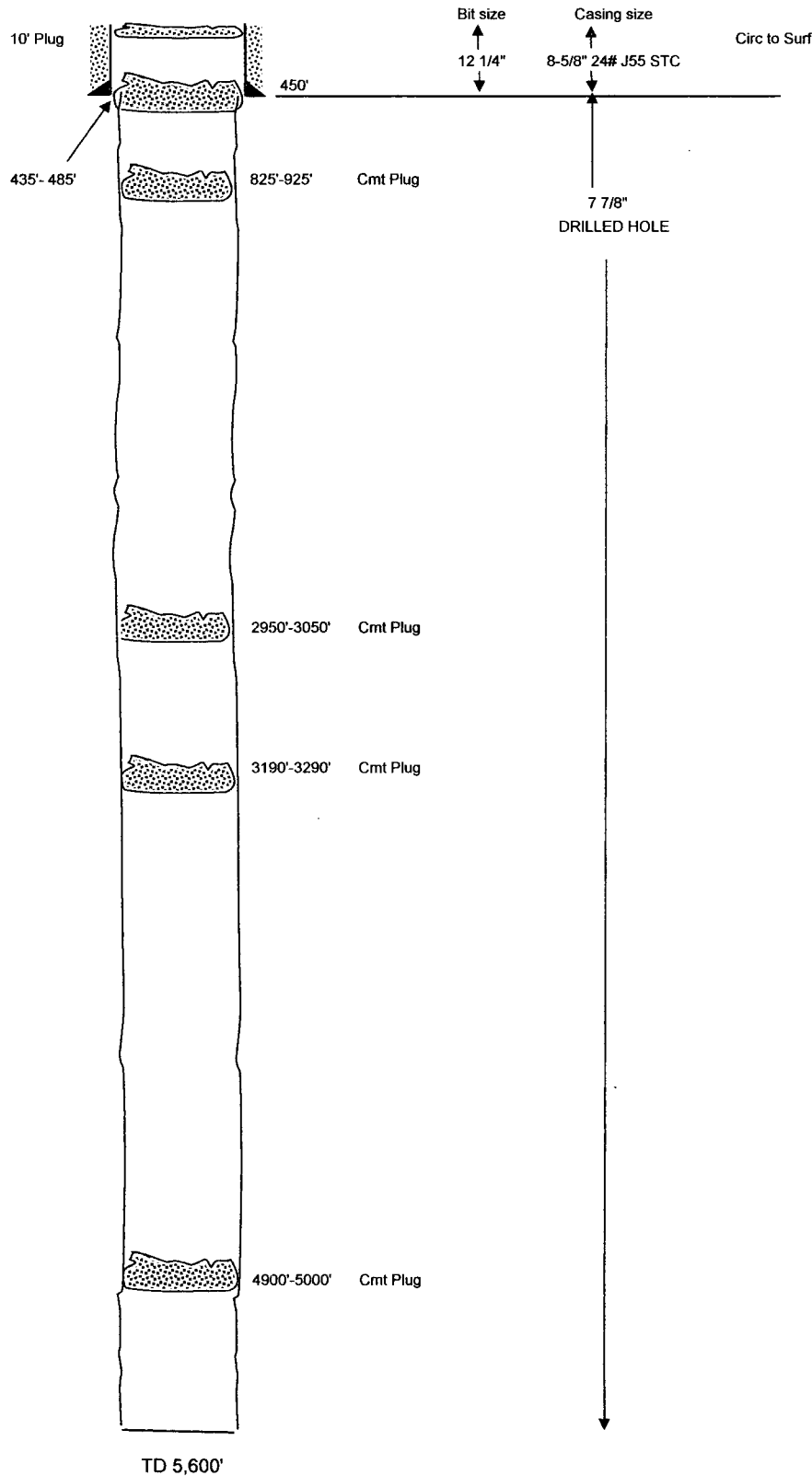

PROPOSED WELLBORE

Spud: 4/11/87

API: 30-015-25742

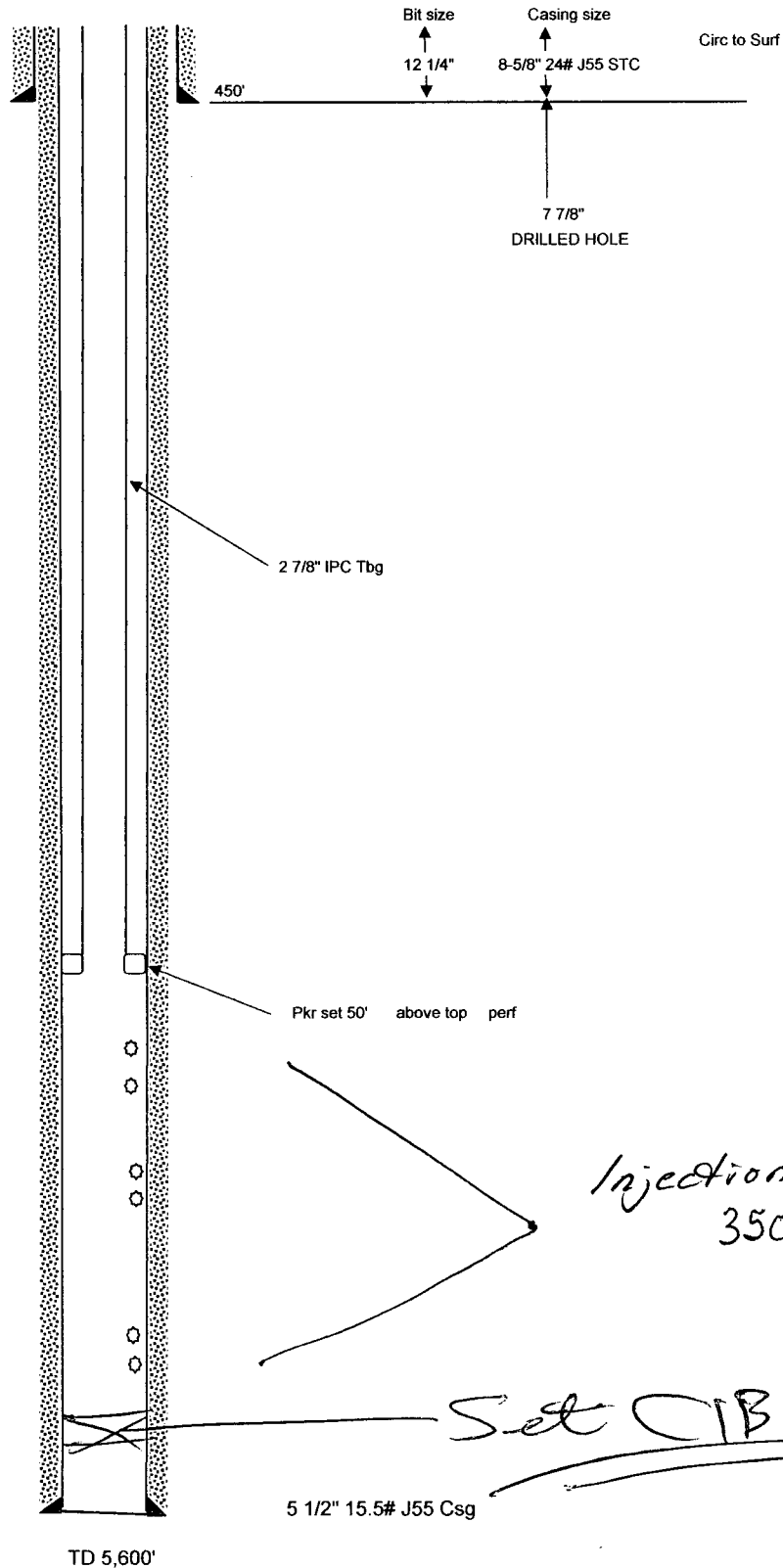

STATE OF NEW MEXICO
ENERGY AND MINERALS DEPARTMENT

NO. OF COPIES RECEIVED	
DISTRIBUTION	
SANTA FE	<input checked="" type="checkbox"/>
FILE	<input checked="" type="checkbox"/>
U.S.G.S.	
LAND OFFICE	
OPERATOR	<input checked="" type="checkbox"/>

OIL CONSERVATION DIVISION

SANTA FE, NEW MEXICO 87501

Form C-103
Revised 10-1-78

APR 28 1987

O. C. D.

5a. Indicate Type of Lease	
State <input checked="" type="checkbox"/>	Fee <input type="checkbox"/>
5. State Oil & Gas Lease No.	
V-843	

SUNDRY NOTICES AND REPORTS ON THE ARTESIAN OFFICE

(DO NOT USE THIS FORM FOR PROPOSALS TO DRILL OR TO DEEPEN OR PLUG BACK TO A DEEPER RESERVOIR. USE "APPLICATION FOR PERMIT -" (FORM C-101) FOR SUCH PROPOSALS.)

1. OIL WELL <input checked="" type="checkbox"/> GAS WELL <input type="checkbox"/> OTHER- <u>30-015-25742</u>		7. Unit Agreement Name
2. Name of Operator WILSON OPERATING CO., INC.		8. Farm or Lease Name Exxon State
3. Address of Operator P. O. Drawer 1978 - Roswell, NM 88201		9. Well No. 1
4. Location of Well UNIT LETTER <u>P</u> , <u>530</u> FEET FROM THE <u>South</u> LINE AND <u>330</u> FEET FROM THE <u>East</u> LINE, SECTION <u>2</u> TOWNSHIP <u>26S</u> RANGE <u>29</u> NMPM.		10. Field and Pool, or Wildcat Brushy Draw - Dela.
15. Elevation (Show whether DF, RT, GR, etc.) 3,040' GR		12. County Eddy

Check Appropriate Box To Indicate Nature of Notice, Report or Other Data
NOTICE OF INTENTION TO:

PERFORM REMEDIAL WORK <input type="checkbox"/>	PLUG AND ABANDON <input type="checkbox"/>
TEMPORARILY ABANDON <input type="checkbox"/>	CHANGE PLANS <input type="checkbox"/>
PULL OR ALTER CASING <input type="checkbox"/>	OTHER <input type="checkbox"/>

SUBSEQUENT REPORT OF:

REMEDIAL WORK <input type="checkbox"/>	ALTERING CASING <input type="checkbox"/>
COMMENCE DRILLING OPNS. <input type="checkbox"/>	PLUG AND ABANDONMENT <input checked="" type="checkbox"/>
CASING TEST AND CEMENT JOB <input type="checkbox"/>	OTHER <input type="checkbox"/>

17. Describe Proposed or Completed Operations (Clearly state all pertinent details, and give pertinent dates, including estimated date of starting any proposed work) SEE RULE 1103.

Set 100' plug 4,900' - 5000'
Set 100' plug 3,190' - 3,290'
Set 100' plug 2,950' - 3,050'
Set 100' plug 825' - 925'
485' - Set 50' plug in and out of 8-5/8" casing
Set 10' plug @ top w/ regulation marker

Plugged and abandoned - 5,600'
(Contract depth: 5,000', amended depth: 5,600')

Post ID-2
5-8-87
PFA

18. I hereby certify that the information above is true and complete to the best of my knowledge and belief.

SIGNED [Signature] TITLE Operator DATE 4/25/87
APPROVED BY [Signature] TITLE Geologist DATE JUN 22 1987
CONDITIONS OF APPROVAL, IF ANY:

NO. OF COPIES RECEIVED	
DISTRIBUTION	
SANTA FE	<input checked="" type="checkbox"/>
FILE	<input checked="" type="checkbox"/>
U.S.G.S.	<input checked="" type="checkbox"/>
LAND OFFICE	<input checked="" type="checkbox"/>
OPERATOR	

NEW MEXICO OIL CONSERVATION COMMISSION
WELL COMPLETION OR RECOMPLETION LOG

RECEIVED BY AND LOG
APR 28 1987
O. C. D.
ARTESIA, OFFICE

Form C-105
Revised 11-1-84

1a. Indicate Type of Lease
State ☒ Fee ☐
5. State Oil & Gas Lease No.
V-843

1b. TYPE OF WELL
OIL WELL ☒ GAS WELL ☐ DRY ☐ OTHER ☐
b. TYPE OF COMPLETION
NEW WELL ☐ WORK OVER ☐ DEEPEN ☐ PLUG BACK ☐ DIFF. REGRV. ☐ OTHER ☐ P & A

7. Unit Agreement Name
8. Form or Lease Name
Exxon State

2. Name of Operator
WILSON OPERATING CO., INC. ✓
3. Address of Operator
P. O. Drawer 1978 - Roswell, NM 88201

9. Well No.
1
10. Field and Pool, or Wildcat
Brushy Draw - Dela.

4. Location of Well
UNIT LETTER P LOCATED 530 FEET FROM THE South LINE AND 330 FEET FROM
THE East LINE OF SEC. 2 TWP. 26S RGE. 29E

11. County
Eddy

15. Date Spudded
4/1/87
16. Date T.D. Reached
4/22/87
17. Date Compl. (Ready to Prod.)
N/A
18. Elevations (DF, RKB, RT, GR, etc.)
3,040' GR
19. Elev. Casinghead
same
20. Total Depth
5,600'
21. Plug Back T.D.
N/A
22. If Multiple Compl., How Many
N/A
23. Intervals Drilled By
Rotary Tools
0-5,600'
Cable Tools

24. Producing Interval(s), of this completion - Top, Bottom, Name
N/A

25. Was Directional Survey Made
NO

26. Type Electric and Other Logs Run
Due to the bad condition of the hole, we did not attempt to run any logs.

27. Was Well Cored
NO

28. CASING RECORD (Report all strings set in well)					
CASING SIZE	WEIGHT LB./FT.	DEPTH SET	HOLE SIZE	CEMENTING RECORD	AMOUNT PULLED
8-5/8"	24#	450'	12-1/4"	350 sx circ.	None

29. LINER RECORD				30. TUBING RECORD		
SIZE	TOP	BOTTOM	SACKS CEMENT	SIZE	DEPTH SET	PACKER SET
	N/A					

31. Perforation Record (Interval, size and number)		32. ACID, SHOT, FRACTURE, CEMENT SQUEEZE, ETC.	
		DEPTH INTERVAL	AMOUNT AND KIND MATERIAL USED
			N/A

33. PRODUCTION
Date First Production
Production Method (Flowing, gas lift, pumping - Size and type pump)
N/A
Well Status (Prod. or Shut-in)
Date of Test
Hours Tested
Choke Size
Pressure Test Period
Oil - BBL.
Gas - MCF
Water - BBL.
Gas - Oil Ratio
Flow Tubing Press.
Casing Pressure
Calculated 24-Hour Rate
Oil - BBL.
Gas - MCF
Water - BBL.
Oil Gravity - API (Corr.)

34. Disposition of Gas (Sold, used for fuel, vented, etc.)
Test Witnessed By

35. List of Attachments

36. I hereby certify that the information shown on both sides of this form is true and complete to the best of my knowledge and belief.
SIGNED Max M. Wilson TITLE Operator DATE 4/27/87

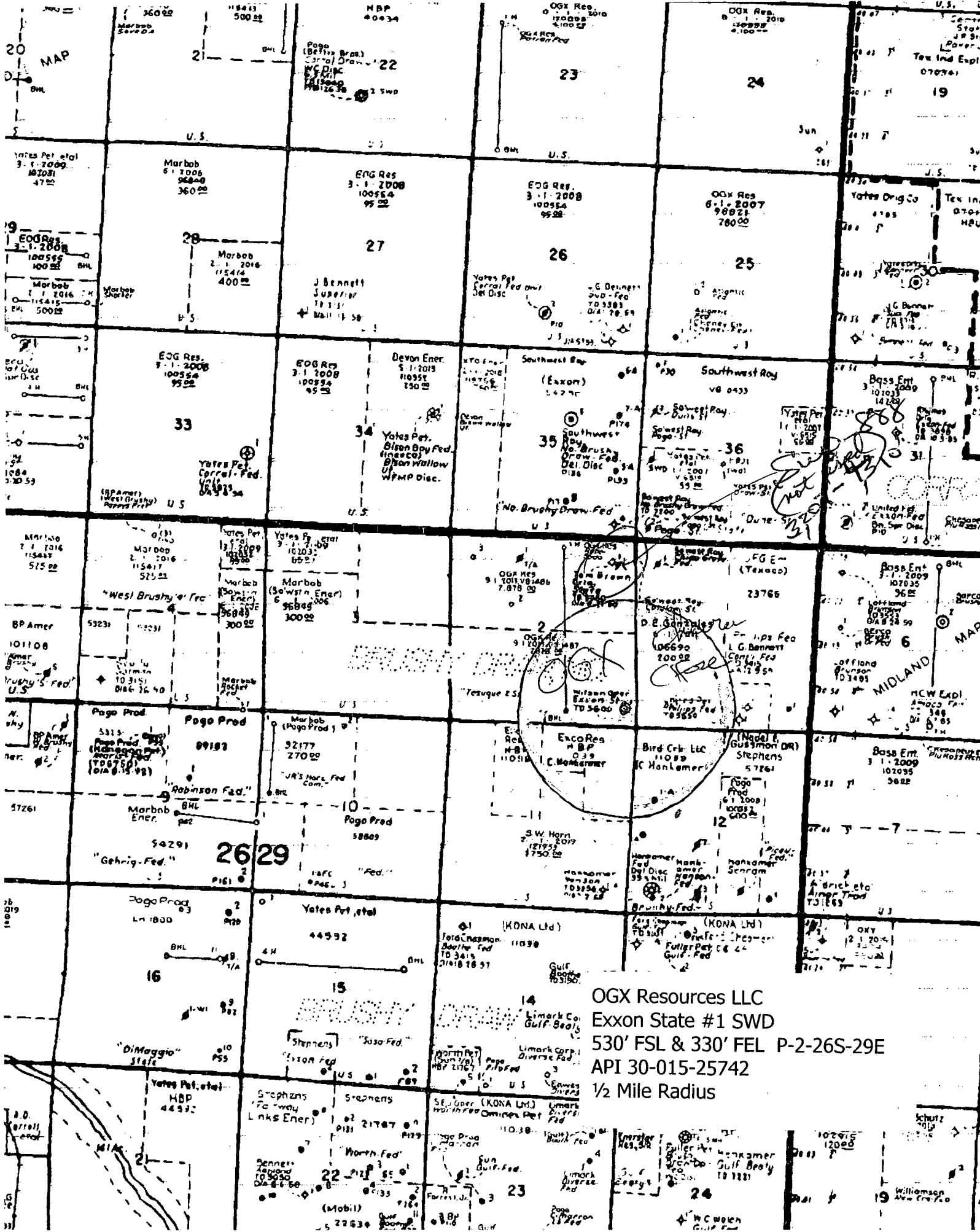

OGX Resources LLC
 Exxon State #1 SWD
 530' FSL & 330' FEL P-2-26S-29E
 API 30-015-25742
 1/2 Mile Radius

OGX Exxon State Well #1 API 30-015-25742 Radius

[illegible]

February 1950

Title

Continental

~~The summary on this page is for the condition of the well at above date.~~

Commenced drilling December 2, 1959 Finished drilling December 9, 1959

OIL OR GAS SANDS OR ZONES

(Denote gas by G)

No. 1, from None to _____ No. 4, from _____ to _____

No. 2, from _____ to _____ No. 5, from _____ to _____

No. 3, from _____ to _____ No. 6, from _____ to _____

IMPORTANT WATER SANDS

No. 1, from None to _____ No. 3, from _____ to _____

No. 2, from _____ to _____ No. 4, from _____ to _____

CASING RECORD

Size casing	Weight per foot	Threads per inch	Make	Amount	Kind of shoe	Cut and pulled from	Perforated		Purpose
							From—	To—	
8 5/16	127 lbs or more	8-14	Union	200' or less	Tapered Puller	from "down position" and leaning back against shoe	and leaning back against shoe	of binding or pulling "down" and upward	
It is of the greatest importance to have a complete history of the well.									
HISTORY OF OIL OR GAS WELL									
							18-43764-3	" - COLLEGEWICK MINING OFFICE	

MUDDING AND CEMENTING RECORD

[illegible]

PLUGS AND ADAPTERS

Heaving plug—Material None Length _____ Depth set _____

Adapters—Material	Size
-------------------	------

SHOOTING RECORD

Size	Shell used	Explosive used	Quantity	Date	Depth shot	Depth cleaned out
	None					

TOOLS USED

Rotary tools were used from Surface feet to 3413 feet, and from _____ feet to _____ feet

Cable tools were used from _____ feet to _____ feet, and from _____ feet to _____ feet.

! DATES

Put to producing dry hole, 19

The production for the first 24 hours was ----- barrels of fluid of which ----- % was oil; ----- % emulsion; ----- % water; and ----- % sediment. Gravity, °Bé. -----

If gas well, cu. ft. per 24 hours _____ Gallons gasoline per 1,000 cu. ft. of gas _____

Rock pressure, lbs. per sq. in. -----

EMPLOYEES

Joe Roper Driller George Hinson Driller

L. Hinson, Driller

FORMATION RECORD

FROM—	TO—	TOTAL FEET	FORMATION
Surface 55'	55' 255'		Salado anhydrite, dolomite, limestone, shale Limestone and anhydrite

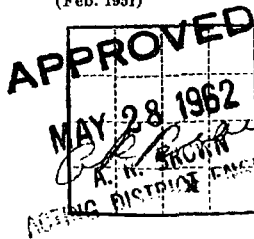

(SUBMIT IN TRIPLICATE)

UNITED STATES
DEPARTMENT OF THE INTERIOR
GEOLOGICAL SURVEY

Budget Bureau No. 42-R358.4.
Form Approved.

Land Office **LC**

Lease No. **071066-A**

Unit **RECEIVED**

MAY 29 1962

SUNDRY NOTICES AND REPORTS ON WELLS. C. C.
ARTESIA, OFFICE

NOTICE OF INTENTION TO DRILL.....	SUBSEQUENT REPORT OF WATER SHUT-OFF.....	
NOTICE OF INTENTION TO CHANGE PLANS.....	SUBSEQUENT REPORT OF SHOOTING OR ACIDIZING.....	
NOTICE OF INTENTION TO TEST WATER SHUT-OFF.....	SUBSEQUENT REPORT OF ALTERING CASING.....	
NOTICE OF INTENTION TO RE-DRILL OR REPAIR WELL.....	SUBSEQUENT REPORT OF RE-DRILLING OR REPAIR.....	
NOTICE OF INTENTION TO SHOOT OR ACIDIZE.....	SUBSEQUENT REPORT OF ABANDONMENT.....	X
NOTICE OF INTENTION TO PULL OR ALTER CASING.....	SUPPLEMENTARY WELL HISTORY.....	
NOTICE OF INTENTION TO ABANDON WELL.....		

(INDICATE ABOVE BY CHECK MARK NATURE OF REPORT, NOTICE, OR OTHER DATA)

30-01S- ~~20132~~
03723

May 23, 1962

Well No. **#1 Cont-Fed** is located **660** ft. from **S** line and **1980** ft. from **E** line of sec. **1**

SE Sec. 1	26S	29E	
(1/4 Sec. and Sec. No.)	(Twp.)	(Range)	(Meridian)
W.C.	Eddy	New Mexico	
(Field)	(County or Subdivision)	(State or Territory)	

The elevation of the derrick floor above sea level is **3023** ft.

DETAILS OF WORK

(State names of and expected depths to objective sands; show sizes, weights, and lengths of proposed casings; indicate mudding jobs, cementing points, and all other important proposed work)

Cemented 266' 8-5/8" Surface Casing with 75 sacks of cement circulated, T.D. 3303'. 25 sacks cement T.D., 25 sacks cement base of salt 3070'. 20 sacks cement top of salt 2550' - 10 sacks cement at base of surface casing set at 266' - 10 sacks cement at surface. Well bore filled with mud-laden fluid.

Set marker and cleaned location

RECEIVED

MAY 25 1962

U. S. GEOLOGICAL SURVEY

I understand that this plan of work must receive approval in writing by the Geological Survey before operations may be commenced.

Company **J. Glen Bennett Estate**

Address **P. O. Box 4667**
Midland, Texas

By
Title **Attorney-in-Fact**

WELLBORE SCHEMATIC

Well Name & No.: J. Glen Bennett Estate - Continental-Federal #1
Field: W.C.
Location: 660' FSL & 1980' FEL, Sec 1, T26S, R29E
County: Eddy State: NM API #: 30 015 03723
GR Elev: 3023.0 Spud Date: 12/02/59
KB: _____ Compl. Date: 12/9/59 Dry Hole
KB Elev: _____ P & A Date: 05/23/62

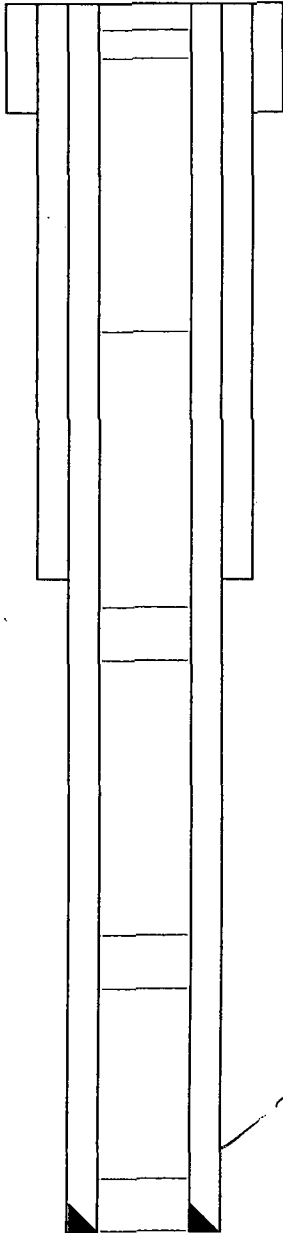

8 5/8" 24# csg
Set @ 266'

WELL HISTORY

12/2/59: Spud

Dry Hole

5/23/62: P&A

Plug #1 - 25 sx cmt TD 3303'

Plug #2 - 25 sx cmt base of salt 3070'

Plug #3 - 20 sx cmt top of salt 2550'

Plug #4 - 10 sx cmt @ base of surf csg set @ 266'

Cemented 266' w/75 sx cmt circulated

Plug #5 - 10 sx cmt @ surface

Wellbore filled with mud-laden fluid.

*All info per Sundries on OCD web site

no casing

Shallow

TD: 3,303', PBTD:

UNITED STATES
DEPARTMENT OF THE INTERIOR
GEOLOGICAL SURVEY

Nov 5 11 41 AM '87

SUNDRY NOTICES AND REPORTS ON WELLS

(Do not use this form for proposals to drill or to deepen or plug back into different reservoir. Use Form 9-331-C for such proposals.)

1. oil ☒ well gas ☐ well other ☐

2. NAME OF OPERATOR

United Petroleum Corporation

3. ADDRESS OF OPERATOR

P. O. Box 387 Pleasanton, Tx. 78064

4. LOCATION OF WELL (REPORT LOCATION CLEARLY. See space 17 below.)

AT SURFACE:

AT TOP PROD. INTERVAL:

AT TOTAL DEPTH:

16. CHECK APPROPRIATE BOX TO INDICATE NATURE OF NOTICE, REPORT, OR OTHER DATA

REQUEST FOR APPROVAL TO:

TEST WATER SHUT-OFF ☐

FRACTURE TREAT ☐

SHOOT OR ACIDIZE ☐

REPAIR WELL ☐

PULL OR ALTER CASING ☐

MULTIPLE COMPLETE ☐

CHANGE ZONES ☐

ABANDON* ☐

(other) ☐

SUBSEQUENT REPORT OF:

☐

☐

☐

☐

☐

☐

☐

☒

☐

5. LEASE

NM 23765

6. IF INDIAN, ALLOTTEE OR TRIBE NAME

7. UNIT AGREEMENT NAME

8. FARM OR LEASE NAME

Phillips Federal

9. WELL NO.

10. FIELD OR WILDCAT NAME

UNL BRUSHY DRAW DELAWARE

11. SEC., T., R., M., OR BLK. AND SURVEY OR AREA

51-T265-R29E

12. COUNTY OR PARISH

EDDY

13. STATE

NM

14. API NO.

30-015-25530

15. ELEVATIONS (SHOW DF, KDB, AND WD)

(NOTE: Report results of multiple completion or zone change on Form 9-330.)

17. DESCRIBE PROPOSED OR COMPLETED OPERATIONS (Clearly state all pertinent details, and give pertinent dates, including estimated date of starting any proposed work. If well is directionally drilled, give subsurface locations and measured and true vertical depths for all markers and zones pertinent to this work.)*

1. Move in and rig up. Pull rods and lay down.
2. Pull tubing out of hole.
3. Rig up wireline and run in hole and set 5½" CIBP @ 3280' with 35' of cement on top.
4. Run tubing and load hole with mud.
5. Free point 5½" casing and cut @ 3023'. Pull and lay down.
6. Run tubing in hole to 3200' and spotted 40 sks. of cement. Wait on cement and tagged plug low; spotted 25 sks. of cement to bring it up.
7. Pulled up to 400' and spotted 35 sks. of cement.
8. Spotted 15 sks. top hole plug and set up P & A marker.

Subsurface Safety Valve: Manu. and Type _____ Set @ _____ Ft.

18. I hereby certify that the foregoing is true and correct

SIGNED [Signature] Baber Well Service P & A Supv. 10-28-87
TITLE _____ DATE _____

(This space for Federal or State office use)

APPROVED BY _____ TITLE _____ DATE _____
CONDITIONS OF APPROVAL, IF ANY: _____

ACCEPTED FOR RECORD

NOV 13 1987

SJS

CARLSBAD, NEW MEXICO

*See Instructions on Reverse Side

UNITED STATES
DEPARTMENT OF THE INTERIOR
BUREAU OF LAND MANAGEMENT

NOV 06 '87
O. C. D.
ARTESIA OFFICE

Form approved
Budget Bureau of Land Management
Expires August 1, 1985
NM-23765

SUNDRY NOTICES AND REPORTS ON WELL RECEIVED

(Do not use this form for proposals or drill to be developed; plug back or a different completion.
Use "APPLICATION FOR PERMIT" for such proposals.)

1. OIL WELL ☒ GAS WELL ☐ OTHER ☐
2. NAME OF OPERATOR
United Petroleum Corporation
3. ADDRESS OF OPERATOR
P.O. Box 2951, Roswell, NM 88201
4. LOCATION OF WELL (Report location clearly and in accordance with any State requirements.
See also space 17 below.)
At surface
FSL & FEL
14. PERMIT NO.
3011' GR
15. ELEVATION (Show whether L.F., H., GR, etc.)

7. UNIT AGREEMENT NAME
8. FARM OR LEASE NAME
Phillips Federal
9. WELL NO.
1
10. FIELD AND POOL OR FIELD AT
Brushy Draw - Delaware
11. SEC., T., R., M., OR B.L. AND
SULVEY OR AREA
Sec. 1, T26S, R29E
12. COUNTY OR PARISH
Eddy NM

16. Check Appropriate Box To Indicate Nature of Notice, Report, or Other Data

NOTICE OF INTENTION TO

COMPLETION REPORT OF

TEST WATER SHUT-OFF
FRAC FIVE TREAT
SHOOT OR ACIDIZE
REPAIR WELL
TOILET

PLUG BACK OR SQUEEZE
MATERIAL COMPLETION
ABANDONMENT
CHANGING LOGS

PLUG BACK & SQUEEZE
X
X

REPAIRING WELL
ALTERING LOGS
RECONSTRUCTION

17. DESCRIBE PROPOSED OR COMPLETED OPERATIONS (Include well logs, completion logs, and other pertinent data including estimated shut-in pressure, any proposed work. If well is directionally drilled, give azimuths, borehole inclination and true vertical depths for all marked and given points relevant to this work.)

- 3/28/86 Set C.I.B.P. @ 5000'
Dump 20' of cmt. on top of C.I.B.P.
Perf. @ 4000' w/4 holes
Squeeze 5 1/2" csg. w/280 sks.
Class "C" 2% C.C. 1/4" BBL flowcheck
5 #BBL salt
- 3/29/86 Perf. F/3315' to 3357' - 17 holes
Frac w/35,000 #20/40 sand & 18,000 #12/20 sand
w/40,000 gal. gelled 2% KCl fluid
- 4/1/86 Put on pump

ACCEPTED FOR RECORD

SJS

AD, NEW MEXICO

18. I hereby certify that foregoing is true and correct

SIGNED *L. H. Linscott*

TITLE Operations Manager

DATE 10/12/87

(This space for Federal or State office use)

APPROVED BY
CONDITIONS OF APPROVAL, IF ANY:

TITLE

DATE

*See Instructions on Reverse Side

UNITED STATES
DEPARTMENT OF THE INTERIOR
BUREAU OF LAND MANAGEMENT

Form approved.
Budget Bureau No. 1004-0135
Expires August 31, 1985

415F

SUNDRY NOTICES AND REPORTS ON WELLS

(Do not use this form for proposals to drill or to deepen or plug back to a different reservoir.
Use "APPLICATION FOR PERMIT—" for such proposals.)

1. OIL WELL <input type="checkbox"/> GAS WELL <input type="checkbox"/> OTHER <u>Drilling Well</u>		7. UNIT AGREEMENT NAME	
2. NAME OF OPERATOR <u>United Petroleum Corporation</u>		8. FARM OR LEASE NAME <u>Phillips Federal</u>	
3. ADDRESS OF OPERATOR <u>P.O. Box 2951, Roswell, New Mexico 88201</u>		9. WELL NO. <u>1</u>	
4. LOCATION OF WELL (Report location clearly and in accordance with any State requirements.* See also space 17 below.) At surface <u>330' FSL & 2063' FEL</u>		10. FIELD AND POOL, OR WILDCAT <u>Brushy Draw-Delaware</u>	
14. PERMIT NO.		15. ELEVATIONS (Show whether DF, RT, GR, etc.) <u>3011' GR</u>	
		12. COUNTY OR PARISH <u>Eddy</u>	
		13. STATE <u>N.M.</u>	

16. Check Appropriate Box To Indicate Nature of Notice, Report, or Other Data

NOTICE OF INTENTION TO:		SUBSEQUENT REPORT OF:	
TEST WATER SHUT-OFF <input type="checkbox"/>	PULL OR ALTER CASING <input type="checkbox"/>	WATER SHUT-OFF <input type="checkbox"/>	REPAIRING WELL <input type="checkbox"/>
FRACTURE TREAT <input type="checkbox"/>	MULTIPLE COMPLETE <input type="checkbox"/>	FRACTURE TREATMENT <input type="checkbox"/>	ALTERING CASING <input type="checkbox"/>
SHOOT OR ACIDIZE <input type="checkbox"/>	ABANDON* <input type="checkbox"/>	SHOOTING OR ACIDIZING <input type="checkbox"/>	ABANDONMENT* <input type="checkbox"/>
REPAIR WELL <input type="checkbox"/>	CHANGE PLANS <input type="checkbox"/>	(Other) <u>Production Casing & Cement</u>	<input checked="" type="checkbox"/>
(Other) <input type="checkbox"/>			

17. DESCRIBE PROPOSED OR COMPLETED OPERATIONS (Clearly state all pertinent details, and give pertinent dates, including estimated date of starting any proposed work. If well is directionally drilled, give subsurface locations and measured and true vertical depths for all markers and zones pertinent to this work.)*

1/22/86 Total Depth 5650'

Ran 5 1/2", 17.0#, J-55, ST&C casing and set at 5650'. Cemented with 825 sx 50-50 Poz-mix, Class 'C', 6# salt/sk. P.O.B. 8:28 A.M. 1/23/86.

ACCEPTED FOR RECORD

Sub
JAN 30 1986

CARLSBAD, NEW MEXICO

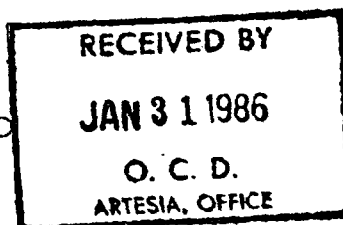

18. I hereby certify that the foregoing is true and correct

SIGNED <u>Jerry W. Franklin</u>	TITLE <u>Agent</u>	DATE <u>1/28/86</u>
(This space for Federal or State office use)		
APPROVED BY _____	TITLE _____	DATE _____
CONDITIONS OF APPROVAL, IF ANY:		

*See Instructions on Reverse Side

UNITED STATES
DEPARTMENT OF THE INTERIOR
BUREAU OF LAND MANAGEMENT
SUNDRY NOTICES AND REPORTS ON WELLS

SUBMIT IN TRI
(Other, instructio
DATE*
ON re

Form approved.
Budget Bureau No. 1004-0135
Expires August 31, 1985

45F

(Do not use this form for proposals to drill or to deepen or plug back to a different reservoir.
Use "APPLICATION FOR PERMIT—" for such proposals.)

5. LEASE DESIGNATION AND SERIAL NO.

NM-23765

6. IF INDIAN, ALLOTTEE OR TRIBE NAME

7. UNIT AGREEMENT NAME

8. FARM OR LEASE NAME

Phillips Federal

9. WELL NO.

1

10. FIELD AND POOL, OR WILDCAT

Brushy Draw-Delaware

11. SEC., T., R., M., OR B.L.K. AND
SURVEY OR AREA

Sec. 1, T26S, R29E

12. COUNTY OR PARISH

Eddy

13. STATE
N.M.

OIL WELL ☐ GAS WELL ☐ OTHER ☒ Drilling Well

2. NAME OF OPERATOR

United Petroleum Corporation

3. ADDRESS OF OPERATOR

P.O. Box 2951, Roswell, New Mexico 88201

4. LOCATION OF WELL (Report location clearly and in accordance with any State requirements.
See also space 17 below.)
At surface

330' FSL & 2063' FEL

14. PERMIT NO.

15. ELEVATIONS (Show whether DF, RT, GR, etc.)

3011' GR

16. Check Appropriate Box To Indicate Nature of Notice, Report, or Other Data

NOTICE OF INTENTION TO:

TEST WATER SHUT-OFF

FRACTURE TREAT

SHOOT OR ACIDIZE

REPAIR WELL

(Other)

PULL OR ALTER CASING

MULTIPLE COMPLETE

ABANDON*

CHANGE PLANS

SUBSEQUENT REPORT OF:

WATER SHUT-OFF

FRACTURE TREATMENT

SHOOTING OR ACIDIZING

(Other) 8 5/8" Casing and Cement

REPAIRING WELL

ALTERING CASING

ABANDONMENT*

(NOTE: Report results of multiple completion on Well
Completion or Recompletion Report and Log form.)

17. DESCRIBE PROPOSED OR COMPLETED OPERATIONS (Clearly state all pertinent details, and give pertinent dates, including estimated date of starting any proposed work. If well is directionally drilled, give subsurface locations and measured and true vertical depths for all markers and zones pertinent to this work.)*

1/13/86 Total Depth 3155'.

Ran 3155' 8 5/8", 24 and 32#, K-55, ST&C casing and set at 3155'.

Cemented with 800 sx Hal-lite, 10# salt/sk followed by 200 sx Class 'C'
2% CaCl. Circulated 30 sx to surface. P.O.B. at 6:00 P.M. W.O.C. 18
hours. Pressure tested B.O.P. and 8 5/8" casing to 800 psi for 30 minutes.

ACCEPTED FOR RECORD

Handwritten signature
JAN 21 1986

CARLSBAD, NEW MEXICO

18. I hereby certify that the foregoing is true and correct

SIGNED

Handwritten signature: Jerry W. Franklin

TITLE

Agent

DATE

1/20/86

(This space for Federal or State office use)

APPROVED BY

TITLE

DATE

CONDITIONS OF APPROVAL, IF ANY:

*See Instructions on Reverse Side

UNITED STATES
DEPARTMENT OF THE INTERIOR
BUREAU OF LAND MANAGEMENT
NEW MEXICO OIL AND GAS COMMISSION

SUBMIT IN TRIPLICATE
(Other instruction on reverse side)

Form approved.
Budget Bureau No. 1004-0135
Expires August 31, 1985

45P

SUNDRY NOTICES AND REPORTS ON WELLS

(Do not use this form for proposals to drill or to deepen or plug back to a different reservoir.
Use "APPLICATION FOR PERMIT—" for such proposals.)

OIL WELL ☐ GAS WELL ☐ OTHER ☒ Drilling Well

2. NAME OF OPERATOR

United Petroleum Corporation

3. ADDRESS OF OPERATOR

P.O. Box 2951, Roswell, New Mexico 88201

4. LOCATION OF WELL (Report location clearly and in accordance with any State requirements.
See also space 17 below.)
At surface

330' FSL & 2063' FEL

RECEIVED BY

JAN 24 1986

O. C. D.
ARTESIA, OFFICE

5. LEASE DESIGNATION AND SERIAL NO.

NM-23765

6. IF INDIAN, ALLOTTEE OR TRIBE NAME

7. JOINT AGREEMENT NAME

8. NAME OF LEASE NAME

Phillips Federal

9. WELL NO.

1

10. FIELD AND POOL, OR WILDCAT

Brushy Draw-Delaware

11. SEC., T., R., M., OR BLK. AND SURVEY OR AREA

Sec. 1, T26S, R29E

12. COUNTY OR PARISH

Eddy

13. STATE

N.M.

14. PERMIT NO.

15. ELEVATIONS (Show whether DF, BT, GR, etc.)

3011' GR

16. Check Appropriate Box To Indicate Nature of Notice, Report, or Other Data

NOTICE OF INTENTION TO:

TEST WATER SHUT-OFF

FRACTURE TREAT

SHOOT OR ACIDIZE

REPAIR WELL

(Other)

PULL OR ALTER CASING

MULTIPLE COMPLETION

ABANDON*

CHANGE PLANS

SUBSEQUENT REPORT OF:

WATER SHUT-OFF

FRACTURE TREATMENT

SHOOTING OR ACIDIZING

(Other) Casing and Cement

(Note: Report results of multiple completion on Well Completion or Recompletion Report and Log form.)

REPAIRING WELL

ALTERING CASING

ABANDONMENT*

X

17. DESCRIBE PROPOSED OR COMPLETED OPERATIONS (Clearly state all pertinent details, and give pertinent dates, including estimated date of starting any proposed work. If well is directionally drilled, give subsurface locations and measured and true vertical depths for all markers and zones pertinent to this work.)

1/06/86 Spud 17 1/2" hole at 6:00 P.M.

1/07/86 Total Depth 400'. Ran 400' 13 3/8", 54.5#, J-55, ST&C casing and set at 400'.

Cemented with 375 sx Class 'C', 2% CaCl. Circulated 20 sx cement to surface. P.O.B. at 9:00 P.M. W.O.C. 19 hours. Pressure tested 13 3/8" casing 1000 psi for 30 minutes.

ACQUIRED FOR RECORD

JAN 21 1986

CARISBAD, NEW MEXICO

18. I hereby certify that the foregoing is true and correct

SIGNED

Terry W. Franklin

TITLE

Agent

DATE

1/20/86

(This space for Federal or State office use)

APPROVED BY

TITLE

DATE

CONDITIONS OF APPROVAL, IF ANY:

*See Instructions on Reverse Side

WELLBORE SCHEMATIC

Well Name & No.: United Petroleum, Phillips Federal #1
 Field: Und Bushy Draw Delaware
 Location: 3300 FSL & 2065 FEL, Sec 1, T26S, R29E
 County: Eddy State: NM API #: 30 015 25530
 GR Elev: _____ Spud Date: 4-6-86
 KB: _____ Compl. Date: 4-1-86
 KB Elev: _____ P & A Date: 10/28/87

WELL HISTORY

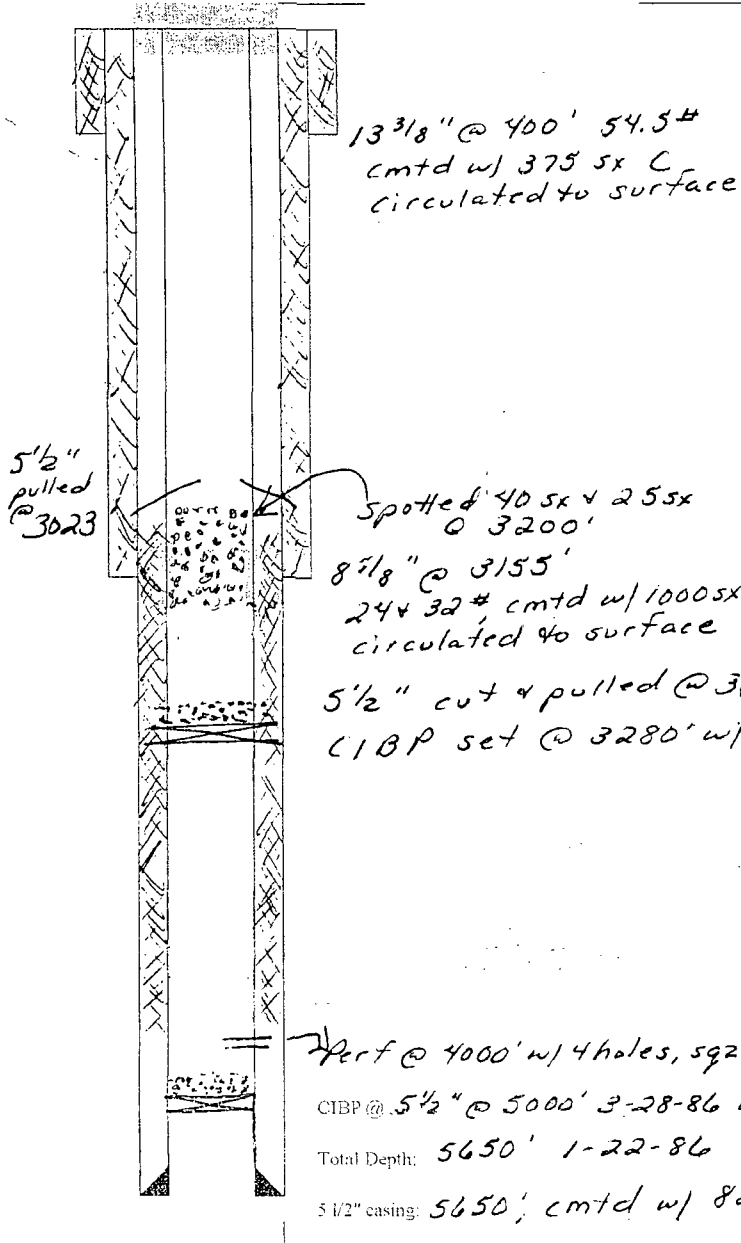

Well P&A Baber Well Service 10-28-87

Set 5 1/2" CIBP @ 3280' w/ 35' cement
 Free Point 5 1/2" cut @ 3023', pulled
 Spotted 40 sx 3200', WOC. additional 25 sx
 Spotted 35 sx @ 400'
 Spotted 15 sx top plug
 Set dry hole marker

UNITED STATES
DEPARTMENT OF THE INTERIOR
BUREAU OF LAND MANAGEMENT

SUBMIT IN DUPLICATE

(See other instructions on reverse side)

Form approved.
Budget Bureau No. 1004-0137
Expires August 31, 1985

158

WELL COMPLETION OR RECOMPLETION REPORT AND LOG

1a. TYPE OF WELL: OIL WELL ☒ GAS WELL ☐ DRY ☐ Other ☐

b. TYPE OF COMPLETION:

NEW WELL ☒ WORK OVER ☐ DEEP EN ☐ PLUG BACK ☐ REPAIR ☐ Other ☐

2. NAME OF OPERATOR

The Petroleum Corporation of Delaware

3. ADDRESS OF OPERATOR

3131 Turtle Creek Blvd., Suite 400, Dallas, TX 75219-3415

4. LOCATION OF WELL (Report location clearly and in accordance with any State requirements)

At surface 630' FWL & 2,021' FNL, Unit Letter E, SW 1/4 of NW/4

At top prod. interval reported below

At total depth

14. PERMIT NO.

O. C. D.
ARTESIA OFFICE

5. LEASE DESIGNATION AND SERIAL NO.

NM-11039

6. IF INDIAN, ALLOTTEE OR TRIBE NAME

7. UNIT AGREEMENT NAME

8. FARM OR LEASE NAME

Brushy 12-A Federal

9. WELL NO.

1

10. FIELD AND POOL, OR WILDCAT

Brushy Draw Delaware

11. SEC., T., R., M., OR BLOCK AND SURVEY OR AREA

Sec. 12, T-26S, R-29E

12. COUNTY OR PARISH
Eddy

13. STATE
NM

15. DATE SPUDDED

6/14/87

16. DATE T.D. REACHED

7/5/87

17. DATE COMPL. (Ready to prod.)

7/18/87

18. ELEVATIONS (DY, RKB, RT, OR, ETC.)*

2,978.5' GR

19. ELEV. CASINGHEAD

2980.0' GR

20. TOTAL DEPTH, MD & TVD

3,482'

21. PLUG BACK T.D., MD & TVD

3,468'

22. IF MISTAKEN COMPL. BY

HPM, MARY

23. INTERVALS DRILLED BY

XX

ROTARY TOOLS

CABLE TOOLS

24. PRODUCING INTERVAL(S) OF THIS COMPLETION—TOP, BOTTOM, NAME (MD AND TVD)*

3,238 - 3,244 Ramsey Sand

25. WAS DIRECTIONAL SURVEY MADE

No

26. TYPE ELECTRIC AND OTHER LOGS RUN

CBL, Litho Density

27. WAS WELL CORED

No

28.

CASING RECORD (Report all strings set in well)

CASING SIZE	WEIGHT, LB./FT.	DEPTH SET (MD)	HOLE SIZE	CEMENTING RECORD	AMOUNT PULLED
8-5/8	24	710'	11'	280 sx C, circ 70 sx	None
4-1/2	10.5/11.6	3,480'	7-5/8"	150 sx Pacesetter - Light & 225 sx Western Expanding	None

29.

LINER RECORD

SIZE	TOP (MD)	BOTTOM (MD)	SACKS CEMENT*	SCREEN (MD)
None				

30. TUBING RECORD

SIZE	DEPTH SET (MD)	PACKER SET (MD)
2-3/8	3,288	None

31. PERFORATION RECORD (Interval, size and number)

3238 - 3244, 4 spf (25 holes)
Schlumberger 3-3/8" ultrajet

32. ACID, SHOT, FRACTURE, CEMENT SQUEEZE, ETC.

DEPTH INTERVAL (MD)	AMOUNT AND KIND OF MATERIAL USED
3,238 - 3,244	10,000 gal gelled diesel with 9,000 lb. 20/40 sand and 5,000 lb. 12/20 sand

33.*

PRODUCTION

DATE FIRST PRODUCTION		PRODUCTION METHOD (Flowing, gas lift, pumping—size and type of pump)				WELL STATUS (Producing or shut-in)	
7/29/97		Pumping - 2" X 1-1/2" X 18' insert				Producing	
DATE OF TEST	HOURS TESTED	CHOKE SIZE	PROD'N. FOR TEST PERIOD	OIL—BBL.	GAS—MCF.	WATER—BBL.	GAS-OIL RATIO
7/30/87	24	Open	→	30	15	180	500 scf/bbl
FLOW. TUBING PRESS.	CASING PRESSURE	CALCULATED 24-HOUR RATE	OIL—BBL.	GAS—MCF.	WATER—BBL.	OIL GRAVITY-API (CORR.)	
85	85	→	30	15	180	41	

34. DISPOSITION OF GAS (Sold, used for fuel, vented, etc.)

Sold

TEST WITNESSED BY

Dan Wright

35. LIST OF ATTACHMENTS

Deviation survey, cement bond & density logs, sundry notices (2)

36. I hereby certify that the foregoing and attached information is complete and correct as determined from all available records

SIGNED

Ralph P. White

TITLE

Petroleum Engineer

DATE

8/3/87

*(See Instructions and Spaces for Additional Data on Reverse Side)



Workover Proposal
BRUSHY 12-A FEDERAL 1

wellbore submitted to OCO
8-5-09

Field: BRUSHY DRAW DELAWARE
County: EDDY
State: NEW MEXICO
Location: SEC 12, 26S-29E, 2021 FNL & 630 FWL
Elevation: GL 2,978.50 KB 2,984.50
KB Height: 6.00

Spud Date: 6/14/1987
Initial Compl. Date:
API #: 3001525615
CHK Property #: 891208
1st Prod Date: 7/31/1987
PBTD: Lateral 1 - 3468.0
TD: 3,500.0

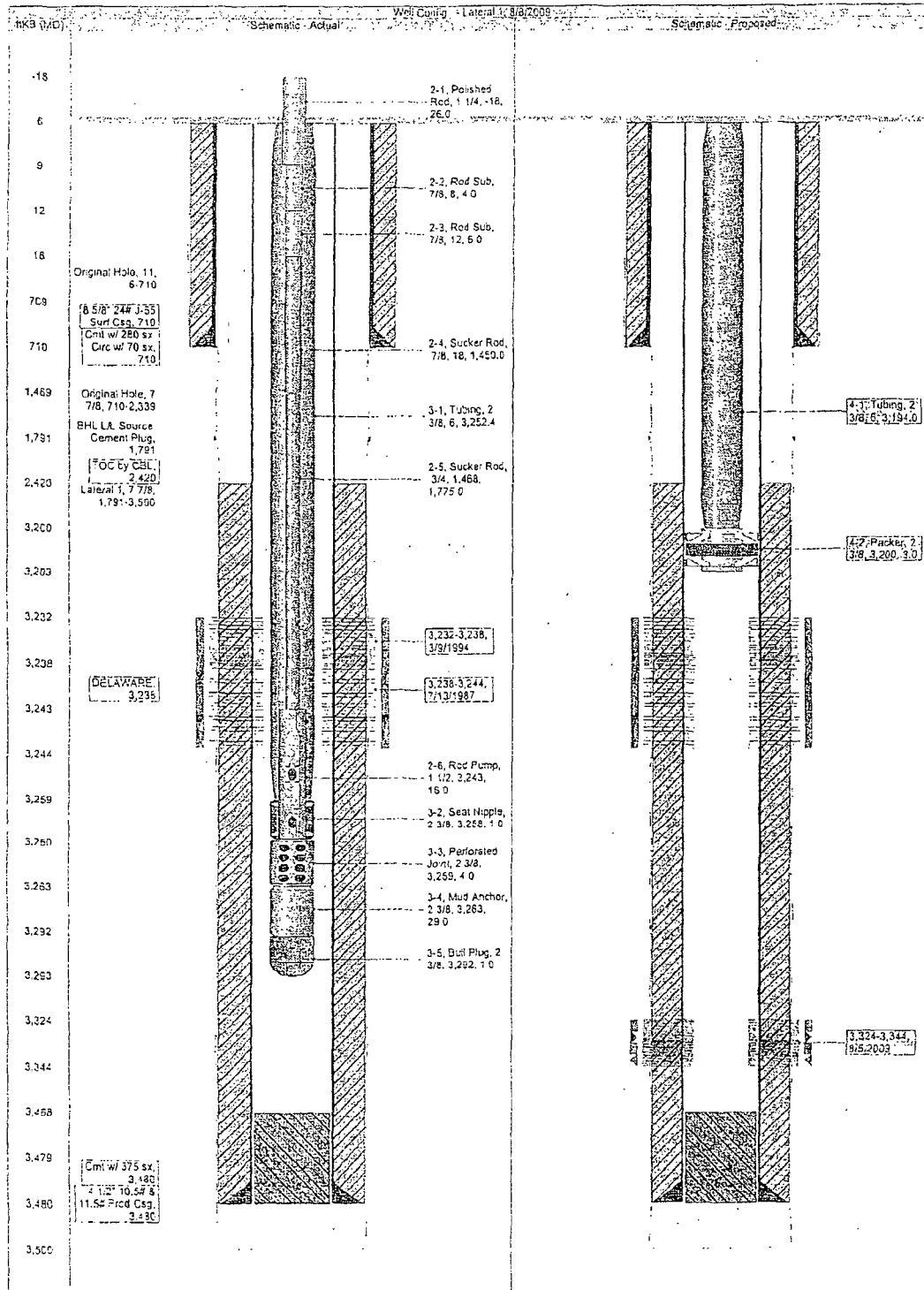

DISTRICT I
1625 N. FRENCH DR., HOBBS, NM 88240

DISTRICT II
1301 W. GRAND AVENUE, ARTESIA, NM 88210

DISTRICT III
1000 Rio Brazos Rd., Aztec, NM 87410

DISTRICT IV
1220 S. ST. FRANCIS DR., SANTA FE, NM 87505

State of New Mexico
Energy, Minerals and Natural Resources Department

OIL CONSERVATION DIVISION
1220 SOUTH ST. FRANCIS DR.
Santa Fe, New Mexico 87505

Form C-102
Revised October 12, 2005
Submit to Appropriate District Office
State Lease - 4 Copies
Fee Lease - 3 Copies

WELL LOCATION AND ACREAGE DEDICATION PLAT

☐ AMENDED REPORT

API Number 30-015-36774	Pool Code 8085	Pool Name BRUSHY DRAW DELAWARE-NORTH
Property Code 37487	Property Name REPOSADO "2" STATE	Well Number 1H
OGRID No. 217955	Operator Name OGX RESOURCES	Elevation 3012'

Surface Location

UL or lot No.	Section	Township	Range	Lot Idn	Feet from the	North/South line	Feet from the	East/West line	County
B	2	26-S	29-E		330	NORTH	1980	EAST	EDDY

Bottom Hole Location If Different From Surface

UL or lot No.	Section	Township	Range	Lot Idn	Feet from the	North/South line	Feet from the	East/West line	County
0	2	26-S	29-E		350	SOUTH	1980	EAST	EDDY

Dedicated Acres 160	Joint or Infill	Consolidation Code	Order No.
------------------------	-----------------	--------------------	-----------

NO ALLOWABLE WILL BE ASSIGNED TO THIS COMPLETION UNTIL ALL INTERESTS HAVE BEEN CONSOLIDATED
OR A NON-STANDARD UNIT HAS BEEN APPROVED BY THE DIVISION

<p>PROJECT AREA →</p> <p>V-6825 → PRODUCING AREA</p> <p>V-6825</p> <p>GRID AZ. = 176°35'27"</p> <p>HORZ. DIST. = 4716.3'</p> <p>GEODETIC COORDINATES NAD 27 NME</p> <p>Y=392286.6 N X=618016.1 E</p> <p>LAT.=32.077939° N LONG.=103.952308° W</p> <p>BOTTOM HOLE LOCATION Y=387579.7 N X=618296.3 E</p>	<p>POINT OF ENTRY 543' FNL & 1980' FEL</p> <p>1980'</p> <p>330'</p> <p>S.L.</p> <p>1980'</p> <p>350'</p> <p>B.H.</p> <p>40R well</p>	<p>OPERATOR CERTIFICATION</p> <p>I hereby certify that the information herein is true and complete to the best of knowledge and belief, and that this organization either owns a working interest in the land, or has a right to drill this well at this location pursuant to a contract with an owner of such mineral or working interest, or to a voluntary pooling agreement or a compulsory pooling order heretofore entered by the division.</p> <p>Signature: <i>Joe T. Janica</i> Date: 11/14/08 Printed Name: Joe T. Janica</p> <p>SURVEYOR CERTIFICATION</p> <p>I hereby certify that the well location shown on this plat was plotted from field notes of actual surveys made by me or under my supervision, and that the same is true and correct to the best of my belief.</p> <p>RONALD J. EIDSON OCTOBER 30, 2008 Date Surveyed: 11/11/08 Signature & Seal: <i>Ronald J. Eidson</i> Professional Surveyor Certificate No. GARY EIDSON 12641 RONALD J. EIDSON 3239</p>
---	--	---

OGX Resources

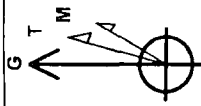

Azimuths to Grid North
True North: 2.45°
Magnetic North: 9.61°
Magnetic Field
Strength: 49339.48nT
Dip Angle: 60.95°
Date: 11/13/2008
Model: IGRF200510

WELL DETAILS: Repasado 2 State #1H									
Ground Elevation		3012.00							
RKB Elevation		WELL @ 3024.00N (12' RKB JW #1)							
Rig Name		12' RKB JW #1							
+N/S		0.00	0.00	0.00	0.00	0.00	0.00	0.00	0.00
+E/W		0.00	0.00	0.00	0.00	0.00	0.00	0.00	0.00
Northing		618016.100							
Easting		327 38' 48.457 N							
Latitude		101° 59' 31.809 W							
Longitude		101° 59' 31.809 W							
Slack									

SECTION DETAILS									
Sec	MD	Inc	Azi	TVD	+N/S	+E/W	DLeg	TFace	VSec Target
1	0.00	0.00	0.00	0.00	0.00	0.00	0.00	0.00	0.00
2	7472.50	0.00	0.00	7472.50	0.00	0.00	0.00	0.00	0.00
3	7222.56	0.00	0.00	7222.56	0.00	0.00	0.00	0.00	0.00
4	12460.25	96.00	176.59	7350.00	-4798.65	286.40	0.00	0.00	4715.23 BHL(Rep#1H)

WELL BORE TARGET DETAILS (MAP CO-ORDINATES)									
Name	TVD	+N/S	+E/W	Northing	Easting	Shape			
BHL(Rep#1H)	7950.00	-4708.60	280.20	387578.700	618296.300	Point			

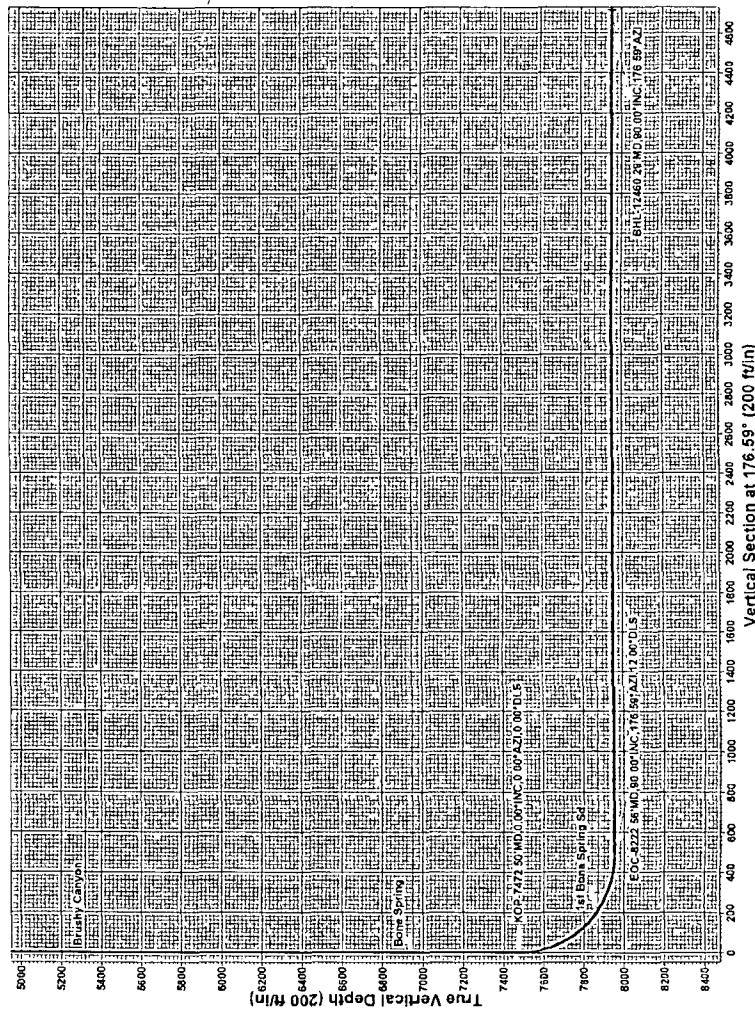

Vertical Section at 176.59° (200 ft/in)

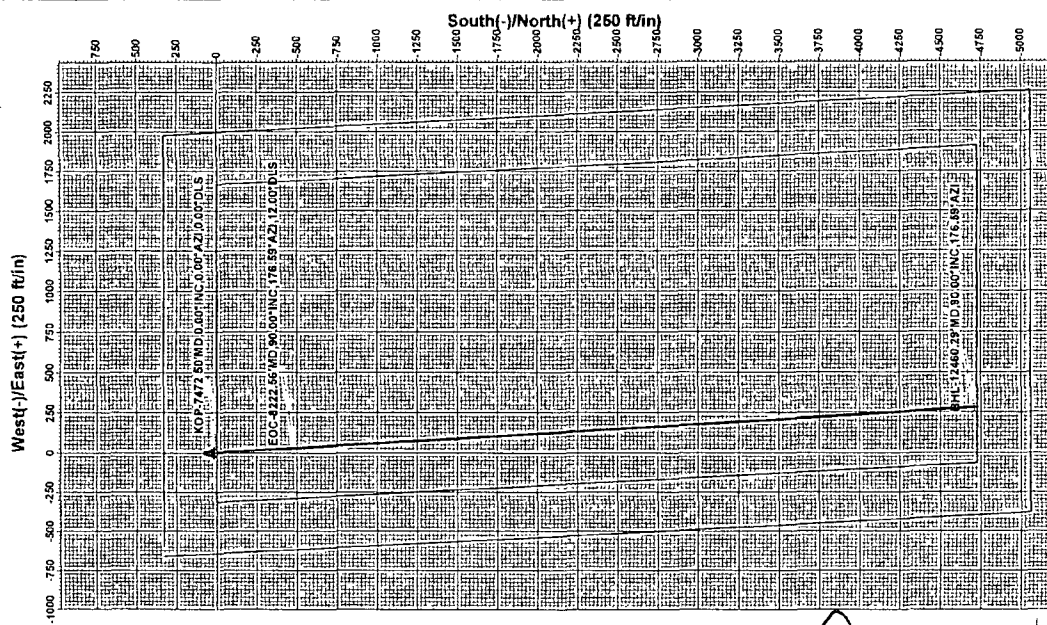

Plan View of Repasado 2 State #1H

Created By: Mike Bligham Date: 13.47, November 13 2008

Checked: _____ Date: _____

AOR
walle



COMPENSATED PHOTO DENSITY COMPENSATED NEUTRON LOG

LOCATION 750' FNL X 500' FEL PRVNC/CO. EDDY FIELD N. BRUSHY DRAW WELL: CAICLAW STATE NO. 1 COMPANY: SOUTHWEST ROYALTIES INC.	COMPANY SOUTHWEST ROYALTIES INC.			
	WELL CAICLAW STATE NO. 1			
	FIELD N. BRUSHY DRAW			
	PROVINCE/COUNTY EDDY			
COUNTRY/STATE U.S.A. / NEW MEXICO				
LOCATION		OTHER SERVICES		
LSD		DFF		
SEC 02		TWP 26S		
RCE 29E				
PERMANENT DATUM GROUND LEVEL ELEVATION 3247 FT.				
LOC MEASURED FROM K.B. 0 FT. ABOVE PERMANENT DATUM				
DRILLING MEASURED FROM K.B.				
ELEVATIONS: KB 3255 FT. DF 3254 FT. CL 3247 FT.				
DATE	10-JAN-94			
RUN NUMBER	ONE			
DEPTH-DRILLER	5615 FT.			
DEPTH-LOGGER	5617 FT.			
FIRST READING	5615 FT.			
LAST READING	100 FT.			
CASING-DRILLER	3207 FT.			
CASING-LOGGER	3206 FT.			
BIT SIZE	7 7/8 INCH			
HOLE FLUID TYPE	BRINE			
DENS./VISC.	9.4 28			
PH/FLUID LOSS	10 NA			
SAMPLE SOURCE	FLOWLINE			
RM @ MEAS TEMP	0.077 @ 70 F			
RME @ MEAS TEMP	0.077 @ 70 F			
RMC @ MEAS TEMP				
SOURCE: RME/RMC	CALC CALC			
RM @ BHT	0.047 @ 112			
TIME SINCE CIRC	4 HOURS			
MAX REC TEMP	112 DEG F			
EQUIPMENT/BASE	V1031 MDD			
RECORDED BY	GILBERT			
WITNESSED BY	MR MASTERSON			

*Off-setter
Permitted
DISPOSAL
not USED*

Handwritten notes and signatures at the bottom right of the log.

709 W. INDIANA
MIDLAND, TEXAS 79701
FAX (432) 682-8819



New Mexico Office of the State Engineer **Water Column/Average Depth to Water**

No records found.

Basin/County Search:

Basin: Lea County

County: Lea

PLSS Search:

Section(s): 2

Township: 26S

Range: 29E

The data is furnished by the NMOSE/ISC and is accepted by the recipient with the expressed understanding that the OSE/ISC make no warranties, expressed or implied, concerning the accuracy, completeness, reliability, usability, or suitability for any particular purpose of the data.

P.O. BOX 98
MIDLAND, TX. 79702
PHONE (432) 683-4521

Martin Water Laboratories, Inc.

709 W. INDIANA
MIDLAND, TEXAS 79701
FAX (432) 882-8810

RESULT OF WATER ANALYSES

TO: Mr. Steve Douglass
PO Box 2064, Midland, TX 79702

LABORATORY NO. _____ 610-150
SAMPLE RECEIVED _____ 6-15-10
RESULTS REPORTED _____ 6-17-10

COMPANY OGX Resources

LEASE Exxon Estate #1

FIELD OR POOL

SECTION _____ BLOCK _____ SURVEY _____ COUNTY Eddy STATE NM

SOURCE OF SAMPLE AND DATE TAKEN:

NO. 1 Fresh water sample - taken 6-15-10.

NO. 2

NO. 3

NO. 4

REMARKS:

[illegible]

Form No. 3

6

Greg Ogden, B.S.

LATHAM PRINTING CO. • 525-1282

Exxon State
Fresh Water Well

OGX Resources, LLC
Sec. 2, T26S, R29E
Exxon State Well #1: C-108 Application Filing
Eddy County, New Mexico

New Mexico Oil Conservation Division:

Available geologic and engineering data have been examined and no evidence of open faults or hydrological connection between the disposal zone and any underground sources of drinking water has been found.

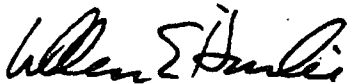

William E. Hardie, Geologist
OGX Resources, LLC

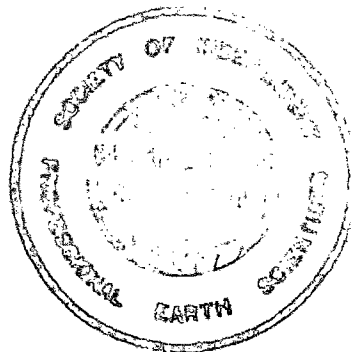

Affidavit of Publication

Copy of Publication:

NO. 21119

STATE OF NEW MEXICO

County of Eddy:

GARY D. SCOTT being duly

sworn, says: That he is the PUBLISHER of The

Artesia Daily Press, a daily newspaper of general
circulation, published in English at Artesia, said county
and county and state, and that the here to attached

Legal Notice

was published in a regular and entire issue of the said
Artesia Daily Press, a daily newspaper duly qualified
for that purpose within the meaning of Chapter 167 of
the 1937 Session Laws of the state of New Mexico for

1 Consecutive week/days on the same
day as follows:

First Publication April 23, 2010

Second Publication _____

Third Publication _____

Fourth Publication _____

Fifth Publication _____

Subscribed and sworn to before me this

23 Day April 2010



OFFICIAL SEAL
Jo Morgan
NOTARY PUBLIC STATE OF NEW MEXICO

My commission expires: 6/30/2012

Jo Morgan

Jo Morgan
Notary Public, Eddy County, New Mexico

LEGAL NOTICE

NOTICE OF COMMERCIAL INJECTION APPLICATION

OGX Resources, LLC, c/o
P.O. Box 953, Midland, TX
79702 will file the New
Mexico Conservation Division
Form C-108, Application for
Authorization to Inject, with
the NMOCD seeking admin-
istrative approval for commer-
cial water injection/disposal
into their Exxon State No. 1
well, 530' ESL & 330' FEL of
Sec. 2, T26S, R29E in Eddy
County, NM.

The proposed injection inter-
val is from 3500-4800'. The
proposed maximum surface
pressure is 875 psi, with max-
imum injection rate of 4000
bbls water per day. The injec-
tion water will be sourced
from area Brushy Draw and
Delaware Formation.

All interested parties oppos-
ing the application must file
objection with the New
Mexico Oil Conservation
Division, 1220 South St.
Francis Drive, Santa Fe NM
87505 within 15 days of this
notice. Additional information
can be obtained by contact-
ing Ann Ritchie, Regulatory
Agent, OGX Resources,
LLC, c/o P.O. Box 953,
Midland, TX 79702, (432)
684-6381.

Published in the Artesia Daily
Press, Artesia, NM April 23,
2010.

Legal No. 21119

Offsetting Owners to Exxon State No. 1 in Section 2, T-26-S, R-29-E, N.M.P.M.
Eddy County, New Mexico

Section 2 All OGX Resources LLC 100%

Section 1 W/2 Chevron USA Inc.
15 Smith Rd
Midland, Texas 79705 ✓

Chase Oil Corp
P.O. Box 1767
Artesia, NM 88211 ✓

Section 11 E/2 NW/4
N/2 NE/4
SE/4 NE/4

Section 12 NW/4

Chesapeake Exploration LP
P.O. Box 18496
Oklahoma City, OK 73154 ✓

Carbon Techs Energy Inc.
727 Seventh Ave SW #1100
Calgary AB T2P 075 ✓

Exco Resources Inc.
6500 Greenville Ave. #600
Dallas, TX 75206 ✓

John F. Green
43 Haight Ave
Poughkeepsie, NY 12603 ✓

KEERCO INC.
Niels Esperson Bldg.
Houston, Tx 77002 ✓

NU-ENERGY O&G INC
302-1550 W 8TH AVE
VANCOUVER BC V6S4R8 ✓

RKC INC.
1527 HILLSIDE RD
FARFIELD CT 06490 ✓

Section 11 NW/4 NE/4

Steven W. Horn ✓
P.O. Box 2755
Midland, TX 79702

Surface Owners

Section 2 State of New Mexico ✓

Section 1 USA

Section 11 USA

Section 12 USA

Surface Tenant all of the above

Byron Wayne Paschal ✓
P.O. Box 992
Pecos, Texas 79772

U.S. Postal Service
CERTIFIED MAIL RECEIPT
(Domestic Mail Only; No Insurance Coverage Provided)

For delivery information visit our website at www.usps.com

OKLAHOMA CITY OK 73155

Postage	\$ 0.44
Certified Fee	\$2.80
Return Receipt Fee (Endorsement Required)	\$0.00
Restricted Delivery Fee (Endorsement Required)	\$0.00
Total Postage & Fees	\$ 3.24

0710

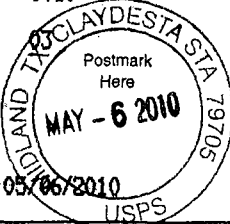

Sent To CHESAPEAKE EXPL LP
Street, Apt. No., or PO Box No. PO Box 18496
City, State, ZIP+4 OKLAHOMA CITY OK 73154
PS Form 3800, August 2006 See Reverse for Instructions

U.S. Postal Service
CERTIFIED MAIL RECEIPT
(Domestic Mail Only; No Insurance Coverage Provided)

For delivery information visit our website at www.usps.com

ARTESIA NM 88211

Postage	\$ 0.44
Certified Fee	\$2.80
Return Receipt Fee (Endorsement Required)	\$0.00
Restricted Delivery Fee (Endorsement Required)	\$0.00
Total Postage & Fees	\$ 3.24

0710

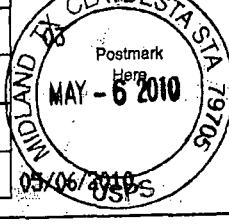

Sent To CHASE OIL CORP
Street, Apt. No., or PO Box No. PO Box 1767
City, State, ZIP+4 ARTESIA NM 88211
PS Form 3800, August 2006 See Reverse for Instructions

U.S. Postal Service
CERTIFIED MAIL RECEIPT
(Domestic Mail Only; No Insurance Coverage Provided)

For delivery information visit our website at www.usps.com

MIDLAND TX 79705

Postage	\$ 0.44
Certified Fee	\$2.80
Return Receipt Fee (Endorsement Required)	\$2.30
Restricted Delivery Fee (Endorsement Required)	\$0.00
Total Postage & Fees	\$ 5.54

0710

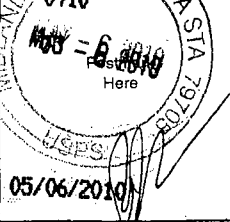

Sent To CHEVRON USA INC
Street, Apt. No., or PO Box No. 15 SMITH ROAD
City, State, ZIP+4 MIDLAND TX 79705
PS Form 3800, August 2006 See Reverse for Instructions

U.S. Postal Service
CERTIFIED MAIL RECEIPT
(Domestic Mail Only; No Insurance Coverage Provided)

For delivery information visit our website at www.usps.com

FAIRFIELD CT 06824

Postage	\$ 0.44
Certified Fee	\$2.80
Return Receipt Fee (Endorsement Required)	\$0.00
Restricted Delivery Fee (Endorsement Required)	\$0.00
Total Postage & Fees	\$ 3.24

0710

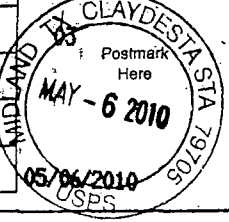

Sent To RKC INC
Street, Apt. No., or PO Box No. 1527 HILLSIDE RD
City, State, ZIP+4 FAIRFIELD CT 06824
PS Form 3800, August 2006 See Reverse for Instructions

Registered No.

RB822508701US

Date Stamp

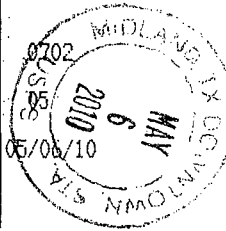
To Be Completed
By Post Office

Reg. Fee	\$11.50	
Handling Charge	\$0.00	Return Receipt \$0.00
Postage	\$0.75	Restricted Delivery \$0.00

Received by *[Signature]*Customer Must Declare
Full Value \$0.00Domestic Insurance up to \$25,000 is included
based upon the declared value. International
Indemnity is limited. (See Reverse).

OFFICIAL USE

To Be Completed By Customer
(Please Print)
All Entries Must Be in Ballpoint or Typed

FROM	OGX Resources LLC c/o PO Box 953 Midland, TX 79702
TO	NO Energy O + G Inc 302-1550 W 8th Ave Vancouver BC V6S 4R8 Canada

PS Form 3806, Receipt for Registered Mail Copy 1 - Customer
May 2007 (7530-02-000-9051) (See Information on Reverse)For domestic delivery information, visit our website at www.usps.com®

Registered No.

RB822508692US

Date Stamp

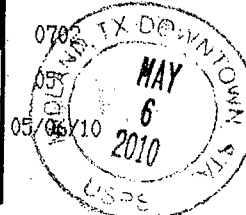
To Be Completed
By Post Office

Reg. Fee	\$11.50	
Handling Charge	\$0.00	Return Receipt \$0.00
Postage	\$0.75	Restricted Delivery \$0.00

Received by *[Signature]*Customer Must Declare
Full Value \$0.00Domestic Insurance up to \$25,000 is included
based upon the declared value. International
Indemnity is limited. (See Reverse).

OFFICIAL USE

To Be Completed By Customer
(Please Print)
All Entries Must Be in Ballpoint or Typed

FROM	OGX Resources LLC c/o PO Box 953 Midland, TX 79702
TO	Carbon Tech Energy Inc 727 Seventh Ave SW #1100 Calgary AB T2P 0T5 CANADA

PS Form 3806, Receipt for Registered Mail Copy 1 - Customer
May 2007 (7530-02-000-9051) (See Information on Reverse)For domestic delivery information, visit our website at www.usps.com®

CERTIFIED MAIL™ RECEIPT
(Domestic Mail Only; No Insurance Coverage Provided)For delivery information visit our website at www.usps.com

SANTA FE NM 87504

Postage	\$	\$0.44
Certified Fee		\$2.80
Return Receipt Fee (Endorsement Required)		\$0.00
Restricted Delivery Fee (Endorsement Required)		\$0.00
Total Postage & Fees	\$	\$3.24

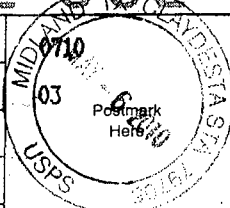

05/06/2010

Sent To **NEW MEXICO STATE LAND OFFICE**
Street, Apt. No., or PO Box No. **PO Box 1148**
City, State, ZIP+4 **SANTA FE NM 87504-1148**

PS Form 3800, August 2006

See Reverse for Instructions

U.S. Postal Service™
CERTIFIED MAIL™ RECEIPT
(Domestic Mail Only; No Insurance Coverage Provided)For delivery information visit our website at www.usps.com

MIDLAND TX 79702

Postage	\$	\$0.44
Certified Fee		\$2.80
Return Receipt Fee (Endorsement Required)		\$0.00
Restricted Delivery Fee (Endorsement Required)		\$0.00
Total Postage & Fees	\$	\$3.24

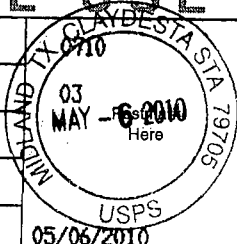

05/06/2010

Sent To **STEVEN W. HORN**
Street, Apt. No., or PO Box No. **PO Box 2755**
City, State, ZIP+4 **MIDLAND TX 79702**

PS Form 3800, August 2006

See Reverse for Instructions

U.S. Postal Service™
CERTIFIED MAIL™ RECEIPT
(Domestic Mail Only; No Insurance Coverage Provided)For delivery information visit our website at www.usps.com

POUGHKEEPSIE NY 12603

Postage	\$	\$0.44
Certified Fee		\$2.80
Return Receipt Fee (Endorsement Required)		\$0.00
Restricted Delivery Fee (Endorsement Required)		\$0.00
Total Postage & Fees	\$	\$3.24

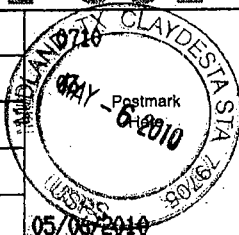

05/06/2010

Sent To **JOHN F. GREEN**
Street, Apt. No., or PO Box No. **43 HAIGHT AVE**
City, State, ZIP+4 **POUGHKEEPSIE NY 12603**

PS Form 3800, August 2006

See Reverse for Instructions

CERTIFIED MAIL™ RECEIPT
(Domestic Mail Only; No Insurance Coverage Provided)For delivery information visit our website at www.usps.com

PECOS TX 79772

Postage	\$	\$0.44
Certified Fee		\$2.80
Return Receipt Fee (Endorsement Required)		\$0.00
Restricted Delivery Fee (Endorsement Required)		\$0.00
Total Postage & Fees	\$	\$3.24

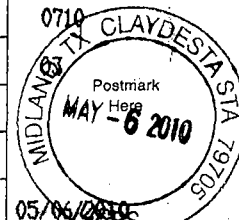

05/06/2010

Sent To **BYRON WAYNE PASCHAL**
Street, Apt. No., or PO Box No. **PO Box 992**
City, State, ZIP+4 **PECOS TX 79772**

PS Form 3800, August 2006

See Reverse for Instructions

U.S. Postal Service™
CERTIFIED MAIL™ RECEIPT
(Domestic Mail Only; No Insurance Coverage Provided)For delivery information visit our website at www.usps.com

HOUSTON TX 77002

Postage	\$	\$0.44
Certified Fee		\$2.80
Return Receipt Fee (Endorsement Required)		\$0.00
Restricted Delivery Fee (Endorsement Required)		\$0.00
Total Postage & Fees	\$	\$3.24

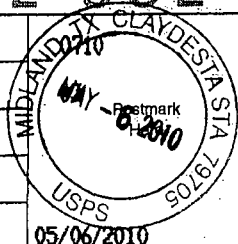

05/06/2010

Sent To **KEERCO INC**
Street, Apt. No., or PO Box No. **NIELS ESPERSON BLDG**
City, State, ZIP+4 **HOUSTON TX 77002**

PS Form 3800, August 2006

See Reverse for Instructions

U.S. Postal Service™
CERTIFIED MAIL™ RECEIPT
(Domestic Mail Only; No Insurance Coverage Provided)For delivery information visit our website at www.usps.com

DALLAS TX 75206

Postage	\$	\$0.44
Certified Fee		\$2.80
Return Receipt Fee (Endorsement Required)		\$0.00
Restricted Delivery Fee (Endorsement Required)		\$0.00
Total Postage & Fees	\$	\$3.24

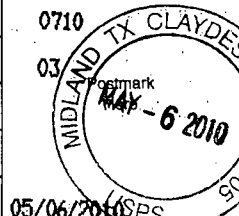

05/06/2010

Sent To **EXCO RESOURCES INC**
Street, Apt. No., or PO Box No. **6500 GREENVILLE AVE #600**
City, State, ZIP+4 **DALLAS TX 75206**

PS Form 3800, August 2006

See Reverse for Instructions

Jones, William V., EMNRD

From: Jones, William V., EMNRD
Sent: Thursday, June 10, 2010 3:51 PM
To: 'Ann Ritchie'
Cc: Ezeanyim, Richard, EMNRD; Dade, Randy, EMNRD
Subject: Disposal application from OGX Resources, LLC: Exxon State #1 30-015-25742

Hello Ann:

Just reviewed this application and have a few requests:

- a. What are the tops of the members of the Delaware in this area?
- b. What Delaware members are included in the 3500 to 4800 foot proposed disposal interval?
- c. Please send well bore diagrams for the Phillips Federal #1 30-015-25530 and the Brushy 12-A Fed #1 30-015-25615.
- d. Your post-conversion wellbore diagram shows new 5-1/2 casing all the way to 5600 feet but you don't intend to dispose below 4800, is this correct?
- e. There are no logs on this well, the permit would require an attempt at open hole logs and a cement bond log if cement does not circulate.
- f. Do you have a mudlog over this interval? How was it deemed non-productive?
- g. How deep is fresh water in this area and are there any windmills or wells within 1 mile? If so, please send water analysis.

Thank You,

William V Jones, P.E.
Engineering, Oil Conservation Division
1220 South St. Francis Drive, Santa Fe, NM 87505
Tel 505.476.3448 ~ Fax 505.476.3462



Jones, William V., EMNRD

From: Ann Ritchie [ann.wtor@gmail.com]
Sent: Monday, June 21, 2010 10:44 AM
To: Jones, William V., EMNRD
Subject: OGX Data - Exxon State
Attachments: swd .pdf

Will,

Attached is the water analysis for the OGX Exxon State SWD application.

Below are the questions you had concerning the application - I have answered in red.

Please let me know if you need this in letter format with the water sample attached - mailed to you?

Not sure how much you can accept by e-mail.

Hello Ann:

Just reviewed this application and have a few requests:

a. What are the tops of the members of the Delaware in this area? Tops in Exxon State area:

Lamar	3230
Bell Canyon	3264
Cherry Canyon	4150
Manzanita	4340
Brushy Canyon	5380

b. What Delaware members are included in the 3500 to 4800 foot proposed disposal interval? **Formations included in disposal interval are Bell Canyon and Cherry Canyon.**

c. Please send well bore diagrams for the Phillips Federal #1 30-015-25530 and the Brushy 12-A Fed #1 30-015-25615. **Will send in separate e-mail.**

d. Your post-conversion wellbore diagram shows new 5-1/2 casing all the way to 5600 feet but you don't intend to dispose below 4800, is this correct? **Correct.**

e. There are no logs on this well, the permit would require an attempt at open hole logs and a cement bond log if cement does not circulate. **OGX will do.**

f. Do you have a mudlog over this interval? How was it deemed non-productive? **We have been unable to get mudlog for this well, area non-productive, dry holes**

g. How deep is fresh water in this area and are there any windmills or wells within 1 mile? If so, please send water analysis. **Attached**

----- Forwarded message -----

From: **Jeff Birkelbach** <JBirkelbach@ogxresources.com>

Date: Mon, Jun 21, 2010 at 7:24 AM

Subject:

To: Ann Ritchie <ann.wtor@gmail.com>

Jones, William V., EMNRD

From: Ann Ritchie [ann.wtor@gmail.com]
Sent: Monday, June 21, 2010 2:58 PM
To: Jones, William V., EMNRD
Subject: Re: OGX Data - Exxon State
Attachments: OGX Exxon State radius wellbores.pdf

Will,
Attached are the wellbore diagrams for the two wells requested. 30 015 25530 is pretty messy. There was a squeeze job, casing pulled, etc. So not a "straight up" plugging job, but definately lots of cement behind pipe. Let me know if it is okay.
The other one was filed w/OCD by Chesapeake on 8-5-09, no filing since.
Thank you,
Ann

On Mon, Jun 21, 2010 at 11:43 AM, Ann Ritchie <ann.wtor@gmail.com> wrote:

Will,
Attached is the water analysis for the OGX Exxon State SWD application.
Below are the questions you had concerning the application - I have answered in red.
Please let me know if you need this in letter format with the water sample attached - mailed to you?
Not sure how much you can accept by e-mail.

Hello Ann:
Just reviewed this application and have a few requests:

a. What are the tops of the members of the Delaware in this area? Tops in Exxon State area:

Lamar	3230
Bell Canyon	3264
Cherry Canyon	4150
Manzanita	4340
Brushy Canyon	5380

b. What Delaware members are included in the 3500 to 4800 foot proposed disposal interval? **Formations included in disposal interval are Bell Canyon and Cherry Canyon.**

c. Please send well bore diagrams for the Phillips Federal #1 30-015-25530 and the Brushy 12-A Fed #1 30-015-25615. **Will send in separate e-mail.**

d. Your post-conversion wellbore diagram shows new 5-1/2 casing all the way to 5600 feet but you don't intend to dispose below 4800, is this correct? **Correct.**

e. There are no logs on this well, the permit would require an attempt at open hole logs and a cement bond log if cement does not circulate. **OGX will do.**

f. Do you have a mudlog over this interval? How was it deemed non-productive? **We have been unable to get mudlog for this well, area non-productive, dry holes**

g. How deep is fresh water in this area and are there any windmills or wells within 1 mile? If so, please send water analysis. **Attached**

----- Forwarded message -----

From: Jeff Birkelbach <JBirkelbach@ogxresources.com>
Date: Mon, Jun 21, 2010 at 7:24 AM
Subject:

Injection Permit Checklist (03/15/2010)

Case 622 R- SWD WFX PMX IPI 6/2/10 Permit Date 6/2/10 UIC Qtr 6/2/10

Wells 1 Well Name: EXXON STOKA #1

API Num: (30-) 015-25742 Spud Date: 4/1/87 New/Old: X (UIC primacy March 7, 1982)

Footages: 530 FSL/330 FEL Unit P Sec 2 Tsp 26S Rge 29E County EDDY

Operator: OGX Resources LLC Contact Ann E. Ritchie

OGRID: 217955 RULE 5.9 Compliance (Wells) 0/22 (Finan Assur) OK IS 5.9 OK? OK

Operator Address: % Ann Ritchie 16 Box 533 Midland TX 79702

Current Status: P&A 1987

Planned Work to Well:

Planned Tubing Size/Depth: 27/8 3,450'

	Sizes Hole.....Pipe	Setting Depths	Cement Sx or Cf	Cement-Top and Determination Method
Existing <input checked="" type="checkbox"/> Surface	<u>12 1/4 8 5/8</u>	<u>450</u>	<u>(3.50)</u>	<u>CIRC</u>
Existing <input type="checkbox"/> Intermediate				
Existing <input type="checkbox"/> Long String	<u>7 7/8 5 1/2</u>	<u>5600'</u>	<u>1200</u>	<u>Design to SIRC</u>

QV Tool ☐ Liner ☐ Open Hole ☐ Total Depth 5600'

Well File Reviewed ☒

Diagrams: Before Conversion ☒ After Conversion ☒ Elogs in Imaging File: no logs

Intervals:	Depths	Formation	Producing (Yes/No)
Above (Name and Top)			
Above (Name and Top)	<u>3240</u>	<u>TOP DEL.</u>	
Injection..... Interval TOP:	<u>3500</u>	<u>Ball C.</u>	
Injection..... Interval BOTTOM:	<u>4500</u>	<u>Cherry C.</u>	
Below (Name and Top)			

GENERAL LOCATION

Rough marginally productive in TR-15 area.

700 PSI Max. WHIP

Open Hole (Y/N) ☐

Deviated Hole? ☐

Sensitive Areas: Capitan Reef Cliff House Salt Depths 2500-3000

..... Potash Area (R-TT-P) Noticed?

Fresh Water: Depths: _____ Wells _____ Analysis? _____ Affirmative Statement ☒

Disposal Fluid Sources: Del. Analysis? _____

Disposal Interval Production Potential/Testing/Analysis Analysis: BY Passed before

Notice: Newspaper(Y/N) ☒ Surface Owner SLD. / Potash Mineral Owner(s) _____

RULE 26.7(A) Affected Parties: BLM / Chingabe / Exco / H&E (H&E) 5/6/10

Area of Review: Adequate Map (Y/N) ☒ and Well List (Y/N) ☒

Active Wells 1 Num Repairs 0 Producing in Injection Interval in AOR Shallow interval

..P&A Wells 2 Num Repairs 0 All Wellbore Diagrams Included? NO OK

Questions/Required Work:

Proof SPZ Surface P&A ?
Proof Bottom of inj interval ?

Long well in E/2 Sec 2 ?

Run logs before CSP

Request Sent _____ Reply: _____

Request Sent _____ Reply: _____

Request Sent _____ Reply: _____

Just above Red Bluff Reservoir in NM

Proposed New

4/23

Set CIBP w/in 200'