

~~151~~(50)3/3/99
NA

SDX RESOURCES, INC.

P.O. BOX 5061
MIDLAND, TEXAS 79704
(915) 685-1761

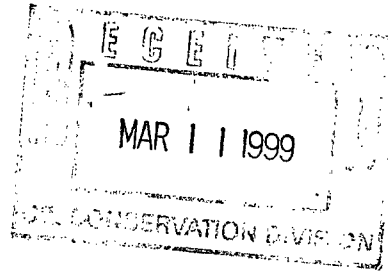

March 4, 1999

NMOCD
2040 S. Pacheco St
Santa Fe, NM 87505

Attention: Mr. Mike Stogner

Re: Langlie A Federal #2
Sec. 17, T25S, R37E
660' FSL, 1980' FEL
Lea Co., NM

Dear Mr. Stogner:

SDX Resources, Inc is the operator of the Langlie A Federal #1 well located in Unit J of Sec. 17, T25S, R37E of Lea Co., NM. This well is dedicated to a 160 acre proration unit consisting of the SE/4 of Sec. 17. SDX is planning to drill the Langlie A Federal A #2 well on the same 160 acre proration unit at the above-mentioned location.

SDX requests that this letter serve as an application to simultaneously dedicate this 160 acre proration unit to the Langlie A Federal #1 and #2 wells.

BLM form 3160 and OCD form C-102 for the #2 well, an outlined lease map, and other pertinent information is attached to the application. All offset operators have been notified and proof of notification is attached.

Your assistance on this is appreciated.

Sincerely,

A handwritten signature in cursive script that reads "Chuck Morgan".

Chuck Morgan
Engineer

CM:bja

enclosures

OFFSET OPERATORS

Langlie A Federal #2

Arch Petroleum
10 Desta Dr. #420E
Midland, TX 79705

Chevron
Attn: Land Dept
15 Smith Rd
Midland, TX 79705

Chance Oil Co., Inc.
PO Box 1379
Vernon, TX 76385

Doyle Hartman
PO Box 10426
Midland, TX 79702

Bettis & Stoval
PO Box 1240
Graham, TX 76450

Bristol Resources, Corp
6655 S. Lewis #200
Tulsa OK 74136

GP II
Attn: George Mitchell
PO Box 50682
Midland, TX 79710

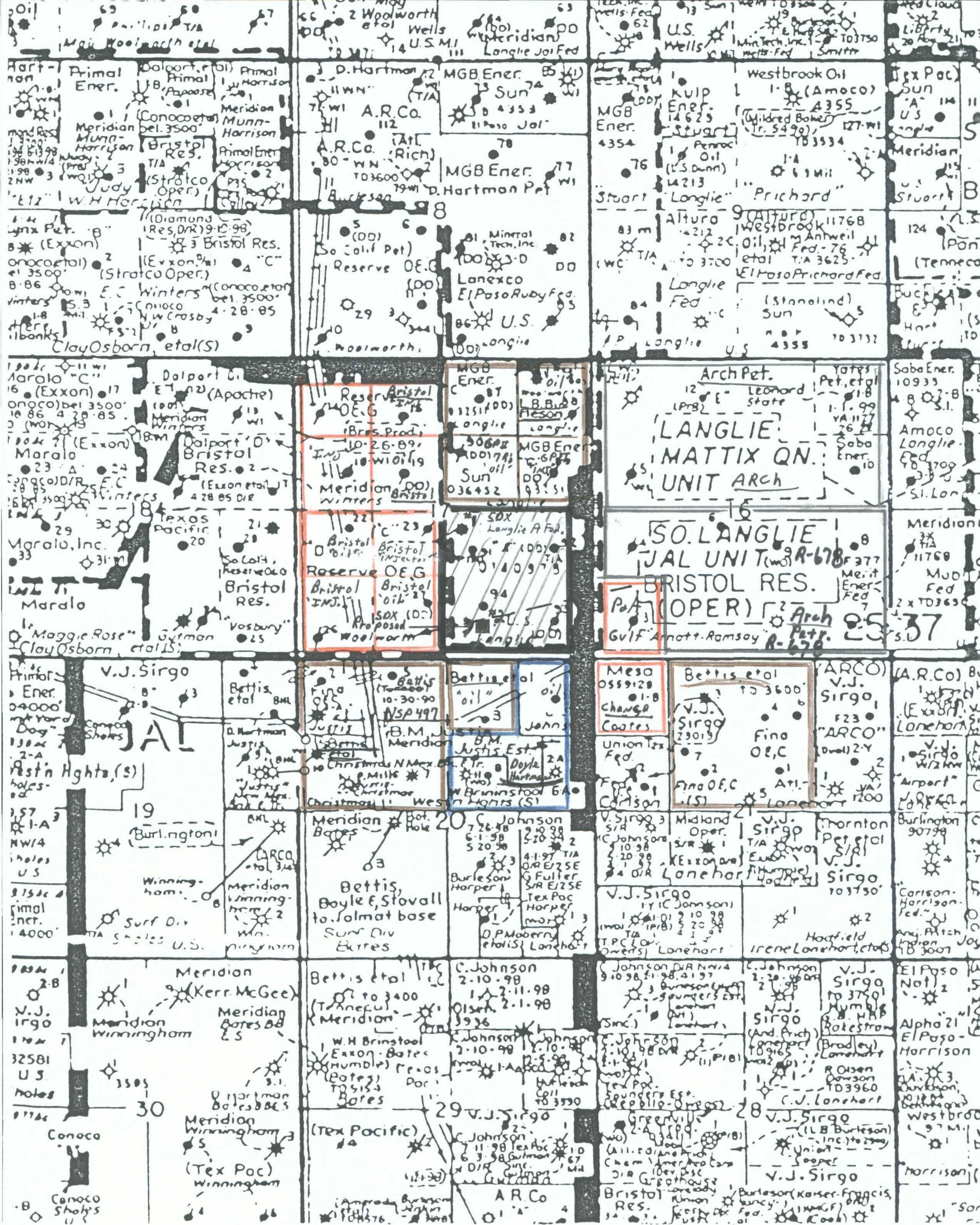

Now: SOX Resources All

ces must be from the outer boundaries of the Section

Wally Felt

SENMM

| | | | | |
|--|--|-------------------------------------|--|----------------------|
| Operator El Paso Natural Gas Company | | Lease Langlie "A" Federal | | Well No. 1 |
| Unit Letter J | Section 17 | Township 25S | Range 37E | County Lea |
| Actual Footage Location of Well: 2,310 feet from the South line and 2,310 feet from the East line | | | | |
| Ground Level Elev. 3,108 | Producing Formation Yates-Seven Rivers | Pool Jalmat | Dedicated Acreage: 160 Acres | |

1. Outline the acreage dedicated to the subject well by colored pencil or hachure marks on the plat below.
2. If more than one lease is dedicated to the well, outline each and identify the ownership thereof (both as to working interest and royalty).
3. If more than one lease of different ownership is dedicated to the well, have the interests of all owners been consolidated by communitization, unitization, force-pooling, etc?

☐ Yes ☐ No If answer is "yes," type of consolidation _____

If answer is "no," list the owners and tract descriptions which have actually been consolidated. (Use reverse side of this form if necessary.) _____

No allowable will be assigned to the well until all interests have been consolidated (by communitization, unitization, forced-pooling, or otherwise) or until a non-standard unit, eliminating such interests, has been approved by the Commission.

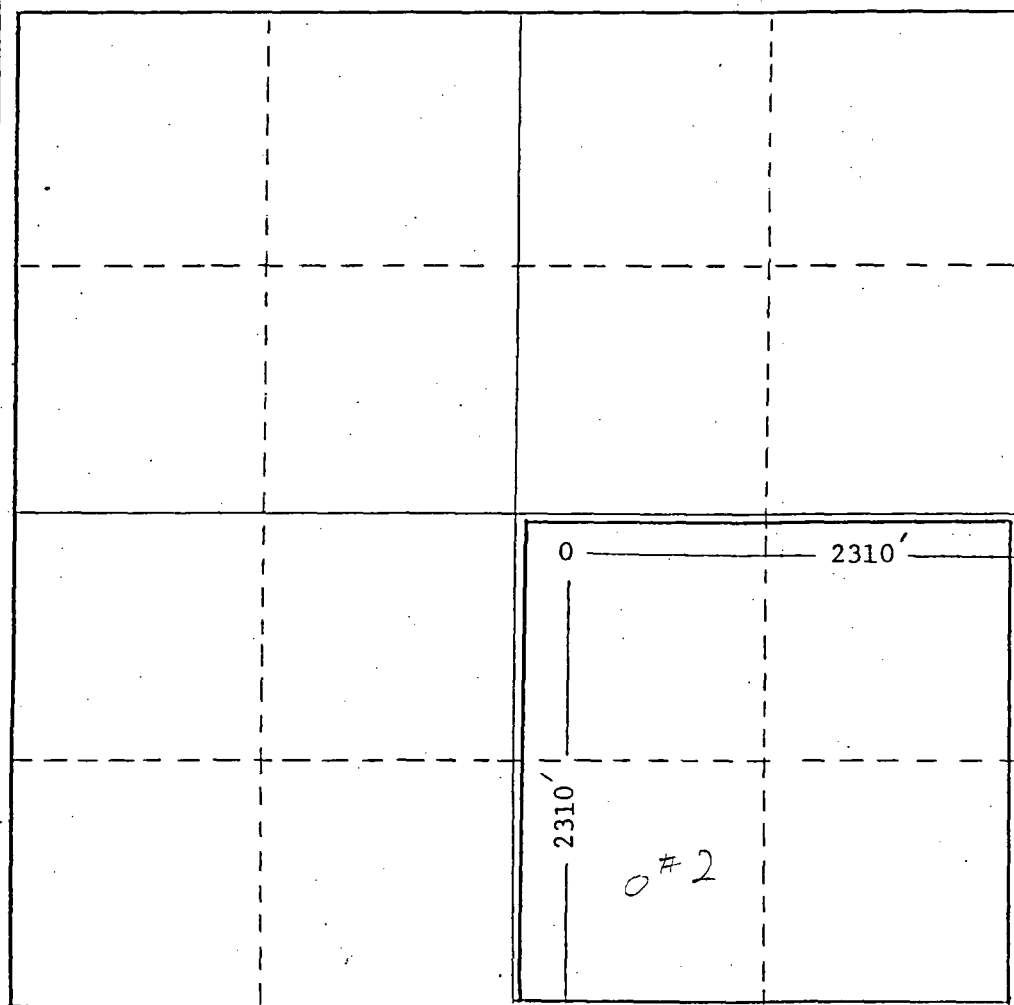

CERTIFICATION

I hereby certify that the information contained herein is true and complete to the best of my knowledge and belief.

John S. Delk

Name

John S. Delk

Position

Supervisor Production Svc.

Company

El Paso Natural Gas Co.

Date

March 18, 1982

I hereby certify that the well location shown on this plat was plotted from field notes of actual surveys made by me or under my supervision, and that the same is true and correct to the best of my knowledge and belief.

Date Surveyed

12/4/53

Registered Professional Engineer
and/or Land Surveyor

Larry C. Zink

Certificate No.

0 330 660 990 1320 1650 1980 2310 2640 2000 1500 1000 500 0

R-678

280 ACRES

non Arch Petr.

NEW MEXICO
OIL CONSERVATION COMMISSION

Gas Well Plat

Date September 29, 1955

Gulf Oil Corporation Operator
Arnett Ramsay Lease
NCT-E 2 Well No.

Name of Producing Formation Yates-Seven Rivers Pool Jalmat Gas

Non-Standard Gas Proportion Unit
Approved Case No. 918, Order No.
R-678

No. Acres Dedicated to the Well 280

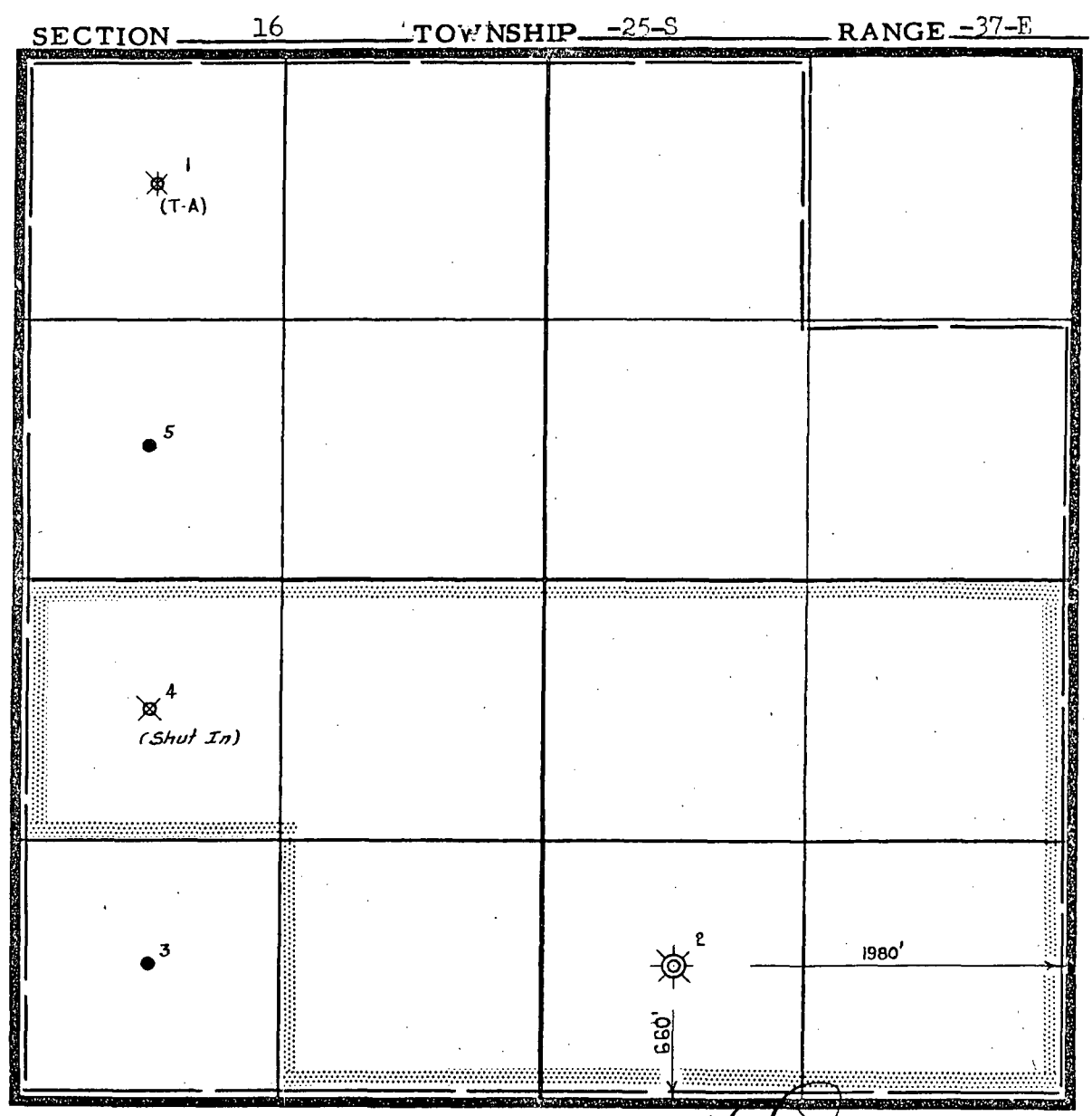

I hereby certify that the information given above is true and complete to the best of my knowledge.



- Gas Well
- Oil Well
- Lease Line
- Acreage Dedicated

Name J. R. Sherman J. R. Sherman
Position Asst. Division Gas Engineer
Representing Gulf Oil Corporation
Address P. O. Box 1290, Fort Worth, Texas

District II
811 South First, Artesia, NM 88210

OIL CONSERVATION DIVISION
2040 South Pacheco
Santa Fe, NM 87505

Instructions on back
Submit to Appropriate District Office
5 Copies

District III
1000 Rio Brazos Rd., Aztec, NM 87410

☐ AMENDED REPORT

District IV
2040 South Pacheco, Santa Fe, NM 87505

I. REQUEST FOR ALLOWABLE AND AUTHORIZATION TO TRANSPORT

| | | |
|--|--|---|
| Operator name and Address Bristol Resources Corporation 6655 S. Lewis - Ste 200 Tulsa, OK 74136 | | OGRID Number 002894 |
| | | Reason for Filing Code CH - Effective 1/1/97 |
| API Number 30 - 025 - 11638 | Pool Name Jalmat Tansill Yates Seven Rivers | Pool Code 33820 |
| Property Code 16821 2D157 | Property Name South Langlie JAL Unit | Well Number 023 |

II. Surface Location

| | | | | | | | | | |
|--------------------|---------------|-----------------|--------------|---------|-----------------------|---------------------------|-----------------------|------------------------|---------------|
| UL or lot no. K | Section 17 | Township 25S | Range 37E | Lot Idn | Feet from the 2310 | North/South Line South | Feet from the 2310 | East/West line West | County Lea |
|--------------------|---------------|-----------------|--------------|---------|-----------------------|---------------------------|-----------------------|------------------------|---------------|

Bottom Hole Location

| | | | | | | | | | |
|---------------|---------------------------------|---------------------|---------------------|----------------------|-----------------------|------------------|---------------|----------------|--------|
| UL or lot no. | Section | Township | Range | Lot Idn | Feet from the | North/South line | Feet from the | East/West line | County |
| | | | | | | | | | |
| Lse Code P | Producing Method Code Inject | Gas Connection Date | C-129 Permit Number | C-129 Effective Date | C-129 Expiration Date | | | | |

III. Oil and Gas Transporters

| Transporter OGRID | Transporter Name and Address | POD | O/G | POD ULSTR Location and Description |
|-------------------|------------------------------|-----|-----|------------------------------------|
| | | | | |
| | | | | |
| | | | | |
| | | | | |
| | | | | |
| | | | | |
| | | | | |

IV. Produced Water

| | |
|-----|------------------------------------|
| POD | POD ULSTR Location and Description |
|-----|------------------------------------|

V. Well Completion Data

| | | | | | |
|-----------|----------------------|-----------|--------------|--------------|-------------|
| Spud Date | Ready Date | TD | PBTD | Perforations | DHC, DC, MC |
| Hole Size | Casing & Tubing Size | Depth Set | Sacks Cement | | |
| | | | | | |
| | | | | | |
| | | | | | |
| | | | | | |

VI. Well Test Data

| | | | | | |
|--------------|-------------------|-----------|-------------|---------------|---------------|
| Date New Oil | Gas Delivery Date | Test Date | Test Length | Tbg. Pressure | Csg. Pressure |
| Choke Size | Oil | Water | Gas | AOF | Test Method |

I hereby certify that the rules of the Oil Conservation Division have been complied with and that the information given above is true and complete to the best of my knowledge and belief.

Signature: *Lori Livingston*

Printed name: Lori Livingston

Title: Production Supervisor

Date: 12/20/96

Phone: 918-492-7900

OIL CONSERVATION DIVISION

Approved by: ORIGINAL SIGNED BY JERRY SEXTON
REGULATORY SUPERVISOR

Title:

Approval Date:

JAN 16 1997

If this is a change of operator fill in the OGRID number and name of the previous operator

#000873 Apache Corporation

Previous Operator Signature

Printed Name

Title

Date

Julia North
Julia North

Sr Regulatory Analyst

12/20/96

WELL LOCATION SURVY PLAT

OPERATOR CULBERTSON & IRWIN, INC.
LEASE WOOLWORTH "D"
WELL NO. 1

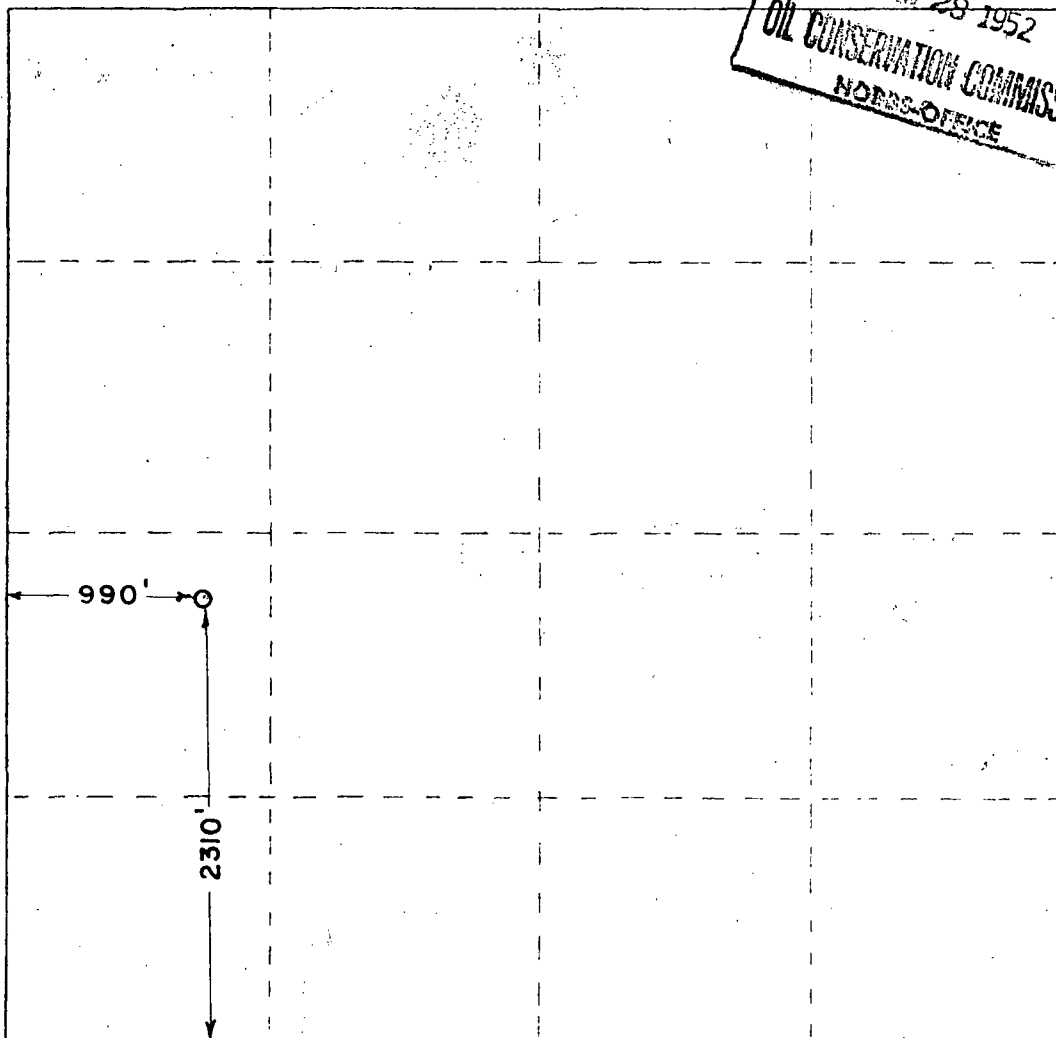
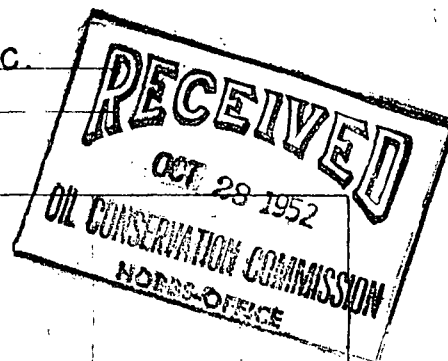

SEC. 17, TWP. 25 S., RGE. 37 E., N.M.P.M.

I HEREBY CERTIFY THAT THIS PLAT WAS MADE
FROM NOTES TAKEN IN THE FIELD BY ME AND
THAT THE SAME IS TRUE AND CORRECT TO
BEST OF MY KNOWLEDGE AND BELIEF.

Now Bristol Resources

6655 S. Lewis St 70200

Tulsa, Okla 74136

S. Langlie JAL Unit oil

John W West
JOHN W. WEST, PE & LS NO. 676

9-26-52

I. REQUEST FOR ALLOWABLE AND AUTHORIZATION TO TRANSPORT

| | | |
|--|--|---|
| Operator name and Address Bristol Resources Corporation 6655 S. Lewis - Ste 200 Tulsa, OK 74136 | | OGRID Number 002894 |
| | | Reason for Filing Code CH - Effective 1/1/97 |
| API Number 30 - 025- 11645 | Pool Name Jalmat Tansill Yates Seven Rivers | Pool Code 33820 |
| Property Code 16821 2D157 | Property Name South Langlie JAL Unit | Well Number 026 |

II. Surface Location

| | | | | | | | | | |
|--------------------|---------------|-----------------|--------------|---------|----------------------|---------------------------|----------------------|------------------------|---------------|
| UL or lot no. M | Section 17 | Township 25S | Range 37E | Lot Idn | Feet from the 330 | North/South Line South | Feet from the 330 | East/West line West | County Lea |
|--------------------|---------------|-----------------|--------------|---------|----------------------|---------------------------|----------------------|------------------------|---------------|

Bottom Hole Location

| | | | | | | | | | |
|---------------|---------------------------------|---------------------|---------------------|----------------------|-----------------------|------------------|---------------|----------------|--------|
| UL or lot no. | Section | Township | Range | Lot Idn | Feet from the | North/South line | Feet from the | East/West line | County |
| Lse Code P | Producing Method Code Inject | Gas Connection Date | C-129 Permit Number | C-129 Effective Date | C-129 Expiration Date | | | | |

III. Oil and Gas Transporters

| Transporter OGRID | Transporter Name and Address | POD | O/G | POD ULSTR Location and Description |
|-------------------|------------------------------|-----|-----|------------------------------------|
| | | | | |
| | | | | |
| | | | | |
| | | | | |
| | | | | |
| | | | | |

IV. Produced Water

| | |
|-----|------------------------------------|
| POD | POD ULSTR Location and Description |
|-----|------------------------------------|

V. Well Completion Data

| | | | | | |
|-----------|----------------------|-----------|--------------|--------------|-------------|
| Spud Date | Ready Date | TD | PBTD | Perforations | DHC, DC, MC |
| Hole Size | Casing & Tubing Size | Depth Set | Sacks Cement | | |
| | | | | | |
| | | | | | |
| | | | | | |
| | | | | | |

VI. Well Test Data

| | | | | | |
|--------------|-------------------|-----------|-------------|---------------|---------------|
| Date New Oil | Gas Delivery Date | Test Date | Test Length | Tbg. Pressure | Csg. Pressure |
| Choke Size | Oil | Water | Gas | AOF | Test Method |

I hereby certify that the rules of the Oil Conservation Division have been complied with and that the information given above is true and complete to the best of my knowledge and belief.

Signature: *Lori Livingston*

Printed name: Lori Livingston

Title: Production Supervisor

Date: 12/20/96 Phone: 918-492-7900

OIL CONSERVATION DIVISION

Approved by: ORIGINAL SIGNED BY JERRY SEXTON

Title:

Approval Date: JAN 16 1997

If this is a change of operator fill in the OGRID number and name of the previous operator

#000873 Apache Corporation

| | | | |
|---|-----------------------------|--------------------------------|------------------|
| Previous Operator Signature <i>Julia North</i> | Printed Name Julia North | Title Sr Regulatory Analyst | Date 12/20/96 |
|---|-----------------------------|--------------------------------|------------------|

PO Box 1980, Hobbs, NM 88240
District II
811 South First, Artesia, NM 88210
District III
1000 Rio Brazos Rd., Aztec, NM 87410
District IV
2040 South Pacheco, Santa Fe, NM 87505

STATE OF NEW MEXICO
Energy, Minerals & Natural Resources Department

Form C-104
Revised October 18, 1994
Instructions on back
Submit to Appropriate District Office
5 Copies

OIL CONSERVATION DIVISION
2040 South Pacheco
Santa Fe, NM 87505

☐ AMENDED REPORT

I. REQUEST FOR ALLOWABLE AND AUTHORIZATION TO TRANSPORT

| | | |
|--|--|---|
| Operator name and Address Bristol Resources Corporation 6655 S. Lewis - Ste 200 Tulsa, OK 74136 | | OGRID Number 002894 |
| | | Reason for Filing Code CH - Effective 1/1/97 |
| API Number 30 - 025- 11641 | Pool Name Jalmat Tansill Yates Seven Rivers | Pool Code 33820 |
| Property Code 16821 20157 | Property Name South Langlie JAL Unit | Well Number 027 |

II. Surface Location

| | | | | | | | | | |
|--------------------|---------------|-----------------|--------------|---------|----------------------|---------------------------|-----------------------|------------------------|---------------|
| UL or lot no. N | Section 17 | Township 25S | Range 37E | Lot Idn | Feet from the 990 | North/South Line South | Feet from the 2310 | East/West line West | County Lea |
|--------------------|---------------|-----------------|--------------|---------|----------------------|---------------------------|-----------------------|------------------------|---------------|

Bottom Hole Location

| | | | | | | | | | |
|---------------|----------------------------|-------------------------------|---------------------|----------------------|-----------------------|------------------|---------------|----------------|--------|
| UL or lot no. | Section | Township | Range | Lot Idn | Feet from the | North/South line | Feet from the | East/West line | County |
| Lse Code P | Producing Method Code P | Gas Connection Date 1/1/79 | C-129 Permit Number | C-129 Effective Date | C-129 Expiration Date | | | | |

III. Oil and Gas Transporters

| | | | | |
|-------------------|--|---------|-----|------------------------------------|
| Transporter OGRID | Transporter Name and Address | POD | O/G | POD ULSTR Location and Description |
| 020667 | Shell Pipeline Corporation PO Box 2648 Houston, TX 77252 | 2480110 | 0 | |
| 020809 | Sid Richardson Gasoline Co 201 Main St - Ste 3000 Ft Worth, TX 76102 | 2480130 | G | |
| | | | | |
| | | | | |
| | | | | |

IV. Produced Water

| | |
|----------------|------------------------------------|
| POD 2480150 | POD ULSTR Location and Description |
|----------------|------------------------------------|

V. Well Completion Data

| | | | | | |
|-----------|----------------------|-----------|--------------|--------------|-------------|
| Spud Date | Ready Date | TD | PBTD | Perforations | DHC, DC, MC |
| Hole Size | Casing & Tubing Size | Depth Set | Sacks Cement | | |
| | | | | | |
| | | | | | |
| | | | | | |

VI. Well Test Data

| | | | | | |
|--------------|-------------------|-----------|-------------|---------------|---------------|
| Date New Oil | Gas Delivery Date | Test Date | Test Length | Tbg. Pressure | Csg. Pressure |
| Choke Size | Oil | Water | Gas | AOF | Test Method |

I hereby certify that the rules of the Oil Conservation Division have been complied with and that the information given above is true and complete to the best of my knowledge and belief.

Signature: *Lori Livingston*

Printed name: Lori Livingston

Title: Production Supervisor

Date: 12/20/96

Phone: 918-492-7900

OIL CONSERVATION DIVISION

Approved by: ORIGINAL SIGNED BY JERRY SEXTON

DEPUTY SUPERVISOR

Title:

Approval Date:

JAN 10 1997

* If this is a change of operator fill in the OGRID number and name of the previous operator

#000873 Apache Corporation

Previous Operator Signature

Printed Name

Title

Date

Julia North
Julia North

Sr Regulatory Analyst

12/20/96

OIL CONSERVATION COMMISSION

Date November 27, 1953Western Natural Gas Co.Woolworth1

Operator

Lease

Well No.

Name of Producing Formation Yates

Pool

JalcoNo. Acres Dedicated to the Well 160

SECTION

17

TOWNSHIP

255

RANGE

37E

| | | | |
|---|--|--|--|
| <p>1. How many acres of land are included in the well? <u>160</u></p> <p>2. Is the gas well a dual completion? <u>Yes</u></p> | | <p>3. If the answer to Question 2 is "Yes", please specify the location of all other dual completions within the dedicated area.</p> | <p>4. If the answer to Question 2 is "Yes", please specify the location of all other dual completions within the dedicated area.</p> |
| | | <p>5. If the answer to Question 2 is "Yes", please specify the location of all other dual completions within the dedicated area.</p> | <p>6. If the answer to Question 2 is "Yes", please specify the location of all other dual completions within the dedicated area.</p> |
| | | | |
| | | | |

I hereby certify that the information given above is true and complete to the best of my knowledge.

Name W. M. KeyPosition Division SuperintendentRepresenting Western Natural Gas CompanyAddress 823 Midland Tower, Midland, Texas

(over)

Knowledge and belief.

Signature: SA MV

Printed name:

Steven L. Burleson

Title:

Vice-PresidentDate: 9/4/98Phone: 915/683-4747

Approved by:

ORIGINAL SIGNED BY
GARY WINK
FIELD REP. II

Title:

Approval Date:

SEP 15 1998

If this is a change of operator (U) in the OGRID number and name of the previous operator

Previous Operator Signature

Printed Name

Title

Date

STATE OF NEW MEXICO
ENERGY, MINERALS AND NATURAL RESOURCES DEPARTMENTOIL CONSERVATION DIVISION
HOBBS DISTRICT OFFICEBRUCE KING
GOVERNORPOST OFFICE BOX 1980
HOBBS, NEW MEXICO 88241-1980
(505) 393-6161

May 20, 1993

Lewis B. Burleson Inc.
ATT: Steven L Burleson
P O Box 2479
Midland, TX 79702RE: Reclassification of Well
JALMAT TANSILL YATES SR
Woolworth WN, #1-A, Sec.17-T25S-R36E

Gentlemen:

Due to the recently submitted gas/oil ratio test for the above-referenced well, it will be reclassified from a gas well to an oil well in the Jalmat Pool effective July 1, 1993 and the gas allowable cancelled effective that date.

This test does not conform with the previous characteristics of this well and if you feel this test does not reflect the proper classification of this well, please submit another test for our consideration by May 28, 1993.

If the well is to be reclassified to oil, please furnish this office with the following:

- 1.) C-102 outlining 40 ac. to be dedicated to oil well completion.
- 2.) C-104 showing reclassification from gas to oil and designating oil & casinghead gas transporters.

If you have further question, please feel free to contact Evelyn or Donna at District I office, Hobbs NM (505) 393-6161.

Very truly yours,

OIL CONSERVATION DIVISION

Jerry Sexton
District I, Supervisor*submitted new test remains gas*JS:dp
5/21/93

Attached you will find a corrected filing of a C-116 on the above referenced well. The original C-116 filed, contained a clerical error, showing 4 BO instead of 2 BO. Should you have any further questions, feel free to call this office.

Steven L Burleson

District I
PO Box 1900, Hobbs, NM 88241-1900
District II
PO Drawer DD, Artesia, NM 88211-0719
District III
1000 Rio Brazos Rd., Aztec, NM 87410
District IV
PO Box 2088, Santa Fe, NM 87504-2088

State of New Mexico
Energy, Minerals & Natural Resources Department

OIL CONSERVATION DIVISION
PO Box 2088
Santa Fe, NM 87504-2088

Form C-104
Revised February 10, 1994
Instructions on back
Submit to Appropriate District Office
5 Copies

☐ AMENDED REPORT

I. REQUEST FOR ALLOWABLE AND AUTHORIZATION TO TRANSPORT

| | | |
|---|--------------------------------|-----------------------|
| Operator name and Address Lewis B. Burleson, Inc. P.O. Box 2479 Midland, Texas 79702 | | OGRID Number 13300 |
| Reason for Filing Code CG | | SEP 01 1998 |
| API Number 30-025-11632 | Pool Name JALMAT (T-YIS-TR) | Pool Code 79240 |
| Property Code 005906 | Property Name WOOLWORTH WN | Well Number 1 |

II. ¹⁰ Surface Location

| UL or lot no. | Section | Township | Range | Lot Ida | Feet from the | North/South Line | Feet from the | East/West Line | County |
|---------------|---------|----------|-------|---------|---------------|------------------|---------------|----------------|--------|
| A | 17 | 255 | 37E | | 330 | NORTH | 990 | EAST | LEA |

¹¹ Bottom Hole Location

| UL or lot no. | Section | Township | Range | Lot Ida | Feet from the | North/South Line | Feet from the | East/West Line | County |
|---------------|----------------------------|---------------------|-------|---------------------|---------------|----------------------|---------------|-----------------------|--------|
| | | | | | | | | | |
| Lee Code F | Producing Method Code P | Gas Connection Date | | C-129 Permit Number | | C-129 Effective Date | | C-129 Expiration Date | |

III. Oil and Gas Transporters

| Transporter OGRID | Transporter Name and Address | POD | O/G | POD ULSTR Location and Description |
|-------------------|--|---------|-----|------------------------------------|
| 024650 | Dynegy Midstream Services, Limited Partnership | 1172530 | G | |
| 167356 | SCURLOCK PERMIAN LLC | 1172510 | O | |
| | | | | |
| | | | | |
| | | | | |
| | | | | |

IV. Produced Water

| POD | POD ULSTR Location and Description |
|---------|------------------------------------|
| 1172550 | |

V. Well Completion Data

| Spud Date | Ready Date | TD | FSTD | Perforations |
|-----------|----------------------|-----------|--------------|--------------|
| | | | | |
| Hole Size | Casing & Tubing Size | Depth Set | Sacks Cement | |
| | | | | |
| | | | | |
| | | | | |
| | | | | |

VI. Well Test Data

| Date New Oil | Gas Delivery Date | Test Date | Test Length | Tbg. Pressure | Csg. Pressure |
|--------------|-------------------|-----------|-------------|---------------|---------------|
| | | | | | |
| Choke Size | Oil | Water | Gas | AOF | Test Method |
| | | | | | |

I hereby certify that the rules of the Oil Conservation Division have been complied with and that the information given above is true and complete to the best of my knowledge and belief.

Signature:

Printed name:

Steven L. Burleson

Title:

Vice-President

Date:

9/4/98

Phone:

915/683-4747

Approved by:

Title:

Approval Date:

OIL CONSERVATION DIVISION

ORIGINAL SIGNED BY
GARY WINK
FIELD REP. II

SEP 15 1998

If this is a change of operator fill in the OGRID number and name of the previous operator

Previous Operator Signature

Printed Name

Title

Date

I. REQUEST FOR ALLOWABLE AND AUTHORIZATION TO TRANSPORT

| | | |
|--|--|---|
| Operator name and Address Bristol Resources Corporation 6655 S. Lewis - Ste 200 Tulsa, OK 74136 | | OGRID Number 002894 |
| | | Reason for Filing Code CH - Effective 1/1/97 |
| API Number 30 - 025- 11647 | Pool Name Jalmat Tansill Yates Seven Rivers | Pool Code 33820 |
| Property Code 16821 20157 | Property Name South Langlie JAL Unit | Well Number 015 |

II. Surface Location

| | | | | | | | | | |
|--------------------|---------------|-----------------|--------------|---------|----------------------|---------------------------|-----------------------|------------------------|---------------|
| UL or lot no. C | Section 17 | Township 25S | Range 37E | Lot Idn | Feet from the 990 | North/South Line North | Feet from the 1980 | East/West line West | County Lea |
|--------------------|---------------|-----------------|--------------|---------|----------------------|---------------------------|-----------------------|------------------------|---------------|

Bottom Hole Location

| | | | | | | | | | |
|---------------|---------------------------------|---------------------|---------------------|----------------------|-----------------------|------------------|---------------|----------------|--------|
| UL or lot no. | Section | Township | Range | Lot Idn | Feet from the | North/South line | Feet from the | East/West line | County |
| Lse Code P | Producing Method Code Inject | Gas Connection Date | C-129 Permit Number | C-129 Effective Date | C-129 Expiration Date | | | | |

III. Oil and Gas Transporters

| Transporter OGRID | Transporter Name and Address | POD | O/G | POD ULSTR Location and Description |
|-------------------|------------------------------|-----|-----|------------------------------------|
| | | | | |
| | | | | |
| | | | | |
| | | | | |
| | | | | |
| | | | | |
| | | | | |

IV. Produced Water

| | |
|-----|------------------------------------|
| POD | POD ULSTR Location and Description |
|-----|------------------------------------|

V. Well Completion Data

| | | | | | |
|-----------|----------------------|-----------|--------------|--------------|-------------|
| Spud Date | Ready Date | TD | PBTD | Perforations | DHC, DC, MC |
| Hole Size | Casing & Tubing Size | Depth Set | Sacks Cement | | |
| | | | | | |
| | | | | | |
| | | | | | |
| | | | | | |

VI. Well Test Data

| | | | | | |
|--------------|-------------------|-----------|-------------|---------------|---------------|
| Date New Oil | Gas Delivery Date | Test Date | Test Length | Tbg. Pressure | Csg. Pressure |
| Choke Size | Oil | Water | Gas | AOF | Test Method |

I hereby certify that the rules of the Oil Conservation Division have been complied with and that the information given above is true and complete to the best of my knowledge and belief.

Signature: *Lori Livingston*

Printed name: Lori Livingston

Title: Production Supervisor

Date: 12/20/96 Phone: 918-492-7900

OIL CONSERVATION DIVISION

Approved by: ORIGINAL SIGNED BY JERRY CEXTON
DISTRICT I OIL CONSERVATOR

Title:

Approval Date: JAN 16 1997

If this is a change of operator fill in the OGRID number and name of the previous operator

#000873 Apache Corporation

Previous Operator Signature: *Julia North* Printed Name: Julia North Title: Sr Regulatory Analyst Date: 12/20/96

I. REQUEST FOR ALLOWABLE AND AUTHORIZATION TO TRANSPORT

| | | |
|--|--|---|
| Operator name and Address Bristol Resources Corporation 6655 S. Lewis - Ste 200 Tulsa, OK 74136 | | OGRID Number 002894 |
| | | Reason for Filing Code CH - Effective 1/1/97 |
| API Number 30 - 025-11642 | Pool Name Jalmat Tansill Yates Seven Rivers | Pool Code 33820 |
| Property Code 16821 2D157 | Property Name South Langlie JAL Unit | Well Number 018 |

II. Surface Location

| | | | | | | | | | |
|--------------------|---------------|-----------------|--------------|---------|-----------------------|---------------------------|----------------------|------------------------|---------------|
| UL or lot no. E | Section 17 | Township 25S | Range 37E | Lot Idn | Feet from the 1980 | North/South Line North | Feet from the 990 | East/West line West | County Lea |
|--------------------|---------------|-----------------|--------------|---------|-----------------------|---------------------------|----------------------|------------------------|---------------|

Bottom Hole Location

| | | | | | | | | | |
|---------------|---------------------------------|---------------------|---------------------|----------------------|-----------------------|------------------|---------------|----------------|--------|
| UL or lot no. | Section | Township | Range | Lot Idn | Feet from the | North/South line | Feet from the | East/West line | County |
| Lse Code P | Producing Method Code Inject | Gas Connection Date | C-129 Permit Number | C-129 Effective Date | C-129 Expiration Date | | | | |

III. Oil and Gas Transporters

| Transporter OGRID | Transporter Name and Address | POD | O/G | POD ULSTR Location and Description |
|-------------------|------------------------------|-----|-----|------------------------------------|
| | | | | |
| | | | | |
| | | | | |
| | | | | |
| | | | | |

IV. Produced Water

| | |
|-----|------------------------------------|
| POD | POD ULSTR Location and Description |
|-----|------------------------------------|

V. Well Completion Data

| | | | | | |
|-----------|----------------------|-----------|--------------|--------------|-------------|
| Spud Date | Ready Date | TD | PBTD | Perforations | DHC, DC, MC |
| Hole Size | Casing & Tubing Size | Depth Set | Sacks Cement | | |
| | | | | | |
| | | | | | |
| | | | | | |

VI. Well Test Data

| | | | | | |
|--------------|-------------------|-----------|-------------|---------------|---------------|
| Date New Oil | Gas Delivery Date | Test Date | Test Length | Tbg. Pressure | Csg. Pressure |
| Choke Size | Oil | Water | Gas | AOF | Test Method |

I hereby certify that the rules of the Oil Conservation Division have been complied with and that the information given above is true and complete to the best of my knowledge and belief.

Signature: *Lori Livingston*

Printed name: Lori Livingston

Title: Production Supervisor

Date: 12/20/96

Phone: 918-492-7900

OIL CONSERVATION DIVISION

Approved by: ORIGINAL SIGNED BY JERRY SEXTON

Title: DISTRICT ENGINEER

Approval Date: JAN 16 1997

If this is a change of operator fill in the OGRID number and name of the previous operator

#000873 Apache Corporation

Previous Operator Signature: *Julia North*

Printed Name: Julia North

Title: Sr Regulatory Analyst

Date: 12/20/96

istrict I
Box 1980, Hobbs, NM 88201

istrict II
11 South First, Artesia, NM 88210

istrict III
100 Rio Brazos Rd., Aztec, NM 87410

istrict IV
140 South Pacheco, Santa Fe, NM 87505

State of New Mexico
Energy, Minerals & Natural Resources Department

OIL CONSERVATION DIVISION

2040 South Pacheco

Santa Fe, NM 87505

Revised October 18, 1994

Instructions on back

Submit to Appropriate District Office

5 Copies

☐ AMENDED REPORT

REQUEST FOR ALLOWABLE AND AUTHORIZATION TO TRANSPORT

Operator name and Address

Bristol Resources Corporation
6655 S. Lewis - Ste 200
Tulsa, OK 74136

OGRID Number

002894

Reason for Filing Code

CH - Effective 1/1/97

API Number

30 - 025- 11640

Pool Name

Jalmat Tansill Yates Seven Rivers

Pool Code

33820

Property Code

16821 2D157

Property Name

South Langlie JAL Unit

Well Number

019

I. Surface Location

| UL or lot no. | Section | Township | Range | Lot Idn | Feet from the | North/South Line | Feet from the | East/West line | County |
|---------------|---------|----------|-------|---------|---------------|------------------|---------------|----------------|--------|
| F | 17 | 25S | 37E | | 1980 | North | 1980 | West | Lea |

Bottom Hole Location

| UL or lot no. | Section | Township | Range | Lot Idn | Feet from the | North/South line | Feet from the | East/West line | County |
|---------------|---------|----------|-------|---------|---------------|------------------|---------------|----------------|--------|
| | | | | | | | | | |

| Lse Code | Producing Method Code | Gas Connection Date | C-129 Permit Number | C-129 Effective Date | C-129 Expiration Date |
|----------|-----------------------|---------------------|---------------------|----------------------|-----------------------|
| P | P | 1/1/52 | | | |

Oil and Gas Transporters

| Transporter OGRID | Transporter Name and Address | POD | O/G | POD ULSTR Location and Description |
|-------------------|--|---------|-----|------------------------------------|
| 020667 | Shell Pipeline Corporation PO Box 2648 Houston, TX 77252 | 2480110 | 0 | |
| 020809 | Sid Richardson Gasoline Co 201 Main St - Ste 3000 Ft Worth, TX 76102 | 2480130 | G | |
| | | | | |
| | | | | |
| | | | | |

Produced Water

| POD | POD ULSTR Location and Description |
|---------|------------------------------------|
| 2480150 | |

Well Completion Data

| Spud Date | Ready Date | TD | PBTD | Perforations | DHC, DC,MC |
|-----------|------------|----|------|--------------|------------|
| | | | | | |
| | | | | | |
| | | | | | |
| | | | | | |

| Hole Size | Casing & Tubing Size | Depth Set | Sacks Cement |
|-----------|----------------------|-----------|--------------|
| | | | |
| | | | |
| | | | |
| | | | |

Well Test Data

| Date New Oil | Gas Delivery Date | Test Date | Test Length | Tbg. Pressure | Csg. Pressure |
|--------------|-------------------|-----------|-------------|---------------|---------------|
| | | | | | |
| | | | | | |

| Choke Size | Oil | Water | Gas | AOF | Test Method |
|------------|-----|-------|-----|-----|-------------|
| | | | | | |
| | | | | | |

I hereby certify that the rules of the Oil Conservation Division have been complied with and that the information given above is true and complete to the best of my knowledge and belief.

Signature: *Lori Livingston*

Printed name: Lori Livingston

Title: Production Supervisor

Date: 12/20/96

Phone: 918-492-7900

OIL CONSERVATION DIVISION

APPROVED BY: *[Signature]*

DISTRICT SUPERVISOR

Approved by: [Signature]

Title:

Approval Date: JAN 16 1997

If this is a change of operator fill in the OGRID number and name of the previous operator

#000873 Apache Corporation

Previous Operator Signature: *[Signature]*

Printed Name: Julia North

Title: Sr Regulatory Analyst

Date: 12/20/96

F. FORM: Apache Corp

NEW MEXICO OIL CONSERVATION COMMISSION WELL LOCATION AND ACREAGE DEDICATION PLAT

Form C-102
Supersedes C-128
Effective 1-1-65

All distances must be from the outer boundaries of the Section.

| | | | | | |
|--|-------------------------------------|------------------------------|-----------------------------|-----------------------|--|
| Operator DOYLE HARTMAN | | Lease B. M. JUSTIS | | Well No. 11 | |
| Unit Letter G | Section 20 | Township 25 SOUTH | Range 37 EAST | County LEA | |
| Actual Footage Location of Well: 1980 feet from the NORTH line and 2210 feet from the EAST line | | | | | |
| Ground Level Elev. 3071.0 | Producing Formation Yates | | Pool Jalmat (Gas) | | Dedicated Acreage: 120 Acres |

1. Outline the acreage dedicated to the subject well by colored pencil or hachure marks on the plat below.
2. If more than one lease is dedicated to the well, outline each and identify the ownership thereof (both as to working interest and royalty).
3. If more than one lease of different ownership is dedicated to the well, have the interests of all owners been consolidated by communitization, unitization, force-pooling, etc?

☐ Yes ☐ No If answer is "yes," type of consolidation _____

If answer is "no," list the owners and tract descriptions which have actually been consolidated. (Use reverse side of this form if necessary.) _____

No allowable will be assigned to the well until all interests have been consolidated (by communitization, unitization, forced-pooling, or otherwise) or until a non-standard unit, eliminating such interests, has been approved by the Commission.

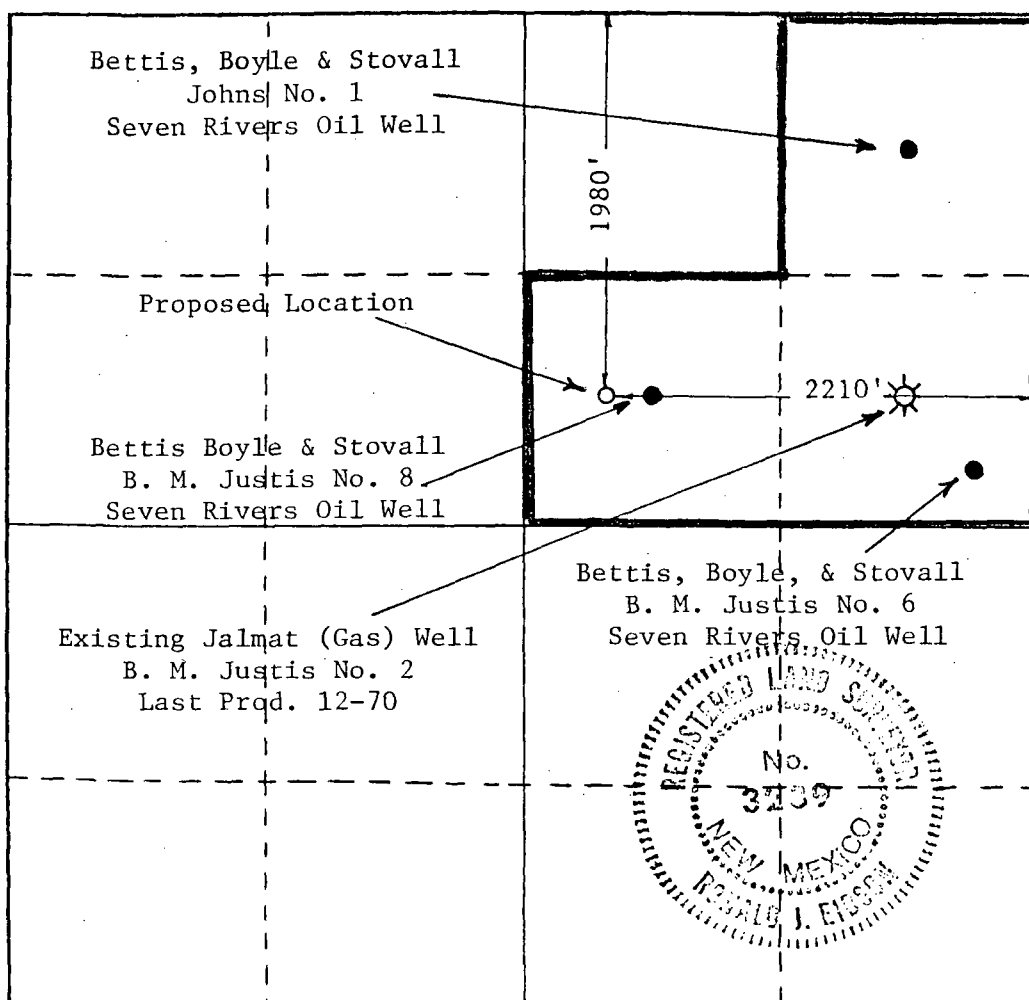

CERTIFICATION

I hereby certify that the information contained herein is true and complete to the best of my knowledge and belief.

Name
Larry A. Nimmer

Position
Engineer

Company
Doyle Hartman

Date
May 26, 1982

I hereby certify that the well location shown on this plat was plotted from field notes of actual surveys made by me or under my supervision, and that the same is true and correct to the best of my knowledge and belief.

Date Surveyed
May 21, 1982

Registered Professional Engineer

[Signature]

OIL CONSERVATION DIVISION
PO Box 2088
Santa Fe, NM 87504-2088

☐ AMENDED REPORT

REQUEST FOR ALLOWABLE AND AUTHORIZATION TO TRANSPORT

| | | | |
|--|--|------------------------|---------------------------------------|
| Operator name and Address Pettis Boyle & Stovall PO Box 1240 Graham Texas 76450 | | Classified as oil well | OGRID Number 002175 |
| | | | Reason for Filing Code CO-11-01-96 |
| API Number 25-11661 | Pool Name Jalmat Tansill Yates Seven Rivers | | Pool Code 33820 |
| Property Code 2009 | Property Name Johns Federal | | Well Number 001 |

| 10 Surface Location | | | | | | | | | |
|---------------------|----------|-------|---------|---------------|------------------|---------------|----------------|--------|--|
| Section | Township | Range | Lot Ida | Feet from the | North/South Line | Feet from the | East/West line | County | |
| 20 | 25S | 37E | | 660 | North | 660 | East | Lea | |

| 11 Bottom Hole Location | | | | | | | | | |
|-------------------------|----------------------------|---------------------|---------------------|----------------------|-----------------------|---------------|----------------|--------|--|
| Section | Township | Range | Lot Ida | Feet from the | North/South line | Feet from the | East/West line | County | |
| | | | | | | | | | |
| Code | Producing Method Code P | Gas Connection Date | C-129 Permit Number | C-129 Effective Date | C-129 Expiration Date | | | | |

| Oil and Gas Transporters | | | | |
|--------------------------|--|---------|-----|------------------------------------|
| Transporter OGRID | Transporter Name and Address | POD | O/G | POD ULSTR Location and Description |
| 09 | Sid Richardson Gasoline Co. 201 Main Street Ft. Worth, Texas 79702 | 0551530 | G | A 20 25S 37E |
| 53 | Lantern Petroleum Corp. PO Box 2281 Midland, Texas 79702 | 0551510 | O | A 20 25S 37E |
| | | | | |
| | | | | |
| | | | | |

| Produced Water | |
|----------------|------------------------------------|
| POD | POD ULSTR Location and Description |
| | |

| Well Completion Data | | | | |
|----------------------|----------------------|-----------|--------------|--------------|
| Spud Date | Ready Date | TD | PBTD | Perforations |
| | | | | |
| Hole Size | Casing & Tubing Size | Depth Set | Sacks Cement | |
| | | | | |
| | | | | |
| | | | | |

| Well Test Data | | | | | |
|----------------|-------------------|-----------|-------------|---------------|---------------|
| Date New Oil | Gas Delivery Date | Test Date | Test Length | Tog. Pressure | Cig. Pressure |
| | | | | | |
| Choke Size | Oil | Water | Gas | AOF | Test Method |
| | | | | | |

| | | | |
|--|--|---|--|
| I hereby certify that the rules of the Oil Conservation Division have been complied with and that the information given above is true and complete to the best of my knowledge and belief. | | OIL CONSERVATION DIVISION ORIGINAL SIGNED BY DISTRICT SUPERVISOR | |
| Signature: Kim Ligon | | Approved by: DISTRICT SUPERVISOR | |
| Name: Kim Ligon | | Title: | |
| Regulatory Analyst | | Approval Date: OCT 10 1996 | |
| 10/08/96 | | Phone: 817-549-0780 | |

| | | | |
|---|--------------|-------|------|
| This is a change of operator fill in the OGRID number and name of the previous operator | | | |
| Previous Operator Signature | Printed Name | Title | Date |
| | | | |

istrict I
Box 1980, Hobbs, NM 88241-1980
istrict II
Drawer DD, Artesia, NM 88211-0719
istrict III
00 Rio Brazos Rd., Aztec, NM 87410
istrict IV
Box 2088, Santa Fe, NM 87504-2088

OIL CONSERVATION DIVISION
PO Box 2088
Santa Fe, NM 87504-2088

☐ AMENDED REPORT

REQUEST FOR ALLOWABLE AND AUTHORIZATION TO TRANSPORT

| | | |
|---|--|---------------------------------------|
| Operator name and Address Bettis Boyle & Stovall P O Box 1240 Graham Texas 76450 | | OGRID Number 002175 |
| | | Reason for Filing Code CO-11-01-96 |
| API Number 30 - 025-11665 | Pool Name Jalmat Tansill Yates Seven Rivers | Pool Code 33820 |
| Property Code 002010 | Property Name B M Justis A | Well Number 003 |

I. Surface Location

| UL or lot no. | Section | Township | Range | Lot Idn | Feet from the | North/South Line | Feet from the | East/West line | County |
|---------------|---------|----------|-------|---------|---------------|------------------|---------------|----------------|--------|
| B | 20 | 25S | 37E | | 990 | North | 1980 | East | Lea |

II. Bottom Hole Location

| UL or lot no. | Section | Township | Range | Lot Idn | Feet from the | North/South line | Feet from the | East/West line | County |
|---------------|---------|----------|-------|---------|---------------|------------------|---------------|----------------|--------|
| | | | | | | | | | |

| Lee Code | Producing Method Code | Gas Connection Date | C-129 Permit Number | C-129 Effective Date | C-129 Expiration Date |
|----------|-----------------------|---------------------|---------------------|----------------------|-----------------------|
| P | P | | | | |

III. Oil and Gas Transporters

| Transporter OGRID | Transporter Name and Address | POD | O/G | POD ULSTR Location and Description |
|-------------------|--|---------|-----|------------------------------------|
| 020809 | Sid Richardson Gasoline Co. 201 Main Street Ft. Worth, Texas 79702 | 0551630 | G | B 20 25S 37E |
| 013063 | Lantern Petroleum Corp. P O Box 2281 Midland, Texas 79702 | 0551610 | O | B 20 25S 37E |
| | | | | |
| | | | | |
| | | | | |

IV. Produced Water

| POD | POD ULSTR Location and Description |
|-----|------------------------------------|
| | |

V. Well Completion Data

| Spud Date | Ready Date | TD | PBTD | Perforations |
|-----------|------------|----|------|--------------|
| | | | | |
| | | | | |
| | | | | |
| | | | | |

| Hole Size | Casing & Tubing Size | Depth Set | Sacks Cement |
|-----------|----------------------|-----------|--------------|
| | | | |
| | | | |
| | | | |
| | | | |

VI. Well Test Data

| | | | | | |
|---|-------------------|-----------|---|---------------|---------------|
| Date New Oil | Gas Delivery Date | Test Date | Test Length | Tbg. Pressure | Gas. Pressure |
| Choke Size | Oil | Water | Gas | AOF | Test Method |
| I hereby certify that the rules of the Oil Conservation Division have been complied with and that the information given above is true and complete to the best of my knowledge and belief. Signature: <i>Kim Ligon</i> | | | OIL CONSERVATION DIVISION ORIGINAL SIGNED BY JERRY SEXTON DISTRICT I SUPERVISOR | | |
| Printed name: Kim Ligon | | | Approved by: | | |
| Title: Regulatory Analyst | | | Title: | | |
| Date: 10/08/96 | | | Approval Date: OCT 15 1996 | | |
| Phone: 817-549-0780 | | | | | |

| | | | |
|--|--------------|-------|------|
| If this is a change of operator fill in the OGRID number and name of the previous operator | | | |
| Previous Operator Signature | Printed Name | Title | Date |
| | | | |

Well Location

Section A.

Operator Leonard Oil Company Lease B.M. Justis Date June 19, 1977
 Well No. 7 Unit Letter F Section 20 Township 25S Range 37E NMPM
 Located 1960' Feet From North Line, 1980' Feet From West Line
 County Lea G. L. Elevation 3075.6 Dedicated Acreage 160 Acres
 Name of Producing Formation Yates Pool Jalmat (Gas)

1. Is the Operator the only owner* in the dedicated acreage outlined on the plat below?
 Yes X No
2. If the answer to question one is "no," have the interests of all the owners been consolidated by communitization agreement or otherwise? Yes No . If answer is "yes," Type of Consolidation
3. If the answer to question two is "no," list all the owners and their respective interests below:

Owner

Land Description

Now 8 Bettis and Stoval

P.O. Box 1240

Graham, Tx. 76450

Section B

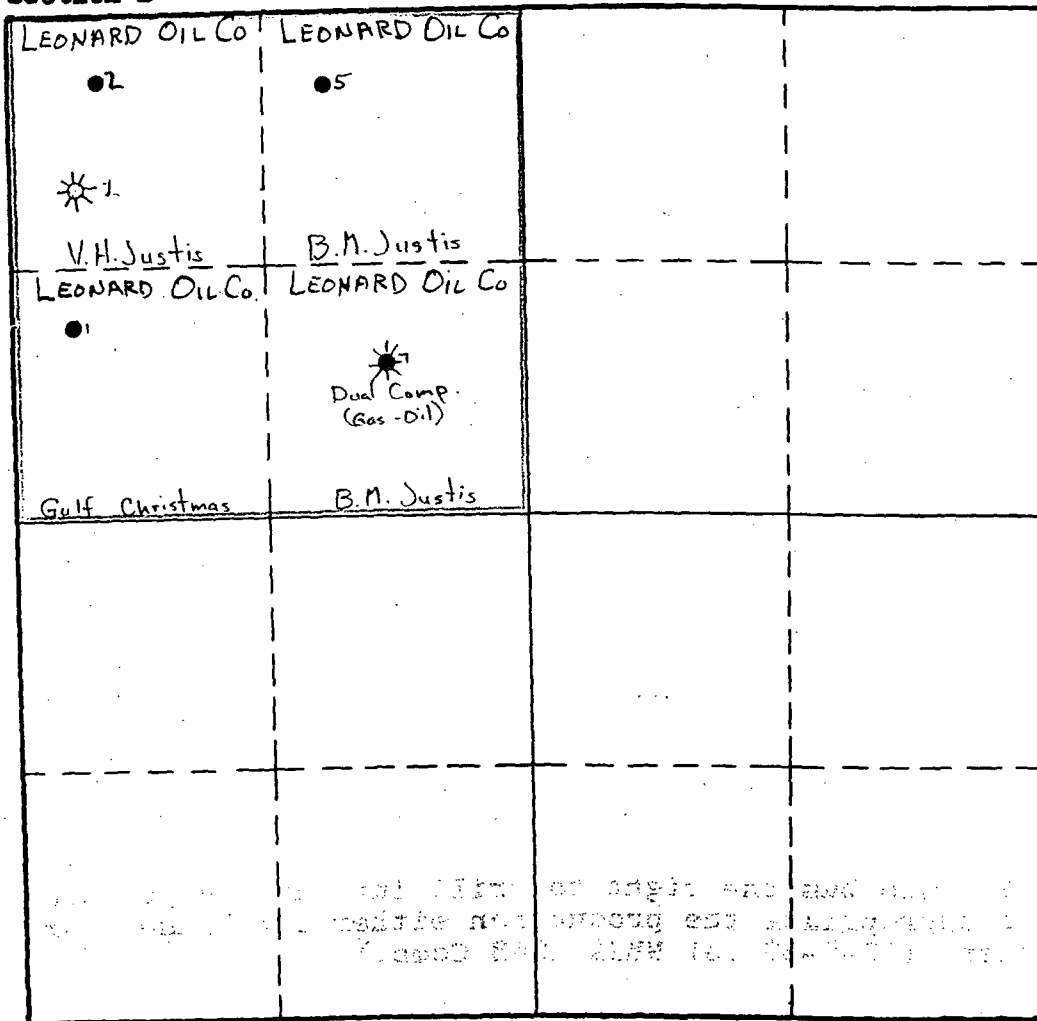

This is to certify that the information in Section A above is true and complete to the best of my knowledge and belief.

Leonard Oil Company

(Operator)

Powder Mill

(Representative) Gen. Mgr.

Box 708, Roswell, New Mexico
 Address

This is to certify that the well location shown on the plat in Section B was plotted from field notes of actual surveys made by me or under my supervision and that the same is true and correct to the best of my knowledge and belief.

Date Surveyed

Registered Professional Engineer and/or Land Surveyor.

Certificate No.

(See instructions for completing this form on the reverse side)

UNITED STATES P. O. BOX 1980
DEPARTMENT OF THE INTERIOR
BUREAU OF LAND MANAGEMENT
MIDLAND, NEW MEXICO 88240FORM APPROVED
Budget Bureau No. 1004-0135
Expires: March 31, 1993

5. Lease Designation and Serial No.

NM 036452 act

6. If Indian, Allottee or Tribe Name

7. If Unit or CA, Agreement Designation

8910115870

8. Well Name and No.

Langlie Jal Unit #90

9. API Well No.

30-025-1164300

10. Field and Pool, or Exploratory Area

Langlie Mattix

11. County or Parish, State

Lea County, N. M.

SUNDRY NOTICES AND REPORTS ON WELLS

Do not use this form for proposals to drill or to deepen or reentry to a different reservoir.
Use "APPLICATION FOR PERMIT—" for such proposals

SUBMIT IN TRIPLICATE

1. Type of Well

☒ Oil Well ☐ Gas Well ☐ Other

2. Name of Operator

GP II Energy, Inc.

3. Address and Telephone No.

P. O. Box 50682, Midland, Tx. 79710, 915-684-4748

4. Location of Well (Footage, Sec., T., R., M., or Survey Description)

G, 1650' FNL & 2310' FEL

S 17, T 25S, R 37E

12. CHECK APPROPRIATE BOX(S) TO INDICATE NATURE OF NOTICE, REPORT, OR OTHER DATA

TYPE OF SUBMISSION

- ☐
- Notice of Intent
-
- ☒
- Subsequent Report
-
- ☐
- Final Abandonment Notice

TYPE OF ACTION

- ☐
- Abandonment
-
- ☐
- Recompletion
-
- ☐
- Plugging Back
-
- ☐
- Casing Repair
-
- ☐
- Altering Casing
-
- ☐
- Other
- Add perfs, acidize
-
- ☐
- Change of Plans
-
- ☐
- New Construction
-
- ☐
- Non-Routine Fracturing
-
- ☐
- Water Shut-Off
-
- ☐
- Conversion to Injection
-
- ☐
- Dispose Water

(Note: Report results of multiple completion on Well Completion or Recompletion Report and Log form.)

13. Describe Proposed or Completed Operations (Clearly state all pertinent details, and give pertinent dates, including estimated date of starting any proposed work. If well is directionally drilled, give subsurface locations and measured and true vertical depths for all markers and zones pertinent to this work.)*

05-02-96 - 05-09-96

- MIRU. RIH w/3 7/8" bit, (6) 3 1/8" DCs, & work string. Tag liner top @ 2990'. Tag TD @ 3050'.
- RU reverse unit. Drill 4 1/2" CIBP @ 3100'. Drill plug loose. Chase plug to TD @ 3565'. Drill plug on btm.
- Pull PND log.
- Perf open hole (3/4" @ 3 SPF): 3400'-3420', 3447'-3453', 3463'-3468', 3479'-3487', 3497'-3532', 3539'-3544'. Perf 4 1/2" liner @ 3 SPF: 3150'-3174', 3178'-3210', 3220'-3236', 3250'-3266', 3276'-3292', 3317'-3328'. (Total 194', 582 holes.)
- Clean out to bottom w/3 7/8" bit to. RIH w/4 1/2" pkr. Acidize well w/7000 gals 7 1/2% NeFe w/5 rock salt stages (4900#)
- Release pkr. RIH w/4 1/2" RBP & AD-1 pkr. Set BP @ (+) 3338' & pkr @ 3100'. Acidize isolated interval w/6000 gals 7 1/2% NeFe & 5250# rock salt. Release pkr. Leave BP to isolate zone. SIFN.
- RIH w/retrievable tool for RBP. POOH w/RBP. RIH w/12 jts 2 3/8" tbg & SN, & 94 jts 2 7/8". Land tbg w/SN @ 3325'. Run pump & rods. Hang well on.

ACCEPTED FOR RECORD

OCT 01 1996

14. I hereby certify that the foregoing is true and correct

Signed

Title President

Date 5-13-96

(This space for Federal or State office use)

Approved by

Title

Date

Conditions of approval, if any:

UNITED STATES
DEPARTMENT OF THE INTERIOR
BUREAU OF LAND MANAGEMENT

APPROVED
1004-0135
Expires: March 31, 1993

SUNDRY NOTICES AND REPORTS ON WELLS

Do not use this form for proposals to drill or to deepen or reentry to a different reservoir.
Use "APPLICATION FOR PERMIT—" for such proposals

SUBMIT IN TRIPLICATE

Type of Well
☐ Oil Well ☐ Gas Well ☒ Other Injection

Name of Operator

GP II Energy, Inc.

Address and Telephone No.

P. O. Box 50682 Midland, Tx, 79710 91-684-4748

Location of Well (Footage, Sec., T., R., M., or Survey Description)

H, 1980' FNL & 660' FEL

S 17, T 25S, R 37E

5. Lease Designation and Serial No.

LC-032511-C

6. If Indian, Allottee or Tribe Name

7. If Unit or CA, Agreement Designation

8910115870

8. Well Name and No.

Langlie Jal Unit #89

9. API Well No.

30-025-1163000

10. Field and Pool, or Exploratory Area

Langlie Mattix

11. County or Parish, State

Lea County, N. M.

CHECK APPROPRIATE BOX(S) TO INDICATE NATURE OF NOTICE, REPORT, OR OTHER DATA

TYPE OF SUBMISSION

- ☐ Notice of Intent
☒ Subsequent Report
☐ Final Abandonment Notice

TYPE OF ACTION

- ☐ Abandonment
☐ Recompletion
☐ Plugging Back
☐ Casing Repair
☐ Altering Casing
☒ Other Add perfs. Acidize
☐ Change of Plans
☐ New Construction
☐ Non-Routine Fracturing
☐ Water Shut-Off
☐ Conversion to Injection
☐ Dispose Water

(Note: Report results of multiple completion on Well Completion or Recompletion Report and Log form.)

Describe Proposed or Completed Operations (Clearly state all pertinent details, and give pertinent dates, including estimated date of starting any proposed work. If well is directionally drilled, give subsurface locations and measured and true vertical depths for all markers and zones pertinent to this work.)*

05-08-96 - 05-13-96

Add perfs: 3278'-92', 3298'-3300', 3306'-12', 3316'-3330', 3334'-38', 3348'-88', 3396'-98', 3415'-18', 3434'-36', 3444'-50', 3462'-74', 3481'-84', 3499'-3502', 3505'-10', 3515'-19', 3529'-32', 3538'-42', 3546'-49', 3554'-57', 3560'-64', 3566'-68', 3573'-78'.

Acidize perfs w/6000 gals acid.

Test csg to 300 psi.

Return to injection.

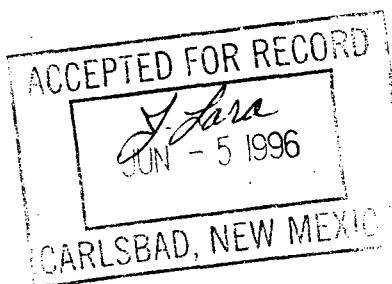

RECEIVED
MAY 16 12 29 PM '96

I hereby certify that the foregoing is true and correct

Signed [Signature] Title President

Date 5-15-96

(This space for Federal or State office use)

Approved by _____
Conditions of approval, if any:

Title _____

Date _____

18 U.S.C. Section 1001, makes it a crime for any person knowingly and willfully to make to any department or agency of the United States any false, fictitious or fraudulent statements or representations as to any matter within its jurisdiction.

*See Instruction on Reverse Side

District I
PO Box 1980, Hobbs, NM 88241-1980
District II
PO Drawer DD, Artesia, NM 88211-0719
District III
1000 Rio Brazos Rd., Aztec, NM 87410
District IV
PO Box 2088, Santa Fe, NM 87504-2088

State of New Mexico
Energy, Minerals & Natural Resources Department

OIL CONSERVATION DIVISION
PO Box 2088
Santa Fe, NM 87504-2088

Form C-102
Revised February 10, 1994
Instructions on back
Submit to Appropriate District Office
State Lease - 4 Copies
Fee Lease - 3 Copies

☐ AMENDED REPORT

WELL LOCATION AND ACREAGE DEDICATION PLAT

| | | |
|---|--|--------------------------------------|
| ¹ API Number 30-025-27517 | ² Pool Code 79240 | ³ Pool Name Jalmat Gas |
| ⁴ Property Code 14895 | ⁵ Property Name Arnott Ramsay NCT-E | ⁶ Well Number 12 |
| ⁷ OGRID No. 000962 | ⁸ Operator Name Arch Petroleum, Inc. | ⁹ Elevation 3030' GL |

¹⁰ Surface Location

| | | | | | | | | | |
|--------------------|---------------|-----------------|--------------|---------|----------------------|---------------------------|-----------------------|------------------------|---------------|
| UL or lot no. C | Section 16 | Township 25S | Range 37E | Lot Idn | Feet from the 660 | North/South line North | Feet from the 1980 | East/West line West | County Lea |
|--------------------|---------------|-----------------|--------------|---------|----------------------|---------------------------|-----------------------|------------------------|---------------|

¹¹ Bottom Hole Location If Different From Surface

| | | | | | | | | | |
|--------------------------------------|-------------------------------|----------------------------------|-------------------------|---------|---------------|------------------|---------------|----------------|--------|
| UL or lot no. | Section | Township | Range | Lot Idn | Feet from the | North/South line | Feet from the | East/West line | County |
| ¹² Dedicated Acres 280 | ¹³ Joint or Infill | ¹⁴ Consolidation Code | ¹⁵ Order No. | | | | | | |

NO ALLOWABLE WILL BE ASSIGNED TO THIS COMPLETION UNTIL ALL INTERESTS HAVE BEEN CONSOLIDATED
OR A NON-STANDARD UNIT HAS BEEN APPROVED BY THE DIVISION

| | |
|---|--|
| ¹⁶ 1980' 660' #12 1980' #11 1980' | ¹⁷ OPERATOR CERTIFICATION I hereby certify that the information contained herein is true and complete to the best of my knowledge and belief Merrick S. Vanderslice Signature Merrick S. Vanderslice Printed Name Vice President of Operations Title 7/8/94 Date |
| ¹⁸ SURVEYOR CERTIFICATION I hereby certify that the well location shown on this plat was plotted from field notes of actual surveys made by me or under my supervision, and that the same is true and correct to the best of my belief. Date of Survey Signature and Seal of Professional Surveyor: Certificate Number | |

NEW MEXICO CONSERVATION COMMISSION
WELL LOCATION AND ACREAGE DEDICATION PLAT

Form C-102
Supersedes C-128
Effective 1-1-65

Post Aug. 2, 1976

All distances must be from the outer boundaries of the Section.

| | | | | | |
|----------------------------------|-----------------------------------|-----------------------------|------------------------------------|---------------|--------------------------------|
| Gulf Oil Corporation | | | Lease Arnott-Ramsay (NCT-E) No. | | Well No. 3 |
| Unit Letter M | Section 16 | Township 25S | Range 37E | County Lea | |
| Actual Footage Location of Well: | | | | | |
| 615 feet from the south line and | | 705 feet from the west line | | | |
| Ground Level Elev. 3095' | Producing Formation Jalmat Gas | | Pool Jalmat Gas | | Dedicated Acreage: 40 Acres |

1. Outline the acreage dedicated to the subject well by colored pencil or hachure marks on the plat below.
2. If more than one lease is dedicated to the well, outline each and identify the ownership thereof (both as to working interest and royalty).
3. If more than one lease of different ownership is dedicated to the well, have the interests of all owners been consolidated by communitization, unitization, force-pooling, etc?

☐ Yes ☐ No If answer is "yes," type of consolidation _____

If answer is "no," list the owners and tract descriptions which have actually been consolidated. (Use reverse side of this form if necessary.) _____

No allowable will be assigned to the well until all interests have been consolidated (by communitization, unitization, forced-pooling, or otherwise) or until a non-standard unit, eliminating such interests, has been approved by the Commission.

| | |
|---------|--|
| NSP-842 | |
| | |
| | |
| | |
| | |

CERTIFICATION

I hereby certify that the information contained herein is true and complete to the best of my knowledge and belief.

Name
ORIGINAL SIGNED BY
C. D. BORLAND
Position
Area Production Manager
Company
Gulf Oil Corporation
Date
July 14, 1971

I hereby certify that the well location shown on this plat was plotted from field notes of actual surveys made by me or under my supervision, and that the same is true and correct to the best of my knowledge and belief.

Date Surveyed
Registered Professional Engineer
and/or Land Surveyor

Certificate No.

0 330 660 990 1320 1650 1980 2310 2640 2000 1500 1000 500 0

District II
811 South 1st, Artesia NM 88210

District III
1000 Rio Bravo Rd. Aztec, NM 87410

District IV
2040 South Pacheco, Santa Fe NM 87505

OIL CONSERVATION DIVISION

2040 South Pacheco
Santa Fe, NM 87505

☐ AMENDED REPORT

REQUEST FOR ALLOWABLE AND AUTHORIZATION TO TRANSPORT

| | | |
|---|---|--|
| 1. Operator name and Address CHANCE PROPERTIES c/o OIL REPORTS & GAS SERVICES, INC. P. O. BOX 755 HOBBS, NEW MEXICO 88241 | | 2. OGRID Number 004058 |
| | | 3. Reason for Filing Code CD- EFFECTIVE 09/01/98 |
| 4. API Number 30-025-11674 | 5. Pool Name JALMATT-Y-SR | 6. Pool Code 33820 |
| 7. Property Code 020814 | 8. Property Name A. B. COATES B | 9. Well Number #001 |

II. 10. Surface Location

| | | | | | | | | | |
|----------------|-----------|------------|------------|-----------|---------------|------------------|---------------|----------------|------------|
| Utr or lot no. | Section | Township | Range | Lot. Idn. | Feet from the | North/South Line | Feet from the | East/West Line | County |
| D | 21 | 25S | 37E | | 660 | North | 660 | West | Lea |

11. Bottom Hole Location

| | | | | | | | | | |
|-------------------------|---------------------------------------|-------------------------|------------|-----------|-------------------------|------------------|--------------------------|----------------|---------------------------|
| Utr or lot no. | Section | Township | Range | Lot. Idn. | Feet from the | North/South Line | Feet from the | East/West Line | County |
| D | 21 | 25S | 37E | | 660 | North | 660 | West | Lea |
| 12. Lm Code F | 13. Producing Method Code P | 14. Gas Connection Date | | | 15. C-129 Permit Number | | 16. C-129 Effective Date | | 17. C-129 Expiration Date |

III. Oil and Gas Transporters

| 18 Transporter OGRID | 19 Transporter Name and Address | 20 POD | 21 O/G | 22 POD ULSTR Location and Description |
|----------------------|---|----------------|----------|---------------------------------------|
| 171771 | WEST TEXAS CRUDE OIL TRANSPORT, INC. P. O. BOX 1119 KERMIT, TX 79745 | 1898010 | O | D-21-25S-37E |
| 020809 | SID RICHARDSON GASOLINE CO. 201 MAIN ST. FORT WORTH, TX 76102 | 1898030 | G | D-21-25S-37E |
| | | | | |
| | | | | |
| | | | | |

IV. Produced Water

| | |
|--------|---------------------------------------|
| 23 POD | 24 POD ULSTR Location and Description |
|--------|---------------------------------------|

V. Well Completion Data

| | | | | | |
|--------------|-------------------------|--------------|---------|-----------------|--------------|
| 25 Spud Date | 26 Ready Date | 27 TD | 28 PBTD | 29 Perforations | 30 DHC, DCMC |
| 31 Hole Size | 32 Casing & Tubing Size | 33 Depth Set | | 34 Sacks Cement | |
| | | | | | |
| | | | | | |
| | | | | | |
| | | | | | |

VI. Well Test Data

| | | | | | |
|-----------------|----------------------|--------------|----------------|------------------|------------------|
| 35 Date New Oil | 36 Gas Delivery Date | 37 Test Date | 38 Test Length | 39 Tbg. Pressure | 40 Csg. Pressure |
| 41 Choke Size | 42 Oil | 43 Water | 44 Gas | 45 ACF | 46 Test Method |

I hereby certify that the rules of Oil Conservation Division have been complied with and that the information given above is true and complete to the best my knowledge and belief.

OIL CONSERVATION DIVISION

| | | | | | | | | |
|---|--|------------------------|--|-----------------------|----------------------|----------------------|--|--|
| Operator BETTIS, BOYLE, & STOVALL | | | Lease B. T. LANEHART | | | Well No. 5 | | |
| Unit Letter G | Section 21 | Township 25S | | Range 37E | County LEA | | | |
| Actual Footage Location of Well: | | | | | | | | |
| 2310 feet from the NORTH line and | | | 2310 feet from the EAST line | | | | | |
| Ground Level Elev. 3075' | Producing Formation YATES-SEVEN RIVERS | | | Pool JALMAT | | | Dedicated Acreage: 160 Acres | |

1. Outline the acreage dedicated to the subject well by colored pencil or hatchure marks on the plat below.
2. If more than one lease is dedicated to the well, outline each and identify the ownership thereof (both as to working interest and royalty).
3. If more than one lease of different ownership is dedicated to the well, have the interests of all owners been consolidated by communitization, unitization, force-pooling, etc?

☐ Yes ☐ No If answer is "yes," type of consolidation _____

If answer is "no," list the owners and tract descriptions which have actually been consolidated. (Use reverse side of this form if necessary.) _____

No allowable will be assigned to the well until all interests have been consolidated (by communitization, unitization, forced-pooling, or otherwise) or until a non-standard unit, eliminating such interests, has been approved by the Commission.

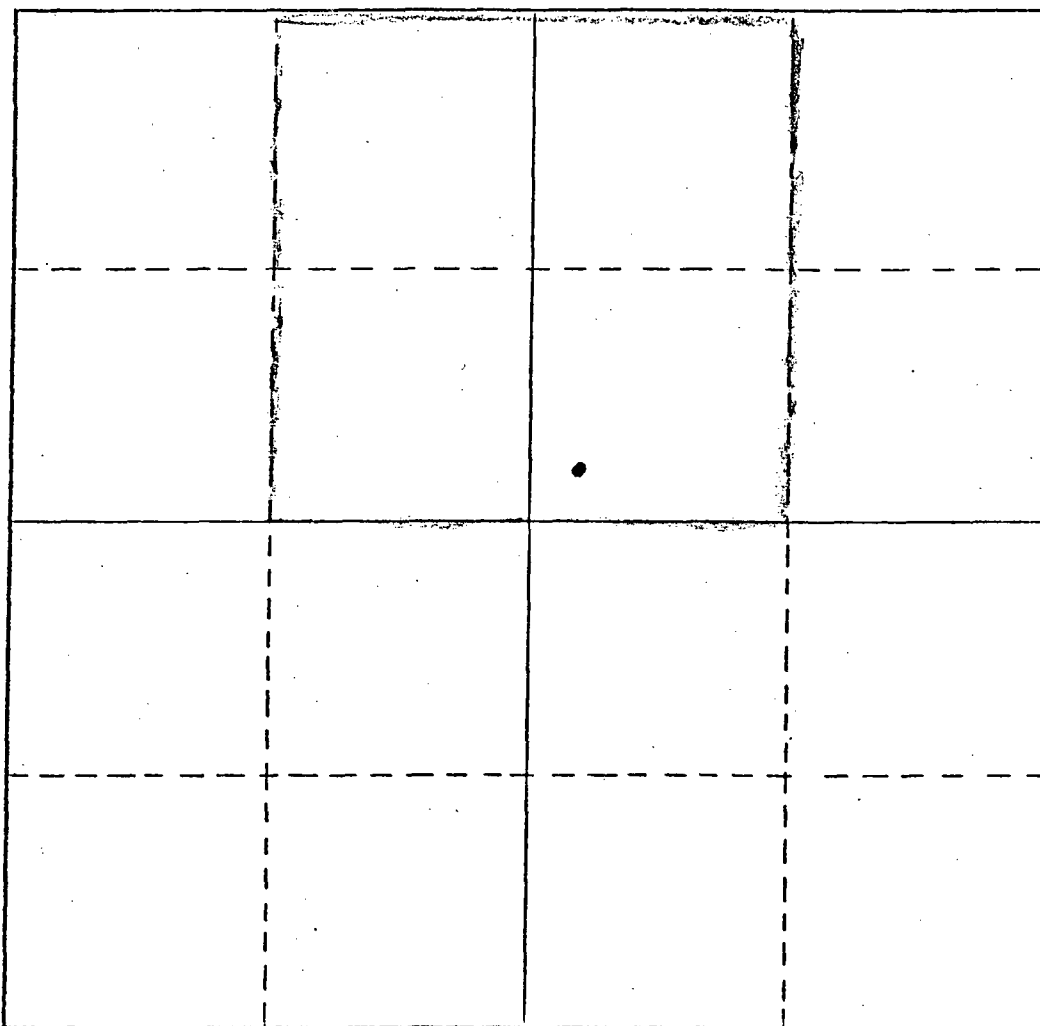

CERTIFICATION

I hereby certify that the information contained herein is true and complete to the best of my knowledge and belief.

Name *Thomas J. Liff*

Position

PROD. SUPT.

Company

BETTIS, BOYLE, & STOVALL

Date

9/22/77

I hereby certify that the well location shown on this plat was plotted from field notes of actual surveys made by me or under my supervision, and that the same is true and correct to the best of my knowledge and belief.

Date Surveyed

Registered Professional Engineer and/or Land Surveyor

Certificate No.

0 330 660 990 1320 1650 1980 2310 2640 2970 3300 3630 3960 4290 4620 4950 5280 5610 5940 6270 6600

**UNITED STATES
DEPARTMENT OF THE INTERIOR
BUREAU OF LAND MANAGEMENT**

SUBMIT IN TRIPLICATE*
(Other instructions on
reverse side)

FORM APPROVED
OMB NO. 1004-0136
Expires: February 28, 1995

| | | | |
|--|-----------------------|---|---------------|
| APPLICATION FOR PERMIT TO DRILL OR DEEPEN | | | |
| 1a. TYPE OF WORK DRILL <input checked="" type="checkbox"/> DEEPEN <input type="checkbox"/> | | 5. LEASE DESIGNATION AND SERIAL NO. NM-0140978 | |
| b. TYPE OF WELL OIL WELL <input type="checkbox"/> GAS WELL <input checked="" type="checkbox"/> OTHER <input type="checkbox"/> SINGLE ZONE <input checked="" type="checkbox"/> MULTIPLE ZONE <input type="checkbox"/> | | 6. IF INDIAN, ALLOTTEE OR TRIBE NAME _____ | |
| 2. NAME OF OPERATOR SDX Resources, Inc. | | 7. UNIT AGREEMENT NAME _____ | |
| 3. ADDRESS AND TELEPHONE NO. PO Box 5061, Midland, TX 79704 915/685-1761 | | 8. FARM OR LEASE NAME, WELL NO. Langlie A Federal #2 | |
| 4. LOCATION OF WELL (Report location clearly and in accordance with any State requirements.)* At surface 660' FSL, 1980' FEL, Sec 17, T25S, R37E, Unit O. At proposed prod. zone _____ | | 9. API WELL NO. _____ | |
| 14. DISTANCE IN MILES AND DIRECTION FROM NEAREST TOWN OR POST OFFICE* 1 miles NW of Jal, NM | | 10. FIELD AND POOL, OR WILDCAT Jalmat, Tansill, Yt, 7R | |
| 15. DISTANCE FROM PROPOSED* LOCATION TO NEAREST PROPERTY OR LEASE LINE, FT (Also to nearest drilg. unit line, if any) 660' | | 11. SEC., T., R., M., OR BLK. AND SURVEY OR AREA Sec 17, T25S, R37E | |
| 16. NO. OF ACRES IN LEASE 160 | | 12. COUNTY OR PARISH Lea | |
| 17. NO. OF ACRES ASSIGNED TO THIS WELL 160 | | 13. STATE NM | |
| 18. DISTANCE FROM PROPOSED LOCATION* TO NEAREST WELL, DRILLING, COMPLETED, OR APPLIED FOR, ON THIS LEASE, FT. 330' | | 19. PROPOSED DEPTH 3200' | |
| 20. ROTARY OR CABLE TOOLS Rotary | | 21. ELEVATIONS (Show whether DF, RT, GR, etc.) 3091' GR | |
| 22. APPROX. DATE WORK WILL START* 05/01/99 | | 23. PROPOSED CASING AND CEMENTING PROGRAM | |
| SIZE OF HOLE | GRADE, SIZE OF CASING | WEIGHT PER FOOT | SETTING DEPTH |
| 12-1/4" | 8-5/8" J55 | 24# | 450' |
| 7-7/8" | 4-1/2-5-1/2 J55 | 9.5-17# | 3200' |
| QUANTITY OF CEMENT | | | |
| 350 sx Class C | | | |
| 400 sx Lite, 200 sx Class C | | | |

Plan to drill 12-1/4" hole to appx 450'. Set 8-5/8" surface csg. Circ Class C cmt. Drill 7-7/8" hole to 3200'. Set 4-1/2" or 5-1/2" csg & circ cmt. Perforate Yates gas zone & stimulate as necessary for optimum production.

Specific Programs:

- Exhibit #1: BOP Diagram
- Exhibit #2: Survey Plat
- Exhibit #3: Existing & Proposed Roads Map
- Exhibit #4: Producing Well Area Map
- Exhibit #5: Drill Site Layout

IN ABOVE SPACE DESCRIBE PROGRAM: If proposal is to deepen, give data on present productive zone and proposed new productive zone. If proposal is to drill or deepen directionally, give pertinent data on subsurface locations and measured and true vertical depths. Give blowout preventer program, if any.

24. SIGNED Bonnie Ottwater TITLE Regulatory Tech. DATE 02/26/99

(This space for Federal or State office use)

PERMIT NO. _____ APPROVAL DATE _____

Application approval does not warrant or certify that the applicant holds legal or equitable title to those rights in the subject lease which would entitle the applicant to conduct operations thereon.
CONDITIONS OF APPROVAL, IF ANY:

APPROVED BY _____ TITLE _____ DATE _____

***See Instructions On Reverse Side**

Title 18 U.S.C. Section 1001, makes it a crime for any person knowingly and willfully to make to any department or agency of the United States any false, fictitious or fraudulent statements or representations as to any matter within its jurisdiction.

District I
PO Box 1980, Hobbs, NM 88240-2980
District II
PO Drawer DD, Artesia, NM 88211-0719
District III
1000 Rio Grande Rd., Aztec, NM 87410
District IV
PO Box 2088, Santa Fe, NM 87504-2088

State of New Mexico
Energy, Minerals & Natural Resources Department

OIL CONSERVATION DIVISION
PO Box 2088
Santa Fe, NM 87504-2088

RECEIVED

MAR 21 1999

Form C-102
Revised February 10, 1994
Instructions on back
Submit to Appropriate District Office
State Lease - 4 Copies
Fee Lease - 3 Copies

☐ AMENDED REPORT

WELL LOCATION AND ACREAGE DEDICATION PLAT

| | | |
|------------------------|--------------------------------------|---------------------------------|
| API Number | Pool Code 79240 | Pool Name Jalmat, TN, YT, 7R |
| Property Code 23986 | Property Name LANGLIE A FEDERAL | Well Number 2 |
| OGRID No. 020451 | Operator Name SDX RESOURCES, INC. | Elevation 3091. |

10 Surface Location

| UL or lot no. | Section | Township | Range | Lot Idn | Feet from the | North/South line | Feet from the | East/West line | County |
|---------------|---------|----------|-------|---------|---------------|------------------|---------------|----------------|--------|
| 0 | 17 | 25-S | 37-E | | 660 | SOUTH | 1980 | EAST | LEA |

11 Bottom Hole Location If Different From Surface

| UL or lot no. | Section | Township | Range | Lot Idn | Feet from the | North/South line | Feet from the | East/West line | County |
|---------------|---------|----------|-------|---------|---------------|------------------|---------------|----------------|--------|
| | | | | | | | | | |

| | | | |
|---------------------------|--------------------|-----------------------|--------------|
| 12 Dedicated Acres 160 | 13 Joint or Infill | 14 Consolidation Code | 15 Order No. |
|---------------------------|--------------------|-----------------------|--------------|

NO ALLOWABLE WILL BE ASSIGNED TO THIS COMPLETION UNTIL ALL INTERESTS HAVE BEEN CONSOLIDATED
OR A NON-STANDARD UNIT HAS BEEN APPROVED BY THE DIVISION

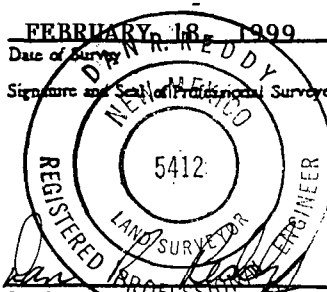
| | | | | | | | | | |
|----|--|--|--|--|---|--|--|--|--|
| 16 | | | | | 17 OPERATOR CERTIFICATION I hereby certify that the information contained herein is true and complete to the best of my knowledge and belief. Signature <u>Bonnie Atwater</u> Printed Name <u>Bonnie Atwater</u> Title <u>Regulatory Tech.</u> Date <u>March 4, 1999</u> | | | | |
| | | | | | | | | | |
| | | | | | 18 SURVEYOR CERTIFICATION I hereby certify that the well location shown on this plat was plotted from field notes of actual surveys made by me or under my supervision, and that the same is true and correct to the best of my belief. Date of Survey <u>FEBRUARY 18, 1999</u> Signature and Seal of Professional Surveyor:  Certificate Number <u>NM PEAPS NO. 5412</u> | | | | |
| | | | | | 1980' 660' | | | | |

CMD :
OG5SECTONGARD
INQUIRE LAND BY SECTION03/12/99 08:32:18
OGOMES -TPR1
PAGE NO: 1

Sec : 17 Twp : 25S Rng : 37E Section Type : NORMAL

| | | | |
|----------------------------------|----------------------------------|---|---|
| D 40.00 Fee owned P | C 40.00 Fee owned A | B 40.00 Federal owned U A | A 40.00 Federal owned U A A |
| E 40.00 Fee owned A | F 40.00 Fee owned A | G 40.00 Federal owned U A | H 40.00 Federal owned U A |

PF01 HELP
PF07 BKWDPF02
PF08 FWDPF03 EXIT
PF09 PRINTPF04 GoTo
PF10 SDIVPF05
PF11PF06
PF12

CMD :
OG5SECTONGARD
INQUIRE LAND BY SECTION03/12/99 08:32:25
OGOMES -TPR1
PAGE NO: 2

Sec : 17 Twp : 25S Rng : 37E Section Type : NORMAL

| | | | |
|----------------------------------|----------------------------------|---|---|
| L 40.00 Fee owned A | K 40.00 Fee owned A | J 40.00 Federal owned U A A | I 40.00 Federal owned U A |
| M 40.00 Fee owned A | N 40.00 Fee owned A | O 40.00 Federal owned U A | P 40.00 Federal owned U A |

PF01 HELP
PF07 BKWDPF02
PF08 FWDPF03 EXIT
PF09 PRINTPF04 GoTo
PF10 SDIVPF05
PF11PF06
PF12

CMD : ONGARD 03/12/99 08:32:37
OG6IWCM INQUIRE WELL COMPLETIONS OGOMES -TPR1

API Well No : 30 25 11631 Eff Date : 04-01-1998 WC Status : P
Pool Idn : 33820 JALMAT;TAN-YATES-7 RVRS (OIL)
OGRID Idn : 141913 MINERAL TECHNOLOGIES INC
Prop Idn : 18133 LANGLIE A FEDERAL

Well No : 001
GL Elevation: 3108

| | U/L | Sec | Township | Range | North/South | East/West | Prop/Act (P/A) |
|--|-----|-----|----------|-------|--------------|--------------|----------------|
| | --- | --- | ----- | ----- | ----- | ----- | ----- |
| B.H. Locn | : J | 17 | 25S | 37E | FTG 2310 F S | FTG 2310 F E | A |
| Lot Identifier: | | | | | | | |
| Dedicated Acre: | | | | | | | |
| Lease Type | : F | | | | | | |
| Type of consolidation (Comm, Unit, Forced Pooling - C/U/F/O) | | | | | | | |

M0025: Enter PF keys to scroll

| | | | | | |
|-----------|------|-----------|--------------|--------------|-------------|
| PF01 HELP | PF02 | PF03 EXIT | PF04 GoTo | PF05 | PF06 |
| PF07 | PF08 | PF09 | PF10 NEXT-WC | PF11 HISTORY | PF12 NXTREC |

CMD : ONGARD 03/12/99 08:32:47
OG6IWCM INQUIRE WELL COMPLETIONS OGOMES -TPR1

API Well No : 30 25 11631 Eff Date : 12-01-1998 WC Status : A
Pool Idn : 79240 JALMAT;TAN-YATES-7 RVRS (PRO GAS)
OGRID Idn : 20451 SDX RESOURCES INC
Prop Idn : 23986 LANGLIE A FEDERAL

Well No : 001
GL Elevation: 3108

| | U/L | Sec | Township | Range | North/South | East/West | Prop/Act (P/A) |
|---------------|-----|-----|----------|--------------|--------------|-----------|----------------|
| | --- | --- | ----- | ----- | ----- | ----- | ----- |
| B.H. Locn : J | 17 | 25S | 37E | FTG 2310 F S | FTG 2310 F E | | A |

Lot Identifier:

Dedicated Acre: 160.00

Lease Type : F

Type of consolidation (Comm, Unit, Forced Pooling - C/U/F/O) :

| | | | | | |
|-----------|------|-----------|--------------|--------------|-------------|
| PF01 HELP | PF02 | PF03 EXIT | PF04 GoTo | PF05 | PF06 |
| PF07 | PF08 | PF09 | PF10 NEXT-WC | PF11 HISTORY | PF12 NXTREC |