

SD N/R

DOYLE HARTMAN

Oil Operator

500 NORTH MAIN

P.O. BOX 10426

MIDLAND, TEXAS 79702

(915) 684-4011

(915) 682-7616 FAX

Via FedEx

August 4, 1999

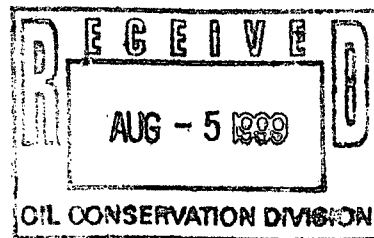

New Mexico Oil Conservation Division

2040 S. Pacheco

Santa Fe, NM 87505

Attn: Michael Stogner, Chief Hearing Officer

Re: Simultaneous Dedication Application

H.M. Britt No. 1 Eumont Well

1980' FNL and 1980' FWL

Section 7, T-20-S, R-37-E

Lea County, New Mexico

Gentlemen:

We are currently in the process of filing a *3160-4 Recompletion Report* and *C-102 Acreage Dedication Plat* (copies enclosed) for our newly-completed H.M. Britt No. 1 Eumont well situated at a standard gas location consisting of 1980' FNL and 1980' FWL Section 7, T-20-S, R-37-E, Lea County, New Mexico. The H.M. Britt No. 1 well was previously an abandoned Eunice-Monument gas well that last produced in 1984. As to the current status of the H.M. Britt No. 1 well, substantial well repair work and recompletion work has been recently performed so as to restore wellbore integrity and return the well to beneficial use.

In light of the foregoing, we are hereby filing for administrative approval to simultaneously dedicate our H.M. Britt No. 1 well, along with the previously approved H.M. Britt Nos. 3 and 12 Eumont wells, to the 320-acre H.M. Britt Eumont gas proration unit consisting of the W/2E/2 and E/2W/2 Section 7, T-20-S, R-37-E, Lea County, New Mexico. The creation of the 320-acre H.M. Britt gas proration unit and the simultaneous dedication of the H.M. Britt Nos. 3 and 12 wells thereto was approved by NMOCDD Order R-5448 dated June 8, 1977.

New Mexico Oil Conservation Division
August 4, 1999
Page 2

Where applicable, notice of this administrative application has been sent by certified mail to the operators of the adjacent and diagonal Eumont proration units, which operators are as follows:

Via CMRRR

Oryx Energy Company
13155 Noel Road (75240-5067)
P.O. Box 2880
Dallas, TX 75221-2880
Attn: Fred Winter, Manager of Land Dept.
(Adjacent West-offset Operator)

Doyle Hartman, Oil Operator
500 N. Main
Midland, TX 79702
(Diagonal Northwest-offset Operator)

Via CMRRR

Gruy Petroleum Management Company
600 E. Las Colinas Blvd., Suite 1200 (75039)
P.O. Box 140907
Irving, TX 75014-0907
Attn: Bill Mann, Operations Manager
(Adjacent North-offset Operator)

Via CMRRR

Chevron U.S.A., Inc.
P.O. Box 1635
Houston, TX 77251
Attn: Corry Woolington, Manager, Land
(Adjacent North-offset Operator)

Yours very truly,

DOYLE HARTMAN, Oil Operator

A handwritten signature in black ink, appearing to read 'Steve Hartman', with a stylized flourish at the end.

Steve Hartman
Engineer

enclosures (6)

New Mexico Oil Conservation Division
August 4, 1999
Page 3

rcs
wpdocs\corresp\nmood-britt.#1

cc: New Mexico Oil Conservation Division
2040 S. Pacheco
Santa Fe, NM 87505
Attn: Lori Wrotenbery, Director
Via FedEx

Bureau of Land Management
Roswell Field Office
2909 W. 2nd Street
Roswell, NM 88201
Attn: Armando Lopez, Assistant District Manager

James A. Davidson
214 W. Texas, Suite 710
Midland, TX 79701

DOYLE HARTMAN, Oil Operator
Don Mashburn, Engineer
Sheila Potts, Geologist
Linda Land, Controller
Cindy Brooks, Accountant
Land Department

Adjacent and Diagonal Eumont Operators

Doyle Hartman-operated

H. M. Britt No. 1 Eumont Well

W/2 E/2, E/2 W/2 Section 7, T-20-S, R-37-E

Lea County, New Mexico

(320 acres)

Tract	Color Code	Operator	Eumont P.U. Description	Eumont Producer	Well No.	Well Location
1	Yellow	Doyle Hartman	W/2 SW/4 Section 6 T-20-S, R-37-E NSP Order No. 1631 (80 acres)	Britt A-6	1	M-6-20S-37E
2	Pink	Gruy	E/2 SW/4 Section 6 T-20-S, R-37-E NSP Order No. 1051 (80 acres)	Britt A	6	N-6-20S-37E
3	Purple	Chevron	SE/4 Section 6 T-20-S, R-37-E NSP Order No. 312 (160 acres)	G C Matthews	2 12	J-6-20S-37E P-6-20S-37E
4	Orange	Oryx	W/2 W/2 Section 7 T-20-S, R-37-E NMOCD Order No. R-458 (160 acres)	Alaska Cooper	3 8	D-7-20S-37E L-7-20S-37E

UNITED STATES
DEPARTMENT OF THE INTERIOR
BUREAU OF LAND MANAGEMENT

SUBMIT IN DUPLICATE*

(See other in-
structions on
reverse side)FORM APPROVED
OMB NO. 1004-0137
Expires: February 28, 1995

5. LEASE DESIGNATION AND SERIAL NO.

LC-031621-A

6. IF INDIAN, ALLOTTEE OR TRIBE NAME

7. UNIT AGREEMENT NAME

8. FARM OR LEASE NAME, WELL NO.

H.M. Britt No. 1

9. API WELL NO.

30-025-05972

10. FIELD AND POOL, OR WILDCAT

Eumont (Y-7R-Q) Gas

11. SEC., T., R., M., OR BLOCK AND SURVEY
OR AREA

Sec. 7, T-20-S, R-37-E, NMMP

12. COUNTY OR PARISH

Lea

13. STATE

New Mexico

WELL COMPLETION OR RECOMPLETION REPORT AND LOG*

1a. TYPE OF WELL: OIL WELL ☐ GAS WELL ☒ DRY ☐ Otherb. TYPE OF COMPLETION: NEW WELL ☐ WORK OVER ☐ DEEP-EN ☐ PLUG BACK ☐ DIFF. RESVR. ☒ Other

2. NAME OF OPERATOR

Doyle Hartman

3. ADDRESS AND TELEPHONE NO.

500 N. Main Street, Midland, Texas 79701; 800-444-8093

4. LOCATION OF WELL (Report location clearly and in accordance with any State requirements)*

At surface

1980' FNL & 1980' FWL (F)

At top prod. interval reported below

same

At total depth

same

14. PERMIT NO.

DATE ISSUED

15. DATE SPUDDED

06/11/35

16. DATE T.D. REACHED

17. DATE COMPL. (Ready to prod.)

07/26/99

18. ELEVATIONS (DF, RXB, RT, GE, ETC.)*

3555' RKB

19. ELEV. CASINGHEAD

3547'

20. TOTAL DEPTH, MD & TVD

3881' MD

21. PLUG, BACK T.D., MD & TVD

3552' MD

22. IF MULTIPLE COMPL.,
HOW MANY*23. INTERVALS
DRILLED BY

ROTARY TOOLS

2625'-3881'

CABLE TOOLS

0'-2625'

24. PRODUCING INTERVAL(S), OF THIS COMPLETION-TOP, BOTTOM, NAME (MD AND TVD)*

3120'-3381' MD (Queen-Penrose)

25. WAS DIRECTIONAL
SURVEY MADE

No

26. TYPE ELECTRIC AND OTHER LOGS RUN

CNL-DAS-GR-CCL, VDCBL-GR-CCL

27. WAS WELL CORED

No

28. CASING RECORD (Report all strings set in well)

CASING SIZE/GRADE	WEIGHT, LB./FT.	DEPTH SET (MD)	HOLE SIZE	TOP OF CEMENT, CEMENTING RECORD	AMOUNT PULLED
16"	70	72'	18"	15 sx	None
10-3/4"	40	1008'	12"	0' / 810 sx	None
8-5/8"	32	2622'	10"	/1100 sx	None
6-5/8"	20	3803'	8"	0' / 510 sx	None

29. LINER RECORD

SIZE	TOP (MD)	BOTTOM (MD)	SACKS CEMENT*	SCREEN (MD)	SIZE	DEPTH SET (MD)	PACKER SET (MD)
					2-3/8"	3505'	None

31. PERFORATION RECORD (Interval, size and number)

3120'-3381' w/ (24) - 0.38" holes

32. ACID, SHOT, FRACTURE, CEMENT SQUEEZE, ETC.

DEPTH INTERVAL (MO)	AMOUNT AND KIND OF MATERIAL USED
3120'-3381'	A/4600 gal 15% MCA
2590'-2654'	Sqz/950 sx Class-C
3567'-3572'	Sqz/250 sx Class-C
3449'-3499'	Sqz/600 sx Class-C

33. * PRODUCTION 10-3/4" x 8-5/8" Annulus: Sqz/264 sx Class-C

DATE FIRST PRODUCTION 07/03/99		PRODUCTION METHOD (Flowing, gas lift, pumping--size and type of pump) Pumping-Flowing (9.5 x 64 x 1-1/4)				WELL STATUS (Producing or shut-in) Producing	
DATE OF TEST 07/26/99	HOURS TESTED 24	CHOKE SIZE 0.375" OP	PROD'N FOR TEST PERIOD →	OIL-BBL. 0	GAS-MCF. 42	WATER-BBL. 3.33	GAS-OIL RATIO
FLOW. TUBING PRESS. -----	CASING PRESSURE 3 psig	CALCULATED 24-HOUR RATE →	OIL-BBL. 0	GAS-MCF. 42	WATER-BBL. 3.33	OIL GRAVITY-API (CORR.)	

34. DISPOSITION OF GAS (Sold, used for fuel, vented, etc.)

Vented

TEST WITNESSED BY

H. Swain

35. LIST OF ATTACHMENTS

CNL-DAS-GR-CCL log and VDCBL-GR-CCL log

36. I hereby certify that the foregoing and attached information is complete and correct as determined from all available records

SIGNED

TITLE Executive Assistant

DATE 08/04/99

*(See Instructions and Spaces for Additional Data on Reverse Side)

Title 18 U.S.C. Section 1001, makes it a crime for any person knowingly and willfully to make to any department or agency of the United States any false, fictitious or fraudulent statements or representations as to any matter within its jurisdiction.

District I
PO Box 1980, Hobbs, NM 88241-1980

District II
911 South First, Artesia, NM 88210

District III
1000 Rio Brazos Rd., Aztec, NM 87410

District IV
2040 South Pacheco, Santa Fe, NM 87505

State of New Mexico
Energy, Minerals & Natural Resources Department

OIL CONSERVATION DIVISION
2040 South Pacheco
Santa Fe, NM 87505

Form C-102
Revised October 18, 1994
Instructions on back
Submit to Appropriate District Office
State Lease - 4 Copies
Fee Lease - 3 Copies

☐ AMENDED REPORT

WELL LOCATION AND ACREAGE DEDICATION PLAT

API Number 30-025-05972	Pool Code 76480	Pool Name Eumont (Y-7R-Q) Gas
Property Code 19147	Property Name H. M. Britt	Well Number 1
OGRID No. 6473	Operator Name Doyle Hartman	Elevation 3555

Surface Location

UL or lot no. F	Section 7	Township 20S	Range 37E	Lot Idn	Feet from the 1980	North/South line North	Feet from the 1980	East/West Line West	County Lea
--------------------	--------------	-----------------	--------------	---------	-----------------------	---------------------------	-----------------------	------------------------	---------------

Bottom Hole Location If Different From Surface

UL or lot no.	Section	Township	Range	Lot Idn	Feet from the	North/South line	Feet from the	East/West Line	County
---------------	---------	----------	-------	---------	---------------	------------------	---------------	----------------	--------

Dedicated Acres 320.00	Joint or Infill Y	Consolidation Code	Order No. R-5448 (6/8/77)
---------------------------	----------------------	--------------------	------------------------------

NO ALLOWABLE WILL BE ASSIGNED TO THIS COMPLETION UNTIL ALL INTERESTS HAVE BEEN CONSOLIDATED
OR A NON-STANDARD UNIT HAS BEEN APPROVED BY THE DIVISION

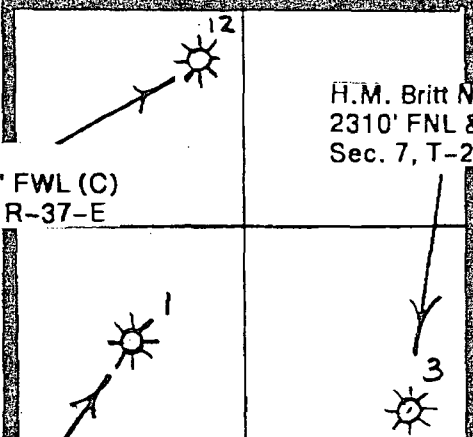
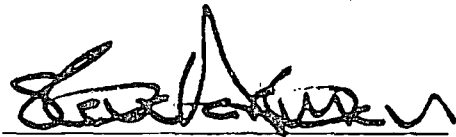
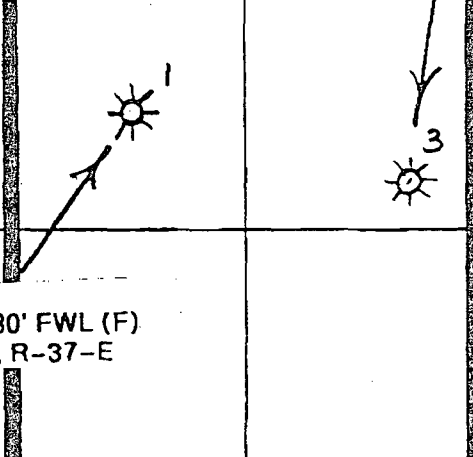
16		<p>H.M. Britt No. 12 330' FNL & 2281' FWL (C) Sec. 7, T-20-S, R-37-E</p> <p>H.M. Britt No. 3 2310' FNL & 1650' FEL (G) Sec. 7, T-20-S, R-37-E</p>	<p>17. OPERATOR CERTIFICATION I hereby certify that the information contained herein is true and complete to the best of my knowledge and belief</p> <p></p> <p>Signature Steve Hartman Printed Name Engineer Title 08-04-99 Date</p>
		<p>H.M. Britt No. 1 1980' FNL & 1980' FWL (F) Sec. 7, T-20-S, R-37-E</p>	<p>18. SURVEYOR CERTIFICATION I hereby certify that the well location shown on this plat was plotted from field notes of actual surveys made by me or under my supervision, and that the same is true and correct to the best of my belief.</p> <p>Date of Survey Signature and Seal of Professional Surveyer.</p>
	<p>320 ac. (R-5448)</p>	<p>Existing 320-acre Eumont P.U. H.M. Britt Lease W/2 E/2 and E/2 W/2 Section 7, T-20-S, R-37-E R-5448 (6/8/77)</p>	<p>Certificate Number</p>

Gas Well Plat

No. Acres Dedicated to the Well 320

(over)

N MEXICO OIL CONSERVATION COMMISSION
WELL LOCATION AND ACREAGE DEDICATION PLAT

Form C-102
Supersedes C-128
Effective 1-1-65

All distances must be from the outer boundaries of the Section.

Operator UNION TEXAS PETROLEUM CORPORATION			Lessee Britt		Well No. 12
Unit Letter C	Section 7	Township T-20-S	Range R-37-E	County Lea	
Actual Footage Location of Well: 330 feet from the North line and 2281 feet from the West line					
Ground Level Elev. 3552	Producing Formation Queen	Pool Eumont Gas Pool		Dedicated Acreage: 320 Acres	

1. Outline the acreage dedicated to the subject well by colored pencil or hachure marks on the plat below.
2. If more than one lease is dedicated to the well, outline each and identify the ownership thereof (both as to working interest and royalty).
3. If more than one lease of different ownership is dedicated to the well, have the interests of all owners been consolidated by communitization, unitization, force-pooling, etc?

☐ Yes ☐ No If answer is "yes," type of consolidation _____

If answer is "no," list the owners and tract descriptions which have actually been consolidated. (Use reverse side of this form if necessary.) _____

No allowable will be assigned to the well until all interests have been consolidated (by communitization, unitization, forced-pooling, or otherwise) or until a non-standard unit, eliminating such interests, has been approved by the Commission.

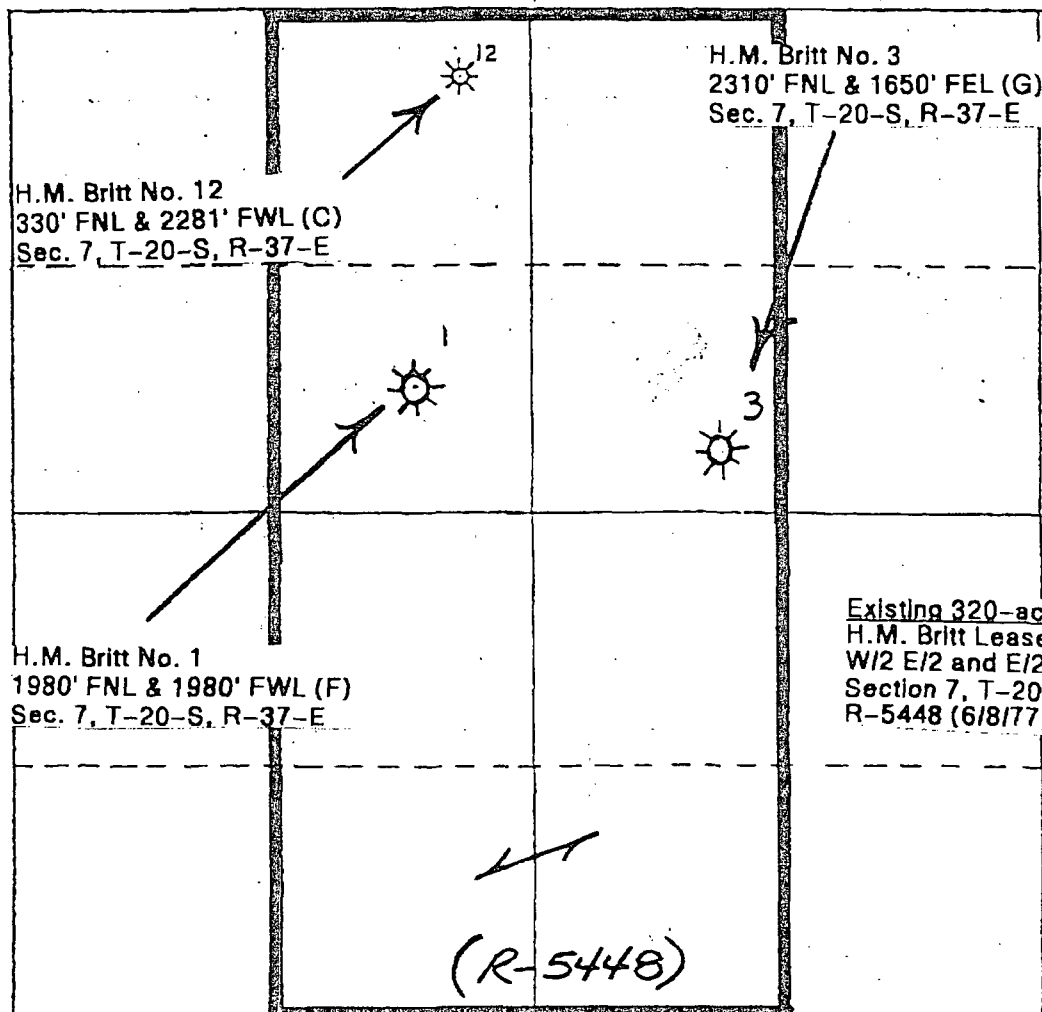

CERTIFICATION

I hereby certify that the information contained herein is true and complete to the best of my knowledge and belief.

Name
Stanley A. Post

Position
Senior Production Analyst

Company
UNION TEXAS PETROLEUM CORP

Date
April 13, 1977

I hereby certify that the well location
Existing 320-acre Eumont P.U. plot was plotted from field
H.M. Britt Lease of surveys made by me or
W/2 E/2 and E/2 W/2 revision, and that the same
Section 7, T-20-S, R-37-E tract to the best of my
R-5448 (6/8/77) knowledge and belief.

Date Surveyed _____

Registered Professional Engineer
and/or Land Surveyor _____

Certificate No. _____

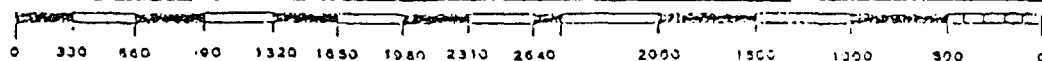

FORMATION	TOP	BOTTOM	DESCRIPTION, CONTENTS, ETC.
Seven Rivers-Queen	3070	3174	DST 200 MCFPD

U.S. GOVERNMENT PRINTING OFFICE: 1992 - 774-872

ACREAGE OWNERSHIP PLAT
T-20-S, R-36-E and R-37-E
LEA COUNTY, NEW MEXICO
SCALE: 1"=2000'

EUMONT (GAS) WELL
H. M. BRITT NO. 12
330 FNL & 2281' FWL (C)
SECTION 7, T-20-S, R-37-E

NEWLY-COMPLETED EUMONT (GAS)
H. M. BRITT NO. 1
1980' FNL & 1980' FWL (F)
SECTION 7, T-20-S, R-37-E

EUMONT (GAS) WELL
H. M. BRITT NO. 3
2310' FNL & 1650' FEL (G)
SECTION 7, T-20-S, R-37-E

SIMULTANEOUS DEDICATION-EUMONT (GAS) P.
H. M. BRITT LEASE
W/2 E/2, E/2 W/2 SECTION 7, T-20-S, R-37-E
(320 ACRES)

EUNICE MONUMENT
UNIT
GREENHIL
PET.(OPER)

DOYLE HARTMAN

Oil Operator

500 NORTH MAIN

P.O. BOX 10426

MIDLAND, TEXAS 79702

(915) 684-4011

(915) 682-7616 FAX

Via FedEx

August 4, 1999

New Mexico Oil Conservation Division
2040 S. Pacheco
Santa Fe, NM 87505

Attn: Michael Stogner, Chief Hearing Officer

Re: Simultaneous Dedication Application
H.M. Britt No. 1 Eumont Well
1980' FNL and 1980' FWL
Section 7, T-20-S, R-37-E
Lea County, New Mexico

Gentlemen:

We are currently in the process of filing a *3160-4 Recompletion Report* and *C-102 Acreage Dedication Plat* (copies enclosed) for our newly-completed H.M. Britt No. 1 Eumont well situated at a standard gas location consisting of 1980' FNL and 1980' FWL Section 7, T-20-S, R-37-E, Lea County, New Mexico. The H.M. Britt No. 1 well was previously an abandoned Eunice-Monument gas well that last produced in 1984. As to the current status of the H.M. Britt No. 1 well, substantial well repair work and recompletion work has been recently performed so as to restore wellbore integrity and return the well to beneficial use.

In light of the foregoing, we are hereby filing for administrative approval to simultaneously dedicate our H.M. Britt No. 1 well, along with the previously approved H.M. Britt Nos. 3 and 12 Eumont wells, to the 320-acre H.M. Britt Eumont gas proration unit consisting of the W/2E/2 and E/2W/2 Section 7, T-20-S, R-37-E, Lea County, New Mexico. The creation of the 320-acre H.M. Britt gas proration unit and the simultaneous dedication of the H.M. Britt Nos. 3 and 12 wells thereto was approved by NMOCD Order R-5448 dated June 8, 1977.

New Mexico Oil Conservation Division
August 4, 1999
Page 2

Where applicable, notice of this administrative application has been sent by certified mail to the operators of the adjacent and diagonal Eumont proration units, which operators are as follows:

Via CMRRR

Oryx Energy Company
13155 Noel Road (75240-5067)
P.O. Box 2880
Dallas, TX 75221-2880
Attn: Fred Winter, Manager of Land Dept.
(Adjacent West-offset Operator)

Doyle Hartman, Oil Operator
500 N. Main
Midland, TX 79702
(Diagonal Northwest-offset Operator)

Via CMRRR

Gruy Petroleum Management Company
600 E. Las Colinas Blvd., Suite 1200 (75039)
P.O. Box 140907
Irving, TX 75014-0907
Attn: Bill Mann, Operations Manager
(Adjacent North-offset Operator)

Via CMRRR

Chevron U.S.A., Inc.
P.O. Box 1635
Houston, TX 77251
Attn: Corry Woolington, Manager, Land
(Adjacent North-offset Operator)

Yours very truly,

DOYLE HARTMAN, Oil Operator

A handwritten signature in black ink, appearing to read 'Steve Hartman', with a stylized flourish at the end.

Steve Hartman
Engineer

enclosures (6)

New Mexico Oil Conservation Division
August 4, 1999
Page 3

rds
wpdocs\corresp\nmood-britt.#1

cc: New Mexico Oil Conservation Division
2040 S. Pacheco
Santa Fe, NM 87505
Attn: Lori Wrotenbery, Director
Via FedEx

Bureau of Land Management
Roswell Field Office
2909 W. 2nd Street
Roswell, NM 88201
Attn: Armando Lopez, Assistant District Manager

James A. Davidson
214 W. Texas, Suite 710
Midland, TX 79701

DOYLE HARTMAN, Oil Operator
Don Mashburn, Engineer
Sheila Potts, Geologist
Linda Land, Controller
Cindy Brooks, Accountant
Land Department

ACREAGE OWNERSHIP PLAT
T-20-S, R-36-E and R-37-E
LEA COUNTY, NEW MEXICO
SCALE: 1"=2000'

EUMONT (GAS) WELL
H. M. BRITT NO. 12
330 FNL & 2281' FWL (C)
SECTION 7, T-20-S, R-37-E

NEWLY-COMPLETED EUMONT (GAS)
H. M. BRITT NO. 1
1980' FNL & 1980' FWL (F)
SECTION 7, T-20-S, R-37-E

EUMONT (GAS) WELL
H. M. BRITT NO. 3
2310' FNL & 1650' FEL (G)
SECTION 7, T-20-S, R-37-E

SIMULTANEOUS DEDICATION-EUMONT (GAS) P.
H. M. BRITT LEASE
W1/2 E1/2, E1/2 W1/2 SECTION 7, T-20-S, R-37-E
(320 ACRES)

EUNICE MONUMENT
UNIT
GREENHILL PET.(OPER)

Adjacent and Diagonal Eumont Operators

Doyle Hartman-operated
H. M. Britt No. 1 Eumont Well
W/2 E/2, E/2 W/2 Section 7, T-20-S, R-37-E
Lea County, New Mexico
(320 acres)

Tract	Color Code	Operator	P.U. Description	Eumont Producer	Well No.	Well Location
1	Yellow	Doyle Hartman	W/2 SW/4 Section 6 T-20-S, R-37-E NSP Order No. 1631 (80 acres)	Britt A-6	1	M-6-20S-37E
2	Pink	Gruy	E/2 SW/4 Section 6 T-20-S, R-37-E NSP Order No. 1051 (80 acres)	Britt A	6	N-6-20S-37E
3	Purple	Chevron	SE/4 Section 6 T-20-S, R-37-E NSP Order No. 312 (160 acres)	G C Matthews	2 12	J-6-20S-37E P-6-20S-37E
4	Orange	Oryx	W/2 W/2 Section 7 T-20-S, R-37-E NMOCD Order No. R-458 (160 acres)	Alaska Cooper	3 8	D-7-20S-37E L-7-20S-37E

UNITED STATES
DEPARTMENT OF THE INTERIOR
BUREAU OF LAND MANAGEMENT

SUBMIT IN DUPLICATE*

(See other in-
structions on
reverse side)FORM APPROVED
OMB NO. 1004-0137
Expires: February 28, 1995

5. LEASE DESIGNATION AND SERIAL NO.

LC-031621-A

6. IF INDIAN, ALLOTTEE OR TRIBE NAME

7. UNIT AGREEMENT NAME

8. FARM OR LEASE NAME, WELL NO.

H.M. Britt No. 1

9. API WELL NO.

30-025-05972

10. FIELD AND POOL, OR WILDCAT

Eumont (Y-7R-Q) Gas

11. SEC., T., R., M., OR BLOCK AND SURVEY
OR AREA

Sec. 7, T-20-S, R-37-E, NMPM

12. COUNTY OR PARISH

Lea

13. STATE

New Mexico

WELL COMPLETION OR RECOMPLETION REPORT AND LOG*

1a. TYPE OF WELL: OIL WELL ☐ GAS WELL ☒ DRY ☐ Other _____b. TYPE OF COMPLETION: NEW WELL ☐ WORK OVER ☐ DEEP-EN ☐ PLUG BACK ☐ DIFF. RESVR. ☒ Other _____

2. NAME OF OPERATOR

Doyle Hartman

3. ADDRESS AND TELEPHONE NO.

500 N. Main Street, Midland, Texas 79701; 800-444-8093

4. LOCATION OF WELL (Report location clearly and in accordance with any State requirements)*

At surface

1980' FNL & 1980' FWL (F)

At top prod. interval reported below

same

At total depth

same

14. PERMIT NO.

DATE ISSUED

15. DATE SPUDDED

06/11/35

16. DATE T.D. REACHED

17. DATE COMPL. (Ready to prod.)

07/26/99

18. ELEVATIONS (DF, RKB, RT, GE, ETC.)*

3555' RKB

19. ELEV. CASINGHEAD

3547'

20. TOTAL DEPTH, MD & TVD

3881' MD

21. PLUG, BACK T.D., MD & TVD

3552' MD

22. IF MULTIPLE COMPL.,
HOW MANY*23. INTERVALS
DRILLED BY

ROTARY TOOLS

2625'-3881'

CABLE TOOLS

0'-2625'

24. PRODUCING INTERVAL(S), OF THIS COMPLETION-TOP, BOTTOM, NAME (MD AND TVD)*

3120'-3381' MD (Queen-Penrose)

25. WAS DIRECTIONAL
SURVEY MADE

No

26. TYPE ELECTRIC AND OTHER LOGS RUN

CNL-DAS-GR-CCL, VDCBL-GR-CCL

27. WAS WELL CORED

No

28. CASING RECORD (Report all strings set in well)

CASING SIZE/GRADE	WEIGHT, LB./FT.	DEPTH SET (MD)	HOLE SIZE	TOP OF CEMENT, CEMENTING RECORD	AMOUNT PULLED
16"	70	72'	18"	15 sx	None
10-3/4"	40	1008'	12"	0' / 810 sx	None
8-5/8"	32	2622'	10"	/1100 sx	None
6-5/8"	20	3803'	8"	0' / 510 sx	None

29. LINER RECORD

SIZE	TOP (MD)	BOTTOM (MD)	SACKS CEMENT*	SCREEN (MD)	SIZE	DEPTH SET (MD)	PACKER SET (MD)
					2-3/8"	3505'	None

31. PERFORATION RECORD (Interval, size and number)

3120'-3381' w/ (24) - 0.38" holes

32. ACID, SHOT, FRACTURE, CEMENT SQUEEZE, ETC.

DEPTH INTERVAL (MD)	AMOUNT AND KIND OF MATERIAL USED
3120'-3381'	A/4600 gal 15% MCA
2590'-2654'	Sqz/950 sx Class-C
3567'-3572'	Sqz/250 sx Class-C
3449'-3499'	Sqz/600 sx Class-C

33. * PRODUCTION 10-3/4" x 8-5/8" Annulus: Sqz/264 sx Class-C

DATE FIRST PRODUCTION 07/03/99 PRODUCTION METHOD (Flowing, gas lift, pumping-size and type of pump) Pumping-Flowing (9.5 x 64 x 1-1/4) WELL STATUS (Producing or shut-in) Producing

DATE OF TEST 07/26/99 HOURS TESTED 24 CHOKE SIZE 0.375" OP PROD'N FOR TEST PERIOD OIL-BBL. 0 GAS-MCF. 42 WATER-BBL. 3.33 GAS-OIL RATIO

FLOW. TUBING PRESS. CASING PRESSURE 3 psig CALCULATED 24-HOUR RATE OIL-BBL. 0 GAS-MCF. 42 WATER-BBL. 3.33 OIL GRAVITY-API (CORR.)

34. DISPOSITION OF GAS (Sold, used for fuel, vented, etc.)

Vented

TEST WITNESSED BY

H. Swain

35. LIST OF ATTACHMENTS

CNL-DAS-GR-CCL log and VDCBL-GR-CCL log

36. I hereby certify that the foregoing and attached information is complete and correct as determined from all available records

SIGNED

TITLE Executive Assistant

DATE 08/04/99

*(See Instructions and Spaces for Additional Data on Reverse Side)

Title 18 U.S.C. Section 1001, makes it a crime for any person knowingly and willfully to make to any department or agency of the United States any false, fictitious or fraudulent statements or representations as to any matter within its jurisdiction.

37. SUMMARY OF POROUS ZONES: (Show all important zones of porosity and contents thereof; cored intervals; and all drill-stem tests, including depth interval tested, cushion used, time tool open, flowing and shut-in pressures, and recoveries):

FORMATION	TOP	BOTTOM	DESCRIPTION, CONTENTS, ETC.
Seven Rivers-Queen	3070	3174	DST 200 MCFPD

38. GEOLOGICAL MARKERS			38. GEOLOGICAL MARKERS		
NAME	TOP		NAME	TOP	
	MEAS. DEPTH	TRUE VERT. DEPTH		MEAS. DEPTH	TRUE VERT. DEPTH
Yates	2400'	2400'	(+1155')		
Seven Rivers	2680'	2680'	(+ 875')		
Queen	3130'	3130'	(+ 425')		
Penrose	3237'	3237'	(+ 318')		
Grayburg	3450'	3450'	(+ 105')		

District I
PO Box 1980, Hobbs, NM 88241-1980

District II
811 South First, Artesia, NM 88210

District III
1000 Rio Brazos Rd., Aztec, NM 87410

District IV
2040 South Pacheco, Santa Fe, NM 87505

State of New Mexico
Energy, Minerals & Natural Resources Department

OIL CONSERVATION DIVISION
2040 South Pacheco
Santa Fe, NM 87505

Form C-102
Revised October 18, 1994
Instructions on back
Submit to Appropriate District Office
State Lease - 4 Copies
Fee Lease - 3 Copies

☐ AMENDED REPORT

WELL LOCATION AND ACREAGE DEDICATION PLAT

1 API Number 30-025-05972		2 Pool Code 76480		3 Pool Name Eumont (Y-7R-Q) Gas	
4 Property Code 19147		5 Property Name H. M. Britt			6 Well Number 1
7 OGRID No. 6473		8 Operator Name Doyle Hartman			9 Elevation 3555

10 Surface Location

UL or lot no. F	Section 7	Township 20S	Range 37E	Lot Idn	Feet from the 1980	North/South line North	Feet from the 1980	East/West Line West	County Lea
--------------------	--------------	-----------------	--------------	---------	-----------------------	---------------------------	-----------------------	------------------------	---------------

11 Bottom Hole Location If Different From Surface

UL or lot no.	Section	Township	Range	Lot Idn	Feet from the	North/South line	Feet from the	East/West Line	County
---------------	---------	----------	-------	---------	---------------	------------------	---------------	----------------	--------

12 Dedicated Acres 320.00	13 Joint or Infill Y	14 Consolidation Code	15 Order No. R-5448 (6/8/77)
------------------------------	-------------------------	-----------------------	---------------------------------

NO ALLOWABLE WILL BE ASSIGNED TO THIS COMPLETION UNTIL ALL INTERESTS HAVE BEEN CONSOLIDATED
OR A NON-STANDARD UNIT HAS BEEN APPROVED BY THE DIVISION

<p>16</p> <p>H.M. Britt No. 12 330' FNL & 2281' FWL (C) Sec. 7, T-20-S, R-37-E</p> <p>H.M. Britt No. 3 2310' FNL & 1650' FEL (G) Sec. 7, T-20-S, R-37-E</p> <p>H.M. Britt No. 1 1980' FNL & 1980' FWL (F) Sec. 7, T-20-S, R-37-E</p> <p>320 ac. (R-5448)</p>		<p>17 OPERATOR CERTIFICATION</p> <p>I hereby certify that the information contained herein is true and complete to the best of my knowledge and belief.</p> <p>Signature Steve Hartman Printed Name Engineer Title 08-04-99 Date</p> <p>18 SURVEYOR CERTIFICATION</p> <p>I hereby certify that the well location shown on this plat was plotted from field notes of actual surveys made by me or under my supervision, and that the same is true and correct to the best of my belief.</p> <p>Date of Survey Signature and Seal of Professional Surveyor</p> <p>Existing 320-acre Eumont P.U. H.M. Britt Lease W/2 E/2 and E/2 W/2 Section 7, T-20-S, R-37-E R-5448 (6/8/77)</p> <p>Certificate Number</p>
--	--	--

NEW MEXICO
OIL CONSERVATION COMMISSION

Gas Well Plat

Date September 8, 1954

Anderson-Prichard Oil Corp. Britt 3
Operator Lease Well No.

Name of Producing Formation Queen Pool Eumont

No. Acres Dedicated to the Well 320

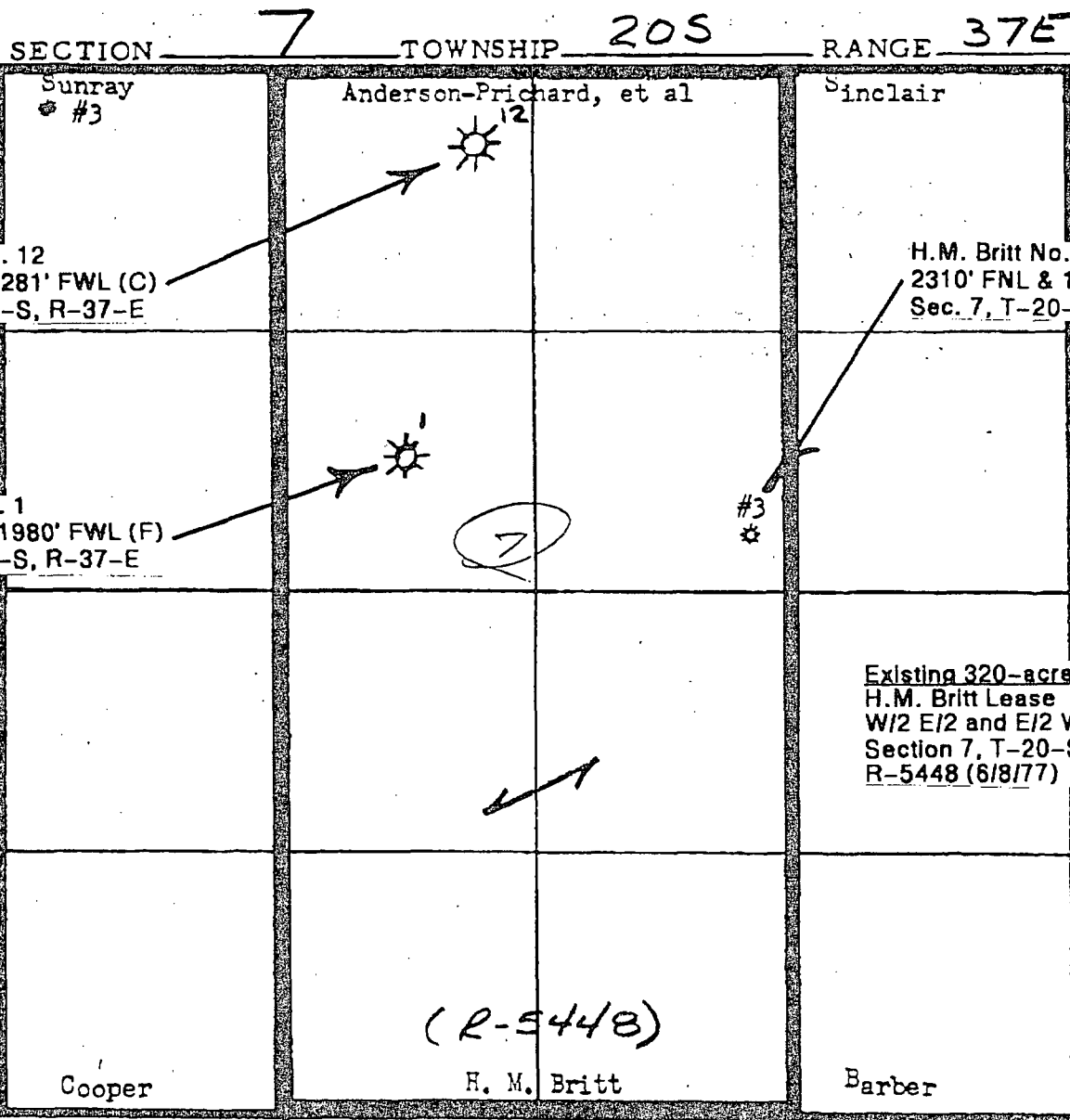

I hereby certify that the information given above is true and complete to the best of my knowledge.

Name M. L. Meltzer
Position District Engineer
Representing Anderson-Prichard Oil Corporation
Address Box 2197, Hobbs, New Mexico

(over)

MEXICO OIL CONSERVATION COMMISSION
WELL LOCATION AND ACREAGE DEDICATION PLAT

Form C-102
Supersedes C-128
Effective 1-1-65

All distances must be from the outer boundaries of the Section.

Operator UNION TEXAS PETROLEUM CORPORATION			Lease Britt		Well No. 12
Unit Letter C	Section 7	Township T-20-S	Range R-37-E	County Lea	
Actual Footage Location of Well: 330 feet from the North line and 2281 feet from the West line					
Ground Level Elev. 3552	Producing Formation Queen	Pool Eumont Gas Pool		Dedicated Acreage: 320 Acres	

1. Outline the acreage dedicated to the subject well by colored pencil or hatchure marks on the plat below.
2. If more than one lease is dedicated to the well, outline each and identify the ownership thereof (both as to working interest and royalty).
3. If more than one lease of different ownership is dedicated to the well, have the interests of all owners been consolidated by communitization, unitization, force-pooling, etc?

☐ Yes ☐ No If answer is "yes," type of consolidation _____

If answer is "no," list the owners and tract descriptions which have actually been consolidated. (Use reverse side of this form if necessary.) _____

No allowable will be assigned to the well until all interests have been consolidated (by communitization, unitization, forced-pooling, or otherwise) or until a non-standard unit, eliminating such interests, has been approved by the Commission.

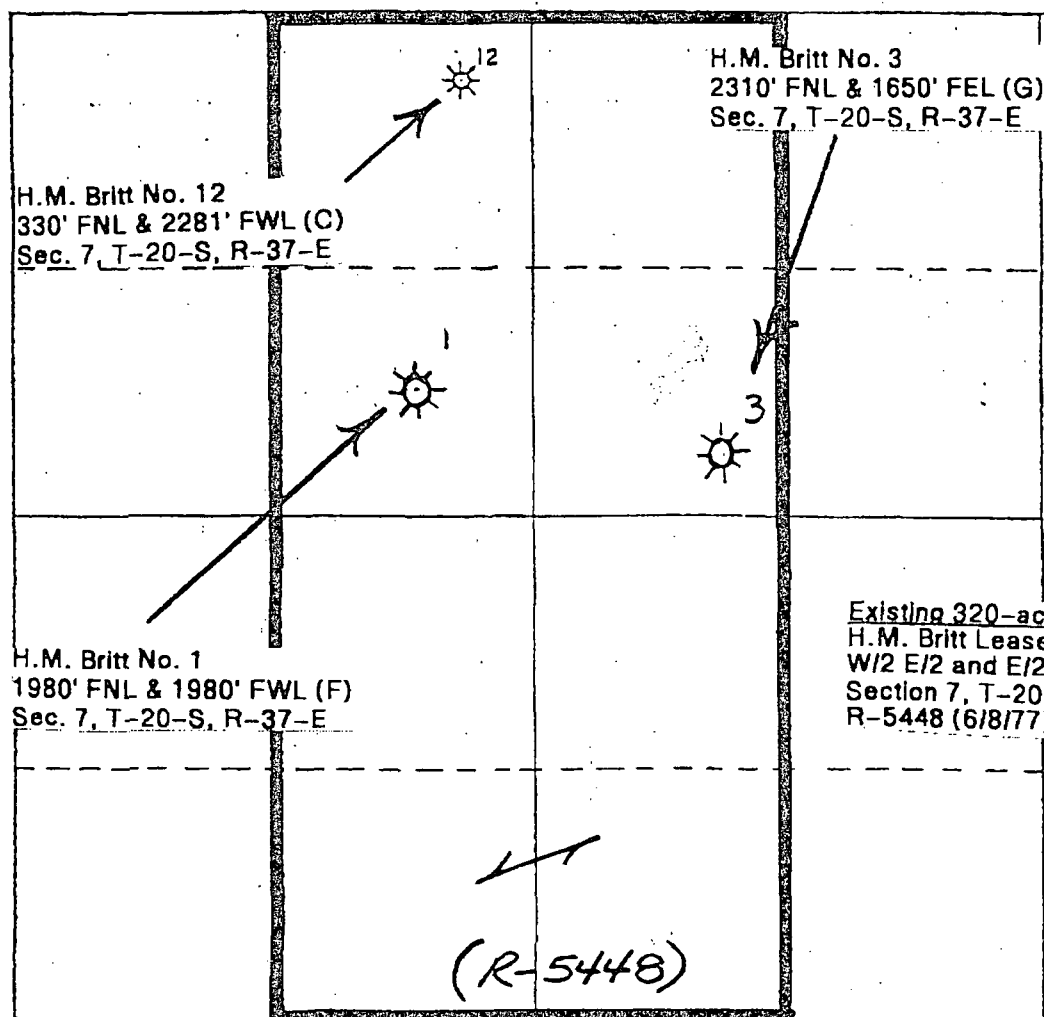

CERTIFICATION

I hereby certify that the information contained herein is true and complete to the best of my knowledge and belief.

Stanley A. Post
Name

Stanley A. Post

Position

Senior Production Analyst

Company

UNION TEXAS PETROLEUM CORP

Date

April 13, 1977

I hereby certify that the well location plot was plotted from field H.M. Britt Lease W/2 E/2 and E/2 W/2 Section 7, T-20-S, R-37-E R-5448 (6/8/77) to the best of my knowledge and belief.

Date Surveyed

Registered Professional Engineer and/or Land Surveyor

Certificate No.

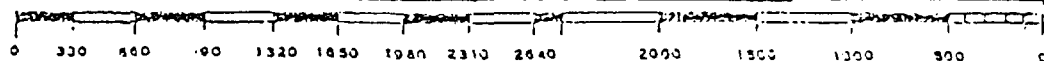

BEFORE THE OIL CONSERVATION COMMISSION
OF THE STATE OF NEW MEXICO

IN THE MATTER OF THE HEARING
CALLED BY THE OIL CONSERVATION
COMMISSION OF NEW MEXICO FOR
THE PURPOSE OF CONSIDERING:

CASE NO. 5935
Order No. R-5448

APPLICATION OF UNION TEXAS PETROLEUM
FOR A NON-STANDARD PRORATION UNIT AND
SIMULTANEOUS DEDICATION, LEA COUNTY,
NEW MEXICO.

ORDER OF THE COMMISSION

BY THE COMMISSION:

This cause came on for hearing at 9 a.m. on May 25, 1977,
at Santa Fe, New Mexico, before Examiner Richard L. Stamets.

NOW, on this 8th day of June, 1977, the Commission, a
quorum being present, having considered the testimony, the record,
and the recommendations of the Examiner, and being fully advised
in the premises,

FINDS:

(1) That due public notice having been given as required
by law, the Commission has jurisdiction of this cause and the
subject matter thereof.

(2) That the applicant, Union Texas Petroleum, seeks
approval of a 320-acre non-standard gas proration unit comprising
the E/2 W/2 and W/2 E/2 of Section 7, Township 20 South, Range
37 East, NMPM, Lea County, New Mexico, to be simultaneously
dedicated to applicant's Britt Wells Nos. 3 and 12 located at
unorthodox locations in Units G and C of said Section 7,
respectively.

(3) That the entire non-standard proration unit may
reasonably be presumed productive of gas from the Eumont Gas
Pool and that the entire non-standard gas proration unit can be
efficiently and economically drained and developed by the
aforesaid wells.

(4) That Commission administrative order NSP-11 should
be superseded.

(5) That approval of the subject application will afford
the applicant the opportunity to produce his just and equitable
share of the gas in the Eumont Gas Pool, will prevent the economic
loss caused by the drilling of unnecessary wells, avoid the
augmentation of risk arising from the drilling of an excessive

number of wells, and will otherwise prevent waste and protect correlative rights.

IT IS THEREFORE ORDERED:

(1) That a 320-acre non-standard gas proration unit in the Eumont Gas Pool comprising the E/2 W/2 and W/2 E/2 of Section 7, Township 20 South, Range 37 East, NMPM, Lea County, New Mexico, is hereby established and simultaneously dedicated to the Union Texas Petroleum Corporation Britt Wells Nos. 3 and 12, located at unorthodox locations in Units G and C of said Section 7, respectively.

(2) That Commission administrative order NSP-11 is hereby superseded.

(3) That jurisdiction of this cause is retained for the entry of such further orders as the Commission may deem necessary.

DONE at Santa Fe, New Mexico, on the day and year herein-above designated.

STATE OF NEW MEXICO
OIL CONSERVATION COMMISSION

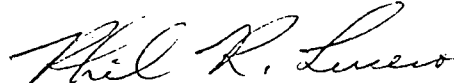

PHIL R. LUCERO, Chairman

EMERY C. ARNOLD, Member
JOE D. RAMEY, Member & Secretary

S E A L

OIL CONSERVATION COMMISSION

P. O. BOX 871

SANTA FE, NEW MEXICO

October 10, 1954

C
O
P
Y
Anderson-Prichard Oil Corporation
District II Field Office
107 West Sanger Street
HOBBS NEW MEXICO

Attention: Mr. E. L. Melton, District Engineer

Gentlemen:

Administrative Order NSP-11

Reference is made to your application (received September 10, 1954) for approval of a 320-acre non-standard gas proration unit consisting of the following acreage:

W/2 E/2 and E/2 W/2 of Section 7,
Township 20 South, Range 37 East,
NMPM, Lea County, New Mexico;

said unit to be ascribed to your H. M. Britt Well No. 3, located 2310 feet from the north line and 1650 feet from the east line of Section 7, Township 20 South, Range 37 East.

By authority granted me under provisions of Rule 5, Section (b)-6 of the Special Rules and Regulations for the Eumont Gas Pool as set forth in Order R-520, you are hereby authorized to operate the above-described acreage as a non-standard gas proration unit, with allowable to be assigned thereto in accordance with pool rules.

Very truly yours,

W. B. Macey
Secretary-Director

WBM:nr

cc: Oil Conservation Commission:
Hobbs

N. M. Oil & Gas Eng. Committee:
Hobbs

CMD :
OG5SECTONGARD
INQUIRE LAND BY SECTION08/23/99 13:51:49
OGOMES -TPFF
PAGE NO: 1

Sec : 07 Twp : 20S Rng : 37E Section Type : NORMAL

1 39.16	C 40.00	B 40.00	A 40.00
Fee owned	Federal owned	Federal owned	Fee owned
A A A	A A	A A	A A A
2 39.22	F 40.00	G 40.00	H 40.00
Fee owned	Federal owned	Federal owned	Fee owned
	A	A A	A A A

PF01 HELP
PF07 BKWDPF02
PF08 FWDPF03 EXIT
PF09 PRINTPF04 GoTo
PF10 SDIVPF05
PF11PF06
PF12

CMD :
OG5SECT

ONGARD
INQUIRE LAND BY SECTION

08/23/99 13:51:55
OGOMES -TPFF
PAGE NO: 2

Sec : 07 Twp : 20S Rng : 37E Section Type : NORMAL

3 39.26	K 40.00	J 40.00	I 40.00
Fee owned	Federal owned	Federal owned	Fee owned
A A	A A	A A A	A A
4 39.32	N 40.00	O 40.00	P 40.00
Fee owned	Federal owned	Federal owned	Fee owned
A	A	A	A A

PF01 HELP PF02 PF03 EXIT PF04 GoTo PF05 PF06

PF07 BKWD PF08 FWD PF09 PRINT PF10 SDIV PF11 PF12

STATE OF NEW MEXICO
ENERGY, MINERALS AND NATURAL RESOURCES DEPARTMENT
OIL CONSERVATION DIVISION

IN THE MATTER OF THE HEARING
CALLED BY THE OIL CONSERVATION
DIVISION FOR THE PURPOSE OF
CONSIDERING:

CASE NO. 13050
ORDER NO. R-5448-A

APPLICATION OF DOYLE HARTMAN, OIL OPERATOR FOR SIMULTANEOUS
DEDICATION, AN EXCEPTION TO RULE 3 (D) OF THE SPECIAL RULES AND
REGULATIONS FOR THE EUMONT GAS POOL, AN UNORTHODOX INFILL
GAS WELL LOCATION, AND TO AMEND DIVISION ADMINISTRATIVE
ORDER NSL-4773 (SD), LEA COUNTY, NEW MEXICO.

ORDER OF THE DIVISION

BY THE DIVISION:

This case came on for hearing at 8:15 a.m. on July 24, 2003, at Santa Fe, New Mexico before Examiner Michael E. Stogner.

NOW, on this 21st day of May, 2004, the Division Director, having considered the testimony, the record and the recommendations of the Examiner,

FINDS THAT:

(1) Due public notice has been given, and the Division has jurisdiction of this case and its subject matter.

(2) By Order No. R-8170-P, issued in Case No. 12563 on December 14, 2001, the Division caused the prorationing of gas production to cease within the Eumont Gas Pool (76480) and promulgated "*Special Pool Rules for the Eumont Gas Pool*," which provide for: (i) oil development on standard 40-acre oil spacing units [Rule 2 (B)] and gas development on standard 640-acre gas spacing units [Rule 2 (A)]; (ii) gas development on a well density based on one well per 160 acres [Rules 3 (C) and (D)]; (iii) gas well locations to be no closer than 660 feet to any outer boundary of the assigned gas spacing unit or governmental quarter section line nor closer than 330 feet to any governmental quarter-quarter section line [Rule (A) (2)]; and (iv) administrative exceptions, in most cases, to these rules (Rule 4).

(3) These special rules further prohibit: (i) the simultaneous dedication of acreage committed to a gas well in the Eumont Gas Pool to an oil well in the Eumont Gas Pool [Rule 2 (C)]; and (ii) a gas well density greater than one Eumont well per quarter-quarter section [Rule 3 (D)].

(4) The vertical limits of the Eumont Gas Pool extend from the top of the Yates formation, through the Seven Rivers formation, to the base of the Queen formation.

(5) The applicant in this case, Doyle Hartman ("Applicant"), is the designated operator of a non-standard 320-acre gas spacing unit in the Eumont Gas Pool comprising the W/2 E/2 (Units B, G, J, and O) and E/2 W/2 (Units C, F, K, and N) of Section 7, Township 20 South, Range 37 East, NMPM, Lea County, New Mexico (originally approved by Division Order No. R-5448, issued in Case No. 5935 on June 8, 1977). By Division Administrative Orders SD-99-9, dated August 23, 1999, and NSL-4773 (SD), dated September 4, 2002, Doyle Hartman was granted authorization to simultaneously dedicate the following six gas wells to this 320-acre unit:

(a) H. M. Britt Well No. 1 (API No. 30-025-05972) (the subject of Division Administrative Order SD-99-9) located at a standard gas well location 1980 feet from the North and West lines (Unit F) of Section 7;

(b) H. M. Britt Well No. 3 (API No. 30-025-05991), located at an unorthodox gas well location (approved by Division Order No. R-5448) 2310 feet from the North line and 1650 feet from the East line (Unit G) of Section 7;

(c) H. M. Britt Well No. 4 (API No. 30-025-05992), located at a standard gas well location 660 feet from the North line and 1980 feet from the East line (Unit B) of Section 7;

(d) H. M. Britt Well No. 5 (API No. 30-025-05993), located at a standard gas well location 1980 feet from the South and West lines (Unit K) of Section 7;

(e) H. M. Britt Well No. 12 (API No. 30-025-05999), located at an unorthodox gas well location (also approved by Division Order No. R-5448) 330 feet from the North line and 2281 feet from the West line (Unit C) of Section 7; and

(f) Britt Well No. 14 (API No. 30-025-35152), located at an unorthodox gas well location [approved by Division Administrative Order NSL-4773 (SD)] 1400 feet from the South line and 2310 feet from the East line (Unit J) of Section 7.

(6) Applicant now seeks an exception to Rule 3 (D) of the special rules governing the Eumont Gas Pool, to allow its existing H. M. Britt Well No. 2 (API No. 30-025-05990), located at a standard infill gas well location 660 feet from the North line and 1980 feet from the West line (Unit C) of Section 7, to be recompleted as a Eumont gas producer within the same quarter-quarter section [NE/4 NW/4 (Unit C)] as the above-described H. M. Britt Well No. 12.

(7) Applicant further proposes to replace the above-described H. M. Britt Well No. 3 within the SW/4 NE/4 (Unit G) of Section 7 with its existing H. M. Britt Well No. 11 (API No. 30-025-05998), located at an unorthodox infill gas well location 1650 feet from the North and East lines (Unit G) of Section 7.

(8) Applicant seeks to amend Division Administrative Order NSL-4773 (SD) to properly reflect any changes approved by the order issued in this case.

(9) Kerr-McGee Oil & Gas Onshore, L.L.C., an offset operator to the subject 320-acre unit, appeared at the hearing through legal counsel, but offered no testimony.

(10) Within the NE/4 NW/4 (Unit C) of Section 7, Doyle Hartman has recompleted its H. M. Britt Well No. 2 from the Eunice-Monument (Grayburg-San Andres) Pool (23000), where it was initially completed in 1936, into the Queen formation, the lower portion of the Eumont Gas Pool, through perforations from 3,017 feet to 3,277 feet. The above-described H. M. Britt Well No. 12, which was initially drilled in 1954 to a total depth of 5,713 feet, is currently producing from the upper Yates and Seven Rivers intervals of the upper portion of the Eumont Gas Pool through perforations from 2,293 feet to 2,955 feet. Testimony was presented to indicate that the current conditions of the H. M. Britt Wells No. 2 and 12, due to their completion techniques and age, are such that neither well could be economically worked over or worked over in a sound engineering manner through the entire gas productive interval of the Eumont Gas Pool.

(11) Both the H. M. Britt Well No. 2 and 12 are needed to drain the entire vertical extent of the Eumont Gas Pool within the northwestern portion of this 320-acre unit.

(12) Within the SW/4 NE/4 (Unit G) of Section 7, due to water production and economics, Applicant will abandon the above-described H. M. Britt Well No. 3 and, in order to further deplete the Eumont gas reserves underlying the unit, proposes to replace it with the H. M. Britt Well No. 11, which was recently recompleted from the Eunice-Monument Pool to the Eumont Gas Pool with perforations from 3,081 feet to 3,298 feet.

(13) The H. M. Britt Well No. 11 was initially drilled in 1954 to a total depth of 5,710 feet. Its location, like that of the H. M. Britt Well No. 3, is 330 feet from the eastern outer boundary of the subject 320-acre unit, resulting in it being an unorthodox Eumont gas well location pursuant to Rule (A) (2) of the special pool rules.

(14) No offset operator and/or interest owner appeared at the hearing in opposition to this application.

(15) Approval of this application will provide Doyle Hartman the opportunity to deplete the Eumont gas reservoir underlying this 320-acre unit, which will allow increased recovery of reserves otherwise unrecoverable, is in the best interest of conservation, supports sound engineering practices, and will otherwise serve to prevent waste and protect correlative rights.

(16) In order to simplify the administrative process, the order issued in this case should replace the provisions of Division Administrative Orders SD-99-9 and NSL-4773 (SD).

IT IS THEREFORE ORDERED THAT:

(1) Pursuant to the application of Doyle Hartman ("Applicant"), the 320-acre non-standard gas spacing unit in the Eumont Gas Pool (76480) comprising the W/2 E/2 (Units B, G, J, and O) and E/2 W/2 (Units C, F, K, and N) of Section 7, Township 20 South, Range 37 East, NMPM, Lea County, New Mexico (approved by Division Order No. R-5448, issued in Case No. 5935 on June 8, 1977), shall be simultaneously dedicated to the seven (7) following-described wells:

(a) H. M. Britt Well No. 1 (API No. 30-025-05972), located at a standard gas well location 1980 feet from the North and West lines (Unit F) of Section 7;

(b) H. M. Britt Well No. 2 (API No. 30-025-05990), located at a standard gas well location 660 feet from the North line and 1980 feet from the West line (Unit C) of Section 7;

(c) H. M. Britt Well No. 4 (API No. 30-025-05992), located at a standard gas well location 660 feet from the North line and 1980 feet from the East line (Unit B) of Section 7;

(d) H. M. Britt Well No. 5 (API No. 30-025-05993), located at a standard gas well location 1980 feet from the South and West lines (Unit K) of Section 7;

(e) H. M. Britt Well No. 11 (API No. 30-025-05998), located at an unorthodox infill gas well location, herein approved, 1650 feet from the North and East lines (Unit G) of Section 7;

(f) H. M. Britt Well No. 12 (API No. 30-025-05999), located at an unorthodox gas well location 330 feet from the North line and 2281 feet from the West line (Unit C) of Section 7; and

(g) Britt Well No. 14 (API No. 30-025-35152), located at an unorthodox gas well location 1400 feet from the South line and 2310 feet from the East line (Unit J) of Section 7.

(2) Division Administrative Orders SD-99-9, dated August 23, 1999, and NSL-4773 (SD), dated September 4, 2002, are hereby rescinded and placed in abeyance until further notice.

(3) Jurisdiction of this case is retained for the entry of such further orders as the Division may deem necessary.

DONE at Santa Fe, New Mexico, on the day and year hereinabove designated.

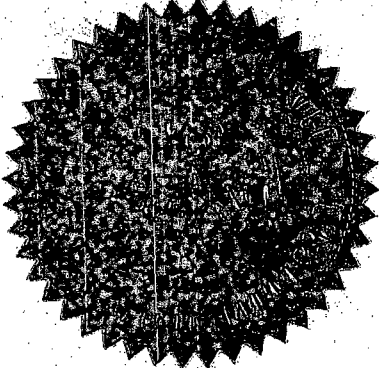

SEAL

STATE OF NEW MEXICO
OIL CONSERVATION DIVISION

JOANNA PRUKOP
Cabinet Secretary/Interim Director



NEW MEXICO ENERGY, MINERALS and NATURAL RESOURCES DEPARTMENT

GARY E. JOHNSON

Governor

BETTY RIVERA

Cabinet Secretary

Lori Wrotenbery

Director

Oil Conservation Division

September 4, 2002

Doyle Hartman, Oil Operator
P. O. Box 10426
Midland, Texas 79702
Attention: Steve Hartman

Telefax No. (915) 682-7616

Administrative Order NSL-4773 (SD)

Dear Mr. Hartman:

Reference is made to the following: (i) your application submitted to the New Mexico Oil Conservation Division ("Division") on August 15, 2002 (*application reference No. pKRV0-223138260*); and (ii) the records of the Division in Santa Fe, including the files on Division Case No. 5935 (which resulted in the issuance of Division Order No. R-5448) and Division Administrative Orders NSP-11 and SD-99-9; all concerning Doyle Hartman's request for five additional wells within an existing 320-acre non-standard gas spacing unit comprising the W/2 E/2 and E/2 W/2 of Section 7, Township 20 South, Range 37 East, NMPM, Eumont Gas Pool (76480), Lea County, New Mexico.

THE DIVISION DIRECTOR FINDS THAT:

(1) This 320-acre non-standard gas spacing unit was initially established by Division Order No. R-5448, issued in Case No. 5935 on June 8, 1977 and had dedicated thereon the following two wells:

(A) the original H. M. Britt Well No. 3 (API No. 30-025-05991) located at an unorthodox gas well location 2310 feet from the North line and 1650 feet from the East line (Unit G) of Section 7 (which unorthodox gas well location was also approved by Division Order No. R-5448); and

(B) the Britt Well No. 12 (API No. 30-025-05999) located at an unorthodox infill gas well location 330 feet from the North line and 2281 feet from the West line (Unit C) of Section 7 (which unorthodox well location was also approved by Division Order No. R-5448).

(2) By Division Administrative Order SD-99-9, dated August 23, 1999, a third well for this 320-acre unit, the H. M. Britt Well No. 1 (API No. 30-025-05972), located at a standard

infill gas well location 1980 feet from the North and West lines (Unit F) of Section 7 was approved.

(3) The subject application has been duly filed under the provisions of the "*Special Pool Rules for the Eumont Gas Pool*," as promulgated by Division Order No. R-8170-P, issued in Case No. 12563 on December 14, 2001.

(4) All five of the proposed wells that are the subject of this application are currently completed in the Eumont Gas Pool; only one however is currently producing.

(5) Four of the five wells that are the subject of this application were initially drilled and completed in deeper oil bearing intervals (four within the Eunice Monument-Grayburg-San Andres Pool and one in the Monument-Blinbry Pool). Only one well was drilled and completed as an infill Eumont gas well (completion date report, October 16, 2000).

(6) Two of the five infill gas well locations that are the subject of this application are considered to be unorthodox and three are standard [see Rule 3 (A) (2) of the special Eumont Gas Pool rules].

(7) Two of the five wells that are the subject of this application are located within quarter-quarter sections that already have a producing Eumont gas well. This will be a violation of Rule 3 (D) of the Eumont special pool rules.

IT IS THEREFORE ORDERED THAT:

(1) Under the provisions of Rules 4 (B) and (D) of the special rules now governing the Eumont Gas Pool (**76480**), Doyle Hartman, Oil Operator is authorized to simultaneously dedicate gas production from the Eumont Gas Pool to its previously approved (see Division Order No. R-5448, issued in Case No. 5935 on June 8, 1977) 320-acre non-standard gas spacing unit comprising the W/2 E/2 and E/2 W/2 of Section 7, Township 20 South, Range 37 East, NMPM, Lea County, New Mexico, the two following-described wells:

(A) the H. M. Britt Well No. 4 (**API No. 30-025-05992**) located at a standard infill gas well location 660 feet from the North line and 1980 feet from the East line (Unit B) of Section 7; and

(B) the H. M. Britt Well No. 5 (**API No. 30-025-05993**) located at a standard infill gas well location 1980 feet from the South and West lines (Unit K) of Section 7.

(2) Under the provisions of Rules 4 (A), (B), and (D) of the Eumont special pool rules, Doyle Hartman's Britt Well No. 14 (**API No. 30-025-35152**), which well was drilled and

completed in September/October, 2000 at an unorthodox infill gas well location within the subject 320-acre unit 1400 feet from the South line and 2310 feet from the East line (Unit J) of Section 7 is hereby approved.

PLEASE NOTE HOWEVER THAT Doyle Hartman, as a prudent operator, should recognize that a well location is unorthodox prior to its drilling and not wait a period of eight months after producing from the affected interval to seek the necessary regulatory exceptions. If, any future application by Doyle Hartman for an unorthodox location is not filed in a more timely fashion, all such subsequent applications may be subject to the Division's hearing process until further notice.

IT IS FURTHER ORDERED HOWEVER THAT:

(3) Doyle Hartman's request to simultaneously dedicate to this 320-acre non-standard gas spacing unit the following two wells is hereby **denied**:

(A) H. M. Britt Well No. 2 (**API No. 30-025-05990**), located at a standard infill gas well location 660 feet from the North line and 1980 feet from the West line (Unit C) of Section 7, which well is located within the same quarter-quarter section [NE/4 NW/4 (Unit C) of Section 7] as the above-described Britt Well No. 12; and

(B) the H. M. Britt Well No. 11 (**API No. 30-025-05998**), located at an unorthodox infill gas well location 1650 feet from the North and West lines (Unit G) of Section 7, which well is located within the same quarter-quarter section [SW/4 NE/4 (Unit G) of Section 7] as the above-described H. M. Britt Well No. 3.

(4) Doyle Hartman is authorized to simultaneously dedicate Eumont gas production from its H. M. Britt Wells No. 1, 3, 4, and 5 and Britt Wells No. 12 and 14.

(5) All provisions applicable to the subject 320-acre non-standard gas spacing unit in Division Order No. R-5448 and Division Administrative Order SD-99-9, not in conflict with this order, shall remain in full force and affect until further notice.

(6) Jurisdiction of this matter shall be further retained for the entry of any such

Administrative Order NSL-4773(SD)

Doyle Hartman, Oil Operator

September 4, 2002

Page 4

subsequent orders, as the Division may deem necessary.

Sincerely,

A handwritten signature in cursive script, appearing to read "Lori Wrotenbery" followed by a stylized monogram or initials.

Lori Wrotenbery

Director

LW/MES/kv

cc: New Mexico Oil Conservation Division - Hobbs

U. S. Bureau of Land Management - Carlsbad

File: NSP-11

SD-99-9 /