

## Bratcher, Mike, EMNRD

---

**From:** Tavaréz, Ike [Ike.Tavaréz@tetrattech.com]  
**Sent:** Wednesday, October 07, 2009 9:53 AM  
**To:** Bratcher, Mike, EMNRD  
**Cc:** Pat Ellis  
**Subject:** COG - RJU #119 Work Plan  
**Attachments:** COG - RJU #119, Work Plan.pdf; COG - RJU #119, Work Plan Figures.pdf

Mike,

Please find enclosed the COG - RJU #119 Work Plan. As discussed in our meeting, the proposed excavation depths and liner installation are presented in the work plan. COG is currently scheduling the excavation for next week. Our main concern on the excavation is the active Conoco line running through the spill area. Prior to excavation, I would like to discuss this issue with you. Please let me know if you have any questions concerning the work plan. I will mail you a hard copy of the work plan for your files. Thanks

Ike Tavaréz, P.E. Senior Project Manager

Phone: 432 682 4559 | Fax: 432 682 3943 | Cell: 432 425 3278

[Ike.Tavaréz@tetrattech.com](mailto:Ike.Tavaréz@tetrattech.com)

Tetra Tech - Complex World. Clear Solutions™

1910 North 9th Spring - Midland, TX 79701 | [www.tetrattech.com](http://www.tetrattech.com)

PLEASE NOTE: This message, including any attachments, may include privileged, confidential and/or inside information. Any distribution or use of this communication by anyone other than the intended recipient is strictly prohibited and may be unlawful. If you are not the intended recipient, please notify the sender by replying to this message and then delete it from your system.

---

This inbound email has been scanned for malicious software and transmitted safely to you using Webroot Email Security.

---



**TETRA TECH**

October 6, 2009

Mr. Mike Bratcher  
Environmental Engineer Specialist  
Oil Conservation Division, District 2  
1301 West Grand Avenue  
Artesia, NM 88210

**Re: Work Plan for the COG Operating LLC., RJU Unit #119, Injection line leak, Unit P, Section 27, Township 17 South, Range 29 East, Eddy County, New Mexico.**

Mr. Bratcher:

Tetra Tech Inc. (Tetra Tech) was contacted by COG Operating LLC. (COG) to assess a spill from the RJU #119 located in Unit P, Section 27, Township 17 South, Range 29 East, Eddy County, New Mexico (Site). The spill site coordinates are N 32.80042°, W 104.05663°. The site location is shown on Figures 1 and 2.

### **Background**

According to the State of New Mexico C-141 Initial Report, the leak was discovered on May 30, 2009. Approximately 200 barrels of produced water was released from a hole on a 2-inch injection line. The 2 inch poly line was repaired with new connections. Vacuum trucks were utilized to recover 150 barrels of standing fluids. The initial C-141 is enclosed in Appendix A.

### **Groundwater**

No water wells were listed within Section 27. An abandoned water well was located in Section 35 and measured a total depth of 153' (dry). According to the Geology and Groundwater Resources of Eddy County, New Mexico (Report 3), one well is located in Section 22 (Bear Grass Draw) with a depth to water of 79.0' below surface. In addition, a well located in Section 29 was reported at 210 below surface. According to the NMOCD groundwater map the average depth to groundwater in this area is approximately 150' below surface. The Geology and Groundwater Resources of Eddy County, New Mexico (Report 3) well report data is shown in Appendix B.

Tetra Tech

1910 North Big Spring, Midland, TX 79705

Tel: 432.682.3539 Fax: 432.682.3946 [www.tetratech.com](http://www.tetratech.com)



## **Regulatory**

A risk-based evaluation was performed for the Site in accordance with the New Mexico Oil Conservation Division (NMOCD) Guidelines for Remediation of Leaks, Spills and Releases, dated August 13, 1993. The guidelines require a risk-based evaluation of the site to determine recommended remedial action levels (RRAL) for benzene, toluene, ethylbenzene and xylene (collectively referred to as BTEX) and total petroleum hydrocarbons (TPH) in soil. The proposed RRAL for benzene was determined to be 10 parts per million (ppm) or milligrams per kilogram (mg/kg) and 50 ppm for total BTEX (sum of benzene, toluene, ethylbenzene, and xylene). Based upon the depth to groundwater, the proposed RRAL for TPH is 5,000 mg/kg.

## **Soil Assessment and Results**

On June 4, 2009, Tetra Tech personnel inspected the spill area, which measured approximately 40' x 205' and 10' x 100', located west of the County Road. Prior to sampling, COG excavated 1.0' to 2.0' of impacted soil and hauled to proper disposal. A total of seven (7) auger holes (AH-1 through AH-7) were installed using a stainless steel hand auger to assess the impacted soils. Select samples were analyzed for TPH analysis by EPA method 8015 modified, BTEX by EPA Method 8021B and chloride by EPA method 300.0. Copies of laboratory analysis and chain-of-custody documentation are included in Appendix D. The results of the sampling are summarized in Table 1.

Referring to Table 1, AH-1 and AH-2 samples exceeded the TPH RRAL to a depth of 2.0' below surface. In addition, the total BTEX exceeded the RRAL in AH-1 and AH-2. Elevated chloride concentrations were detected in all of the auger holes, with no chlorides delineated in any of the auger holes.

In order to complete delineation of the chlorides at the sites, on June 30, 2009, Tetra Tech personnel were onsite to install ten (10) boreholes (SB-1 through SB-10) utilizing an air rotary rig. Some of the borings were installed in the vicinity of the previous auger holes. The boreholes were extended to a maximum depth of 15 to 35 feet bgs with samples collected at 2 to 3 foot intervals for the first 15 feet and 5 foot intervals thereafter and submitted to the laboratory for analysis of chlorides and selected samples for BTEX.

Analytical results indicate the maximum extent of chloride impact greater than 1,000 mg/kg extended from 11 feet (SB-2) to 30 feet (SB-1) bgs. All samples had chloride concentrations that decreased with depth. Borehole logs are included in Appendix C. Copies of laboratory analysis and chain-of-custody documentation are included in Appendix D. The results of the sampling are summarized in Table 1. The borehole and auger hole locations are shown on Figure 3.

## **Work Plan**

Based upon the corrective action discussion with the NMOCD on July 27, 2009, Tetra Tech personnel will supervise the removal of impacted soils for proper disposal. In addition, selected excavated areas will be capped (lined) with a 40 mil plastic liner.



**TETRA TECH**

Once the areas are excavated to the appropriate depths, the excavation will be backfilled with clean soil. The liner will be installed at a depth of 4.0' below surface. The depths of the excavations and liner installation areas are shown on Figure 4. Two lines are located in the area of spill/excavation. The active line (Conoco) is running east and west through the center of the spill area and an abandoned line (DCP) runs north and south through the spill. These areas will need to be cleared prior to excavating around the lines.

If you require any additional information or have any questions or comments concerning this report, please call at (432) 682-4559.

Respectfully submitted,  
TETRA TECH

Ike Tavarez, P.G.  
Senior Project Manager

cc: Pat Ellis – COG

**Table 1**  
**COG Operating LLC**  
**RJU #119 Flowline Spill**  
**Eddy County, New Mexico**

Area	Sample ID	Date Sampled	Sample Depth (ft)	Soil Status		TPH (mg/kg)			Benzene (mg/kg)	Toluene (mg/kg)	Ethylbenzene (mg/kg)	Xylene (mg/kg)	Chloride (mg/kg)
				In-Situ	Removed	DRO	GRO	Total					
Area of SB-1	AH-5	6/4/2009	0-1	X		3200	19.9	3219.9	-	-	-	-	1170
		6/4/2009	1-1.5	X		-	-	-	-	-	-	-	412
		6/4/2009	2-2.5	X		-	-	-	-	-	-	-	535
		6/4/2009	3-3.5	X		-	-	-	-	-	-	-	638
		6/4/2009	4-4.5	X		-	-	-	-	-	-	-	1160
		6/4/2009	5-5.5	X		-	-	-	-	-	-	-	937
		6/4/2009	6-6.5	X		-	-	-	-	-	-	-	927
		6/4/2009	7-7.5	X		-	-	-	-	-	-	-	1380
		6/4/2009	8-8.5	X		-	-	-	-	-	-	-	1100
Area of SB-2	AH-4	6/4/2009	0-1	X		<50.0	18.1	18.1	-	-	-	-	5390
		6/4/2009	1-1.5	X		-	-	-	-	-	-	-	5570
		6/4/2009	2-2.5	X		-	-	-	-	-	-	-	8120
		6/4/2009	3-3.5	X		-	-	-	-	-	-	-	3280
		6/4/2009	4-4.5	X		-	-	-	-	-	-	-	2740
		6/4/2009	5-5.5	X		-	-	-	-	-	-	-	2710
		6/30/2009	5-6	X		-	-	-	-	-	-	-	3,990
		6/30/2009	8-9	X		-	-	-	-	-	-	-	3,290
		6/30/2009	11-12	X		-	-	-	-	-	-	-	590
Area of SB-2	SB-2	6/30/2009	13-14	X		-	-	-	-	-	-	-	207
		6/30/2009	15-16	X		-	-	-	-	-	-	-	<200
Area of SB-2	Liner	6/30/2009	11-12	X		-	-	-	-	-	-	-	6,240
		6/30/2009	13-14	X		-	-	-	-	-	-	-	2,760
		6/30/2009	15-16	X		-	-	-	-	-	-	-	4,210
		6/30/2009	20-21	X		-	-	-	-	-	-	-	1,870
		6/30/2009	25-26	X		-	-	-	-	-	-	-	1,290
		6/30/2009	30-31	X		-	-	-	-	-	-	-	706
		6/30/2009	35-36	X		-	-	-	-	-	-	-	406

(-) Not Analyzed

Proposed Excavation Depths  
 \_\_\_\_\_ Liner

**Table 1**  
**COG Operating LLC**  
**RJU #119 Flowline Spill**  
**Eddy County, New Mexico**

Area	Sample ID	Date Sampled	Sample Depth (ft)	Soil Status		TPH (mg/kg)			Benzene (mg/kg)	Toluene (mg/kg)	Ethlybenzene (mg/kg)	Xylene (mg/kg)	Chloride (mg/kg)
				In-Situ	Removed	DRO	GRO	Total					
Area of SB-3	AH-3	6/4/2009	0-1	X		<50.0	31.6	31.6	-	-	-	-	2330
		6/4/2009	1-1.5	X		-	-	-	-	-	-	-	799
		6/4/2009	2-2.5	X		-	-	-	-	-	-	-	468
		6/4/2009	3-3.5	X		-	-	-	-	-	-	-	1350
		6/4/2009	4-4.5	X		-	-	-	-	-	-	-	2490
		6/4/2009	5-5.5	X		-	-	-	-	-	-	-	3540
		6/4/2009	6-6.5	X		-	-	-	-	-	-	-	4080
	SB-3		5-6	X		-	-	-	-	-	-	-	1,430
		6/30/2009	8-9	X		-	-	-	-	-	-	-	2,880
		6/30/2009	11-12	X		-	-	-	-	-	-	-	2,820
		6/30/2009	13-14	X		-	-	-	-	-	-	-	2,250
		6/30/2009	15-16	X		-	-	-	-	-	-	-	1,980
		6/30/2009	20-21	X		-	-	-	-	-	-	-	993
		6/30/2009	25-26	X		-	-	-	-	-	-	-	<200
Area of SB-4	SB-4	6/30/2009	0-1	X		1160	736	1896	<0.0500	7.52	19.5	43.0	1,070
		6/30/2009	2-3	X		691	817	1508	<0.100	7.19	20.1	37.2	1,520
		6/30/2009	5-6	X		-	-	-	<0.0500	6.06	23.2	34.0	1,390
		6/30/2009	8-9	X		-	-	-	<0.0100	<0.0100	<0.0100	<0.0100	1,860
		6/30/2009	11-12	X		-	-	-	-	-	-	-	1,790
		6/30/2009	13-14	X		-	-	-	-	-	-	-	966
		6/30/2009	15-16	X		-	-	-	-	-	-	-	518
		6/30/2009	20-21	X		-	-	-	-	-	-	-	510
		6/30/2009	25-26	X		-	-	-	-	-	-	-	336

(-) Not Analyzed



Proposed Excavation Depths

Liner

**Table 1**  
**COG Operating LLC**  
**RJU #119 Flowline Spill**  
**Eddy County, New Mexico**

Area	Sample ID	Date Sampled	Sample Depth (ft)	Soil Status		TPH (mg/kg)			Benzene (mg/kg)	Toluene (mg/kg)	Ethlybenzene (mg/kg)	Xylene (mg/kg)	Chloride (mg/kg)
				In-Situ	Removed	DRO	GRO	Total					
Area of SB-5	AH-2	6/4/2009	0-1	X		3570	2330	5900	7.55	74.1	72.5	101	1250
		6/4/2009	1-1.5	X		4320	2830	7150	9.86	112	105	129	1670
		6/4/2009	2-2.5	X		1120	2370	3490	4.78	94.4	93.5	118	3250
		6/4/2009	3-3.5	X		-	-	-	-	-	-	-	4760
		6/4/2009	4-4.5	X		-	-	-	-	-	-	-	5240
		6/4/2009	5-5.5	X		-	-	-	-	-	-	-	5740
		6/4/2009	6-6.5	X		-	-	-	-	-	-	-	5270
	SB-5	6/30/2009	3-4	X		-	-	-	<0.0100	<0.0100	<0.0100	<0.0100	2,670
		6/30/2009	5-6	X		-	-	-	-	-	-	-	1,790
		6/30/2009	8-9	X		-	-	-	-	-	-	-	2,950
		6/30/2009	11-12	X		-	-	-	-	-	-	-	3,660
		6/30/2009	13-14	X		-	-	-	-	-	-	-	5,090
		6/30/2009	15-16	X		-	-	-	-	-	-	-	5,090
		6/30/2009	20-21	X		-	-	-	-	-	-	-	2,600
	liners	6/30/2009	25-26	X		-	-	-	-	-	-	-	386
Area of SB-6	SB-6	6/30/2009	0-1	X		-	-	-	-	-	-	-	1,380
		6/30/2009	2-3	X		-	-	-	-	-	-	-	10,200
		6/30/2009	5-6	X		-	-	-	-	-	-	-	5,910
		6/30/2009	8-9	X		-	-	-	-	-	-	-	6,300
		6/30/2009	11-12	X		-	-	-	-	-	-	-	2,430
		6/30/2009	13-14	X		-	-	-	-	-	-	-	1,850
		6/30/2009	15-16	X		-	-	-	-	-	-	-	436
		6/30/2009	20-21	X		-	-	-	-	-	-	-	421
		6/30/2009	25-26	X		-	-	-	-	-	-	-	389
		6/30/2009	30-31	X		-	-	-	-	-	-	-	<200

(-) Not Analyzed

 Proposed Excavation Depths

 Liner

**Table 1**  
**COG Operating LLC**  
**RJU #119 Flowline Spill**  
**Eddy County, New Mexico**

Area	Sample ID	Date Sampled	Sample Depth (ft)	Soil Status		TPH (mg/kg)			Benzene (mg/kg)	Toluene (mg/kg)	Ethlybenzene (mg/kg)	Xylene (mg/kg)	Chloride (mg/kg)
				In-Situ	Removed	DRO	GRO	Total					
Area of SB-7	AH-1	6/4/2009	0-1	X		6910	766	7676	<0.0500	2.80	22.2	34.9	1520
		6/4/2009	1-1.5	X		4140	1130	5270	-	-	-	-	1690
		6/4/2009	2-2.5	X		<50.0	21.0	21.0	-	-	-	-	675
		6/4/2009	3-3.5	X		-	-	-	-	-	-	-	1280
		6/4/2009	4-4.5	X		-	-	-	-	-	-	-	1440
		6/4/2009	5-5.5	X		-	-	-	-	-	-	-	1450
		6/4/2009	6-6.5	X		-	-	-	-	-	-	-	994
liner	SB-7	6/30/2009	5-6	X		-	-	-	-	-	-	-	6,230
		6/30/2009	8-9	X		-	-	-	-	-	-	-	4,100
		6/30/2009	11-12	X		-	-	-	-	-	-	-	3,180
		6/30/2009	13-14	X		-	-	-	-	-	-	-	1,820
		6/30/2009	15-16	X		-	-	-	-	-	-	-	1,590
		6/30/2009	20-21	X		-	-	-	-	-	-	-	1,180
		6/30/2009	25-26	X		-	-	-	-	-	-	-	952
		6/30/2009	30-31	X		-	-	-	-	-	-	-	309
Area of SB-8	SB-8	6/30/2009	0-1	X		-	-	-	-	-	-	-	10,700
		6/30/2009	2-3	X		-	-	-	-	-	-	-	3,980
		6/30/2009	5-6	X		-	-	-	-	-	-	-	3,120
		6/30/2009	8-9	X		-	-	-	-	-	-	-	3,390
		6/30/2009	11-12	X		-	-	-	-	-	-	-	3,130
		6/30/2009	13-14	X		-	-	-	-	-	-	-	4,020
		6/30/2009	15-16	X		-	-	-	-	-	-	-	5,120
		6/30/2009	20-21	X		-	-	-	-	-	-	-	4,480
		6/30/2009	25-26	X		-	-	-	-	-	-	-	275
		6/30/2009	30-31	X		-	-	-	-	-	-	-	310

(-) Not Analyzed

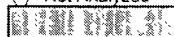

Proposed Excavation Depths

Liner



Table 1  
COG Operating LLC  
RJU #119 Flowline Spill  
Eddy County, New Mexico

Area	Sample ID	Date Sampled	Sample Depth (ft)	Soil Status		TPH (mg/kg)			Benzene (mg/kg)	Toluene (mg/kg)	Ethylbenzene (mg/kg)	Xylene (mg/kg)	Chloride (mg/kg)
				In-Situ	Removed	DRO	GRO	Total					
Area of SB-9	AH-6	6/4/2009	0-1	X		<50.0	<1.00	<50.0	-	-	-	-	6750
		6/4/2009	1-1.5	X		-	-	-	-	-	-	-	8750
		6/4/2009	2-2.5	X		-	-	-	-	-	-	-	1180
		6/4/2009	3-3.5	X		-	-	-	-	-	-	-	1120
		6/4/2009	4-4.5	X		-	-	-	-	-	-	-	3710
	liner	6/4/2009	5-5.5	X		-	-	-	-	-	-	-	2850
		6/4/2009	6-6.5	X		-	-	-	-	-	-	-	2540
	SB-9	6/30/2009	5-6	X		-	-	-	-	-	-	-	2,080
		6/30/2009	8-9	X		-	-	-	-	-	-	-	3,030
		6/30/2009	11-12	X		-	-	-	-	-	-	-	3,150
		6/30/2009	13-14	X		-	-	-	-	-	-	-	2,370
		6/30/2009	15-16	X		-	-	-	-	-	-	-	2,260
		6/30/2009	20-21	X		-	-	-	-	-	-	-	5,250
		6/30/2009	25-26	X		-	-	-	-	-	-	-	838
		6/30/2009	30-31	X		-	-	-	-	-	-	-	486
Area of SB-10	SB-10	6/30/2009	0-1	X		-	-	-	-	-	-	-	<200
		6/30/2009	2-3	X		-	-	-	-	-	-	-	527
		6/30/2009	5-6	X		-	-	-	-	-	-	-	1,150
		6/30/2009	8-9	X		-	-	-	-	-	-	-	2,360
		6/30/2009	11-12	X		-	-	-	-	-	-	-	9,190
	liner	6/30/2009	13-14	X		-	-	-	-	-	-	-	7,050
		6/30/2009	15-16	X		-	-	-	-	-	-	-	4,920
		6/30/2009	20-21	X		-	-	-	-	-	-	-	3,620
		6/30/2009	25-26	X		-	-	-	-	-	-	-	2,140
		6/30/2009	30-31	X		-	-	-	-	-	-	-	709
		6/30/2009	35-36	X		-	-	-	-	-	-	-	274

(-) Not Analyzed

Proposed Excavation Depths

Liner

Table 1  
COG Operating LLC  
RJU #119 Flowline Spill  
Eddy County, New Mexico

Area	Sample ID	Date Sampled	Sample Depth (ft)	Soil Status		TPH (mg/kg)			Benzene (mg/kg)	Toluene (mg/kg)	Ethlybenzene (mg/kg)	Xylene (mg/kg)	Chloride (mg/kg)
				In-Situ	Removed	DRO	GRO	Total					
Area of SB-11	AH-7	6/4/2009	0-1	X		<50.0	6.14	6.14	-	-	-	-	8240
		6/4/2009	1-1.5	X		-	-	-	-	-	-	-	6460
		6/4/2009	2-2.5	X		-	-	-	-	-	-	-	9000
		6/4/2009	3-3.5	X		-	-	-	-	-	-	-	9310
SB-11		6/30/2009	5-6	X		-	-	-	-	-	-	-	3,820
		6/30/2009	8-9	X		-	-	-	-	-	-	-	4,030
		6/30/2009	11-12	X		-	-	-	-	-	-	-	9,070
		6/30/2009	13-14	X		-	-	-	-	-	-	-	4,930
		6/30/2009	15-16	X		-	-	-	-	-	-	-	3,750
		6/30/2009	20-21	X		-	-	-	-	-	-	-	1,330
		6/30/2009	25-26	X		-	-	-	-	-	-	-	310
		6/30/2009	30-31	X		-	-	-	-	-	-	-	284

(-) Not Analyzed

Proposed Excavation Depths  
Liner

District I  
1625 N. French Dr., Hobbs, NM 88240  
District II  
1301 W. Grand Avenue, Artesia, NM 88210  
District III  
1000 Rio Brazos Road, Aztec, NM 87410  
District IV  
1220 S. St. Francis Dr., Santa Fe, NM 87505

State of New Mexico  
Energy Minerals and Natural Resources  
Oil Conservation Division  
1220 South St. Francis Dr.  
Santa Fe, NM 87505

Form C-14  
Revised October 10, 200

Submit 2 Copies to appropriate  
District Office in accordance  
with Rule 116 on back  
side of form

**Release Notification and Corrective Action**

**OPERATOR**

☒ Initial Report ☐ Final Report

Name of Company	COG OPERATING LLC	Contact	Kanicia Carrillo
Address	550 W. Texas, Suite 1300 Midland, TX 79701	Telephone No.	432-685-4332
Facility Name	RJ Unit #119	Facility Type	Injection Well
Surface Owner	Mineral Owner	Lease No. 30-015-03146	

**LOCATION OF RELEASE**

Unit Letter	Section	Township	Range	Feet from the	North/South Line	Feet from the	East/West Line	County
O	27	17S	29E	660	South	1980	East	Eddy

Latitude \_\_\_\_\_ Longitude \_\_\_\_\_

**NATURE OF RELEASE**

Type of Release-Produced Water	Volume of Release-200bbls	Volume Recovered- 150bbls
Source of Release- Hole in 2" injection line	Date and Hour of Occurrence- 5/30/09- 12:00 pm	Date and Hour of Discovery 5/30/09-12:00pm
Was Immediate Notice Given? <input checked="" type="checkbox"/> Yes <input type="checkbox"/> No <input type="checkbox"/> Not Required	If YES, To Whom? Mike Bratcher NMOCD District 2	
By Whom? Kent Greenway	Date and Hour 6/1/09- 9:30 am	
Was a Watercourse Reached? <input type="checkbox"/> Yes <input checked="" type="checkbox"/> No	If YES, Volume Impacting the Watercourse.	

If a Watercourse was Impacted, Describe Fully.\*

Describe Cause of Problem and Remedial Action Taken.\*

Hole in a 2" steel injection line. Injection was shut in at this location and the line will be replaced.

Describe Area Affected and Cleanup Action Taken.\*

Approximately 50' X 100' area in pasture was affected. All liquid was vacuumed up. The area is being dug out to a 1' depth for testing. Tetra Tech will sample the spill site area to delineate any possible contamination from the release and we will present a remediation work plan to the NMOCD/BLM for your approval prior to any significant remediation work.

I hereby certify that the information given above is true and complete to the best of my knowledge and understand that pursuant to NMOCD rules and regulations all operators are required to report and/or file certain release notifications and perform corrective actions for releases which may endanger public health or the environment. The acceptance of a C-141 report by the NMOCD marked as "Final Report" does not relieve the operator of liability should their operations have failed to adequately investigate and remediate contamination that pose a threat to ground water, surface water, human health or the environment. In addition, NMOCD acceptance of a C-141 report does not relieve the operator of responsibility for compliance with any other federal, state, or local laws and/or regulations.

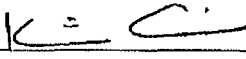
Signature: 		<b>OIL CONSERVATION DIVISION</b>	
Printed Name: Kanicia Carrillo		Approved by District Supervisor:	
Title: Regulatory Analyst		Approval Date:	Expiration Date:
E-mail Address: kcarrillo@conchoresources.com		Conditions of Approval:	Attached <input type="checkbox"/>
Date: 6/3/09 Phone: 432-685-4332			

\* Attach Additional Sheets If Necessary

**Water Well Data**  
**Average Depth to Groundwater (ft)**  
**COG - RJU Unit #119**  
**Eddy County, New Mexico**

16 South			28 East		
6	5	4	3	2	1
7	8	9	10	11	12
18	17	16	15	14	13
19	20	21	22	23	24
30	29	28	27	26	25
31	32	33	34	35	36

16 South			29 East		
6	5	4	3	2	1
7	8	9	10	11	12
18	17	16	15	14	13
19	20	21	22	23	24
30	29	28	27	26	25
31	32	33	34	35	36

16 South			30 East		
6	5	4	3	2	1
7	8	9	10	11	12
18	17	16	15	14	13
19	20	21	22	23	24
30	29	28	27	26	25
31	32	33	34	35	36

17 South			28 East		
6	5	4	3	2	1
7	8	9	10	11	12
18	17	16	15	14	13
19	20	21	22	23	24
30	29	28	27	26	25
31	32	33	34	35	36

17 South			29 East		
6	5	4	3	2	1
7	8	9	10	11	12
18	17	16	15	14	13
19	20	21	22	23	24
30	29	28	27	26	25
31	32	33	34	35	36

17 South			30 East		
6	5	4	3	2	1
7	8	9	10	11	12
18	17	16	15	14	13
19	20	21	22	23	24
30	29	28	27	26	25
31	32	33	34	35	36

18 South			28 East		
6	5	4	3	2	1
7	8	9	10	11	12
18	17	16	15	14	13
19	20	21	22	23	24
30	29	28	27	26	25
31	32	33	34	35	36

18 South			29 East		
6	5	4	3	2	1
7	8	9	10	11	12
18	17	16	15	14	13
19	20	21	22	23	24
30	29	28	27	26	25
31	32	33	34	35	36

18 South			30 East		
6	5	4	3	2	1
7	8	9	10	11	12
18	17	16	15	14	13
19	20	21	22	23	24
30	29	28	27	26	25
31	32	33	34	35	36

88 New Mexico State Engineers Well Reports

105 USGS Well Reports

90 Geology and Groundwater Conditions in Southern Lea, County, NM (Report 6)

Geology and Groundwater Resources of Eddy County, NM (Report 3)

34 NMOCD - Groundwater Data

123 Field water level

143 NMOCD Groundwater map well location

CLAYTON COUNTY

R.28E. Parallel R.29E. R.30E. South R.31E.

5d

5c

T.16S.

TO WALDEN

TO LAWRENCE

T.17S.

East

Meridian

T.18S.

5c

0158

0210?

016

018

019

020

021

022

023

024

025

026

027

028

029

030

031

032

033

034

035

036

037

038

039

040

041

042

043

044

045

046

047

048

049

050

051

052

053

054

055

056

057

058

059

060

061

062

063

064

065

066

067

068

069

070

071

072

073

074

075

076

077

078

079

080

081

082

083

084

085

086

087

088

089

090

091

092

093

094

095

096

097

098

099

100

101

102

103

104

105

106

107

108

109

110

111

112

113

114

115

116

117

118

119

120

121

122

123

124

125

126

127

128

129

130

131

132

133

134

135

136

137

138

139

140

141

142

143

144

145

146

147

148

149

150

151

152

153

154

155

156

157

158

159

160

161

162

163

164

165

166

167

168

169

170

171

172

173

174

175

176

177

178

179

180

181

182

183

184

185

186

187

188

189

190

191

192

193

194

195

196

197

198

199

200

201

202

203

204

205

206

207

208

209

210

211

212

213

214

215

216

217

218

219

220

221

222

223

224

225

226

227

228

229

230

231

232

233

234

235

236

237

238

239

240

241

242

243

244

245

246

247

248

249

250

251

252

253

254

255

256

257

258

259

260

261

262

263

264

265

266

267

268

269

270

271

272

273

274

275

276

277

278

279

280

281

282

283

284

285

286

287

288

289

290

291

292

293

294

295

296

297

298

299

300

301

302

303

304

305

306

307

308

309

310

311

312

313

314

315

316

317

318

319

320

321

322

323

324

325

326

327

328

329

330

331

332

333

334

335

336

337

338

339

340

341

342

343

344

345

346

347

348

349

350

351

352

353

354

355

356

357

358

359

360

361

362

363

364

365

366

367

368

369

370

371

372

373

374

375

376

377

378

379

380

381

382

383

384

385

386

387

388

389

390

391

392

393

394

395

396

397

398

399

400

401

402

403

404

405

406

407

408

409

410

411

412

413

414

415

416

417

418

419

420

421

422

423

424

425

426

427

428

429

430

431

432

433

434

435

436

437

438

439

440

441

44

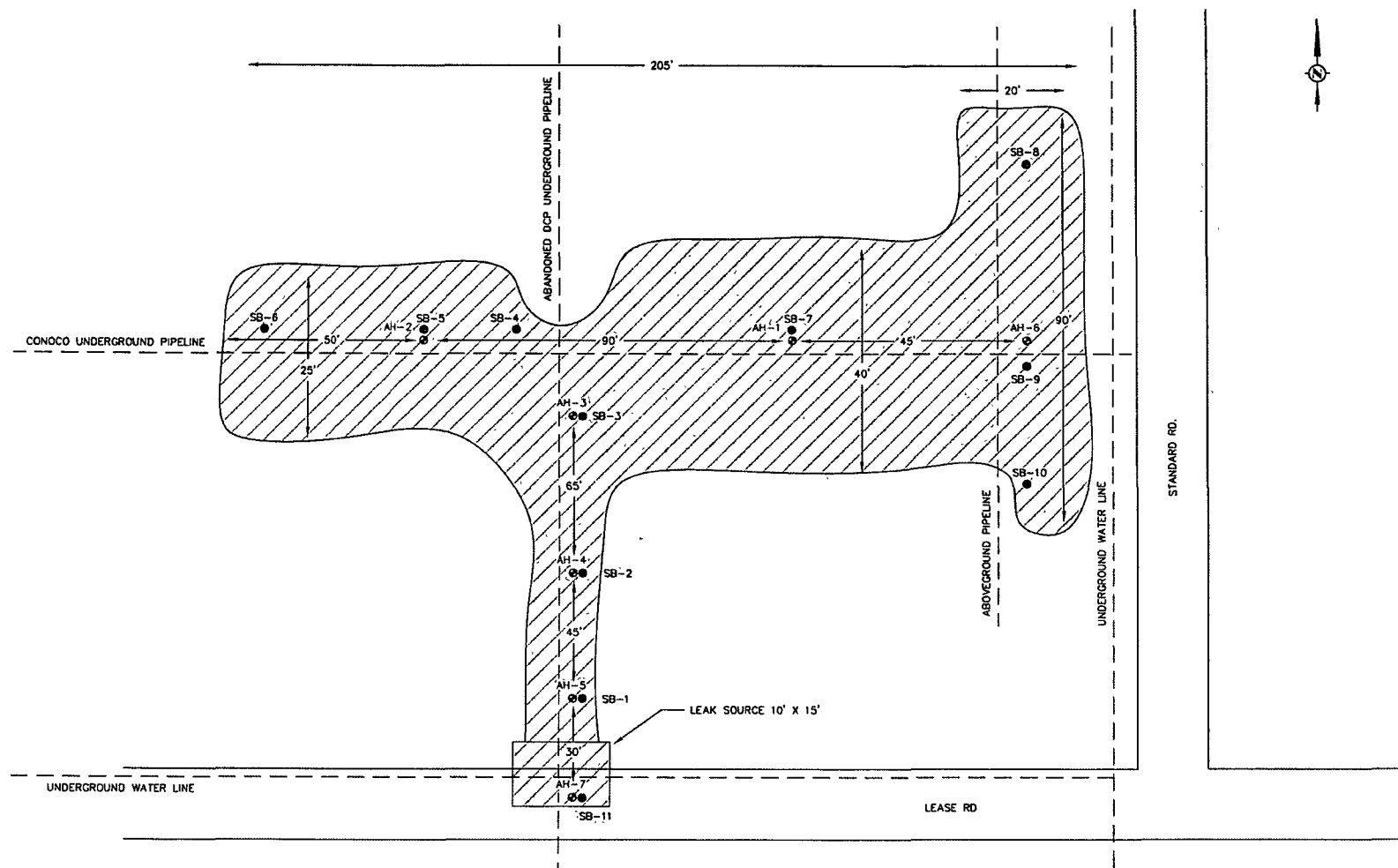

[Hatched Box] SPILL AREA  
 [Circle with Dot] SAMPLE LOCATIONS  
 [Dot] SOIL BORING LOCATIONS

NOT TO SCALE

DATE:  
6/12/09  
 DWN. BY:  
JJ  
 FILE:  
N:\COG\8402310  
RJU #119 FLOWLINE

FIGURE NO. 3

EDDY COUNTY, NEW MEXICO

COG OPERATING LLC

RJU #119 FLOWLINE LEAK

TETRA TECH, INC.  
 MIDLAND, TEXAS

