

*Log in & type order*

**AZTEC OIL & GAS COMPANY**

920 MERCANTILE SECURITIES BLDG.

DALLAS 1, TEXAS

1959 OCT 7 PM 1:51

October 2, 1959

*NW 1/4 333*  
*Cubana*

REGISTERED MAIL

Mr. A. L. Porter, Secretary-Director  
New Mexico Oil Conservation Commission  
P. O. Box 871  
Santa Fe, New Mexico

Re: Application of Aztec Oil & Gas Company  
for an Exception to Rule 6(A) of Order  
No. R-565-C for Administrative Approval  
of a Non-Standard Gas Proration Unit in  
the Aztec Pictured-Cliffs Gas Pool San  
Juan County, New Mexico

Dear Mr. Porter:

Pursuant to Rule 6(B) of the special rules pertaining to the Aztec Pictured-Cliffs Gas Pool of Order No. R-565-C, Aztec Oil & Gas Company (hereafter called "Applicant") hereby submits in triplicate its application for an exception to Rule 6(A) of such rules, and requests Administrative Approval of a Non-Standard Gas Proration Unit comprising all of Lots 1, 2, and  $E\frac{1}{2}NW\frac{1}{4}$ , or what may be known as the  $NW\frac{1}{4}$ , Section 18, Township 28 North, Range 9 West, N.M.P.M., San Juan County, New Mexico. It further requests that pursuant to Rule 9 of said special rules of Order R-565-C, as amended by Rule 9 of Order No. R-967, and upon approval of such Non-Standard Proration Unit, Applicant be granted an allowable for such well in the ratio which the area of the Non-Standard Proportion Unit bears to a Proration Unit of 160 acres; i.e. 140.99/160.

In support of this request for a Non-Standard Proration Unit, Applicant respectfully states and shows the following:

(1) The unorthodox size of the Proration Unit is due to a variation in legal subdivision of the United States Public Land Survey.

(2) The proposed Non-Standard Proration Unit is substantially in the form of a square and consists of contiguous quarter-quarter sections and/or lots.

(3) The Non-Standard Gas Proration Unit lies wholly within a single governmental section.

Mr. A. L. Porter

-2-

October 2, 1959

(4) The entire Non-Standard Gas Proration Unit may reasonably be presumed to be productive of gas.

(5) Applicant owns all of the acreage within the section on which is located the proposed Non-Standard Unit, as is indicated on Exhibit "A" attached hereto and by reference made a part hereof.

(6) Applicant is the only operator that owns acreage offsetting the Non-Standard Unit.

WHEREFOR, Aztec Oil & Gas Company respectfully requests that the Secretary-Director of the Commission, by Administrative Approval, grant an exception to Rule 6(A) of the Special Rules for the Aztec Pictured-Cliffs Gas Pool of Order No. R-565-C, as amended by Order No. R-967, without notice and hearing, approving the Non-Standard Gas Proration Unit set forth above.

Yours very truly,

AZTEC OIL & GAS COMPANY

By   
Gordon L. Llewellyn  
Attorney

Mr. A. L. Porter

-3-

October 2, 1959

STATE OF TEXAS     )  
                              )  
COUNTY OF DALLAS    )

Gordon L. Llewellyn, being first duly sworn, hereby states that he is the attorney of Aztec Oil & Gas Company, the applicant in the foregoing application; that he has executed said application on behalf of Aztec Oil & Gas Company; that he has read said application and to the best of his knowledge, information and belief, all statements of fact contained therein are true and correct.

  
Gordon L. Llewellyn

Sworn to and subscribed before me, the undersigned authority, on this 2d day of October, 1959.

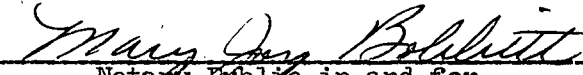
  
Notary Public in and for  
Dallas County, Texas

My Commission Expires:

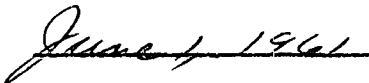

# EXHIBIT "A"

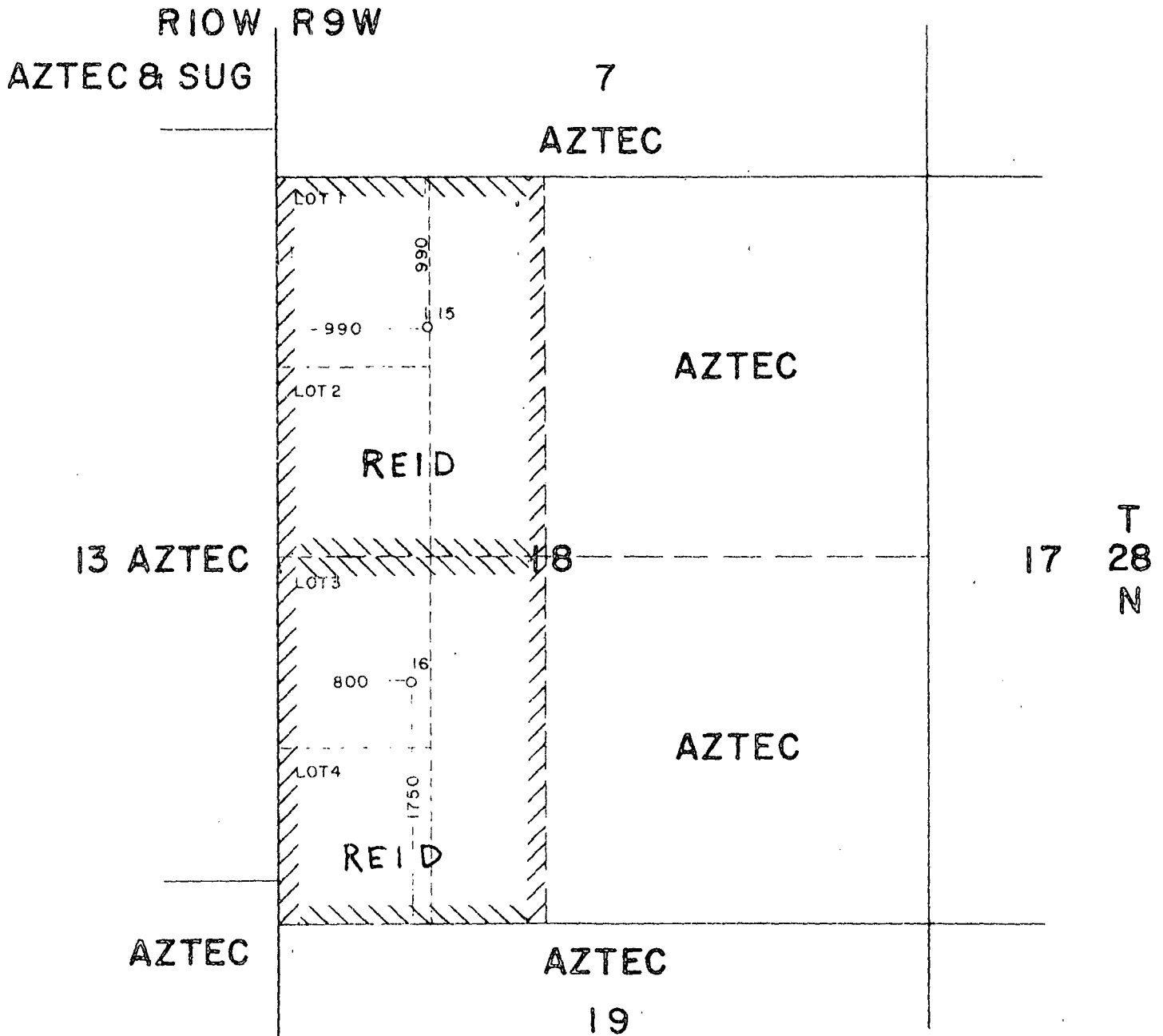

## PLAT

SCALE 1"=1000'

Accompanying application for  
 Non-Standard Units in Aztec  
 Pictured Creek's Pool for Aztec  
 Oil & Gas Company's Reid #15  
 NW 1/4 Section 16-T28N-R9W of 140.99  
 acres and Reid #16 SW 1/4 Section 18  
 T28N-R9W of 141.29 acres.

AZTEC OIL & GAS COMPANY