

DATE IN 8.19.10	SUSPENSE	ENGINEER DB	LOGGED IN 8.19.10	TYPE NSP	PTB-W APP NO. 1023145432
------------------------	----------	--------------------	--------------------------	-----------------	------------------------------------

ABOVE THIS LINE FOR DIVISION USE ONLY

NEW MEXICO OIL CONSERVATION DIVISION
 - Engineering Bureau -
 1220 South St. Francis Drive, Santa Fe, NM 87505



COG

State S-19#34

ADMINISTRATIVE APPLICATION CHECKLIST **30-015-37869**

THIS CHECKLIST IS MANDATORY FOR ALL ADMINISTRATIVE APPLICATIONS FOR EXCEPTIONS TO DIVISION RULES AND REGULATIONS WHICH REQUIRE PROCESSING AT THE DIVISION LEVEL IN SANTA FE

Application Acronyms:

[NSL-Non-Standard Location] [NSP-Non-Standard Proration Unit] [SD-Simultaneous Dedication]
[DHC-Downhole Commingling] [CTB-Lease Commingling] [PLC-Pool/Lease Commingling]
[PC-Pool Commingling] [OLS - Off-Lease Storage] [OLM-Off-Lease Measurement]
[WFX-Waterflood Expansion] [PMX-Pressure Maintenance Expansion]
[SWD-Salt Water Disposal] [IPI-Injection Pressure Increase]
[EOR-Qualified Enhanced Oil Recovery Certification] [PPR-Positive Production Response]

1945

[1] TYPE OF APPLICATION - Check Those Which Apply for [A]

[A] Location - Spacing Unit - Simultaneous Dedication
☐ NSL ☒ NSP ☐ SD

Check One Only for [B] or [C]

[B] Commingling - Storage - Measurement
☐ DHC ☐ CTB ☐ PLC ☐ PC ☐ OLS ☐ OLM

[C] Injection - Disposal - Pressure Increase - Enhanced Oil Recovery
☐ WFX ☐ PMX ☐ SWD ☐ IPI ☐ EOR ☐ PPR

[D] Other: Specify _____

RECEIVED OGD
200 AUG 19 AM 11:24

[2] NOTIFICATION REQUIRED TO: - Check Those Which Apply, or ☐ Does Not Apply

INTEREST ARE THE SAME

[A] ☐ Working, Royalty or Overriding Royalty Interest Owners

[B] ☒ Offset Operators, Leaseholders or Surface Owner

[C] ☐ Application is One Which Requires Published Legal Notice

[D] ☐ Notification and/or Concurrent Approval by BLM or SLO
 U.S. Bureau of Land Management - Commissioner of Public Lands, State Land Office

[E] ☒ For all of the above, Proof of Notification or Publication is Attached, and/or,

[F] ☐ Waivers are Attached

[3] SUBMIT ACCURATE AND COMPLETE INFORMATION REQUIRED TO PROCESS THE TYPE OF APPLICATION INDICATED ABOVE.

[4] CERTIFICATION: I hereby certify that the information submitted with this application for administrative approval is **accurate** and **complete** to the best of my knowledge. I also understand that **no action** will be taken on this application until the required information and notifications are submitted to the Division.

Note: Statement must be completed by an individual with managerial and/or supervisory capacity.

ROBYN M. ODOM
Print or Type Name

Signature

REGULATORY ANALYST
Title

8/18/10
Date

(432) 685-4385
Phone Number

rododm@conchoresources.com
E-mail Address

State S-19 #34

COG proposes to drill a SW/4, 27.40 acre spacing
Empire; Glorieta-Yeso oil well
TD of approximately 5550'

Location:

1700' FSL & 700' FWL Sec 19, T17S, R29E, Lot 3 Eddy County, NM

This location is in Lot 3 and is 27.40 acres which is approximately 70% of a 40 acre unit, and therefore a Non Standard Spacing Unit. The proposed location is the third Empire Yeso well in this lot.

The plan for this well is to complete it in the Yeso formation. We won't know the exact perms until we drill & log it, but it will be very similar to the State S-19 #31 (1650' FSL & 330' FWL, Lot 3) which was completed in May 2007.

The State S-19 #31 completion broke the Yeso up into 2 perf/stimulation intervals. At this time, we assume the State S-19 #34 should be very similar.

State S-19 #31 has perms from: 4349' – 5068' overall, but broken up into 2 separate intervals, with 2 separate fracs.

1st interval: 4349' – 4569',
acidized w/ 2500 gals,
frac'd w/ 95,096 gals gel, 8,011 # LiteProp, & 76,756# 16/30 sand.

2nd interval: 4788' – 5068',
acidized w/ 2000 gals,
frac'd w/ 76,996 gals gel, 8000# LiteProp, & 50,620# 16/30 sand.

Attachment 1

Plat showing 27.40 acre spacing

Attachment 2

Map & legend of offset wells.

Attachment 3

Updated land plat showing COG Operating LLC acreage.
The adjoining units this affects are Units E, F, K, M, N of Section 19 and Units H, I, P of Section 24 .

The proposed location is the third Empire; Glorieta-Yeso well in this Lot.

COG Operating LLC respectfully requests administrative approval without
hearing for this Non-standard Spacing Unit.

DISTRICT I
1625 N. FRENCH DR., HOBBS, NM 88240

State of New Mexico
Energy, Minerals and Natural Resources Department

Form C-102

DISTRICT II
1301 W. GRAND AVENUE, ARTESIA, NM 88210

OIL CONSERVATION DIVISION

Revised October 12, 2005
Submit to Appropriate District Office
State Lease - 4 Copies
Fee Lease - 3 Copies

DISTRICT III
1000 RIO BRAZOS RD., AZTEC, NM 87410

11885 SOUTH ST. FRANCIS DR.
Santa Fe, New Mexico 87505

DISTRICT IV
11885 S. ST. FRANCIS DR., SANTA FE, NM 87505

WELL LOCATION AND ACREAGE DEDICATION PLAT

☐ AMENDED REPORT

API Number 30-015-37869	Pool Code 96210	Pool Name EMPIRE; GLORIETA-YESO
Property Code 302569	Property Name STATE S-19	Well Number 34
OGRID No. 229137	Operator Name COG OPERATING, LLC	Elevation 3663'

Surface Location

UL or lot No. 3	Section 19	Township 17-S	Range 29-E	Lot Idn	Feet from the 1700	North/South line SOUTH	Feet from the 700	East/West line WEST	County EDDY
--------------------	---------------	------------------	---------------	---------	-----------------------	---------------------------	----------------------	------------------------	----------------

Bottom Hole Location If Different From Surface

UL or lot No.	Section	Township	Range	Lot Idn	Feet from the	North/South line	Feet from the	East/West line	County
Dedicated Acres 27.40	Joint or Infill	Consolidation Code	Order No.						

NO ALLOWABLE WILL BE ASSIGNED TO THIS COMPLETION UNTIL ALL INTERESTS HAVE BEEN CONSOLIDATED
OR A NON-STANDARD UNIT HAS BEEN APPROVED BY THE DIVISION

LOT 1									
27.36 AC LOT 2									
27.28 AC LOT 3									
27.40 AC LOT 4									
27.50 AC									

GEODETIC COORDINATES
NAD 27 NME
Y=661150.6 N
X=565951.5 E
LAT.=32.817407° N
LONG.=104.118657° W

700'

1700'

OPERATOR CERTIFICATION
I hereby certify that the information herein is true and complete to the best of my knowledge and belief, and that this organization either owns a working interest or unleased mineral interest in the land including the proposed bottom hole location or has a right to drill this well at this location pursuant to a contract with an owner of such mineral or working interest, or to a voluntary pooling agreement or a compulsory pooling order heretofore entered by the division.
Signature: Robyn Odom Date: 6/24/2010
Printed Name: Robyn Odom

SURVEYOR CERTIFICATION
I hereby certify that the well location shown on this plat was plotted from field notes of actual surveys made by me or under my supervision, and that the same is true and correct to the best of my belief.
Date Surveyed: 5/20/10 Rev. 5/20/10 DSS
Signature & Seal of: GARY G. EIDSON
Professional Surveyor
Certificate No. GARY G. EIDSON 12641
RONALD J. EIDSON 3239

SECTION 19, TOWNSHIP 17 SOUTH, RANGE 29 EAST, N.M.P.M.
 EDDY COUNTY NEW MEXICO

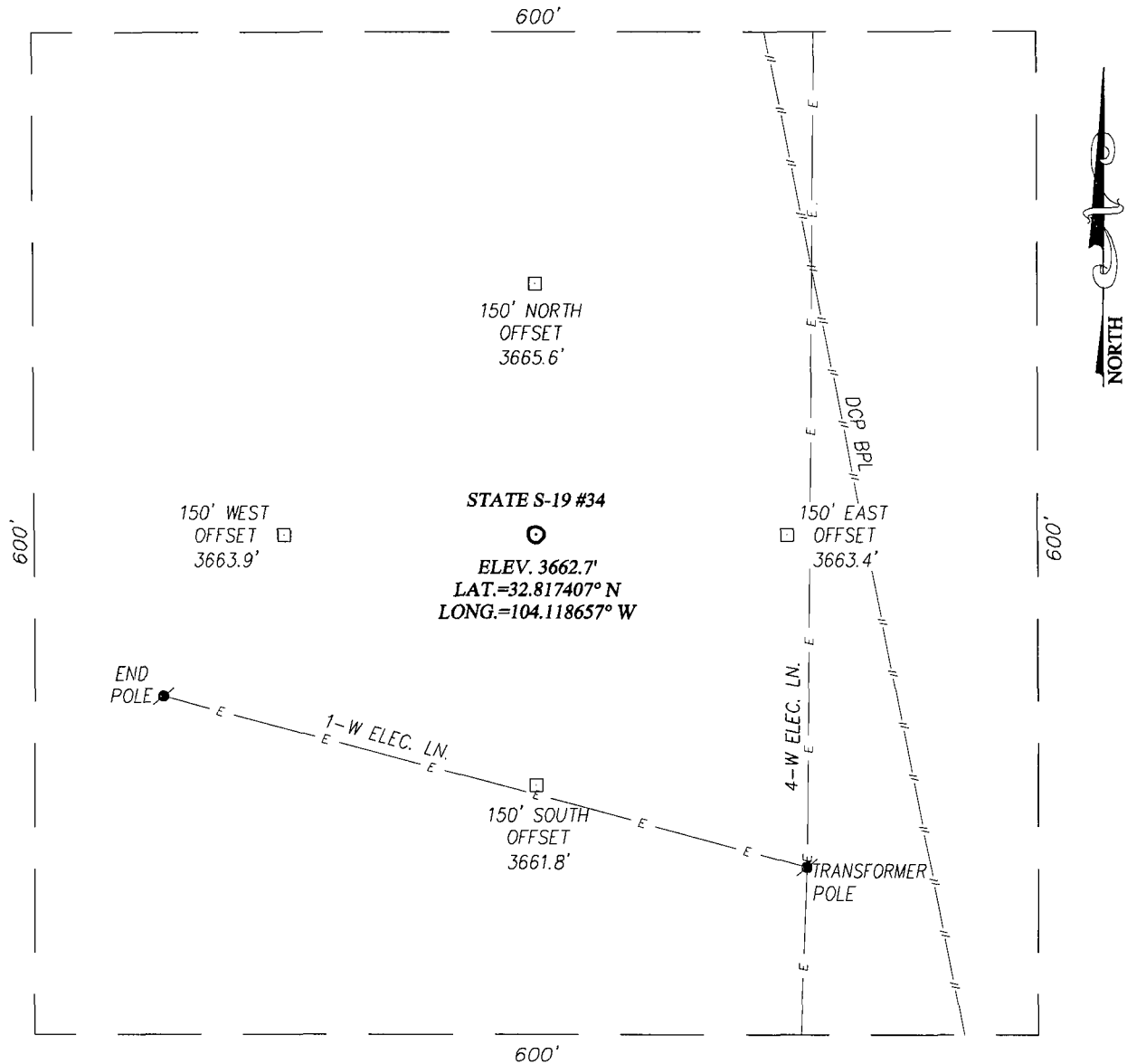

DIRECTIONS TO LOCATION

FROM THE INTERSECTION OF U.S. HIGHWAY #82 AND COUNTY ROAD #211 (OLD LOCO ROAD), GO WEST ON U.S. HIGHWAY #82 APPROX. 1.1 MILE. TURN RIGHT AND GO NORTH APPROX. 0.5 MILES. TURN LEFT AND GO WEST APPROX. 0.2 MILES. THIS LOCATION STAKE IS APPROX. 750 FEET NORTH OF LEASE RD.

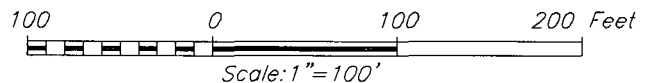

COG OPERATING, LLC

STATE S-19 #34 WELL
 LOCATED 1700 FEET FROM THE SOUTH LINE
 AND 700 FEET FROM THE WEST LINE OF SECTION 19,
 TOWNSHIP 17 SOUTH, RANGE 29 EAST, N.M.P.M.,
 EDDY COUNTY, NEW MEXICO

Survey Date: 5/4/10	Sheet 1 of 1 Sheets
W.O. Number: 10.11.0620	Dr By: DSS
Date: 5/10/10	10110620
	Scale: 1"=100'

PROVIDING SURVEYING SERVICES
 SINCE 1946

JOHN WEST SURVEYING COMPANY

412 N. DAL PASO
 HOBBS, N.M. 88240
 (575) 393-3117

VICINITY MAP

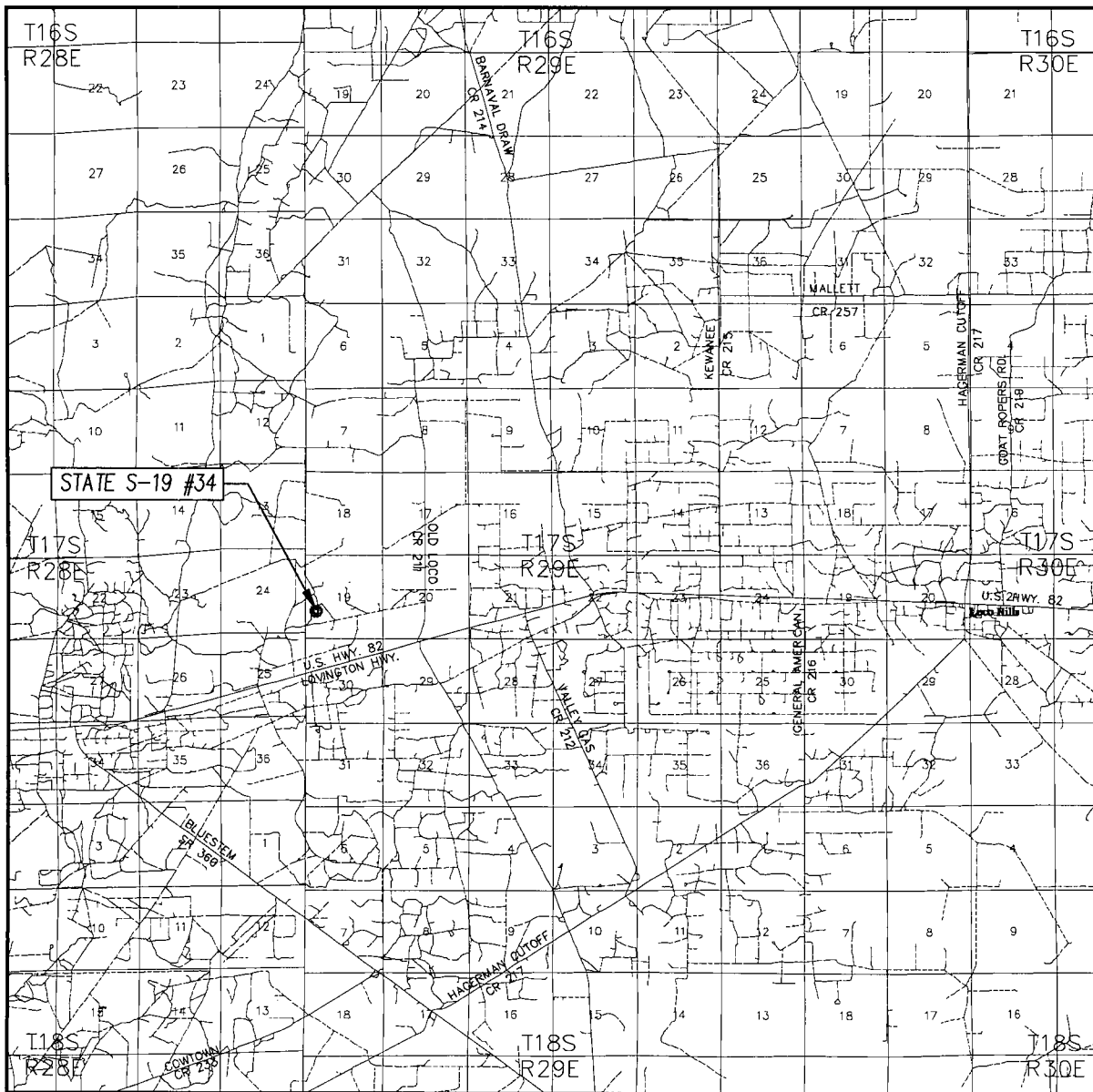

SCALE: 1" = 2 MILES

SEC. 19 TWP. 17-S RGE. 29-E

SURVEY N.M.P.M.

COUNTY EDDY STATE NEW MEXICO

DESCRIPTION 1700' FSL & 700' FWL

ELEVATION 3663'

OPERATOR COG OPERATING, LLC

LEASE STATE S-19

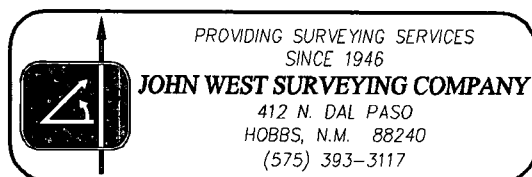

LOCATION VERIFICATION MAP

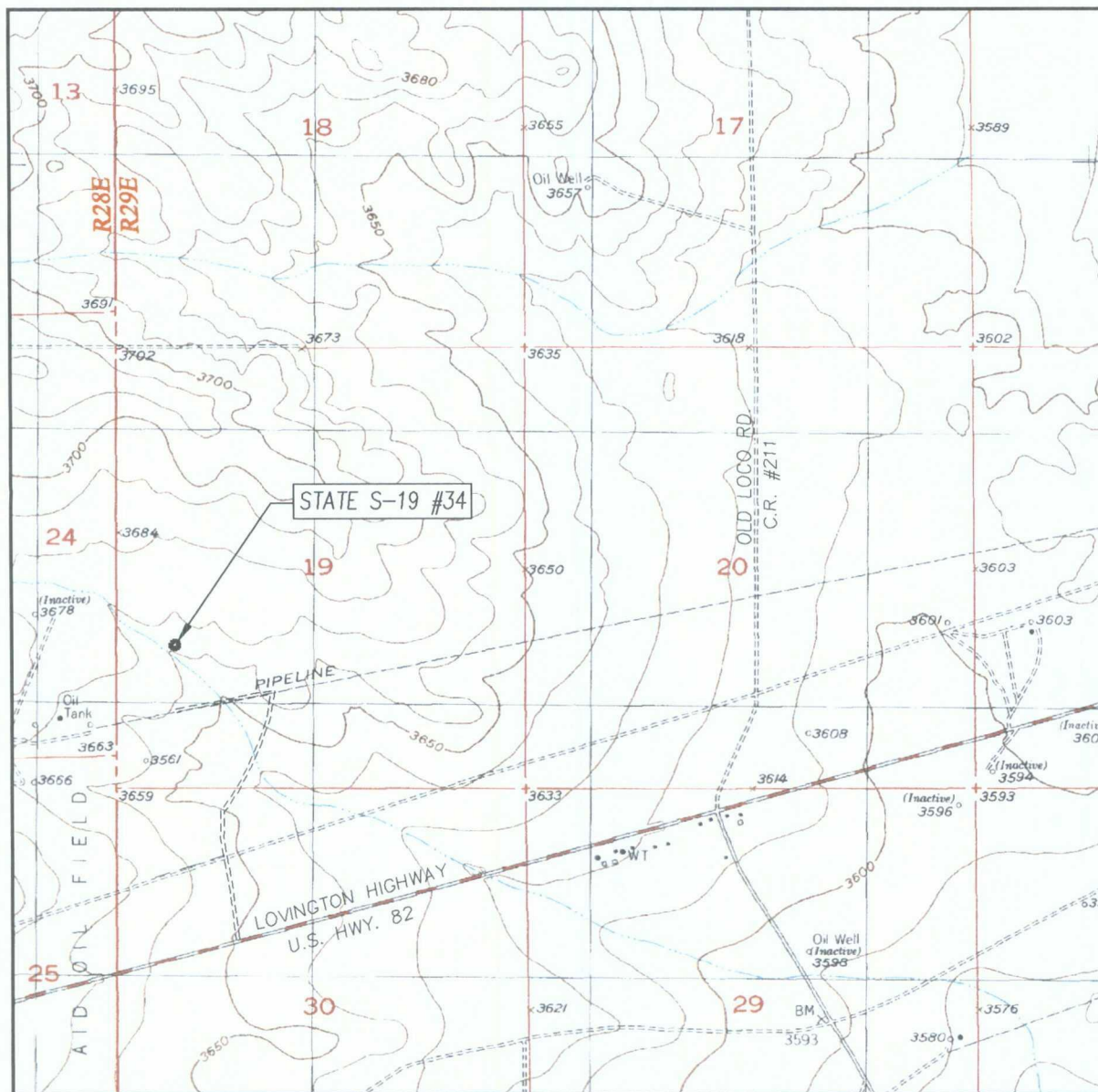

SCALE: 1" = 2000'

CONTOUR INTERVAL:
RED LAKE SE, N.M. - 10'

SEC. 19 TWP. 17-S RGE. 29-E

SURVEY N.M.P.M.

COUNTY EDDY STATE NEW MEXICO

DESCRIPTION 1700' FSL & 700' FWL

ELEVATION 3663'

OPERATOR COG OPERATING, INC.

LEASE STATE S-19

U.S.G.S. TOPOGRAPHIC MAP
RED LAKE SE, N.M.

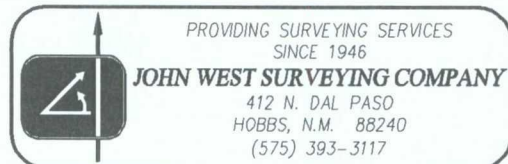

Offset Wells to State S-19 #34

API#	Operator	Lease	Well#	County	Legal	Field Name	Reservoir Name	Total Depth	Well Type	Well Status	First Prod.	Last Prod.
30-015-03001	MACK ENERGY CORP	STATE S-19	002	EDDY	S:19, T:17S, R:29E	SWD	GRAYBURG-SAN ANDRES	2,450	D	Pumping		
30-015-03005	DORAL ENERGY CORP.	SINCLAIR A STATE	001	EDDY	S:19, T:17S, R:29E	AID	YATES-SEVEN RIVERS	0	O	Pumping	Jan 1957	Mar 2010
30-015-03007	DORAL ENERGY CORP.	HUMBLE STATE	003	EDDY	S:19, T:17S, R:29E	AID	YATES-SEVEN RIVERS	0	O	Active	Aug 1956	Mar 2010
30-015-03008	DORAL ENERGY CORP.	HUMBLE STATE	004	EDDY	S:19, T:17S, R:29E	AID	YATES-SEVEN RIVERS	0	O	Active	Nov 1956	Mar 2010
30-015-22743	COG OPERATING LLC	STATE S-19	001	EDDY	S:19, T:17S, R:29E	EMPIRE	ABO	10,880	O	Active	Oct 1981	Mar 2010
30-015-22930	CLAYTON WILLIAMS ENERGY INC	GREEN B FEDERAL	009	EDDY	S:19, T:17S, R:29E	EMPIRE	MORROW, SOUTH (GAS)	10,870	I	Plugged and Abandoned	Jul 1979	Aug 2000
30-015-24143	MACK ENERGY CORP	STATE S-19	003	EDDY	S:19, T:17S, R:29E	EMPIRE	ABO	7,300	O	Pumping	Aug 1982	Oct 1985
30-015-24273	COG OPERATING LLC	STATE S-19	004	EDDY	S:19, T:17S, R:29E	EMPIRE	ABO	7,350	O	Active	Feb 1983	Mar 2010
30-015-25643	ENDURANCE RESOURCES LLC	GREEN FEDERAL	001	EDDY	S:19, T:17S, R:29E	AID	YATES-SEVEN RIVERS	0	PO	Pumping	Aug 1987	Mar 2010
30-015-29965	COG OPERATING LLC	STATE S-19	007	EDDY	S:19, T:17S, R:29E	EMPIRE	YESO	4,270	O	Pumping	Mar 1998	Mar 2010
30-015-30728	COG OPERATING LLC	STATE S-19	009	EDDY	S:19, T:17S, R:29E	EMPIRE	YESO	4,233	O	Pumping	Nov 1999	Mar 2010
30-015-30729	COG OPERATING LLC	STATE S-19	012	EDDY	S:19, T:17S, R:29E	EMPIRE	YESO	4,225	O	Pumping	Dec 1999	Mar 2010
30-015-30915	COG OPERATING LLC	STATE S-19	011	EDDY	S:19, T:17S, R:29E	EMPIRE	YESO	4,221	O	Pumping	Jul 2000	Mar 2010
30-015-30916	COG OPERATING LLC	STATE S-19	013	EDDY	S:19, T:17S, R:29E	EMPIRE	YESO	4,467	O	Pumping	Jul 2000	Mar 2010
30-015-30917	COG OPERATING LLC	STATE S-19	015	EDDY	S:19, T:17S, R:29E	EMPIRE	YESO	4,402	O	Pumping	Mar 2000	Mar 2010
30-015-30944	COG OPERATING LLC	STATE S-19	014	EDDY	S:19, T:17S, R:29E	EMPIRE	YESO	4,411	O	Pumping	May 2000	Mar 2010
30-015-31108	COG OPERATING LLC	STATE S-19	010	EDDY	S:19, T:17S, R:29E	EMPIRE	YESO	4,440	O	Pumping	Sep 2000	Mar 2010
30-015-31224	CLAYTON WILLIAMS ENERGY INC	PHILLIPS 19 FEDERAL	001	EDDY	S:19, T:17S, R:29E	EMPIRE	YESO, EAST	4,805	O	Pumping	Sep 2000	Sep 2000

30-015-31224	CLAYTON WILLIAMS ENERGY INC	PHILLIPS 19 FEDERAL	001	EDDY	S:19, T:17S, R:29E	EMPIRE			YESO		4,805	O	Pumping		Sep 2000	Apr 2010
30-015-31225	CLAYTON WILLIAMS ENERGY INC	PHILLIPS 19 FEDERAL	002	EDDY	S:19, T:17S, R:29E	EMPIRE			YESO, EAST		4,556	O	Pumping		Oct 2000	Oct 2000
30-015-31225	CLAYTON WILLIAMS ENERGY INC	PHILLIPS 19 FEDERAL	002	EDDY	S:19, T:17S, R:29E	EMPIRE			YESO		4,556	O	Pumping		Oct 2000	Apr 2010
30-015-31226	CLAYTON WILLIAMS ENERGY INC	PHILLIPS 19 FEDERAL	005	EDDY	S:19, T:17S, R:29E	EMPIRE			YESO		4,550	O	Pumping		Oct 2000	Apr 2010
30-015-31227	CLAYTON WILLIAMS ENERGY INC	PHILLIPS 19 FEDERAL	006	EDDY	S:19, T:17S, R:29E	EMPIRE			YESO		4,545	O	Pumping		Nov 2000	Apr 2010
30-015-31279	COG OPERATING LLC	STATE S-19	016	EDDY	S:19, T:17S, R:29E	EMPIRE			YESO		4,465	O	Pumping		Nov 2000	Mar 2010
30-015-31445	CLAYTON WILLIAMS ENERGY INC	PHILLIPS 19 FEDERAL	003	EDDY	S:19, T:17S, R:29E	EMPIRE			YESO		4,500	O	Pumping		Feb 2001	Apr 2010
30-015-31448	CLAYTON WILLIAMS ENERGY INC	PHILLIPS 19 FEDERAL	007	EDDY	S:19, T:17S, R:29E	EMPIRE			YESO		4,500	O	Pumping		Feb 2001	Apr 2010
30-015-31503	COG OPERATING LLC	STATE S-19	017	EDDY	S:19, T:17S, R:29E	EMPIRE			YESO		4,245	O	Pumping		May 2001	Mar 2010
30-015-31504	COG OPERATING LLC	STATE S-19	018	EDDY	S:19, T:17S, R:29E	EMPIRE			YESO		4,255	O	Pumping		Feb 2001	Mar 2010
30-015-31539	CLAYTON WILLIAMS ENERGY INC	PHILLIPS 19 FEDERAL	009	EDDY	S:19, T:17S, R:29E	EMPIRE			YESO		4,500	O	Pumping		Feb 2001	Apr 2010
30-015-31554	CLAYTON WILLIAMS ENERGY INC	PHILLIPS 19 FEDERAL	011	EDDY	S:19, T:17S, R:29E	EMPIRE			YESO		4,500	O	Pumping		Mar 2001	Apr 2010
30-015-31555	CLAYTON WILLIAMS ENERGY INC	PHILLIPS 19 FEDERAL	012	EDDY	S:19, T:17S, R:29E	EMPIRE			YESO		4,500	O	Pumping		Mar 2001	Apr 2010
30-015-31614	CLAYTON WILLIAMS ENERGY INC	PHILLIPS 19 FEDERAL	010	EDDY	S:19, T:17S, R:29E	EMPIRE			YESO		4,500	O	Pumping		Apr 2001	Apr 2010
30-015-31633	CLAYTON WILLIAMS ENERGY INC	PHILLIPS 19 FEDERAL	013	EDDY	S:19, T:17S, R:29E	EMPIRE			YESO		4,500	O	Pumping		Apr 2001	Apr 2010
30-015-32059	COG OPERATING LLC	STATE S-19	019	EDDY	S:19, T:17S, R:29E	EMPIRE			YESO		5,303	O	Pumping		Dec 2001	Mar 2010
30-015-32060	COG OPERATING LLC	STATE S-19	20	EDDY	S:19, T:17S, R:29E	EMPIRE			YESO		4,216	O	Pumping		Feb 2002	Mar 2010
30-015-32062	COG OPERATING LLC	STATE S-19	21	EDDY	S:19, T:17S, R:29E	EMPIRE			YESO		5,506	O	Pumping		Mar 2002	Mar 2010
30-015-32226	COG OPERATING LLC	STATE S-19	22	EDDY	S:19, T:17S, R:29E	EMPIRE			YESO		4,430	O	Pumping		Jun 2002	Mar 2010
	COG OPERATING				S:19, T:17S,											

30-015-32241	LLC	STATE S-19	008	EDDY	R-29E S:19, T:17S, R:29E	EMPIRE	YESO	4,350	O	Pumping	Jul 2002	Mar 2010
30-015-32502	COG OPERATING LLC	STATE S-19	6	EDDY	R-29E S:19, T:17S, R:29E	EMPIRE	YESO	5,435	O	Active	Jan 2003	Mar 2010
30-015-31227	CLAYTON WILLIAMS ENERGY INC	PHILLIPS 19 FEDERAL	006	EDDY	S:19, T:17S, R:29E	EMPIRE	YESO, EAST	4,545	O	Pumping		
30-015-03001		STATE S 19	002	EDDY	S:19, T:17S, R:29E	GRAYBURG JACKSON	SR-Q-G-SA	2,450	D	Pumping	Oct 1957	Mar 1982
30-015-03002		STATE S 19	001	EDDY	S:19, T:17S, R:29E	AID	YATES-SEVEN RIVERS		O	Active	Sep 1957	Jul 1966
30-015-03005		SINCLAIR A STATE	001	EDDY	S:19, T:17S, R:29E	AID	YATES-SEVEN RIVERS	0	O	Pumping	Jun 1956	Dec 1993
30-015-03004		CONTINENTAL STATE	002	EDDY	S:19, T:17S, R:29E	AID	YATES-SEVEN RIVERS		O	Active	Dec 1956	Oct 1958
30-015-22743		STATE 19 COM	001	EDDY	S:19, T:17S, R:29E	EMPIRE	MORROW, SOUTH (GAS)	10,880	O	Active	Jan 1981	Sep 1981
30-015-33503	CLAYTON WILLIAMS ENERGY INC	PHILLIPS 19 FEDERAL	015M	EDDY	S:19, T:17S, R:29E	EMPIRE	YESO	4,227	O	Active	Nov 2004	Apr 2010
30-015-33516	CLAYTON WILLIAMS ENERGY INC	PHILLIPS 19 FEDERAL	14	EDDY	S:19, T:17S, R:29E	EMPIRE	YESO	4,177	O	Active	Jan 2005	Apr 2010
30-015-33502	CLAYTON WILLIAMS ENERGY INC	PHILLIPS 19 FEDERAL	004	EDDY	S:19, T:17S, R:29E	EMPIRE	YESO	4,200	O	Active	Nov 2004	Apr 2010
30-015-34120	CIMAREX ENERGY CO. OF COLORADO	CP STATE COM	001	EDDY	S:19, T:17S, R:29E	EMPIRE	MORROW, SOUTH (GAS)	10,971	G	Active Permit	Jan 2006	Jun 2008
30-015-22930	GENERAL AMERICAN OIL COMPANY OF TEXAS	GREEN "B"	009	EDDY	S:19, T:17S, R:29E	SOUTH EMPIRE MORROW		10,870	I	Plugged and Abandoned		
30-015-34825	COG OPERATING LLC	STATE S-19	23	EDDY	S:19, T:17S, R:29E	EMPIRE; YESO 96210		5,410	O	Active Permit	Sep 2006	Dec 2006
30-015-34826	COG OPERATING LLC	STATE S-19	24	EDDY	S:19, T:17S, R:29E	EMPIRE; YESO 96210		5,475	O	Active Permit	Oct 2006	Jan 2007
30-015-34827	COG OPERATING LLC	STATE S-19	25	EDDY	S:19, T:17S, R:29E	EMPIRE; YESO		5,460	O	Active Permit	Jul 2006	Nov 2006
30-015-34828	COG OPERATING LLC	STATE S-19	26	EDDY	S:19, T:17S, R:29E	EMPIRE	YESO	5,435	O	Active Permit	Sep 2006	Mar 2010
30-015-34829	COG OPERATING LLC	STATE S-19	27	EDDY	S:19, T:17S, R:29E	EMPIRE; YESO 96210		5,460	O	Active Permit	Dec 2006	Dec 2006
30-015-34830	COG OPERATING LLC	STATE S-19	28	EDDY	S:19, T:17S, R:29E	EMPIRE; YESO 96210		5,480	O	Active Permit	Aug 2006	Nov 2006
30-015-34888	MACK ENERGY CORP	SCHLEY FEDERAL	16	EDDY	S:19, T:17S, R:29E	EMPIRE; GLORIETA-YESO		5,674	O	Active Permit		

30-015-35241	COG OPERATING LLC	STATE S-19	30	EDDY	S:19, T:17S, R:29E	EMPIRE	YESO		5,510	O	Active Permit	Aug 2007	Mar 2010
30-015-35242	COG OPERATING LLC	STATE S-19	31	EDDY	S:19, T:17S, R:29E	EMPIRE	YESO		5,500	PO	Active Permit	May 2007	Mar 2010
30-015-35261	COG OPERATING LLC	STATE S-19	29	EDDY	S:19, T:17S, R:29E	EMPIRE	YESO		5,515	O	Active	May 2007	Mar 2010
30-015-34828	COG OPERATING LLC	STATE S-19	26	EDDY	S:19, T:17S, R:29E	EMPIRE; YESO 96210			5,435	O	Active Permit		
30-015-34827	COG OPERATING LLC	STATE S-19	25	EDDY	S:19, T:17S, R:29E	EMPIRE	YESO		5,460	O	Active Permit	Jul 2006	Mar 2010
30-015-34830	COG OPERATING LLC	STATE S-19	28	EDDY	S:19, T:17S, R:29E	EMPIRE	YESO		5,480	O	Active Permit	Aug 2006	Mar 2010
30-015-34825	COG OPERATING LLC	STATE S-19	23	EDDY	S:19, T:17S, R:29E	EMPIRE	YESO		5,410	O	Active Permit	Sep 2006	Mar 2010
30-015-34829	COG OPERATING LLC	STATE S-19	27	EDDY	S:19, T:17S, R:29E	EMPIRE	YESO		5,460	O	Active Permit	Dec 2006	Mar 2010
30-015-34888	COG OPERATING LLC	SCHLEY FEDERAL	16	EDDY	S:19, T:17S, R:29E	EMPIRE	YESO, EAST		5,674	O	Active Permit	Oct 2006	Mar 2010
30-015-34826	COG OPERATING LLC	STATE S-19	24	EDDY	S:19, T:17S, R:29E	EMPIRE	YESO		5,475	O	Active Permit	Oct 2006	Mar 2010
30-015-35242	COG OPERATING LLC	STATE S-19	31	EDDY	S:19, T:17S, R:29E	EMPIRE; YESO 96210			5,500	PO	Active Permit		
30-015-35743	COG OPERATING LLC	STATE S-19	032	EDDY	S:19, T:17S, R:29E	EMPIRE GLORIETA; YESO 96210			5,421	O	Active Permit		
30-015-35241	COG OPERATING LLC	STATE S-19	30	EDDY	S:19, T:17S, R:29E	EMPIRE; YESO			5,510	O	Active Permit		
30-015-35743	COG OPERATING LLC	STATE S-19	032	EDDY	S:19, T:17S, R:29E	EMPIRE	YESO		5,421	O	Active Permit	Sep 2007	Mar 2010
30-015-35922	COG OPERATING LLC	STATE S-19	33	EDDY	S:19, T:17S, R:29E	EMPIRE	YESO		5,419	O	Active Permit	Jan 2008	Mar 2010
30-015-35261	COG OPERATING LLC	STATES S-19	29	EDDY	S:19, T:17S, R:29E	EMPIRE; YESO			5,515	O	Active		
30-015-32226	MACK ENERGY CORPORATION	STATE S-19	22	EDDY	S:19, T:17S, R:29E	EMPIRE; YESO			4,430	O	Pumping		
30-015-32060	MACK ENERGY CORP	STATE S-19	20	EDDY	S:19, T:17S, R:29E	EMPIRE; YESO			4,216	O	Pumping		
30-015-35922	COG OPERATING LLC	STATE S-19	33	EDDY	S:19, T:17S, R:29E	EMPIRE; GLORIETA-YESO			5,419	O	Active Permit		
	MACK ENERGY				S:19, T:17S,								

30-015-32062	CORP	STATE S-19	21	EDDY	R:29E S:19, T:17S, R:29E	EMPIRE; GLORIETA-YESO	5,506	O	Pumping		
30-015-32502	MACK ENERGY CORP	STATE S-19	6	EDDY	S:19, T:17S, R:29E	EMPIRE; YESO	5,435	O	Active		
30-015-32059	MACK ENERGY CORP	STATE S-19	019	EDDY	S:19, T:17S, R:29E	EMPIRE; GLORIETA-YESO	5,303	O	Pumping		
30-015-33516	CLAYTON WILLIAMS ENERGY, INC.	PHILLIPS 19 FEDERAL	14	EDDY	S:19, T:17S, R:29E	EMPIRE; YESO	4,177	O	Active		
30-015-32226	COG OPERATING LLC	STATE S-19	22	EDDY	S:19, T:17S, R:29E	EMPIRE; GLORIETA-YESO	4,430	O	Pumping		
30-015-32502	COG OPERATING LLC	STATE S-19	6	EDDY	S:19, T:17S, R:29E	EMPIRE; GLORIETA-YESO	5,435	O	Active		
30-015-32062	COG OPERATING LLC	STATE S-19	21	EDDY	S:19, T:17S, R:29E	EMPIRE; GLORIETA-YESO	5,506	O	Pumping		
30-015-32059	TEST	STATE S-19	019	EDDY	S:19, T:17S, R:29E	EMPIRE; GLORIETA-YESO	5,303	O	Pumping		
30-015-34120	GRUY PETROLEUM MANAGEMENT, CO.	CP STATE COM	001	EDDY	S:19, T:17S, R:29E	EMPIRE; MORROW, SOUTH (GAS)	10,971	G	Active Permit		
30-015-37869	COG OPERATING LLC	STATE S-19	034	EDDY	S:19, T:17S, R:29E	EMPIRE (YESO)	5,550	PO	Active		

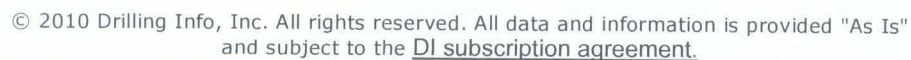

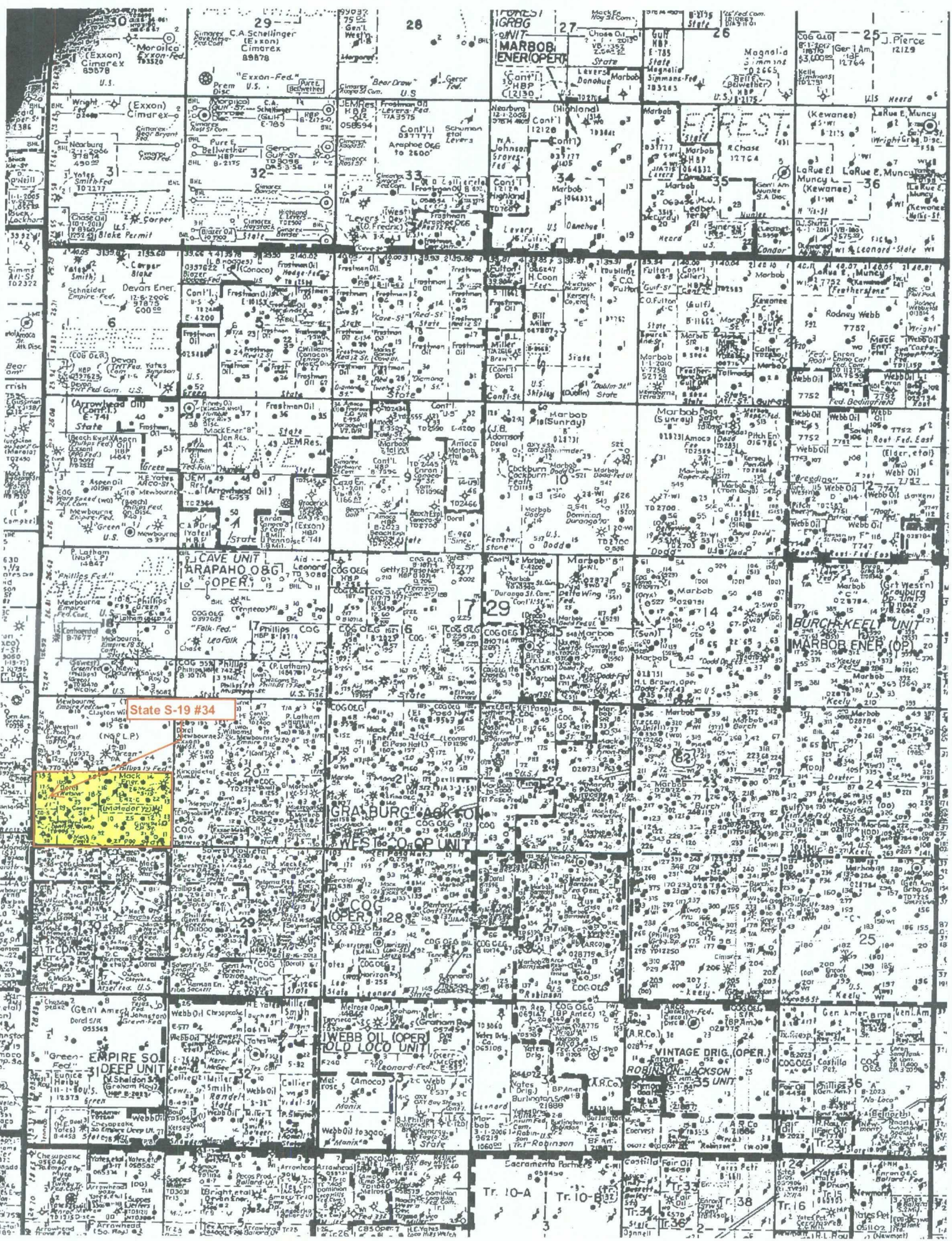

SENDER: COMPLETE THIS SECTION

- ☐ Complete items 1, 2, and 3. Also complete item 4 if Restricted Delivery is desired.
- ☐ Print your name and address on the reverse so that we can return the card to you.
- ☐ Attach this card to the back of the mailpiece, or on the front if space permits.

1. Article Addressed to:

Clayton Williams Energy Inc.
6 Desta Dr., Ste. 3000
Midland, TX 79705

COMPLETE THIS SECTION ON DELIVERY

A. Signature ☒ Agent
Kim Budy ☐ Addressee

B. Received by (Printed Name) C. Date of Delivery
6-25-00

D. Is delivery address different from item 1? ☐ Yes
If YES, enter delivery address below: ☐ No

3. Service Type
☒ Certified Mail ☐ Express Mail
☐ Registered ☒ Return Receipt for Merchandise
☐ Insured Mail ☐ C.O.D.

4. Restricted Delivery? (Extra Fee) ☐ Yes

2. Article Number
(Transfer from service label)

7010 0780 0001 8634 9578

PS Form 3811, February 2004

Domestic Return Receipt

102595-02-M-1540

**COG OPERATING LLC
550 W. TEXAS, SUITE 1300
MIDLAND, TX 79701**

June 24, 2010

Clayton Williams Energy Inc.
6 Desta Dr., Ste. 3000
Midland, TX 79705

Re: Request for Unorthodox Well Location

To Whom It May Concern:

This letter will serve as notice under Rule 104.F (3) that COG Operating LLC has requested administrative approval from the Oil Conservation Division in Santa Fe, NM for a Non-standard spacing Empire: GLORIETA-YESO oil well.

**STATE S-19 #34
Eddy County, NM**

1700' FSL & 700' FWL Sec 19, T17S, R29E, Lot 3

Should your company have any objection, it must be filed in writing within twenty (20) days from the date of this notice. The Division Director may allow COG to produce from the unorthodox location after the well is drilled, if no objection has been made within the 20 days after the application has been received.

Sincerely,

COG Operating LLC

A handwritten signature in black ink, appearing to read "Robyn Odom". The signature is fluid and cursive, with the first name "Robyn" and last name "Odom" clearly distinguishable.

Robyn Odom
Regulatory Analyst

432-685-4385
rodom@conchoresources.com

SENDER: COMPLETE THIS SECTION

- Complete items 1, 2, and 3. Also complete item 4 if Restricted Delivery is desired.
- Print your name and address on the reverse so that we can return the card to you.
- Attach this card to the back of the mailpiece, or on the front if space permits.

1. Article Addressed to:

Paul Latham
6 Desta Dr., Ste. 3000
Midland, TX 79705

COMPLETE THIS SECTION ON DELIVERY

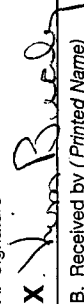
- A. Signature ☒ Agent
 ☐ Addressee
- B. Received by (Printed Name) C. Date of Delivery
6-25-10
- D. Is delivery address different from item 1? ☐ Yes
If YES, enter delivery address below: ☐ No

3. Service Type ☒ Certified Mail ☐ Express Mail
☐ Registered ☒ Return Receipt for Merchandise
☐ Insured Mail ☐ C.O.D.

4. Restricted Delivery? (Extra Fee) ☐ Yes

2. Article Number

(Transfer from service label)

7010 0780 0001 8634 9585

PS Form 3811, February 2004

Domestic Return Receipt

102595-02-M-1540

**COG OPERATING LLC
550 W. TEXAS, SUITE 1300
MIDLAND, TX 79701**

June 24, 2010

Paul Latham
6 Desta Dr., Ste. 3000
Midland, TX 79705

Re: Request for Unorthodox Well Location

To Whom It May Concern:

This letter will serve as notice under Rule 104.F (3) that COG Operating LLC has requested administrative approval from the Oil Conservation Division in Santa Fe, NM for a Non-standard spacing Empire: GLORIETA-YESO oil well.

**STATE S-19 #34
Eddy County, NM**

1700' FSL & 700' FWL Sec 19, T17S, R29E, Lot 3

Should your company have any objection, it must be filed in writing within twenty (20) days from the date of this notice. The Division Director may allow COG to produce from the unorthodox location after the well is drilled, if no objection has been made within the 20 days after the application has been received.

Sincerely,

COG Operating LLC

A handwritten signature in black ink, appearing to read "Robyn Odom", written in a cursive style.

Robyn Odom
Regulatory Analyst

432-685-4385
rodome@conchoresources.com

SENDER: COMPLETE THIS SECTION

- ☐ Complete items 1, 2, and 3. Also complete item 4 if Restricted Delivery is desired.
- ☐ Print your name and address on the reverse so that we can return the card to you.
- ☐ Attach this card to the back of the mailpiece, or on the front if space permits.

1. Article Addressed to:

Mel Riggs
6 Desta Dr., Ste. 3000
Midland, TX 79705

COMPLETE THIS SECTION ON DELIVERY

A. Signature ☒ Agent
☒ Addressee

B. Received by (Printed Name) Handley B. Riggs
Date of Delivery 6-25-10

D. Is delivery address different from item 1? ☐ Yes
If YES, enter delivery address below: ☐ No

3. Service Type
☒ Certified Mail ☐ Express Mail
☐ Registered ☒ Return Receipt for Merchandise
☐ Insured Mail ☐ C.O.D.

4. Restricted Delivery? (Extra Fee) ☐ Yes

2. Article Number
(Transfer from service label)

7010 0780 0001 8634 9592

PS Form 3811, February 2004

Domestic Return Receipt

102595-02-M-1540

**COG OPERATING LLC
550 W. TEXAS, SUITE 1300
MIDLAND, TX 79701**

June 24, 2010

Mel Riggs
6 Desta Dr., Ste. 3000
Midland, TX 79705

Re: Request for Unorthodox Well Location

To Whom It May Concern:

This letter will serve as notice under Rule 104.F (3) that COG Operating LLC has requested administrative approval from the Oil Conservation Division in Santa Fe, NM for a Non-standard spacing Empire: GLORIETA-YESO oil well.

**STATE S-19 #34
Eddy County, NM**

1700' FSL & 700' FWL Sec 19, T17S, R29E, Lot 3

Should your company have any objection, it must be filed in writing within twenty (20) days from the date of this notice. The Division Director may allow COG to produce from the unorthodox location after the well is drilled, if no objection has been made within the 20 days after the application has been received.

Sincerely,

COG Operating LLC

A handwritten signature in black ink, appearing to read "Robyn Odom". The signature is fluid and cursive, with the first name "Robyn" and last name "Odom" clearly distinguishable.

Robyn Odom
Regulatory Analyst

432-685-4385
rodome@conchoresources.com

SENDER: COMPLETE THIS SECTION

- Complete items 1, 2, and 3. Also complete item 4 if Restricted Delivery is desired.
- Print your name and address on the reverse so that we can return the card to you.
- Attach this card to the back of the mailpiece, or on the front if space permits.

1. Article Addressed to:

Mark and Betty Tisdale
6 Desta Dr., Ste. 3000
Midland, TX 79705

2. Article Number
(Transfer from service label)

7010 0780 0001 8634 9608

PS Form 3811, February 2004

Domestic Return Receipt

102595-02-M-1540

COMPLETE THIS SECTION ON DELIVERY

A. Signature ☒ Agent
Mark Tisdale ☐ Addressee

B. Received by (Printed Name) ☐ Date of Delivery
8-25-10

D. Is delivery address different from item 1? ☐ Yes
If YES, enter delivery address below: ☐ No

3. Service Type
☒ Certified Mail ☐ Express Mail
☐ Registered ☒ Return Receipt for Merchandise
☐ Insured Mail ☐ C.O.D.

4. Restricted Delivery? (Extra Fee) ☐ Yes

**COG OPERATING LLC
550 W. TEXAS, SUITE 1300
MIDLAND, TX 79701**

June 24, 2010

Mark and Betty Tisdale
6 Desta Dr., Ste. 3000
Midland, TX 79705

Re: Request for Unorthodox Well Location

To Whom It May Concern:

This letter will serve as notice under Rule 104.F (3) that COG Operating LLC has requested administrative approval from the Oil Conservation Division in Santa Fe, NM for a Non-standard spacing Empire: GLORIETA-YESO oil well.

**STATE S-19 #34
Eddy County, NM**

1700' FSL & 700' FWL Sec 19, T17S, R29E, Lot 3

Should your company have any objection, it must be filed in writing within twenty (20) days from the date of this notice. The Division Director may allow COG to produce from the unorthodox location after the well is drilled, if no objection has been made within the 20 days after the application has been received.

Sincerely,

COG Operating LLC



Robyn Odom
Regulatory Analyst

432-685-4385
rodom@conchoresources.com

SENDER: COMPLETE THIS SECTION

- Complete items 1, 2, and 3. Also complete item 4 if Restricted Delivery is desired.
- Print your name and address on the reverse so that we can return the card to you.
- Attach this card to the back of the mailpiece, or on the front if space permits.

1. Article Addressed to:

Greg Benton
6 Desta Dr., Ste. 3000
Midland, TX 79705

COMPLETE THIS SECTION ON DELIVERY

- A. Signature ☒ Agent
Greg Benton ☐ Addressee
- B. Received by (Printed Name) ☐ Date of Delivery
Greg Benton *6-25-10*
- D. Is delivery address different from item 1? ☐ Yes
If YES, enter delivery address below: ☐ No

3. Service Type ☒ Certified Mail ☐ Express Mail
☐ Registered ☒ Return Receipt for Merchandise
☐ Insured Mail ☐ C.O.D.
4. Restricted Delivery? (Extra Fee) ☐ Yes

2. Article Number
(Transfer from service label) **7010 0780 0001 8634 9615**

PS Form 3811, February 2004 Domestic Return Receipt 102595-02-M-1540

**COG OPERATING LLC
550 W. TEXAS, SUITE 1300
MIDLAND, TX 79701**

June 24, 2010

Greg Benton
6 Desta Dr., Ste. 3000
Midland, TX 79705

Re: Request for Unorthodox Well Location

To Whom It May Concern:

This letter will serve as notice under Rule 104.F (3) that COG Operating LLC has requested administrative approval from the Oil Conservation Division in Santa Fe, NM for a Non-standard spacing Empire: GLORIETA-YESO oil well.

**STATE S-19 #34
Eddy County, NM**

1700' FSL & 700' FWL Sec 19, T17S, R29E, Lot 3

Should your company have any objection, it must be filed in writing within twenty (20) days from the date of this notice. The Division Director may allow COG to produce from the unorthodox location after the well is drilled, if no objection has been made within the 20 days after the application has been received.

Sincerely,

COG Operating LLC

A handwritten signature in black ink, appearing to read "Robyn Odom", with a stylized flourish at the end.

Robyn Odom
Regulatory Analyst

432-685-4385
rodom@conchoresources.com

SENDER: COMPLETE THIS SECTION

- Complete items 1, 2, and 3. Also complete item 4 if Restricted Delivery is desired.
- Print your name and address on the reverse so that we can return the card to you.
- Attach this card to the back of the mailpiece, or on the front if space permits.

1. Article Addressed to:

Matt Swiem
6 Desta Dr., Ste. 3000
Midland, TX 79705

COMPLETE THIS SECTION ON DELIVERY

A. Signature ☒ Agent
[Signature] ☐ Addressee

B. Received by (Printed Name) ☐ Date of Delivery
6-25-10

D. Is delivery address different from item 1? ☐ Yes
If YES, enter delivery address below: ☐ No

3. Service Type
☒ Certified Mail ☐ Express Mail
☐ Registered ☒ Return Receipt for Merchandise
☐ Insured Mail ☐ C.O.D.

4. Restricted Delivery? (Extra Fee) ☐ Yes

2. Article Number

(Transfer from service label)

7010 0780 0001 8634 9622

PS Form 3811, February 2004

Domestic Return Receipt

102595-02-M-1540

**COG OPERATING LLC
550 W. TEXAS, SUITE 1300
MIDLAND, TX 79701**

June 24, 2010

Matt Swiem
6 Desta Dr., Ste. 3000
Midland, TX 79705

Re: Request for Unorthodox Well Location

To Whom It May Concern:

This letter will serve as notice under Rule 104.F (3) that COG Operating LLC has requested administrative approval from the Oil Conservation Division in Santa Fe, NM for a Non-standard spacing Empire: GLORIETA-YESO oil well.

**STATE S-19 #34
Eddy County, NM**

1700' FSL & 700' FWL Sec 19, T17S, R29E, Lot 3

Should your company have any objection, it must be filed in writing within twenty (20) days from the date of this notice. The Division Director may allow COG to produce from the unorthodox location after the well is drilled, if no objection has been made within the 20 days after the application has been received.

Sincerely,

COG Operating LLC

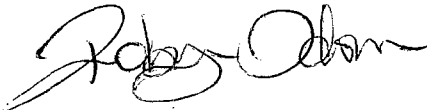
A handwritten signature in black ink, appearing to read "Robyn Odom", with a stylized flourish at the end.

Robyn Odom
Regulatory Analyst

432-685-4385
rodom@conchoresources.com

SENDER: COMPLETE THIS SECTION

- Complete items 1, 2, and 3. Also complete item 4 if Restricted Delivery is desired.
- Print your name and address on the reverse so that we can return the card to you.
- Attach this card to the back of the mailpiece, or on the front if space permits.

1. Article Addressed to:

John Kennedy
6 Desta Dr., Ste. 3000
Midland, TX 79705

COMPLETE THIS SECTION ON DELIVERY

- A. Signature ☒ Agent ☐ Addressee
John Kennedy
- B. Received by (Printed Name) ☐ Date of Delivery
6-25-10
- D. Is delivery address different from item 1? ☐ Yes
If YES, enter delivery address below: ☐ No

3. Service Type ☒ Certified Mail ☐ Express Mail
☐ Registered ☒ Return Receipt for Merchandise
☐ Insured Mail ☐ C.O.D.
4. Restricted Delivery? (Extra Fee) ☐ Yes

2. Article Number
(Transfer from service label)

7010 0780 0001 8634 9639

PS Form 3811, February 2004

Domestic Return Receipt

102595-02-M-1540

**COG OPERATING LLC
550 W. TEXAS, SUITE 1300
MIDLAND, TX 79701**

June 24, 2010

John Kennedy
6 Desta Dr., Ste. 3000
Midland, TX 79705

Re: Request for Unorthodox Well Location

To Whom It May Concern:

This letter will serve as notice under Rule 104.F (3) that COG Operating LLC has requested administrative approval from the Oil Conservation Division in Santa Fe, NM for a Non-standard spacing Empire: GLORIETA-YESO oil well.

**STATE S-19 #34
Eddy County, NM**

1700' FSL & 700' FWL Sec 19, T17S, R29E, Lot 3

Should your company have any objection, it must be filed in writing within twenty (20) days from the date of this notice. The Division Director may allow COG to produce from the unorthodox location after the well is drilled, if no objection has been made within the 20 days after the application has been received.

Sincerely,

COG Operating LLC

A handwritten signature in black ink, appearing to read "Robyn Odom", with a stylized, flowing script.

Robyn Odom
Regulatory Analyst

432-685-4385
rodome@conchoresources.com

SENDER: COMPLETE THIS SECTION

- Complete items 1, 2, and 3. Also complete item 4 if Restricted Delivery is desired.
- Print your name and address on the reverse so that we can return the card to you.
- Attach this card to the back of the mailpiece, or on the front if space permits.

1. Article Addressed to:

Mickey Cunningham
6 Desta Dr., Ste. 3000
Midland, TX 79705

COMPLETE THIS SECTION ON DELIVERY

A. Signature
☒ Agent
☐ Addressee
B. Received by (Printed Name) John Buckley
C. Date of Delivery 6-25-10

D. Is delivery address different from item 1? ☐ Yes
If YES, enter delivery address below: ☐ No

3. Service Type
☒ Certified Mail ☐ Express Mail
☐ Registered ☒ Return Receipt for Merchandise
☐ Insured Mail ☐ C.O.D.

4. Restricted Delivery? (Extra Fee) ☐ Yes

2. Article Number
(Transfer from service label)

7010 0780 0001 8634 9646

PS Form 3811, February 2004

Domestic Return Receipt

102595-02-M-1540

**COG OPERATING LLC
550 W. TEXAS, SUITE 1300
MIDLAND, TX 79701**

June 24, 2010

Mickey Cunningham
6 Desta Dr., Ste. 3000
Midland, TX 79705

Re: Request for Unorthodox Well Location

To Whom It May Concern:

This letter will serve as notice under Rule 104.F (3) that COG Operating LLC has requested administrative approval from the Oil Conservation Division in Santa Fe, NM for a Non-standard spacing Empire: GLORIETA-YESO oil well.

**STATE S-19 #34
Eddy County, NM**

1700' FSL & 700' FWL Sec 19, T17S, R29E, Lot 3

Should your company have any objection, it must be filed in writing within twenty (20) days from the date of this notice. The Division Director may allow COG to produce from the unorthodox location after the well is drilled, if no objection has been made within the 20 days after the application has been received.

Sincerely,

COG Operating LLC

A handwritten signature in black ink, appearing to read "Robyn Odom". The signature is fluid and cursive, with the first name "Robyn" and last name "Odom" clearly distinguishable.

Robyn Odom
Regulatory Analyst

432-685-4385
rodome@conchoresources.com

SENDER: COMPLETE THIS SECTION

- ☐ Complete items 1, 2, and 3. Also complete item 4 if Restricted Delivery is desired.
- ☐ Print your name and address on the reverse so that we can return the card to you.
- ☐ Attach this card to the back of the mailpiece, or on the front if space permits.

1. Article Addressed to:

Robert Thomas
6 Desta Dr., Ste. 3000
Midland, TX 79705

COMPLETE THIS SECTION ON DELIVERY

A. Signature ☐ Agent
☒ *Robert Thomas* ☐ Addressee

B. Received by (Printed Name) C. Date of Delivery
6-25-10

D. Is delivery address different from item 1? ☐ Yes
If YES, enter delivery address below: ☐ No

3. Service Type
☒ Certified Mail ☐ Express Mail
☐ Registered ☒ Return Receipt for Merchandise
☐ Insured Mail ☐ C.O.D.

4. Restricted Delivery? (Extra Fee) ☐ Yes

2. Article Number
(Transfer from service label)

7010 0780 0001 8634 9653

PS Form 3811, February 2004

Domestic Return Receipt

102595-02-M-1540

**COG OPERATING LLC
550 W. TEXAS, SUITE 1300
MIDLAND, TX 79701**

June 24, 2010

Robert Thomas
6 Desta Dr., Ste. 3000
Midland, TX 79705

Re: Request for Unorthodox Well Location

To Whom It May Concern:

This letter will serve as notice under Rule 104.F (3) that COG Operating LLC has requested administrative approval from the Oil Conservation Division in Santa Fe, NM for a Non-standard spacing Empire: GLORIETA-YESO oil well.

**STATE S-19 #34
Eddy County, NM**

1700' FSL & 700' FWL Sec 19, T17S, R29E, Lot 3

Should your company have any objection, it must be filed in writing within twenty (20) days from the date of this notice. The Division Director may allow COG to produce from the unorthodox location after the well is drilled, if no objection has been made within the 20 days after the application has been received.

Sincerely,

COG Operating LLC

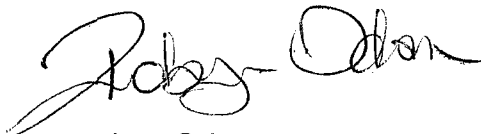
A handwritten signature in black ink, appearing to read "Robyn Odom", written in a cursive style.

Robyn Odom
Regulatory Analyst

432-685-4385
rododm@conchoresources.com

SENDER: COMPLETE THIS SECTION

- Complete items 1, 2, and 3. Also complete item 4 if Restricted Delivery is desired.
- Print your name and address on the reverse so that we can return the card to you.
- Attach this card to the back of the mailpiece, or on the front if space permits.

1. Article Addressed to:

Mike Pollard
6 Desta Dr., Ste. 3000
Midland, TX 79705

COMPLETE THIS SECTION ON DELIVERY

- A. Signature ☒ Agent
☒ Addressee
- B. Received by (Printed Name) Mike Pollard C. Date of Delivery 6-25-00
- D. Is delivery address different from item 1? ☐ Yes
 if YES, enter delivery address below: ☐ No

3. Service Type
☒ Certified Mail ☐ Express Mail
☐ Registered ☒ Return Receipt for Merchandise
☐ Insured Mail ☐ C.O.D.

4. Restricted Delivery? (Extra Fee) ☐ Yes

2. Article Number 7010 0780 0001 8634 9660

(Transfer from service label)

PS Form 3811, February 2004

Domestic Return Receipt

102595-02-M-1540

**COG OPERATING LLC
550 W. TEXAS, SUITE 1300
MIDLAND, TX 79701**

June 24, 2010

Mike Pollard
6 Desta Dr., Ste. 3000
Midland, TX 79705

Re: Request for Unorthodox Well Location

To Whom It May Concern:

This letter will serve as notice under Rule 104.F (3) that COG Operating LLC has requested administrative approval from the Oil Conservation Division in Santa Fe, NM for a Non-standard spacing Empire: GLORIETA-YESO oil well.

**STATE S-19 #34
Eddy County, NM**

1700' FSL & 700' FWL Sec 19, T17S, R29E, Lot 3

Should your company have any objection, it must be filed in writing within twenty (20) days from the date of this notice. The Division Director may allow COG to produce from the unorthodox location after the well is drilled, if no objection has been made within the 20 days after the application has been received.

Sincerely,

COG Operating LLC

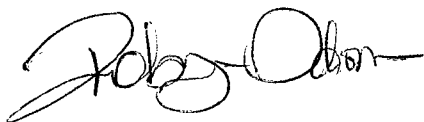
A handwritten signature in black ink, appearing to read "Robyn Odom", with a stylized flourish at the end.

Robyn Odom
Regulatory Analyst

432-685-4385
rododm@conchoresources.com

SENDER: COMPLETE THIS SECTION

- Complete items 1, 2, and 3. Also complete item 4 if Restricted Delivery is desired.
- Print your name and address on the reverse so that we can return the card to you.
- Attach this card to the back of the mailpiece, or on the front if space permits.

1. Article Addressed to:

Mark B. Heinen
11912 Persuasion Dr.
San Antonio, TX 78216

COMPLETE THIS SECTION ON DELIVERY

A. Signature  ☐ Agent ☐ Addressee

B. Received by (Printed Name) C. Date of Delivery

D. Is delivery address different from item 1? ☐ Yes ☐ No
If YES, enter delivery address below:

0102 82 M77

3. Service Type ☒ Certified Mail ☐ Registered ☐ Insured Mail ☐ Return Receipt for Merchandise ☐ C.O.D.

4. Restricted Delivery? (Extra Fee) ☐ Yes

2. Article Number
(Transfer from service label)

7010 0780 0001 8634 9677

PS Form 3811, February 2004

Domestic Return Receipt

102595-02-M-1540

**COG OPERATING LLC
550 W. TEXAS, SUITE 1300
MIDLAND, TX 79701**

June 24, 2010

Mark B. Heinen
11912 Persuasion Dr.
San Antonio, TX 78216

Re: Request for Unorthodox Well Location

To Whom It May Concern:

This letter will serve as notice under Rule 104.F (3) that COG Operating LLC has requested administrative approval from the Oil Conservation Division in Santa Fe, NM for a Non-standard spacing Empire: GLORIETA-YESO oil well.

**STATE S-19 #34
Eddy County, NM**

1700' FSL & 700' FWL Sec 19, T17S, R29E, Lot 3

Should your company have any objection, it must be filed in writing within twenty (20) days from the date of this notice. The Division Director may allow COG to produce from the unorthodox location after the well is drilled, if no objection has been made within the 20 days after the application has been received.

Sincerely,

COG Operating LLC

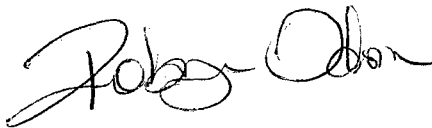
A handwritten signature in black ink, appearing to read "Robyn Odom", with a stylized flourish at the end.

Robyn Odom
Regulatory Analyst

432-685-4385
rodom@conchoresources.com

SENDER: COMPLETE THIS SECTION

- Complete items 1, 2, and 3. Also complete item 4 if Restricted Delivery is desired.
- Print your name and address on the reverse so that we can return the card to you.
- Attach this card to the back of the mailpiece, or on the front if space permits.

1. Article Addressed to:

Raven Resources, LLC
13220 N. MacArthur
Oklahoma City, OK 73142

COMPLETE THIS SECTION ON DELIVERY

- A. Signature ☒ Agent ☐ Addressee
- B. Received by (Printed Name) ☐ C. Date of Delivery
- D. Is delivery address different from item 1? ☐ Yes ☐ No
- If YES, enter delivery address below:



3. Service Type ☒ Certified Mail ☒ Express Mail ☐ Registered ☒ Return Receipt for Merchandise ☐ Insured Mail ☐ C.O.D.
4. Restricted Delivery? (Extra Fee) ☐ Yes ☐ No

2. Article Number

(Transfer from service label)

7010 0780 0081-8634 9684

Form 3811, February 2004

Domestic Return Receipt

102595-02-M-1540

**COG OPERATING LLC
550 W. TEXAS, SUITE 1300
MIDLAND, TX 79701**

June 24, 2010

Raven Resources, LLC
13220 N. MacArthur
Oklahoma City, OK 73142

Re: Request for Unorthodox Well Location

To Whom It May Concern:

This letter will serve as notice under Rule 104.F (3) that COG Operating LLC has requested administrative approval from the Oil Conservation Division in Santa Fe, NM for a Non-standard spacing Empire: GLORIETA-YESO oil well.

**STATE S-19 #34
Eddy County, NM**

1700' FSL & 700' FWL Sec 19, T17S, R29E, Lot 3

Should your company have any objection, it must be filed in writing within twenty (20) days from the date of this notice. The Division Director may allow COG to produce from the unorthodox location after the well is drilled, if no objection has been made within the 20 days after the application has been received.

Sincerely,

COG Operating LLC

A handwritten signature in black ink, appearing to read "Robyn Odom", with a stylized flourish at the end.

Robyn Odom
Regulatory Analyst

432-685-4385
rododm@conchoresources.com



550 West Texas Avenue, Suite 1300 Midland, Texas 79701



7010 0780 0001 8634 9691

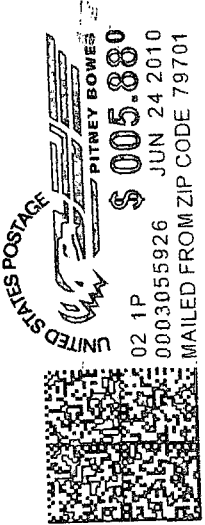

Amc
12/21

Wedel Oil & Gas, Inc
5901 N. Western, Ste. 301
Oklahoma City, Ok

NIXIE 731 DC 1 00 07/08/10
RETURN TO SENDER
ATTEMPTED - NOT KNOWN
UNABLE TO FORWARD

EC: 79701421025 *2557-02729-03-23

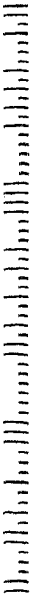

SENDER: COMPLETE THIS SECTION

- Complete items 1, 2, and 3. Also complete item 4 if Restricted Delivery is desired.
- Print your name and address on the reverse so that we can return the card to you.
- Attach this card to the back of the mailpiece, or on the front if space permits.

1. Article Addressed to:

Wedel Oil & Gas, Inc
5901 N. Western, Ste. 301
Oklahoma City, OK 73118

COMPLETE THIS SECTION ON DELIVERY

- A. Signature ☒ Agent ☐ Addressee
- B. Received by (Printed Name) C. Date of Delivery
- D. Is delivery address different from item 1? ☐ Yes
If YES, enter delivery address below: ☐ No

3. Service Type ☒ Certified Mail ☐ Express Mail
☐ Registered ☒ Return Receipt for Merchandise
☐ Insured Mail ☐ C.O.D.
4. Restricted Delivery? (Extra Fee) ☐ Yes

2. Article Number

(Transfer from service label)

7010 0780 0001 8634 9691

PS Form 3811, February 2004

Domestic Return Receipt

102595-02-M-1540

**COG OPERATING LLC
550 W. TEXAS, SUITE 1300
MIDLAND, TX 79701**

June 24, 2010

Wedel Oil & Gas, Inc
5901 N. Western, Ste. 301
Oklahoma City, OK 73118

Re: Request for Unorthodox Well Location

To Whom It May Concern:

This letter will serve as notice under Rule 104.F (3) that COG Operating LLC has requested administrative approval from the Oil Conservation Division in Santa Fe, NM for a Non-standard spacing Empire: GLORIETA-YESO oil well.

**STATE S-19 #34
Eddy County, NM**

1700' FSL & 700' FWL Sec 19, T17S, R29E, Lot 3

Should your company have any objection, it must be filed in writing within twenty (20) days from the date of this notice. The Division Director may allow COG to produce from the unorthodox location after the well is drilled, if no objection has been made within the 20 days after the application has been received.

Sincerely,

COG Operating LLC

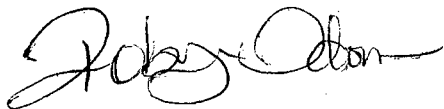

Robyn Odom
Regulatory Analyst

432-685-4385
rodom@conchoresources.com

SENDER: COMPLETE THIS SECTION

- ☐ Complete items 1, 2, and 3. Also complete item 4 if Restricted Delivery is desired.
- ☐ Print your name and address on the reverse so that we can return the card to you.
- ☐ Attach this card to the back of the mailpiece, or on the front if space permits.

1. Article Addressed to:

Eddy Andrew, LP
9520 N. May Ave., Ste. 310
Oklahoma, OK 73120

COMPLETE THIS SECTION ON DELIVERY

- A. Signature ☐ Agent ☐ Addressee
X *Melodi Frazier*
- B. Received by (Printed Name) ☐ Date of Delivery
Melodi Frazier *6-28*
- D. Is delivery address different from item 1? ☐ Yes
If YES, enter delivery address below: ☐ No

3. Service Type ☐ Express Mail
☒ Certified Mail ☒ Return Receipt for Merchandise
☐ Registered ☐ Insured Mail ☐ C.O.D.
4. Restricted Delivery? (Extra Fee) ☐ Yes

2. Article Number
(Transfer from service label) **7010 0780 0001 8634 9707**

PS Form 3811, February 2004 Domestic Return Receipt 102595-02-M-1540

**COG OPERATING LLC
550 W. TEXAS, SUITE 1300
MIDLAND, TX 79701**

June 24, 2010

Eddy Andrew, LP
9520 N. May Ave., Ste. 310
Oklahoma, OK 73120

Re: Request for Unorthodox Well Location

To Whom It May Concern:

This letter will serve as notice under Rule 104.F (3) that COG Operating LLC has requested administrative approval from the Oil Conservation Division in Santa Fe, NM for a Non-standard spacing Empire: GLORIETA-YESO oil well.

**STATE S-19 #34
Eddy County, NM**

1700' FSL & 700' FWL Sec 19, T17S, R29E, Lot 3

Should your company have any objection, it must be filed in writing within twenty (20) days from the date of this notice. The Division Director may allow COG to produce from the unorthodox location after the well is drilled, if no objection has been made within the 20 days after the application has been received.

Sincerely,

COG Operating LLC

A handwritten signature in black ink, appearing to read "Robyn Odom", with a stylized flourish at the end.

Robyn Odom
Regulatory Analyst

432-685-4385
rodom@conchoresources.com

SENDER: COMPLETE THIS SECTION

- ☐ Complete items 1, 2, and 3. Also complete item 4 if Restricted Delivery is desired.
- ☐ Print your name and address on the reverse so that we can return the card to you.
- ☐ Attach this card to the back of the mailpiece, or on the front if space permits.

1. Article Addressed to:

W-4 Capital, LLC
P.O. Box 30598
Edmond, OK 73003

COMPLETE THIS SECTION ON DELIVERY

A. Signature
X *Cindi Webb* ☐ Agent ☐ Addressee

B. Received by (Printed Name) C. Date of Delivery

CINDI WEBB

D. Is delivery address different from item 1? ☐ Yes ☐ No
If YES, enter delivery address below:

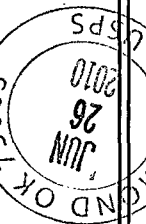

3. Service Type
☒ Certified Mail ☐ Express Mail
☐ Registered ☒ Return Receipt for Merchandise
☐ Insured Mail ☐ C.O.D.

4. Restricted Delivery? (Extra Fee) ☐ Yes

2. Article Number
(Transfer from service label) **7010 0780 0001 8634 9714**

PS Form 3811, February 2004

Domestic Return Receipt

102595-02-M-1540

**COG OPERATING LLC
550 W. TEXAS, SUITE 1300
MIDLAND, TX 79701**

June 24, 2010

W-4 Capital, LLC
P.O. Box 30598
Edmond, OK 73003

Re: Request for Unorthodox Well Location

To Whom It May Concern:

This letter will serve as notice under Rule 104.F (3) that COG Operating LLC has requested administrative approval from the Oil Conservation Division in Santa Fe, NM for a Non-standard spacing Empire: GLORIETA-YESO oil well.

**STATE S-19 #34
Eddy County, NM**

1700' FSL & 700' FWL Sec 19, T17S, R29E, Lot 3

Should your company have any objection, it must be filed in writing within twenty (20) days from the date of this notice. The Division Director may allow COG to produce from the unorthodox location after the well is drilled, if no objection has been made within the 20 days after the application has been received.

Sincerely,

COG Operating LLC

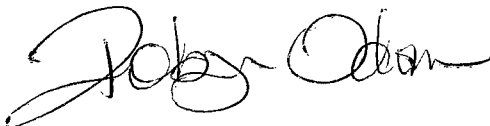
A handwritten signature in black ink, appearing to read "Robyn Odom", with a stylized, cursive script.

Robyn Odom
Regulatory Analyst

432-685-4385
rodom@conchoresources.com

SENDER: COMPLETE THIS SECTION

- Complete items 1, 2, and 3. Also complete item 4 if Restricted Delivery is desired.
- Print your name and address on the reverse so that we can return the card to you.
- Attach this card to the back of the mailpiece, or on the front if space permits.

1. Article Addressed to:

Rocktree, LLC
4400 Deason Dr.
Edmond, OK 73013

COMPLETE THIS SECTION ON DELIVERY

A. Signature [Signature] ☒ Agent ☐ Addressee

B. Received by (Printed Name) Orz Green C. Date of Delivery 6/16

D. Is delivery address different from item 1? ☐ Yes ☐ No
If YES, enter delivery address below:

3. Service Type
☒ Certified Mail ☐ Express Mail
☐ Registered ☒ Return Receipt for Merchandise
☐ Insured Mail ☐ C.O.D.

4. Restricted Delivery? (Extra Fee) ☐ Yes

2. Article Number (Transfer from service label) 7010 0780 0001 8634 9721

PS Form 3811, February 2004

Domestic Return Receipt

102595-02-M-1540

**COG OPERATING LLC
550 W. TEXAS, SUITE 1300
MIDLAND, TX 79701**

June 24, 2010

Rocktree, LLC
4400 Deason Dr.
Edmond, OK 73013

Re: Request for Unorthodox Well Location

To Whom It May Concern:

This letter will serve as notice under Rule 104.F (3) that COG Operating LLC has requested administrative approval from the Oil Conservation Division in Santa Fe, NM for a Non-standard spacing Empire: GLORIETA-YESO oil well.

**STATE S-19 #34
Eddy County, NM**

1700' FSL & 700' FWL Sec 19, T17S, R29E, Lot 3

Should your company have any objection, it must be filed in writing within twenty (20) days from the date of this notice. The Division Director may allow COG to produce from the unorthodox location after the well is drilled, if no objection has been made within the 20 days after the application has been received.

Sincerely,

COG Operating LLC

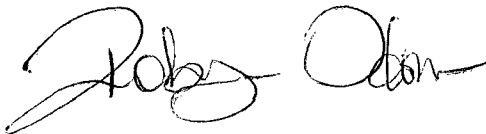
A handwritten signature in black ink, appearing to read "Robyn Odom", with a stylized flourish at the end.

Robyn Odom
Regulatory Analyst

432-685-4385
rododm@conchoresources.com

SENDER: COMPLETE THIS SECTION

- ☒ Complete items 1, 2, and 3. Also complete item 4 if Restricted Delivery is desired.
- ☒ Print your name and address on the reverse so that we can return the card to you.
- ☒ Attach this card to the back of the mailpiece, or on the front if space permits.

1. Article Addressed to:

RDC Holdings, LLC
5724 N. Coltrane
Edmond, OK 73034

COMPLETE THIS SECTION ON DELIVERY

A. Signature ☒ Agent
RDC ☐ Addressee

B. Received by (Printed Name) C. Date of Delivery
RDC

D. Is delivery address different from item 1? ☐ Yes
If YES, enter delivery address below: ☐ No

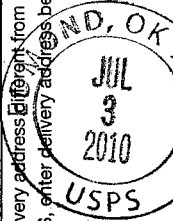

3. Service Type *73034*
☒ Certified Mail ☐ Express Mail
☐ Registered ☒ Return Receipt for Merchandise
☐ Insured Mail ☐ C.O.D.

4. Restricted Delivery? (Extra Fee) ☐ Yes

2. Article Number (Transfer from service label) *7010 0780 0001 8634 9738*

Form 3811, February 2004 Domestic Return Receipt 102595-02-M-1540

**COG OPERATING LLC
550 W. TEXAS, SUITE 1300
MIDLAND, TX 79701**

June 24, 2010

RDC Holdings, LLC
5724 N. Coltrane
Edmond, OK 73034

Re: Request for Unorthodox Well Location

To Whom It May Concern:

This letter will serve as notice under Rule 104.F (3) that COG Operating LLC has requested administrative approval from the Oil Conservation Division in Santa Fe, NM for a Non-standard spacing Empire: GLORIETA-YESO oil well.

**STATE S-19 #34
Eddy County, NM**

1700' FSL & 700' FWL Sec 19, T17S, R29E, Lot 3

Should your company have any objection, it must be filed in writing within twenty (20) days from the date of this notice. The Division Director may allow COG to produce from the unorthodox location after the well is drilled, if no objection has been made within the 20 days after the application has been received.

Sincerely,

COG Operating LLC

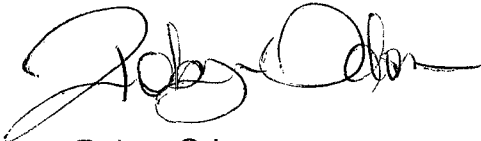
A handwritten signature in black ink, appearing to read 'Robyn Odom', with a stylized flourish at the end.

Robyn Odom
Regulatory Analyst

432-685-4385
rodوم@conchoresources.com

SENDER: COMPLETE THIS SECTION		COMPLETE THIS SECTION ON DELIVERY	
<p>1. Article Addressed to:</p> <p>Jerry W. Craven C/O Nathan E. Daniels Roofing Co. P.O. Box 4242 Meridian, MS 39304</p>		<p>A. Signature <input checked="" type="checkbox"/> <i>Butch Gibson</i> <input type="checkbox"/> Agent <input type="checkbox"/> Addressee</p>	
<p>2. Article Number (Transfer from service label)</p> <p>7010 0780 0001 8634 9745</p>		<p>B. Received by (Printed Name) Butch Gibson C. Date of Delivery</p>	
<p>3. Service Type <input checked="" type="checkbox"/> Certified Mail <input type="checkbox"/> Express Mail <input type="checkbox"/> Registered <input checked="" type="checkbox"/> Return Receipt for Merchandise <input type="checkbox"/> Insured Mail <input type="checkbox"/> C.O.D.</p>		<p>D. Is delivery address different from item 1? <input type="checkbox"/> Yes <input checked="" type="checkbox"/> No If YES, enter delivery address below:</p>	
<p>4. Restricted Delivery? (Extra Fee) <input type="checkbox"/> Yes</p>		<p>PS Form 3811, February 2004 Domestic Return Receipt 102595-02-M-1540</p>	

**COG OPERATING LLC
550 W. TEXAS, SUITE 1300
MIDLAND, TX 79701**

June 24, 2010

Jerry W. Craven
C/O Nathan E. Daniels Roofing Co.
P.O. Box 4242
Meridian, MS 39304

Re: Request for Unorthodox Well Location

To Whom It May Concern:

This letter will serve as notice under Rule 104.F (3) that COG Operating LLC has requested administrative approval from the Oil Conservation Division in Santa Fe, NM for a Non-standard spacing Empire: GLORIETA-YESO oil well.

**STATE S-19 #34
Eddy County, NM**

1700' FSL & 700' FWL Sec 19, T17S, R29E, Lot 3

Should your company have any objection, it must be filed in writing within twenty (20) days from the date of this notice. The Division Director may allow COG to produce from the unorthodox location after the well is drilled, if no objection has been made within the 20 days after the application has been received.

Sincerely,

COG Operating LLC

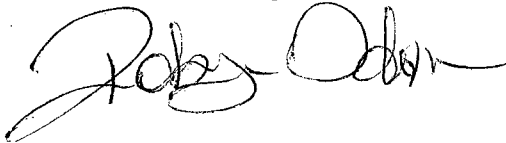
A handwritten signature in black ink, appearing to read "Robyn Odom", written over the printed name.

Robyn Odom
Regulatory Analyst

432-685-4385
rododm@conchoresources.com

SENDER: COMPLETE THIS SECTION		COMPLETE THIS SECTION ON DELIVERY	
<ul style="list-style-type: none">■ Complete items 1, 2, and 3. Also complete item 4 if Restricted Delivery is desired.■ Print your name and address on the reverse so that we can return the card to you.■ Attach this card to the back of the mailpiece, or on the front if space permits.		<p>A. Signature <u><i>Nick Patti</i></u> <input type="checkbox"/> Agent <input type="checkbox"/> Addressee</p> <p>B. Received by (Printed Name) _____ C. Date of Delivery _____</p> <p>D. Is delivery address different from item 1? <input type="checkbox"/> Yes <input type="checkbox"/> No If YES, enter delivery address below: _____</p>	
<p>1. Article Addressed to:</p> <p>Lime Rock Resources A, LP 1111 Bagby Street, Ste. 4600 Houston, TX 77002</p>		<p>3. Service Type</p> <p><input checked="" type="checkbox"/> Certified Mail <input type="checkbox"/> Express Mail</p> <p><input type="checkbox"/> Registered <input checked="" type="checkbox"/> Return Receipt for Merchandise</p> <p><input type="checkbox"/> Insured Mail <input type="checkbox"/> C.O.D.</p>	
		<p>4. Restricted Delivery? (Extra Fee) <input type="checkbox"/> Yes <input type="checkbox"/> No</p>	
<p>2. Article Number (Transfer from service label)</p> <p>7010 0780 0001 8634 9752</p>			
<p>PS Form 3811, February 2004</p>		<p>Domestic Return Receipt 102595-02-M-1540</p>	

**COG OPERATING LLC
550 W. TEXAS, SUITE 1300
MIDLAND, TX 79701**

June 24, 2010

Lime Rock Resources A, LP
1111 Bagby Street, Ste. 4600
Houston, TX 77002

Re: Request for Unorthodox Well Location

To Whom It May Concern:

This letter will serve as notice under Rule 104.F (3) that COG Operating LLC has requested administrative approval from the Oil Conservation Division in Santa Fe, NM for a Non-standard spacing Empire: GLORIETA-YESO oil well.

**STATE S-19 #34
Eddy County, NM**

1700' FSL & 700' FWL Sec 19, T17S, R29E, Lot 3

Should your company have any objection, it must be filed in writing within twenty (20) days from the date of this notice. The Division Director may allow COG to produce from the unorthodox location after the well is drilled, if no objection has been made within the 20 days after the application has been received.

Sincerely,

COG Operating LLC

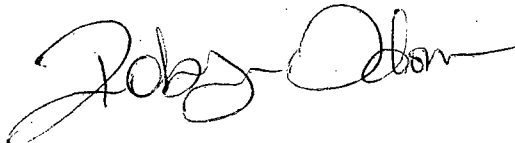
A handwritten signature in black ink, appearing to read "Robyn Odom", with a stylized flourish at the end.

Robyn Odom
Regulatory Analyst

432-685-4385
rododm@conchoresources.com

Brooks, David K., EMNRD

From: Brooks, David K., EMNRD
Sent: Friday, August 20, 2010 9:56 AM
To: 'Robyn Odom'
Subject: State S-19 #34; NSP application

Dear Ms. Odom

I have received the referenced non-standard unit application.

It seems that you have correctly identified the offsetting units the owners of which should be notified, and you have attached copies of notices. However I am requesting that you furnish me a list of the parties noticed identifying the particular units in which they have interests, so I can verify that all necessary notices have been given.

Thanks

David K. Brooks
Legal Examiner