

TEXACO  
INC.

PETROLEUM PRODUCTS



P. O. BOX 2100  
DENVER COLO. 80201

April 14, 1965

DOMESTIC PRODUCING DEPARTMENT  
DENVER DIVISION

J. F. NEILL, ASSISTANT DIVISION MANAGER

RE: NON-STANDARD DAKOTA GAS UNIT  
STATE GAS UNIT "BG" NO. 1  
N $\frac{1}{2}$  SECTION 2, T29N, R10W  
SAN JUAN COUNTY, NEW MEXICO

Mr. A. L. Porter, Jr.  
New Mexico Oil  
Conservation Commission  
P. O. Box 2088  
Santa Fe, New Mexico

Dear Mr. Porter:

Texaco Inc. has received a copy of the Pan American Petroleum Corporation application, dated April 16, 1965, for Administrative approval of a non-standard Dakota Gas Unit in the N $\frac{1}{2}$  Section 2, T29N, R10W, San Juan County, New Mexico.

Texaco Inc. is a participating interest owner in the requested non-standard gas spacing unit and the owner of an offsetting productive lease. Texaco Inc. has no objection to Pan American's application. Please accept this letter as a waiver for the proposed non-standard Dakota Gas Unit in the N $\frac{1}{2}$  Section 2, T29N, R10W, San Juan County, New Mexico.

Very truly yours,

TEXACO Inc.  
Domestic Producing Department (West)

By

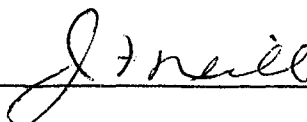
  
\_\_\_\_\_

JTT:SG

cc: (See attached sheet)

*New file*  
*5/8*

Pan American Petroleum Corp.  
P. O. Box 480  
Farmington, New Mexico

Southern Union Production Co.  
Fidelity Union Tower Bldg.  
Dallas, Texas

El Paso Natural Gas Co.  
P. O. Box 1492  
El Paso, Texas

Aztec Oil & Gas Co.  
920 Mercantile Securities  
Bldg.  
Dallas, Texas

LaPlata Gathering System,  
Inc.  
1900 Mercantile Dallas  
Bldg.  
Dallas, Texas

OIL CONSERVATION COMMISSION

3 DISTRICT

MAIN TELEPHONE  
APR 12 1965

OIL CONSERVATION COMMISSION  
BOX 871  
SANTA FE, NEW MEXICO

DATE 4-8-65

Re: Proposed NSP \_\_\_\_\_

Proposed NWU ✓ 518

Proposed NSL \_\_\_\_\_

Proposed NFO \_\_\_\_\_

Proposed DC \_\_\_\_\_

Gentlemen:

I have examined the application dated 4-6-65

for the Pet American Pet Co State Gas Unit BG #1 NW 2-29N-10W  
Operator Lease and Well No. S-T-R

and my recommendations are as follows:

approve  
\_\_\_\_\_  
\_\_\_\_\_  
\_\_\_\_\_  
\_\_\_\_\_  
\_\_\_\_\_

Yours very truly,

Emily C. Lewis

*NW*  
*File*

SOUTHERN UNION PRODUCTION COMPANY

FIDELITY UNION TOWER  
DALLAS, TEXAS 75201

L. S. MUENNINK  
MANAGER  
EXPLORATION

April 9, 1965

MAIL OFFICE

'65 APR 11 PM 1 21

Mr. A. L. Porter, Jr.  
New Mexico Oil Conservation Commission  
P. O. Box 2088  
Santa Fe, New Mexico

Dear Mr. Porter:

This is in reference to Pan American Petroleum Corporation's application for a non-standard Basin Dakota gas proration unit for their State Gas Unit "BG" No. 1 well, located in the N/2 of Section 2, T-29N, R-10W, San Juan County, New Mexico.

As an offset operator, Southern Union Production Company has no objection to this non-standard unit.

Yours very truly,

SOUTHERN UNION PRODUCTION COMPANY

*L. S. Muennink*

LSM:t

cc: Mr. T. M. Curtis  
Pan American Petroleum Corp.  
P. O. Box 480  
Farmington, New Mexico

*NW 4 578*  
*new*  
*[Signature]*

# PAN AMERICAN PETROLEUM CORPORATION

P. O. Box 480, Farmington, New Mexico  
April 6, 1965

File: N-227-986.510.1

Subject: Non-Standard Dakota Gas Unit  
State Gas Unit "BG" No. 1  
N/2 Section 2, T-29N, R-10W  
San Juan County, New Mexico

STATE OF NEW MEXICO

1965 APR 8 PM 1 26

Mr. A. L. Porter, Jr. (3)  
New Mexico Oil Conservation Commission  
P. O. Box 2088  
Santa Fe, New Mexico

Dear Sir:

Pan American Petroleum Corporation respectfully requests Administrative Approval of a 328.24 -acre non-standard gas proration unit to consist of the N/2 of Section 2, T-29-N, R-10-W, San Juan County, New Mexico. In accordance with the provisions of Rule 5 (B) of Item A, Well Location and Acreage Requirements, under the Special Rules and Regulations for the Basin Dakota Gas Pool of NMOCC Order No. R-1670-C, the requested non-standard proration unit is due to the unorthodox size of the tract due to variation in the legal subdivisions of the United States Public Lands Survey. The following provisions are complied with:

1. The non-standard unit consists of contiguous quarter-quarter sections or lots (see attached Form C-128 dated April 6, 1965).
2. The non-standard unit lies wholly within a governmental section.
3. The entire non-standard unit may reasonably be presumed to be productive of gas (see attached map dated April 6, 1965).
4. The length or width of the non-standard unit does not exceed 5280 feet.

The requested 328.24 acre non-standard gas proration unit is necessitated by the occurrences of lots larger than 40 acres along the northern edge of Section 2, T-29-N, R-10-W. A copy of NMOCC Form C-128 (Well Location and Acreage Dedication Plat) shows the proposed location 1450 feet from the north line and 1490 feet from the west line of Section 2 in the proposed N/2 Section 2 gas unit. A map showing the proposed location in relation to other Basin Dakota Pool wells is also attached, which indicates that the entire non-standard unit may reasonably be presumed to be productive of gas.

Page 2  
Mr. A. L. Porter (3)

April 6, 1965  
N-227-986.510.1

A copy of this Application has been forwarded by Certified Mail to the below listed companies who have acreage offsetting the proposed Dakota gas unit: Aztec Oil and Gas Company, Texaco Inc., Southern Union Production Company, El Paso Natural Gas Company, and La Plata Gathering System, Inc. It is requested that all of the listed operators furnish a waiver for the proposed non-standard Dakota gas unit.

Yours very truly,

PAN AMERICAN PETROLEUM CORPORATION



T. M. Curtis  
District Production Superintendent

FHH:en  
Attach.

cc by Certified Mail:

Aztec Oil & Gas Co.  
920 Mercantile Securities Bldg.  
Dallas, Texas

Texaco Inc.  
P. O. Box 2100  
Denver, Colorado

Southern Union Production Co.  
Fidelity Union Tower Bldg.  
Dallas, Texas

El Paso Natural Gas Co.  
P. O. Box 1492  
El Paso, Texas

La Plata Gathering System, Inc.  
1900 Mercantile Dallas Bldg.  
Dallas 1, Texas

cc: Mr. E. C. Arnold  
New Mexico Oil Conservation Commission  
Aztec, New Mexico

Well Location and Acreage Dedication Plat

APR 11 1965  
8 PM 1 30

April 6, 1965

Section A.

Operator PAN AMERICAN PETROLEUM CORPORATION Lease STATE GAS UNIT "BG"  
 Well No. 1 Unit Letter F Section 2 Township 29 NORTH Range 10 WEST  
 Located 1450 Feet From the NORTH Line 1490 Feet From the WEST Line  
 County SAN JUAN G. L. Elevation Report Later Dedicated Acreage 328.24 Acres  
 Name of Producing Formation Dakota Pool Basin Dakota

1. Is the Operator the only owner in the dedicated acreage outlined on the plat below?  
 Yes \_\_\_\_\_ No X
2. If the answer to question one is "no", have the interests of all the owners been consolidated by communitization agreement or otherwise? Yes X No \_\_\_\_\_ If answer is "yes", Type of Consolidation, **Communitization and Operating Agreements circulating for signature---all parties have agreed to join in drilling of well.**
3. If the answer to question two is "no", list all the owners and their respective interests below:

<u>Owner</u>	<u>Land Description</u>
--------------	-------------------------

Section B.

This is to certify that the information in Section A above is true and complete to the best of my knowledge and belief.

PAN AMERICAN PETROLEUM CORP.  
*F. H. Hollingsworth* (Operator)  
F. H. Hollingsworth  
 (Representative)  
P. O. Box 480  
 (Address)  
Farmington, New Mexico

Note: All distances must be from outer boundaries of section.

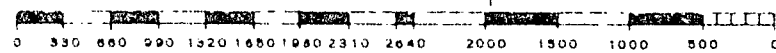
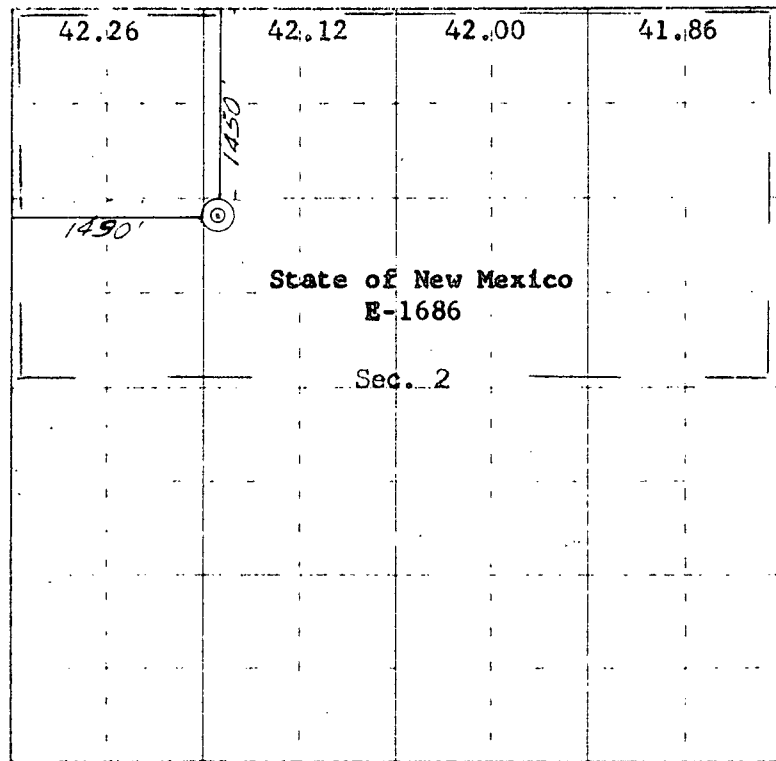

Ref: GLO plat dated 19 April 1987

This is to certify that the above plat was prepared from field notes of actual surveys made by me or under my supervision and that the same are true and correct to the best of my knowledge and belief.

Date Surveyed February 19, 1965

*James P. Leese*  
 Registered Professional Engineer and of Land Surveyor  
 James P. Leese, N1 Mex. Reg. No. 1463  
 San Juan Engineering Company



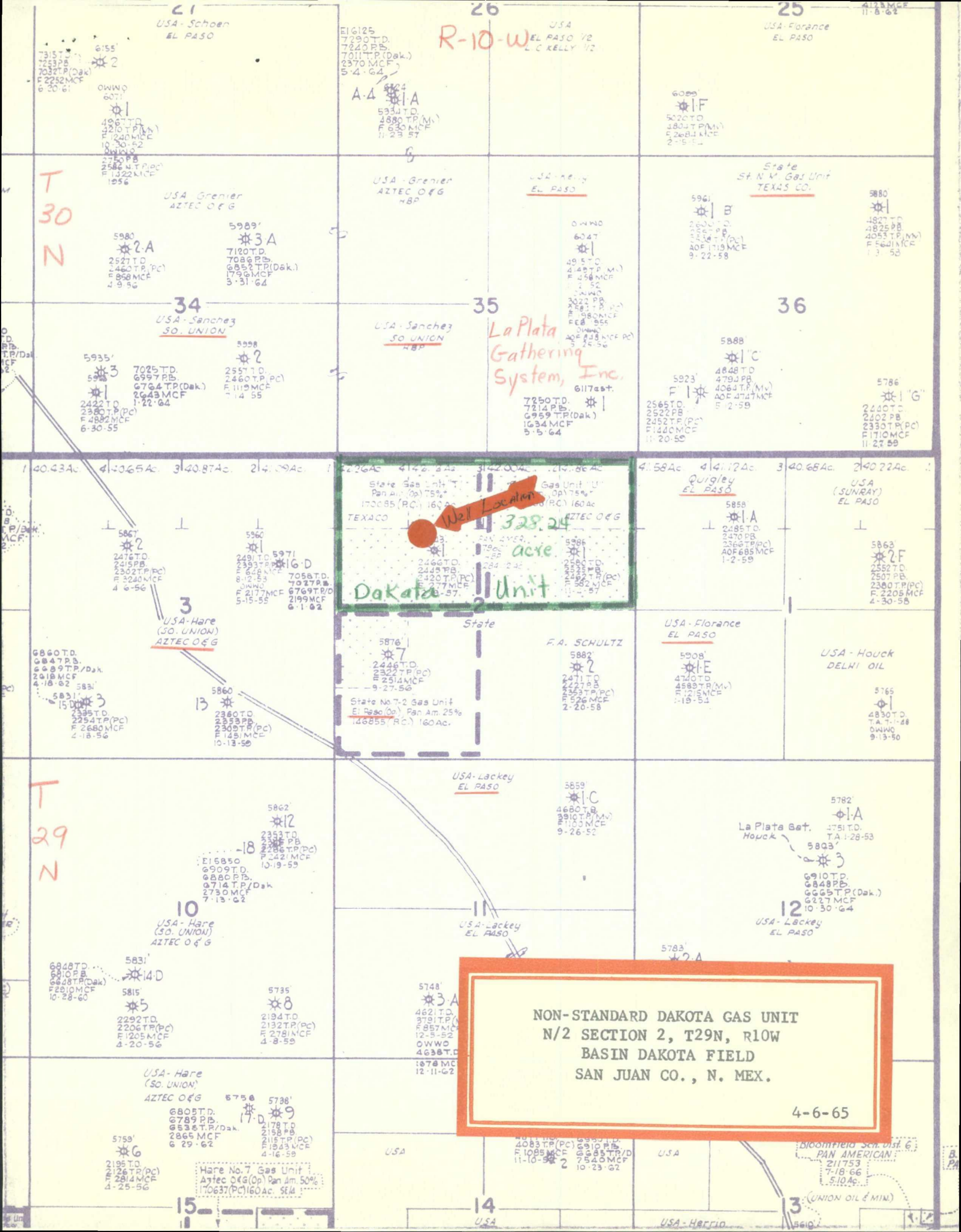

R-10-W

T  
30  
N

T  
29  
N

**NON-STANDARD DAKOTA GAS UNIT**  
**N/2 SECTION 2, T29N, R10W**  
**BASIN DAKOTA FIELD**  
**SAN JUAN CO., N. MEX.**  
**4-6-65**

USA  
EL PASO  
C KELLY '72

USA - Grenier  
AZTEC O&G  
HBP

USA - Sanchez  
SO UNION  
HBP

USA - Lackey  
EL PASO

USA - Lackey  
EL PASO

State  
S.N.M. Gas Unit  
TEXAS CO.

USA - Florance  
EL PASO

USA - Florance  
EL PASO

USA - Lackey  
EL PASO

USA - Lackey  
EL PASO

State Gas Unit  
 Pan Am. (Op) 75%  
 170085 (PC) 160Ac.  
 TEXACO  
 328.24  
 acre  
 Dakota Unit  
 AZTEC O&G

State No. 7 Gas Unit  
 El Paso (Op), Pan Am. 25%  
 148855 (PC) 160Ac.

Hare No. 7 Gas Unit  
 Aztec O&G (Op) Pan Am. 50%  
 10637 (PC) 160Ac. 56A

USA - Schoen  
EL PASO  
6:55  
2  
OWNO  
6071  
4987 T.D.  
3210 T.P.M.  
1240 MCF  
10-30-52  
UNCLD  
1750 PB  
2584 T.P.(Dak)  
1322 MCF  
1-25-56

USA - Grenier  
AZTEC O&G  
5989'  
2A  
2521 T.D.  
2460 T.P.(PC)  
858 MCF  
4-9-56

USA - Sanchez  
SO UNION  
5935'  
3  
7025 T.D.  
6997 PB.  
6764 T.P.(Dak)  
2643 MCF  
1-22-64

USA - Hare  
(SO. UNION)  
AZTEC O&G  
5861'  
2  
2476 T.D.  
2450 PB.  
2362 T.P.(PC)  
4-16-56

USA - Hare  
(SO. UNION)  
AZTEC O&G  
5831'  
3  
2335 T.D.  
2254 T.P.(PC)  
2680 MCF  
2-18-56

USA - Hare  
(SO. UNION)  
AZTEC O&G  
5862'  
12  
2353 T.D.  
2308 PB.  
2309 T.P.(PC)  
10-13-59

USA - Hare  
(SO. UNION)  
AZTEC O&G  
5831'  
4D  
5815  
2292 T.D.  
2206 T.P.(PC)  
11205 MCF  
4-20-56

USA - Hare  
(SO. UNION)  
AZTEC O&G  
5759'  
6  
2195 T.D.  
2126 T.P.(PC)  
2814 MCF  
4-25-56

USA - Hare  
(SO. UNION)  
AZTEC O&G  
5738'  
9  
2178 T.D.  
2158 PB.  
2182 T.P.(PC)  
4-16-59

ELIG25  
7290 T.D.  
7240 PB.  
7011 T.P.(Dak)  
2370 MCF  
5-4-64  
A-4  
5331 T.D.  
4880 T.P.(M)  
630 MCF  
11-23-57

USA - Grenier  
AZTEC O&G  
HBP  
5989'  
3A  
7120 T.D.  
7086 PB.  
6855 T.P.(Dak)  
1796 MCF  
3-31-64

USA - Sanchez  
SO UNION  
HBP  
5998  
2  
2557 T.D.  
2460 T.P.(PC)  
1110 MCF  
1-14-55

USA - Sanchez  
SO UNION  
HBP  
5935'  
3  
7025 T.D.  
6997 PB.  
6764 T.P.(Dak)  
2643 MCF  
1-22-64

USA - Lackey  
EL PASO  
5876'  
7  
2446 T.D.  
2322 T.P.(PC)  
2514 MCF  
9-27-56

USA - Lackey  
EL PASO  
5862'  
12  
2353 T.D.  
2308 PB.  
2309 T.P.(PC)  
10-13-59

USA - Lackey  
EL PASO  
5748'  
3A  
4621 T.D.  
3791 T.P.(M)  
1085 MCF  
12-5-52

USA - Lackey  
EL PASO  
5738'  
9  
2178 T.D.  
2158 PB.  
2182 T.P.(PC)  
4-16-59

USA - Lackey  
EL PASO  
5738'  
9  
2178 T.D.  
2158 PB.  
2182 T.P.(PC)  
4-16-59

USA - Florance  
EL PASO  
6089'  
F  
5020 T.D.  
3800 T.P.(M)  
2264 MCF  
2-5-51

USA - Grenier  
AZTEC O&G  
HBP  
5989'  
3A  
7120 T.D.  
7086 PB.  
6855 T.P.(Dak)  
1796 MCF  
3-31-64

USA - Sanchez  
SO UNION  
HBP  
5935'  
3  
7025 T.D.  
6997 PB.  
6764 T.P.(Dak)  
2643 MCF  
1-22-64

USA - Hare  
(SO. UNION)  
AZTEC O&G  
5861'  
2  
2476 T.D.  
2450 PB.  
2362 T.P.(PC)  
4-16-56

USA - Lackey  
EL PASO  
5876'  
7  
2446 T.D.  
2322 T.P.(PC)  
2514 MCF  
9-27-56

USA - Lackey  
EL PASO  
5862'  
12  
2353 T.D.  
2308 PB.  
2309 T.P.(PC)  
10-13-59

USA - Lackey  
EL PASO  
5748'  
3A  
4621 T.D.  
3791 T.P.(M)  
1085 MCF  
12-5-52

USA - Lackey  
EL PASO  
5738'  
9  
2178 T.D.  
2158 PB.  
2182 T.P.(PC)  
4-16-59

USA - Lackey  
EL PASO  
5738'  
9  
2178 T.D.  
2158 PB.  
2182 T.P.(PC)  
4-16-59

Bloomfield Sch. Dist. 6  
PAN AMERICAN  
211753  
7-18-66  
5.10 Ac.  
(UNION OIL & MIN.)



*NW 4  
file  
5/8*

**AZTEC OIL & GAS COMPANY**

920 MERCANTILE SECURITIES BLDG  
DALLAS 1, TEXAS

MAIN OFFICE 0000

APR 14 1965

LAND DEPARTMENT

KENNETH A. SWANSON, MANAGER

April 12, 1965

Mr. A. L. Porter, Jr.  
New Mexico Oil Conservation Commission  
P. O. Box 2008  
Santa Fe, New Mexico

RE: Application of Pan American  
Petroleum Corporation for  
Administrative Approval of a  
Non-Standard Dakota Gas Unit,  
San Juan County, New Mexico

Dear Mr. Porter:

Aztec Oil & Gas Company has been furnished a copy of Pan American Petroleum Corporation's captioned application for approval of a 328.24 acre non-standard gas proration unit to consist of the N $\frac{1}{2}$  of Section 2, T-29-N, R-10-W, San Juan County, New Mexico.

Aztec has no objection to the approval by the Commission of the captioned application and hereby waives its right to notice and hearing.

Very truly yours,

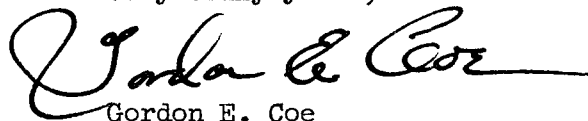
  
Gordon E. Coe

GEC/sc

cc: Pan American Petroleum Corporation  
ATTENTION: Mr. T. M. Curtis  
P. O. Box 480  
Farmington, New Mexico