

TESORO PETROLEUM CORPORATION

533 BUSBY DRIVE

512-TAYLOR 4-0261

SAN ANTONIO, TEXAS 78209

February 3, 1967

67 FEB 6 AM 0 58

*104 m  
544  
2-16-67*

Mr. A. L. Porter, Jr., Secretary-Director  
Oil Conservation Commission  
State of New Mexico  
P. O. Box 2088  
Santa Fe, New Mexico 87501

Dear Mr. Porter:

Tesoro Petroleum Corporation has recently completed the Santa Fe No. 72 Well in the southeast quarter of the southeast quarter of Section 1, T-17N, R-9W, McKinley County, New Mexico.

This well is located in the South Hospah Lower Sand Field<sup>Arnold</sup> and is completed in a different zone than the Hospah Sand Unit. The well is located on a 52-acre lot and as we do not want to drill on the 12-acre strip on the east side of the quarter section, we are requesting the New Mexico Conservation Commission approve a non-standard unit of 52 acres for this well.

We have been advised by Mr. Emery Arnold that since this is a legal subdivision of the U. S. Public Land Survey the Commission can approve this application by administrative action if no objections are voiced by offset operators. We have advised the offset operators of this application by certified letter, copies of which are attached. Also attached is a plat showing the location of the well as surveyed by Ernest V. Echohawk, a plat showing the location of the wells owned by offset operators, and a copy of the Form C-104 filed on this well.

We would very much appreciate your favorable consideration of this application and if possible we would like to have the effective date February 15, 1967 of the adjusted allowable. If you need additional information, please advise.

Thank you for your consideration of this matter.

Yours very truly,

*Harold Vagtberg Jr.*  
Harold Vagtberg, Jr.

HV:lt  
Enclosures

MEXICO OIL CONSERVATION COMMISSION  
WELL LOCATION AND ACREAGE DEDICATION PLAT

Form C-102  
Supersedes C-128  
Effective 1-1-65

All distances must be from the outer boundaries of the Section.

Operator Tesoro Petroleum Corporation		Lease Santa Fe		Well No. 72
Unit Letter P.	Section 1	Township 17 North	Range 9 West	County McKinley
Actual Footage Location of Wells: 330 feet from the South line and 1250 feet from the East line				
Ground Level Elev. 6994	Producing Formation Lower Hospah	Pool Hospah	Dedicated Acreage 52 <u>40</u> Acres	

1. Outline the acreage dedicated to the subject well by colored pencil or hachure marks on the plat below.
2. If more than one lease is dedicated to the well, outline each and identify the ownership thereof (both as to working interest and royalty).
3. If more than one lease of different ownership is dedicated to the well, have the interests of all owners been consolidated by communitization, unitization, force-pooling, etc?

☐ Yes ☐ No If answer is "yes," type of consolidation \_\_\_\_\_

If answer is "no," list the owners and tract descriptions which have actually been consolidated. (Use reverse side of this form if necessary.) \_\_\_\_\_

No allowable will be assigned to the well until all interests have been consolidated (by communitization, unitization, forced-pooling, or otherwise) or until a non-standard unit, eliminating such interests, has been approved by the Commission.

CERTIFICATION

I hereby certify that the information contained herein is true and complete to the best of my knowledge and belief.

Name  
Harold Vagtborg, Jr.

Position  
Vice President

Company  
Tesoro Petroleum Corp.

Date  
December 8, 1966

I hereby certify that the well location shown on this plat was plotted from field notes of actual surveys made by me or under my supervision, and that the same is true and correct to the best of my knowledge and belief.

Date Surveyed  
October 25, 1965

Registered Professional Engineer  
and/or Land Surveyor

Certificate No.  
3602

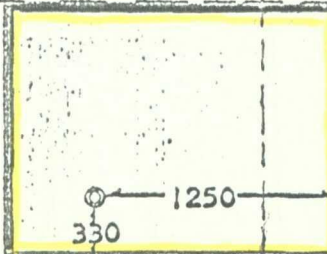
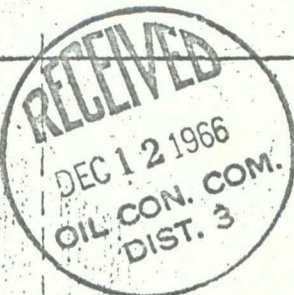



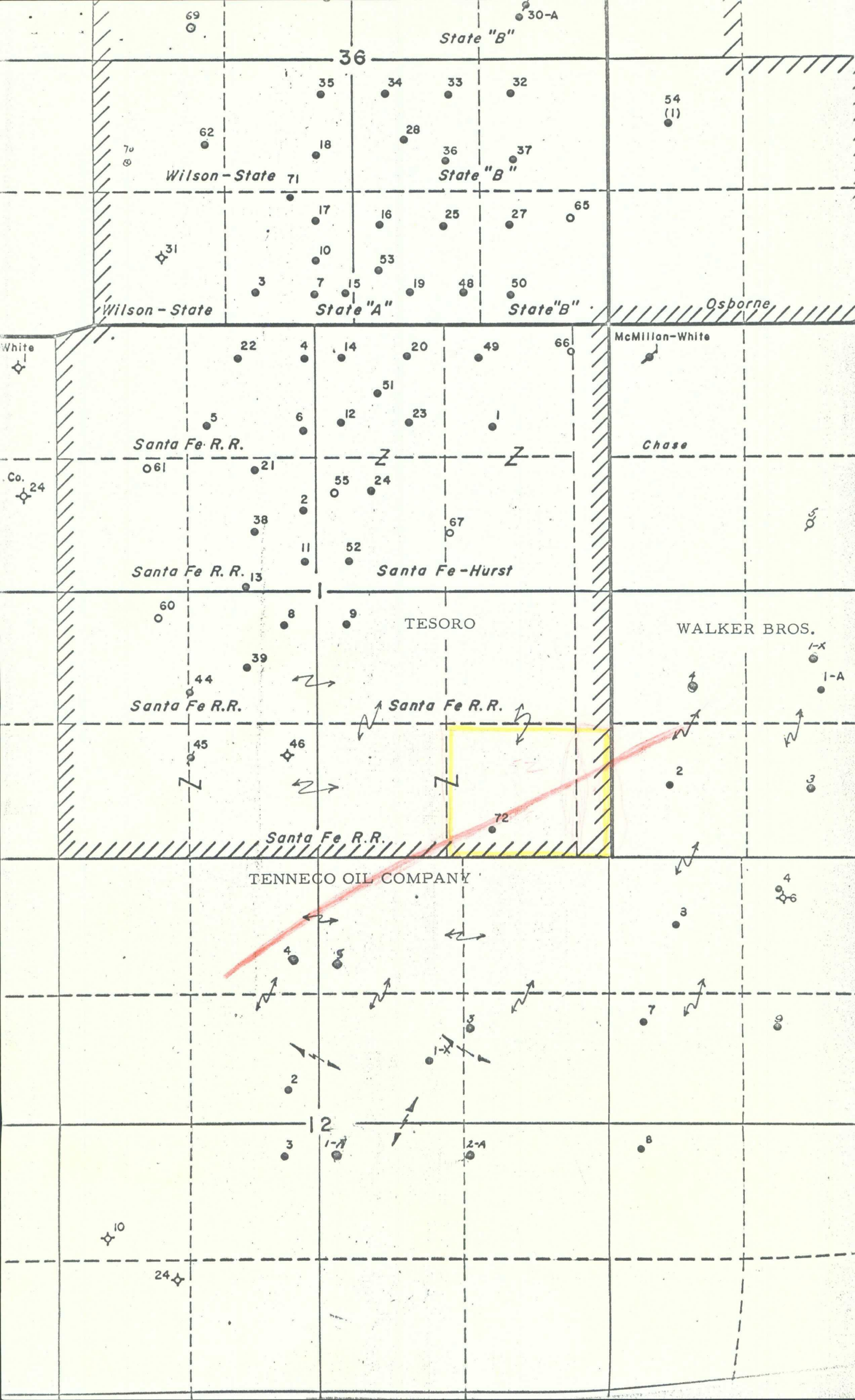

NO. OF COPIES RECEIVED		5
DISTRIBUTION		
SANTA FE		1
FILE		1
U.S.G.S.		
LAND OFFICE		
TRANSPORTER	OIL	1
	GAS	
OPERATOR	2- Tesoro	
PRORATION OFFICE		

NEW MEXICO OIL CONSERVATION COMMISSION  
REQUEST FOR ALLOWABLE  
AND  
AUTHORIZATION TO TRANSPORT OIL AND NATURAL GAS

Form C-104  
Supersedes Old C-104 and C-110  
Effective 1-1-65

Operator Tesoro Petroleum Corporation		
Address 533 Busby Drive, San Antonio, Texas 78209		
Reason(s) for filing (Check proper box)		Other (Please explain)
New Well <input type="checkbox"/>	Change in Transporter of:	DEC 29 1966 OIL CON. COM. DIST. 3
Recompletion <input checked="" type="checkbox"/>	Oil <input type="checkbox"/> Dry Gas <input type="checkbox"/>	
Change in Ownership <input type="checkbox"/>	Casinghead Gas <input type="checkbox"/> Condensate <input type="checkbox"/>	

If change of ownership give name  
and address of previous owner

II. DESCRIPTION OF WELL AND LEASE

Lease Name Santa Fe Railroad	Well No. 72	Pool Name, Including Formation Hospah Pool, Lower Hospah	Kind of Lease State, Federal or Fee	Fee
Location South Hospah & lower Sand				
Unit Letter P	1250	Feet From The East	Line and 330	Feet From The South
Line of Section 1	Township 17N	Range 9W	NMPM,	McKinley County

III. DESIGNATION OF TRANSPORTER OF OIL AND NATURAL GAS

Name of Authorized Transporter of Oil <input checked="" type="checkbox"/> or Condensate <input type="checkbox"/>	Address (Give address to which approved copy of this form is to be sent)					
Shell Pipeline Company	Farmington, New Mexico					
Name of Authorized Transporter of Casinghead Gas <input type="checkbox"/> or Dry Gas <input type="checkbox"/>	Address (Give address to which approved copy of this form is to be sent)					
No gas production						
If well produces oil or liquids, give location of tanks.	Unit K	Sec. 1	Twp. 17N	Rge. 9W	Is gas actually connected?	When

If this production is commingled with that from any other lease or pool, give commingling order number: Not commingled

V. COMPLETION DATA

Designate Type of Completion - (X)	Oil Well <input checked="" type="checkbox"/>	Gas Well	New Well	Workover	Deepen	Plug Back	Same Res'v.	Diff. Res'v.
	X				X			
Date Spudded Dec. 15, 1966	Date Compl. Ready to Prod. Dec. 23, 1966	Total Depth 1631 KB		P.B.T.D.				
Pool Hospah	Name of Producing Formation Lower Hospah (Gallup)	Top Oil/Gas Pay 1618		Tubing Depth 1581				
Perforations Old perforations 1568-89 squeezed with 50 sacks Class "C" cement. Present completion open hole with slotted liner - 10' open hole below liner						Depth Casing Shoe 1608 (4-1/2")		
TUBING, CASING, AND CEMENTING RECORD								
HOLE SIZE	CASING & TUBING SIZE		DEPTH SET		SACKS CEMENT			
9-3/4	7"		77 KB		35 sax circulated			
6-1/4	4-1/2		1608 KB		50 sax Class "C"			
3-3/4	3-1/2 OD Liner		1621.5 KB		Not cemented			
	2"		1581 KB					

V. TEST DATA AND REQUEST FOR ALLOWABLE OIL WELL (Test must be after recovery of total volume of load oil and must be equal to or exceed top allowable for this depth or be for full 24 hours)

Date First New Oil Run To Tanks Dec. 20, 1966	Date of Test Dec. 24, 1966	Producing Method (Flow, pump, gas lift, etc.) Pump	
Length of Test 24	Tubing Pressure Nil	Casing Pressure Nil	Choke Size -
Actual Prod. During Test 125 Bbls.	Oil-Bbls. 125 Bbls.	Water-Bbls. -0-	Gas-MCF Nil

\* No deviation survey run as hole deepened only 22 feet.

GAS WELL

Actual Prod. Test-MCF/D	Length of Test	Bbls. Condensate/MMCF	Gravity of Condensate
Testing Method (pitot, back pr.)	Tubing Pressure	Casing Pressure	Choke Size

I. CERTIFICATE OF COMPLIANCE

I hereby certify that the rules and regulations of the Oil Conservation Commission have been complied with and that the information given above is true and complete to the best of my knowledge and belief.

Harold Vagthorpe  
(Signature)  
Vice President  
(Title)  
December 27, 1966  
(Date)

OIL CONSERVATION COMMISSION

APPROVED DEC 29 1966  
BY A. R. Derfusick  
TITLE PETROLEUM ENGINEER DIST. NO. 5

This form is to be filed in compliance with RULE 1104.

\* If this is a request for allowable for a newly drilled or deepened well, this form must be accompanied by a tabulation of the deviation tests taken on the well in accordance with RULE 111.

All sections of this form must be filled out completely for allowable on new and recompleted wells.

Fill out Sections I, II, III, and VI only for changes of owner, well name or number, or transporter, or other such change of condition.

Separate Forms C-104 must be filed for each pool in multiply completed wells.

TESORO PETROLEUM CORPORATION

533 BUSBY DRIVE

512-TAYLOR 4-0261

SAN ANTONIO, TEXAS 78209

February 2, 1967

CERTIFIED MAIL NO. 951310

Mr. Rex H. Byers  
Production Superintendent  
Southwestern Division  
Tenneco Oil Company  
4th Floor, 201 Wall Building  
Midland, Texas 79701

Dear Rex:

Tesoro Petroleum Corporation has successfully completed the Hospah Field Santa Fe Well No. 72 in the Lower Hospah Sand. This well is located in the southeast of the southeast of Section 1, T-17N, R-9W, McKinley County, New Mexico on a 52-acre lot.

We are requesting approval from the New Mexico Conservation Commission to allocate the entire acreage of this lot to the well for allowable purposes which would result in a legal allowable of 91 barrels of oil per day. We have been advised that before approval can be granted Tenneco, as an offset operator, must be advised of this application since this is a non-standard unit.

If you have no objection to this application, you need do nothing. However, if for some reason you have a valid reason why this should not be approved, you are to so advise the Commission within 20 days after receipt of this letter.

I was very happy to have the opportunity to meet you on your recent visit to San Antonio and I am sorry that we were unable to work out a deal on our Hospah acreage.

Best personal regards.

Yours very truly,

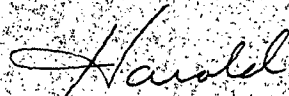

Harold Vagtborg, Jr.

HV:lt

TESORO PETROLEUM CORPORATION

533 BUSBY DRIVE

512 TAYLOR 4-0261

SAN ANTONIO, TEXAS 78209

February 2, 1967

CERTIFIED MAIL NO. 951262

Mr. J. Ewing Walker  
2203 E. Wilshire Blvd.  
Oklahoma City, Oklahoma

Dear Ewing:

As you know, we have successfully completed our Santa Fe No. 72 Well in the Lower Hospah Sand. This well is located in the southeast of the southeast of Section 1, T-17N, R-9W, McKinley County, New Mexico on a 52-acre lot. We are requesting approval from the New Mexico Conservation Commission to allocate the entire acreage of this lot to the well for allowable purposes which would result in a legal allowable of 91 barrels of oil per day.

We have been advised that before approval can be granted by the Commission, you, as an offset operator, must be advised of this application since this is a non-standard unit.

If you have no objection to this application, you need do nothing. However, if for some reason you have a valid reason why this should not be approved, you are to so advise the Commission within 20 days after receipt of this letter.

I recently spent some time in Hospah and found out that our LACT meter was loaned to Tenneco rather than to Walker Bros. I had a moment or two to spend with Lonnie and he seemed very happy about the way operations were going.

I want to thank you again for your hospitality on my recent visit to Oklahoma City. If you ever visit San Antonio, I would like to reciprocate.

Best personal regards.

Yours very truly,

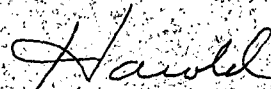

Harold Vagtberg, Jr.

HV:lt