

Sec : 19 Twp : 30N Rng : 08W Section Type : NORMAL

1 15.98	C 40.00	6 39.82	5 39.82
Federal owned	Federal owned	Federal owned	Federal owned
	A	A A	
2 16.10	112.08 F 40.00	7 42.18	H 40.00
Federal owned	Federal owned	Federal owned	Fee owned
	A	A	A
8 17.56	K 40.00	J 40.00	I 40.00
Federal owned	Fee owned	Fee owned	Fee owned
9 18.42	115.98 N 40.00	O 40.00	P 40.00
Federal owned	Fee owned	Fee owned	Federal owned
	A A		A C

Sec : 30 Twp : 30N Rng : 08W Section Type : NORMAL

6 18.16 Fee owned	C 40.00 Fee owned A A	B 40.00 Fee owned A	5 36.77 Federal owned
2 16.32 Fee owned	114.48 F 40.00 Fee owned	G 40.00 Fee owned A	7 35.88 Federal owned
3 16.28 Fee owned	K 40.00 Fee owned A	9 35.44 Federal owned	8 34.84 Federal owned
10 14.63 Federal owned A	11 35.61 Federal owned	12 34.18 Federal owned	13 33.58 Federal owned A

CMD : ONGARD 02/03/04 10:51:32
OG6IWCM INQUIRE WELL COMPLETIONS OGOMES -TQAS

API Well No : 30 45 23607 Eff Date : 04-30-1991 WC Status : A
Pool Idn : 72359 BLANCO PICTURED CLIFFS (GAS)
OGRID Idn : 778 BP AMERICA PRODUCTION COMPANY
Prop Idn : 268 ARCHULETA

Well No : 002
GL Elevation: 6268

	U/L	Sec	Township	Range	North/South	East/West	Prop/Act (P/A)
	---	---	-----	-----	-----	-----	-----
B.H. Locn : C	19	30N	08W	FTG	450 F N	FTG 850 F W	P

Lot Identifier:
Dedicated Acre: 169.64
Lease Type : F
Type of consolidation (Comm, Unit, Forced Pooling - C/U/F/O) :

E6317: No more recs. for this api well no.

PF01 HELP PF02 PF03 EXIT PF04 GoTo PF05 PF06
PF07 PF08 PF09 PF10 NEXT-WC PF11 HISTORY PF12 NXTREC

CMD : ONGARD 02/03/04 10:51:36
 OG6ACRE C102-DEDICATE ACREAGE OGOMES -TQAS
 Page No : 1

API Well No : 30 45 23607 Eff Date : 04-30-1991
 Pool Idn : 72359 BLANCO PICTURED CLIFFS (GAS)
 Prop Idn : 268 ARCHULETA Well No : 002
 Spacing Unit : 46314 OCD Order : Simultaneous Dedication:
 Sect/Twp/Rng : 19 30N 08W Acreage : 169.64 Revised C102? (Y/N) :
 Dedicated Land:

S	Base	U/L	Sec	Twp	Rng	Acreage	L/W	Ownership	Lot	Idn
	C		19	30N	08W	40.00	N	FD		
	F		19	30N	08W	40.00	N	FD		
	K		19	30N	08W	40.00	N	FE		
	D	1	19	30N	08W	15.98	N	FD		
	E	2	19	30N	08W	16.10	N	FD		
	L	8	19	30N	08W	17.56	N	FD		

E0005: Enter data to modify or PF keys to scroll

PF01 HELP PF02 PF03 EXIT PF04 GoTo PF05 PF06 CONFIRM
 PF07 BKWD PF08 FWD PF09 PF10 LAND PF11 NXTSEC PF12 RECONF

CMD : ONGARD 02/03/04 13:01:06
 OG6IPRD INQUIRE PRODUCTION BY POOL/WELL OGOMES -TQAS
 Page No: 1

OGRID Identifier : 778 BP AMERICA PRODUCTION COMPANY
 Pool Identifier : 72359 BLANCO PICTURED CLIFFS (GAS)
 API Well No : 30 45 23607 Report Period - From : 01 1993 To : 12 2003

API Well No	Property Name	Prodn. MM/YY	Days Prod	Production Volumes Gas	Oil	Water	Well Stat
30 45 23607	ARCHULETA	01 93	27	1647			F
30 45 23607	ARCHULETA	02 93	28	1247	7		F
30 45 23607	ARCHULETA	03 93	28	1308	6		F
30 45 23607	ARCHULETA	04 93	30	1374	25		F
30 45 23607	ARCHULETA	05 93	31	1515			F
30 45 23607	ARCHULETA	06 93	30	1371			F
30 45 23607	ARCHULETA	07 93	31	999			F

Reporting Period Total (Gas, Oil) :

M0002: This is the first page

PF01 HELP PF02 PF03 EXIT PF04 GoTo PF05 PF06 CONFIRM
 PF07 BKWD PF08 FWD PF09 PF10 NXTPOOL PF11 NXTOGD PF12

CMD : ONGARD 02/03/04 13:01:09
 OG6IPRD INQUIRE PRODUCTION BY POOL/WELL OGOMES -TQAS
 Page No: 2

OGRID Identifier : 778 BP AMERICA PRODUCTION COMPANY
 Pool Identifier : 72359 BLANCO PICTURED CLIFFS (GAS)
 API Well No : 30 45 23607 Report Period - From : 01 1993 To : 12 2003

API Well No	Property Name	Prodn. Days MM/YY Prod	Production Volumes Gas Oil Water	Well Stat
30 45 23607	ARCHULETA	08 93 30	1350	F
30 45 23607	ARCHULETA	09 93 30	1001 1	F
30 45 23607	ARCHULETA	10 93 31	1012	F
30 45 23607	ARCHULETA	11 93 28	907 4	F
30 45 23607	ARCHULETA	12 93 31	1042	F
30 45 23607	ARCHULETA	01 94 31	506	F
30 45 23607	ARCHULETA	02 94 28	309	F

Reporting Period Total (Gas, Oil) :

E0049: User may continue scrolling.

PF01 HELP PF02 PF03 EXIT PF04 GoTo PF05 PF06 CONFIRM
 PF07 BKWD PF08 FWD PF09 PF10 NXTPOOL PF11 NXTOGD PF12

CMD : ONGARD 02/03/04 13:01:10
 OG6IPRD INQUIRE PRODUCTION BY POOL/WELL OGOMES -TQAS
 Page No: 3

OGRID Identifier : 778 BP AMERICA PRODUCTION COMPANY
 Pool Identifier : 72359 BLANCO PICTURED CLIFFS (GAS)
 API Well No : 30 45 23607 Report Period - From : 01 1993 To : 12 2003

API Well No	Property Name	Prodn. MM/YY	Days Prod	Production Gas	Oil	Water	Well Stat
30 45 23607	ARCHULETA	03 94	30	494	2		F
30 45 23607	ARCHULETA	04 94	22	475			F
30 45 23607	ARCHULETA	05 94	28	609			F
30 45 23607	ARCHULETA	06 94	21	597	12		F
30 45 23607	ARCHULETA	07 94	31	581			F
30 45 23607	ARCHULETA	08 94	31	515			F
30 45 23607	ARCHULETA	09 94	30	558			F

Reporting Period Total (Gas, Oil) :

E0049: User may continue scrolling.

PF01 HELP PF02 PF03 EXIT PF04 GoTo PF05 PF06 CONFIRM
 PF07 BKWD PF08 FWD PF09 PF10 NXTPOOL PF11 NXTOGD PF12

CMD : ONGARD 02/03/04 13:01:11
 OG6IPRD INQUIRE PRODUCTION BY POOL/WELL OGOMES -TQAS
 Page No: 4

OGRID Identifier : 778 BP AMERICA PRODUCTION COMPANY
 Pool Identifier : 72359 BLANCO PICTURED CLIFFS (GAS)
 API Well No : 30 45 23607 Report Period - From : 01 1993 To : 12 2003

API Well No				Property Name		Prodn. Days		Production Volumes			Well	
						MM/YY	Prod	Gas	Oil	Water	Stat	
30	45	23607	ARCHULETA			10 94	31	430	11	3	F	
30	45	23607	ARCHULETA			11 94	30	1102	3	3	F	
30	45	23607	ARCHULETA			12 94	31	1036		3	F	
30	45	23607	ARCHULETA			01 95	31	957	4	3	F	
30	45	23607	ARCHULETA			02 95	28	713	8		F	
30	45	23607	ARCHULETA			03 95	23	729			F	
30	45	23607	ARCHULETA			04 95	30	1324	7		F	

Reporting Period Total (Gas, Oil) :

E0049: User may continue scrolling.

PF01 HELP PF02 PF03 EXIT PF04 GoTo PF05 PF06 CONFIRM
 PF07 BKWD PF08 FWD PF09 PF10 NXTPOOL PF11 NXTOGD PF12

CMD : ONGARD 02/03/04 13:01:12
 OG6IPRD INQUIRE PRODUCTION BY POOL/WELL OGOMES -TQAS
 Page No: 5

OGRID Identifier : 778 BP AMERICA PRODUCTION COMPANY
 Pool Identifier : 72359 BLANCO PICTURED CLIFFS (GAS)
 API Well No : 30 45 23607 Report Period - From : 01 1993 To : 12 2003

API Well No	Property Name	Prodn. Days MM/YY Prod	Production Volumes Gas Oil Water	Well Stat
30 45 23607	ARCHULETA	05 95 31	1224 3	F
30 45 23607	ARCHULETA	06 95 26	1088 1	F
30 45 23607	ARCHULETA	07 95 31	1228 7	F
30 45 23607	ARCHULETA	08 95 31	1305 3	F
30 45 23607	ARCHULETA	09 95 30	1268 3	F
30 45 23607	ARCHULETA	10 95 31	1292 2	F
30 45 23607	ARCHULETA	11 95 30	1244 3	F

Reporting Period Total (Gas, Oil) :

E0049: User may continue scrolling.

PF01 HELP PF02 PF03 EXIT PF04 GoTo PF05 PF06 CONFIRM
 PF07 BKWD PF08 FWD PF09 PF10 NXTPOOL PF11 NXTOGD PF12

CMD : ONGARD 02/03/04 13:01:12
 OG6IPRD INQUIRE PRODUCTION BY POOL/WELL OGOMES -TQAS
 Page No: 6

OGRID Identifier : 778 BP AMERICA PRODUCTION COMPANY
 Pool Identifier : 72359 BLANCO PICTURED CLIFFS (GAS)
 API Well No : 30 45 23607 Report Period - From : 01 1993 To : 12 2003

API Well No	Property Name	Prodn. Days MM/YY Prod	Production Volumes Gas Oil Water	Well Stat
30 45 23607	ARCHULETA	12 95 31	1290 4	F
30 45 23607	ARCHULETA	01 96 31	1209 2	F
30 45 23607	ARCHULETA	02 96 29	1271 3	F
30 45 23607	ARCHULETA	03 96 31	1375 4	F
30 45 23607	ARCHULETA	04 96 30	1313 4	F
30 45 23607	ARCHULETA	05 96 31	1277 2	F
30 45 23607	ARCHULETA	06 96 22	1121 1	F

Reporting Period Total (Gas, Oil) :

E0049: User may continue scrolling.

PF01 HELP PF02 PF03 EXIT PF04 GoTo PF05 PF06 CONFIRM
 PF07 BKWD PF08 FWD PF09 PF10 NXTPOOL PF11 NXTOGD PF12

CMD : ONGARD 02/03/04 13:01:13
 OG6IPRD INQUIRE PRODUCTION BY POOL/WELL OGOMES -TQAS
 Page No: 7

OGRID Identifier : 778 BP AMERICA PRODUCTION COMPANY
 Pool Identifier : 72359 BLANCO PICTURED CLIFFS (GAS)
 API Well No : 30 45 23607 Report Period - From : 01 1993 To : 12 2003

API Well No	Property Name	Prodn. Days MM/YY Prod	Production Volumes Gas Oil Water	Well Stat
30 45 23607	ARCHULETA	07 96 31	1367 1	F
30 45 23607	ARCHULETA	08 96 31	1332 2	F
30 45 23607	ARCHULETA	09 96 30	1301 3	F
30 45 23607	ARCHULETA	10 96 31	1330	F
30 45 23607	ARCHULETA	11 96 30	1247 4	F
30 45 23607	ARCHULETA	12 96 31	1252	F
30 45 23607	ARCHULETA	01 97 31	1218	F

Reporting Period Total (Gas, Oil) :

E0049: User may continue scrolling.

PF01 HELP PF02 PF03 EXIT PF04 GoTo PF05 PF06 CONFIRM
 PF07 BKWD PF08 FWD PF09 PF10 NXTPOOL PF11 NXTOGD PF12

CMD : ONGARD 02/03/04 13:01:14
 OG6IPRD INQUIRE PRODUCTION BY POOL/WELL OGOMES -TQAS
 Page No: 8

OGRID Identifier : 778 BP AMERICA PRODUCTION COMPANY
 Pool Identifier : 72359 BLANCO PICTURED CLIFFS (GAS)
 API Well No : 30 45 23607 Report Period - From : 01 1993 To : 12 2003

API Well No	Property Name	Prodn. Days MM/YY Prod	Production Volumes Gas Oil Water	Well Stat
30 45 23607	ARCHULETA	02 97 28	1088 4	F
30 45 23607	ARCHULETA	03 97 31	1187	F
30 45 23607	ARCHULETA	04 97 30	1167 2	F
30 45 23607	ARCHULETA	05 97 31	1208	F
30 45 23607	ARCHULETA	06 97 20	1114 4	F
30 45 23607	ARCHULETA	07 97 31	1223	F
30 45 23607	ARCHULETA	08 97 31	1287 5	F

Reporting Period Total (Gas, Oil) :

E0049: User may continue scrolling.

PF01 HELP PF02 PF03 EXIT PF04 GoTo PF05 PF06 CONFIRM
 PF07 BKWD PF08 FWD PF09 PF10 NXTPOOL PF11 NXTOGD PF12

CMD : ONGARD 02/03/04 13:01:15
 OG6IPRD INQUIRE PRODUCTION BY POOL/WELL OGOMES -TQAS
 Page No: 9

OGRID Identifier : 778 BP AMERICA PRODUCTION COMPANY
 Pool Identifier : 72359 BLANCO PICTURED CLIFFS (GAS)
 API Well No : 30 45 23607 Report Period - From : 01 1993 To : 12 2003

API Well No	Property Name	Prod. Days MM/YY Prod	Production Volumes Gas Oil Water	Well Stat
30 45 23607	ARCHULETA	09 97 30	1246	F
30 45 23607	ARCHULETA	10 97 31	1280	F
30 45 23607	ARCHULETA	11 97 30	1179 5	F
30 45 23607	ARCHULETA	12 97 31	1129 2	F
30 45 23607	ARCHULETA	01 98 31	1111	F
30 45 23607	ARCHULETA	02 98 28	1010	F
30 45 23607	ARCHULETA	03 98 31	1079	F

Reporting Period Total (Gas, Oil) :

E0049: User may continue scrolling.

PF01 HELP PF02 PF03 EXIT PF04 GoTo PF05 PF06 CONFIRM
 PF07 BKWD PF08 FWD PF09 PF10 NXTPOOL PF11 NXTOGD PF12

CMD : ONGARD 02/03/04 13:01:16
 OG6IPRD INQUIRE PRODUCTION BY POOL/WELL OGOMES -TQAS
 Page No: 10

OGRID Identifier : 778 BP AMERICA PRODUCTION COMPANY
 Pool Identifier : 72359 BLANCO PICTURED CLIFFS (GAS)
 API Well No : 30 45 23607 Report Period - From : 01 1993 To : 12 2003

API Well No	Property Name	Prod. Days MM/YY Prod	Production Volumes Gas Oil Water	Well Stat
30 45 23607	ARCHULETA	04 98 30	1012	F
30 45 23607	ARCHULETA	05 98 27	1012	F
30 45 23607	ARCHULETA	06 98 30	1027	F
30 45 23607	ARCHULETA	07 98 31	1026	F
30 45 23607	ARCHULETA	08 98 31	981	F
30 45 23607	ARCHULETA	09 98 30	826	F
30 45 23607	ARCHULETA	10 98 26	901	F

Reporting Period Total (Gas, Oil) :

E0049: User may continue scrolling.

PF01 HELP PF02 PF03 EXIT PF04 GoTo PF05 PF06 CONFIRM
 PF07 BKWD PF08 FWD PF09 PF10 NXTPOOL PF11 NXTOGD PF12

CMD : ONGARD 02/03/04 13:01:17
 OG6IPRD INQUIRE PRODUCTION BY POOL/WELL OGOMES -TQAS
 Page No: 11

OGRID Identifier : 778 BP AMERICA PRODUCTION COMPANY
 Pool Identifier : 72359 BLANCO PICTURED CLIFFS (GAS)
 API Well No : 30 45 23607 Report Period - From : 01 1993 To : 12 2003

API Well No	Property Name	Prod. Days MM/YY Prod	Production Volumes Gas Oil Water	Well Stat
30 45 23607	ARCHULETA	11 98 30	987	F
30 45 23607	ARCHULETA	12 98 31	966	F
30 45 23607	ARCHULETA	01 99 31	938	F
30 45 23607	ARCHULETA	02 99 28	782	F
30 45 23607	ARCHULETA	03 99 31	631	F
30 45 23607	ARCHULETA	04 99 30	556	F
30 45 23607	ARCHULETA	05 99 16	373	F

Reporting Period Total (Gas, Oil) :

E0049: User may continue scrolling.

PF01 HELP PF02 PF03 EXIT PF04 GoTo PF05 PF06 CONFIRM
 PF07 BKWD PF08 FWD PF09 PF10 NXTPOOL PF11 NXTOGD PF12

CMD : ONGARD 02/03/04 13:01:18
 OG6IPRD INQUIRE PRODUCTION BY POOL/WELL OGOMES -TQAS
 Page No: 12

OGRID Identifier : 778 BP AMERICA PRODUCTION COMPANY
 Pool Identifier : 72359 BLANCO PICTURED CLIFFS (GAS)
 API Well No : 30 45 23607 Report Period - From : 01 1993 To : 12 2003

API Well No	Property Name	Prodn. MM/YY	Days Prod	Production Volumes Gas	Oil	Water	Well Stat
30 45 23607	ARCHULETA	06 99	30	683			F
30 45 23607	ARCHULETA	07 99	31	796			F
30 45 23607	ARCHULETA	08 99	31	858			F
30 45 23607	ARCHULETA	09 99	30	826			F
30 45 23607	ARCHULETA	10 99	31	827			F
30 45 23607	ARCHULETA	11 99	8	221			F
30 45 23607	ARCHULETA	12 99					S

Reporting Period Total (Gas, Oil) :

E0049: User may continue scrolling.

PF01 HELP PF02 PF03 EXIT PF04 GoTo PF05 PF06 CONFIRM
 PF07 BKWD PF08 FWD PF09 PF10 NXTPOOL PF11 NXTOGD PF12

CMD : ONGARD 02/03/04 13:01:19
 OG6IPRD INQUIRE PRODUCTION BY POOL/WELL OGOMES -TQAS
 Page No: 13

OGRID Identifier : 778 BP AMERICA PRODUCTION COMPANY
 Pool Identifier : 72359 BLANCO PICTURED CLIFFS (GAS)
 API Well No : 30 45 23607 Report Period - From : 01 1993 To : 12 2003

API Well No	Property Name	Prod. Days MM/YY Prod	Production Volumes Gas Oil Water	Well Stat
30 45 23607	ARCHULETA	01 00		S
30 45 23607	ARCHULETA	02 00		S
30 45 23607	ARCHULETA	03 00		S
30 45 23607	ARCHULETA	08 00		S
30 45 23607	ARCHULETA	09 00		S
30 45 23607	ARCHULETA	05 02	3	S
30 45 23607	ARCHULETA	01 03		S

Reporting Period Total (Gas, Oil) :

E0049: User may continue scrolling.

PF01 HELP PF02 PF03 EXIT PF04 GoTo PF05 PF06 CONFIRM
 PF07 BKWD PF08 FWD PF09 PF10 NXTPOOL PF11 NXTOGD PF12

CMD : ONGARD 02/03/04 13:01:20
 OG6IPRD INQUIRE PRODUCTION BY POOL/WELL OGOMES -TQAS
 Page No: 14

OGRID Identifier : 778 BP AMERICA PRODUCTION COMPANY
 Pool Identifier : 72359 BLANCO PICTURED CLIFFS (GAS)
 API Well No : 30 45 23607 Report Period - From : 01 1993 To : 12 2003

API Well No	Property Name	Prod. Days MM/YY Prod	Production Volumes Gas Oil Water	Well Stat
30 45 23607	ARCHULETA	02 03		S
30 45 23607	ARCHULETA	03 03		S
30 45 23607	ARCHULETA	04 03		S
30 45 23607	ARCHULETA	05 03		S
30 45 23607	ARCHULETA	06 03		S
30 45 23607	ARCHULETA	07 03		S
30 45 23607	ARCHULETA	08 03		S

Reporting Period Total (Gas, Oil) :

E0049: User may continue scrolling.

PF01 HELP PF02 PF03 EXIT PF04 GoTo PF05 PF06 CONFIRM
 PF07 BKWD PF08 FWD PF09 PF10 NXTPOOL PF11 NXTOGD PF12

CMD : ONGARD 02/03/04 13:01:22
 OG6IPRD INQUIRE PRODUCTION BY POOL/WELL OGOMES -TQAS
 Page No: 15

OGRID Identifier : 778 BP AMERICA PRODUCTION COMPANY
 Pool Identifier : 72359 BLANCO PICTURED CLIFFS (GAS)
 API Well No : 30 45 23607 Report Period - From : 01 1993 To : 12 2003

API Well No	Property Name	Prodn. Days MM/YY Prod	Production Volumes Gas Oil Water	Well Stat
30 45 23607	ARCHULETA	09 03		S
30 45 23607	ARCHULETA	10 03		S
30 45 23607	ARCHULETA	11 03		S

Reporting Period Total (Gas, Oil) : 84797 167 12

E0049: User may continue scrolling.

PF01 HELP PF02 PF03 EXIT PF04 GoTo PF05 PF06 CONFIRM
 PF07 BKWD PF08 FWD PF09 PF10 NXTPOOL PF11 NXTOGD PF12

UNITED STATES
DEPARTMENT OF THE INTERIOR
GEOLOGICAL SURVEY

APPLICATION FOR PERMIT TO DRILL, DEEPEN, OR PLUG BACK

1a. TYPE OF WORK DRILL <input checked="" type="checkbox"/> DEEPEN <input type="checkbox"/> PLUG BACK <input type="checkbox"/>		5. LEASE DESIGNATION AND SERIAL NO. USA SF-079511-A	
b. TYPE OF WELL OIL WELL <input type="checkbox"/> GAS WELL <input checked="" type="checkbox"/> OTHER <input type="checkbox"/> SINGLE ZONE <input checked="" type="checkbox"/> MULTIPLE ZONE <input type="checkbox"/>		6. IF INDIAN, ALLOTTEE OR TRIBE NAME	
2. NAME OF OPERATOR Tenneco Oil Company		7. UNIT AGREEMENT NAME	
3. ADDRESS OF OPERATOR 720 South Colorado Blvd., Denver, Colorado 80222		8. FARM OR LEASE NAME Archuleta	
4. LOCATION OF WELL (Report location clearly and in accordance with any State requirements.) At surface 450' FNL, 850' FWL At proposed prod. zone		9. WELL NO. 2	
14. DISTANCE IN MILES AND DIRECTION FROM NEAREST TOWN OR POST OFFICE See Point 1B, Surface Use Plan		10. FIELD AND POOL OR WILDCAT Blanco Pictured Cliffs	
15. DISTANCE FROM PROPOSED LOCATION TO NEAREST PROPERTY OR LEASE LINE, FT. (Also to nearest drg. unit line, if any)		11. SEC. T., R., M., OR R.R. AND SURVEY OR AREA Sec. 19, T30N, R8W	
16. NO. OF ACRES IN LEASE		12. COUNTY OR PARISH 13. STATE San Juan New Mexico	
17. NO. OF ACRES ASSIGNED TO THIS WELL 169.64		19. PROPOSED DEPTH 2650	
20. ROTARY OR CABLE TOOLS Rotary		22. APPROX. DATE WORK WILL START October 1, 1979	
21. ELEVATIONS (Show whether DP, RT, GR, etc.) 6268 G.L.			

23. PROPOSED CASING AND CEMENTING PROGRAM				
SIZE OF HOLE	SIZE OF CASING	WEIGHT PER FOOT	SETTING DEPTH	QUANTITY OF CEMENT
12-1/4"	8-5/8"	24#	150 +	See 4 Below
7-7/8"	4-1/2"	10.5#	2650	See 4 Below

- The geological name of the surface formation is Tertiary San Jose.
- 2&3. Estimated Formation Tops:

OJO Alamo	+ 1762'
Fruitland	+ 2770'
Pictured Cliffs	+ 2970'
Total Depth	+ 3170'
- Drill a 12-1/4" hole to 150+. Run 8-5/8", 24#, K-55 ST & C casing to 150+. Cement with sufficient volume to circulate cement to surface. Reduce hole to 7-7/8" and drill to total depth. Run 4-1/2", 10.5#, K-55 ST & C casing to 2650. Cement with sufficient volume to circulate cement to surface.
- Blowout Preventors: Hydraulic, double ram, 10". One set of rams will be provided for each size drill pipe in the hole. One set of blind rams at all times. Fill line will be 2", Kill line will be 2", choke relief line will be 2" with variable choke. BOPs will be installed, tested and in working order before drilling below surface casing and shall be maintained ready for use until drilling operations are completed. BOPs, drills and test will be recorded in the IADC Drilling Report. They shall be checked every 24 hours. All rig equipment will be tested to above BOE ratings.
- 0-150 Native Solids. Sufficient viscosity to clean hole & run casing.
150-2650 Low Solids.
- Auxiliary Equipment
 - Kelly cock will be in use at all times.
 - Stabbing valve to fit drill pipe will be present on floor at all times.
 - Mud monitoring will be visual, no abnormal pressures are anticipated in this area.
 - Floats at bits.
 - Drill string safety valve(s) to fit all pipe in the drill string will be maintained on the rig floor while drilling operations are in progress.
 - Rotating head will be used while drilling with gas.
- No cores or DST's are anticipated. 30' samples will be taken from 150-2650. GR/FDC/CNL Caliper from total depth to 2000' above T.D. SP/Induction/SN/GR from 2650 to surface.
- No abnormal pressures or temperatures are anticipated. See point #5 for blowout prevention equipment.
- The drilling of this well will take approximately 5 days. The gas is not yet contracted.

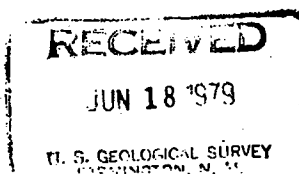

IN ABOVE SPACE DESCRIBE PROPOSED PROGRAM: If proposal is to deepen or plug back, give data on present productive zone and proposed new productive zone. If proposal is to drill or deepen directionally, give pertinent data on subsurface locations and measured and true vertical depths. Give blowout prevention program, if any.

SIGNED: J. M. Lewis By Vernon Seal TITLE: Div. Production Manager DATE: 6-14-79

(This space for Federal or State office use)

PERMIT NO.

NMOCC
APPROVAL DATE

INS

NEW MEXICO OIL CONSERVATION COMMISSION

WELL LOCATION AND ACREAGE DEDICATION PLAT

Form C-102
Supersedes C-128

Effective 1-1-63

All distances must be from the outer boundaries of the Section.

Operator TENNECO OIL COMPANY			Lease ARCHULETA		Well No. 2
Unit Letter C	Section 19	Township 30N	Range 8W	County San Juan	
Actual Footage Location of Well: 450 feet from the North line and 850 feet from the West line					
Ground Level Elev. 6268	Producing Formation Pictured Cliffs	Pool Blanco Pictured Cliffs	Dedicated Acreage: 169.64 Acres		

1. Outline the acreage dedicated to the subject well by colored pencil or hatchure marks on the plat below.
2. If more than one lease is dedicated to the well, outline each and identify the ownership thereof (both as to working interest and royalty).
3. If more than one lease of different ownership is dedicated to the well, have the interests of all owners been consolidated by communitization, unitization, force-pooling, etc?

☐ Yes ☒ No

If answer is "yes," type of consolidation

Communitization in progress.

If answer is "no," list the owners and tract descriptions which have actually been consolidated. (Use reverse side of this form if necessary.)

No allowable will be assigned to the well until all interests have been consolidated (by communitization, unitization, forced-pooling, or otherwise) or until a non-standard unit, eliminating such interests, has been approved by the Commission.

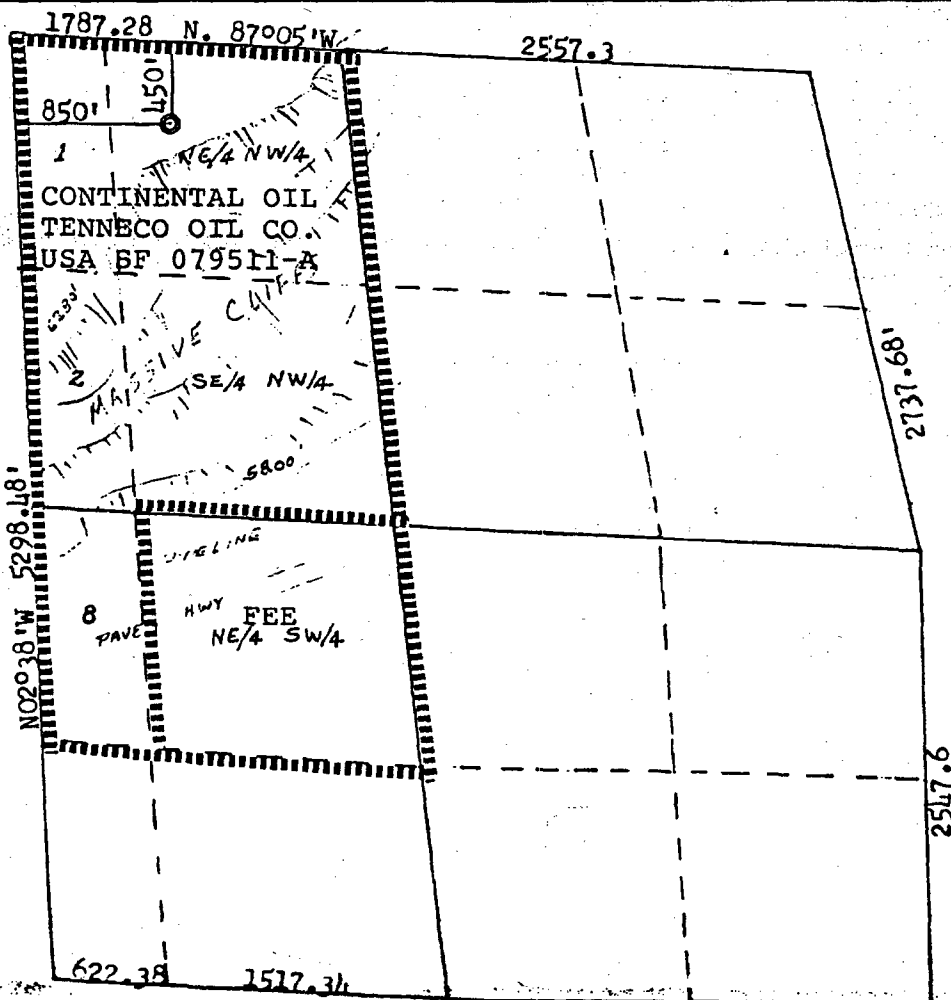
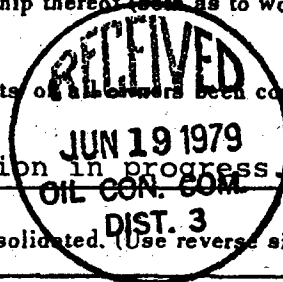

CERTIFICATION

I hereby certify that the information contained herein is true and complete to the best of my knowledge and belief.

Name J. A. Rush
Position Environmental Coordinator
Company Tenneco Oil Company
Date June 11, 1979

I hereby certify that the well location shown on this plat was plotted from field notes of actual surveys made by me or under my supervision, and that the same is true and correct to the best of my knowledge and belief.

Date Surveyed March 27, 1979
Registered Professional Engineer and Land Surveyor
[Signature]
Certified for NEER. 18.
3950

UNITED STATES
DEPARTMENT OF THE INTERIOR
GEOLOGICAL SURVEY

SUNDRY NOTICES AND REPORTS ON WELLS

(Do not use this form for proposals to drill or to deepen or plug back to a different reservoir. Use Form 9-331-C for such proposals.)

1. oil well ☐ gas well ☒ other ☐
2. NAME OF OPERATOR
Tenneco Oil Company
3. ADDRESS OF OPERATOR
720 So. Colo. Blvd., Denver, Co. 80222
4. LOCATION OF WELL (REPORT LOCATION CLEARLY. See space 17 below.)
AT SURFACE: 450' FNL & 850' FWL, Unit D
AT TOP PROD. INTERVAL:
AT TOTAL DEPTH:

16. CHECK APPROPRIATE BOX TO INDICATE NATURE OF NOTICE, REPORT, OR OTHER DATA

REQUEST FOR APPROVAL TO:

SUBSEQUENT REPORT OF:

- TEST WATER SHUT-OFF ☐
FRACTURE TREAT ☐
SHOOT OR ACIDIZE ☐
REPAIR WELL ☐
PULL OR ALTER CASING ☐
MULTIPLE COMPLETE ☐
CHANGE ZONES ☐
ABANDON* ☐

- ☐
☐
☐
☐
☐
☐
☐
☐

(other) Spud, surface & production csg

5. LEASE
USA SF 079511-A
6. IF INDIAN, ALLOTTEE OR TRIBE NAME
7. UNIT AGREEMENT NAME
8. FARM OR LEASE NAME
Archuleta
9. WELL NO.
2
10. FIELD OR WILDCAT NAME
Blanco Pictured Cliffs
11. SEC., T., R., M., OR BLK. AND SURVEY OR AREA
Sec. 19, T-30-N, R-8-W
12. COUNTY OR PARISH
San Juan
13. STATE
New Mexico
14. API NO.
15. ELEVATIONS (SHOW DF, KDB, AND WD)
6268' GL

(NOTE: Report results of multiple completion or zone change on Form 9-330.)

17. DESCRIBE PROPOSED OR COMPLETED OPERATIONS (Clearly state all pertinent details, and give pertinent dates, including estimated date of starting any proposed work. If well is directionally drilled, give subsurface locations and measured and true vertical depths for all markers and zones pertinent to this work.)*

7/19/79 - 7/23/79

Spudded 12 1/4" hole on 7/19/79 and drilled to 190'. Ran 4 jts 8 5/8", 24#, K-55 csg & set @ 190'. Cemented w/150 Sx class "B" neat cement, 2% CACL2. WOC 12 hrs. NUBOE, & pressure tstd to 1000 psi for 30 min - held ok. Reduced hole to 7 7/8" & drilled to T.D. @ 3148' on 7/21/79. Ran electric logs. Ran 95 jts 4 1/2", 10.5#, K-55 csg & set @ 3148'. Cemented w/725 Sx 50/50 poz mix, 2% Gel, 6 1/2# Sx Gilsonite, 1/4# Sx Flocele, 0.5% CFR-2, followed by 100 Sx class "B" neat cement. WOC 12 hrs. Installed wellhead. Released rig. WOCU.

Subsurface Safety Valve: Manu. and Type

18. I hereby certify that the foregoing is true and correct

SIGNED

Barley J. [Signature]

TITLE

Admin. Supervisor

DATE

7/30/79

(This space for Federal or State office use)

APPROVED BY

TITLE

DATE

CONDITIONS OF APPROVAL, IF ANY:

WYMOCK

TABULATION OF DEVIATION TESTS

TENNECO OIL COMPANY

DEPTH INCLINATION

190'
690
1200
1775
2283
2772
3148

DEPTH INCLINATION

1/2°
1/2
1/2
3/4
3/4
1
1 1/2

AFFIDAVIT

This is to certify that to the best of my knowledge, the above tabulation details the deviation test taken on Tenneco Oil Company's well:
Archuleta #2, Unit D, Sec. 19, T30N, R8W, San Juan County, New Mexico.

Signed

Carley Watkins
Agent for Tenneco Oil Company

THE STATE OF COLORADO)
CITY AND COUNTY OF DENVER)

Before me, the undersigned authority, on this day, personally appeared,
Carley Watkins, known to me to be an Agent for Tenneco Oil
Company, and to be the person whose name is subscribed to the above
statement, who, being by me duly sworn on oath, states that he
has knowledge of the facts stated herein, and that said statement is true
and correct. Subscribed and sworn to before me, a Notary Public in and
for said County and State, this

My Commission Expires:

My Commission expires Nov. 8, 1982

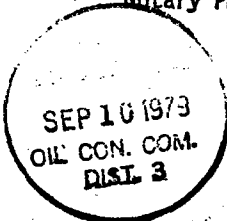

UNITED STATES
DEPARTMENT OF THE INTERIOR
GEOLOGICAL SURVEY

SUBMIT IN DUPLICATE*

(See other in-
structions on
reverse side)Form approved.
Budget Bureau No. 42-R355.5.

WELL COMPLETION OR RECOMPLETION REPORT AND LOG*

1a. TYPE OF WELL:		OIL WELL <input type="checkbox"/>	GAS WELL <input checked="" type="checkbox"/>	DRY <input type="checkbox"/>	Other _____		
b. TYPE OF COMPLETION:		NEW WELL <input checked="" type="checkbox"/>	WORK OVER <input type="checkbox"/>	DEEP-EN <input type="checkbox"/>	PLUG BACK <input type="checkbox"/>	DIFF. RESVR. <input type="checkbox"/>	Other _____
2. NAME OF OPERATOR Tenneco Oil Company						5. LEASE DESIGNATION AND SERIAL NO. USA-SF-079511-A	
3. ADDRESS OF OPERATOR 720 S. Colorado Blvd., Denver, Co 80222						6. IF INDIAN, ALLOTTEE OR TRIBE NAME	
4. LOCATION OF WELL (Report location clearly and in accordance with any State requirements)* At surface 450' FNL, & 850' FWL, Unit D At top prod. interval reported below At total depth-						7. UNIT AGREEMENT NAME	
14. PERMIT NO.						DATE ISSUED	
15. DATE SPUDDED 7/19/79						16. DATE T.D. REACHED 7/21/79	
17. DATE COMPL. (Ready to prod.) 8/7/79						18. ELEVATIONS (DV, REB, RT, GR, ETC.)* 6268' GL	
19. ELEV. CASINGHEAD						20. TOTAL DEPTH, MD & TVD 3148'	
21. PLUG, BACK T.D., MD & TVD 3108'						22. IF MULTIPLE COMPL., HOW MANY*	
23. INTERVALS DRILLED BY →						ROTARY TOOLS O-TD	
24. PRODUCING INTERVAL(S), OF THIS COMPLETION—TOP, BOTTOM, NAME (MD AND TVD)* 3004-3066(Pictured Cliffs)						25. WAS DIRECTIONAL SURVEY MADE Yes	
26. TYPE ELECTRIC AND OTHER LOGS RUN Induction-SFL, CND						27. WAS WELL CORED No	
28. CASING RECORD (Report all strings set in well)							
CASING SIZE		WEIGHT, LB./FT.		DEPTH SET (MD)		HOLE SIZE	
8 5/8"		24#		190'		12 1/4"	
4 1/2"		10.5#		3148'		7 7/8"	
29. LINER RECORD							
SIZE		TOP (MD)		BOTTOM (MD)		SACKS CEMENT*	
None							
30. TUBING RECORD							
SIZE		DEPTH SET (MD)		PACKER SET (MD)			
1 1/4"		3083'					
31. PERFORATION RECORD (Interval, size and number)							
80 holes from 3004' to 3066'							
32. ACID, SHOT, FRACTURE, CEMENT SQUEEZE, ETC.							
DEPTH INTERVAL (MD)				AMOUNT AND KIND OF MATERIAL USED			
3004-3066				800 gal 15% DI MCA			
33. PRODUCTION							
DATE FIRST PRODUCTION		PRODUCTION METHOD (Flowing, gas lift, pumping—size and type of pump) flowing				WELL STATUS (Producing or shut-in) Shut-in	
DATE OF TEST 8/15/79		HOURS TESTED 3		CROCK SIZE 3/4"		PROD'N. FOR TEST PERIOD →	
FLOW. TUBING PRESS. 68		CASING PRESSURE 108		CALCULATED 24-HOUR RATE →		OIL—BSL. AOF=1092	
						GAS—MCF. Q=1066	
						WATER—BSL.	
						OIL GRAVITY-API (CORR.) AUG 23-1979	
34. DISPOSITION OF GAS (Sold, used for fuel, vented, etc.) will be sold pending hook-up							
35. LIST OF ATTACHMENTS two copies of electric logs forwarded by Schlumberger							
36. I hereby certify that the foregoing and attached information is complete and correct as determined from all available records							
SIGNED		TITLE		Admin. Supervisor		DATE 8/17/79	

*(See Instructions and Spaces for Additional Data on Reverse Side)

Tenneco

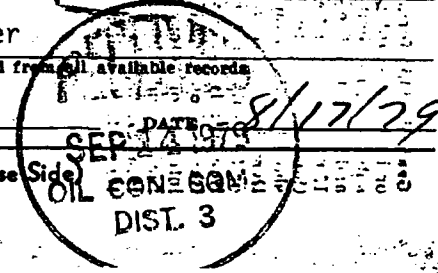

INSTRUCTIONS

General: This form is designed for submitting a complete and correct well completion report and log on all types of lands and leases to either a Federal agency or a State agency, or both, pursuant to applicable Federal and/or State laws and regulations. Any necessary special instructions concerning the use of this form and the number of copies to be submitted, particularly with regard to local, area, or regional procedures and practices, either are shown below or will be issued by, or may be obtained from, the local Federal and/or State office. See instructions on Items 22 and 24, and 33, below regarding separate reports for separate completions. If not filed prior to the time this summary record is submitted, copies of all currently available logs (drillers, geologists, sample and core analysis, all types electric, etc.), formation and pressure tests, and directional surveys, should be attached hereto, to the extent required by applicable Federal and/or State laws and regulations. All attachments should be listed on this form, see Item 33.

Item 4: If there are no applicable State requirements, locations on Federal or Indian land should be described in accordance with Federal requirements. Consult local State or Federal office for specific instructions.

Item 18: Indicate which elevation is used as reference (where not otherwise shown) for depth measurements given in other spaces on this form and in any attachments.

Items 22 and 24: If this well is completed for separate production from more than one interval zone (multiple completion), so state in Item 22, and in Item 24 show the producing interval, or intervals, top(s), bottom(s) and name(s) (if any) for only the interval reported in Item 33. Submit a separate report (page) on this form, adequately identified, for each additional interval to be separately produced, showing the additional data pertinent to such interval.

Item 29: "Sacks Cement": Attached supplemental records for this well should show the details of any multiple stage cementing and the location of the cementing tool.

Item 33: Submit a separate completion report on this form for each interval to be separately produced. (See instruction for Items 22 and 24 above.)

37. SUMMARY OF POROUS ZONES:

SHOW ALL IMPORTANT ZONES OF POROSITY AND CONTENTS THEREOF; CORRELATE INTERVALS; AND ALL DRILL-STEM TESTS, INCLUDING DEPTH INTERVAL TESTED, CUSHION USED, TIME TOOL OPEN, FLOWING AND SHUT-IN PRESSURES, AND RECOVERIES

FORMATION	TOP	BOTTOM	DESCRIPTION, CONTENTS, ETC.	NAME	MEAS. DEPTH	TRUE VERT. DEPTH
Pictured Cliffs	3002	3100	shaley sand, gas	Ojo Alamo	1810	
				Fruitland	2702	

38.

GEOLOGIC MARKERS

OIL CONSERVATION DIVISION

P.O. Box 2088
Santa Fe, New Mexico 87504-2088

REQUEST FOR ALLOWABLE AND AUTHORIZATION
TO TRANSPORT OIL AND NATURAL GAS

Operator AMOCO PRODUCTION COMPANY		Well API No. 300452360700
Address P.O. BOX 800, DENVER, COLORADO 80201		
Reason(s) for Filing (Check proper box) <input type="checkbox"/> Other (Please explain)		
New Well <input type="checkbox"/>	Change in Transporter of: <input type="checkbox"/>	
Recompletion <input type="checkbox"/>	Oil <input checked="" type="checkbox"/>	Dry Gas <input type="checkbox"/>
Change in Operator <input type="checkbox"/>	Casinghead Gas <input type="checkbox"/>	Condensate <input type="checkbox"/>
If change of operator give name and address of previous operator		

II. DESCRIPTION OF WELL AND LEASE

Lease Name ARCHULETA	Well No. 2	Pool Name, Including Formation BLANCO PICTURED CLIFFS (GAS)	Kind of Lease State, Federal or Fee	Lease No.
Location Unit Letter 19 Section 30N Township 8W Range 8W Line and 2370 Feet From The FNL Line and 850 Feet From The FWL Line Section 19 Township 30N Range 8W N10PM, SAN JUAN County				

III. DESIGNATION OF TRANSPORTER OF OIL AND NATURAL GAS

Name of Authorized Transporter of Oil <input type="checkbox"/> or Condensate <input type="checkbox"/> MERIDIAN OIL INC.	Address (Give address to which approved copy of this form is to be sent) 3535 EAST 30TH STREET, FARMINGTON, NM 87401	
Name of Authorized Transporter of Casinghead Gas <input type="checkbox"/> or Dry Gas <input type="checkbox"/> EL PASO NATURAL GAS COMPANY	Address (Give address to which approved copy of this form is to be sent) P.O. BOX 1492, EL PASO, TX 79978	
If well produces oil or liquids, give location of tanks.	Unit	Soc.
	Twp.	Rge.
		Is gas actually connected? When?

If this production is commingled with that from any other lease or pool, give commingling order number:

IV. COMPLETION DATA

Designate Type of Completion - (X)	Oil Well	Gas Well	New Well	Workover	Deepen	Plug Back	Same Res'v	Diff Res'v
Date Spudded	Date Compl. Ready to Prod.		Total Depth		P.B.T.D.			
Elevations (DF, RAB, RT, GR, etc.)	Name of Producing Formation		Top Oil/Gas Pay		Tubing Depth			
Perforations					Depth Casing Shoe			
TUBING, CASING AND CEMENTING RECORD								
HOLE SIZE	CASING & TUBING SIZE		DEPTH SET		RECEIVED			
					AUG 23 1990			

V. TEST DATA AND REQUEST FOR ALLOWABLE

OIL WELL (Test must be after recovery of total volume of flood oil and must be equal to or exceed top allowable for this depth of test for full 24 hours)

Date First New Oil Run To Tank	Date of Test	Producing Method (Flow, pump, gas lift, etc.)	
Length of Test	Tubing Pressure	Casing Pressure	Choke Size
Actual Prod. During Test	Oil - Bbls.	Water - Bbls.	Gas - MCF

GAS WELL

Actual Prod. Test - MCF/D	Length of Test	Bbls. Condensate/MCF	Gravity of Condensate
Testing Method (prod, back pr.)	Tubing Pressure (Shut-in)	Casing Pressure (Shut-in)	Choke Size

VI. OPERATOR CERTIFICATE OF COMPLIANCE

I hereby certify that the rules and regulations of the Oil Conservation Division have been complied with and that the information given above is true and complete to the best of my knowledge and belief.

Signature *Doug W. Whaley*
Doug W. Whaley, Staff Admin. Supervisor
Printed Name Title
Date July 5, 1990 Telephone No. 303-830-4280

OIL CONSERVATION DIVISION

Date Approved AUG 23 1990
By *[Signature]*
Title SUPERVISOR DISTRICT #3

INSTRUCTIONS: This form is to be filed in compliance with Rule 1104

- 1) Request for allowable for newly drilled or deepened well must be accompanied by tabulation of deviation tests taken in accordance with Rule 111.
- 2) All sections of this form must be filled out for allowable on new and recompleted wells.
- 3) Fill out only Sections I, II, III, and VI for changes of operator, well name or number, transporter, or other such changes.
- 4) Separate Form C-104 must be filed for each pool in multiply completed wells.

District I
1625 N. French Dr., Hobbs, NM 88240
District II
1301 W. Grand Avenue, Artesia, NM 88210
District III
1000 Rio Brazos Road, Aztec, NM 87410
District IV
1220 S. St. Francis Dr., Santa Fe, NM 87505

State of New Mexico
Energy Minerals and Natural Resources

Form C-104B
March 19, 2001

Oil Conservation Division
1220 South St. Francis Dr.
Santa Fe, NM 87505

Submit 1 copy of the final affected
wells list along with 1 copy of this form
per number of wells on that list to
appropriate District Office

Change of Operator Name

OGRID: 000778
Effective Date: 12/31/2001

Previous Operator Name and Information:

Name: Amoco Production Company
Address: P.O. Box 3092
Address: _____
City, State, Zip: Houston, Texas 77253

New Operator Name and Information:

New Name: BP America Production Company
Address: P.O. Box 3092
Address: _____
City, State, Zip: Houston, Texas 77253

I hereby certify that the rules of the Oil Conservation Division have been complied with and that the information given on this form and the attached list of wells is true and complete to the best of my knowledge and belief.

Signature: Mary Corley

Printed
name: Mary Corley

Title: Senior Regulatory Specialist

Date: 12/10/2001 Phone: 281-366-4491

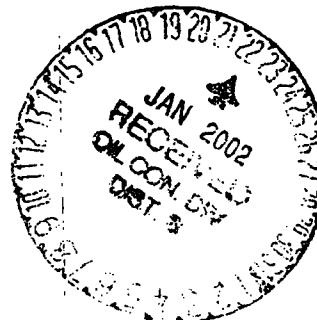

NMOCD Approval

Signature: [Signature]

Printed Name: SUPERVISOR DISTRICT #3

District: JAN 22 2002

Date: _____

BEFORE THE OIL CONSERVATION COMMISSION
OF THE STATE OF NEW MEXICO

IN THE MATTER OF THE APPLICATION OF
DELHI OIL CORPORATION, DALLAS, TEXAS
FOR AN ORDER PERMITTING THE COMMUNITIZ-
ING OF SHORT OR NARROW QUARTER-SECTIONS
ON A NORTH-SOUTH BASIS AS THEY MAY LIE
ALONG THE WEST SIDE OF TOWNSHIPS 30 AND
31 NORTH, RANGE 9 WEST, FOR THE PURPOSE
OF CREATING DRILLING UNITS AND ALLOWABLES
APPROXIMATELY CORRESPONDING TO THE
SPACING AND ALLOWABLE REQUIREMENTS OF
ORDER NO. 799 RELATING TO THE BLANCO-
MESAVERDE GAS POOL IN SAN JUAN COUNTY,
NEW MEXICO.

✓
CASE NO. 236
ORDER NO. R-35

ORDER OF THE COMMISSION

BY THE COMMISSION:

This cause came on for hearing at Santa Fe, New Mexico, at 10:00 o'clock A. M., October 24, 1950, before the Oil Conservation Commission of New Mexico, hereinafter referred to as the "Commission".

NOW, on this 1st day of December, 1950, the Commission having before it for consideration the testimony adduced at the hearing of said case and being fully advised in the premises,

FINDS:

A. The extreme western quarter sections of sections 6, 7, 18, 19, 30 and 31 of Townships 30 and 31 north, Range 8 west, NMPM, San Juan County, New Mexico are "narrow" quarter sections comprising approximately 100 acres each.

B. That the sections in question are within or near the areal limits of the Blanco-Mesaverde Pool.

C. That wells drilled upon "narrow" half sections would be entitled to only approximately 200/320 of the allowable assigned to a full 320 acre drilling unit.

D. That waste would result from unnecessary drilling on 200-acre units.

IT IS THEREFORE ORDERED:

1. The following "narrow" quarter sections are hereby unitized as shown below by threes, each three unitized quarter sections of approximately 300 acres each to be a drilling unit for the Mesaverde formation underlying:

W/2 Sec. 6 and NW/4 Sec. 7
SW/4 Sec. 7 and W/2 Sec. 18
W/2 Sec. 19 and NW/4 Sec. 30
SW/4 Sec. 30 and W/2 Sec. 31
~~W/2 Sec. 19 and NW/4 Sec. 30~~
SW/4 Sec. 30 and W/2 Sec. 31

for both Townships 30 and 31 north, Range 9 west.

2. (a) Wells which may be located upon these eight unitized drilling units will be located as follows:

All to be not closer than 660 ft. to the outer boundary nor closer to the center than 330 ft. of the quarter section ("narrow") upon which it is located:

SW/4 Sec. 6	for both Townships 30 and 31 North
SW/4 Sec. 18	Range 9 west.
SW/4 Sec. 19	
SW/4 Sec. 30	

(b) All wells upon the east half of the narrow sections to be located in the northeast quarter of the section not closer than 660 feet to the outer boundary nor closer than 330 feet to the center of the quarter section upon which they are located.

3. That no well shall be drilled or completed and no Notice of Intention nor drilling permit shall be approved unless one of the above designated 300 acre units is assigned to the well for allowable and proration purposes.

4. That the allowable for any unit shall in direct proportion of the acreage in the unit to 320, i. e., a 300-acre unit will receive $300/320$ or $15/16$ or 93.75% of a normal unit allowable for 320 acres in Mesaverde pools spaced one well to each half section.

DONE at Santa Fe, New Mexico, on this 1st day of December, 1950.

STATE OF NEW MEXICO
OIL CONSERVATION COMMISSION

Signed by: Thomas J. Mabry, Chairman; Guy Shepard, Member, R.R. Spurrier, Secy.

BEFORE THE OIL CONSERVATION COMMISSION
OF THE STATE OF NEW MEXICO

CASE No. 258
ORDER No. R-60

IN THE MATTER OF THE APPLICATION OF
BYRD-FROST, INC. FOR PERMISSION TO
COMMUNITIZE THE SHORT SECTIONS ON A
NORTH-SOUTH BASIS, BEING LOCATED ON
THE WEST SIDE OF T. 29 N, R. 8 W, SUCH
UNITS TO APPROXIMATE THE REGULAR 320
ACRE UNITS FOR THE MESAVERDE POOLS
UNDERLYING THE ABOVE DESCRIBED AREA
IN SAN JUAN COUNTY, NEW MEXICO

ORDER OF THE COMMISSION

BY THE COMMISSION:

This cause came on for hearing at Santa Fe, New Mexico, on 20 February 1951 at 10:00 a.m. After hearing testimony, the case was taken under advisement.

NOW, on this 21 day of March 1951, having duly considered the evidence, the Commission finds:

1. That it has jurisdiction of this cause, due notice having been given of the hearing.
2. Sections 6, 7, 18, 19, 30, and 31 of Township 29 North, Range 8 West are less than normal in size, each containing approximately 549 acres. In order to provide a uniform drilling pattern, special drilling units should be established in said sections as to all wells now drilling or hereafter drilled to the Mesaverde gas horizon.
3. In order to prevent waste and protect correlative rights, it is necessary that all lands within each drilling unit be pooled as to production of gas from the Mesaverde gas horizon.

IT IS THEREFORE ORDERED:

1. The following lands shall constitute drilling units for production from the Mesaverde gas horizon:

Unit No. 1 W/2 sec. 6; NW/4 sec. 7, T. 29 N, R. 8 W

Unit No. 2 SW/4 sec. 7; W/2 sec. 18, T. 29 N, R. 8 W

~~Unit No. 3 W/2 sec. 19; NW/4 sec. 30, T. 29 N, R. 8 W~~

Unit No. 4 SW/4 sec. 30; W/2 sec. 31, T. 29 N, R. 8 W

2. All lands within each of the above drilling units are hereby pooled as to production from the Mesaverde gas horizon. Only one well shall be drilled on each drilling unit.

3. Wells shall be located not closer than 660 feet from the outer boundary of any drilling unit.

4. Wells drilled in the east halves of said sections shall be located in the northeast quarter of said section and not closer than 660 feet to the outer boundaries of said quarter sections.

5. In the event gas proration orders are later issued for said wells, each of Units 1, 2, 3, and 4, as defined above, shall be given an allowable equal to that of a 320-acre tract.

DONE at Santa Fe, New Mexico, on this 21 day of March 1951.

STATE OF NEW MEXICO
OIL CONSERVATION COMMISSION

BEFORE THE OIL CONSERVATION COMMISSION
OF THE STATE OF NEW MEXICO

IN THE MATTER OF THE HEARING CALLED
BY THE OIL CONSERVATION COMMISSION OF
THE STATE OF NEW MEXICO FOR THE PURPOSE
OF CONSIDERING:

CASE NO. 300
ORDER NO. R-120

THE APPLICATION OF DELHI OIL
CORPORATION FOR AN ORDER AUTHORIZING
COMMUNITIZATION OF CERTAIN EXTREME
WESTERN QUARTER SECTIONS OF SECTIONS
6, 7, 18, 19, 30, AND 31 OF TOWNSHIPS 29 AND
30 NORTH, RANGE 8 WEST, NMPM, SAN JUAN
COUNTY, NEW MEXICO, FOR THE ESTABLISHMENT
OF EIGHT DRILLING UNITS THEREIN.

ORDER OF THE COMMISSION

BY THE COMMISSION:

This cause came on for hearing at 10 a. m. on August 21, 1951, at Santa Fe, New Mexico, before the Oil Conservation Commission of New Mexico, hereinafter referred to as the "Commission."

NOW, this 8th day of January, 1952, the Commission, having considered the testimony adduced and exhibits received at said hearing,

FINDS: (1) That due public notice having been given as required by law, the Commission has jurisdiction of this cause, and the subject matter thereof.

(2) That Sections 6, 7, 18, 19, 30, and 31 of Townships 29 and 30 North, Range 8 West, NMPM, San Juan County, New Mexico, are less than normal size, each containing approximately 549 acres. In order to provide a uniform drilling pattern, special drilling units should be established in said sections as to all wells now drilling or hereafter drilled to the Mesaverde gas horizon.

(3) That the Commission, by its Orders R-35 and R-60, heretofore issued, approved communitization of portions of Sections within the area which is the subject matter of this case.

(4) That pooling of all lands within each drilling unit as to production of gas from the Mesaverde gas horizon will prevent waste, avoid unnecessary drilling, and protect correlative rights.

Case No. 300
Order No. R-120

IT IS THEREFORE ORDERED:

(1) The following lands shall constitute drilling units for production from the Mesa-verde gas horizon:

Unit No. 1: W/2 Sec. 6 and NW/4 Sec. 7, T. 30N, R. 8 W

Unit No. 2: SW/4 Sec. 7 and W/2 Sec. 18, T. 30N, R. 8 W

Unit No. 3: ~~W/2 Sec. 19 and NW/4 Sec. 30, T. 30N, R. 8 W~~

Unit No. 4: SW/4 Sec. 30 and W/2 Sec. 31, T. 30N, R. 8 W

(2) All lands within each of the above drilling units are hereby pooled as to production from the Mesaverde gas horizon. Only one well shall be drilled on each drilling unit.

(3) Wells shall be located not closer than 660 feet from the outer boundary of any drilling unit.

(4) Wells drilled in the east halves of said sections shall be located in the northeast quarter of said section and not closer than 660 feet to the outer boundaries of said quarter section.

(5) In the event gas proration orders are later issued for said wells, each, of Units 1, 2, 3 and 4, as defined above, shall be given an allowable equal to that of a 320-acre tract.

DONE at Santa Fe, New Mexico, on the day and year hereinabove designated.

STATE OF NEW MEXICO
OIL CONSERVATION COMMISSION

/s/ EDWIN L. MECHEM, CHAIRMAN

/s/ GUY SHEPARD, MEMBER

/s/ R. R. SPURRIER, SECRETARY

S E A L

BEFORE THE OIL CONSERVATION COMMISSION
OF THE STATE OF NEW MEXICO

IN THE MATTER OF THE HEARING
CALLED BY THE OIL CONSERVATION
COMMISSION OF NEW MEXICO FOR
THE PURPOSE OF CONSIDERING:

CASE NO. 606
Order No. R-392

THE APPLICATION OF EL PASO NATURAL
GAS COMPANY FOR AN ORDER PERMITTING
THE COMMUNITIZATION ON A NORTH-SOUTH
BASIS OF THE NARROW SECTIONS LOCATED
ON THE WEST SIDE OF TOWNSHIP 31 NORTH,
RANGE 8 WEST, NMPM, SUCH UNITS TO
APPROXIMATE THE REGULAR 320-ACRE UNITS
FOR THE BLANCO-MESAVERDE POOL UNDER-
LYING THE ABOVE DESCRIBED AREA IN SAN
JUAN COUNTY, NEW MEXICO.

ORDER OF THE COMMISSION

BY THE COMMISSION:

This cause came on for hearing at 9 o'clock a.m. November 19, 1953, at Santa Fe, New Mexico, before the Oil Conservation Commission, hereinafter referred to as the "Commission."

NOW, on this 24th day of November, 1953, the Commission, a quorum being present, having considered the application and the testimony adduced at the hearing, and being fully advised in the premises,

FINDS:

(1) That due public notice having been given as required by law, the Commission has jurisdiction of this cause.

(2) That Sections 6, 7, 18, 19, 30 and 31 of Township 31 North, Range 8 West, are less than normal in size, each containing approximately 540 acres. In order to provide a uniform drilling pattern, special drilling units should be established in said sections as to all wells now drilling or hereafter drilled to the Mesaverde gas horizon.

(3) That in order to prevent waste and protect correlative rights, it is necessary that all lands within each drilling unit be pooled as to production of gas from the Mesaverde gas horizon.

IT IS THEREFORE ORDERED:

1. The following lands shall constitute drilling units for production from the Mesaverde gas horizon:

OIL CONSERVATION COMMISSION

P. O. BOX 871

SANTA FE, NEW MEXICO

April 20, 1960

Delhi-Taylor Oil Corporation
Corrigan Tower
Dallas 1, Texas

ATTENTION: Mr. Tyson Cleary

Administrative Order MMU-352

Gentlemen:

Reference is made to your application for approval of a 342.54-acre non-standard gas proration unit in the Blanco-Messverde Gas Pool consisting of the following acreage, which unit has increased in size due to a 1959 Dependent Resurvey from 337.30 acres to 342.54 acres.

TOWNSHIP 10 NORTH, RANGE 2 WEST, NDMN

Section 19: E/2 W/2 and lots 1, 2, 3, and 4

Section 20: E/2 NW/4 and lots 1 and 2

It is understood that this unit is to be dedicated to your Archuleta Well No. 1, located 1000 feet from the south line and 1000 feet from the West line of said Section 19.

You are hereby authorized to operate the above described acreage as a non-standard gas proration unit, with allowable to be assigned thereto in accordance with the pool rules, based upon the unit size of 342.54 acres.

Very truly yours,

A. L. PORTER, Jr.,
Secretary-Director

ALP/JER/og

cc: Oil Conservation Commission - Astec

Mr. Fred Mares - Santa Fe, N. Mex.

OIL CONSERVATION COMMISSION
P. O. BOX 2088
SANTA FE, NEW MEXICO 87501

March 28, 1977

COPY
Tenneco Oil Company
Lincoln Tower Building
Suite 1200
Denver, Colorado 80203

Attention: D. D. Myers

Administrative Order NSL-830

Gentlemen:

Reference is made to your application for approval of a non-standard location for your Archuleta Well No. 1-A, located 1975 feet from the North line and 1745 feet from the West line of Section 19, Township 30 North, Range 8 West, NNPM, San Juan County, New Mexico.

By authority granted me under the provisions of Rule 104 F of the Commission Rules and Regulations, the above-described unorthodox location is hereby approved.

Very truly yours,

JOE D. RAMEY,
Secretary-Director

JDR/JEK/dr

cc: Oil Conservation Commission - Aztec
Oil & Gas Engineering Committee - Hobbs

OIL CONSERVATION COMMISSION
P. O. BOX 2088
SANTA FE, NEW MEXICO 87501

June 13, 1977

COPY
Tenneco Oil Company
Suite 1200
Lincoln Tower Building
Denver, Colorado 80203

Attention: D. D. Myers

Amendment
Administrative Order NSL-830

Gentlemen:

Reference is made to your application for approval of a non-standard location for your Archuleta Well No. 1-A, located 2134 feet from the North line and 1641 feet from the West line of Section 19, Township 30 North, Range 8 West, NNPM, San Juan County, New Mexico.

By authority granted me under the provisions of Rule 104 F of the Commission Rules and Regulations, the above-described unorthodox location is hereby approved.

Very truly yours,

JOE D. RAMEY
Secretary-Director

JDR/JEK/jr

cc: Oil Conservation Commission - Aztec
Oil & Gas Engineering Committee - Hobbs

BEFORE THE OIL CONSERVATION COMMISSION
OF THE STATE OF NEW MEXICO

IN THE MATTER OF THE HEARING CALLED BY THE OIL CONSERVATION COMMISSION UPON ITS OWN MOTION TO CONSIDER THE ESTABLISHMENT OF NON-STANDARD GAS PRORATION UNITS AND UNORTHODOX GAS WELL LOCATIONS, WHERE NECESSARY, IN THE AZTEC AND BLANCO-PICTURED CLIFFS GAS POOLS IN SECTIONS 6, 7, 18, 19, 30, AND 31, TOWNSHIPS 29 AND 30 NORTH, RANGES 8 AND 9 WEST, NMPM, SAN JUAN COUNTY, NEW MEXICO.

CASE No. 4032
Order No. R-3669

ORDER OF THE COMMISSION

BY THE COMMISSION:

This cause came on for hearing at 9 a.m. on January 22, 1969, at Santa Fe, New Mexico, before Examiner Elvis A. Utz.

NOW, on this 30th day of January, 1969, the Commission, a quorum being present, having considered the testimony, the record, and the recommendations of the Examiner, and being fully advised in the premises,

FINDS:

(1) That due public notice having been given as required by law, the Commission has jurisdiction of this cause and the subject matter thereof.

(2) That due to variations in legal subdivisions of the U. S. Public Land Surveys along the west sides of Township 29 North, Range 8 West, Township 29 North, Range 9 West, Township 30 North, Range 8 West, and Township 30 North, Range 9 West, NMPM, San Juan County, New Mexico, the west halves of Sections 6, 7, 18, 19, 30, and 31 in each of said townships are irregular in size.

(3) That said irregularity in size precludes the establishment of standard 160-acre drilling and proration units.

(4) That said irregularity in size precludes the drilling of wells at locations prescribed for standard 160-acre units.

(5) That the principal gas producing formation in the area is the Pictured Cliffs.

(6) That a standard gas proration unit in the Pictured Cliffs formation in the area of the subject sections is 160 acres.

(7) That the principal gas producing pools in the subject area are the Aztec-Pictured Cliffs Gas Pool and the Blanco-Pictured Cliffs Gas Pool.

(8) That the applicable rules provide that gas wells in the Aztec-Pictured Cliffs and Blanco-Pictured Cliffs Gas Pools be located not closer than 790 feet to any outer boundary of the tract nor closer than 130 feet to any quarter-quarter section line or subdivision inner boundary.

(9) That in order to ensure systematic development and thereby prevent waste and protect correlative rights, non-standard gas proration units approximating 160 acres each should be established for the Pictured Cliffs formation along the west side of the subject sections.

(10) That gas wells drilled on said units should be located not closer than 500 feet to any outer boundary of the tract nor closer than 130 feet to any quarter-quarter section line or subdivision inner boundary.

(11) That Administrative Order No. NWU 3-75, dated March 18, 1968, approved a non-standard gas proration unit in the Blanco-Pictured Cliffs Gas Pool comprising the W/2 of Section 31, Township 30 North, Range 8 West, NMPM, San Juan County, New Mexico.

(12) That Administrative Order No. NWU 3-75 should be superseded by this order.

IT IS THEREFORE ORDERED:

(1) That the following-described non-standard gas spacing and proration units in the Pictured Cliffs formation, San Juan County, New Mexico, are hereby established:

-3-

CASE No. 4032

Order No. R-3669

TOWNSHIP 29 NORTH, RANGE 8 WEST, NMPM

<u>Unit</u>	<u>Acres</u>	<u>Description</u>
1	131.24	Section 6: Lots 8, 9, 10, 11, and 12
2	159.99	Section 6: Lots 14 and 15 Section 7: Lots 5, 6, 7, and 8
3	168.01	Section 7: Lots 9, 10, 11, and 12 Section 18: Lot 1 and NE/4 NW/4
4	173.87	Section 18: Lots 2, 3, 4, SE/4 NW/4, and E/2 SW/4
5	173.85	Section 19: Lots 1, 2, 3, E/2 NW/4, and NE/4 SW/4
6	173.75	Section 19: Lot 4 and SE/4 SW/4 Section 30: Lots 1, 2, and E/2 NW/4

TOWNSHIP 29 NORTH, RANGE 9 WEST, NMPM

<u>Unit</u>	<u>Acres</u>	<u>Description</u>
1	172.00	Section 6: Lots 8, 9, 10, 11, 12, 13, and 14
2	171.16	Section 6: SE/4 SW/4 Section 7: Lots 5, 6, 7, 9, and E/2 NW/4
3	177.18	Section 7: Lot 8 and SE/4 SW/4 Section 18: Lot 1 and E/2 NW/4
4	169.34	Section 18: Lots 2, 3, 4, and E/2 SW/4 Section 19: Lot 1 and NE/4 NW/4
5	166.18	Section 19: Lots 6, 9, 4, SE/4 NW/4, and E/2 SW/4 Section 30: Lot 1
6	187.16	Section 30: Lots 6, 10, 11, 12, 13, and E/2 NW/4

TOWNSHIP 30 NORTH, RANGE 8 WEST, NMPM

<u>Unit</u>	<u>Acres</u>	<u>Description</u>
1	164.28	Section 6: Lots 3, 4, 5, 6, SE/4 NW/4, and NE/4 SW/4
2	166.72	Section 6: Lot 7 and SE/4 SW/4 Section 7: Lots 1, 2, and E/2 NW/4
3	167.32	Section 7: Lots 3, 4, and E/2 SW/4 Section 18: Lot 1 and NE/4 NW/4
4	167.62	Section 18: Lots 2, 3, 4, SE/4 NW/4, and E/2 SW/4
5	169.64	Section 19: Lots 1, 2, 8, E/2 NW/4, and NE/4 SW/4
6	172.90	Section 19: Lot 9 and SE/4 SW/4 Section 30: Lots 6, 2, and E/2 NW/4
7	154.19	Section 30: Lots 3, 10, 11, and NE/4 SW/4 Section 31: Lots 7 and 8
8	128.31	Section 31: Lots 9, 10, 15, 16, 17, and 18

TOWNSHIP 30 NORTH, RANGE 9 WEST, NMPM

<u>Unit</u>	<u>Acres</u>	<u>Description</u>
1	148.69	Section 6: Lots 4, 5, 6, E/2 NW/4, and NE/4 SW/4
2	151.16	Section 6: Lot 7 and SE/4 SW/4 Section 7: Lots 1, 2, and E/2 NW/4
3	150.94	Section 7: Lots 3, 4, and E/2 SW/4 Section 18: Lot 1 and NE/4 NW/4
4	153.45	Section 18: Lots 2, 3, 4, SE/4 NW/4, and E/2 SW/4

-5-

CASE No. 4032

Order No. R-3669

TOWNSHIP 30 NORTH, RANGE 9 WEST, NMPM
(Continued from Page 4)

<u>Unit</u>	<u>Acres</u>	<u>Description</u>
5	155.16	Section 19: Lots 1, 2, 3, E/2 NW/4, and NE/4 SW/4
6	152.48	Section 31: Lots 2, 3, 4, SE/4 NW/4, and E/2 SW/4

(2) That each well drilled to or completed in the Pictured Cliffs formation on one of the above-described units shall be located not closer than 500 feet to any outer boundary of such unit nor closer than 130 feet to any quarter-quarter section line or subdivision inner boundary.

(3) That Administrative Order No. NWU 3-75 is hereby superseded.

(4) That jurisdiction of this cause is retained for the entry of such further orders as the Commission may deem necessary.

DONE at Santa Fe, New Mexico, on the day and year hereinabove designated.

STATE OF NEW MEXICO
OIL CONSERVATION COMMISSION

DAVID F. CARGO, Chairman

ALEX J. ARMIJO, Member

A. L. PORTER, Jr., Member & Secretary

S E A L

esr/

CMD :
OG6IWCM

ONGARD
INQUIRE WELL COMPLETIONS

02/03/04 10:52:36
OGOMES -TQAS

API Well No : 30 45 9279 Eff Date : 04-30-1991 WC Status : A
Pool Idn : 72319 BLANCO-MESAVERDE (PRORATED GAS)
OGRID Idn : 778 BP AMERICA PRODUCTION COMPANY
Prop Idn : 268 ARCHULETA

Well No : 001
GL Elevation: 5712

	U/L	Sec	Township	Range	North/South	East/West	Prop/Act (P/A)
	---	---	-----	-----	-----	-----	-----
B.H. Locn : N	19	30N	08W	FTG 1000 F S	FTG 1080 F W	P	

Lot Identifier:
Dedicated Acre: 342.54
Lease Type : P
Type of consolidation (Comm, Unit, Forced Pooling - C/U/F/O) :

M0025: Enter PF keys to scroll

PF01 HELP	PF02	PF03 EXIT	PF04 GoTo	PF05	PF06
PF07	PF08	PF09	PF10 NEXT-WC	PF11 HISTORY	PF12 NXTREC

CMD : ONGARD 02/03/04 10:52:43
 OG6ACRE C102-DEDICATE ACREAGE OGOMES -TQAS
 Page No : 1

API Well No : 30 45 9279 Eff Date : 06-23-1995
 Pool Idn : 72319 BLANCO-MESAVERDE (PRORATED GAS)
 Prop Idn : 268 ARCHULETA Well No : 001
 Spacing Unit : 48156 OCD Order : Simultaneous Dedication:
 Sect/Twp/Rng : 19 30N 08W Acreage : 342.54 Revised C102? (Y/N) :
 Dedicated Land:

S	Base	U/L	Sec	Twp	Rng	Acreage	L/W	Ownership	Lot	Idn
	C		19	30N	08W	40.00	N	FD		
	F		19	30N	08W	40.00	N	FD		
	K		19	30N	08W	40.00	N	FE		
	N		19	30N	08W	40.00	N	FE		
D	1		19	30N	08W	15.98	N	FD		
E	2		19	30N	08W	16.10	N	FD		
L	8		19	30N	08W	17.56	N	FD		
M	9		19	30N	08W	18.42	N	FD		
	C		30	30N	08W	40.00	N	FE		

E0005: Enter data to modify or PF keys to scroll

PF01 HELP PF02 PF03 EXIT PF04 GoTo PF05 PF06 CONFIRM
 PF07 BKWD PF08 FWD PF09 PF10 LAND PF11 NXTSEC PF12 RECONF

CMD : ONGARD 02/03/04 10:52:51
OG6IPRD INQUIRE PRODUCTION BY POOL/WELL OGOMES -TQAS
Page No: 1

OGRID Identifier : 778 BP AMERICA PRODUCTION COMPANY
Pool Identifier : 72319 BLANCO-MESAVERDE (PRORATED GAS)
API Well No : 30 45 9279 Report Period - From : 01 2003 To : 12 2003

API Well No	Property Name	Prod.	Days	Production Volumes	Well		
		MM/YY	Prod	Gas	Oil	Water	Stat
30 45 9279	ARCHULETA	01 03	31	3996	5	45	P
30 45 9279	ARCHULETA	02 03	28	3321	2		F
30 45 9279	ARCHULETA	03 03	31	3551	2		F
30 45 9279	ARCHULETA	04 03	31	3424	3		P
30 45 9279	ARCHULETA	05 03	31	3370	1		P
30 45 9279	ARCHULETA	06 03	31	4184	4	60	P
30 45 9279	ARCHULETA	07 03	31	4521	2		P

Reporting Period Total (Gas, Oil) :

M0025: Enter PF keys to scroll

PF01 HELP PF02 PF03 EXIT PF04 GoTo PF05 PF06 CONFIRM
PF07 BKWD PF08 FWD PF09 PF10 NXTPPOOL PF11 NXTOGD PF12

CMD : ONGARD 02/03/04 10:52:53
 OG6IPRD INQUIRE PRODUCTION BY POOL/WELL OGOMES -TQAS
 Page No: 2

OGRID Identifier : 778 BP AMERICA PRODUCTION COMPANY
 Pool Identifier : 72319 BLANCO-MESAVERDE (PRORATED GAS)
 API Well No : 30 45 9279 Report Period - From : 01 2003 To : 12 2003

API Well No	Property Name	Prodn. Days MM/YY Prod	Production Volumes Gas Oil Water	Well Stat
30 45 9279	ARCHULETA	08 03 31	4580	P
30 45 9279	ARCHULETA	09 03 31	3825 1 204	P
30 45 9279	ARCHULETA	10 03 31	4555 6	P
30 45 9279	ARCHULETA	11 03 30	4552 1	P

Reporting Period Total (Gas, Oil) : 43879 27 309

E0049: User may continue scrolling.

PF01 HELP PF02 PF03 EXIT PF04 GoTo PF05 PF06 CONFIRM
 PF07 BKWD PF08 FWD PF09 PF10 NXTPOOL PF11 NXTOGD PF12

CMD :
OG6IWCM

ONGARD
INQUIRE WELL COMPLETIONS

02/03/04 10:52:09
OGOMES -TQAS

API Well No : 30 45 22567 Eff Date : 04-30-1991 WC Status : A
Pool Idn : 72319 BLANCO-MESAVERDE (PRORATED GAS)
OGRID Idn : 778 BP AMERICA PRODUCTION COMPANY
Prop Idn : 268 ARCHULETA

Well No : 001A
GL Elevation: 5747

	U/L	Sec	Township	Range	North/South	East/West	Prop/Act (P/A)
	---	---	-----	-----	-----	-----	-----
B.H. Locn : F	19	30N	08W	FTG 2134	F N	FTG 1640	F W P

Lot Identifier:
Dedicated Acre: 342.54
Lease Type : F
Type of consolidation (Comm, Unit, Forced Pooling - C/U/F/O) :

E6317: No more recs. for this api well no.

PF01 HELP	PF02	PF03 EXIT	PF04 GoTo	PF05	PF06
PF07	PF08	PF09	PF10 NEXT-WC	PF11 HISTORY	PF12 NXTREC

CMD : ONGARD 02/03/04 10:52:13
 OG6ACRE C102-DEDICATE ACREAGE OGOMES -TQAS
 Page No : 1

API Well No : 30 45 22567 Eff Date : 06-23-1995
 Pool Idn : 72319 BLANCO-MESAVERDE (PRORATED GAS)
 Prop Idn : 268 ARCHULETA Well No : 001A
 Spacing Unit : 48156 OCD Order : Simultaneous Dedication:
 Sect/Twp/Rng : 19 30N 08W Acreage : 342.54 Revised C102? (Y/N) :
 Dedicated Land:

S	Base	U/L	Sec	Twp	Rng	Acreage	L/W	Ownership	Lot	Idn
	C		19	30N	08W	40.00	N	FD		
	F		19	30N	08W	40.00	N	FD		
	K		19	30N	08W	40.00	N	FE		
	N		19	30N	08W	40.00	N	FE		
	D	1	19	30N	08W	15.98	N	FD		
	E	2	19	30N	08W	16.10	N	FD		
	L	8	19	30N	08W	17.56	N	FD		
	M	9	19	30N	08W	18.42	N	FD		
	C		30	30N	08W	40.00	N	FE		

E0005: Enter data to modify or PF keys to scroll

PF01 HELP PF02 PF03 EXIT PF04 GoTo PF05 PF06 CONFIRM
 PF07 BKWD PF08 FWD PF09 PF10 LAND PF11 NXTSEC PF12 RECONF

CMD : ONGARD 02/03/04 10:52:21
 OG6IPRD INQUIRE PRODUCTION BY POOL/WELL OGOMES -TQAS
 Page No: 1

OGRID Identifier : 778 BP AMERICA PRODUCTION COMPANY
 Pool Identifier : 72319 BLANCO-MESAVERDE (PRORATED GAS)
 API Well No : 30 45 22567 Report Period - From : 01 2003 To : 12 2003

API Well No	Property Name	Prodn. Days MM/YY Prod	Production Volumes Gas Oil Water	Well Stat
30 45 22567	ARCHULETA	01 03 23	4275 40 35	P
30 45 22567	ARCHULETA	02 03 28	6699	F
30 45 22567	ARCHULETA	03 03 31	6299 48 80	F
30 45 22567	ARCHULETA	04 03 31	6755 1 85	P
30 45 22567	ARCHULETA	05 03 31	5949	P
30 45 22567	ARCHULETA	06 03 31	6432 25 40	P
30 45 22567	ARCHULETA	07 03 31	6612 8	P

Reporting Period Total (Gas, Oil) :

M0025: Enter PF keys to scroll

PF01 HELP PF02 PF03 EXIT PF04 GoTo PF05 PF06 CONFIRM
 PF07 BKWD PF08 FWD PF09 PF10 NXTPOOL PF11 NXTOGD PF12

CMD : ONGARD 02/03/04 10:52:24
 OG6IPRD INQUIRE PRODUCTION BY POOL/WELL OGOMES -TQAS
 Page No: 2

OGRID Identifier : 778 BP AMERICA PRODUCTION COMPANY
 Pool Identifier : 72319 BLANCO-MESAVERDE (PRORATED GAS)
 API Well No : 30 45 22567 Report Period - From : 01 2003 To : 12 2003

API Well No	Property Name	Prodn. Days MM/YY Prod	Production Volumes Gas Oil Water	Well Stat
30 45 22567	ARCHULETA	08 03 31	6968 7	P
30 45 22567	ARCHULETA	09 03 31	6114 3 80	P
30 45 22567	ARCHULETA	10 03 31	7070 1	P
30 45 22567	ARCHULETA	11 03 30	5907 4	P

Reporting Period Total (Gas, Oil) : 69080 137 320

E0049: User may continue scrolling.

PF01 HELP PF02 PF03 EXIT PF04 GoTo PF05 PF06 CONFIRM
 PF07 BKWD PF08 FWD PF09 PF10 NXTPOOL PF11 NXTOGD PF12

CMD :
OG6IWCM

ONGARD
INQUIRE WELL COMPLETIONS

02/03/04 10:55:47
OGOMES -TQAS

API Well No : 30 45 29261 Eff Date : 08-16-1996 WC Status : A
Pool Idn : 72319 BLANCO-MESAVERDE (PRORATED GAS)
OGRID Idn : 778 BP AMERICA PRODUCTION COMPANY
Prop Idn : 268 ARCHULETA

Well No : 001B
GL Elevation: 5651

	U/L	Sec	Township	Range	North/South	East/West	Prop/Act (P/A)
	---	---	-----	-----	-----	-----	-----
B.H. Locn : C	30	30N	08W	FTG	980 F N	FTG 1230 F W	P

Lot Identifier:
Dedicated Acre: 342.54
Lease Type : P
Type of consolidation (Comm, Unit, Forced Pooling - C/U/F/O) :

E6317: No more recs. for this api well no.

PF01 HELP	PF02	PF03 EXIT	PF04 GoTo	PF05	PF06
PF07	PF08	PF09	PF10 NEXT-WC	PF11 HISTORY	PF12 NXTREC

CMD : ONGARD 02/03/04 10:55:51
 OG6ACRE C102-DEDICATE ACREAGE OGOMES -TQAS
 Page No : 1

API Well No : 30 45 29261 Eff Date : 06-23-1995
 Pool Idn : 72319 BLANCO-MESAVERDE (PRORATED GAS)
 Prop Idn : 268 ARCHULETA Well No : 001B
 Spacing Unit : 48156 OCD Order : Simultaneous Dedication:
 Sect/Twp/Rng : 30 30N 08W Acreage : 342.54 Revised C102? (Y/N) :
 Dedicated Land:

S	Base	U/L	Sec	Twp	Rng	Acreage	L/W	Ownership	Lot	Idn
	C		19	30N	08W	40.00	N	FD		
	F		19	30N	08W	40.00	N	FD		
	K		19	30N	08W	40.00	N	FE		
	N		19	30N	08W	40.00	N	FE		
D		1	19	30N	08W	15.98	N	FD		
E		2	19	30N	08W	16.10	N	FD		
L		8	19	30N	08W	17.56	N	FD		
M		9	19	30N	08W	18.42	N	FD		
	C		30	30N	08W	40.00	N	FE		

E0005: Enter data to modify or PF keys to scroll

PF01 HELP PF02 PF03 EXIT PF04 GoTo PF05 PF06 CONFIRM
 PF07 BKWD PF08 FWD PF09 PF10 LAND PF11 NXTSEC PF12 RECONF

CMD : ONGARD 02/03/04 10:55:59
 OG6IPRD INQUIRE PRODUCTION BY POOL/WELL OGOMES -TQAS
 Page No: 1

OGRID Identifier : 778 BP AMERICA PRODUCTION COMPANY
 Pool Identifier : 72319 BLANCO-MESAVERDE (PRORATED GAS)
 API Well No : 30 45 29261 Report Period - From : 01 2003 To : 12 2003

API Well No	Property Name	Prodn. Days MM/YY Prod	Production Volumes Gas Oil Water	Well Stat
30 45 29261	ARCHULETA	01 03 31	4882	P
30 45 29261	ARCHULETA	02 03 28	5231	F
30 45 29261	ARCHULETA	03 03 31	5218	F
30 45 29261	ARCHULETA	04 03 31	4304	F
30 45 29261	ARCHULETA	05 03 31	4349	F
30 45 29261	ARCHULETA	06 03 31	4296	F
30 45 29261	ARCHULETA	07 03 31	5292	F

Reporting Period Total (Gas, Oil) :

M0025: Enter PF keys to scroll

PF01 HELP PF02 PF03 EXIT PF04 GoTo PF05 PF06 CONFIRM
 PF07 BKWD PF08 FWD PF09 PF10 NXTPOOL PF11 NXTOGD PF12

CMD : ONGARD 02/03/04 10:56:02
 OG6IPRD INQUIRE PRODUCTION BY POOL/WELL OGOMES -TQAS
 Page No: 2

OGRID Identifier : 778 BP AMERICA PRODUCTION COMPANY
 Pool Identifier : 72319 BLANCO-MESAVERDE (PRORATED GAS)
 API Well No : 30 45 29261 Report Period - From : 01 2003 To : 12 2003

API Well No	Property Name	Prodn. Days MM/YY Prod	Production Volumes Gas Oil Water	Well Stat
30 45 29261	ARCHULETA	08 03 31	5072	F
30 45 29261	ARCHULETA	09 03 31	4692	F
30 45 29261	ARCHULETA	10 03 31	4894	F
30 45 29261	ARCHULETA	11 03 30	4448	F

Reporting Period Total (Gas, Oil) : 52678

E0049: User may continue scrolling.

PF01 HELP PF02 PF03 EXIT PF04 GoTo PF05 PF06 CONFIRM
 PF07 BKWD PF08 FWD PF09 PF10 NXTPOOL PF11 NXTOGD PF12