

Energy Producing Company
Exploration and Production

facsimile transmittal

To: Am State Attn: David Catanaach

From: Kim Stewart Date: 1-28-02

Re: Anasconda & Pages:

Putman Battery

☐ Urgent

☒ For Review

☐ Please Comment

☐ Please Reply

Confidentiality Note: The information contained in this facsimile message is legally privileged and confidential information intended for the use of the individual or entity named above. If the reader of this message is not the intended recipient, you are hereby notified that any dissemination, distribution or copy of this transmittal is strictly prohibited. If you have received this telecopy in error, please notify us by telephone immediately. THANK YOU!

3300 N. "A" Street, Bldg. 2, Ste. 120; Midland, TX, 79705, USA
Tel (011) 916 686 8236 Fax (011) 916 686 7806

Nearburg Producing Company

Exploration and Production
3300 North "A" Street
Building 2, Suite 120
Midland, Texas 79705
915/686-8235
Fax 915/686-7806

ATTACHMENT IV

June 21, 2001

CERTIFIED MAIL – RETURN RECEIPT REQUESTED

TO: INTEREST OWNERS AND PURCHASER
(List Attached)

RE: Notification of Application of Nearburg Producing Company
for Administrative Approval for Lease Commingling for Off Lease Gas
Measurement and Sales Meter Allocation Purposes
Section 3 & 11, T20S, R33E, Lea County, New Mexico

Dear Interest Owner or Purchaser:

Nearburg Producing Company hereby notifies you that it is seeking approval to first meter and then commingle and off lease measure gas production from wells listed on Attachment I. The common sales meter is located in Section 11, T20S, R33E, Lea County, New Mexico. See Attachment II showing each well location and sales meter.

If you have objection to this request, then it is necessary for you to file a written objection within twenty (20) days of June 21, 2001, with Oil Conservation Division of the State of New Mexico and Bureau of Land Management. If you have no objection, then it is not necessary to do anything.

Please feel free to call if I can be of any assistance.

Very truly yours,

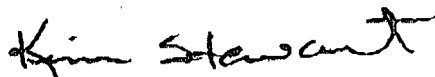

Kim Stewart
Regulatory Analyst

Encl.

ATTACHMENT IV (CON'T)

DISTRIBUTION LIST

Nearburg Producing Company
3300 North "A" Street
Building 2, Suite 120
Midland, TX 79705

Samson Resources Company
PO Box 94339
Tulsa, OK 74194

E.G.L. Resources, Inc.
PO Box 371
Midland, TX 79702

Sunoco Inc. (R&M)
901 South Detroit
Tulsa, OK 74102

Conoco, Inc.
10 Desta Drive, Suite 100W
Midland, TX 79705

ATTACHMENT I

Anaconda 11 Federal #1

Unit D, 660 FNL and 760 FWL, Section 11-20S-33E, Lea County, NM

Anaconda 11 Federal #2

Unit F

1650 FNL and 1650 FWL, Section 11-20S-33E, Lea County, NM

Python 3 Federal #1

Unit J

1900 FSL and 1650 FEL, Section 3-20S-33E, Lea County, NM

Python 3 Federal #3

Unit H

SHL: 2200 FNL and 1330 FEL, Section 3-20S-33E, Lea County, NM

BHL: 2050 FNL and 1758 FEL, Section 3-20S-33E, Lea County, NM

Python 3 Federal #4

Unit H

SHL: 2310 FNL and 130 FEL, Section 3-20S-33E, Lea County, NM

BHL: 1685 FNL and 976 FEL, Section 3-20S-33E, Lea County, NM

Python 3 Federal #5D

Unit H, SHL: 2310 FNL and 330 FEL, Section 3-20S-33E, Lea County, NM

Unit B, BHL: 698 FNL and 1915 FEL, Section 3-20S-33E, Lea County, NM

Python 3 Federal #6

Unit K, SHL: 1980 FSL and 2510 FWL, Section 3-20S-33E, Lea County, NM

Unit F, BHL: 3632 FSL and 2210 FWL, Section 3-20S-33E, Lea County, NM

Python 3 Federal #7

Unit K, 1980 FSL and 2310 FWL, Section 3-20S-33E, Lea County, NM

SECTIONS 3, T-20-S, R-33-E, LEA COUNTY, NM

ATTACHMENT II

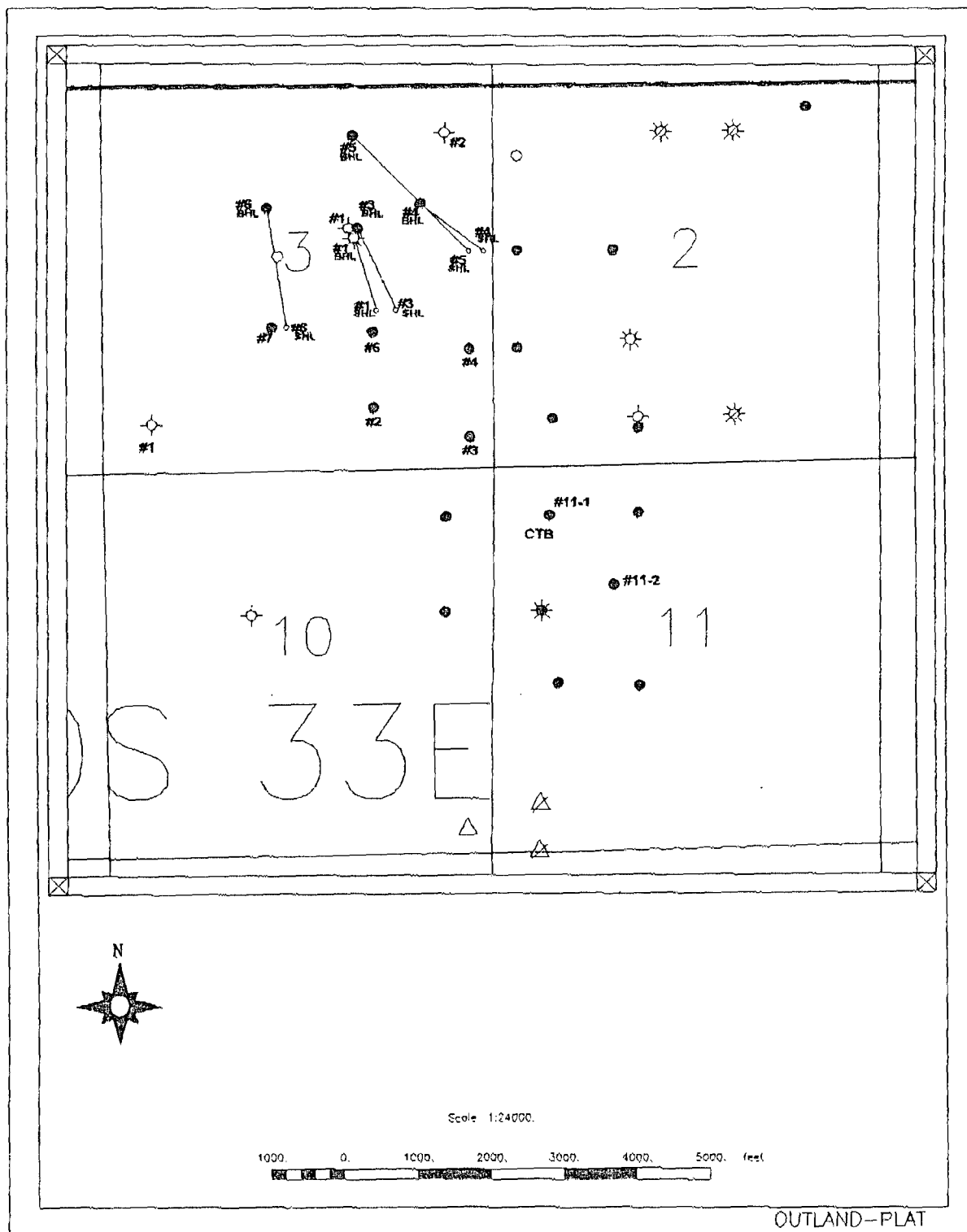

Nearburg Producing Company

Exploration and Production
3300 North "A" Street
Building 2, Suite 120
Midland, Texas 79705
915/686-8235
Fax 915/686-7806

ATTACHMENT IV

March 14, 2000

CERTIFIED MAIL – RETURN RECEIPT REQUESTED

TO: INTEREST OWNERS AND PURCHASER
(List Attached)

RE: Notification of Application of Nearburg Producing Company
for Administrative Approval for Lease Commingling
Section 3 & 11, T20S, R33E, NMPM, Lea County, New Mexico

Dear Interest Owner or Purchaser:

Nearburg Producing Company hereby notifies you that it is seeking approval to first meter and then commingle production from wells listed on Attachment I. The common tank battery for said well(s) is located Unit D, NW of Section 11, T20S, R33E, NMPM, Lea County, New Mexico.

If you have objection to this request, then it is necessary for you to file a written objection within twenty (20) days of March 14, 2000, with Bureau of Land Management (BLM) of New Mexico. If you have no objection, then it is not necessary to do anything.

Please feel free to call if I can be of any assistance.

Very truly yours,



Kim Stewart
Regulatory Analyst

Encl.

List of Interest Owners or Purchasers for the Anaconda & Python Leases

Nearburg Producing Company
3300 N. "A" Street, Building 2, Suite 120
Midland, TX 79705

Samson Resources Company
PO Box 94339
Tulsa, OK 74194

E.G.L. Resources, Inc.
PO Box 371
Midland, TX 79702

Sun Company Inc. (R&M)
907 South Detroit
Tulsa, OK 74012

Conoco, Inc.
10 Desta Drive, Suite 100W
Midland, TX 79705

ATTACHMENT I

***Anaconda 11 Federal #1**

Unit D

660' FNL and 760' FWL, Section 11, T20S, R33E, Lea County, New Mexico

Anaconda 11 Federal #2

Unit F

1,650' FNL and 1,650' FWL, Section 11, T20S, R33E, Lea County, New Mexico

***Python 3 Federal #1**

Unit J

1,900' FSL and 1,650' FEL, Section 3, T20S, R33E, Lea County, New Mexico

Python 3 Federal #2

Unit O

855' FSL and 1,650' FEL, Section 3, T20S, R33E, Lea County, New Mexico

Python 3 Federal #3

Unit H

2,310' FNL and 330' FEL, Section 3, T20S, R33E, Lea County, New Mexico

SECTIONS 3 & 11, T-20-S, R-33-E, LEA COUNTY, NM

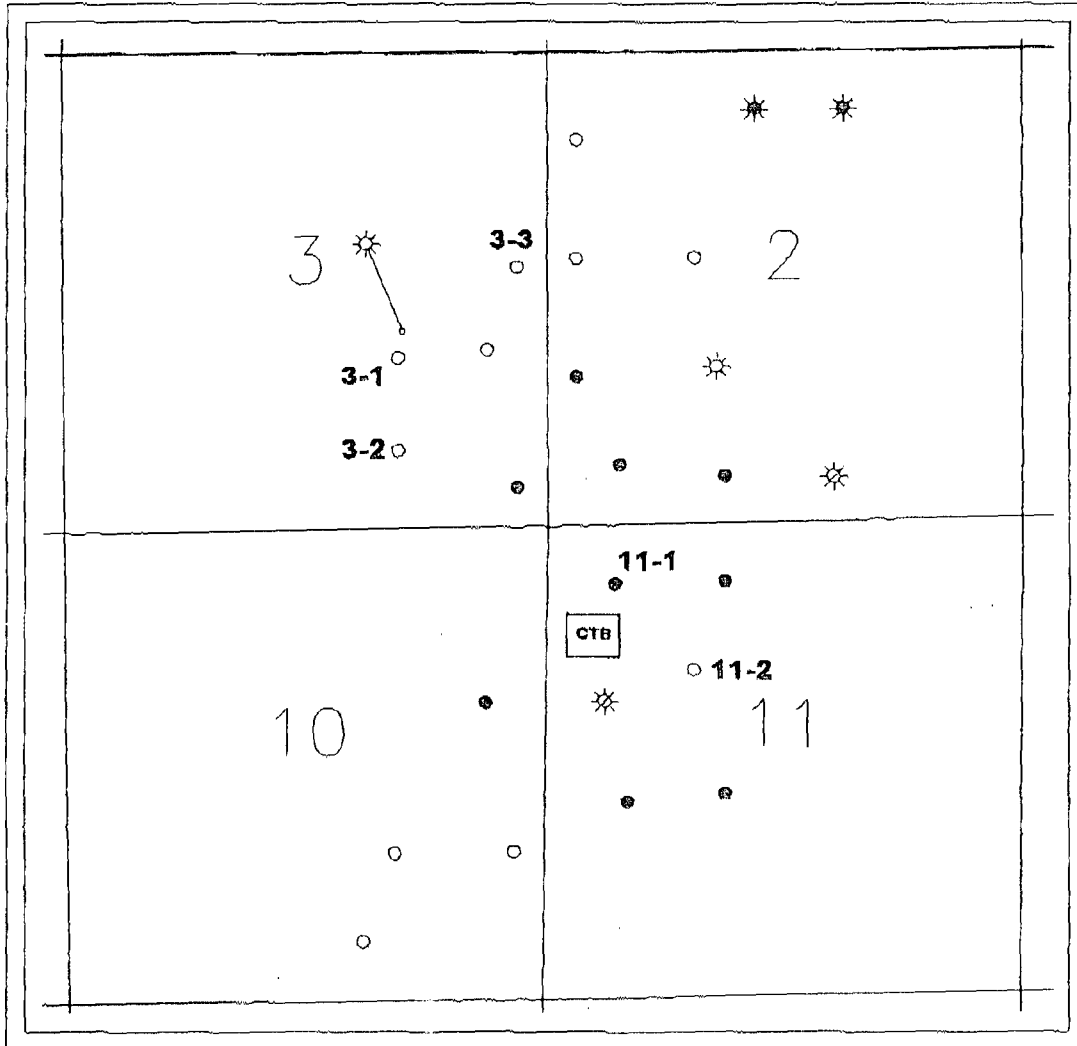
ATTACHMENT II

Pool

Range

NMPM

A 36x6 grid with numbers 1-36 in the top row and 6-36 in the bottom row. A 3x3 yellow square is at the top right, containing numbers 5, 6, 3, 4, 7, 1. A 2x2 pink square is at the top right, containing numbers 1, 2.

208

332