

DATE IN <u>10.12.10</u>	SUSPENSE	ENGINEER <u>RE.</u>	LOGGED IN <u>10.12.10</u>	TYPE <u>PC</u>	APP NO. <u>1028557782</u>
-------------------------	----------	---------------------	---------------------------	----------------	---------------------------

ABOVE THIS LINE FOR DIVISION USE ONLY

# NEW MEXICO OIL CONSERVATION DIVISION

- Engineering Bureau -

1220 South St. Francis Drive, Santa Fe, NM 87505



XTO Energy

Alice Bolack #13

## ADMINISTRATIVE APPLICATION CHECKLIST 30-045-06488

THIS CHECKLIST IS MANDATORY FOR ALL ADMINISTRATIVE APPLICATIONS FOR EXCEPTIONS TO DIVISION RULES AND REGULATIONS WHICH REQUIRE PROCESSING AT THE DIVISION LEVEL IN SANTA FE

### Application Acronyms:

**[NSL-Non-Standard Location]** **[NSP-Non-Standard Proration Unit]** **[SD-Simultaneous Dedication]**  
**[DHC-Downhole Commingling]** **[CTB-Lease Commingling]** **[PLC-Pool/Lease Commingling]**  
**[PC-Pool Commingling]** **[OLS - Off-Lease Storage]** **[OLM-Off-Lease Measurement]**  
**[WFX-Waterflood Expansion]** **[PMX-Pressure Maintenance Expansion]**  
**[SWD-Salt Water Disposal]** **[IPI-Injection Pressure Increase]**  
**[EOR-Qualified Enhanced Oil Recovery Certification]** **[PPR-Positive Production Response]**

### [1] TYPE OF APPLICATION - Check Those Which Apply for [A]

[A] Location - Spacing Unit - Simultaneous Dedication  
☐ NSL ☐ NSP ☐ SD

Check One Only for [B] or [C]

[B] Commingling - Storage - Measurement  
☐ DHC ☐ CTB ☐ PLC ☒ PC ☐ OLS ☐ OLM

[C] Injection - Disposal - Pressure Increase - Enhanced Oil Recovery  
☐ WFX ☐ PMX ☐ SWD ☐ IPI ☐ EOR ☐ PPR

[D] Other: Specify \_\_\_\_\_

### [2] NOTIFICATION REQUIRED TO: - Check Those Which Apply, or ☐ Does Not Apply

[A] ☒ Working, Royalty or Overriding Royalty Interest Owners

[B] ☐ Offset Operators, Leaseholders or Surface Owner

[C] ☐ Application is One Which Requires Published Legal Notice

[D] ☒ Notification and/or Concurrent Approval by BLM or SLO  
 U.S. Bureau of Land Management - Commissioner of Public Lands, State Land Office

[E] ☐ For all of the above, Proof of Notification or Publication is Attached, and/or,

[F] ☐ Waivers are Attached

### [3] SUBMIT ACCURATE AND COMPLETE INFORMATION REQUIRED TO PROCESS THE TYPE OF APPLICATION INDICATED ABOVE.

[4] **CERTIFICATION:** I hereby certify that the information submitted with this application for administrative approval is **accurate** and **complete** to the best of my knowledge. I also understand that **no action** will be taken on this application until the required information and notifications are submitted to the Division.

**Note:** Statement must be completed by an individual with managerial and/or supervisory capacity.

Jennifer Morrow  
 Print or Type Name

Jennifer Morrow  
 Signature

Senior Regulatory Compliance Technician  
 Title

October 8, 2010  
 Date

Jennifer.Morrow@xtoenergy.com  
 e-mail Address

PC-1229



RECEIVED OCT

2010 OCT 12 P 1: 2

October 8, 2010

Mr. Richard Ezeanyim  
New Mexico Oil Conservation Division  
1220 South Saint Francis Drive  
Santa Fe, New Mexico 87505

Subject: Proposed Surface Commingle  
Alice Bolack 13 and Bolack 15-1  
San Juan County, New Mexico

Dear Mr. Ezeanyim:

XTO Energy Inc. requests administrative approval for surface commingling of natural gas produced from the following wells, both on Lease Number NMSF-078872A: Alice Bolack 13 and Bolack 15-1. These wells are located in Section 15K-Township 27N-Range 11W in San Juan County, New Mexico.

XTO plans to produce the commingled gas through a central compressor, thus lowering operating expenses and extending the economic life of the wells. This also increases the ultimate recoveries on all leases. The anticipated allocated fuel production and fuel usage for the compressor is noted in the attachments.

Each well will be equipped with allocation meters that will be maintained by XTO Energy in accordance with State and Federal Regulations (Onshore Order No. 5). Produced liquids will not be surface commingled. All interest owners have been notified via certified mail, return receipt, on August 18, 2010.

The following attachments are included with this application:

- Form C107B (application for surface commingle; diverse ownership)
- Map of all wells and their associated leases
- Form C-102 for each well (plats)
- Table of well with lease and agreement information, spacing, permits, gravities/BTU, MCF
- Schematic diagram showing all flowlines, compressors & equipment
- Details of allocation formula
- Letter to WI, NRI & ORRI owners & list of owners
- Administrative Application Checklist

Sincerely,

A handwritten signature in cursive script that reads 'Jennifer Morrow'.

Jennifer Morrow  
Senior Regulatory Compliance Technician

xc: OCD, Aztec Office

District I  
1625 N. French Drive, Hobbs, NM 88240  
District II  
1301 W. Grand Ave, Artesia, NM 88210  
District III  
1000 Rio Brazos Road, Aztec, NM 87410  
District IV  
1220 S. St Francis Dr, Santa Fe, NM  
87505

State of New Mexico  
Energy, Minerals and Natural Resources Department

Form C-107-B  
Revised June 10, 2003

**OIL CONSERVATION DIVISION**  
1220 S. St Francis Drive  
Santa Fe, New Mexico 87505

Submit the original  
application to the Santa Fe  
office with one copy to the  
appropriate District Office.

**APPLICATION FOR SURFACE COMMINGLING (DIVERSE OWNERSHIP)**

OPERATOR NAME: XTO Energy, Inc.

OPERATOR ADDRESS: 382 Road 3100, Aztec, New Mexico 87410

APPLICATION TYPE:

☒ Pool Commingling ☐ Lease Commingling ☐ Pool and Lease Commingling ☐ Off-Lease Storage and Measurement (Only if not Surface Commingled)

LEASE TYPE: ☐ Fee ☐ State ☒ Federal

Is this an Amendment to existing Order? ☐ Yes ☒ No If "Yes", please include the appropriate Order No. \_\_\_\_\_

Have the Bureau of Land Management (BLM) and State Land office (SLO) been notified in writing of the proposed commingling

☒ Yes ☐ No

**(A) POOL COMMINGLING**  
Please attach sheets with the following information

(1) Pool Names and Codes	Gravities / BTU of Non-Commingled Production	Calculated Gravities / BTU of Commingled Production		Calculated Value of Commingled Production	Volumes
KUTZ W PICTURED CLIFF 79680	<input checked="" type="checkbox"/>				
BASIN FRUITLAND COAL 71629	<input checked="" type="checkbox"/>				

(2) Are any wells producing at top allowables? ☐ Yes ☒ No

(3) Has all interest owners been notified by certified mail of the proposed commingling? ☒ Yes ☐ No.

(4) Measurement type: ☒ Metering ☐ Other (Specify)

(5) Will commingling decrease the value of production? ☐ Yes ☒ No If "yes", describe why commingling should be approved

**(B) LEASE COMMINGLING**  
Please attach sheets with the following information

(1) Pool Name and Code.

(2) Is all production from same source of supply? ☐ Yes ☐ No

(3) Has all interest owners been notified by certified mail of the proposed commingling? ☐ Yes ☐ No

(4) Measurement type: ☐ Metering ☐ Other (Specify)

**(C) POOL and LEASE COMMINGLING**  
Please attach sheets with the following information

(1) Complete Sections A and E.

**(D) OFF-LEASE STORAGE and MEASUREMENT**  
Please attached sheets with the following information

(1) Is all production from same source of supply? ☐ Yes ☐ No

(2) Include proof of notice to all interest owners.

**(E) ADDITIONAL INFORMATION (for all application types)**  
Please attach sheets with the following information

(1) A schematic diagram of facility, including legal location.

(2) A plat with lease boundaries showing all well and facility locations. Include lease numbers if Federal or State lands are involved.

(3) Lease Names, Lease and Well Numbers, and API Numbers.

I hereby certify that the information above is true and complete to the best of my knowledge and belief.

SIGNATURE: Jennifer Morrow TITLE: Senior Regulatory Compliance Technician DATE: October 8, 2010

TYPE OR PRINT NAME: Jennifer Morrow TELEPHONE NO.: (505) 333-3682

E-MAIL ADDRESS: Jennifer\_Morrow@xtoenergy.com



XTO ENERGY INC.  
ALICE BOLACK 13/ 15 #1 CDP  
SEC 15: T27N-R11W  
SAN JUAN COUNTY, NM

 Alice Bolack 13/15 #1 CDP  
v1928-10

Well Name: Alice Bolack #13 CDP  
 Field: San Juan County NM  
 Lease #  
 Section: 15K, T 27N, R 11W  
 CA # If Applicable :  
 Updated: 9/24/2010

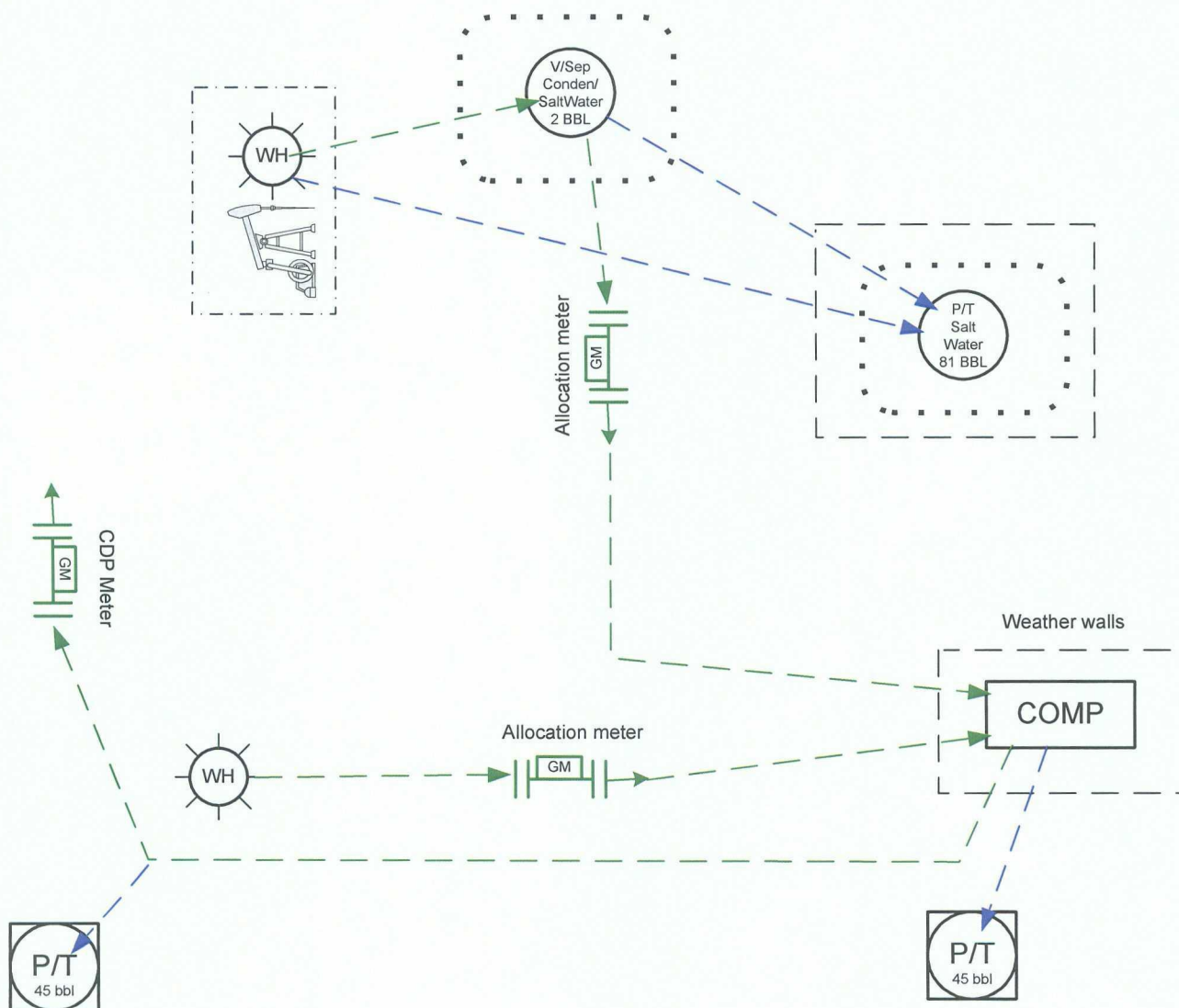

Production  
 Gas  
 Oil  
 Water  
 Equalizing Line  
 Catch Basin-

General sealing of valves, sales by tank gauging  
 Production phase: Drain valve D1 and sales valve S1 sealed closed.  
 Sales phase: Drain valve D1 sealed closed. Sales valve S1 open.  
 Draining phase: Drain valve D1 open. Sales valve S1 closed.

This lease is subject to the site security plan for San Juan Basin Area. The plan is located at:  
 XTO ENERGY INC.  
 382 Road 3100  
 Aztec, NM 87410



Well Name: Bolack 15 # 1  
 Field: San Juan County NM  
 Lease #: Lease # NMSF-078872A, API # 30-045-27806  
 Section: NE/SW Sec. 15 (K), T-27N, R-11W  
 CA # If Applicable: N/A  
 Updated: 2-04-10

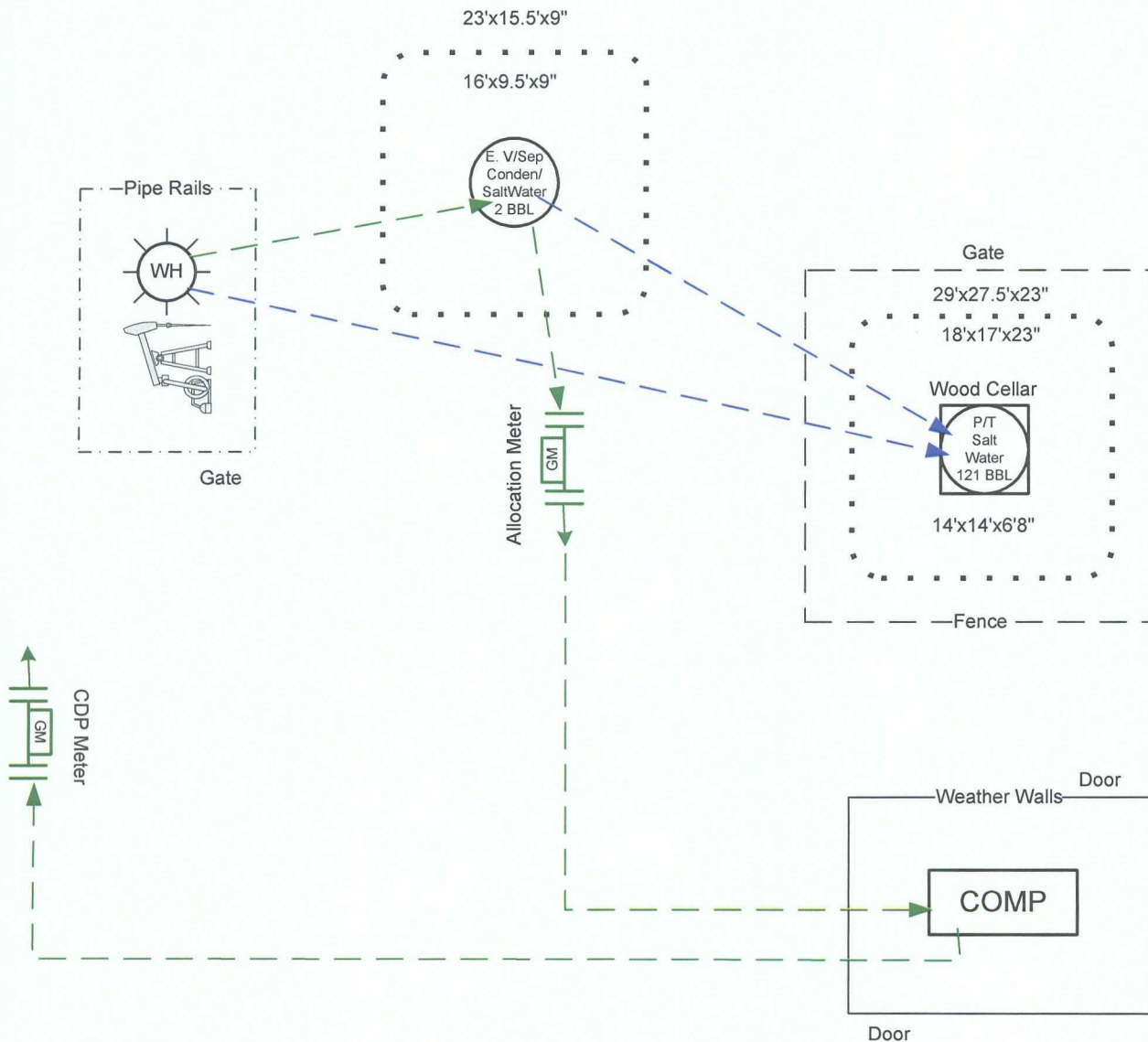
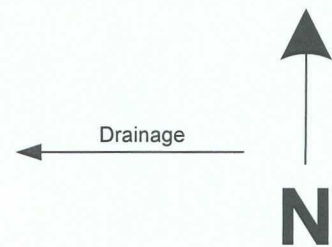

Production  
 Gas  
 Oil  
 Water  
 Equalizing Line  
 Catch Basin-

General sealing of valves, sales by tank gauging  
 Production phase: Drain valve D1 and sales valve S1 sealed closed.  
 Sales phase: Drain valve D1 sealed closed. Sales valve S1 open.  
 Draining phase: Drain valve D1 open. Sales valve S1 closed.

This lease is subject to the site security plan for San Juan Basin Area. The plan is located at:  
 XTO ENERGY INC.  
 382 Road 3100  
 Aztec, NM 87410

Submit to Appropriate  
District Office  
State Leases - 4 copies  
Fee Leases - 3 copies

State of New Mexico  
Energy, Minerals and Natural Resources Department

Form C-102  
Revised 1-1-89

OIL CONSERVATION DIVISION

P.O. Box 2088

Santa Fe, New Mexico 87504-2088

DISTRICT I

P.O. Box 1980, Hobbs, NM 88240

DISTRICT II

P.O. Drawer DD, Artesia, NM 88210

DISTRICT III

1000 Rip Brazos Rd., Aztec, NM 87410

WELL LOCATION AND ACREAGE DEDICATION PLAT

All Distances must be from the outer boundaries of the section

Operator MARATHON OIL COMPANY			Lease BOLACK 15		Well No. 15-1
Unit Letter K	Section 15	Township 27 N	Range 11 W	County San Juan	
Actual Footage Location of Well: 2510 feet from the South line and 1790 feet from the West line					
Ground level Elev. 6298	Producing Formation Fruitland Coal	Pool Basin Fruitland Coal		Dedicated Acreage: 320 Acres	
<p>1. Outline the acreage dedicated to the subject well by colored pencil or hatchure marks on the plat below.</p> <p>2. If more than one lease is dedicated to the well, outline each and identify the ownership thereof (both as to working interest and royalty).</p> <p>3. If more than one lease of different ownership is dedicated to the well, have the interest of all owners been consolidated by communitization, unitization, force-pooling, etc.? <input type="checkbox"/> Yes <input type="checkbox"/> No If answer is "yes" type of consolidation _____</p> <p>If answer is "no" list the owners and tract descriptions which have actually been consolidated. (Use reverse side of this form if necessary.) _____</p> <p>No allowable will be assigned to the well until all interests have been consolidated (by communitization, unitization, forced-pooling, or otherwise) or until a non-standard unit, eliminating such interest, has been approved by the Division.</p>					

0 330 660 990 1320 1650 1980 2310 2640 2000 1500 1000 500 0

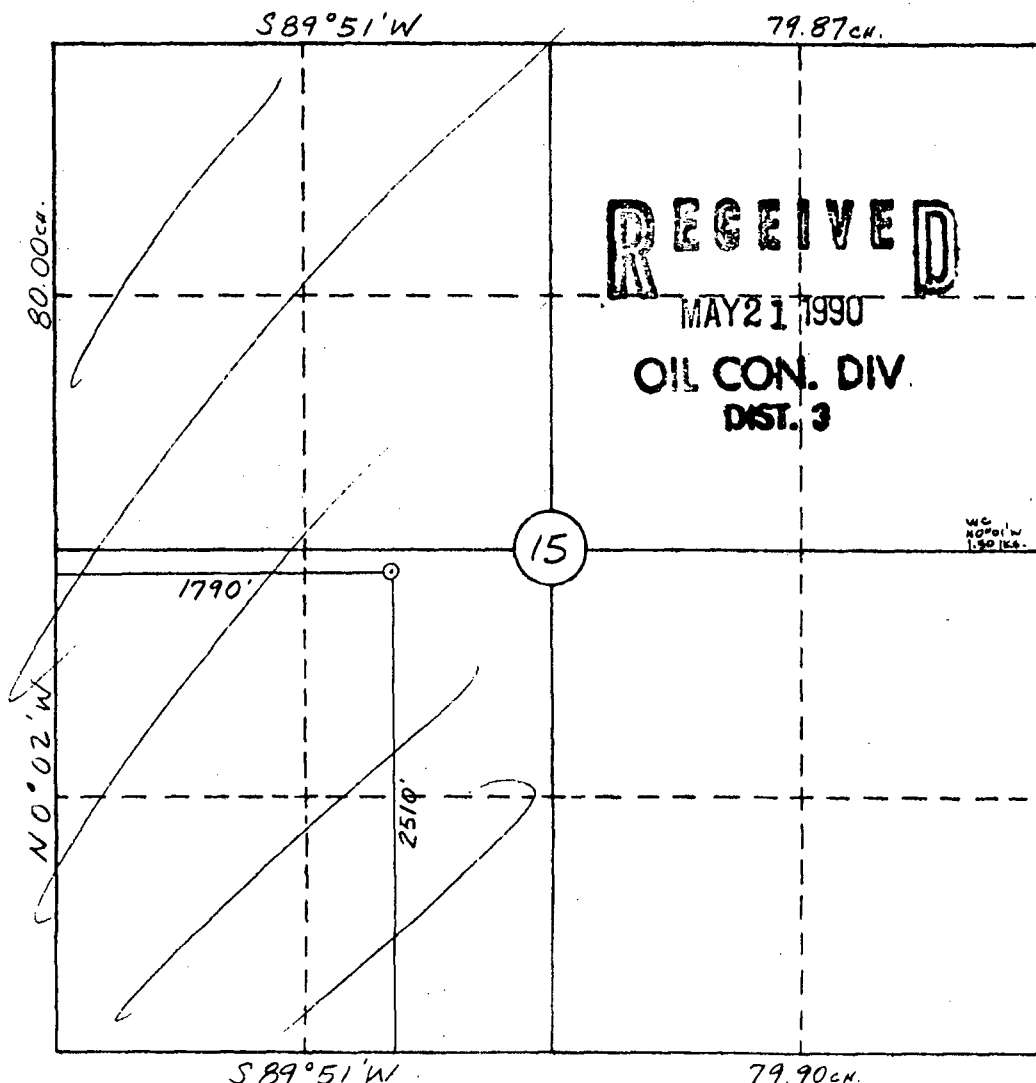

OPERATOR CERTIFICATION

I hereby certify that the information contained herein is true and complete to the best of my knowledge and belief.

Signature *S. L. Atnipp*  
Printed Name  
S. L. Atnipp  
Position  
Drilling Superintendent  
Company  
Marathon Oil Company  
Date  
4/10/90

SURVEYOR CERTIFICATION

I hereby certify that the well location shown on this plat was plotted from field notes of actual surveys made by me or under my supervision, and that the same is true and correct to the best of my knowledge and belief.

3-9-90

Date Surveyed  
William F. Mahnke II  
Signature & Seal of E. MAHNKE II  
Professional Geologist

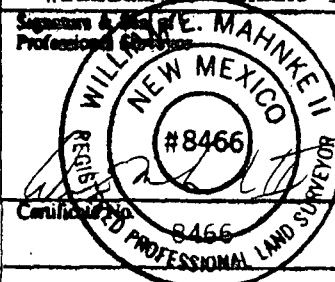

NEW MEXICO  
OIL CONSERVATION COMMISSION

Gas Well Plat

Date December 13, 1954

The Frontier Refining Co. Bolack 13  
Operator Lease Well No.

Name of Producing Formation Pictured Cliffs Pool West Kutz Pictured Cliffs

No. Acres Dedicated to the Well 160

Indicate land status and show ownership. U.S.A. Federal Government Land  
SECTION 15 TOWNSHIP 27N RANGE 11W

	☼		

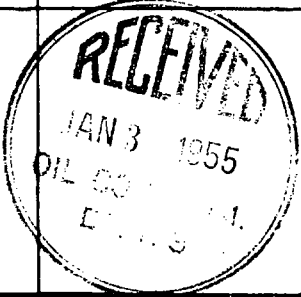

I hereby certify that the information given above is true and complete  
to the best of my knowledge.

ORIGINAL SIGNED  
Name BEN H. PARKER  
Position Ben H. Parker, Vice President  
Representing The Frontier Refining Co.  
Address 410 Boston Bldg., Denver, Colo.

(over)

Alice Bolack 13/15-1

Well Name	API#	Pool	S-T-R	FNL/FSL	FEL/FWL	Lease Number	Agreement Number	Permits	Gravity	BTU	Est Daily Gas Rate
Alice Bolack 13	30-045-06488	Pictured Cliffs	15K-27N-11W	1650S	1650W	NMSF-078872A	N/A	N/A	no oil	1.045	60
Bolack 15-1	30-045-27806	Fruitland Coal	15K-27N-11W	2510S	1790W	NMSF-078872A	N/A	N/A	no oil	1.019	109



## Alice Bolack 13 and Bolack 15-1

### *Proposed Allocation Procedure*

#### Base Data:

W = Gas volume (MCF) from allocation meters at individual wells during allocation period

X = Gas volume (MCF) from CDP sales meter during allocation period

Allocation period is typically a calendar month and will be the same for all wells.

Production and fuel use will be based on the following formula:

$$\text{Allocated sales volume (MCF)} = (W / \text{Sum } W) \times X$$

NOTE: Production liquids will not be surface commingled.

Compressor Information			
Location:	Alice Bolack 13/15-1		
Lat/Long:	36.57227/-107.9938		
Manufacturer:	Caterpillar		
Engine:	G3304NA		
Horse Power:	60		
Fuel Usage:			
	100%	14.4	mcf/d
	75%	12.2	mcf/d
	50%	10	mcf/d



August 18, 2010

RE: Notice to Working and Royalty Interest Owners  
Application to Surface Commingle Gas Production  
San Juan County, New Mexico

XTO Energy Inc. is applying to the New Mexico Oil Conservation Division (NMOCD) for approval to surface commingle gas production from the Alice Bolack #13 and Bolack 15 #1. NMOCD requires that all interest owners be notified of plans to surface commingle when ownership is different between wells.

Produced gas from each well will be measured separately prior to being commingled. We plan to produce the commingled gas through a shared compressor. Produced liquids will not be surface commingled. In the future, additional wells, pools and acreage may be added to this surface commingle or this gathering system.

If you need additional information, or have any questions, please contact me at (505) 333-3682. If you have an objection to our application, you must file a protest in writing to the NMOCD Santa Fe office at 1220 South Saint Francis Drive, Santa Fe, NM 87505 within 20 days from the date of this letter. If there are no objections raised, an application will be submitted to NMOCD at that time.

Sincerely,

A handwritten signature in cursive script that reads 'Jennifer Morrow'.

Jennifer Morrow  
Senior Regulatory Compliance Technician

Xc: Well Files  
FW Land Department  
NMOCD, Aztec

**AMY L FERN**  
**719 12TH AVE**  
**HONOLULU, HI 968162247**  
Alice Bolack 13 CDP J Morrow Reg Dept

**AMY L FERN**  
**719 12TH AVE**  
**HONOLULU, HI 968162247**  
Alice Bolack 13 CDP J Morrow Reg Dept

**AMY L FERN**  
**719 12TH AVE**  
**HONOLULU, HI 968162247**  
Alice Bolack 13 CDP J Morrow Reg Dept

**ANITA C LUKE**  
**3216 KAOHINANI DR**  
**HONOLULU, HI 968171041**  
Alice Bolack 13 CDP J Morrow Reg Dept

**ANITA C LUKE**  
**3216 KAOHINANI DR**  
**HONOLULU, HI 968171041**  
Alice Bolack 13 CDP J Morrow Reg Dept

**ANITA C LUKE**  
**3216 KAOHINANI DR**  
**HONOLULU, HI 968171041**  
Alice Bolack 13 CDP J Morrow Reg Dept

**BURDOCK LIMITED COMPANY A NM**  
**LIMITED LIABILITY CO**  
**PO BOX 90428**  
**ALBUQUERQUE, NM 871990428**  
Alice Bolack 13 CDP J Morrow Reg Dept

**BURDOCK LIMITED COMPANY A NM**  
**LIMITED LIABILITY CO**  
**PO BOX 90428**  
**ALBUQUERQUE, NM 871990428**  
Alice Bolack 13 CDP J Morrow Reg Dept

**BURDOCK LIMITED COMPANY A NM**  
**LIMITED LIABILITY CO**  
**PO BOX 90428**  
**ALBUQUERQUE, NM 871990428**  
Alice Bolack 13 CDP J Morrow Reg Dept

**BURLINGTON RESOURCES OIL & GAS**  
**COMPANY**  
**22295 NETWORK PLACE**  
**CHICAGO, IL 606731222**  
Alice Bolack 13 CDP J Morrow Reg Dept

**BURLINGTON RESOURCES OIL & GAS**  
**COMPANY**  
**22295 NETWORK PLACE**  
**CHICAGO, IL 606731222**  
Alice Bolack 13 CDP J Morrow Reg Dept

**BURLINGTON RESOURCES OIL & GAS**  
**COMPANY**  
**22295 NETWORK PLACE**  
**CHICAGO, IL 606731222**  
Alice Bolack 13 CDP J Morrow Reg Dept

**C B HARRISON JR**  
**18333 PRESTON RD STE 188**  
**DALLAS, TX 752520000**  
Alice Bolack 13 CDP J Morrow Reg Dept

**C B HARRISON JR**  
**18333 PRESTON RD STE 188**  
**DALLAS, TX 752520000**  
Alice Bolack 13 CDP J Morrow Reg Dept

**C B HARRISON JR**  
**18333 PRESTON RD STE 188**  
**DALLAS, TX 752520000**  
Alice Bolack 13 CDP J Morrow Reg Dept

**C. JOSEPH CAIN**  
**6001 WESTSIDE DRIVE**  
**AUSTIN, TX 787310000**  
Alice Bolack 13 CDP J Morrow Reg Dept

**C. JOSEPH CAIN**  
**6001 WESTSIDE DRIVE**  
**AUSTIN, TX 787310000**  
Alice Bolack 13 CDP J Morrow Reg Dept

**C. JOSEPH CAIN**  
**6001 WESTSIDE DRIVE**  
**AUSTIN, TX 787310000**  
Alice Bolack 13 CDP J Morrow Reg Dept

**CARTER FAMILY TRUST HAROLD D.**  
**CARTER, TRUSTEE**  
**PO BOX 12766**  
**DALLAS, TX 752250000**  
Alice Bolack 13 CDP J Morrow Reg Dept

**CARTER FAMILY TRUST HAROLD D.**  
**CARTER, TRUSTEE**  
**PO BOX 12766**  
**DALLAS, TX 752250000**  
Alice Bolack 13 CDP J Morrow Reg Dept

**CARTER FAMILY TRUST HAROLD D.**  
**CARTER, TRUSTEE**  
**PO BOX 12766**  
**DALLAS, TX 752250000**  
Alice Bolack 13 CDP J Morrow Reg Dept

**COOKSEY FAMILY TRUST ROBERT A**  
**COOKSEY, TRUSTEE**  
**4925 GREENVILLE, BOX 92**  
**DALLAS, TX 752060000**  
Alice Bolack 13 CDP J Morrow Reg Dept

**COOKSEY FAMILY TRUST ROBERT A**  
**COOKSEY, TRUSTEE**  
**4925 GREENVILLE, BOX 92**  
**DALLAS, TX 752060000**  
Alice Bolack 13 CDP J Morrow Reg Dept

**COOKSEY FAMILY TRUST ROBERT A**  
**COOKSEY, TRUSTEE**  
**4925 GREENVILLE, BOX 92**  
**DALLAS, TX 752060000**  
Alice Bolack 13 CDP J Morrow Reg Dept

**DOROTHY LYUM PARK**  
**1116 A CLIO ST**  
**HONOLULU, HI 968222701**  
Alice Bolack 13 CDP J Morrow Reg Dept

**DOROTHY LYUM PARK**  
**1116 A CLIO ST**  
**HONOLULU, HI 968222701**  
Alice Bolack 13 CDP J Morrow Reg Dept

**DOROTHY LYUM PARK**  
**1116 A CLIO ST**  
**HONOLULU, HI 968222701**  
Alice Bolack 13 CDP J Morrow Reg Dept

**EARL L YEAKEL III**  
**P O BOX 164196**  
**AUSTIN, TX 787164196**  
Alice Bolack 13 CDP J Morrow Reg Dept

**EARL L YEAKEL III**  
**P O BOX 164196**  
**AUSTIN, TX 787164196**  
Alice Bolack 13 CDP J Morrow Reg Dept

**EARL L YEAKEL III**  
**P O BOX 164196**  
**AUSTIN, TX 787164196**  
Alice Bolack 13 CDP J Morrow Reg Dept

**ELSR LP BENGALJONES GROUP LLC,  
GENERAL PARTNER  
8080 NORTH CENTRAL EXPWY #1420  
DALLAS, TX 752060000**

Alice Bolack 13 CDP J Morrow Reg Dept

**ELSR LP BENGALJONES GROUP LLC,  
GENERAL PARTNER  
8080 NORTH CENTRAL EXPWY #1420  
DALLAS, TX 752060000**

Alice Bolack 13 CDP J Morrow Reg Dept

**ELSR LP BENGALJONES GROUP LLC  
GENERAL PARTNER  
8080 NORTH CENTRAL EXPWY #1420  
DALLAS, TX 752060000**

Alice Bolack 13 CDP J Morrow Reg Dept

**GROVER FAMILY LP ATTN: ARDEN R  
GROVER**

**P O BOX 3666  
MIDLAND, TX 797023666**

Alice Bolack 13 CDP J Morrow Reg Dept

**GROVER FAMILY LP ATTN: ARDEN R  
GROVER**

**P O BOX 3666  
MIDLAND, TX 797023666**

Alice Bolack 13 CDP J Morrow Reg Dept

**GROVER FAMILY LP ATTN: ARDEN R  
GROVER**

**P O BOX 3666  
MIDLAND, TX 797023666**

Alice Bolack 13 CDP J Morrow Reg Dept

**HENRY HUNG PUI CHUN REV TRUST  
HENRY HUNG PUI CHUN**

**2137 LILIHA ST.  
HONOLULU, HI 968171639**

Alice Bolack 13 CDP J Morrow Reg Dept

**HENRY HUNG PUI CHUN REV TRUST  
HENRY HUNG PUI CHUN**

**2137 LILIHA ST.  
HONOLULU, HI 968171639**

Alice Bolack 13 CDP J Morrow Reg Dept

**HENRY HUNG PUI CHUN REV TRUST  
HENRY HUNG PUI CHUN**

**2137 LILIHA ST.  
HONOLULU, HI 968171639**

Alice Bolack 13 CDP J Morrow Reg Dept

**HONUA OLA MAU LLC**

**PO BOX 1831  
HONOLULU, HI 968050000**

Alice Bolack 13 CDP J Morrow Reg Dept

**HONUA OLA MAU LLC**

**PO BOX 1831  
HONOLULU, HI 968050000**

Alice Bolack 13 CDP J Morrow Reg Dept

**HONUA OLA MAU LLC**

**PO BOX 1831  
HONOLULU, HI 968050000**

Alice Bolack 13 CDP J Morrow Reg Dept

**JANE G K HEW**

**2233 HOONANEA ST  
HONOLULU, HI 968220000**

Alice Bolack 13 CDP J Morrow Reg Dept

**JANE G K HEW**

**2233 HOONANEA ST  
HONOLULU, HI 968220000**

Alice Bolack 13 CDP J Morrow Reg Dept

**JANE G K HEW**

**2233 HOONANEA ST  
HONOLULU, HI 968220000**

Alice Bolack 13 CDP J Morrow Reg Dept

**JOHN LAWRENCE KOLIVAS &  
DEANNA L CARPENTER KOLIVAS**

**PO BOX 89368  
HONOLULU, HI 968150000**

Alice Bolack 13 CDP J Morrow Reg Dept

**JOHN LAWRENCE KOLIVAS &  
DEANNA L CARPENTER KOLIVAS**

**PO BOX 89368  
HONOLULU, HI 968150000**

Alice Bolack 13 CDP J Morrow Reg Dept

**JOHN LAWRENCE KOLIVAS &  
DEANNA L CARPENTER KOLIVAS**

**PO BOX 89368  
HONOLULU, HI 968150000**

Alice Bolack 13 CDP J Morrow Reg Dept

**LORINNA J SCHMIDT**

**2333 KAPIOLANI BLVD #2  
HONOLULU, HI 968260000**

Alice Bolack 13 CDP J Morrow Reg Dept

**LORINNA J SCHMIDT**

**2333 KAPIOLANI BLVD #2  
HONOLULU, HI 968260000**

Alice Bolack 13 CDP J Morrow Reg Dept

**LORINNA J SCHMIDT**

**2333 KAPIOLANI BLVD #2  
HONOLULU, HI 968260000**

Alice Bolack 13 CDP J Morrow Reg Dept

**MARK T. MITCHELL**

**3009 MEANDERING RIVER CT  
AUSTIN, TX 787460000**

Alice Bolack 13 CDP J Morrow Reg Dept

**MARK T. MITCHELL**

**3009 MEANDERING RIVER CT  
AUSTIN, TX 787460000**

Alice Bolack 13 CDP J Morrow Reg Dept

**MARK T. MITCHELL**

**3009 MEANDERING RIVER CT  
AUSTIN, TX 787460000**

Alice Bolack 13 CDP J Morrow Reg Dept

**MAY RUTH GAUDIN**

**525 GRANADA CRESCENT  
N VANCOUVER BC V7N 3A7  
CANADA, . 0**

Alice Bolack 13 CDP J Morrow Reg Dept

**MAY RUTH GAUDIN**

**525 GRANADA CRESCENT  
N VANCOUVER BC V7N 3A7  
CANADA, . 0**

Alice Bolack 13 CDP J Morrow Reg Dept

**MAY RUTH GAUDIN**

**525 GRANADA CRESCENT  
N VANCOUVER BC V7N 3A7  
CANADA, . 0**

Alice Bolack 13 CDP J Morrow Reg Dept

**MILDRED O TOGIKAWA TRUST DEE T  
TOGIKAWA SUCCESSOR**

**3060 WESTVIEW CT  
LAKE OSWEGO, OR 970347323**

Alice Bolack 13 CDP J Morrow Reg Dept

**MILDRED O TOGIKAWA TRUST DEE T  
TOGIKAWA SUCCESSOR**

**3060 WESTVIEW CT  
LAKE OSWEGO, OR 970347323**

Alice Bolack 13 CDP J Morrow Reg Dept

**MILDRED O TOGIKAWA TRUST DEE T  
TOGIKAWA SUCCESSOR**

**3060 WESTVIEW CT  
LAKE OSWEGO, OR 970347323**

Alice Bolack 13 CDP J Morrow Reg Dept

**MMS XTO FEDERAL**  
**C/O XTO ENERGY INC**  
**810 HOUSTON STREET**  
**FORT WORTH, TX 761026298**  
Alice Bolack 13 CDP JMorrow Reg Dept

**MMS XTO FEDERAL**  
**C/O XTO ENERGY INC**  
**810 HOUSTON STREET**  
**FORT WORTH, TX 761026298**  
Alice Bolack 13 CDP JMorrow Reg Dept

**MMS XTO FEDERAL**  
**C/O XTO ENERGY INC**  
**810 HOUSTON STREET**  
**FORT WORTH, TX 761026298**  
Alice Bolack 13 CDP JMorrow Reg Dept

**OKLAHOMA OIL COMPANY**  
**4809 COLE STE 210**  
**DALLAS, TX 752050000**  
Alice Bolack 13 CDP JMorrow Reg Dept

**OKLAHOMA OIL COMPANY**  
**4809 COLE STE 210**  
**DALLAS, TX 752050000**  
Alice Bolack 13 CDP JMorrow Reg Dept

**OKLAHOMA OIL COMPANY**  
**4809 COLE STE 210**  
**DALLAS, TX 752050000**  
Alice Bolack 13 CDP JMorrow Reg Dept

**PATSY CHUN CHUN REV TRUST**  
**PATSY CHUN CHUN TRUSTEE**  
**2137 LILIHA ST.**  
**HONOLULU, HI 968171639**  
Alice Bolack 13 CDP JMorrow Reg Dept

**PATSY CHUN CHUN REV TRUST**  
**PATSY CHUN CHUN TRUSTEE**  
**2137 LILIHA ST.**  
**HONOLULU, HI 968171639**  
Alice Bolack 13 CDP JMorrow Reg Dept

**PATSY CHUN CHUN REV TRUST**  
**PATSY CHUN CHUN TRUSTEE**  
**2137 LILIHA ST.**  
**HONOLULU, HI 968171639**  
Alice Bolack 13 CDP JMorrow Reg Dept

**SYLVIA H TATEISHI**  
**1 KEAHOLE PLACE #2408**  
**HONOLULU, HI 968250000**  
Alice Bolack 13 CDP JMorrow Reg Dept

**SYLVIA H TATEISHI**  
**1 KEAHOLE PLACE #2408**  
**HONOLULU, HI 968250000**  
Alice Bolack 13 CDP JMorrow Reg Dept

**SYLVIA H TATEISHI**  
**1 KEAHOLE PLACE #2408**  
**HONOLULU, HI 968250000**  
Alice Bolack 13 CDP JMorrow Reg Dept

**SYLVIA KALAMA & RONDA LOQUE**  
**JTWRS**  
**1448 YOUNG ST # 204**  
**HONOLULU, HI 968140000**  
Alice Bolack 13 CDP JMorrow Reg Dept

**SYLVIA KALAMA & RONDA LOQUE**  
**JTWRS**  
**1448 YOUNG ST # 204**  
**HONOLULU, HI 968140000**  
Alice Bolack 13 CDP JMorrow Reg Dept

**SYLVIA KALAMA & RONDA LOQUE**  
**JTWRS**  
**1448 YOUNG ST # 204**  
**HONOLULU, HI 968140000**  
Alice Bolack 13 CDP JMorrow Reg Dept

**SYLVIA-LEE KALAMA**  
**1448 YOUNG ST #204**  
**HONOLULU, HI 968140000**  
Alice Bolack 13 CDP JMorrow Reg Dept

**SYLVIA-LEE KALAMA**  
**1448 YOUNG ST #204**  
**HONOLULU, HI 968140000**  
Alice Bolack 13 CDP JMorrow Reg Dept

**SYLVIA-LEE KALAMA**  
**1448 YOUNG ST #204**  
**HONOLULU, HI 968140000**  
Alice Bolack 13 CDP JMorrow Reg Dept

**THOMAS SCHMIDT**  
**PO BOX 398**  
**KAILUA KONA, HI 967450000**  
Alice Bolack 13 CDP JMorrow Reg Dept

**THOMAS SCHMIDT**  
**PO BOX 398**  
**KAILUA KONA, HI 967450000**  
Alice Bolack 13 CDP JMorrow Reg Dept

**THOMAS SCHMIDT**  
**PO BOX 398**  
**KAILUA KONA, HI 967450000**  
Alice Bolack 13 CDP JMorrow Reg Dept

**TOMMY BOLACK AKA DUANE**  
**THOMAS BOLACK**  
**3901 BLOOMFIELD HIGHWAY**  
**FARMINGTON, NM 874010000**  
Alice Bolack 13 CDP JMorrow Reg Dept

**TOMMY BOLACK AKA DUANE**  
**THOMAS BOLACK**  
**3901 BLOOMFIELD HIGHWAY**  
**FARMINGTON, NM 874010000**  
Alice Bolack 13 CDP JMorrow Reg Dept

**TOMMY BOLACK AKA DUANE**  
**THOMAS BOLACK**  
**3901 BLOOMFIELD HIGHWAY**  
**FARMINGTON, NM 874010000**  
Alice Bolack 13 CDP JMorrow Reg Dept

**W D KENNEDY PROPERTIES LTD**  
**ATTN W D KENNEDY**  
**500 WEST TEXAS STE 655**  
**MIDLAND, TX 797014257**  
Alice Bolack 13 CDP JMorrow Reg Dept

**W D KENNEDY PROPERTIES LTD**  
**ATTN W D KENNEDY**  
**500 WEST TEXAS STE 655**  
**MIDLAND, TX 797014257**  
Alice Bolack 13 CDP JMorrow Reg Dept

**W D KENNEDY PROPERTIES LTD**  
**ATTN W D KENNEDY**  
**500 WEST TEXAS STE 655**  
**MIDLAND, TX 797014257**  
Alice Bolack 13 CDP JMorrow Reg Dept

**WESLEY K M HEU**  
**94-457 KUAKAHI PLACE**  
**WAIPAHU, HI 967970000**  
Alice Bolack 13 CDP JMorrow Reg Dept

**WESLEY K M HEU**  
**94-457 KUAKAHI PLACE**  
**WAIPAHU, HI 967970000**  
Alice Bolack 13 CDP JMorrow Reg Dept

**WESLEY K M HEU**  
**94-457 KUAKAHI PLACE**  
**WAIPAHU, HI 967970000**  
Alice Bolack 13 CDP JMorrow Reg Dept