

DATE IN 1-12-11	SUSPENSE	ENGINEER DLB	LOGGED IN 1-13-10	TYPE NSL	APP NO 1101352150
-----------------	----------	--------------	-------------------	----------	-------------------

ABOVE THIS LINE FOR DIVISION USE ONLY

**NEW MEXICO OIL CONSERVATION DIVISION**  
 - Engineering Bureau -  
 1220 South St. Francis Drive, Santa Fe, NM 87505



PLU Rose Ranch 20 #1 H  
 Chesapeake  
 6328

**ADMINISTRATIVE APPLICATION CHECKLIST**

THIS CHECKLIST IS MANDATORY FOR ALL ADMINISTRATIVE APPLICATIONS FOR EXCEPTIONS TO DIVISION RULES AND REGULATIONS WHICH REQUIRE PROCESSING AT THE DIVISION LEVEL IN SANTA FE

**Application Acronyms:**

[NSL-Non-Standard Location] [NSP-Non-Standard Proration Unit] [SD-Simultaneous Dedication]  
 [DHC-Downhole Commingling] [CTB-Lease Commingling] [PLC-Pool/Lease Commingling]  
 [PC-Pool Commingling] [OLS - Off-Lease Storage] [OLM-Off-Lease Measurement]  
 [WFX-Waterflood Expansion] [PMX-Pressure Maintenance Expansion]  
 [SWD-Salt Water Disposal] [IPI-Injection Pressure Increase]  
 [EOR-Qualified Enhanced Oil Recovery Certification] [PPR-Positive Production Response]

[1] **TYPE OF APPLICATION** - Check Those Which Apply for [A]

[A] Location - Spacing Unit - Simultaneous Dedication  
☒ NSL ☐ NSP ☐ SD

Check One Only for [B] or [C]

[B] Commingling - Storage - Measurement  
☐ DHC ☐ CTB ☐ PLC ☐ PC ☐ OLS ☐ OLM

[C] Injection - Disposal - Pressure Increase - Enhanced Oil Recovery  
☐ WFX ☐ PMX ☐ SWD ☐ IPI ☐ EOR ☐ PPR

[D] Other: Specify \_\_\_\_\_

RECEIVED OGD  
 2011 JAN 12 P 3:47

[2] **NOTIFICATION REQUIRED TO:** - Check Those Which Apply, or Does Not Apply

[A] ☐ Working, Royalty or Overriding Royalty Interest Owners  
 [B] ☒ Offset Operators, Leaseholders or Surface Owner  
 [C] ☐ Application is One Which Requires Published Legal Notice  
 [D] ☐ Notification and/or Concurrent Approval by BLM or SLO  
U.S. Bureau of Land Management - Commissioner of Public Lands, State Land Office  
 [E] ☐ For all of the above, Proof of Notification or Publication is Attached, and/or,  
 [F] ☐ Waivers are Attached

[3] **SUBMIT ACCURATE AND COMPLETE INFORMATION REQUIRED TO PROCESS THE TYPE OF APPLICATION INDICATED ABOVE.**

[4] **CERTIFICATION:** I hereby certify that the information submitted with this application for administrative approval is **accurate** and **complete** to the best of my knowledge. I also understand that **no action** will be taken on this application until the required information and notifications are submitted to the Division.

Note: Statement must be completed by an individual with managerial and/or supervisory capacity.

Ocean Munds-Dry Ocean Munds-Dry Attorney 1-12-11  
 Print or Type Name Signature Title Date  
 omundsdry@hollandhart.com  
 e-mail Address

January 12, 2011

**HAND-DELIVERED**

Daniel Sanchez  
Acting Director  
Oil Conservation Division  
New Mexico Department of Energy,  
Minerals and Natural Resources  
1220 South Saint Francis Drive  
Santa Fe, New Mexico 87505

**Re: Application of Chesapeake Operating, Inc. for administrative approval of an unorthodox well location for its PLU Ross Ranch "20" Federal Com Well No. 1H to be drilled from a surface location and penetration point 100 feet from the North line and 400 feet from the West line and a bottomhole location 330 feet from the South line and 400 feet from the West line of Section 20, Township 25 South, Range 30 East, NMPM, Eddy County, New Mexico.**

Dear Mr. Sanchez:

Chesapeake Operating, Inc. ("Chesapeake") hereby seeks administrative approval pursuant to the provisions of Division Rules 19.15.15.13 and 19.15.16.14 for an unorthodox well location for its PLU Ross Ranch "20" Federal Com Well No. 1H. This well is located in Section 20, Township 25 South, Range 30 East, N.M.P.M., Eddy County, New Mexico and is to be drilled in the Bone Spring formation at a surface location and a penetration point 100 feet from the North line and 400 feet from the West line and a bottomhole location 330 feet from the South line and 400 feet from the West line of Section 20, Eddy County, New Mexico. A 160-acre project area has been dedicated to this horizontal well comprised of the W/2 W/2 of Section 20.

This location is unorthodox because the Bone Spring formation under this acreage is governed by the Division's statewide rules which provide for wells on 40-acre spacing units to be located no closer than 330 feet to the outer boundary of the spacing unit. Division Rule 19.15.16.14 defines the "Penetration Point" as "the point where the wellbore penetrates the top of the pool from which it is intended to produce." The wellbore penetrates the Bone Spring formation at a point 100 feet from the North line of Section 20 and is therefore closer than allowed by Division rules.



Although the wellbore penetrates the top of the Bone Spring at an unorthodox location, the well will be at a standard location at the producing interval. Chesapeake is targeting the Lower Avalon Shale at approximately 7970 feet (TVD). Therefore, once Chesapeake reaches the targeted formation, it will be at a standard location.

**Exhibit A** is a plat showing the location of the well. This location is encroaching to the north of Section 20. This location is within the Poker Lake Unit which is operated by BOPCo., LP. A copy of this application with all attachments was mailed to BOPCO., LP and advised that if they have an objection to this application it must be filed in writing with the Division's Santa Fe office within twenty days from the date notice was sent. They were also advised that if no objections were received by the Division within twenty days, the Division Director could approve the application.

**Exhibit B** is the C-102 for this well.

**Exhibit C** is the notice list.

Your attention to this application is appreciated.

Sincerely,

A handwritten signature in black ink that reads "Ocean Munds-Dry".

Ocean Munds-Dry  
ATTORNEY FOR  
CHESAPEAKE OPERATING, INC.

Enclosures

cc: OCD District Office



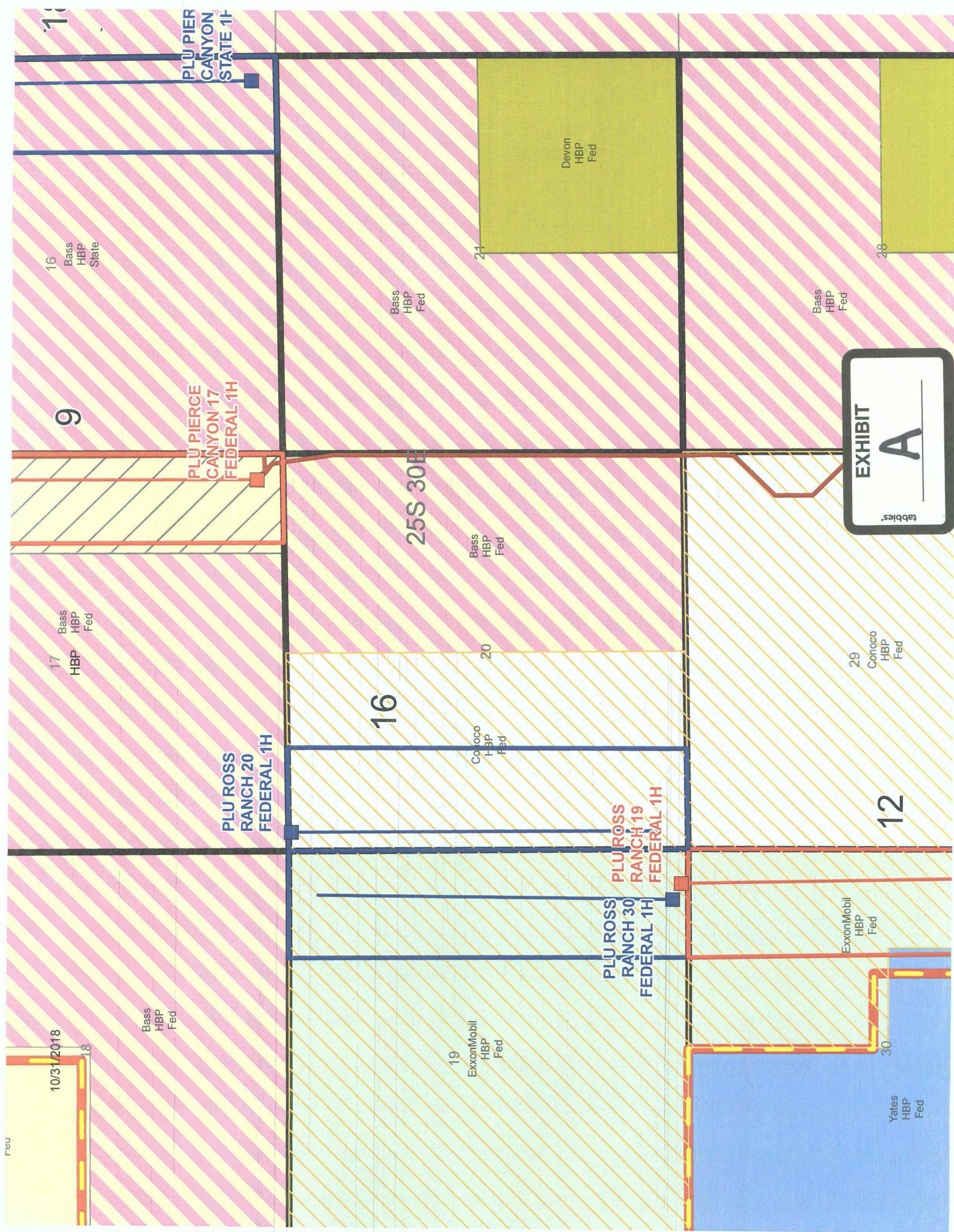

rev

10/31/2018

PLU PIER  
CANYON  
STATE 1H

PLU PIERCE  
CANYON 17  
FEDERAL 1H

PLU ROSS  
RANCH 20  
FEDERAL 1H

PLU ROSS  
RANCH 30  
FEDERAL 1H

PLU ROSS  
RANCH 19  
FEDERAL 1H

Bass  
HBP  
Fed

ExxonMobil  
HBP  
Fed

Conoco  
HBP  
Fed

Bass  
HBP  
Fed

Devon  
HBP  
Fed

Bass  
HBP  
Fed

ExxonMobil  
HBP  
Fed

Conoco  
HBP  
Fed

Yates  
HBP  
Fed

EXHIBIT  
A

tabbles



DISTRICT I  
1825 N. French Dr., Hobbs, NM 88240

DISTRICT II  
1301 W. Grand Avenue, Artesia, NM 88210

DISTRICT III  
1000 Rio Brazos Rd., Aztec, NM 87410

DISTRICT IV  
1220 S. St. Francis Dr., Santa Fe, NM 87505

State of New Mexico  
Energy, Minerals and Natural Resources Department

Form G-102  
Revised October 16, 2009

Submit one copy to appropriate  
District Office

# OIL CONSERVATION DIVISION

1220 South St. Francis Dr.  
Santa Fe, New Mexico 87505

## WELL LOCATION AND ACREAGE DEDICATION PLAT

☐ AMENDED REPORT

API Number <b>80-015-38357</b>	Pool Code <b>13354</b>	Pool Name <i>under</i> <b>Cornet Canyon; Bone Spring, South</b>
Property Code	Property Name <b>PLU-ROSS RANCH "20" FEDERAL</b>	Well Number <b>1H</b>
OCRID No. <b>147179</b>	Operator Name <b>CHESAPEAKE OPERATING CO.</b>	Elevation <b>3199'</b>

### Surface Location

UL or lot no.	Section	Township	Range	Lot Idn	Feet from the	North/South line	Feet from the	East/West line	County
<b>D</b>	<b>20</b>	<b>25 S</b>	<b>30 E</b>		<b>100</b>	<b>NORTH</b>	<b>400</b>	<b>WEST</b>	<b>EDDY</b>

### Bottom Hole Location If Different From Surface

UL or lot No.	Section	Township	Range	Lot Idn	Feet from the	North/South line	Feet from the	East/West line	County
<b>M</b>	<b>20</b>	<b>25 S</b>	<b>30 E</b>		<b>330</b>	<b>SOUTH</b>	<b>400</b>	<b>WEST</b>	<b>EDDY</b>

Dedicated Acres	Joint or Infill	Consolidation Code	Order No.
<b>160</b>			

NO ALLOWABLE WILL BE ASSIGNED TO THIS COMPLETION UNTIL ALL INTERESTS HAVE BEEN CONSOLIDATED  
OR A NON-STANDARD UNIT HAS BEEN APPROVED BY THE DIVISION

<p>3197.4 3202.5 100'</p> <p>400' ST.</p> <p>3197.7 3202.7</p> <p>485.6'</p> <p>Producing Area</p> <p>Project Area</p> <p><b>SURFACE LOCATION</b> Lat - N 32.12258464° Long - W 103.9107995° NMSPC- N 408587.817 E 672146.356 (NAD-83)</p> <p><b>PROPOSED BOTTOM HOLE LOCATION</b> Lat - N 32.10915696° Long - W 103.9107945° NMSPC- N 403703.114 E 672167.020 (NAD-83)</p>	<p><b>OPERATOR CERTIFICATION</b></p> <p>I hereby certify that the information contained herein is true and complete to the best of my knowledge and belief, and that this organization either owns a working interest or unleased mineral interest in the land including the proposed bottom hole location or has a right to drill the well at this location pursuant to a contract with an owner of such a mineral or working interest, or to a voluntary pooling agreement or a compulsory pooling order heretofore entered by the division.</p> <p><i>Bryan Arrant</i> 10/09/2010 Signature Date</p> <p>Bryan Arrant Printed Name</p> <p><b>SURVEYOR CERTIFICATION</b></p> <p>I hereby certify that the well location shown on this plat was plotted from field notes of actual surveys made by me or under my supervision, and that the same is true and correct to the best of my belief.</p> <p>Date Surveyed Signature &amp; Seal of Professional Surveyor Certificate No. Gary L. Jones 7977</p> <p>BASIN SURVEYS</p>
---	---

EXHIBIT

B

**Exhibit C**

Chesapeake's NSL Application  
PLU Ross Ranch "20" Fed Com Well No. 1H

BOPCo., LP  
201 W. Main Street Suite 3100  
Fort Worth, Texas 76102