

PIPELINE LEGEND:						
Number	Name	Type	Size	Location	From	To
1	Enterprise	Light Run	6-in. steel	Holly south	Texas	Lea, connects with #9
2	DCP	Stabilizer off gas	4-in. steel	Lea N to S	Lea Refinery	DCP midstream
3	RO reject	RO reject water	4-in. poly	Lea north	Refinery	Currently out of service
4	Crude	Incoming crude	8-in. steel	Holly north	Oil field	Lea Refinery
5	Gas Co. of NM	Natural gas (fuel)	6-in. steel	Holly north	Gas Co.	Lea Refinery (loop)
6	Beeson	Incoming crude	8-in. steel	Holly north	Oil field	Lea Refinery
7	Hobbs station	Incoming crude	8-in. steel	Holly north	Hobbs station	Lea Refinery
8	Empire	Outgoing process	10-in. steel	Holly south	Lea Refinery	Artesia Refinery
9	Lea 8-in.	Light Run	8-in. steel	Holly south	Enterprise	Artesia Refinery
10	Low To Art. Crude	Crude	16-in. steel	Holly south	Lea Refinery	Artesia Refinery
11	Roadrunner	Canadian crude	16-in. steel	Holly south	Canada	Lea, connects with # 10
12	Wastewater	Wastewater	6-in. poly	Lea north	Lea Refinery	Lovington WWTP
13	Russell	Incoming crude	12-in. steel	Lea north	Russell stat. (TX)	Lea Refinery
14	Plains	Crude	8-in. steel	Lea center	Pass-through, out of service 3-4 years, purged	

Not shown	Multi-purpose	Crude/process	12-in. steel	Lea N to S	Lea north	Connects with Low. to Art. #8 and #10
Not shown	Chevron	Incoming crude	4-in. poly	Lea S to N	Oil field	Lea Refinery
Notes:						
Holly north refers to pipeline and manifolds near MW-16 on this plate.						
Holly south refers to pipelines and manifolds near MW-14 on this plate.						
Lea north refers to pipelines in the area of the refinery process area.						

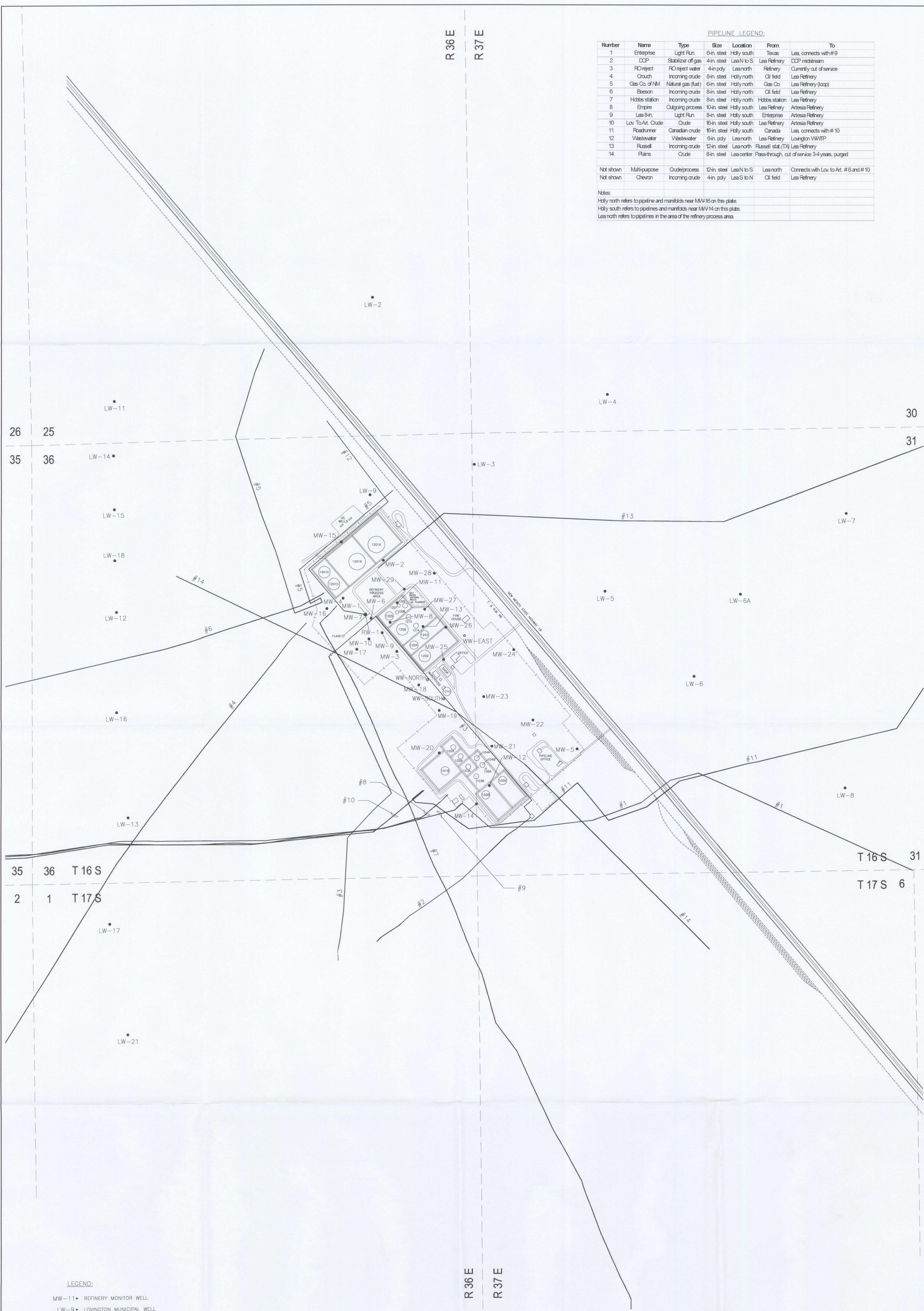

LEGEND:

MW-11 • REFINERY MONITOR WELL
LW-9 • LOVINGTON MUNICIPAL WELL

NOTES:

1. LOCATIONS OF REFINERY MONITOR (MW) AND WATER WELLS (WW) SURVEYED BY ASEL SURVEYING, HOBBS.
2. LOVINGTON MUNICIPAL WELLS (LW) LOCATED BY GPS AND CONFIRMED BY CITY WATER SUPERINTENDENT.
3. FOR NAVAJO/HOLLY PIPELINE INFORMATION SEE TABLE 7, NOVEMBER 15, 2010 ENVIRONMENTAL STATUS REPORT.
4. NOT SHOWN ARE PIPELINES CONTROLLED BY OTHER OPERATORS WHICH ARE NOT WITHIN OR ADJACENT TO THE REFINERY.

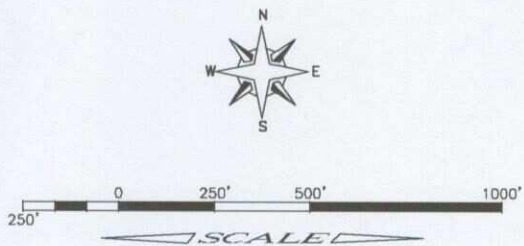

DRAWING TITLE				NAVAJO REFINING CO. LEA REFINERY LOVINGTON, NM	
PLATE 2 PIPELINE LOCATIONS NAVAJO LEA REFINERY AND VICINITY		DATE OF EJS 11-15-10	DATE BY DB 11-15-10	SCALE 1" = 500'-0"	PROJECT NUMBER Lovington03 Plate.dwg 0