

DATE <u>4/15/11</u>	SUSPENSE	ENGINEER <u>WJ</u>	LOGGED IN <u>4/15/11</u>	TYPE <u>SWD</u>	APP NO. <u>1110546847</u>
---------------------	----------	--------------------	--------------------------	-----------------	---------------------------

ABOVE THIS LINE FOR DIVISION USE ONLY

NEW MEXICO OIL CONSERVATION DIVISION

- Engineering Bureau -

1220 South St. Francis Drive, Santa Fe, NM 87505



PTG-W
1286
COG 229137
2011 APR 30
Maljamar SWD 302
12:33

ADMINISTRATIVE APPLICATION CHECKLIST

THIS CHECKLIST IS MANDATORY FOR ALL ADMINISTRATIVE APPLICATIONS FOR EXCEPTIONS TO DIVISION RULES AND REGULATIONS WHICH REQUIRE PROCESSING AT THE DIVISION LEVEL IN SANTA FE

Application Acronyms:

[NSL-Non-Standard Location] [NSP-Non-Standard Proration Unit] [SD-Simultaneous Dedication]
[DHC-Downhole Commingling] [CTB-Lease Commingling] [PLC-Pool/Lease Commingling]
[PC-Pool Commingling] [OLS - Off-Lease Storage] [OLM-Off-Lease Measurement]
[WFX-Waterflood Expansion] [PMX-Pressure Maintenance Expansion]
[SWD-Salt Water Disposal] [IPI-Injection Pressure Increase]
[EOR-Qualified Enhanced Oil Recovery Certification] [PPR-Positive Production Response]

[1] TYPE OF APPLICATION - Check Those Which Apply for [A]

[A] Location - Spacing Unit - Simultaneous Dedication
☐ NSL ☐ NSP ☐ SD

Check One Only for [B] or [C]

[B] Commingling - Storage - Measurement
☐ DHC ☐ CTB ☐ PLC ☐ PC ☐ OLS ☐ OLM

[C] Injection - Disposal - Pressure Increase - Enhanced Oil Recovery
☐ WFX ☐ PMX ☒ SWD ☐ IPI ☐ EOR ☐ PPR

[D] Other: Specify _____

Fed.
Lea

[2] NOTIFICATION REQUIRED TO: - Check Those Which Apply, or Does Not Apply

[A] ☐ Working, Royalty or Overriding Royalty Interest Owners
[B] ☐ Offset Operators, Leaseholders or Surface Owner
[C] ☐ Application is One Which Requires Published Legal Notice
[D] ☐ Notification and/or Concurrent Approval by BLM or SLO
U.S. Bureau of Land Management - Commissioner of Public Lands, State Land Office
[E] ☒ For all of the above, Proof of Notification or Publication is Attached, and/or,
[F] ☐ Waivers are Attached

4/30/11/5/32E

[3] SUBMIT ACCURATE AND COMPLETE INFORMATION REQUIRED TO PROCESS THE TYPE OF APPLICATION INDICATED ABOVE.

[4] **CERTIFICATION:** I hereby certify that the information submitted with this application for administrative approval is **accurate** and **complete** to the best of my knowledge. I also understand that **no action** will be taken on this application until the required information and notifications are submitted to the Division.

Note: Statement must be completed by an individual with managerial and/or supervisory capacity.

Mark A. Fairchild
Print or Type Name

Mark A. Fairchild
Signature

Senior Operations Engineer 2/28/2011
Title Date

MFairchild@Conchoresources.com
e-mail Address

APPLICATION FOR AUTHORIZATION TO INJECT

- I. PURPOSE: _____ Secondary Recovery _____ Pressure Maintenance ☒ Disposal _____ Storage
Application qualifies for administrative approval? _____ Yes _____ No
- II. OPERATOR: **COG Operating, LLC.**
ADDRESS: **550 West Texas, Ste 100, Midland TX 79701-4287**
CONTACT PARTY: **Mark A. Fairchild** PHONE: **432-686-3021**
- III. WELL DATA: Complete the data required on the reverse side of this form for each well proposed for injection.
Additional sheets may be attached if necessary.
- IV. Is this an expansion of an existing project? _____ Yes ☒ No
If yes, give the Division order number authorizing the project: _____
- V. Attach a map that identifies all wells and leases within two miles of any proposed injection well with a one-half mile radius circle drawn around each proposed injection well. This circle identifies the well's area of review.
- VI. Attach a tabulation of data on all wells of public record within the area of review which penetrate the proposed injection zone. Such data shall include a description of each well's type, construction, date drilled, location, depth, record of completion, and a schematic of any plugged well illustrating all plugging detail.
- VII. Attach data on the proposed operation, including:
1. Proposed average and maximum daily rate and volume of fluids to be injected;
 2. Whether the system is open or closed;
 3. Proposed average and maximum injection pressure;
 4. Sources and an appropriate analysis of injection fluid and compatibility with the receiving formation if other than reinjected produced water; and,
 5. If injection is for disposal purposes into a zone not productive of oil or gas at or within one mile of the proposed well, attach a chemical analysis of the disposal zone formation water (may be measured or inferred from existing literature, studies, nearby wells, etc.).
- *VIII. Attach appropriate geologic data on the injection zone including appropriate lithologic detail, geologic name, thickness, and depth. Give the geologic name, and depth to bottom of all underground sources of drinking water (aquifers containing waters with total dissolved solids concentrations of 10,000 mg/l or less) overlying the proposed injection zone as well as any such sources known to be immediately underlying the injection interval.
- IX. Describe the proposed stimulation program, if any.
- *X. Attach appropriate logging and test data on the well. (If well logs have been filed with the Division, they need not be resubmitted).
- *XI. Attach a chemical analysis of fresh water from two or more fresh water wells (if available and producing) within one mile of any injection or disposal well showing location of wells and dates samples were taken.
- XII. Applicants for disposal wells must make an affirmative statement that they have examined available geologic and engineering data and find no evidence of open faults or any other hydrologic connection between the disposal zone and any underground sources of drinking water.
- XIII. Applicants must complete the "Proof of Notice" section on the reverse side of this form.
- XIV. Certification: I hereby certify that the information submitted with this application is true and correct to the best of my knowledge and belief.
- NAME: **Mark A. Fairchild** TITLE: **Sr. Operations Engr.**
SIGNATURE: Mark A. Fairchild DATE: **3/3/2010**
E-MAIL ADDRESS: **MFairchild@Conchoresources.com**
- * If the information required under Sections VI, VIII, X, and XI above has been previously submitted, it need not be resubmitted. Please show the date and circumstances of the earlier submittal: _____

III. WELL DATA

- A. The following well data must be submitted for each injection well covered by this application. The data must be both in tabular and schematic form and shall include:

- (1) Lease name; Well No.; Location by Section, Township and Range; and footage location within the section.
- (2) Each casing string used with its size, setting depth, sacks of cement used, hole size, top of cement, and how such top was determined.
- (3) A description of the tubing to be used including its size, lining material, and setting depth.
- (4) The name, model, and setting depth of the packer used or a description of any other seal system or assembly used.

Division District Offices have supplies of Well Data Sheets which may be used or which may be used as models for this purpose. Applicants for several identical wells may submit a "typical data sheet" rather than submitting the data for each well.

- B. The following must be submitted for each injection well covered by this application. All items must be addressed for the initial well. Responses for additional wells need be shown only when different. Information shown on schematics need not be repeated.

- (1) The name of the injection formation and, if applicable, the field or pool name.
- (2) The injection interval and whether it is perforated or open-hole.
- (3) State if the well was drilled for injection or, if not, the original purpose of the well.
- (4) Give the depths of any other perforated intervals and detail on the sacks of cement or bridge plugs used to seal off such perforations.
- (5) Give the depth to and the name of the next higher and next lower oil or gas zone in the area of the well, if any.

XIV. PROOF OF NOTICE

All applicants must furnish proof that a copy of the application has been furnished, by certified or registered mail, to the owner of the surface of the land on which the well is to be located and to each leasehold operator within one-half mile of the well location.

Where an application is subject to administrative approval, a proof of publication must be submitted. Such proof shall consist of a copy of the legal advertisement which was published in the county in which the well is located. The contents of such advertisement must include:

- (1) The name, address, phone number, and contact party for the applicant;
- (2) The intended purpose of the injection well; with the exact location of single wells or the Section, Township, and Range location of multiple wells;
- (3) The formation name and depth with expected maximum injection rates and pressures; and,
- (4) A notation that interested parties must file objections or requests for hearing with the Oil Conservation Division, 1220 South St. Francis Dr., Santa Fe, New Mexico 87505, within 15 days.

NO ACTION WILL BE TAKEN ON THE APPLICATION UNTIL PROPER PROOF OF NOTICE HAS BEEN SUBMITTED.

NOTICE: Surface owners or offset operators must file any objections or requests for hearing of administrative applications within 15 days from the date this application was mailed to them.

INJECTION WELL DATA SHEET

OPERATOR: **COG Operating, LLC.**WELL NAME & NUMBER: **Maljamar SWD 30 #2**WELL LOCATION: **1350 FNL; 770 FEL**UNIT LETTER **H** SECTION **30** TOWNSHIP **17S** RANGE **32E**

FOOTAGE LOCATION

WELLBORE SCHEMATIC

*Cement volumes will increase of those shown on this application to account for hole conditions unknown at this time.

WELL CONSTRUCTION DATASurface CasingHole Size: **17 1/2"** Casing Size: **13 3/8"**Cemented with: _____ sx. **or 278** ft³Top of Cement: **Surface** Method Determined: **Circulate**Intermediate CasingHole Size: **12 1/4"** Casing Size: **9 5/8"**Cemented with: _____ sx. **or 1,253** ft³Top of Cement: **Surface** Method Determined: **Circulate**Production CasingHole Size: **8 3/4"** Casing Size: **7"**Cemented with: _____ sx. **or 1,614** ft³Top of Cement: **Surface** Method Determined: **Circulate**Total Depth: **10,300'**

7" Long String Set @ 10,300'

Injection Interval**Jet perforated: 9,550 feet to 9,850'**

(Perforated or Open Hole; indicate which)

INJECTION WELL DATA SHEET

Tubing Size: **3 1/2" EUE** Lining Material: **Internally plastic coated**

Type of Packer: **Double grip type, set in neutral**

Packer Setting Depth: **no more than 100' above top perf**

Other Type of Tubing/Casing Seal (if applicable): **N/A**

Additional Data

1. Is this a new well drilled for injection? **X** Yes **No**

If no, for what purpose was the well originally drilled?

2. Name of the Injection Formation: **Wolfcamp Reef**

3. Name of Field or Pool (if applicable): **None**

4. Has the well ever been perforated in any other zone(s)? List all such perforated intervals and give plugging detail, i.e. sacks of cement or plug(s) used.

No, none

5. Give the name and depths of any oil or gas zones underlying or overlying the proposed injection zone in this area:

San Andres @ 3,750' ; Yeso @ 5,425'



ATTACHMENT TO APPLICATION C-108

COG Operating Inc.
Maljamar SWD 30 #2
Sec. 30, T-17-S, R-32-E
Lea County, NM

- III. WELL DATA – See attached on reverse side of form as requested.
- V. MAP ATTACHED
- VI. LIST OF WELLS AND DATA ATTACHED.
- VII. PROPOSED OPERATIONS
 - 1. The injection volume will average 10,000 to 15,000 BWPD while the maximum injection volumes are expected to be 20,000 BWPD.
 - 2. This will be a closed loop system.
 - 3. Proposed average injection pressure: Vacuum
Proposed maximum injection pressure: 1900 psig
 - 4. Analysis attached, only produced water.
 - 5. This well is not yet drilled. COG will swab the formation and recover fluid samples for analysis and reporting to NMOCD. Research disposal zone formation water and attach and chemical analysis.
- VIII. SEE ATTACHED
- IX. SEE ATTACHED
- X. Logging and test data will be run on the well when drilled.

- XI. No fresh water found or recorded by state engineer or OCD.
- XII. The disposal formation will have several thousand feet of overburden on top of it.

In these several thousands of feet of impermeable shale and evaporate zones of various thickness exists. These zones will stop any hydraulic communication between geologic strata.
- XIII. Notice (this application) has been sent to the surface owner (NMSLO) and to each leasehold operator within a half mile as required.

COG SENM SWD Well Questionnaires

Date: 2/28/11

By: Mark A. Fairchild, Office: 432-686-3021

Note: Answers to questions in this color

What will be the well name?

Maljamar SWD 30 #2

What logs have been/will be run in the well?

Logs will be run as follows: porosity and resistivity

How will you re-enter/drill/convert the well?

The well will be drilled 100% with rotary tools.

How will you test the mechanical integrity of the casing?

A State of New Mexico supervised MIT test to 500 psig will be run on the tubing/casing annulus.

What size tubing do you plan to use?

The tubing will be 3 1/2" Nominal OD.

How will tubing be internally lined?

The tubing will be internally plastic coated.

What type packer will be used?

A nickel plated compression set packer will be utilized.

Where will packer be set?

Within 50 to 100' above the top perforation.

Will there be any other type of casing/tubing seal?

No.

What is the fracture gradient?

Approx 0.75

Will the well be stimulated?

Yes

If yes, how will the well be stimulated?

Large conventional acid job.

Into what perforated intervals will you inject?

Wolfcamp Reef, between 9,500 and 9,700'

What will be the average daily volume injected?

10-15,000 BWPD

What will be the maximum daily volume injected?

20,000 BWPD

What will be the average injection pressure?

Vacuum

What will be the maximum injection pressure?

1900 psig

Will water be trucked or piped to the well?

Piped

What wells will dispose into it?

Various wells owned exclusively by COG on our SWD water line system

Any non-COG wells?

No outside operated water will be disposed of.

What surface facilities (e.g.; tanks, pumps, filters) will be installed?

4 - 750 Bbl water storage tanks, 1 - 1,000 Bbl Gun Barrel

2 - 500 Bbl steel tanks, 1 - 400 BHP H pump

Do you have an analysis of the produced water you plan to inject?

Yes

Do you have an analysis of the formation water into which you'll inject?

No, these well are on a vacuum and do not produce.

How will the geology prevent migration into fresh water zones (e.g., thickness of shale or salt layers)?

Various impervious geological barriers exist between the Wolfcamp and the surface.

Will the system be open or closed?

Closed

DISTRICT I
1625 N. FRENCH DR., HOBBS, NM 88240

DISTRICT II
1301 W. GRAND AVENUE, ARTESIA, NM 88210

DISTRICT III
1000 Rio Brazos Rd., Aztec, NM 87410

DISTRICT IV
1220 S. ST. FRANCIS DR., SANTA FE, NM 87505

State of New Mexico
Energy, Minerals and Natural Resources Department

OIL CONSERVATION DIVISION
1220 SOUTH ST. FRANCIS DR.
Santa Fe, New Mexico 87505

Form C-102
Revised October 12, 2005
Submit to Appropriate District Office
State Lease - 4 Copies
Fee Lease - 3 Copies

WELL LOCATION AND ACREAGE DEDICATION PLAT

☐ AMENDED REPORT

API Number		Pool Code	Pool Name
Property Code	Property Name MALJAMAR SWD 30		Well Number 2
OGRID No.	Operator Name COG OPERATING, LLC		Elevation 3917'

Surface Location

UL or lot No. H	Section 30	Township 17-S	Range 32-E	Lot Idn	Feet from the 1350	North/South line NORTH	Feet from the 770	East/West line EAST	County LEA
--------------------	---------------	------------------	---------------	---------	-----------------------	---------------------------	----------------------	------------------------	---------------

Bottom Hole Location If Different From Surface

UL or lot No.	Section	Township	Range	Lot Idn	Feet from the	North/South line	Feet from the	East/West line	County
Dedicated Acres		Joint or Infill	Consolidation Code	Order No.					

NO ALLOWABLE WILL BE ASSIGNED TO THIS COMPLETION UNTIL ALL INTERESTS HAVE BEEN CONSOLIDATED
OR A NON-STANDARD UNIT HAS BEEN APPROVED BY THE DIVISION

<p>GEODETIC COORDINATES NAD 27 NME Y=658466.4 N X=664111.2 E LAT.=32.809073° N LONG.=103.799193° W</p> <p>DETAIL 3920.2' 3923.6' 600' 600' 3918.3' 3924.3'</p> <p>1350' 770'</p>	<p>OPERATOR CERTIFICATION</p> <p><i>I hereby certify that the information herein is true and complete to the best of my knowledge and belief, and that this organization either owns a working interest or unleased mineral interest in the land including the proposed bottom hole location or has a right to drill this well at this location pursuant to a contract with an owner of such mineral or working interest, or to a voluntary pooling agreement or a compulsory pooling order heretofore entered by the division.</i></p> <p>Signature _____ Date _____</p> <p>Printed Name _____</p>
	<p>SURVEYOR CERTIFICATION</p> <p><i>I hereby certify that the well location shown on this plat was plotted from field notes of actual surveys made by me or under my supervision, and that the same is true and correct to the best of my belief.</i></p>
	<p>JANUARY 21, 2011</p> <p>Date Surveyed _____ LA</p> <p>Signature & Seal of Professional Surveyor <i>Ronald E. Eidson</i> 11.13.0518</p>
	<p>Certificate No. GARY EIDSON 12841 RONALD EIDSON 3239</p>

**SECTION 30, TOWNSHIP 17 SOUTH, RANGE 32 EAST, N.M.P.M.,
LEA COUNTY, NEW MEXICO**

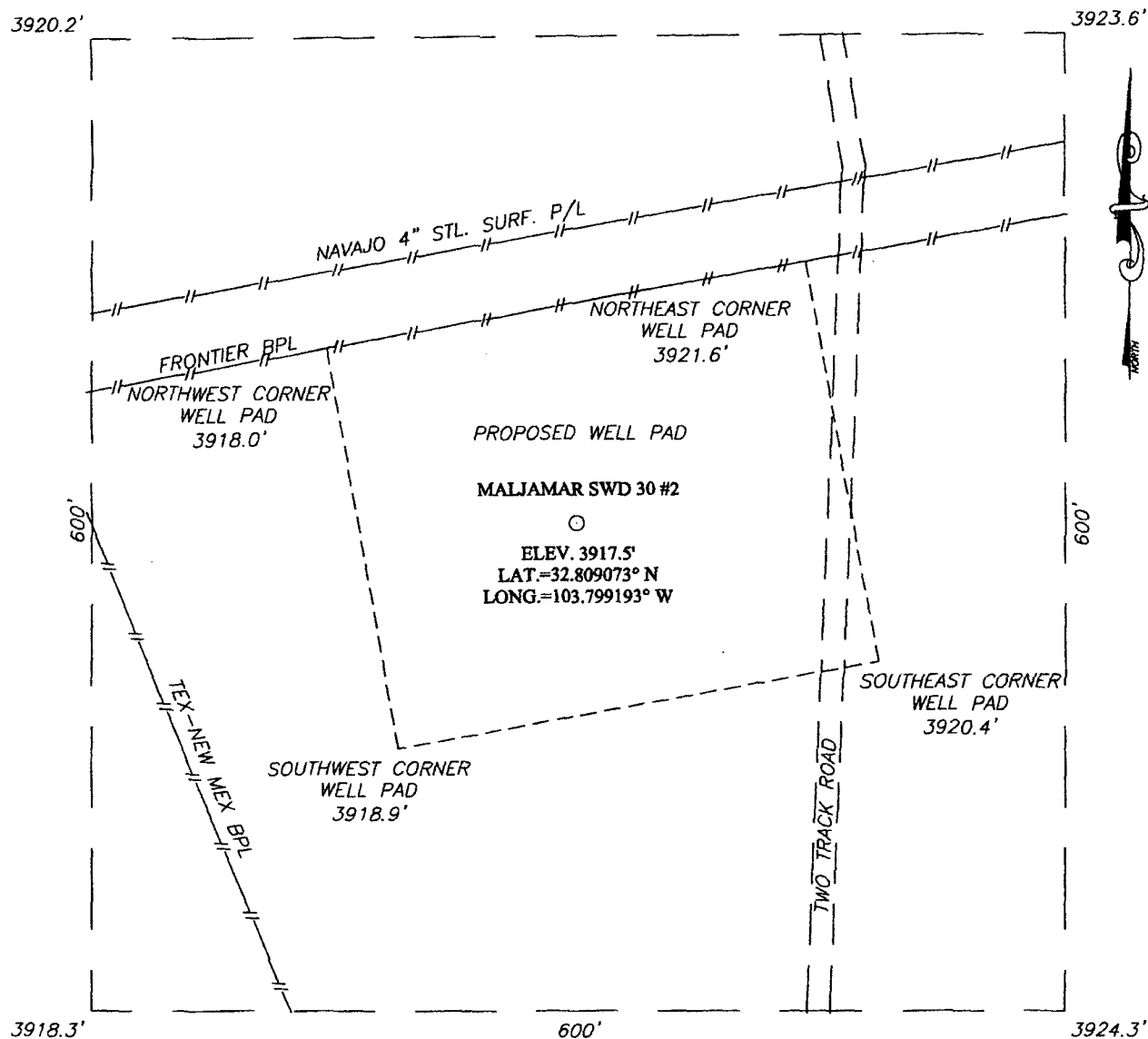

DIRECTIONS TO LOCATION

FROM THE INTERSECTION OF CONOCO ROAD AND CO.
RD. #126 (MALJAMAR RD) GO WEST APPROX. 2.0
MILES, TURN LEFT AND GO SOUTH APPROX. 0.8
MILES. THIS LOCATION IS APPROX. 150 FEET WEST.

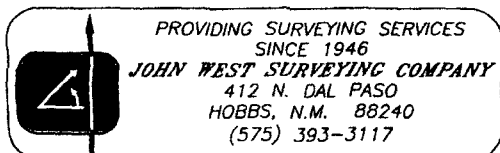
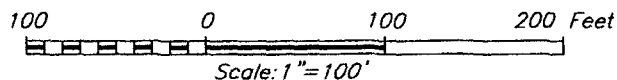

COG OPERATING, LLC

MALJAMAR SWD 30 #2 WELL
LOCATED 1350 FEET FROM THE NORTH LINE
AND 770 FEET FROM THE EAST LINE OF SECTION 30,
TOWNSHIP 17 SOUTH, RANGE 32 EAST, N.M.P.M.,
LEA COUNTY, NEW MEXICO.

Survey Date: 1/21/11	Sheet 1 of 1 Sheets
W.O. Number: 11.13.0518	Dr By: LA
Date: 2/1/11	REL: 11110183
11130518	Scale: 1"=100'

VICINITY MAP

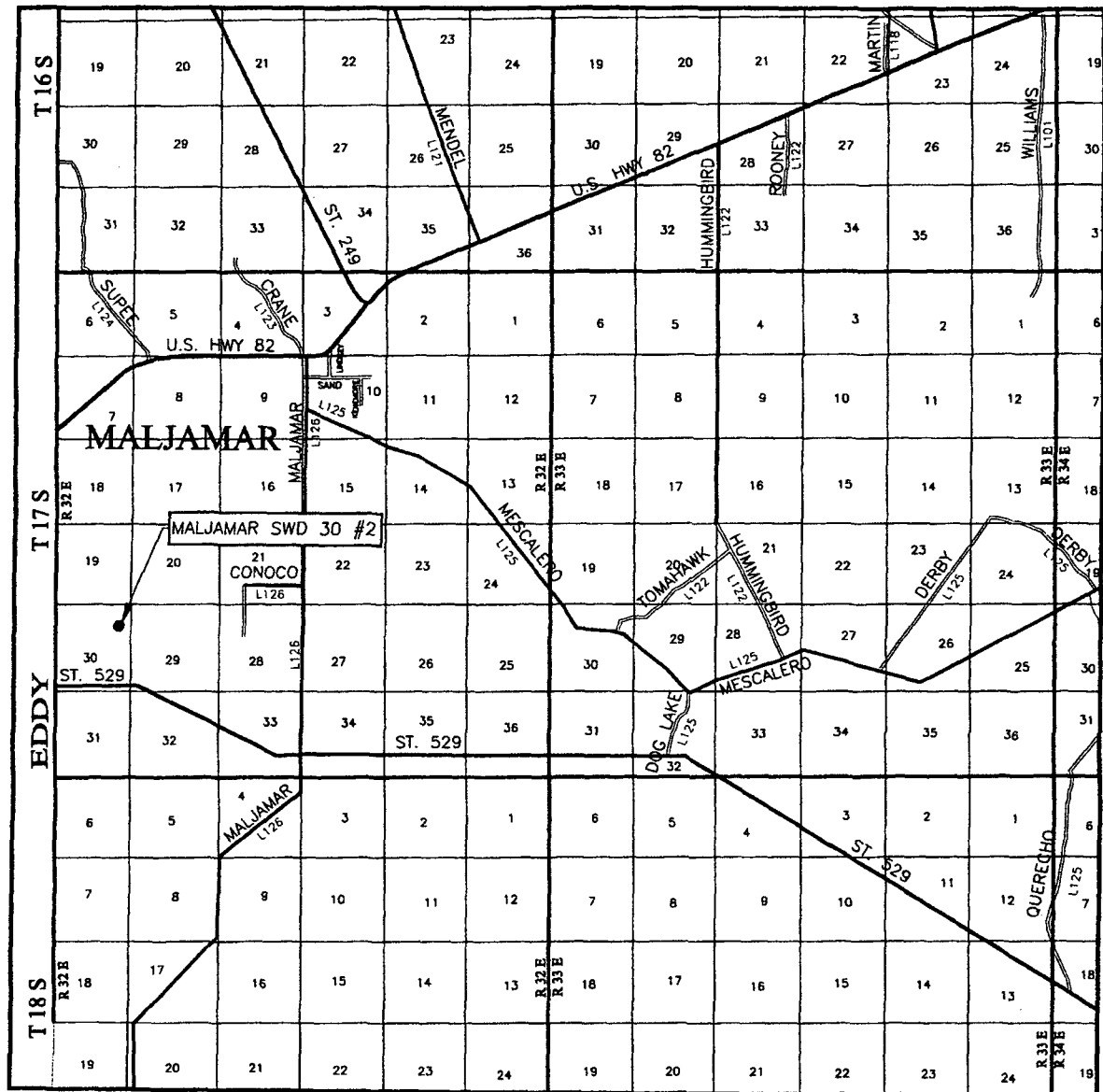

SCALE: 1" = 2 MILES

SEC. 30 TWP. 17-S RGE. 32-E

SURVEY N.M.P.M.

COUNTY LEA STATE NEW MEXICO

DESCRIPTION 1350' FNL & 770' FEL

ELEVATION 3917'

OPERATOR COG OPERATING, LLC

LEASE MALJAMAR SWD 30

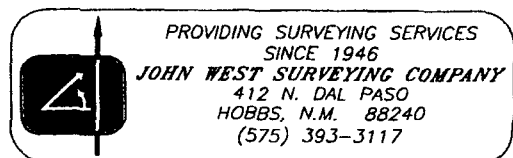

LOCATION VERIFICATION MAP

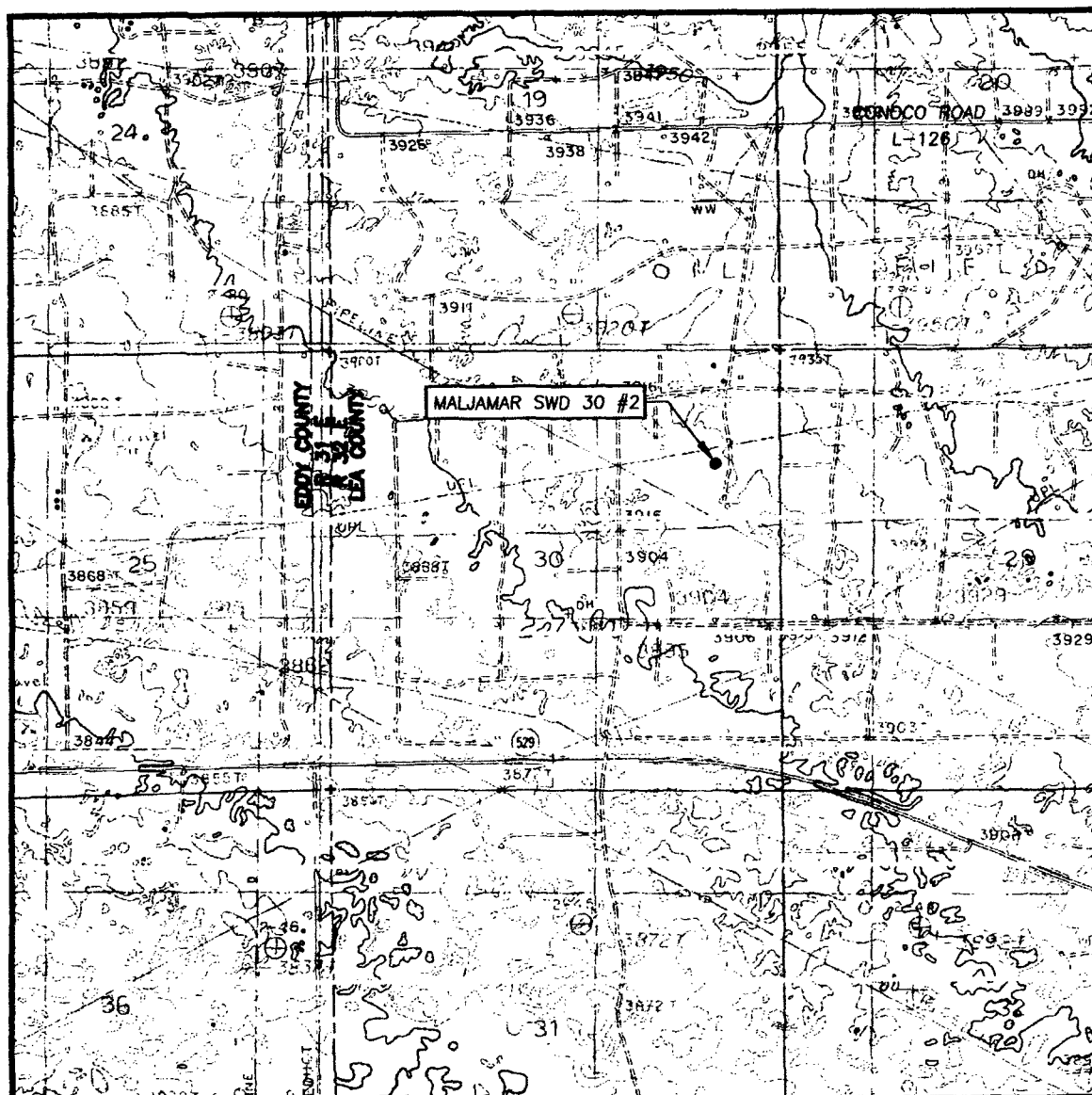

SCALE: 1" = 2000'

CONTOUR INTERVAL:
MALJAMAR, N.M. - 10'

SEC. 30 TWP. 17-S RGE. 32-E

SURVEY N.M.P.M.

COUNTY LEA STATE NEW MEXICO

DESCRIPTION 1350' FNL & 770' FEL

ELEVATION 3917'

OPERATOR COG OPERATING, LLC

LEASE MALJAMAR SWD 30

U.S.G.S. TOPOGRAPHIC MAP
MALJAMAR, N.M.

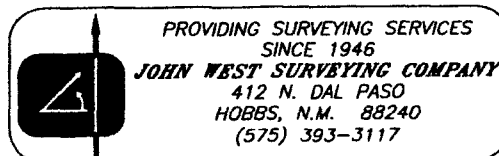

Jones, William V., EMNRD

From: Jones, William V., EMNRD
Sent: Sunday, May 29, 2011 7:06 PM
To: 'Mark Fairchild'; 'Tye Orr'
Cc: Ezeanyim, Richard, EMNRD; Kautz, Paul, EMNRD
Subject: Disposal application from COG Operating LLC: Maljamar SWD "30" #2 30-015-NA
Wolfcamp Reef

Hello Mark:

This application also....

Would you please let me know the depth range you want permitted for disposal into this proposed well?

The newspaper notice and parts of the application differ.

Also, please ask your geologist where the top of the Pennsylvanian is at this location.

This application is for a State well in Lea County. It appears there are no protests and this disposal permit will likely soon be granted.

Do you know if the APD and API number will be issued anytime soon?

Thank You,

William V. Jones, P.E.
Engineering, Oil Conservation Division
1220 South St. Francis Drive, Santa Fe, NM 87505
Tel 505.476.3448 ~ Fax 505.476.3462



Jones, William V., EMNRD

From: Mark Fairchild [MFairchild@conchoresources.com]
Sent: Tuesday, May 31, 2011 1:32 PM
To: Jones, William V., EMNRD
Cc: Ramon Reyes; Harvin Broughton; Robyn Odom; Kelly Holly
Subject: Questions
Attachments: COG SENM SWD Drilling Short Prognosis Maljamar SWD 30 #2.xlsx; COG SENM SWD Drilling Short Prognosis Loco Hills SWD 34 #5.xlsx; COG SENM SWD Drilling Short Prognosis Loco Hills SWD 33 #6.xlsx

Will in answer to your questions on the wells:

1. Attached are our Short form prognosis on each of the wells. The Penn top would be the same as that shown for the Cisco.
2. None of these wells is anticipated to be completed in any but the Wolfcamp reef intervals shown here and on the C-108.
3. Lemme no if this helps.

M.A. Fairchild

COG OPERATING LLC

Office: 432-686-3021

Cell: 432-230-7170



CONFIDENTIALITY NOTICE: The information in this email may be confidential and/or privileged. If you are not the intended recipient or an authorized representative of the intended recipient, you are hereby notified that any review, dissemination or copying of this email and its attachments, if any, or the information contained herein, is prohibited. If you have received this email in error, please immediately notify the sender by return email and delete this email from your system. Thank you.

COG SENM SWD Drilling

Well: Maljamar SWD 30 #2
Location: 1350 FNL; 770 FEL, Unit Ltr. H, Sec 30, T17S, R32E, Lea Co., NM
API:
Permits:
Regulatory: NMOCD: BLM: State Well
Notice Requirements:

Objective: Drill and complete as a Wolfcamp reef SWD well. 7" L-80 casing set through the disposal interval.

Summary of Conduct of Operations:

1. Main Objective: Wolfcamp reef SWD well.
2. Offset wells have encountered few to no drilling hazards.

Geology:	Rustler	700'	Wolfcamp	9000'	Primary Objective
	Yates	2025'	Wolfcamp Reef	9500'	
	Queen	3000'	Cisco	9700'	
	San Andres	3750'	Cisco Reef	10,000'	
	Yeso	5425'			
	Tubb	6950'			
	Abo	7550'			

Logging Program: See Geological prog, attached.

Bit & Casing Program:	Casing					
	Bit Size	Size	Wt	Grd	Connection	Footage
	17 1/2"	13 3/8"	48 ppf	H40	STC	+/- 400'
	12 1/4"	9 5/8"	36 ppf	J55	STC	3400'
			40 ppf	J55	STC	600'
					Total 9 5/8"	4000'
	8 3/4"	7"	26 ppf	L80	LTC	10000'
	8 3/4"	7"	26 ppf	L80-HCL	LTC	300'
					Total 7"	10,300'

Special Req:

1. Sand blast bottom 1500' of 7".
2. DV Tool at 8,000'
3. Two, 3, short joints, on top of DV and one as landing joint.

Cementing Program: Vendor: Rising Star Services
 See attached Cementing Data Sheet

Cementing Hardware: Weatherford (Gemco) w/ PDC drillable on all floats and collars.

Well Control: All BOP's tested to 2000 psig by thrid party.

Mud System: Closed loop

Hole	From	To	Type	Wt	Vis
Surface	40	200	Fresh, Spud	8.9-9.4	32-34
Intermediate	400	4,000	Brine	9.8-10.2	28-30
Production	4,000	10,300	Fresh Water	8.4-8.8	28

Wellhead: see attached, Downing

[illegible]

Empire State SWD 9 #4

Wells within area of review that penetrate proposed disposal interval:

None

Empire Federal SWD 10 #5

Wells within area of review that penetrate proposed disposal interval:

None

Maljamar SWD 30 #2

Wells within area of review that penetrate proposed disposal interval:

API #: 3002520588 Well_Name: SOUTH MALJAMAR DEEP Property Number.: 001
Location: O-30-17.0S-32E, 330 FSL, 1650 FEL Lat:32.7992703506 Long:-103.80260797
Operator Name: HARVEY E YATES CO County: Lea
Land Type: Federal Well Type: Oil Spud Date:1/1/1900 1 Plug Date:1/1/1900 1
Elevation GL: 0 Depth TVD: 10128

Harvey E Yates Co.

South Maljamar Deep #1

Lease & Well #

~~Maljamar SWD 30 #2~~

3002520588

Lea Co., NM

SPUD - 8/10/1976

Sec 30 T17S R32E 330 FsL & 1650 FEL

Elevation - 3883' GR

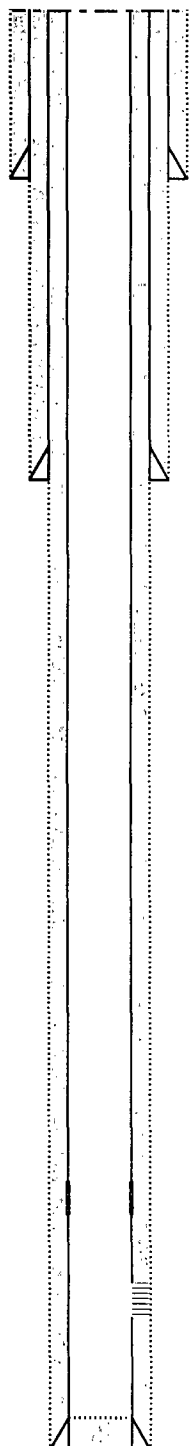

13 3/8" 48 # H-40 @ 302', 300 sx C, circ.

8 5/8" 24 & 32# 8rd J-55 STC @ 4,221', cmt w/550 sx
TOC not found in records.

DV tool @ 8000'

Abo

8938-60' 12 holes. Squeezed off w/100 sx

8940-60' reperforated 10 holes. Acidized w/6,000 gal 15% HCL

1st stage cmt: 265 sx 50/50/2 H, circ 65 sx off DV tool. ✓

2nd stage cmt: 350 sx h/l, 725 sx 50/50/2 C TOC not in records.

4 1/2" 10.5# & 11.6# K-55 STC csg @ 8985' GR.

Maljamar SWD 30 #2

Wells within area of review that penetrate proposed disposal interval:

API #: 3002520588 **Well_Name:** SOUTH MALJAMAR DEEP **Property Number.:** 001
Location: O-30-17.0S-32E, 330 FSL, 1650 FEL **Lat:**32.7992703506 **Long:-** 103.80260797
Operator Name: HARVEY E YATES CO **County:** Lea
Land Type: Federal **Well Type:** Oil **Spud Date:**1/1/1900 1 **Plug Date:**1/1/1900 1
Elevation GL: 0 **Depth TVD:** 10128

Wells within area of review that do not penetrate proposed disposal interval:

API #: 3002523798 **Well_Name:** MCA UNIT **Property Number.:** 290
Location: D-29-17.0S-32E, 1295 FNL, 1295 FWL **Lat:**32.8092955151 **Long:-** 103.79299049
Operator Name: CONTINENTAL OIL **County:** Lea
Land Type: Federal **Well Type:** Oil **Spud Date:**1/1/1900 1 **Plug Date:**1/1/1900 1
Elevation GL: 0 **Depth TVD:** 0

API #: 3002500758 **Well_Name:** MCA UNIT # 110
Location: C-29-17.0S-32E, 660 FNL, 1980 FWL **Lat:**32.8110401722 **Long:-** 103.790752734
Operator Name: CONOCO INC [[Operator and Lessee Info](#)] **County:** Lea
Land Type: Federal **Well Type:** Oil **Spud Date:**7/16/1940 **Plug Date:**4/24/2000
Elevation GL: 3937 **Depth TVD:** 4073
Pools associated:

API #: 3002523778 **Well_Name:** MCA UNIT # 288
Location: D-29-17.0S-32E, 65 FNL, 1295 FWL **Lat:**32.8126762863 **Long:-** 103.792994925
Operator Name: CONOCO INC [[Operator and Lessee Info](#)] **County:** Lea
Land Type: Federal **Well Type:** Oil **Spud Date:** **Plug Date:**6/1/1993 1
Elevation GL: **Depth TVD:**

API #: 3002500760 **Well_Name:** MCA UNIT **Property Number.:** 157
Location: F-29-17.0S-32E , 1980 FNL, 1980 FWL **Lat:**32.8074120273 **Long:-**
103.790747924
Operator Name: CONOCO INC **County:** Lea
Land Type: Federal **Well Type:** Injection **Spud Date:** **Plug Date:**6/29/1990
Elevation GL: **Depth TVD:**

API #: 3002500761 **Well_Name:** MCA UNIT # 158
Location: E-29-17.0S-32E , 1980 FNL, 660 FWL **Lat:**32.8074133299 **Long:-**
103.795064508
Operator Name: CONOCO INC [Operator and Lessee Info] **County:** Lea
Land Type: Federal **Well Type:** Oil **Spud Date:**10/8/1940 **Plug Date:**9/6/1997
1
Elevation GL: 3926 **Depth TVD:** 3779
Pools associated:

API #: 3002535184 **Well_Name:** MCA UNIT **Property Number.:** 389
Location: E-29-17.0S-32E , 2300 FNL, 1000 FWL **Lat:**32.8065334573 **Long:-**
103.793951483
Operator Name: CONOCO INC **County:** Lea
Land Type: Federal **Well Type:** Oil **Spud Date:** **Plug Date:**
Elevation GL: 3930 **Depth TVD:** 0

API #: 3002523707 **Well_Name:** MCA UNIT # 270
Location: F-29-17.0S-32E , 2615 FNL, 1345 FWL **Lat:**32.8056673202 **Long:-**
103.792822125
Operator Name: CONOCOPHILLIPS COMPANY [Operator and Lessee Info
] **County:** Lea
Land Type: Federal **Well Type:** Oil **Spud Date:** **Plug Date:**
Elevation GL: **Depth TVD:** 4130
Pools associated:

API #: 3002500755 **Well_Name:** MCA UNIT # 169
Location: L-29-17.0S-32E , 1980 FSL, 660 FWL **Lat:**32.8037915417 **Long:-**
103.795059757
Operator Name: CONOCOPHILLIPS COMPANY [Operator and Lessee Info
] **County:** Lea
Land Type: Federal **Well Type:** Injection **Spud Date:** **Plug Date:**
Elevation GL: **Depth TVD:** 3935
Pools associated:

API #: 3002523767 **Well_Name:** MCA UNIT # 293
Location: K-29-17.0S-32E, 1345 FSL, 1345 FWL **Lat:**32.8020431265 **Long:-**
103.792817467
Operator Name: CONOCO INC [[Operator and Lessee Info](#)] **County:** Lea
Land Type: Federal **Well Type:** Oil **Spud Date:** **Plug Date:**2/18/1998
Elevation GL: **Depth TVD:**
Pools associated:

API #: 3002500756 **Well_Name:** MCA UNIT # 214
Location: M-29-17.0S-32E, 660 FSL, 660 FWL **Lat:**32.8001633888 **Long:-**
103.795055097
Operator Name: CONOCO INC [[Operator and Lessee Info](#)] **County:** Lea
Land Type: Federal **Well Type:** Oil **Spud Date:** **Plug Date:**10/6/1997
Elevation GL: **Depth TVD:**
Pools associated:

API #: 3002500754 **Well_Name:** MCA UNIT # 170
Location: K-29-17.0S-32E, 1980 FSL, 1980 FWL **Lat:**32.8037855647 **Long:-**
103.790743168
Operator Name: CONOCOPHILLIPS COMPANY [[Operator and Lessee Info](#)
] **County:** Lea
Land Type: Federal **Well Type:** Oil **Spud Date:** **Plug Date:**
Elevation GL: **Depth TVD:** 3964
Pools associated:

API #: 3002500758 **Well_Name:** MCA UNIT # 110
Location: C-29-17.0S-32E, 660 FNL, 1980 FWL **Lat:**32.8110401722 **Long:-**
103.790752734
Operator Name: CONOCO INC [[Operator and Lessee Info](#)] **County:** Lea
Land Type: Federal **Well Type:** Oil **Spud Date:**7/16/1940 **Plug**
Date:4/24/2000
Elevation GL: 3937 **Depth TVD:** 4073
Pools associated:

API #: 3002512764 **Well_Name:** MCA UNIT # 099
Location: P-19-17.0S-32E, 25 FSL, 25 FEL **Lat:**32.8129250562 **Long:-**
103.797311858
Operator Name: CONOCOPHILLIPS COMPANY [[Operator and Lessee Info](#)
] **County:** Lea
Land Type: Federal **Well Type:** Oil **Spud Date:**1/7/1947 **Plug**
Date:3/16/2007
Elevation GL: 3936 **Depth TVD:** 3986
Pools associated:

API #: 3002508069 **Well_Name:** MCA UNIT # 098
Location: M-20-17.0S-32E , 660 FSL, 660 FWL **Lat:**32.8146696148 **Long:-**
103.795074029
Operator Name: CONOCO INC [Operator and Lessee Info] **County:** Lea
Land Type: Federal **Well Type:** Oil **Spud Date:** **Plug Date:**11/22/1999
Elevation GL: **Depth TVD:**
Pools associated:

API #: 3002523673 **Well_Name:** MCA UNIT # 264
Location: I-19-17.0S-32E , 1345 FSL, 25 FEL **Lat:**32.8165532089 **Long:-**
103.797317215
Operator Name: CONOCOPHILLIPS COMPANY [Operator and Lessee Info
] **County:** Lea
Land Type: Federal **Well Type:** Oil **Spud Date:** **Plug Date:**
Elevation GL: **Depth TVD:** 4060
Pools associated:

API #: 3002508035 **Well_Name:** MCA UNIT # 060
Location: I-19-17.0S-32E , 1980 FSL, 660 FEL **Lat:**32.8183028463 **Long:-**
103.799396671
Operator Name: CONOCOPHILLIPS COMPANY [Operator and Lessee Info
] **County:** Lea
Land Type: Federal **Well Type:** Oil **Spud Date:**4/9/1946 1 **Plug Date:**
Elevation GL: **Depth TVD:** 3725
Pools associated:

API #: 3002508032 **Well_Name:** MCA UNIT # 259
Location: I-19-17.0S-32E , 1980 FSL, 860 FEL **Lat:**32.8183041932 **Long:-**
103.800050806
Operator Name: CONOCO INC [Operator and Lessee Info] **County:** Lea
Land Type: Federal **Well Type:** Oil **Spud Date:**3/8/1971 1 **Plug**
Date:7/23/1996
Elevation GL: 3949 **Depth TVD:** 5288
Pools associated:

API #: 3002523739 **Well_Name:** MCA UNIT # 279
Location: P-19-17.0S-32E , 1295 FSL, 1295 FEL **Lat:**32.8164243312 **Long:-**
103.801470769
Operator Name: CONOCO INC [Operator and Lessee Info] **County:** Lea
Land Type: Federal **Well Type:** Oil **Spud Date:**4/10/1971 **Plug**
Date:9/20/1995
Elevation GL: 3933 **Depth TVD:** 4050
Pools associated:

API #: 3002508042 **Well_Name:** MCA UNIT # 059
Location: J-19-17.0S-32E, 1980 FSL, 1980 FEL **Lat:**32.8183116329 **Long:-**
103.803713961
Operator Name: CONOCOPHILLIPS COMPANY [Operator and Lessee Info
] **County:** Lea
Land Type: Federal **Well Type:** Injection **Spud Date:**5/25/1942 **Plug**
Date:9/22/2004
Elevation GL: 3938 **Depth TVD:** 3995
Pools associated:

API #: 3002523745 **Well_Name:** MCA UNIT # 285
Location: J-19-17.0S-32E, 1345 FSL, 2615 FEL **Lat:**32.8165704514 **Long:-**
103.805788263
Operator Name: CONOCOPHILLIPS COMPANY [Operator and Lessee Info
] **County:** Lea
Land Type: Federal **Well Type:** Oil **Spud Date:** **Plug Date:**
Elevation GL: **Depth TVD:** 4060
Pools associated:

API #: 3002508043 **Well_Name:** MCA UNIT # 101
Location: O-19-17.0S-32E, 660 FSL, 1980 FEL **Lat:**32.8146834809 **Long:-**
103.803708604
Operator Name: CONOCO INC [Operator and Lessee Info] **County:** Lea
Land Type: Federal **Well Type:** Oil **Spud Date:**11/12/1941 **Plug**
Date:9/26/1995
Elevation GL: **Depth TVD:** 3695
Pools associated:

API #: 3002523732 **Well_Name:** MCA UNIT # 276
Location: P-19-17.0S-32E, 25 FSL, 1295 FEL **Lat:**32.8129336085 **Long:-**
103.801465615
Operator Name: CONOCOPHILLIPS COMPANY [Operator and Lessee Info
] **County:** Lea
Land Type: Federal **Well Type:** Oil **Spud Date:** **Plug Date:**
Elevation GL: **Depth TVD:** 4030
Pools associated:

API #: 3002512762 **Well_Name:** MCA UNIT # 106
Location: C-30-17.0S-32E, 50 FNL, 2635 FWL **Lat:**32.8127363924 **Long:-**
103.805901094
Operator Name: CONOCOPHILLIPS COMPANY [Operator and Lessee Info
] **County:** Lea
Land Type: Federal **Well Type:** Injection **Spud Date:** **Plug Date:**3/21/2006
Elevation GL: **Depth TVD:** 3975
Pools associated:

API #: 3002523848 **Well_Name:** MCA UNIT # 286
Location: M-19-17.0S-32E, 25 FSL, 1295 FWL **Lat:**32.812951342 **Long:-**
103.810282716
Operator Name: CONOCOPHILLIPS COMPANY [[Operator and Lessee Info](#)
] **County:** Lea
Land Type: Federal **Well Type:** Oil **Spud Date:** **Plug Date:**
Elevation GL: **Depth TVD:** 4070
Pools associated:

API #: 3002500769 **Well_Name:** MCA UNIT # 107
Location: B-30-17.0S-32E, 660 FNL, 1980 FEL **Lat:**32.8110553227 **Long:-**
103.803702502
Operator Name: CONOCOPHILLIPS COMPANY [[Operator and Lessee Info](#)
] **County:** Lea
Land Type: Federal **Well Type:** Injection **Spud Date:** **Plug Date:**2/22/2005
Elevation GL: **Depth TVD:** 4010
Pools associated:

API #: 3002524057 **Well_Name:** MCA UNIT # 306
Location: B-30-17.0S-32E, 1295 FNL, 2615 FEL **Lat:**32.8093141366 **Long:-**
103.805776756
Operator Name: CONOCOPHILLIPS COMPANY [[Operator and Lessee Info](#)
] **County:** Lea
Land Type: Federal **Well Type:** Oil **Spud Date:** **Plug Date:**
Elevation GL: **Depth TVD:** 4020
Pools associated:

API #: 3002500782 **Well_Name:** MCA UNIT # 216
Location: O-30-17.0S-32E, 660 FSL, 1980 FEL **Lat:**32.8001795626 **Long:-**
103.803688284
Operator Name: CONOCOPHILLIPS COMPANY [[Operator and Lessee Info](#)
] **County:** Lea
Land Type: Federal **Well Type:** Oil **Spud Date:** **Plug Date:**3/21/2007
Elevation GL: **Depth TVD:** 4090
Pools associated:

API #: 3002524056 **Well_Name:** MCA UNIT # 305
Location: J-30-17.0S-32E, 1345 FSL, 2615 FEL **Lat:**32.8020665373 **Long:-**
103.805767245
Operator Name: CONOCOPHILLIPS COMPANY [[Operator and Lessee Info](#)
] **County:** Lea
Land Type: Federal **Well Type:** Oil **Spud Date:** **Plug Date:**
Elevation GL: **Depth TVD:** 4100
Pools associated:

API #: 3002500772 **Well_Name:** MCA UNIT # 165
Location: K-30-17.0S-32E, 1980 FSL, 1980 FWL **Lat:**32.8038166083 **Long:-**
103.808029963
Operator Name: CONOCOPHILLIPS COMPANY [Operator and Lessee Info
] **County:** Lea
Land Type: Federal **Well Type:** Oil **Spud Date:** **Plug Date:**
Elevation GL: **Depth TVD:** 3965
Pools associated:

API #: 3002523855 **Well_Name:** MCA UNIT # 297
Location: F-30-17.0S-32E, 2615 FNL, 1375 FWL **Lat:**32.8056945065 **Long:-**
103.81001117
Operator Name: CONOCO INC [Operator and Lessee Info] **County:** Lea
Land Type: Federal **Well Type:** Oil **Spud Date:**8/20/1971 **Plug**
Date:11/11/1994
Elevation GL: **Depth TVD:**
Pools associated:

API #: 3002500774 **Well_Name:** MCA UNIT # 217
Location: N-30-17.0S-32E, 660 FSL, 1980 FWL **Lat:**32.8001884462 **Long:-**
103.808024656
Operator Name: CONOCOPHILLIPS COMPANY [Operator and Lessee Info
] **County:** Lea
Land Type: Federal **Well Type:** Injection **Spud Date:**1/24/1950 **Plug**
Date:2/24/2005
Elevation GL: 3883 **Depth TVD:** 4033
Pools associated:

API #: 3002500774 **Well_Name:** MCA UNIT # 217
Location: N-30-17.0S-32E, 660 FSL, 1980 FWL **Lat:**32.8001884462 **Long:-**
103.808024656
Operator Name: CONOCOPHILLIPS COMPANY [Operator and Lessee Info
] **County:** Lea
Land Type: Federal **Well Type:** Injection **Spud Date:**1/24/1950 **Plug**
Date:2/24/2005
Elevation GL: 3883 **Depth TVD:** 4033
Pools associated:

API #: 3002524234 **Well_Name:** MCA UNIT # 323
Location: K-30-17.0S-32E, 1345 FSL, 1380 FWL **Lat:**32.8020753288 **Long:-**
103.809989476
Operator Name: CONOCOPHILLIPS COMPANY [[Operator and Lessee Info](#)]
County: Lea
Land Type: Federal **Well Type:** Oil **Spud Date:** **Plug Date:**
Elevation GL: **Depth TVD:** 4080
Pools associated:

API #: 3002500771 **Well_Name:** MCA UNIT # 164
Location: L-30-17.0S-32E, 1980 FSL, 660 FWL **Lat:**32.8038256412 **Long:-**
103.812346561
Operator Name: CONOCO INC [[Operator and Lessee Info](#)] **County:** Lea
Land Type: Federal **Well Type:** Injection **Spud Date:** **Plug Date:**9/11/1996
Elevation GL: **Depth TVD:**
Pools associated:

API #: 3002500781 **Well_Name:** MCA UNIT # 215
Location: P-30-17.0S-32E, 660 FSL, 660 FEL **Lat:**32.8001707752 **Long:-**
103.799371689
Operator Name: CONOCO INC [[Operator and Lessee Info](#)] **County:** Lea
Land Type: Federal **Well Type:** Injection **Spud Date:** **Plug Date:**4/9/2001 1
Elevation GL: **Depth TVD:**
Pools associated:

API #: 3002524009 **Well_Name:** MCA UNIT # 304
Location: I-30-17.0S-32E, 1345 FSL, 1295 FEL **Lat:**32.8020578469 **Long:-**
103.801450651
Operator Name: CONOCOPHILLIPS COMPANY [[Operator and Lessee Info](#)]
County: Lea
Land Type: Federal **Well Type:** Oil **Spud Date:** **Plug Date:**
Elevation GL: **Depth TVD:** 4175
Pools associated:

API #: 3002500776 **Well_Name:** MCA UNIT **Property Number.:** 166
Location: J-30-17.0S-32E, 1980 FSL, 1980 FEL **Lat:**32.8038077226 **Long:-**
103.803692944
Operator Name: CONOCO INC **County:** Lea
Land Type: Federal **Well Type:** Injection **Spud Date:**1/1/1900 1 **Plug**
Date:1/1/1900 1
Elevation GL: 0 **Depth TVD:** 0

API #: 3002520425 **Well_Name:** CARPER **Property Number.:** 001
Location: J-30-17.0S-32E, 2310 FSL, 2310 FEL **Lat:**32.8047169346 **Long:-**
103.804773257
Operator Name: FOREST OIL CORP **County:** Lea
Land Type: Federal **Well Type:** Oil **Spud Date:**1/1/1900 1 **Plug Date:**1/1/1900
1
Elevation GL: 0 **Depth TVD:** 0

API #: 3002512781 **Well_Name:** MCA UNIT # 161
Location: J-30-17.0S-32E, 2615 FSL, 2615 FEL **Lat:**32.8055572669 **Long:-**
103.805771729
Operator Name: CONOCOPHILLIPS COMPANY [Operator and Lessee Info
] **County:** Lea
Land Type: Federal **Well Type:** Injection **Spud Date:** **Plug Date:**4/18/2006
Elevation GL: **Depth TVD:** 4034
Pools associated:

API #: 3002500780 **Well_Name:** MCA UNIT # 162
Location: F-30-17.0S-32E, 1980 FNL, 1980 FWL **Lat:**32.8074358909 **Long:-**
103.808035259
Operator Name: CONOCOPHILLIPS COMPANY [Operator and Lessee Info
] **County:** Lea
Land Type: Federal **Well Type:** Injection **Spud Date:**9/11/1947 **Plug**
Date:2/23/2005
Elevation GL: 3899 **Depth TVD:** 3978
Pools associated:

API #: 3002524108 **Well_Name:** MCA UNIT # 310
Location: C-30-17.0S-32E, 1295 FNL, 1365 FWL **Lat:**32.8093227334 **Long:-**
103.81004913
Operator Name: CONOCOPHILLIPS COMPANY [Operator and Lessee Info]
County: Lea
Land Type: Federal **Well Type:** Oil **Spud Date:** **Plug Date:**
Elevation GL: **Depth TVD:** 4025
Pools associated:

API #: 3002523824 **Well_Name:** MCA UNIT # 295
Location: I-30-17.0S-32E, 1345 FSL, 25 FEL **Lat:**32.8020492943 **Long:-**
103.797297564
Operator Name: CONOCOPHILLIPS COMPANY [Operator and Lessee Info]
County: Lea
Land Type: Federal **Well Type:** Oil **Spud Date:** **Plug Date:**
Elevation GL: **Depth TVD:** 4160
Pools associated:

API #: 3002500775 **Well_Name:** MCA UNIT # 167
Location: I-30-17.0S-32E, 1980 FSL, 660 FEL **Lat:**32.8037989357 **Long:-**
103.799376349
Operator Name: CONOCOPHILLIPS COMPANY [Operator and Lessee Info
] **County:** Lea
Land Type: Federal **Well Type:** Oil **Spud Date:** **Plug Date:**
Elevation GL: **Depth TVD:** 3912
Pools associated:

API #: 3002524213 **Well_Name:** MCA UNIT # 319
Location: G-29-17.0S-32E, 2615 FNL, 1345 FEL **Lat:**32.8056647943 **Long:-**
103.784446017
Operator Name: CONOCOPHILLIPS COMPANY [Operator and Lessee Info
] **County:** Lea
Land Type: Federal **Well Type:** Oil **Spud Date:** **Plug Date:**
Elevation GL: **Depth TVD:** 4125
Pools associated:

API #: 3002523824 **Well_Name:** MCA UNIT # 295
Location: I-30-17.0S-32E, 1345 FSL, 25 FEL **Lat:**32.8020492943 **Long:-**
103.797297564
Operator Name: CONOCOPHILLIPS COMPANY [Operator and Lessee Info
] **County:** Lea
Land Type: Federal **Well Type:** Oil **Spud Date:** **Plug Date:**
Elevation GL: **Depth TVD:** 4160
Pools associated:

API #: 3002500775 **Well_Name:** MCA UNIT # 167
Location: I-30-17.0S-32E, 1980 FSL, 660 FEL **Lat:**32.8037989357 **Long:-**
103.799376349
Operator Name: CONOCOPHILLIPS COMPANY [Operator and Lessee Info
] **County:** Lea
Land Type: Federal **Well Type:** Oil **Spud Date:** **Plug Date:**
Elevation GL: **Depth TVD:** 3912
Pools associated:

API #: 3002523930 **Well_Name:** MCA UNIT # 278
Location: G-30-17.0S-32E, 2615 FNL, 1345 FEL **Lat:**32.8056776187 **Long:-**
103.801618811
Operator Name: CONOCO INC [Operator and Lessee Info] **County:** Lea
Land Type: Federal **Well Type:** Oil **Spud Date:** **Plug Date:**3/4/1998 1
Elevation GL: **Depth TVD:**
Pools associated:

API #: 3002500770 **Well_Name:** MCA UNIT # 160
Location: G-30-17.0S-32E, 1980 FNL, 1980 FEL **Lat:**32.8074271625 **Long:-**
103.803697693
Operator Name: CONOCOPHILLIPS COMPANY [Operator and Lessee Info
] **County:** Lea
Land Type: Federal **Well Type:** Oil **Spud Date:** **Plug Date:**12/22/2003
Elevation GL: **Depth TVD:**
Pools associated:

API #: 3002524057 **Well_Name:** MCA UNIT # 306
Location: B-30-17.0S-32E, 1295 FNL, 2615 FEL **Lat:**32.8093141366 **Long:-**
103.805776756
Operator Name: CONOCOPHILLIPS COMPANY [Operator and Lessee Info
] **County:** Lea
Land Type: Federal **Well Type:** Oil **Spud Date:** **Plug Date:**
Elevation GL: **Depth TVD:** 4020
Pools associated:

API #: 3002512798 **Well_Name:** MCA UNIT # 168
Location: I-30-17.0S-32E, 2615 FSL, 140 FEL **Lat:**32.8055407989 **Long:-**
103.797678114
Operator Name: CONOCOPHILLIPS COMPANY [Operator and Lessee Info
] **County:** Lea
Land Type: Federal **Well Type:** Oil **Spud Date:** **Plug Date:**
Elevation GL: 3913 **Depth TVD:** 3995
Pools associated:

API #: 3002500784 **Well_Name:** MCA UNIT # 159
Location: H-30-17.0S-32E, 1980 FNL, 660 FEL **Lat:**32.8074183755 **Long:-**
103.799381098
Operator Name: CONOCO INC [Operator and Lessee Info] **County:** Lea
Land Type: Federal **Well Type:** Injection **Spud Date:** **Plug Date:**5/8/2000 1
Elevation GL: **Depth TVD:**
Pools associated:

API #: 3002523789 **Well_Name:** MCA UNIT # 289
Location: B-30-17.0S-32E, 1165 FNL, 1345 FEL **Lat:**32.8096630978 **Long:-**
103.801624138
Operator Name: CONOCOPHILLIPS COMPANY [Operator and Lessee Info
] **County:** Lea
Land Type: Federal **Well Type:** Oil **Spud Date:**5/29/1971 **Plug**
Date:3/14/2007
Elevation GL: 3910 **Depth TVD:** 4025
Pools associated:

API #: 3002535715 **Well_Name:** BRINE STATION **Property Number.:** 529
Location: O-30-17.0S-32E , 999 FNL, 999 FEL **Lat:**32.8101170412 **Long:-**
103.800493265
Operator Name: I ; W INC **County:** Lea
Land Type: Federal **Well Type:** Miscellaneous **Spud Date:** **Plug Date:**2/4/1997
Elevation GL: 3599 **Depth TVD:** 99

API #: 3002523741 **Well_Name:** MCA UNIT # 281
Location: D-29-17.0S-32E , 1295 FNL, 25 FWL **Lat:**32.8092967193 **Long:-**
103.797143567
Operator Name: CONOCOPHILLIPS COMPANY [[Operator and Lessee Info](#)
] **County:** Lea
Land Type: Federal **Well Type:** Oil **Spud Date:** **Plug Date:**
Elevation GL: **Depth TVD:** 4025
Pools associated:

API #: 3002500769 **Well_Name:** MCA UNIT # 107
Location: B-30-17.0S-32E , 660 FNL, 1980 FEL **Lat:**32.8110553227 **Long:-**
103.803702502
Operator Name: CONOCOPHILLIPS COMPANY [[Operator and Lessee Info](#)
] **County:** Lea
Land Type: Federal **Well Type:** Injection **Spud Date:** **Plug Date:**2/22/2005
Elevation GL: **Depth TVD:** 4010
Pools associated:

API #: 3002523743 **Well_Name:** MCA UNIT # 283
Location: I-19-17.0S-32E , 2565 FSL, 1295 FEL **Lat:**32.8199150538 **Long:-**
103.801475923
Operator Name: CONOCOPHILLIPS COMPANY [[Operator and Lessee Info](#)
] **County:** Lea
Land Type: Federal **Well Type:** Oil **Spud Date:**4/24/1971 **Plug Date:**
Elevation GL: 3936 **Depth TVD:** 4075
Pools associated:

API #: 3002508048 **Well_Name:** MITCHELL B # 015
Location: L-20-17.0S-32E , 1980 FSL, 460 FWL **Lat:**32.8182979401 **Long:-**
103.795733519
Operator Name: CONOCOPHILLIPS COMPANY [[Operator and Lessee Info](#)
] **County:** Lea
Land Type: Federal **Well Type:** Oil **Spud Date:** **Plug Date:**
Elevation GL: **Depth TVD:** 5442
Pools associated:

API #: 3002508068 **Well_Name:** MCA UNIT # 062

Location: L-20-17.0S-32E, 1980 FSL, 660 FWL **Lat:** 32.8182977504 **Long:-**
103.795079386

Operator Name: CONOCO INC [Operator and Lessee Info] **County:** Lea

Land Type: Federal **Well Type:** Injection **Spud Date:** **Plug Date:** 9/15/1995

Elevation GL: **Depth TVD:**

Pools associated:



New Mexico Office of the State Engineer

Point of Diversion by Location

(with Owner Information)

POD Search:

POD Basin: Lea County

PLSS Search:

Section(s): 30

Township: 17S

Range: 32E

No PODs found.

Legal Notice
April 3, 2011

COG Operating LLC is applying to drill the Maljamar SWD 30 #2 as a water disposal well. The well is located at 1350' FNL & 770' FEL, Sec. 30, T. 17 S., R. 32 E., Lea County, NM. The well will dispose of water produced from oil and gas wells into the Wolfcamp Reef zone at a depth of 9500' to 9700' at a maximum rate of 20,000 barrels of water per day and at a maximum pressure of 1,900 psi. Interested parties must file objections or requests for hearing with the NM Oil Conservation Division, 1220 South Saint Francis Dr., Santa Fe, NM 87505, within 15 days. Additional information can be obtained by contacting Tye Orr, Veritas 321 Energy Partners, LP, P.O. Box 173, Midland, TX; phone number is (432) 349-4729.

Affidavit of Publication

State of New Mexico,
County of Eddy, ss.

Kathy McCarroll, being first duly sworn,
on oath says:

That she is the Classified Supervisor of the Carlsbad Current-Argus, a newspaper published daily at the City of Carlsbad, in said county of Eddy, state of New Mexico and of general paid circulation in said county; that the same is a duly qualified newspaper under the laws of the State wherein legal notices and advertisements may be published; that the printed notice attached hereto was published in the regular and entire edition of said newspaper and not in supplement thereof on the date as follows, to wit:

April 5 2011

That the cost of publication is **\$44.09** and that payment thereof has been made and will be assessed as court costs.

Kathy McCarroll

Subscribed and sworn to before me this

17th day of April, 2011

Stephanie Dobson

My commission Expires on 11/25/2014

Notary Public

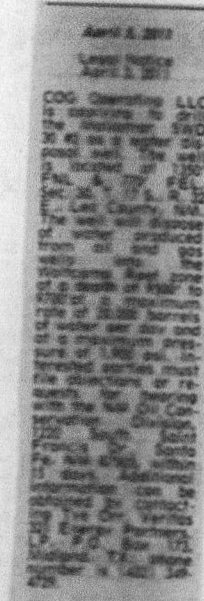
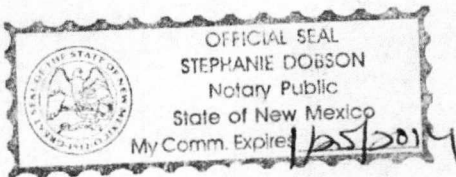

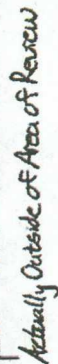

Actually Outside of Area of Review



April 3, 2011

New Mexico State Land Office
310 Old Santa Fe Trail
Santa Fe, NM 87504

COG Operating LLC is applying (see attached application) to drill a salt water disposal well as described below. As required by New Mexico Oil Conservation Division Rules, I am notifying you of the following proposed water disposal well. This letter is a notice only. No action is needed unless you have questions or objections.

Well: Maljamar SWD 30 #2

Proposed Disposal Zone: Wolfcamp Reef (from 9,500' to 9,700')

Location: 1350' FNL & 770' FEL Sec 34, T17S, R30E

Eddy County, NM

Approximate Location: 9-10 miles East of Loco Hills, NM

Applicant Name: COG Operating LLC (432) 685-4340

Applicant's Address: 550 West Texas, Suite 1300, Midland, TX 79701

Submittal Information: Application for a water disposal well will be filed with the NM Oil Conservation Division. If they determine the application complies with the applicable regulations, then it will be approved. The New Mexico Oil Conservation Division address is 1220 South St. Francis Dr., Santa Fe, NM 87505. Their phone number is (505) 476-3440.

Please call me if you have any questions.

Sincerely,

Tye Orr
Consulting Landman
(432) 349-4729

9522 289E E000 0952 7MM7

U.S. Postal Service TM	
CERTIFIED MAIL TM RECEIPT	
(Domestic Mail Only; No Insurance Coverage Provided)	
For delivery information visit our website at www.usps.com	
OFFICIAL USE	
Postage	\$ 1.73
Certified Fee	\$2.80
Return Receipt Fee (Endorsement Required)	\$2.30
Restricted Delivery Fee (Endorsement Required)	\$0.00
Total Postage & Fees	\$ 6.83

0704

MIDLAND, TX VILLAGE STA
Postmark
11 APR
2011

Sent To: NM3LO

Street, Apt. No.,
or PO Box No. 310 Old Santa Fe Trail

City, State, ZIP+4 Santa Fe, NM 87504



April 3, 2011

ConocoPhillips Company
Patsy L. Clugston
3401 E. 30th Street
Farmington, NM 87402

COG Operating LLC is applying (see attached application) to drill a salt water disposal well as described below. As required by New Mexico Oil Conservation Division Rules, I am notifying you of the following proposed water disposal well. This letter is a notice only. No action is needed unless you have questions or objections.

Well: Maljamar SWD 30 #2

Proposed Disposal Zone: Wolfcamp Reef (from 9,500' to 9,700')

Location: 1350' FNL & 770' FEL Sec 34, T17S, R30E

Eddy County, NM

Approximate Location: 9-10 miles East of Loco Hills, NM

Applicant Name: COG Operating LLC (432) 685-4340

Applicant's Address: 550 West Texas, Suite 1300, Midland, TX 79701

Submittal Information: Application for a water disposal well will be filed with the NM Oil Conservation Division. If they determine the application complies with the applicable regulations, then it will be approved. The New Mexico Oil Conservation Division address is 1220 South St. Francis Dr., Santa Fe, NM 87505. Their phone number is (505) 476-3440.

Please call me if you have any questions.

Sincerely,

Tye Orr
Consulting Landman
(432) 349-4729

U.S. Postal Service	
CERTIFIED MAIL RECEIPT	
(Domestic Mail Only. No Insurance Coverage Provided)	
For delivery information visit our website at www.usps.com	
OFFICIAL USE	
FARMINGTON NM 87402	
Postage	\$ 1.73
Certified Fee	\$2.80
Return Receipt Fee (Endorsement Required)	\$2.30
Restricted Delivery Fee (Endorsement Required)	\$0.00
Total Postage & Fees	\$ 6.83
0704 MIDLAND, TX VILLAGE ST. APR 1 2011	
Sent To	
Conoco Phillips Company	
Street, Apt. No., or PO Box No. 3401 E. 30th St.	
City, State, ZIP+4 Farmington, NM 87402	



April 3, 2011

Conoco Inc.
P.O. Box 2197
Houston, TX 77252

COG Operating LLC is applying (see attached application) to drill a salt water disposal well as described below. As required by New Mexico Oil Conservation Division Rules, I am notifying you of the following proposed water disposal well. This letter is a notice only. No action is needed unless you have questions or objections.

Well: Maljamar SWD 30 #2

Proposed Disposal Zone: Wolfcamp Reef (from 9,500' to 9,700')

Location: 1350' FNL & 770' FEL Sec 34, T17S, R30E

Eddy County, NM

Approximate Location: 9-10 miles East of Loco Hills, NM

Applicant Name: COG Operating LLC (432) 685-4340

Applicant's Address: 550 West Texas, Suite 1300, Midland, TX 79701

Submittal Information: Application for a water disposal well will be filed with the NM Oil Conservation Division. If they determine the application complies with the applicable regulations, then it will be approved. The New Mexico Oil Conservation Division address is 1220 South St. Francis Dr., Santa Fe, NM 87505. Their phone number is (505) 476-3440.

Please call me if you have any questions.

Sincerely,

Tye Orr
Consulting Landman
(432) 349-4729

6422 2892 E000 N957 7007

U.S. Postal Service [®]	
CERTIFIED MAIL [®] RECEIPT	
(Domestic Mail Only; No Insurance Coverage Provided)	
For delivery information visit our website at www.usps.com	
HOUSTON TX 77252	
OFFICIAL USE	
Postage	\$ 1.73
Certified Fee	\$2.80
Return Receipt Fee (Endorsement Required)	\$2.30
Restricted Delivery Fee (Endorsement Required)	\$0.00
Total Postage & Fees	\$ 6.83

0704

APR 11 2011

MIDLAND TX

Postmark Here

Sent To: Conoco Inc.

Street, Apt. No., or PO Box No.: P.O. Box 2197

City, State, ZIP+4: Houston, TX 77252

Jones, William V., EMNRD

From: Jones, William V., EMNRD
Sent: Monday, April 18, 2011 11:23 AM
To: 'Mark Fairchild'; 'Tye Orr'
Cc: Brooks, David K., EMNRD; Ezeanyim, Richard, EMNRD
Subject: SWD applications

Hello Mark and Tye:

I have received your hardcopies in the mail of 6 SWD applications. These were logged in and assigned to me to review. I glanced through them and see a couple things that you are probably aware of.

- 5/1/11
PENDING
- a. It seems that the State of New Mexico owns the surface of all but one of these – that one is a federal surface. Since State leases should be faster than Federal leases to generate approved APD's, please let me know when the API numbers will be coming for these? Which ones will come first? The SWD permits are site specific as are API numbers – we like to have API numbers before releasing SWD permits. If the proposed well moves location after we issue an SWD, the disposal permit is no longer valid.
 - b. The Maljamar SWD 30 #2 application has a blurry newspaper notice – please mail another copy.
 - c. The cement top data for surrounding wells – active or P&Aed is not there.
 - d. The wellbore diagrams of P&Aed wells within the ½ mile AOR not there. You could also send diagrams of the non-plugged wells to show cement coverage – your option.
 - e. It appears that owners were researched and notice was provided. We ask all applicants for SWD to tell us exactly which tracts of lands are owned by the parties that were noticed. One way to show that to us is to send a SecTspRge map with the ½ mile circle drawn around the proposed SWD site. On that map, outline all the tracts of common ownership. Reference these tracts in a separate page listing the owner or owners of each specific tract. Since the work has already been done to determine whom to notice, you should have this information.

Thank You,

William V Jones, P.E.
Engineering, Oil Conservation Division
1220 South St. Francis Drive, Santa Fe, NM 87505
Tel 505.476.3448 ~ Fax 505.476.3462



Jones, William V., EMNRD

From: Mark Fairchild [MFairchild@conchoresources.com]
Sent: Thursday, April 21, 2011 9:13 AM
To: Jones, William V., EMNRD
Cc: Noel Olivas; Robyn Odom; Kelly Holly; Sammie Hodges; Tye Orr
Subject: COG SENM SWD Drilling Applications, Additional Data
Attachments: Maljamar SWD 30 #2.xls; Arnold Federal Com #1.xls; Big Tank 33 Fed Com #1.xls; COG SENM SWD Drilling NMOCD Additional Well Data.docx; Conoco 8 State Com #1.xls; Full Tank 33 Fed Com #1.xls

Will, attached please find:

1. A document with all of our proposed new drills by name with the well data for any well within $\frac{1}{2}$ mile that penetrates the zones applied for disposal.
2. A complete wellbore diagram of with cement tops of the wells from one above that penetrate the applied for disposal horizon.
3. Please let me know if this completes our SWD Drilling Application requirements.

Thanks

M.A. Fairchild
COG OPERATING LLC
Office: 432-686-3021
Cell: 432-230-7170



CONFIDENTIALITY NOTICE: The information in this email may be confidential and/or privileged. If you are not the intended recipient or an authorized representative of the intended recipient, you are hereby notified that any review, dissemination or copying of this email and its attachments, if any, or the information contained herein, is prohibited. If you have received this email in error, please immediately notify the sender by return email and delete this email from your system. Thank you.

Inactive Well List

Total Well Count: 2870 Inactive Well Count: 6

Printed On: Sunday, May 29 2011

District	API	Well	ULSTR	OCD Unit	OGRID	Operator	Lease Type	Well Type	Last Production	Formation/Notes	Status	TA Exp Date
2	30-015-02692	E HI LONESOME FEDERAL #006	D-13-16S-29E	D	229137	COG OPERATING LLC	F	O	02/2010			
2	30-015-34278	FPR STATE #001 #001	P-36-19S-29E	P	229137	COG OPERATING LLC	S	O	11/2009	MORROW		
2	30-015-10334	SINCLAIR PARKE #001	F-22-17S-30E	F	229137	COG OPERATING LLC	F	O	02/2010			
2	30-015-23938	SOUTH SHUGART DEEP #001	3-4 -19S-31E	C	229137	COG OPERATING LLC	F	G	03/2009			
2	30-015-03789	TYLER FEDERAL #002	O-35-17S-29E	O	229137	COG OPERATING LLC	F	O	09/2009			
1	30-025-38079	WEST PEARL 36 STATE #001	F-36-19S-34E	F	229137	COG OPERATING LLC	S	G	11/2007	Morrow		

WHERE Ogrid:229137, County:All, District:All, Township:All, Range:All, Section:All, Production(months):15, Excludes Wells Under ACOI, Excludes Wells in Approved TA Period

Injection Permit Checklist (11/15/2010)

WFX _____ PMX _____ (SWD 1286) Permit Date 5/31/11 UIC Qtr (A (M/T))

Wells 1 Well Name(s): Maljara SWD 30 #2

API Num: 30-0 15-NA Spud Date: New New/Old: N (UIC primacy March 7, 1982) Lea

Footages 1350 FNL 1110 FEL Unit H Sec 30 Tsp 17S Rge 32E County EDDP

General Location:

Operator: COG OPERATING, LLC Contact Mark Fairchild

OGRID: _____ RULE 5.9 Compliance (Wells) OK (Finan Assur) OK IS 5.9 OK? OK

Well File Reviewed _____ Current Status: New PLAN

Planned Work to Well: Drill/Dispose

Diagrams: Before Conversion _____ After Conversion _____ Elogs in Imaging File: WILL LOG

Well Details:

	Sizes Hole.....Pipe	Setting Depths	Stage Tool	Cement Sx or Cf	Determination Method
New <input checked="" type="checkbox"/> Existing _____ Surface	17 1/2 13 1/8	400	—	278 CF	CRC
New <input checked="" type="checkbox"/> Existing _____ Interm	12 1/4 9 1/8	4000		1253 CF	CRC
New <input checked="" type="checkbox"/> Existing _____ LongSt	8 3/4 7	10,300		1614 CF	CRC
New _____ Existing _____ Liner					
New _____ Existing _____ OpenHole					

Depths/Formations:

	Depths, Ft.	Formation	Tops?
Formation(s) Above			
950' Injection TOP:	950	WC Reef	Max. PSI 1900 OpenHole _____ Perfs <input checked="" type="checkbox"/>
970' Injection BOTTOM:	970	" "	Tubing Size 3 1/2 Packer Depth _____
Formation(s) Below			

Capitan Reef? _____ (Potash? _____ Noticed? _____) [WIPP? _____ Noticed? _____] Salado Top/Bot _____ Giff House? _____

Fresh Water: Depths: None Formation _____ Wells? _____ Analysis? _____ Affirmative Statement ☒

Disposal Fluid Analysis? Sources: Yes, etc

Disposal Interval: Analysis? _____ Production Potential/Testing: ☒

Notice: Newspaper Date 4/5/11 Surface Owner SLO Mineral Owner(s) _____

RULE 26.7(A) Affected Persons: CONOCO PHILLIPS / CONOCO

AOR: Maps? ☒ Well List? ☒ Producing in Interval? NO Wellbore Diagrams? ☒

.....Active Wells 1 Repairs? 0 Which Wells? _____

.....P&A Wells 0 Repairs? _____ Which Wells? _____

Issues: _____ Request Sent _____ Reply: _____