

copy rec- H.H. 123/57
HUMBLE OIL & REFINING COMPANY

MIDLAND, TEXAS

January 11, 1956

EXC. By Rule 309(6) to Rule 309(6)

J. W. HOUSE

New Mexico Oil Conservation Commission
P. O. Box 871
Santa Fe, New Mexico

Attention: Mr. W. B. Macey

Underground Reservoir

Gentlemen:

has been approved for a full term

On January 4, 1956, we wrote Mr. E. S. Walker, State Land Commissioner of New Mexico, and advised that we were considering the commingling of production from our New Mexico State "AH" Lease with production that may be developed from our New Mexico State "AN" Lease. At the present time we have one oil well on our New Mexico State "AH" Lease producing from an undesignated field. Well No. 1 is now being drilled on our New Mexico State "AN" Lease. Mr. Walker, by his letter of January 6, 1956, advised that his office granted permission to commingle the two leases.

We realize that to commingle the production from two leases it is necessary to secure an exception to Rule 309 of the New Mexico Oil Conservation Commission Rules and Regulations.

To support our request for an exception to Rule 309, we submit the following information:

1. The production from each lease will be estimated on the basis of individual well tests and will be allocated back to each lease.
2. The production to be commingled will be from the same zone and of similar quality.
3. The production from each lease will be in paying quantities.

The description of the leases are as follows:

New Mexico State "AN", Co. Lease No. 120695, State E-735, described as the NE/4 of Section 36, T-15-S, R-34-E, Lea County, New Mexico

New Mexico State "AH", Co. Lease No. 116587, State E-604, described as the S/2 of Section 36, T-15-S, R-34-E, Lea County, New Mexico

We would appreciate your handling this request by administrative approval if this is possible. If an administrative approval is not possible, then we would appreciate your scheduling this for the next hearing date, either an examiner hearing or the regular hearing.

Yours very truly,

HUMBLE OIL & REFINING COMPANY

J. W. HOUSE, Division Superintendent

By: *J. W. House*
Asst. Div. Superintendent

AJT/se
Attach.

HUMBLE OIL & REFINING COMPANY

MIDLAND, TEXAS

January 20, 1956

J. W. HOUSE

New Mexico Oil Conservation Commission
P. O. Box 871
Santa Fe, New Mexico

Attention: Mr. W. B. Macey

Gentlemen:

We were advised that in connection with our application dated January 11, 1956, for an exception to Rule 309 to commingle production from our New Mexico State "AH" Lease, S/2 of Section 36, T-15-S, R-34-E, Lea County, New Mexico, and New Mexico State "AN" Lease, NE/4 of Section 36, T-15-S, R-34-E, Lea County, New Mexico, that it would be necessary to give notice to all offset operators. This notice was given on January 20, 1956, by certified mail to the offset operators by furnishing them a copy of our application.

A copy of our letter of notification is attached.

Yours very truly,

HUMBLE OIL & REFINING COMPANY

J. W. HOUSE,
Division Superintendent

By:

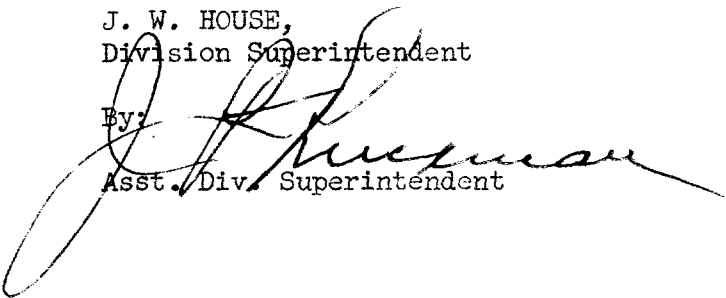
Asst. Div. Superintendent

AJT/sc
Attachment

10-10-10



Superior?

10-10-10



The following information was obtained from the records of the Department of the Interior, Bureau of Land Management, regarding the land owned by the United States in the State of California, and is being furnished to you for your information.

Very truly yours,
Director

Enclosed for you are two copies of a report of the Bureau of Land Management, Department of the Interior, regarding the land owned by the United States in the State of California, and is being furnished to you for your information.

ILLEGIBLE

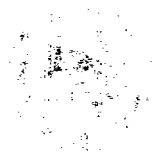

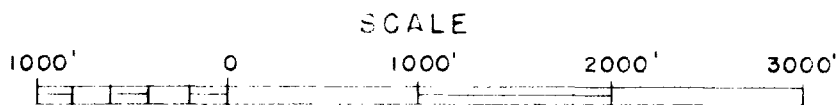
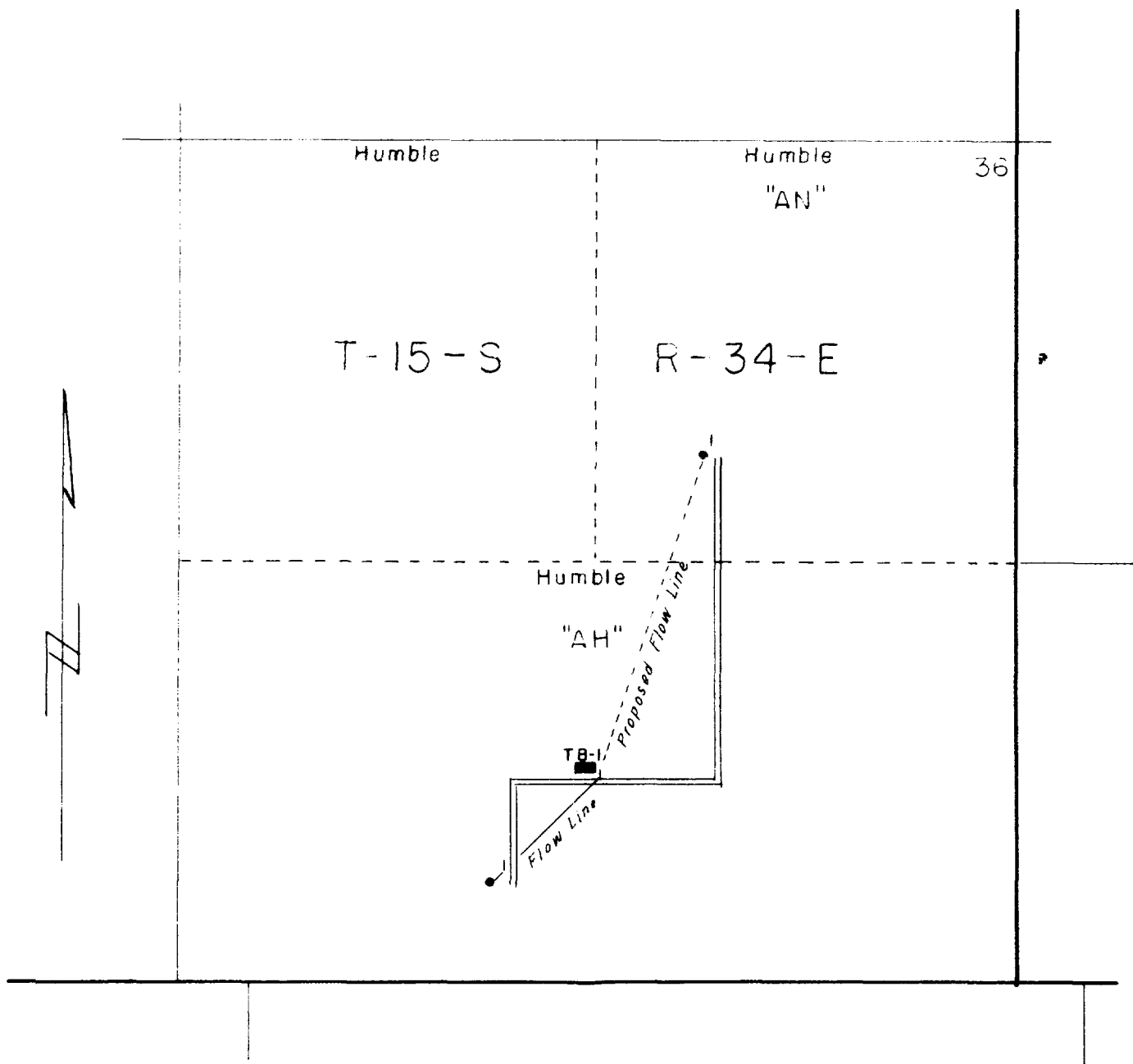

SECTION 36, T-15-S, R-34-E

LEA CO. NEW MEXICO

HUMBLE OIL & REFINING COMPANY
CIVIL ENGINEERING DIVISION
 MIDLAND, TEXAS

DRAWN BILL BRICE
 CHECKED _____
 APPR. _____

SCALE 1" = 1000'
 DATE 12-13-55
 REVISED _____

FILE NO.
 WTA 1997

Refer Reply to:
Oil & Gas Royalty Div.

January 6, 1956

C
O
P
Y

Humble Oil & Refining Company
Box 1600
Midland, Texas

Att: J. W. House, Division Superintendent

Dear Sir:

Permission is hereby granted to commingle oil produced from State Leases E-735 and E-604 located in Sec. 36-158-34E. This acreage will be credited to Common Schools.

When you start reporting production on these leases please combine production on SLO showing both lease numbers on our Production and Royalty Statements Form SLO-111-A.

Sincerely yours,

E. S. WALKER
Commissioner of Public Lands

LC:ESW:mb

cc: Oil Conservation Commission

1. The first part of the report
describes the general situation

in the country

and the results of the survey

conducted in the various regions

of the country. The results of the survey
show that the situation is generally
stable and that the population is

growing at a steady rate. The
economy is also growing and the
government is making progress in

the various fields

of development. The results of the
survey show that the situation is

generally stable

and that the population is