

CTB

3/30/98

Mid-Continent Region  
Production United States



**Marathon  
Oil Company**

P.O. Box 2409  
Hobbs, NM 88241-2409  
Telephone 505/393-7106

467  
3/30/98  
31

March 6, 1998

Ms. Lori Wrotenbery, Director  
State of New Mexico  
Oil Conservation Division  
PO Box 2088  
Santa Fe NM 87504-2088

MAR 9 1998  
OIL CONSERVATION

Case 12068

Re: Request for Exemption to Rule 309-A  
Surface Lease Commingling

David Crockett '27' State Lease  
Sec. 27, T-18-S, R-28-E  
Eddy County  
Travis - Upper Penn

James Buchanan '33' State Lease  
Sec. 33, T-18-S, R-28-E  
Eddy County  
Travis - Upper Penn

59860

Ms. Lori Wrotenbery:

Marathon Oil Company respectfully requests the State of New Mexico Oil Conservation Division to grant administrative approval for exemption to Rule 309-A for the above mentioned leases.

Marathon Oil Company proposes to produce the two leases to a common stock tank battery with separate metering facilities prior to commingling. The common battery will be at the James Buchanan '33' St. No. 1 location. It should be noted that there is a diversity of ownership between the leases. However, the proposed production operation is in accordance with the applicable provisions and all necessary parties have been notified by certified mail.

Please find attached a lease commingling plat and a production facility schematic. Please note that the value of the oil will not be adversely affected.

If you have any questions or comments, please advise.

Sincerely,

A handwritten signature in cursive script, appearing to read 'Bryan L. Williams'.

Bryan L. Williams  
Production Engineer  
(505) 393-7106 ext. 212

BLW//reglatory/commingling/surface/crokl\_a  
Attachments

David Crockett State 27 Lease  
Unit C,D,H,I,K,L,M&N  
W 1/2, Sec. 27, T 18S, R-28E

James Buchanan State 33 Lease  
Unit A,B,G,H,I,J,O&P  
E 1/2, Sec. 33, T 18S, R28E

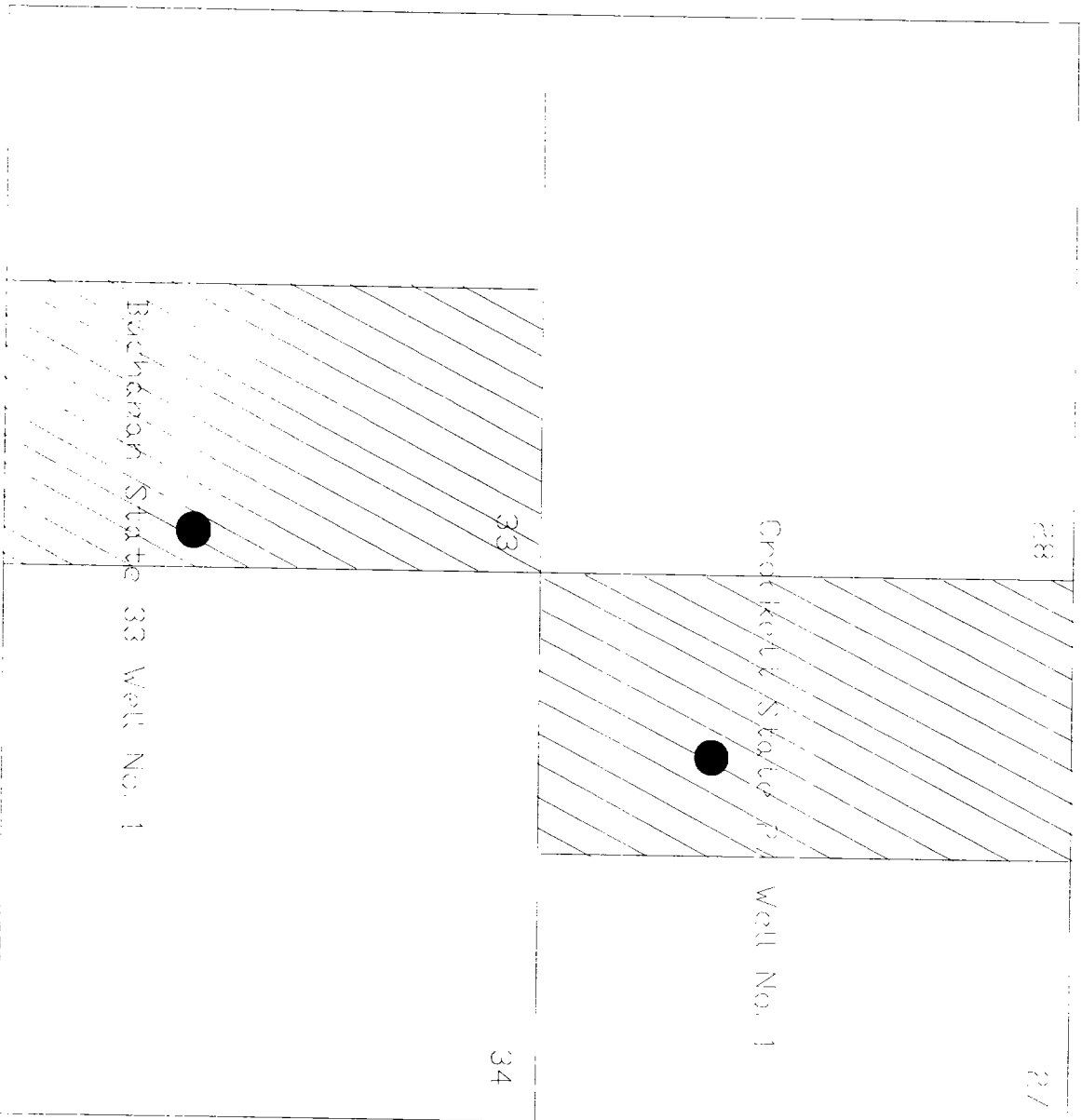

[illegible]

11

# ILLEGIBLE



MARTIN YATES, III  
1912 - 1985  
FRANK W. YATES  
1936 - 1986



105 SOUTH FOURTH STREET  
ARTESIA, NEW MEXICO 88210  
TELEPHONE (505) 748-1471

S. P. YATES  
CHAIRMAN OF THE BOARD  
JOHN A. YATES  
PRESIDENT  
PEYTON YATES  
EXECUTIVE VICE PRESIDENT  
RANDY G. PATTERSON  
SECRETARY  
DENNIS G. KINSEY  
TREASURER

March 26, 1998

New Mexico Oil Conservation Division  
2040 South Pacheco  
Santa Fe, New Mexico 87505

RE: Request for Exemption to Rule 309-A  
Surface Lease Commingling

David Crockett 27 State Lease  
Sec. 27, T18S, R28E  
Eddy County, New Mexico  
Travis - Upper Penn

James Buchanan 33 State Lease  
Sec. 33, T18S, R28E  
Eddy County, New Mexico  
Travis - Upper Penn

Gentlemen:

Please find enclosed a letter agreement to the surface commingling of the captioned leases. The letter has been executed on behalf of Yates Petroleum Corporation.

Thank you.

Very truly yours,

YATES PETROLEUM CORPORATION

Robert Bullock  
Landman

RB:bn  
enclosure(s)

cc:  
Marathon Oil Company  
Attention: Kerry Heerssen, Jr.

Mid-Continent Region  
Production United States



P.O. Box 552  
Midland, TX 79702-0552  
Telephone 915/682-1626

March 9, 1998

Yates Petroleum Corporation  
105 South Forth Street  
Artesia, New Mexico 88210

Re: Request for Exemption to Rule 309-A  
Surface Lease Commingling

David Crockett '27' State Lease  
Sec. 27, T-18-S, R-28-E  
Eddy County  
Travis - Upper Penn

James Buchanan '33' State Lease  
Sec. 33, T-18-S, R-28-E  
Eddy County  
Travis - Upper Penn

Ladies and/or Gentlemen:

Marathon Oil Company has filed an application with the New Mexico Oil Conservation Division to surface commingle the above referenced leases. The proposed production operation is in accordance with the applicable provisions.

If you are in agreement and waive all objections to the surface commingling, please sign below and mail the original to the NMOCD in the enclosed addressed envelope. Also, please return one copy to Marathon at the letterhead address.

Should you have any question, please contact Steve Byrd with Marathon Oil Company at (915) 687-8488.

Sincerely,

A handwritten signature in cursive script, appearing to read 'Kerry Heerssen, Jr.'.

Kerry Heerssen, Jr.  
Landman

BLW//reglatory/commiling/surface/crok1\_b  
Enclosure

Agreed and accepted this 24th day of MARCH 1998

by [Signature], as representative of

Yates Petroleum Corporation

Is your RETURN ADDRESS completed on the reverse side?

<b>SENDER:</b> ■ Complete items 1 and/or 2 for additional services. ■ Complete items 3, 4a, and 4b. ■ Print your name and address on the reverse of this form so that we can return this card to you. ■ Attach this form to the front of the mailpiece, or on the back if space does not permit. ■ Write "Return Receipt Requested" on the mailpiece below the article number. ■ The Return Receipt will show to whom the article was delivered and the date delivered.		I also wish to receive the following services (for an extra fee): 1. <input type="checkbox"/> Addressee's Address 2. <input type="checkbox"/> Restricted Delivery Consult postmaster for fee.	
3. Article Addressed to: Yates Pet. Corp. 105 S. Forest Street Artesia, NM 88210		4a. Article Number P 245 774 268	
5. Received By: (Print Name) JOANN GRIGGS		4b. Service Type <input type="checkbox"/> Registered <input type="checkbox"/> Express Mail <input type="checkbox"/> Return Receipt for Merchandise <input type="checkbox"/> Insured <input type="checkbox"/> COD	
6. Signature: (Addressee or Agent) <i>Joann Griggs</i>		7. Date of Delivery 03/18/98	
PS Form 3811, December 1994		8. Addressee's Address (Only if requested and fee is paid)	
Domestic Return Receipt			

Thank you for using Return Receipt Service.

Is your RETURN ADDRESS completed on the reverse side?

<b>SENDER:</b> ■ Complete items 1 and/or 2 for additional services. ■ Complete items 3, 4a, and 4b. ■ Print your name and address on the reverse of this form so that we can return this card to you. ■ Attach this form to the front of the mailpiece, or on the back if space does not permit. ■ Write "Return Receipt Requested" on the mailpiece below the article number. ■ The Return Receipt will show to whom the article was delivered and the date delivered.		I also wish to receive the following services (for an extra fee): 1. <input type="checkbox"/> Addressee's Address 2. <input type="checkbox"/> Restricted Delivery Consult postmaster for fee.	
3. Article Addressed to: Enron Oil & Gas Co. P. O. Box 2267 Midland, TX 79702-2267		4a. Article Number P 245 774 269	
5. Received By: (Print Name)		4b. Service Type <input type="checkbox"/> Registered <input type="checkbox"/> Express Mail <input type="checkbox"/> Return Receipt for Merchandise <input type="checkbox"/> Insured <input type="checkbox"/> COD	
6. Signature: (Addressee or Agent) <i>X [Signature]</i>		7. Date of Delivery 03/11/98	
PS Form 3811, December 1994		8. Addressee's Address (Only if requested and fee is paid)	
Domestic Return Rec			

FROM MARATHON OIL COMPANY 07:22

Is your RETURN ADDRESS completed on the reverse side?

<b>SENDER:</b> ■ Complete items 1 and/or 2 for additional services. ■ Complete items 3, 4a, and 4b. ■ Print your name and address on the reverse of this form so that we can return this card to you. ■ Attach this form to the front of the mailpiece, or on the back if space does not permit. ■ Write "Return Receipt Requested" on the mailpiece below the article number. ■ The Return Receipt will show to whom the article was delivered and the date delivered.		I also wish to receive the following services (for an extra fee): 1. <input type="checkbox"/> Addressee's Address 2. <input type="checkbox"/> Restricted Delivery Consult postmaster for fee.	
3. Article Addressed to: Reed & Stevens, Inc. P. O. Box 1518 Room 11, RM 88002-1518		4a. Article Number P 245 774 271	
5. Received By: (Print Name) <i>[Signature]</i>		4b. Service Type <input type="checkbox"/> Registered <input type="checkbox"/> Express Mail <input type="checkbox"/> Return Receipt for Merchandise <input type="checkbox"/> Insured <input type="checkbox"/> COD	
6. Signature: (Addressee or Agent) <i>X [Signature]</i>		7. Date of Delivery 03/12/98	
PS Form 3811, December 1994		8. Addressee's Address (Only if requested and fee is paid)	
Domestic Return Receipt			

Thank you for using Return Receipt Service.

Is your RETURN ADDRESS completed on the reverse side?

<b>SENDER:</b> ■ Complete items 1 and/or 2 for additional services. ■ Complete items 3, 4a, and 4b. ■ Print your name and address on the reverse of this form so that we can return this card to you. ■ Attach this form to the front of the mailpiece, or on the back if space does not permit. ■ Write "Return Receipt Requested" on the mailpiece below the article number. ■ The Return Receipt will show to whom the article was delivered and the date delivered.		I also wish to receive the following services (for an extra fee): 1. <input type="checkbox"/> Addressee's Address 2. <input type="checkbox"/> Restricted Delivery Consult postmaster for fee.	
3. Article Addressed to: Roy G. Barton Jr., Trustee P. O. Box 578 Hobbs, NM 88240-0578		4a. Article Number P 245 774 270	
5. Received By: (Print Name) <i>[Signature]</i>		4b. Service Type <input type="checkbox"/> Registered <input type="checkbox"/> Express Mail <input type="checkbox"/> Return Receipt for Merchandise <input type="checkbox"/> Insured <input type="checkbox"/> COD	
6. Signature: (Addressee or Agent) <i>X [Signature]</i>		7. Date of Delivery 03/12/98	
PS Form 3811, December 1994		8. Addressee's Address (Only if requested and fee is paid)	
Domestic Return Rec			

TO 915058271389 P.02

To: Ben Stone

From: Marathon Oil Company

From: Marathon U. Camp

P 245 774 268

US Postal Service

**Receipt for Certified Mail**

No Insurance Coverage Provided.

Do not use for International Mail (See reverse)

Sent to Yates Pet. Corp.	
Street & Number 105 S. Forth Street	
Post Office, State, & ZIP Code Alameda, NM 88210	
Postage	\$
Certified Fee	
Special Delivery Fee	
Restricted Delivery Fee	
Return Receipt Showing to Whom & Date Delivered	
Return Receipt Showing to Whom, Date, & Addressee's Address	
<b>TOTAL Postage &amp; Fees</b>	<b>\$</b>
Postmark or Date	

PS Form 3800, April 1995

P 245 774 270

US Postal Service

**Receipt for Certified Mail**

No Insurance Coverage Provided.

Do not use for International Mail (See reverse)

Sent to Roy G. Barton Jr., Trustee	
Street & Number P. O. Box 978	
Post Office, State, & ZIP Code Hobbs, NM 88240-0978	
Postage	\$
Certified Fee	
Special Delivery Fee	
Restricted Delivery Fee	
Return Receipt Showing to Whom & Date Delivered	
Return Receipt Showing to Whom, Date, & Addressee's Address	
<b>TOTAL Postage &amp; Fees</b>	<b>\$</b>
Postmark or Date	

PS Form 3800, April 1995

P 245 774 271

US Postal Service

**Receipt for Certified Mail**

No Insurance Coverage Provided.

Do not use for International Mail (See reverse)

Sent to Read & Stevens, Inc.	
Street & Number P. O. Box 1528	
Post Office, State, & ZIP Code Roswell, NM 88202-1518	
Postage	\$
Certified Fee	
Special Delivery Fee	
Restricted Delivery Fee	
Return Receipt Showing to Whom & Date Delivered	
Return Receipt Showing to Whom, Date, & Addressee's Address	
<b>TOTAL Postage &amp; Fees</b>	<b>\$</b>
Postmark or Date	

PS Form 3800, April 1995

P 245 774 269

US Postal Service

**Receipt for Certified Mail**

No Insurance Coverage Provided.

Do not use for International Mail (See reverse)

Sent to Enron Oil & Gas Co.	
Street & Number P. O. Box 2267	
Post Office, State, & ZIP Code Midland, TX 79702-2267	
Postage	\$
Certified Fee	
Special Delivery Fee	
Restricted Delivery Fee	
Return Receipt Showing to Whom & Date Delivered	
Return Receipt Showing to Whom, Date, & Addressee's Address	
<b>TOTAL Postage &amp; Fees</b>	<b>\$</b>
Postmark or Date	

PS Form 3800, April 1995



AMEND CTB 5/18/98

Mid-Continent Region  
Production United States



P.O. Box 2409  
Hobbs, NM 88241-2409  
Telephone 505/393-7106

April 21, 1998

Ms. Lori Wrotenbery, Director  
State of New Mexico  
Oil Conservation Division  
PO Box 2088  
Santa Fe NM 87504-2088

APR 28 1998

Re: Request for Exemption to Rule 309-A  
Surface Lease Commingling

Samuel Burns '34' St. Lease  
N 1/2, Sec. 34, T-18-S, R-28-E  
Eddy County  
Travis - Upper Penn

James Buchanan '33' St. Lease  
David Crockett '27' St. Lease  
Henry Courtman '4' St. Lease  
Travis - Upper Penn

Ms. Lori Wrotenbery:

Marathon Oil Company respectfully requests the State of New Mexico Oil Conservation Division to grant administrative approval for exemption to Rule 309-A for the above referenced leases. The Buchanan '33' St. lease and the Crockett '27' St. lease are currently commingled per Order No. CTB-467. An application to include the Courtman '4' St. lease in Order No. CTB-467 is currently awaiting approval. Marathon is requesting for the Burns '34' St. lease to also be included in Order No. CTB-467.

Marathon Oil Company proposes to produce the four leases to a common stock tank battery with separate metering facilities prior to commingling. The common battery will be at the James Buchanan '33' St. No. 1 location. It should be noted that there is a diversity of ownership between the leases. However, the proposed production operation is in accordance with the applicable provisions and all necessary parties have been notified by certified mail.

Please find attached a lease commingling plat and a production facility schematic. Please note that the value of the oil will not be adversely effected.

If you have any questions or comments, please advise.

Sincerely,

A handwritten signature in black ink, appearing to read 'Bryan L. Williams'.

Bryan L. Williams  
Production Engineer  
(505) 393-7106 ext. 212  
n:/reglatory/commingling/surface/burnl\_a  
Attachments

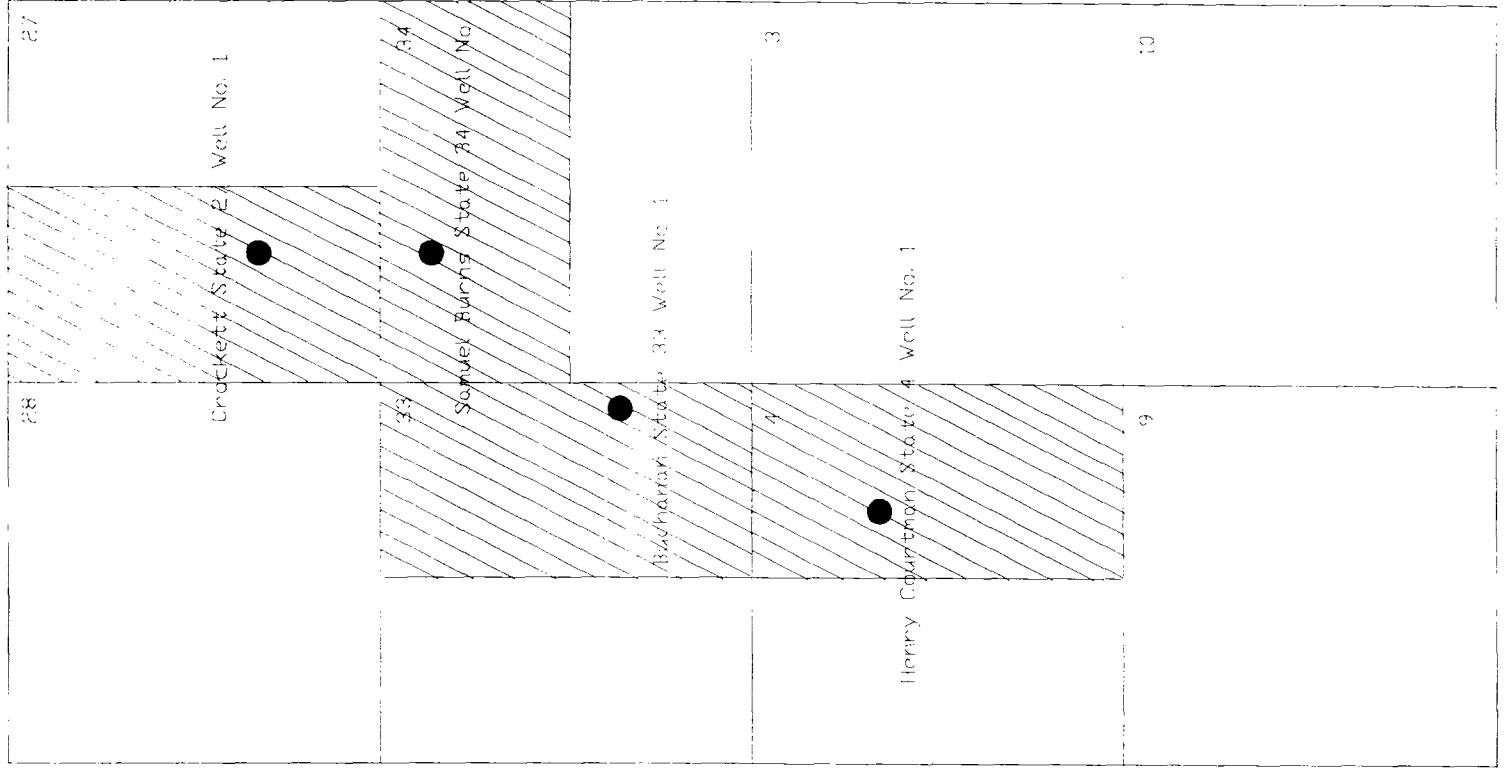

David Crickett State 27 Lease  
Unit A,B,C,D,E,F,G,H,I,J,K,L,M,N  
W 1/2, Sec. 27, T-18S, N-18E

Samuel Burns State 34 Lease  
Unit A,B,C,D,E,F,G,H  
N 1/2, Sec. 34, T-18S, R-28E

James Buchanan State 33 Lease  
Unit A,B,C,D,E,F,G,H,I,J,K,L,P  
E 1/2, Sec. 33, T-18S, R-28E

Henry Courtman State 4 Lease  
Unit A,B,C,D,E,F,G,H,I,J,K,L,P  
E 1/2, Sec. 4, T-19S, R-28E

# ILLEGIBLE

11

1

1  
1  
1  
1  
1

1  
1  
1  
1  
1

ILLEGIBLE

1. *Introduction*

[illegible]

11



1.  $\frac{1}{2}$   
 2.  $\frac{1}{4}$   
 3.  $\frac{1}{8}$   
 4.  $\frac{1}{16}$   
 5.  $\frac{1}{32}$   
 6.  $\frac{1}{64}$   
 7.  $\frac{1}{128}$   
 8.  $\frac{1}{256}$   
 9.  $\frac{1}{512}$   
 10.  $\frac{1}{1024}$   
 11.  $\frac{1}{2048}$   
 12.  $\frac{1}{4096}$   
 13.  $\frac{1}{8192}$   
 14.  $\frac{1}{16384}$   
 15.  $\frac{1}{32768}$   
 16.  $\frac{1}{65536}$   
 17.  $\frac{1}{131072}$   
 18.  $\frac{1}{262144}$   
 19.  $\frac{1}{524288}$   
 20.  $\frac{1}{1048576}$   
 21.  $\frac{1}{2097152}$   
 22.  $\frac{1}{4194304}$   
 23.  $\frac{1}{8388608}$   
 24.  $\frac{1}{16777216}$   
 25.  $\frac{1}{33554432}$   
 26.  $\frac{1}{67108864}$   
 27.  $\frac{1}{134217728}$   
 28.  $\frac{1}{268435456}$   
 29.  $\frac{1}{536870912}$   
 30.  $\frac{1}{1073741824}$   
 31.  $\frac{1}{2147483648}$   
 32.  $\frac{1}{4294967296}$   
 33.  $\frac{1}{8589934592}$   
 34.  $\frac{1}{17179869184}$   
 35.  $\frac{1}{34359738368}$   
 36.  $\frac{1}{68719476736}$   
 37.  $\frac{1}{137438953472}$   
 38.  $\frac{1}{274877906944}$   
 39.  $\frac{1}{549755813888}$   
 40.  $\frac{1}{1099511627776}$   
 41.  $\frac{1}{2199023255552}$   
 42.  $\frac{1}{4398046511104}$   
 43.  $\frac{1}{8796093022208}$   
 44.  $\frac{1}{17592186044416}$   
 45.  $\frac{1}{35184372088832}$   
 46.  $\frac{1}{70368744177664}$   
 47.  $\frac{1}{140737488355328}$   
 48.  $\frac{1}{281474976710656}$   
 49.  $\frac{1}{562949953421312}$   
 50.  $\frac{1}{1125899906842624}$   
 51.  $\frac{1}{2251799813685248}$   
 52.  $\frac{1}{4503599627370496}$   
 53.  $\frac{1}{9007199254740992}$   
 54.  $\frac{1}{18014398509481984}$   
 55.  $\frac{1}{36028797018963968}$   
 56.  $\frac{1}{72057594037927936}$   
 57.  $\frac{1}{144115188075855872}$   
 58.  $\frac{1}{288230376151711744}$   
 59.  $\frac{1}{576460752303423488}$   
 60.  $\frac{1}{1152921504606846976}$   
 61.  $\frac{1}{2305843009213693952}$   
 62.  $\frac{1}{4611686018427387904}$   
 63.  $\frac{1}{9223372036854775808}$   
 64.  $\frac{1}{18446744073709551616}$   
 65.  $\frac{1}{36893488147419103232}$   
 66.  $\frac{1}{73786976294838206464}$   
 67.  $\frac{1}{147573952589676412928}$   
 68.  $\frac{1}{295147905179352825856}$   
 69.  $\frac{1}{590295810358705651712}$   
 70.  $\frac{1}{1180591620717411303424}$   
 71.  $\frac{1}{2361183241434822606848}$   
 72.  $\frac{1}{4722366482869645213696}$   
 73.  $\frac{1}{9444732965739290427392}$   
 74.  $\frac{1}{18889465931478580854784}$   
 75.  $\frac{1}{37778931862957161709568}$   
 76.  $\frac{1}{75557863725914323419136}$   
 77.  $\frac{1}{151115727451828646838272}$   
 78.  $\frac{1}{302231454903657293676544}$   
 79.  $\frac{1}{604462909807314587353088}$   
 80.  $\frac{1}{1208925819614629174706176}$   
 81.  $\frac{1}{2417851639229258349412352}$   
 82.  $\frac{1}{4835703278458516698824704}$   
 83.  $\frac{1}{9671406556917033397649408}$   
 84.  $\frac{1}{19342813113834066795298816}$   
 85.  $\frac{1}{38685626227668133590597632}$   
 86.  $\frac{1}{77371252455336267181195264}$   
 87.  $\frac{1}{154742504910672534362390528}$   
 88.  $\frac{1}{309485009821345068724781056}$   
 89.  $\frac{1}{618970019642690137449562112}$   
 90.  $\frac{1}{1237940039285380274899124224}$   
 91.  $\frac{1}{2475880078570760549798248448}$   
 92.  $\frac{1}{4951760157141521099596496896}$   
 93.  $\frac{1}{9903520314283042199192993792}$   
 94.  $\frac{1}{19807040628566084398385987584}$   
 95.  $\frac{1}{39614081257132168796771975168}$   
 96.  $\frac{1}{79228162514264337593543950336}$   
 97.  $\frac{1}{158456325028528675187087900672}$   
 98.  $\frac{1}{316912650057057350374175801344}$   
 99.  $\frac{1}{633825300114114700748351602688}$   
 100.  $\frac{1}{1267650600228229401496703205376}$   
 101.  $\frac{1}{2535301200456458802993406410752}$   
 102.  $\frac{1}{5070602400912917605986812821504}$   
 103.  $\frac{1}{10141204801825835211973625643008}$   
 104.  $\frac{1}{20282409603651670423947251286016}$   
 105.  $\frac{1}{40564819207303340847894502572032}$   
 106.  $\frac{1}{81129638414606681695789005144064}$   
 107.  $\frac{1}{162259276829213363391578010288128}$   
 108.  $\frac{1}{324518553658426726783156020576256}$   
 109.  $\frac{1}{649037107316853453566312041152512}$   
 110.  $\frac{1}{1298074214633706907132624082305024}$   
 111.  $\frac{1}{2596148429267413814265248164610048}$   
 112.  $\frac{1}{5192296858534827628530496329220096}$   
 113.  $\frac{1}{10384593717069655257060992658440192}$   
 114.  $\frac{1}{20769187434139310514121985316880384}$   
 11

—

r

ILLEGIBLE

**ILLEGIBLE**

11  
12  
13  
14  
15  
16  
17  
18  
19  
20  
21  
22  
23  
24  
25  
26  
27  
28  
29  
30  
31  
32  
33  
34  
35  
36  
37  
38  
39  
40  
41  
42  
43  
44  
45  
46  
47  
48  
49  
50  
51  
52  
53  
54  
55  
56  
57  
58  
59  
60  
61  
62  
63  
64  
65  
66  
67  
68  
69  
70  
71  
72  
73  
74  
75  
76  
77  
78  
79  
80  
81  
82  
83  
84  
85  
86  
87  
88  
89  
90  
91  
92  
93  
94  
95  
96  
97  
98  
99  
100

1  
2  
3  
4  
5  
6  
7  
8  
9  
10  
11  
12  
13  
14  
15  
16  
17  
18  
19  
20  
21  
22  
23  
24  
25  
26  
27  
28  
29  
30  
31  
32  
33  
34  
35  
36  
37  
38  
39  
40  
41  
42  
43  
44  
45  
46  
47  
48  
49  
50  
51  
52  
53  
54  
55  
56  
57  
58  
59  
60  
61  
62  
63  
64  
65  
66  
67  
68  
69  
70  
71  
72  
73  
74  
75  
76  
77  
78  
79  
80  
81  
82  
83  
84  
85  
86  
87  
88  
89  
90  
91  
92  
93  
94  
95  
96  
97  
98  
99  
100

1  
2  
3  
4  
5  
6  
7  
8  
9  
10  
11  
12  
13  
14  
15  
16  
17  
18  
19  
20  
21  
22  
23  
24  
25  
26  
27  
28  
29  
30  
31  
32  
33  
34  
35  
36  
37  
38  
39  
40  
41  
42  
43  
44  
45  
46  
47  
48  
49  
50  
51  
52  
53  
54  
55  
56  
57  
58  
59  
60  
61  
62  
63  
64  
65  
66  
67  
68  
69  
70  
71  
72  
73  
74  
75  
76  
77  
78  
79  
80  
81  
82  
83  
84  
85  
86  
87  
88  
89  
90  
91  
92  
93  
94  
95  
96  
97  
98  
99  
100

1  
2  
3  
4  
5  
6  
7  
8  
9  
10  
11  
12  
13  
14  
15  
16  
17  
18  
19  
20  
21  
22  
23  
24  
25  
26  
27  
28  
29  
30  
31  
32  
33  
34  
35  
36  
37  
38  
39  
40  
41  
42  
43  
44  
45  
46  
47  
48  
49  
50  
51  
52  
53  
54  
55  
56  
57  
58  
59  
60  
61  
62  
63  
64  
65  
66  
67  
68  
69  
70  
71  
72  
73  
74  
75  
76  
77  
78  
79  
80  
81  
82  
83  
84  
85  
86  
87  
88  
89  
90  
91  
92  
93  
94  
95  
96  
97  
98  
99  
100

1  
2  
3  
4  
5  
6  
7  
8  
9  
10  
11  
12  
13  
14  
15  
16  
17  
18  
19  
20  
21  
22  
23  
24  
25  
26  
27  
28  
29  
30  
31  
32  
33  
34  
35  
36  
37  
38  
39  
40  
41  
42  
43  
44  
45  
46  
47  
48  
49  
50  
51  
52  
53  
54  
55  
56  
57  
58  
59  
60  
61  
62  
63  
64  
65  
66  
67  
68  
69  
70  
71  
72  
73  
74  
75  
76  
77  
78  
79  
80  
81  
82  
83  
84  
85  
86  
87  
88  
89  
90  
91  
92  
93  
94  
95  
96  
97  
98  
99  
100

Mid-Continent Region  
Production United States



P.O. Box 2409  
Hobbs, NM 88241-2409  
Telephone 505/393-7106

April 30, 1998

Ms. Lori Wrotenbery, Director  
State of New Mexico  
Oil Conservation Division  
PO Box 2088  
Santa Fe NM 87504-2088

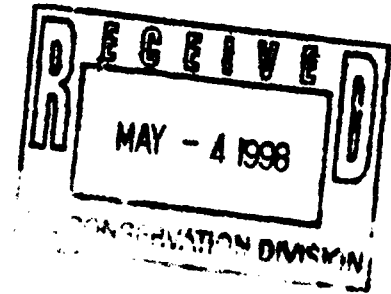

Re: **Amended** Request for Exemption to Rule 309-A  
Surface Lease Commingling

Samuel Burns '34' St. Lease  
N 1/2, Sec. 34, T-18-S, R-28-E  
Eddy County  
Travis - Upper Penn

James Buchanan '33' St. Lease  
David Crockett '27' St. Lease  
Henry Courtman '4' St. Lease  
Travis - Upper Penn

Ms. Lori Wrotenbery:

On April 21, 1998, Marathon Oil Company requested the State of New Mexico Oil Conservation Division to grant administrative approval for exemption to Rule 309-A for the above mentioned leases. In the initial request, the Henry Courtman '4' lease was incorrectly shown in the E 1/2, Sec. 4, T-19-S, R-28-E. The correct location is the N 1/2, Sec. 4, T-19-S, R-28-E. Please accept this letter as an amendment notification.

Please find attached a corrected lease commingling plat. It should be noted that the initial working interest owner notifications correctly identified the Courtman lease in the N 1/2 of Section 4.

If you have any questions or comments, please advise.

Sincerely,

A handwritten signature in cursive script, appearing to read 'Bryan L. Williams'.

Bryan L. Williams  
Production Engineer  
(505) 393-7106 ext. 212

n:/reglatory/commingling/surface/burnl\_d  
Attachments





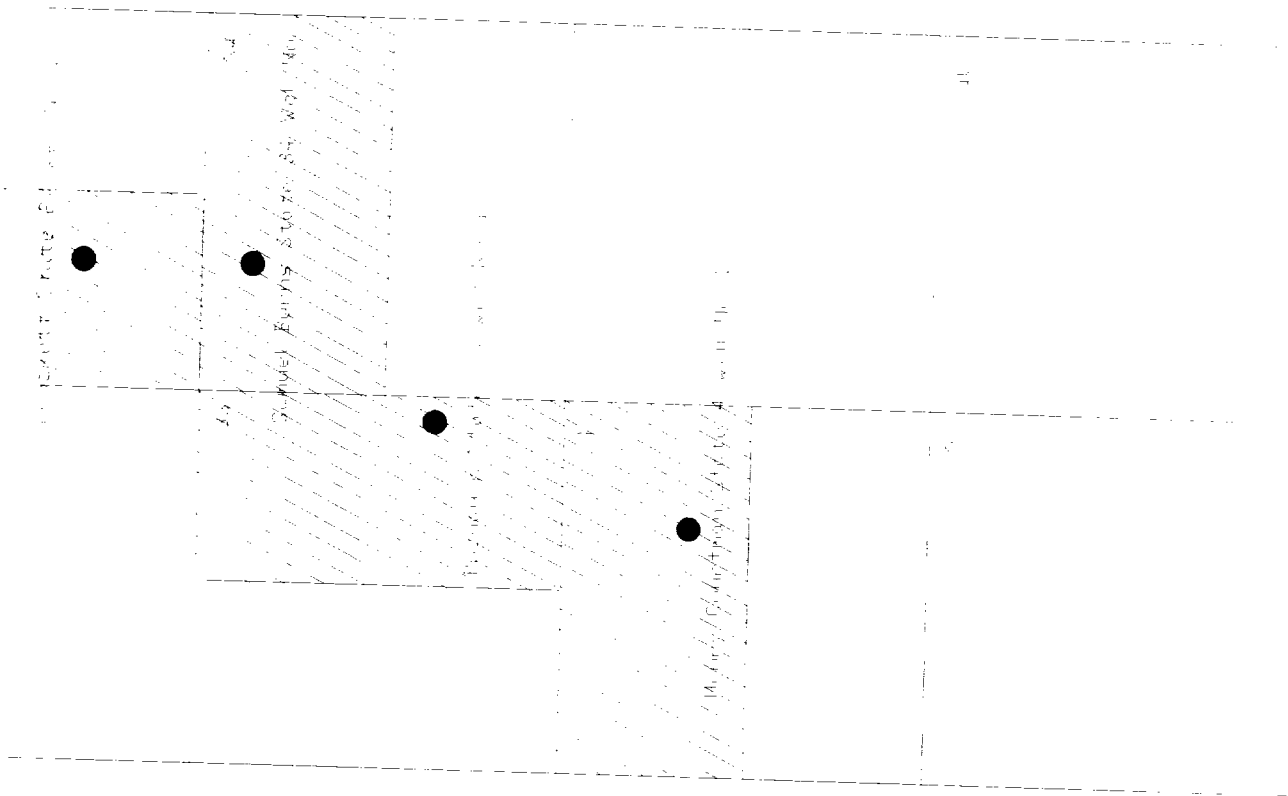

Top Left: Sample Points Set Map

Top Right: Sample Points Set Map

Bottom Left: Sample Points Set Map

Bottom Right: Sample Points Set Map

AMEND CTB 5/4/98

Mid-Continent Region  
Production United States



P.O. Box 2409  
Hobbs, NM 88241-2409  
Telephone 505/393-7106

April 7, 1998

Ms. Lori Wrotenbery, Director  
State of New Mexico  
Oil Conservation Division  
PO Box 2088  
Santa Fe NM 87504-2088

APR 13 1998

Re: Request for Exemption to Rule 309-A  
Surface Lease Commingling

Henry Courtman '4' St. Lease  
N 1/2, Sec. 4, T-19-S, R-28-E  
Eddy County  
Travis - Upper Penn

James Buchanan '33' St. Lease  
E 1/2, Sec. 33, T-18-S, R-28-E  
David Crockett '27' St. Lease  
S 1/2, Sec. 27, T-18-S, R-28-E  
Travis - Upper Penn  
Order No. CTB-467

Ms. Lori Wrotenbery:

Marathon Oil Company respectfully requests the State of New Mexico Oil Conservation Division to grant administrative approval for exemption to Rule 309-A for the above mentioned leases.

Marathon Oil Company proposes to produce the three leases to a common stock tank battery with separate metering facilities prior to commingling. The common battery will be at the James Buchanan '33' St. No. 1 location. It should be noted that there is a diversity of ownership between the leases. However, the proposed production operation is in accordance with the applicable provisions and all necessary parties have been notified by certified mail.

Please find attached a lease commingling plat and a production facility schematic. Please note that the value of the oil will not be adversely effected.

If you have any questions or comments, please advise.

Sincerely,

A handwritten signature in black ink, appearing to read 'Bryan L. Williams'.

Bryan L. Williams  
Production Engineer  
(505) 393-7106 ext. 212

n:/reglatory/comming/surface courtl\_a  
Attachments

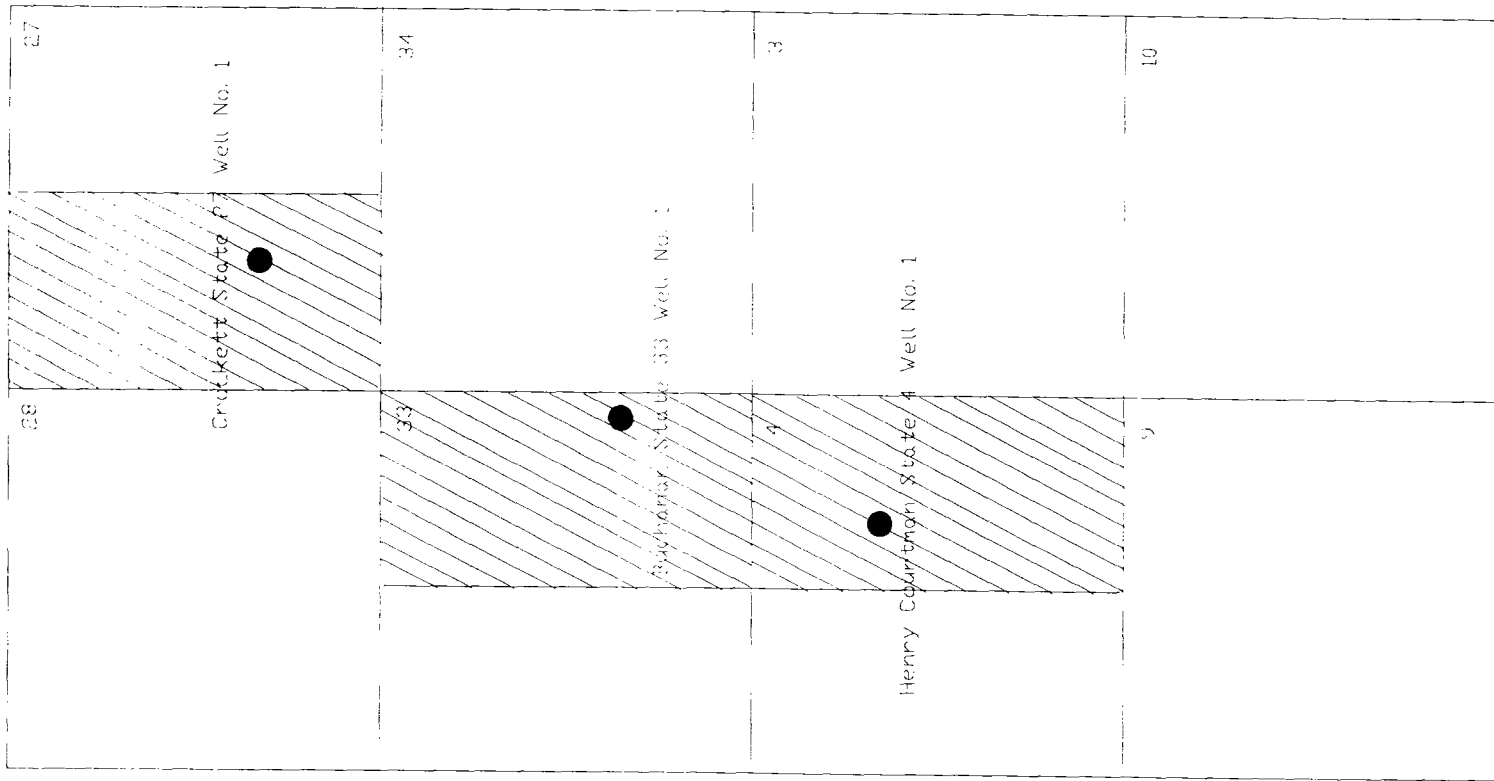

David Crockett State 27 Lease  
 Unit CDDJ,KLM&N  
 W 1/2, Sec. 27, T-18S, R-78E

James Buchanan State 33 Lease  
 Unit ABGH,IJOP  
 E 1/2, Sec. 33, T-18S, R-28E

Henry Courtman State 4 Lease  
 Unit ABGH,IJOP  
 E 1/2 Sec. 4, T-19S, R-28E

\_\_\_\_\_

-

2000

1999

1998

1997

11

1

2

3

4

5

6

1  
2  
3  
4  
5  
6  
7  
8  
9  
10  
11  
12

12

\_\_\_\_\_

-----

-----

11  
12  
13  
14  
15  
16  
17  
18  
19  
20  
21  
22  
23  
24  
25  
26  
27  
28  
29  
30  
31  
32  
33  
34  
35  
36  
37  
38  
39  
40  
41  
42  
43  
44  
45  
46  
47  
48  
49  
50  
51  
52  
53  
54  
55  
56  
57  
58  
59  
60  
61  
62  
63  
64  
65  
66  
67  
68  
69  
70  
71  
72  
73  
74  
75  
76  
77  
78  
79  
80  
81  
82  
83  
84  
85  
86  
87  
88  
89  
90  
91  
92  
93  
94  
95  
96  
97  
98  
99  
100

11

1

11  
12  
13  
14  
15  
16  
17  
18  
19  
20  
21  
22  
23  
24  
25  
26  
27  
28  
29  
30  
31  
32  
33  
34  
35  
36  
37  
38  
39  
40  
41  
42  
43  
44  
45  
46  
47  
48  
49  
50  
51  
52  
53  
54  
55  
56  
57  
58  
59  
60  
61  
62  
63  
64  
65  
66  
67  
68  
69  
70  
71  
72  
73  
74  
75  
76  
77  
78  
79  
80  
81  
82  
83  
84  
85  
86  
87  
88  
89  
90  
91  
92  
93  
94  
95  
96  
97  
98  
99  
100

111

112

113

114

115  
116  
117  
118  
119  
120  
121  
122  
123  
124  
125  
126  
127  
128  
129  
130  
131  
132  
133  
134  
135  
136  
137  
138  
139  
140  
141  
142  
143  
144  
145  
146  
147  
148  
149  
150  
151  
152  
153  
154  
155  
156  
157  
158  
159  
160  
161  
162  
163  
164  
165  
166  
167  
168  
169  
170  
171  
172  
173  
174  
175  
176  
177  
178  
179  
180  
181  
182  
183  
184  
185  
186  
187  
188  
189  
190  
191  
192  
193  
194  
195  
196  
197  
198  
199  
200

-----



CTB 467



COMMERCIAL RESOURCES  
(505)-827-5724

SURFACE RESOURCES  
(505)-827-5793

MINERAL RESOURCES  
(505)-827-3744

ROYALTY  
(505)-827-5772

State of New Mexico  
Commissioner of Public Lands

Ray Powell, M.S., D.V.M.  
310 Old Santa Fe Trail, P. O. Box 1148  
Santa Fe, New Mexico 87504-1148  
Phone (505)-827-5760, Fax (505)-827-5766

PUBLIC AFFAIRS  
(505)-827-5765

ADMINISTRATIVE MGMT.  
(505)-827-5700

LEGAL  
(505)-827-5713

PLANNING  
(505)-827-5752

April 23, 1998

Marathon Oil Company  
P.O. Box 2409  
Hobbs, New Mexico 88241-2409

Attn: Mr. Bryan L. Williams

Re: Application for Surface Commingling  
David Crockett '27' State Well No. 1  
W/2, Section 27-18S-28E  
James Buchanan '33' State Well No. 1  
E/2, Section 33-18S-28E  
Travis Upper Penn Pool  
Eddy County, New Mexico

Dear Mr. Williams:

The New Mexico Oil Conservation Division has advised this office that Marathon Oil Company has applied to surface commingle the production from the David Crockett '27' State Well No. 1 and the James Buchanan '33' State Well No. 1. Marathon Oil Company proposes to store the commingled production from the above-captioned wells at the Buchanan Well No. 1 tank battery site located in Unit Letter I of Section 33-18S-28E.

Pursuant to State Land Office Rule No. 1.053, 1.054 and 1.055, please submit an application to this office for our approval together with the data recommended on the attached commingling pre-application form. The filing fee for a commingling application is \$30.00.

If you have any questions or if we may be of further help, please contact Pete Martinez at (505) 827-5791.

Very truly yours,

RAY POWELL, M.S., D.V.M.  
COMMISSIONER OF PUBLIC LANDS

A handwritten signature in cursive script, appearing to read "Jami Bailey".

BY:  
JAMI BAILEY, Deputy Director  
Oil/Gas and Minerals Division  
(505) 827-5745

RP/JB/cpm  
Enclosure  
pc: Reader File

OCD--Attention: David Catanach, Ben Stone