



NEW MEXICO ENERGY, MINERALS
& NATURAL RESOURCES DEPARTMENT

OIL CONSERVATION DIVISION
2040 South Pacheco Street
Santa Fe, New Mexico 87505
(505) 827-7131

COMMINGLING ORDER PLC-67
2ND AMENDMENT

Conoco, Inc.
10 Desta Dr., Suite 100W
Midland, Texas 79705-4500

Attention: Ms. Ann Ritchie

The above-named company is hereby authorized to commingle Warren-McKee (Oil - 63270), Warren-Tubb (Oil - 63280), Blinebry Oil & Gas (Oil - 6660) and **East Skaggs-Abo (Oil - 56630)** Pool production from the following leases:

Lease: Southeast Monument Unit McKee
Description: Sections 18, 19, 20, 29 & 30, Township 20 South, Range 38 East, NMPM,

Lease: Southeast Monument Unit Blinebry
Description: Sections 18, 19, 20, 29 & 30, Township 20 South, Range 38 East, NMPM,

Lease: Southeast Monument Unit Tubb A Lease
Description: Sections 18, 19, 20, 29 & 30, Township 20 South, Range 38 East, NMPM,

Lease: Burger "B-20" Lease
Description: SE/4 NW/4 of Section 20, Township 20 South, Range 38 East, NMPM,

All in Lea County, New Mexico.

Production shall be allocated to each lease by separately metering the production from each lease prior to commingling.

NOTE: This installation shall be installed and operated in accordance with the applicable provisions of Rule 309-B of the Division Rules and Regulations and the Division "Manual for the Installation and Operation of Commingling Facilities." It is the responsibility of the producer to notify the transporter of this commingling authority.

REMARKS: The commingled production shall be stored at the SEMU "BMT" battery located in the NW/4 SW/4 of Section 20, Township 20 South, Range 38 East, NMPM, Lea County, New Mexico.

FURTHER: The operator shall notify the Hobbs District Office of the Division upon implementation of the commingling process.

Administrative Commingling Order PLC-67 Amended
Conoco, Inc.
December 6, 1999
Page 2

DONE at Santa Fe, New Mexico, on this 6th day of December, 1999.

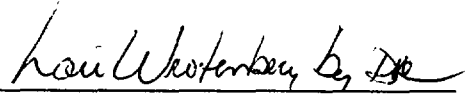
LORI WROTENBERY,
Division Director

LW/MWA/kv

cc: Oil Conservation Division- Hobbs

AMEND PLC ~~XXXXXX~~
12/6/99

October 18, 1999

New Mexico Oil Conservation Division
Department of Energy and Minerals
State of New Mexico
2040 South Pacheco
Santa Fe, NM 87501

OCT 25 1999

✓
Att: Mark Ashley, Engineering Unit

RE: **Conoco, Inc.**, Commingling Order PLC-67, SEMU and Burger "B-20",
"BMT" battery, Section 18, 19, 20, 29, & 30, T20S, R38E, Lea County,
New Mexico - Request for Amendment of Order

Dear Mark,

The Oil Conservation Division has previously approved the commingling of McKee, Blinebry, and Tubb production from Sections 18, 19, 20, 29 and 30, T20S, R38E at Conoco's SEMU "BMT" battery. Please see attached a copy of the latest "Amended", Commingling Order PLC-67 pertaining to this production facility.

The Burger B-20, Well #4 is currently approved under the above referenced order to produce Warren McKee pool "sweet" production into the battery. The oil is metered separately and then commingled in the run tank. The gas is metered and sold to GPM via a total flow gas meter. Conoco intends to recomplete Well #4 in the East Skaggs Abo pool. The Abo crude oil production gravity is sweet and has a gravity of 45 API degrees. The "BMT" battery oil gravity is 41.6 API degrees. We do not believe that the Abo gravity would effect the price per barrel.

Conoco is requesting permission to add production from the East Skaggs Abo to the existing Commingling Order PLC-67. I have enclosed copies of the area map and battery diagram. If you need any further information concerning this request, please contact me as listed below. Thank you.

Yours truly,



Ann E. Ritchie, Regulatory Agent
1-800-432-2967, (915) 682-1458-fax, e-mail: ARitc19676@aol.com
Conoco, Inc.
10 Desta Dr., Suite 100W
Midland, TX 79705-4500

Attachments

Cc: Reesa Wilkes-Conoco/Midland, *SEM - East Skaggs Abo* Roswell

November 16, 1999

New Mexico Oil Conservation Division
Department of Energy and Minerals
State of New Mexico
2040 South Pacheco
Santa Fe, NM 87501

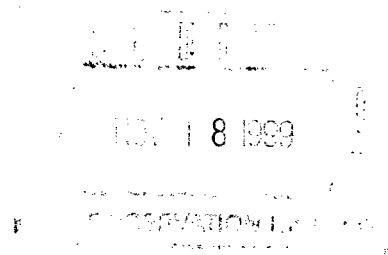

Att: Mark Ashley, Engineering Unit

RE: **Conoco, Inc.**, Commingling Order PLC-67, Burger B-20, Well #4, Lea County,
New Mexico

Dear Mark,

Please see below the ownership for the BurgerB-20 lease. Copies of the request to add the Burger B-20, Well #4 to the existing Commingling Order were sent to them on this date. Thank you.

Apache Corp., 2000 Post Oak Blvd., Suite 100, Houston, TX 77056-4497

Apache Corporation, P.O. Box 840133, Dallas, TX 75284-0133

Chevron USA, Inc, P.O. Box 840592, Dallas, TX 75284-0592

Minerals Management Service
Onshore Federal
P.O. Box 5810
Denver, CO 80217-5810

Conoco, Inc., 10 Desta Dr., Suite 100W, Midland, TX 79705-4500

Please let me know if you need any further information concerning this application.
Thank you.

Yours truly,

Ann E. Ritchie, Regulatory Agent
Conoco, Inc.
10 Desta Dr., Suite 100W
Midland, TX 79702

Cc: Reesa Wilkes-Conoco/Midland
Bureau of Land Management-Roswell

SEMU UNIT BOUNDARY

DEMORAY P/A C-4224-07

TUBB A' P/A C-4224-05

C-4224-10

DRINKARD P/A C-4224-04

EUMONT P/A C-4224-06

MCKEE P/A C-4224-03

BLINEBERRY A P/A

BLANKET P/A C-4224-08

PERMIAN P/A C-4224-09

GRAYBURG FORM.

C-4224-01 (LOWER PERM.)

C-4224-02 (UPPER PERM.)

STRAWN P/A

ARCO SALE
C-49108

7.5% ORR

DATE: 2/2/00

DRAWN BY: gld

CHECKED BY:

APPROVED BY:

SCALE: 1" = 2640'

STATE PLANE COORDINATES REFERRED TO

STATE PLANE COORDINATES

ZONE - 300

EPNGNA



MIDLAND DIVISION

SOUTHEAST MONUMENT UNIT AREA

NEW MEXICO

AP# STATE COUNTY DRAWING

30 / 025 SEMU-UNT

CONOCO INC. OFFICE

10 DESTA DRIVE WEST

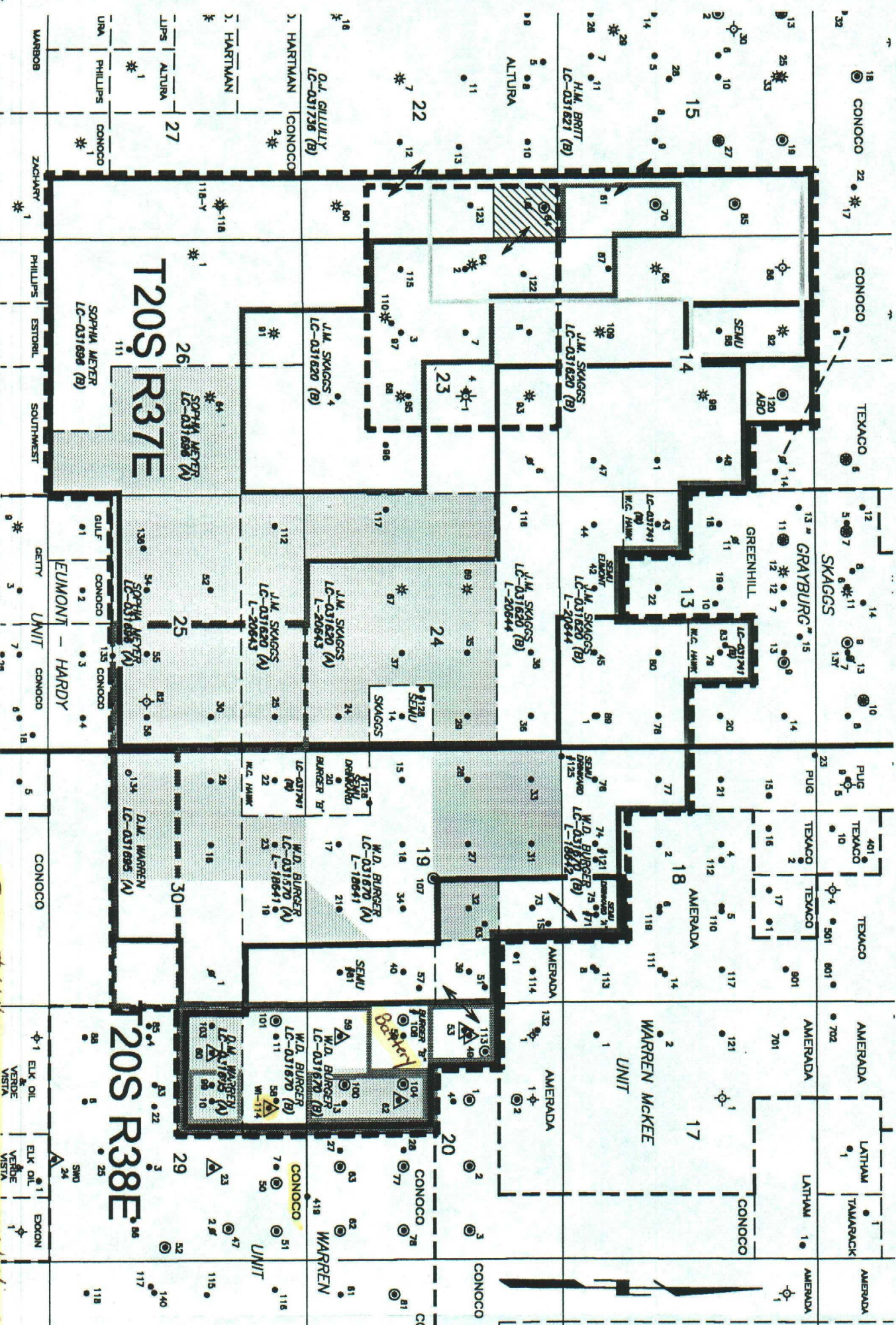

SEM# 114 - Strawn recompilation