

No. 41487  
Key Area

NEW MEXICO OIL CONSERVATION COMMISSION

C-128  
5/1/57

WELL LOCATION AND ACREAGE DEDICATION PLAT

SEE INSTRUCTIONS FOR COMPLETING THIS FORM ON THE REVERSE SIDE

SECTION A

Operator Texaco Inc.		Lease State of New Mexico "O" NCT-1		Well No. 11
Unit Letter F	Section 35	Township 17 South	Range 34 East	County Lea
Actual Footage Location of Well: 1980 feet from the North line and 1780 feet from the West line Sec. 36				
Ground Level Elev. 4003	Producing Formation "see attached sheet"	Pool "see attached sheet"	Dedicated Acreage: 40 Acres	

Depth: 11,900'

1. Is the Operator the only owner in the dedicated acreage outlined on the plat below? YES ☒ NO \_\_\_\_ ("Owner" means the person who has the right to drill into and to produce from any pool and to appropriate the production either for himself or for himself and another. (65-3-29 (e) NMSA 1935 Comp.)
2. If the answer to question one is "no," have the interests of all the owners been consolidated by communitization agreement or otherwise? YES \_\_\_\_ NO \_\_\_\_ . If answer is "yes," Type of Consolidation \_\_\_\_
3. If the answer to question two is "no," list all the owners and their respective interests below:

Owner	Land Description
-------	------------------

NOTICE OF LOCATION

SECTION B

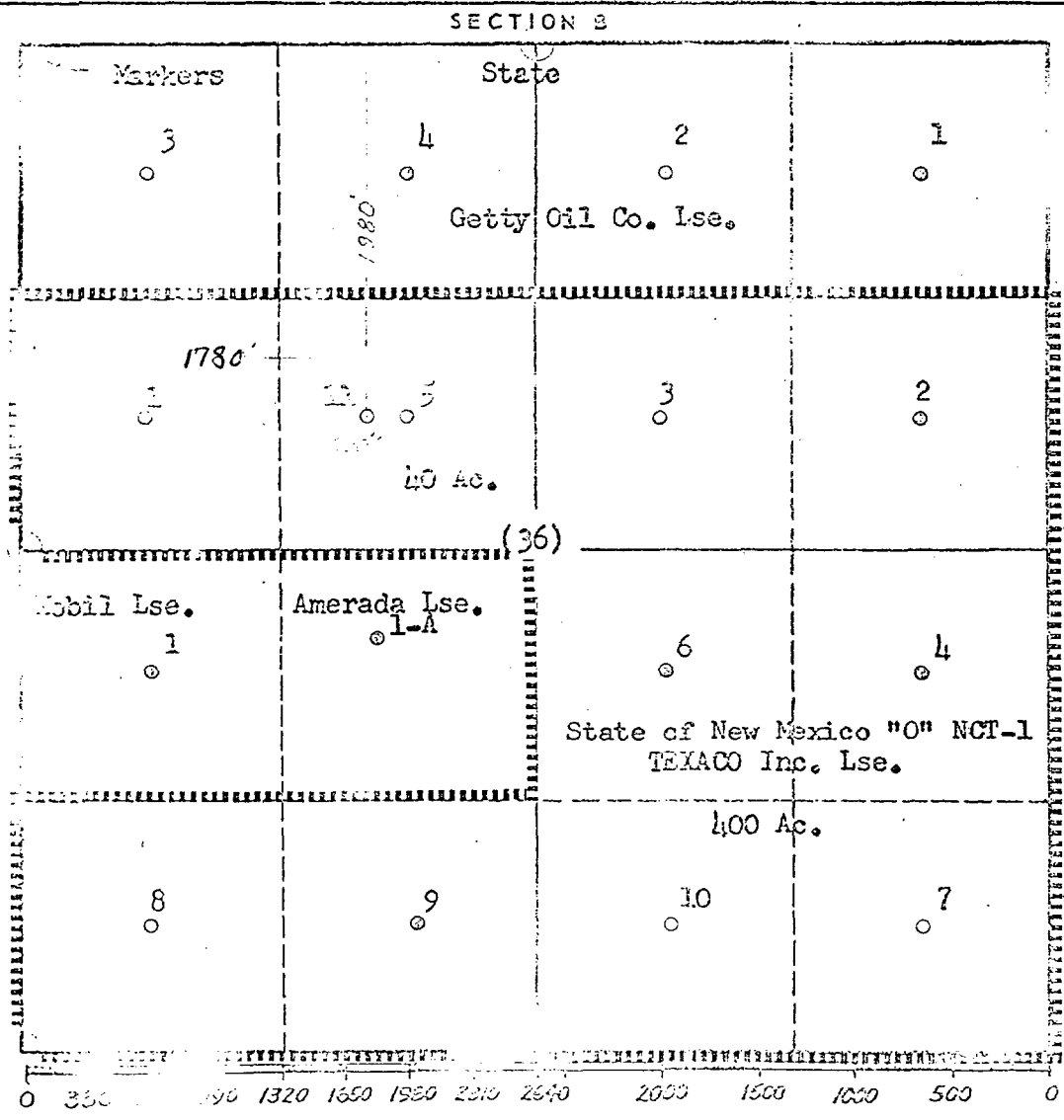

CERTIFICATION

I hereby certify that the information in SECTION A above is true and complete to the best of my knowledge and belief.

Name	J. J. Velten
Position	Division Civil Engineer
Company	TEXACO Inc.
Date	11/9/62

I hereby certify that the well location shown on the plat in SECTION B was plotted from field notes of actual surveys made by me or under my supervision, and that the same is true and correct to the best of my knowledge and belief.

Date Surveyed	11/9/62
Registered Professional Engineer and/or Land Surveyor	J. J. Velten
Certificate No.	8174

See 11/9/62 for well location and acreage

Producing Formations:

Wolfcamp  
Atoka  
Devonian

Pools:

Undesignated (Wolfcamp)  
Undesignated (Atoka)  
Undesignated (Devonian)

Lse. No. 41487

Buckeye Area

## NEW MEXICO OIL CONSERVATION COMMISSION

FORM C-128  
Revised 5/1/57

## WELL LOCATION AND ACREAGE DEDICATION PLAT

SEE INSTRUCTIONS FOR COMPLETING THIS FORM ON THE REVERSE SIDE

## SECTION A

Operator TEXACO Inc.		Lease State of New Mexico "0" NCT-1		Well No. 14
Unit Letter J	Section 36	Township 17 South	Range 34 East	County Lea
Actual Footage Location of Well: 1874 feet from the South line and 2086 feet from the East line Sec. 36				
Ground Level Elev. 3993	Producing Formation "see attached sheet"	Pool "see attached sheet"	Dedicated Acreage: 80 Acres	

Depth: 11,950

1. Is the Operator the only owner in the dedicated acreage outlined on the plat below? YES ☒ NO \_\_\_\_ ("Owner" means the person who has the right to drill into and to produce from any pool and to appropriate the production either for himself or for himself and another. (65-3-29 (e) NMSA 1935 Comp.)
2. If the answer to question one is "no," have the interests of all the owners been consolidated by communitization agreement or otherwise? YES \_\_\_\_ NO \_\_\_\_ . If answer is "yes," Type of Consolidation \_\_\_\_
3. If the answer to question two is "no," list all the owners and their respective interests below:

Owner	Land Description
-------	------------------

## NOTICE OF LOCATION

## SECTION B

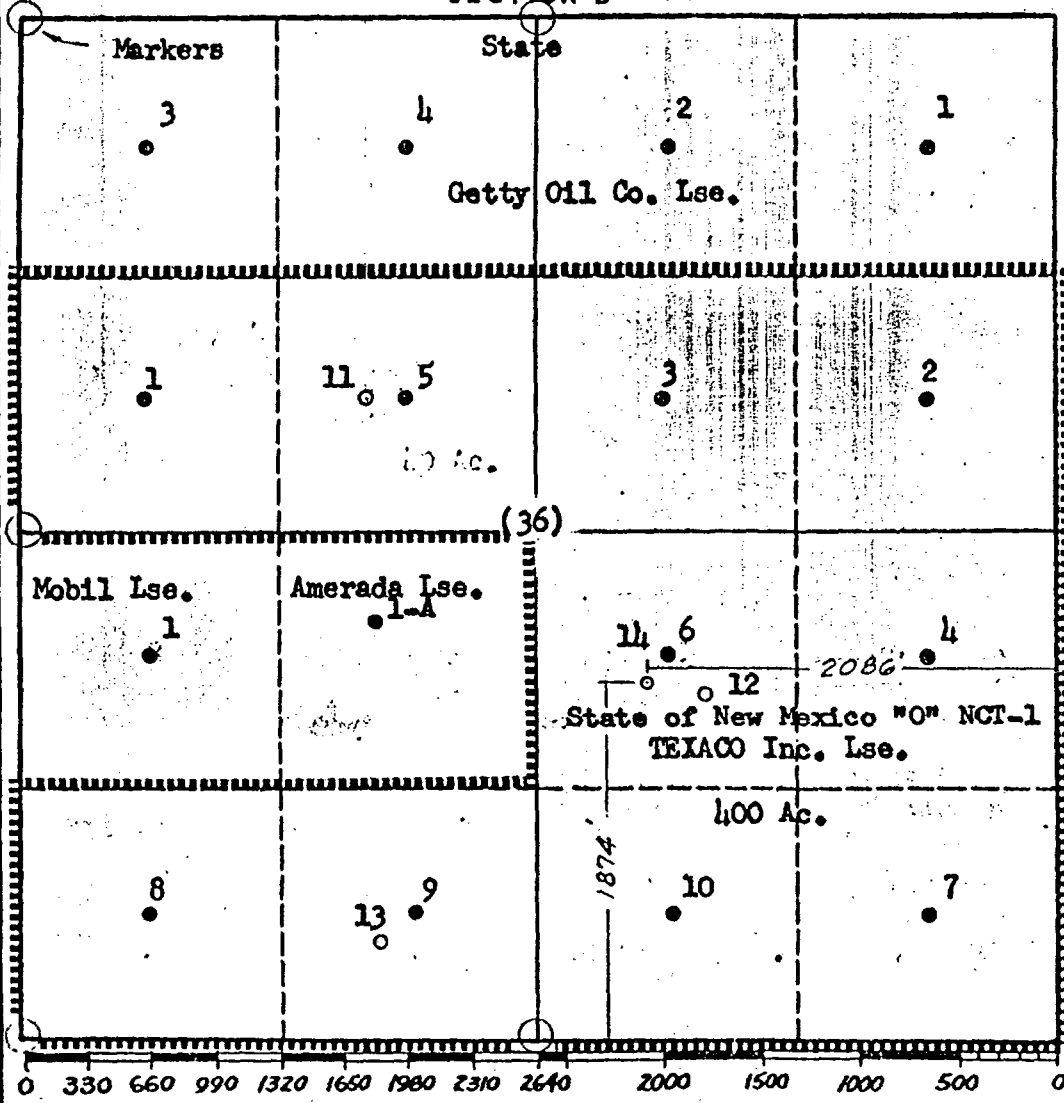

## CERTIFICATION

I hereby certify that the information in SECTION A above is true and complete to the best of my knowledge and belief.

Name	J. J. Velten
Position	Division Civil Engineer
Company	TEXACO Inc.
Date	2/8/63

I hereby certify that the well location shown on the plat in SECTION B was plotted from field notes of actual surveys made by me or under my supervision, and that the same is true and correct to the best of my knowledge and belief.

Date Surveyed	2/8/63
Registered Professional Engineer and/or Land Surveyor	J. J. Velten
Certificate No.	8174

See #18 for location

Producing Formations:

Wolfcamp

Abo

Devonian

Pools:

Undesignated (Wolfcamp)

Undesignated (Abo)

Undesignated (Devonian)

DISTRICT I  
P.O. Box 1980, Hobbs, NM 88241-1980  
DISTRICT II  
P.O. Box Drawer DD, Artesia, NM 88211-0719  
DISTRICT III  
1000 Rio Brazos Rd., Aztec, NM 87410  
DISTRICT IV  
P.O. Box 2088, Santa Fe, NM 87504-2088

State of New Mexico  
Energy, Minerals and Natural Resources Department

**OIL CONSERVATION DIVISION**

P.O. Box 2088  
Santa Fe, New Mexico 87504-2088

Form C-102

Revised February 10, 1994

Instructions on back

Submit to Appropriate District Office

State Lease - 4 Copies

Fee Lease - 3 Copies

☐ AMENDED REPORT

**WELL LOCATION AND ACREAGE DEDICATION PLAT**

<sup>1</sup> API Number 30-025-20057	<sup>2</sup> Pool Code 61760, 62320, 62340	<sup>3</sup> Pool Name VACUUM ABO NORTH/UPPER PENN/ WOLFCAMP
<sup>4</sup> Property Code 11096	<sup>5</sup> Property Name STATE BA	<sup>6</sup> Well No. 6
<sup>7</sup> OGRID Number 022351	<sup>8</sup> Operator Name TEXACO EXPLORATION & PRODUCTION INC.	<sup>9</sup> Elevation 4002' GR

<sup>10</sup> Surface Location

UI or lot no.	Section	Township	Range	Lot.Idn	Feet From The	North/South Line	Feet From The	East/West Line	County
D	36	17S	34E		660	North	860	West	Lea

<sup>11</sup> Bottom Hole Location If Different From Surface

UI or lot no.	Section	Township	Range	Lot.Idn	Feet From The	North/South Line	Feet From The	East/West Line	County

<sup>12</sup> Dedicated Acres 40	<sup>13</sup> Joint or Infill No	<sup>14</sup> Consolidation Code	<sup>15</sup> Order No.
-------------------------------------	-------------------------------------	----------------------------------	-------------------------

NO ALLOWABLE WILL BE ASSIGNED TO THIS COMPLETION UNTIL ALL INTERESTS HAVE BEEN CONSOLIDATED  
OR A NON-STANDARD UNIT HAS BEEN APPROVED BY THE DIVISION

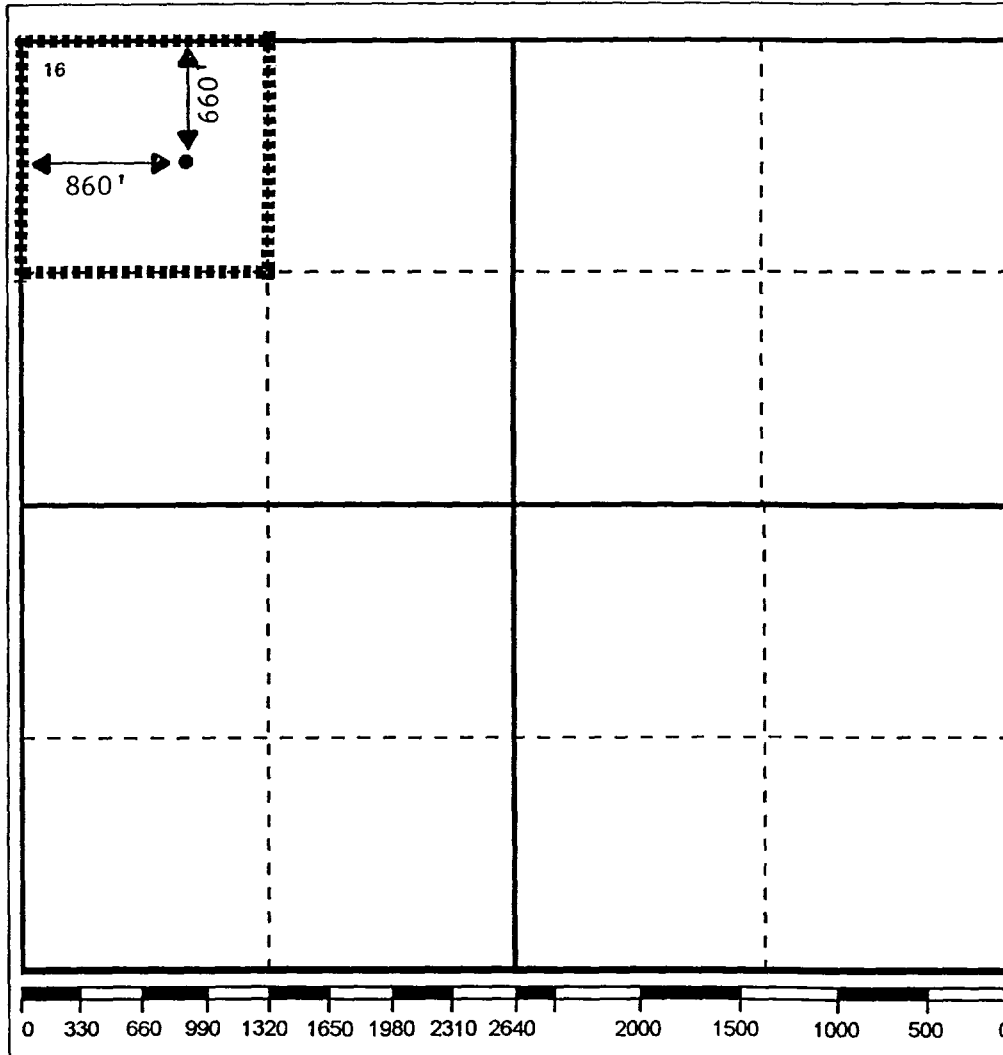

**17 OPERATOR CERTIFICATION**

I hereby certify that the information  
contained herein is true and complete to the  
best of my knowledge and belief

Signature

Printed Name

Monte C. Duncan

Position

Engr Asst

Date

5/1/96

**18 SURVEYOR CERTIFICATION**

I hereby certify that the well location shown  
on this plat was plotted from field notes of  
actual surveys made by me or under my  
supervision, and that the same is true and  
correct to the best of my knowledge and  
belief.

Date Surveyed

Signature & Seal of  
Professional Surveyor

Certificate No.

DISTRICT I  
P.O. Box 1980, Hobbs, NM 88241-1980  
DISTRICT II  
P.O. Box Drawer DD, Artesia, NM 88211-0719  
DISTRICT III  
1000 Rio Brazos Rd., Aztec, NM 87410  
DISTRICT IV  
P.O. Box 2088, Santa Fe, NM 87504-2088

State of New Mexico  
Energy, Minerals and Natural Resources Department

**OIL CONSERVATION DIVISION**

P.O. Box 2088  
Santa Fe, New Mexico 87504-2088

Form C-102  
Revised February 10, 1994  
Instructions on back  
Submit to Appropriate District Office  
State Lease - 4 Copies  
Fee Lease - 3 Copies  
☐ AMENDED REPORT

**WELL LOCATION AND ACREAGE DEDICATION PLAT**

<sup>1</sup> API Number 30-025-20986	<sup>2</sup> Pool Code 61760, 62320, 62340	<sup>3</sup> Pool Name VACUUM ABO NORTH/UPPER PENN/ WOLFCAMP
<sup>4</sup> Property Code 11096	<sup>5</sup> Property Name STATE BA	<sup>6</sup> Well No. 8
<sup>7</sup> OGRID Number 022351	<sup>8</sup> Operator Name TEXACO EXPLORATION & PRODUCTION INC.	<sup>9</sup> Elevation 3995' GL

<sup>10</sup> Surface Location

UI or lot no.	Section	Township	Range	Lot.Idn	Feet From The	North/South Line	Feet From The	East/West Line	County
B	36	17S	34E		766	NORTH	2086	EAST	LEA

<sup>11</sup> Bottom Hole Location If Different From Surface

UI or lot no.	Section	Township	Range	Lot.Idn	Feet From The	North/South Line	Feet From The	East/West Line	County

<sup>12</sup> Dedicated Acres 40	<sup>13</sup> Joint or Infill No	<sup>14</sup> Consolidation Code	<sup>15</sup> Order No.
-------------------------------------	-------------------------------------	----------------------------------	-------------------------

NO ALLOWABLE WILL BE ASSIGNED TO THIS COMPLETION UNTIL ALL INTERESTS HAVE BEEN CONSOLIDATED  
OR A NON-STANDARD UNIT HAS BEEN APPROVED BY THE DIVISION

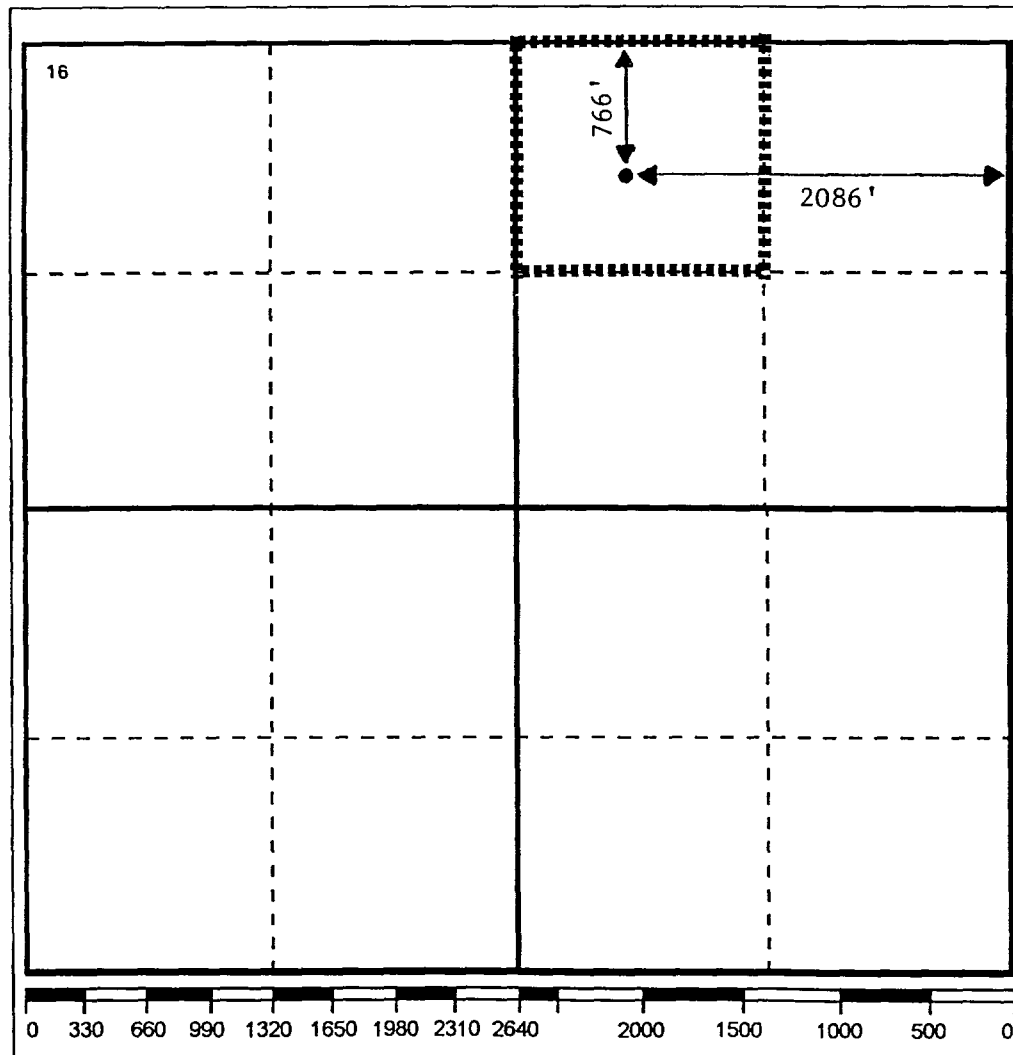

**17 OPERATOR CERTIFICATION**

I hereby certify that the information  
contained herein is true and complete to the  
best of my knowledge and belief

Signature

*Monte C. Duncan*

Printed Name

Monte C. Duncan

Position

Engr Asst

Date

5/1/96

**18 SURVEYOR CERTIFICATION**

I hereby certify that the well location shown  
on this plat was plotted from field notes of  
actual surveys made by me or under my  
supervision, and that the same is true and  
correct to the best of my knowledge and  
belief.

Date Surveyed

Signature & Seal of  
Professional Surveyor

Certificate No.