

August 16, 1961

Mr. J. Cleo Thompson
12th Floor Kirby Building
Dallas 1, Texas

Dear Mr. Thompson:

Reference is made to your application to the Oil Conservation Commission under date of August 10, 1961 which seeks to convert four oil wells to water injection wells, by administrative approval, in the Square Lake Pool, Eddy County, New Mexico.

Before this office can waive objections to the granting of your application, it will be necessary for us to have the construction information on each well involved in this matter. A diagrammatic sketch of the casing and cementing program, including the tubing and packer for injection purposes is usually considered the best means of transmitting the information. We are particularly interested in the depth setting of each string of casing and the amount of cement used and the elevation of the top of the cement behind each string, the age and condition as well as the size of each string of casing, the size and length of the tubing, if tubing is used for injection and the type packer used at the lower end of the tubing. We are also interested in the injection pressure and the source of the water which will be used in the flooding process.

You are no doubt aware that usable water, although limited in quantity, is found in the Square Lake area at depths from 100 to 300 feet and it is the duty of this office to see that these waters are adequately protected.

As soon as I have received the above requested information and had an opportunity to review it, I will forward to the Oil Conservation Commission my recommendations.

Yours truly,

S. E. Reynolds
State Engineer

By:

Frank E. Irby
Chief
Water Rights Division

FEI/ma
cc-Oil Conservation Comm.

J. CLEO THOMPSON, SR. & JAMES CLEO THOMPSON, JR.

OIL PRODUCERS
12TH FLOOR KIRBY BUILDING
DALLAS 1, TEXAS

August 10, 1961

Oil Conservation Commission
State of New Mexico
Santa Fe, New Mexico

Re: Case No. 1614, Order No. R-1354

APPLICATION FOR ADMINISTRATIVE APPROVAL
FOR THE CONVERSION OF THE FOLLOWING OIL
WELLS TO WATER INJECTION WELLS:

Leonard Federal #1 - Unit L, Sec. 34-16-30;

Leonard Federal #3 - Unit N, Sec. 34-16-30;

Leonard Federal #8, Unit D, Sec. 34-16-30;

Evans Federal #10 - Unit G, Sec. 33-16-30.

11

Gentlemen:

In support of our application for the conversion of the above mentioned wells to water injection wells, we submit herewith Form C-116 showing the production tests of the wells before they were stimulated by our present Pilot Water Flood.

We also attach hereto Form C-116 showing the production tests of the affected well or wells after they had been stimulated by our present Water Injection Pilot Flood. We also attach plats of the Water Flood project area, and the immediate surrounding area, and have indicated thereon the owner of each lease, and the location of all Water Injection Wells and producing wells. We also attach an affidavit to the effect that a copy of this application to convert additional wells to Water Injection Wells has been sent to the off-setting operators mentioned therein, as well as a copy of same to the State Engineer as shown by said affidavit.

Leonard Federal #1 - Unit L

Our Leonard #1 well was formerly plugged and abandoned but an application was filed and granted to reenter said well which was done and recently completed. A well log and a potential test will be filed within a short time showing this well's completion. We expect to produce it for a limited time, and then to convert it to a Water Injection Well in order to conform with our flood pattern which is a five-spot pattern, the same as our present Pilot Flood.

Your attention is called to the fact that this well's offset to the North, which is Leonard #6, on November 12, 1960, produced 1.39 barrels of oil, and this same well on July 10, 1961, on a 24-hour test produced 22.92 barrels. Your attention is called to the tests shown on other wells which we think conclusively establishes the fact that they have responded satisfactorily to the Water Injection Pilot Flood. We feel that this well should be converted to a Water Injection Well for the following reasons:

- (1) It would increase the ultimate recovery of oil (These wells are not economically profitable to operate unless production can be stimulated by water injection). This would enable us to recover large quantities of oil from the reservoir which could not be recovered by ordinary primary depletion methods;
- (2) It will enable us to "back up" our present pilot Water Flood, which will in turn increase our efficiency of said Pilot Flood. This proposed injection well is located on a water injection pattern that will result in a thorough and efficient sweep of oil by our Water Flood;
- (3) It will permit us to be able to substantially increase the ultimate recovery of oil from the Project area, and will prevent the migration of oil from the area.

Leonard Federal #3 - Unit N

In connection with our application to convert Leonard Federal #3 from an oil well to a Water Injection Well, your attention is called to the tests shown on Form C-116 made before stimulation and to the tests made after stimulation by Water Injection. These tests, as you will note, show that Leonard #3, on November 7, 1960, produced .69 of a barrel of oil, and on July 10, 1961, it produced 4.83 barrels of oil on a 24-hour test. You will also observe from the tests which are attached hereto that other wells near Leonard Federal #3 have been stimulated by the present Water Pilot Flood.

Our reasons stated in connection with our application for the conversion of Leonard Federal #1 - Unit L to a Water Injection Well apply with equal force

and effect to our request that our Leonard Federal #3 - Unit N well be converted to a Water Injection Well.

Leonard Federal #8 - Unit D

In support of our application for the conversion of Leonard #8 - Unit D well to a Water Injection Well, your attention is called to the fact that on November 10, 1960, this well produced .69 of a barrel of oil, and on July 19, 1961, it produced 5.56 barrels of oil. You will observe that other wells have been stimulated by the Pilot Flood as is shown by the tests made before stimulation and after stimulation.

Our reasons stated in connection with our application for the conversion of Leonard #1 - Unit L to a Water Injection Well apply with equal force and effect to our request that our Leonard Federal #8, Unit D well be converted to a Water Injection Well.

Evans Federal #10 - Unit G

This well will enable us to form another five-spot pattern for water Flood Injection, Leonard Federal #6 being the key well to said five-spot pattern. You will note from our forms C-116 on tests made before stimulation and tests made after stimulation that our direct offset producing well being Leonard #6 - Unit E as shown on the plat on tests made on November 12, 1960, this well made 1.39 barrels of oil, and on tests on the same well on July 10, 1961, on a 24-hour test made 22.92 barrels of oil and no water. This, we feel, resulted from the present Pilot Flood.

Our reasons stated in connection with our application for the conversion of Leonard Federal #1 - Unit L to a Water Injection Well apply with equal force and effect that our Evans Federal #10 - Unit G well be converted to a Water Injection Well.

In connection with the plat which is attached hereto, you are informed that only a part of Section 33 is shown on the plat attached hereto, but in this connection you are advised that we own the Oil and Gas Leasehold rights on all of Section 33, and likewise own all of the Oil & Gas Leasehold rights on the East Half (E/2) of Section 32, T-16-S, Range 30 E. This fact is mentioned in order to advise you that there are no offsetting operators to our Evans #10 Unit G other than ourselves.

From the facts above stated and shown on the attached exhibits, you will note that a substantial response to our Water Injection Pilot Program has been experienced, as shown by the tests made before and after stimulation, and we sincerely feel that all of the wells requested to be converted to Water

Injection Wells mentioned herein should be granted in order to enable us to obtain maximum efficiency of our Water Flood Program and Pattern, and enable us to back up our present Water Injection Pilot Flood. We feel that a delay in granting this request would not be in the interest of Conservation.

We sincerely trust that favorable consideration will be granted to this request and if you desire other or additional information, you will kindly advise us.

Very truly yours,

J. CLEO THOMPSON

JCT: b . .
Encl.

STATE OF TEXAS

I

COUNTY OF DALLAS

I

This is to certify that I have this day mailed copies of
the following instruments:

(A) The plat certified to by Jimmie Thompson on August 9, 1961;

(B) A copy of the Application of J. Cleo Thompson, dated
August 10, 1961, addressed to the Oil Conservation
Commission of the State of New Mexico, for
Administrative Approval for the Conversion of the
following oil wells to Water Injection Wells:

Leonard Federal #1 - Unit L, Sec. 34-16-30;

Leonard Federal #3 - Unit N, Sec. 34-16-30;

Leonard Federal #8, Unit D, Sec. 34-16-30;

Evans Federal #10 - Unit ~~X~~, Sec. 33-16-30;

H

(C) A copy of Form C-116 made before water stimulation
signed by Jimmie Thompson, dated August 10, 1961, and
a copy of Form C-116 executed by Jimmie Thompson on
August 10, 1961, showing the tests of the wells mentioned
therein after water stimulation;

to the following off-set operators as shown on the plat certified to by

Jimmie Thompson on August 9, 1961, as well as a copy of same to the

State Engineer:

General American Oil Company, Meadows Building, Dallas, Texas;
Texaco, Inc., Petroleum Life Building, Midland, Texas;
Mr. R. D. Collier, 907 W. Texas Avenue, Artesia, New Mexico;
Ambassador Oil Corporation, Box 9338, Fort Worth 7, Texas;
Nearburg & Ingram, 100 S. Kentucky Ave., Roswell, New Mexico.

EXECUTED this the 10th day of August, 1961.

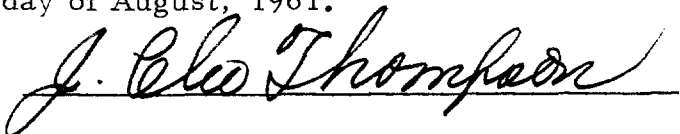

SUBSCRIBED AND SWORN TO BEFORE ME, this the 10th day of August,
1961.

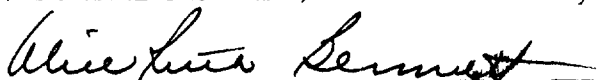

Notary Public, Dallas County, Texas

NEW MEXICO OIL CONSERVATION COMMISSION

GAS-OIL RATIO REPORT

OPERATOR E. Glen Thompson POOL Shure Lake
ADDRESS 1203 Kirby Blvd., Dallas 1, Texas MONTH OF August, 19 61
SCHEDULED TEST _____ COMPLETION TEST _____ SPECIAL TEST X (Check One)
(See Instructions on Reverse Side)

BEFORE STIMULATION

Lease	Well No.	Date of Test	Producing Method	Choke Size	Test Hours	Daily Allowable Bbls.	Production During Test			GOR Cu. Ft. Per Bbl.
							Water Bbls.	Oil Bbls.	Gas MCF	
Etz "G"	2	11-2-60	Surf	-	24	0	0	3.45	2.17	622
	3	11-7-60	Surf	-	24	2	0	.60	TST	TST
	4	11-5-60	Surf	-	24	15	0	1.38	TST	TST
Etz "H"	1	11-25-61	Surf	-	24	3	0	5.53	2.42	438
	4	11-25-60	Surf	-	24	3	0	1.30	TST	TST
Leonard	3	11-7-60	Surf	-	24	7	0	.60	TST	TST
	6	11-10-60	Surf	-	24	10	0	1.30	TST	TST
	7	11-10-60	Surf	-	24	3	0	1.38	TST	TST
	8	11-10-60	Surf	-	24	3	0	.60	TST	TST

11 wells located in Sec. 24-166-301, Tady Co., N.M. were too small to measure
No well will be assigned an allowable greater than the amount of oil produced on the official test.

During gas-oil ratio test, each well shall be produced at a rate not exceeding the top unit allowable for the pool in which well is located by more than 25 percent. Operator is encouraged to take advantage of this 25 percent tolerance in order that well can be assigned increased allowables when authorized by the Commission.

Gas volumes must be reported in MCF measured at a pressure base of 15.025 psia and a temperature of 60 degrees F. Specific gravity base will be 0.60.

Mail original and one copy of this report to the district office of the New Mexico Oil Conservation Commission. In accordance with Rule 301 and Appropriate Pool Rules.

(I certify that the information given is true and complete to the best of my knowledge.)

Date August 10, 1961

By E. Glen Thompson Company Shure Lake
Jimmie Thompson
Chief Engineer Title

NEW MEXICO OIL CONSERVATION COMMISSION

GAS-OIL RATIO REPORT

OPERATOR J. Cleo Thompson POOL Square Lake
 ADDRESS 1203 Kirby Bldg., Dallas 1, Texas MONTH OF August, 1961
 SCHEDULED TEST _____ COMPLETION TEST _____ SPECIAL TEST X (Check One)
 (See Instructions on Reverse Side)

BEFORE STIMULATION

Lease	Well No.	Date of Test	Producing Method	Choke Size	Test Hours	Daily Allowable Bbls.	Production During Test			GOR Cu. Ft. Per Bbl.
							Water Bbls.	Oil Bbls.	Gas MCF	
Etz "C"	2 I	11-2-60	Pump	-	24	2	0	3.45	2.17	629
	3 P	11-7-60	Pump	-	24	3	0	.69	TSTM	TSTM
	4 J	11-5-60	Pump	-	24	15	0	1.38	TSTM	TSTM
Etz "E"	1 G	1-25-61	Pump	-	24	3	0	5.53	2.42	438
	4 A	11-25-60	Pump	-	24	8	0	1.39	TSTM	TSTM
Leonard	3 N	11-7-60	Pump	-	24	7	0	.69	TSTM	TSTM
	6 E	11-12-60	Pump	-	24	10	0	1.39	TSTM	TSTM
	7 C	11-12-60	Pump	-	24	3	0	1.38	TSTM	TSTM
	8 D	11-10-60	Pump	-	24	3	0	.69	TSTM	TSTM

All wells located in Sec. 34-16S-30E, Eddy Co. N.M. TSTM-too small to measure
 No well will be assigned an allowable greater than the amount of oil produced on the official test.

During gas-oil ratio test, each well shall be produced at a rate not exceeding the top unit allowable for the pool in which well is located by more than 25 percent. Operator is encouraged to take advantage of this 25 percent tolerance in order that well can be assigned increased allowables when authorized by the Commission.

Gas volumes must be reported in MCF measured at a pressure base of 15.025 psia and a temperature of 60 degrees F. Specific gravity base will be 0.60.

Mail original and one copy of this report to the district office of the New Mexico Oil Conservation Commission. In accordance with Rule 301 and Appropriate Pool Rules.

(I certify that the information given is true and complete to the best of my knowledge.)

Date August 10, 1961

J. CLEO THOMPSON
 By Jimmie Thompson Company _____
 Chief Engineer
 Title _____

NEW MEXICO OIL CONSERVATION COMMISSION

GAS-OIL RATIO REPORT

OPERATOR J. Cleo Thompson POOL Square Lake
ADDRESS 1203 Kirby Bldg., Dallas 1, Texas MONTH OF August, 19 61
SCHEDULED TEST _____ COMPLETION TEST _____ SPECIAL TEST X (Check One)
(See Instructions on Reverse Side)

AFTER STIMULATION

Lease	Well No.	Date of Test	Producing Method	Choke Size	Test Hours	Daily Allowable Bbls.	Production During Test			GOR Cu. Ft. Per Bbl.
							Water Bbls.	Oil Bbls.	Gas MCF	
Etz "C"	2I	7-22-61	Pump	-	24	15	.69	11.09	2.07	187
" "	3P	7-21-61	Pump	-	24	1	-0-	3.45	T.S.T.M.	T.S.T.M.
" "	40	7-24-61	Pump	-	24	20	-0-	11.09	1.77	160
Etz "E"	1G	7-24-61	Pump	-	24	25	2.77	39.95	8.43	211
" "	4A	7- 9-61	Pump	-	24	25	41.60	15.27	T.S.T.M.	T.S.T.M.
Leonard	3N	7-10-61	Pump	-	24	5	-0-	4.83	T.S.T.M.	T.S.T.M.
" "	6E	7-10-61	Pump	-	24	34	-0-	22.92	6.08	265
" "	7C	7- 9-61	Pump	-	24	2	-0-	10.42	T.S.T.M.	T.S.T.M.
" "	8D	7-19-61	Pump	-	24	2	-0-	5.56	T.S.T.M.	T.S.T.M.
All wells located in Section 34, Township 16 South; Range 30 East, Eddy County, New Mexico										
T.S.T.M. - too small to measure.										

No well will be assigned an allowable greater than the amount of oil produced on the official test.

During gas-oil ratio test, each well shall be produced at a rate not exceeding the top unit allowable for the pool in which well is located by more than 25 percent. Operator is encouraged to take advantage of this 25 percent tolerance in order that well can be assigned increased allowables when authorized by the Commission.

Gas volumes must be reported in MCF measured at a pressure base of 15.025 psia and a temperature of 60 degrees F. Specific gravity base will be 0.60.

Mail original and one copy of this report to the district office of the New Mexico Oil Conservation Commission. In accordance with Rule 301 and Appropriate Pool Rules.

(I certify that the information given is true and complete to the best of my knowledge.)

Date August 10, 1961

J. CLEO THOMPSON
By Jimmie Thompson Chief Engineer
Title

**J. CLEO THOMPSON PILOT WATERFLOOD OPERATIONS
SQUARE LAKE FIELD, EDDY COUNTY, NEW MEXICO**

	<u>Leonard No. 1</u>	<u>Leonard No. 3</u>	<u>Leonard No. 8</u>	<u>Evans No. 10</u>
Date Completed	: 8-20-61	3-28-42	3-28-42	10-14-42
Elevation	: 3742 G	3735 G	3745 G	3744 KB
Oil String Size	: 4 1/2"	7"	7"	5 1/2"
Oil String Depth	: 2930'	2819'	2794'	2816'
Amt. Cement Used	: 100	100	100	100
Cal. Top of Cement:	1555'	2424'	2399'	2218'
Surf. Casing Size	: 8 5/8"	10 3/4"	10 3/4"	8 5/8"
Surf Casing Depth	: 485'	512'	467'	547'
Amt. Cement Used	: 50	50	50	50
Cal Top of Cement	: 196'	387'	342'	252'
Total Depth	: 3126'	3171'	3090'	2957'

1961 AUG 28 AM 8:07
STATE ENGINEER OFFICE
SANTA FE, N.M.

SQUARE LAKE FIELD EDDY COUNTY, N. M.

R 30 E

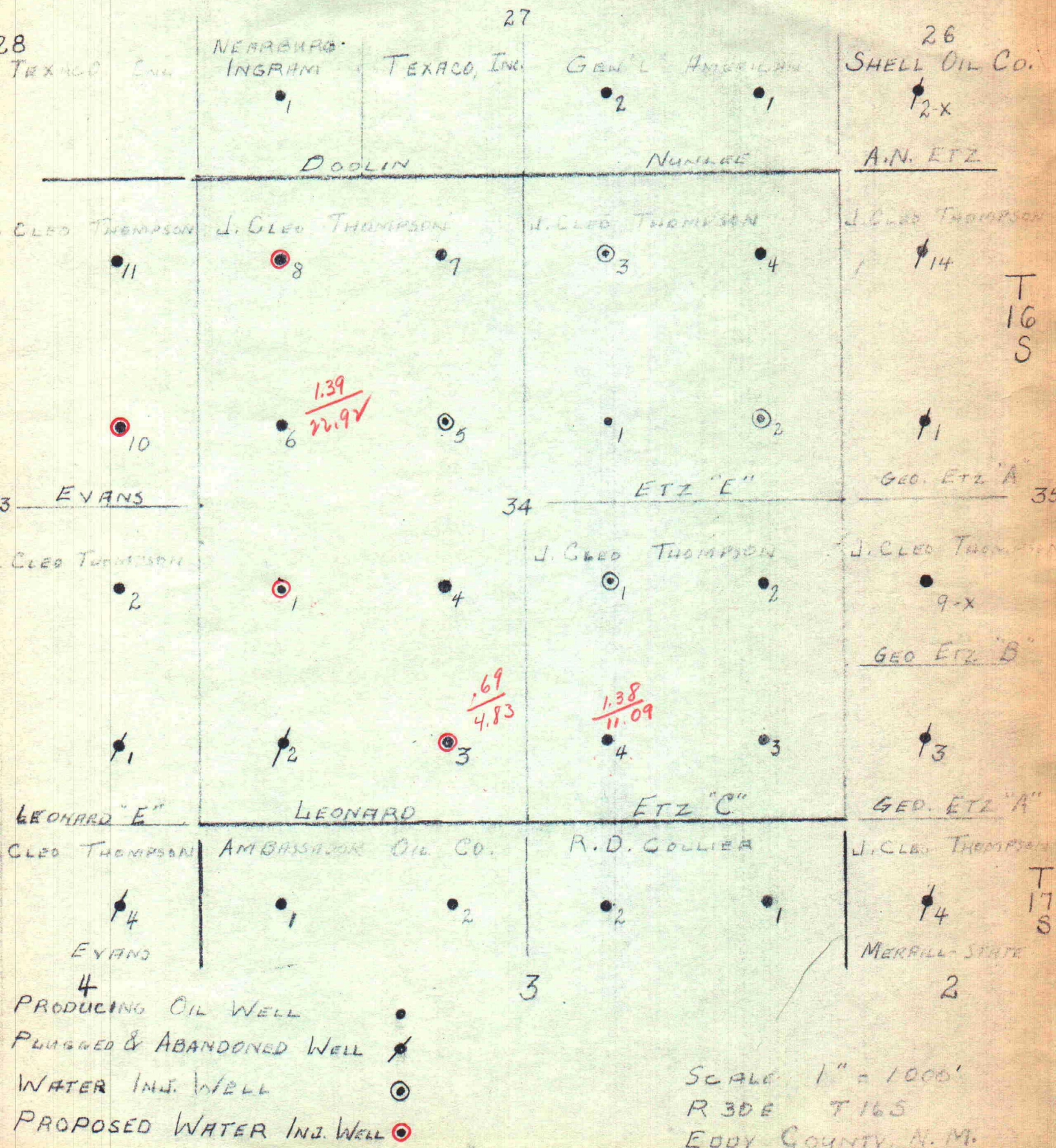

I, Jimmie Thompson, do state that the above plat, according to my information and belief correctly represents the location of all wells indicated thereon, and the leasehold estate owners of all offsetting acreage.

Jimmie Thompson

SUBSCRIBED AND SWORN TO BEFORE ME this the 9th day of August A. D. 1961.

Louis Connolly

Notary Public, in and for Dallas County, Texas

TEXACO INC.

PETROLEUM PRODUCTS

DOMESTIC PRODUCING DEPARTMENT
MIDLAND DIVISION



P. O. BOX 3109
MIDLAND, TEXAS

August 11, 1961

W 74-88

New Mexico Oil Conservation Commission
P. O. Box 871
Santa Fe, New Mexico

Attn: Mr. J. E. Kapteina

Gentlemen:

TEXACO Inc. has been notified by Mr. J. C. Thompson of his application to convert his Leonard Wells No. 1, 3, and 8 in Section 34, T-16-S, R-30-E, and Evans Well No. 10 in Section 33, T-16-S, R-31-E, Eddy County, New Mexico, into water injection wells. TEXACO Inc. has no objection to this application.

Yours very truly,

B. L. Francis
B. L. Francis
Assistant Division Manager

CRB-MM

GENERAL AMERICAN OIL COMPANY OF TEXAS

MEADOWS BUILDING

DALLAS 6, TEXAS

August 14, 1961

Oil Conservation Commission
State of New Mexico
Santa Fe, New Mexico

Attention: Mr. J. E. Kapteina
Engineer

Gentlemen:

We received from J. Cleo Thompson a copy of their application to convert their Leonard oil wells nos. 1, 3, and 8, Section 34, T-16S, R-30E, and Evans oil well no. 10, Section 33, T-16S, R-31E, Eddy County, New Mexico, to water input wells. Also, we were furnished with a copy of Form C-116 showing tests made on all wells in this area before waterflood stimulation and after waterflood stimulation.

This letter is to advise the Oil Conservation Commission that General American Oil Co. of Texas waives all objections to the Commission's granting the applicant permission to convert the above-mentioned wells to water injection wells.

Yours very truly,

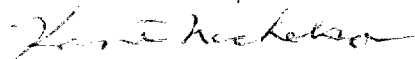

Kent Nicholson
Engineer

KN:gk

cc: Mr. J. Cleo Thompson

EUGENE E. NEARBURG



TOM L. INGRAM

NEARBURG & INGRAM

100 SOUTH KENTUCKY AVENUE

ROSWELL, NEW MEXICO

August 15, 1961

New Mexico Oil Conservation Commission
P. O. Box 371
Santa Fe, New Mexico

Attn: Mr. J. E. Kapteina

Re: Square Lake Area
Eddy County, New Mexico

Gentlemen:

We have received J. Cleo Thompson's application to expand his water-flood in Sections 33 and 34 of Township 16 South, Range 30 East, in the Square Lake Pool.

As operators of a lease covering the SW/4 SW/4 of Section 27, which is a north offset to one of the proposed injection wells, we have no objection to the proposed plan of development.

Yours very truly,

NEARBURG & INGRAM

Tom L. Ingram

TLI:rm

cc: J. Cleo Thompson
Dallas, Texas

Collier Drilling Company



• 5 MILES EAST OF ARTESIA ON LOVINGTON HIGHWAY •
OFFICE - PHONE SHERWOOD 6-6311
P. O. BOX 798

BUCYRUS & WALKER-NEER RIGS
TURNKEY AND CONTRACT DRILLING

R. D. (STATIC) COLLIER, OWNER
PHONE SHERWOOD 6-2614

ARTESIA, NEW MEXICO

August 16, 1961

W 7 V - 88

J. E. Kapteina, Engineer
Oil Conservation Commission
State of New Mexico
Santa Fe, New Mexico

Dear Mr. Kapteina:

We have received a copy of J. Cleo Thompson, Sr. & James Cleo Thompson, Jr. application to convert their Leonard oil wells No. 1, 3, and 8, in Section 34, T-16S, R-30-E, and Evans oil well No. 10, in Section 33, T-16-S, R-31-E, all in Eddy County, New Mexico, into water injection wells.

This letter will waive any objection to your granting their request to convert the above mentioned wells into water injection wells.

Yours very truly,

R. D. Collier

RDC/mh

cc: J. Cleo Thompson
1203 Kirby Bldg.
Dallas 1, Texas

AMBASSADOR OIL CORPORATION

AMBASSADOR BUILDING

3109 WINTHROP P. O. Box 9338

FORT WORTH 7, TEXAS

F. KIRK JOHNSON
PRESIDENT

SEPTEMBER 1, 1961

CABLE ADDRESS:
FRANJO, FORT WORTH

OIL CONSERVATION COMMISSION
STATE OF NEW MEXICO
SANTA FE, NEW MEXICO

ATTENTION: MR. J. E. KAPTEINA

GENTLEMEN:

IT HAS BEEN REQUESTED BY MESSRS. J. CLEO THOMPSON, SR., AND JR., THAT WE INFORM YOU WE HAVE RECEIVED THEIR REQUEST TO EXPAND THEIR PILOT WATERFLOOD IN THE SQUARE LAKE FIELD, EDDY COUNTY, NEW MEXICO. SPECIFICALLY, THEY REQUEST PERMISSION TO CONVERT THEIR LEONARD #1, #3 AND #8, SECTION 34, T16S, R30E AND EVANS #10, SECTION 10, T16S, R30E TO WATER INJECTION STATUS.

THIS INFORMATION HAS BEEN SUPPLIED US AND AS A SOUTH OFFSET OPERATOR, WE HAVE NO OBJECTION TO YOUR GRANTING THIS REQUEST.

WE ARE CURRENTLY NEGOTIATING WITH THE ABOVE GENTLEMEN FOR A COOPERATIVE AGREEMENT WHEREBY THE FLOOD CAN BE EXPANDED ONTO AMBASSADOR OIL CORPORATION'S FEDERAL "Q" LEASE LOCATED IN THE NW/4 OF SECTION 3, T17S, R30E AND FEEL THE REQUEST SHOULD BE GRANTED TO EXPEDITE EARLY EXPANSION OF THE FLOOD PATTERN, THEREBY RECEIVING ULTIMATE OIL RECOVERY.

VERY TRULY YOURS, .

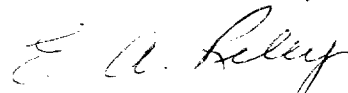

E. A. "MIKE" RILEY

SUPERINTENDENT

SECONDARY RECOVERY DIVISION

EAR/ms

CC: J. CLEO THOMPSON, SR., & JR.
KIRBY BUILDING
DALLAS 1, TEXAS



STATE OF NEW MEXICO

STATE ENGINEER OFFICE

SANTA FE

S. E. REYNOLDS
STATE ENGINEER

September 1, 1961

ADDRESS CORRESPONDENCE TO:
STATE CAPITOL
SANTA FE, N. M.

Mr. A. L. Porter, Jr.
Secretary-Director
Oil Conservation Commission

Dear Mr. Porter:

Reference is made to the application of J. Cleo Thompson, Sr. and James Cleo Thompson, Jr., dated August 10, 1961 which seeks administrative approval for the conversion of the following wells to water injection wells and to subsequent correspondence between Mr. Thompson and me.

Leonard Federal No. 1, Unit L, Section 34
Leonard Federal No. 3, Unit N, Section 34
Leonard Federal No. 8, Unit D, Section 34
Evans Federal No. 10, Unit H, Section 33

All in Township 16 South, Range 30 East.

The State Engineer offers no objection to the granting of this application provided the casing on each of the wells is tested successfully to a pressure of 2300 to 2500 pounds per square inch and the State Engineer is notified forty-eight hours in advance of testing and is privileged to witness the test. If the casing test above mentioned is not successful, then we would waive objection provided injection was made through tubing with packer set below the top of cement in the annulus behind the oil string. This office does object to the granting of the application if these conditions are not met.

Yours truly,

S. E. Reynolds
State Engineer

FEI/ma
cc-F. H. Hennighausen to the
Attn. of James I. Wright

J. C. Thompson, Sr.

By: *Frank E. Irby*
Frank E. Irby
Chief
Water Rights Division

Irby
1961 AUG 28 AM 8:07
STATE ENGINEER OFFICE
SANTA FE, N.M.

J. CLEO THOMPSON, SR. & JAMES CLEO THOMPSON, JR.

OIL PRODUCERS

222 FLOOR KERRY BUILDING

DALLAS 1, TEXAS

August 24, 1961

Mr. Frank Irby
State Engineer Office
Santa Fe, New Mexico

Re: J. Cleo Thompson Pilot Waterflood
Operation, Square Lake Field, Eddy
County, New Mexico

Dear Mr. Irby:

Reference is made to your letter dated August 16, 1961, concerning the above mentioned matter, and for your information, you will find enclosed a data sheet covering the four wells involved in this operation.

You are further advised that we plan to inject approximately 300 to 400 barrels of water per day in each injection well at a maximum of 1650 P.S.I.. We are securing our water from our two present water wells found at a depth of approximately 425 feet to 450 feet. It is also, possibly that we will use some water found at a depth of approximately 2100 feet but as of this date we do not plan on it unless it becomes necessary.

You are further advised that we do not plan on using tubing on any of these four injection wells or any packers, unless it becomes necessary or is advisable.

We will, of course, test all of the casing for leaks before they are put on injection and should there be a leak in the casing we would, of course, fix the leak before putting it on injection and should there arise a leak, at any time in the future, we would, of course, fix it.

We sincerely hope that this information serves your purpose and that in the immediate future, you can waive any objections to our application and so advise the Oil Conservation Commission at your earliest convenience.

Yours truly,

Jimmie Thompson
JIMMIE THOMPSON