

117
11 21

NEWMONT OIL COMPANY
300 BOOKER BUILDING
ARTESIA, NEW MEXICO

September 5, 1962

NEW MEXICO
DISTRICT OFFICE

State of New Mexico
Oil Conservation Commission
P. O. Box 871
Santa Fe, New Mexico

Gentlemen:

We hereby make application for administrative approval to drill Scheurich No. 9 as a water injection well 1650' from the south line, 990' from the west line of Sec. 32, T-17-S, R-30-E, to inject into the Grayburg formation.

The casing program is to set new 8 5/8" casing at the top of the salt, expected at 475', and cement with 50 sacks. The oil string will be 4 1/2", 9.5 lb. J-55 casing set at the top of the oil zone, cemented with 100 sacks.

Attached is a map showing the waterflood area, present injection wells, and the proposed location. Also attached is Form C-116 which shows response to injection from the two offset producers, State 5-BX (M-32-17-30) and Scheurich No. 3 (L-32-17-30).

A copy of this application is being sent to the State Engineer.

Yours very truly,

NEWMONT OIL COMPANY

R. J. Cook

Robert J. Cook
District Engineer

sf
Encl. (3)

NEW MEXICO OIL CONSERVATION COMMISSION

GAS-OIL RATIO REPORT

OPERATOR.....NEWMONT OIL COMPANY.....POOL.....LOCO HILLS
ADDRESS.....Artesia, New Mexico.....MONTH OF....., 19.....
SCHEDULED TEST.....COMPLETION TEST.....SPECIAL TEST.....(Check One)
(See Instructions on Reverse Side)

Lease	Well No.	Date of Test	Producing Method	Choke Size	Test Hours	Daily Allowable Bbls.	Production During Test			GOR Cu. Ft. Per Bbl.
							Water Bbls.	Oil Bbls.	Gas MCF	
Scheurich	3	1/13/61	P	24			0	25		
		6/15/61	P	24			0	24		
		12/5/61	P	24			0	20		
		3/19/62	P	24			0	24		
		6/1/62	P	24			0	37		
		7/19/62	P	24			5	36		

No well will be assigned an allowable greater than the amount of oil produced on the official test.

During gas-oil ratio test, each well shall be produced at a rate not exceeding the top unit allowable for the pool in which well is located by more than 25 percent. Operator is encouraged to take advantage of this 25 percent tolerance in order that well can be assigned increased allowables when authorized by the Commission.

Gas volumes must be reported in MCF measured at a pressure base of 15.025 psia and a temperature of 60 degrees F. Specific gravity base will be 0.60.

Mail original and one copy of this report to the district office of the New Mexico Oil Conservation Commission. In accordance with Rule 301 and Appropriate Pool Rules.

(I certify that the information given is true and complete to the best of my knowledge.)

Date.....September 5, 1962.....

NEWMONT OIL COMPANY

By.....*German J. R. Lutter*.....
Superintendent
Title



STATE OF NEW MEXICO

STATE ENGINEER OFFICE

SANTA FE

S. E. REYNOLDS
STATE ENGINEER

September 14, 1962

ADDRESS CORRESPONDENCE TO:
STATE CAPITOL
SANTA FE, N. M.

Mr. A. L. Porter, Jr.
Secretary-Director
Oil Conservation Commission
Santa Fe, New Mexico

Dear Mr. Porter:

Reference is made to the application of Newmont Oil Company submitted to you under date of September 5, 1962 which seeks administrative approval to drill Scheurich No. 9 as a water injection well 1650 feet from the south line and 990 feet from the west line of Section 32, Township 17 South, Range 30 East to inject water into the Grayburg formation. The cover letter states that this well is located in the Loco Hills pool. This office offers no objection to the approval of this application, provided that the oil string which will be set and cemented at the top of the oil zone is successfully pressure-tested to a pressure in excess of the maximum anticipated pressure to be used in injection.

Yours truly,

S. E. Reynolds
State Engineer

FEI/ma
cc-Newmont Oil Co.
F. H. Hennighausen

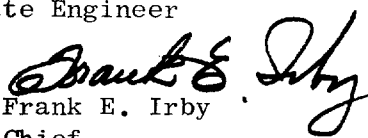
By: 
Frank E. Irby
Chief
Water Rights Division

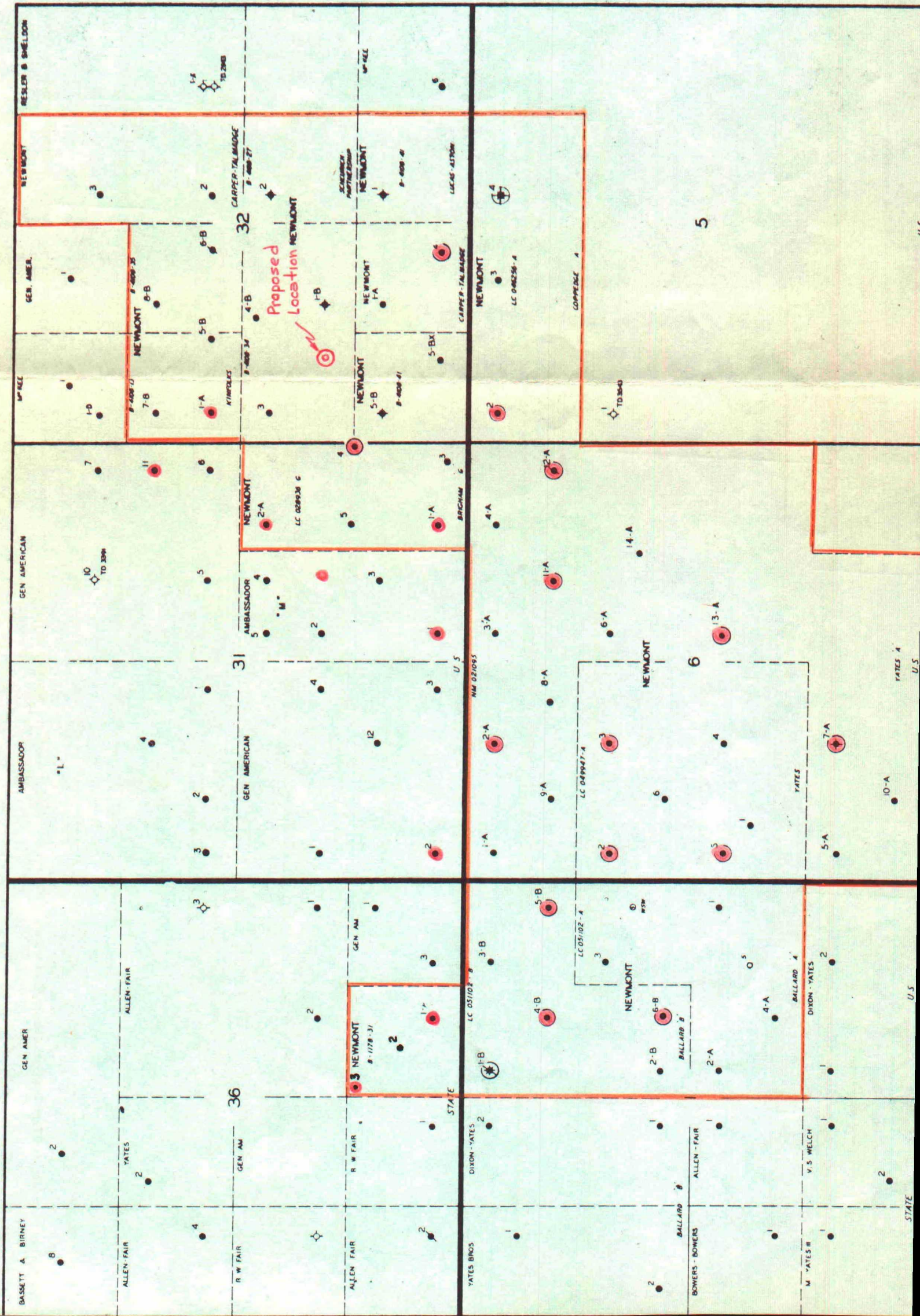

NEW MEXICO OIL CONSERVATION COMMISSION

GAS-OIL RATIO REPORT

OPERATOR NEWMONT OIL COMPANY POOL LOCO HILLS
ADDRESS Artesia, New Mexico MONTH OF , 19 62
SCHEDULED TEST COMPLETION TEST SPECIAL TEST (Check One)
(See Instructions on Reverse Side)

Lease	Well No.	Date of Test	Producing Method	Choke Size	Test Hours	Daily Allowable Bbls.	Production During Test			GOR Cu. Ft. Per Bbl.
							Water Bbls.	Oil Bbls.	Gas MCF	
State BX	5	1/14/61	P		24		0	47		
		3/14/61	P		24		0	42		
		5/13/61	P		24		0	83		
		9/27/61	P		24		0	130		
		12/31/61	P		24		0	182		
		1/26/62	P		24		0	215		
		5/17/62	P		24		0	331		
		6/30/62	P		24		0	353		

No well will be assigned an allowable greater than the amount of oil produced on the official test.

During gas-oil ratio test, each well shall be produced at a rate not exceeding the top unit allowable for the pool in which well is located by more than 25 percent. Operator is encouraged to take advantage of this 25 percent tolerance in order that well can be assigned increased allowables when authorized by the Commission.

Gas volumes must be reported in MCF measured at a pressure base of 15.025 psia and a temperature of 60 degrees F. Specific gravity base will be 0.60.

Mail original and one copy of this report to the district office of the New Mexico Oil Conservation Commission. In accordance with Rule 301 and Appropriate Pool Rules.

(I certify that the information given is true and complete to the best of my knowledge.)

Date September 5, 1962

Newmont Oil Company
Company

By *Germán J. Reddick*
Superintendent

Title