

Reservoir Engineering
Property Management

Byers & Dibert
Engineering & Operating Company
Fourth Floor
Great Plains Life Bldg.
Lubbock, Texas

Telephone
POrter 2-1004

August 25, 1964

11113

11 7 42

Oil & Gas Conservation Commission
State of New Mexico
P. O. Box 2088
Santa Fe, New Mexico

Att: Mr. J. E. Kapteina

Dear Sir:

We return herewith duplicate copies of our request for approval of expansion of the water injection program for the Cone Jalmat Yates Pool Unit, Lea County, New Mexico.

Data offered through Form C-116 has been expanded to conform to our telephone conversation with your Mr. Nutter of this afternoon.

Yours very truly,

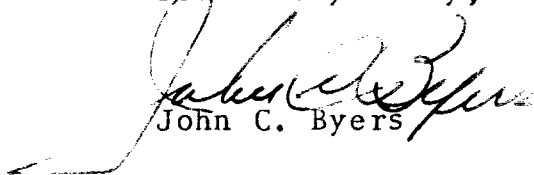
John C. Byers

cc: Hobbs Office
Conservation Commission

Reservoir Engineering
Property Management

Byers & Dibert

Engineering & Operating Company
Fourth Floor
Great Plains Life Bldg.
Lubbock, Texas

Telephone
Porter 2-1004

August 15, 1964

Oil & Gas Conservation Commission
State of New Mexico
P. O. Box 871
Santa Fe, New Mexico

Att: State Engineer

Re: Request for administrative
approval for water flood
expansion.

Dear Sir:

Transmitted herewith are duplicate copies of
our request for approval of expansion of the water
injection program in the Cone Jalmat Yates Pool
Unit, Lea County, New Mexico.

One copy of this request has been forwarded to
the Commission offices at Hobbs and to Cities Service
Oil Company, operator of the properties offsetting the
affected unit.

Yours very truly,

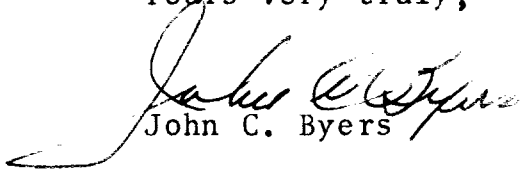
John C. Byers

cc: Hobbs office
Cities Service Oil Co.

Reservoir Engineering
Property Management

Byers & Dibert

Engineering & Operating Company
Fourth Floor
Great Plains Life Bldg.
Lubbock, Texas

Telephone
POrter 2-1004

August 14, 1964

Oil & Gas Conservation Commission
State of New Mexico
P. O. Box 2045
Hobbs, New Mexico

Re: Water Flood Expansion
Cone Jalmat Yates Pool
Unit Lea County, N. M.

Gentlemen:

The Cone Jalmat Yates Pool Unit was authorized for waterflood operations through Commission Orders No. R-2494 and R-2495, dated June 11, 1963. The Unit became effective on July, 1963, and water injection into four wells was commenced July 25, 1963.

Response, in the form of increased oil production rates and reduced gas oil ratio for producing wells affected by this initial water flood development, has been good. This response is reflected through well test data offered in the Form 116, reports attached hereto. Production, from the two wells fully served on 4 sides by water injection, is now tending to increase at a rate averaging 15% per month. This pilot flood response is shown graphically through the pilot flood production curve attached hereto for your convenience.

The Working Interest Owners in the Unit hereby request that administrative approval be granted for expansion of the water injection program for this Unit. The planned expansion, for which approval is requested, will require the conversion of Unit wells No. 1-11, 1-10, 2-2 and 3-4 to water injection service. This expansion will enable the Unit to maintain full waterflood operations, serving that portion of the Unit located in the S 1/2 of Section 13 and the N 1/2 of Section 24 T22S, R35E, Lea County, New Mexico.

Attached hereto, please find Commission forms C-102, through which this request is set-out and form C-116, reflecting well test data relative to the affected Unit area. Also enclosed

Oil & Gas Conservation Commission
State of New Mexico
August 14, 1964

-2-

herewith are production curves for the Unit and Pilot Flood area of the Unit, as well as maps setting out the pilot flood area now under operation and the area for which this request is made.

Your consideration of this request is appreciated and in the event additional information is required, we will be pleased to furnish that.

Yours very truly,

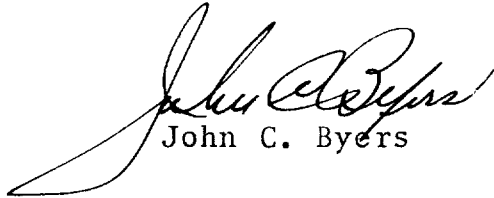

John C. Byers

NEW MEXICO OIL CONSERVATION COMMISSION
Santa Fe, New Mexico

MISCELLANEOUS NOTICES 10 AM 7 45

NUMBER OF COPIES RECEIVED	
DISTRIBUTION	
SANTA FE	
FILE	
U.S.G.S.	
LAND OFFICE	
TRANSPORTER	OIL
	GAS
PRORATION OFFICE	
OPERATOR	

Submit this notice in **TRIPLICATE** to the District Office, Oil Conservation Commission, before the work specified is to begin. A copy will be returned to the sender on which will be given the approval, with any modifications considered advisable, or the rejection by the Commission or agent, of the plan submitted. The plan as approved should be followed, and work should not begin until approval is obtained. See additional instructions in the Rules and Regulations of the Commission.

Indicate Nature of Notice by Checking Below

NOTICE OF INTENTION TO CHANGE PLANS		NOTICE OF INTENTION TO TEMPORARILY ABANDON WELL		NOTICE OF INTENTION TO DRILL DEEPER	
NOTICE OF INTENTION TO PLUG WELL		NOTICE OF INTENTION TO PLUG BACK		NOTICE OF INTENTION TO SET LINER	
NOTICE OF INTENTION TO SQUEEZE		NOTICE OF INTENTION TO ACIDIZE		NOTICE OF INTENTION TO SHOOT (Nitro)	
NOTICE OF INTENTION TO GUN PERFORATE		NOTICE OF INTENTION (OTHER)	X	NOTICE OF INTENTION (OTHER)	

OIL CONSERVATION COMMISSION
SANTA FE, NEW MEXICO

Lubbock, Texas

(Place)

(Date)

Gentlemen:

Following is a Notice of Intention to do certain work as described below at the

J. R. Cone Cone Jalmat Yates Pool Unit

(Company or Operator)

Well No. in (Unit)

1/4 of Sec. 13, T. 1N, R. 10E, NMPM, Jalmat Yates Pool

(40-acre Subdivision)

Lea County.

FULL DETAILS OF PROPOSED PLAN OF WORK
(FOLLOW INSTRUCTIONS IN THE RULES AND REGULATIONS)

We propose to expand the pilot waterflood project authorized by the Commission through its orders No. R-2494 & R-2495, dated 6/11/63 to include injection into Unit wells No. 1-11, 1-10, 2-2 & 3-4. This expansion will place all of the S 1/2 Section 13 and N 1/2 Section 24 under waterflood. These wells will be converted to water injection service. Water injection will average 350 bbl per well per day, at 1200 psi wellhead pressure and through 2" tubing with packer set 300' or more below the top of the cement in the 5 1/2" casing string.

Approved, 19_____
Except as follows:

J. R. Cone
Company or Operator
By *John C. Byers*
Position Engineer

Approved
OIL CONSERVATION COMMISSION

Send Communications regarding well to:

By _____

Name John C. Byers

Title _____

Address 411 Great Plains Bldg. Lubbock, Tex.

NEW MEXICO OIL CONSERVATION COMMISSION

GAS-OIL RATIO REPORT

1964 AUG 27 AM 7 42

OPERATOR J. R. Cone POOL Jalmat Yates
ADDRESS Lubbock, Texas MONTH OF August, 1964
SCHEDULED TEST _____ COMPLETION TEST _____ SPECIAL TEST X (Check One)

(See Instructions on Reverse Side)

This is a comparative well test report showing the change in productive ability of wells before and after water injection into the Yates Sand reservoir.

Lease	Well No.	Date of Test	Producing Method	Choke Size	Test Hours	Daily Allowable Bbls.	Production During Test			GOR Cu. Ft. Per Bbl.
							Water Bbls.	Oil Bbls.	Gas MCF	
Cone Jalmat Yates Pool Unit	1-1	8/63	F		24	0	0	1.4		119,286
	1-1	8/64	F		24		1	2.1		40,273
	1-4	Water injection well								
	1-3	7/63	F		24		0	12.0		4,525
	1-3	8/64	P		24		0	30.0		169
	1-5	Water injection well								
	1-6	7/63	P		24		1	6.0		4,433
	1-6	8/64	P		24		1	16.4		271
	1-9	Water injection well								
	1-8	7/63	P		24		1	1.4		5,330
	1-8	7/64	P		24		1	3.4		2,636
	1-11	7/63	F		24		0	2.0		55,200
	1-11	4/64	F		24		0	5.1		31,300
	1-7	Water injection well								
	1-2	9/63	P		24		5	5.5		2,222
	1-2	7/64	P		24		3	15.7		1,527
	1-10	9/63	P		24		0	1.0		3,752
	1-10	7/64	P		24		1	6.1		440

(I certify that the information given is true and complete to the best of my knowledge.)

Date 8/14/64

By J. R. Cone Company
John C. Byers
Engineer
Title

INSTRUCTIONS

Mail original to Oil Conservation Commission, Santa Fe, New Mexico, and one copy to District Office, Hobbs, New Mexico.

This report shall be mailed to the Commission on or before the 15th of the month following the period in which the well is scheduled to be tested. The ratios, as reported, shall become effective for proration purposes the first of the month following the end of the period in which the test is scheduled to be made. Failure to make the required test and report will be penalized as the Commission's Regulations provide.

Under "producing methods," show flowing, pumping, or gas lift; under "hours," show the duration of the test in hours, which includes all time the well is open for production of oil or gas during the 24-hour test period. The allowable is the daily allowable for the well at the time of test.

METHOD OF TESTING: Produce each well in the normal operating manner and the customary production rate and measure all gas, oil and water produced during 24 hours.

MEASUREMENTS: To be made in accordance with Rule 301. In computing the gas-oil ratio on gas lift wells, input is subtracted from output to obtain net gas volume.

PRESSURE BASE: 15.025 lbs. per sq. in., Specific Gravity .70. Temperature 60° F.

NEW MEXICO OIL CONSERVATION COMMISSION

GAS-OIL RATIO REPORT

OPERATOR J. R. Cone POOL Jalmat Yates
ADDRESS Lubbock, Texas MONTH OF August, 19 64
SCHEDULED TEST _____ COMPLETION TEST _____ SPECIAL TEST X page 2 (Check One)

(See Instructions on Reverse Side)

This is a comparative well test report showing the change in productive ability of wells before and after water injection into the Yates sans reservoir.

Lease	Well No.	Date of Test	Producing Method	Choke Size	Test Hours	Daily Allowable Bbls.	Production During Test			GOR Cu. Ft. Per Bbl.
							Water Bbls.	Oil Bbls.	Gas MCF	
Continue Cone Jalmat Yates Pool Unit	2-2	9/63	P		24		0	12.0		3,650
	2-2	5/64	P		24		0	12.3		4,336
	2-1	7/63	F		24		0	1.0		20,000
	2-1	5/64	F		24		0	1.5		17,100
	3-3	9/63	F		24		0	5.0		7,121
	3-3	5/64	F		24		0	8.7		3,399
	3-4	9/63	P		24		1	1.1		356
	3-4	7/64	P		24		0	2.0		311
Note: Wells No. 1-10, 1-11, 2-2 and 3-4 are proposed water injection wells to serve the expanded water flood area. Of these wells all with the exception of No 3-4 are diagonal off set wells to the pilot water flood area, well No 3-4 is off set diagonaly and directly by wells which have responded to the pilot water flood program.										

(I certify that the information given is true and complete to the best of my knowledge.)

Date August 14, 1964

J. R. Cone

Company

By

John C. Byers

Engineer

Title

INSTRUCTIONS

Mail original to Oil Conservation Commission, Santa Fe, New Mexico, and one copy to District Office, Hobbs, New Mexico.

This report shall be mailed to the Commission on or before the 15th of the month following the period in which the well is scheduled to be tested. The ratios, as reported, shall become effective for proration purposes the first of the month following the end of the period in which the test is scheduled to be made. Failure to make the required test and report will be penalized as the Commission's Regulations provide.

Under "producing methods," show flowing, pumping, or gas lift; under "hours," show the duration of the test in hours, which includes all time the well is open for production of oil or gas during the 24-hour test period. The allowable is the daily allowable for the well at the time of test.

METHOD OF TESTING: Produce each well in the normal operating manner and the customary production rate and measure all gas, oil and water produced during 24 hours.

MEASUREMENTS: To be made in accordance with Rule 301. In computing the gas-oil ratio on gas lift wells, input is subtracted from output to obtain net gas volume.

PRESSURE BASE: 15.025 lbs. per sq. in., Specific Gravity .70. Temperature 60° F.

100,000

10,000

Water Inj.
Total Bbl/month

Oil Bbl/month
Unit total

GOR
Pilot Area

1,000

Oil Bbl/month
Pilot Area

PRODUCTION DATA
CONE JALMAT YATES POOL UNIT
Lea County, New Mexico

100

63

64

65

66

67

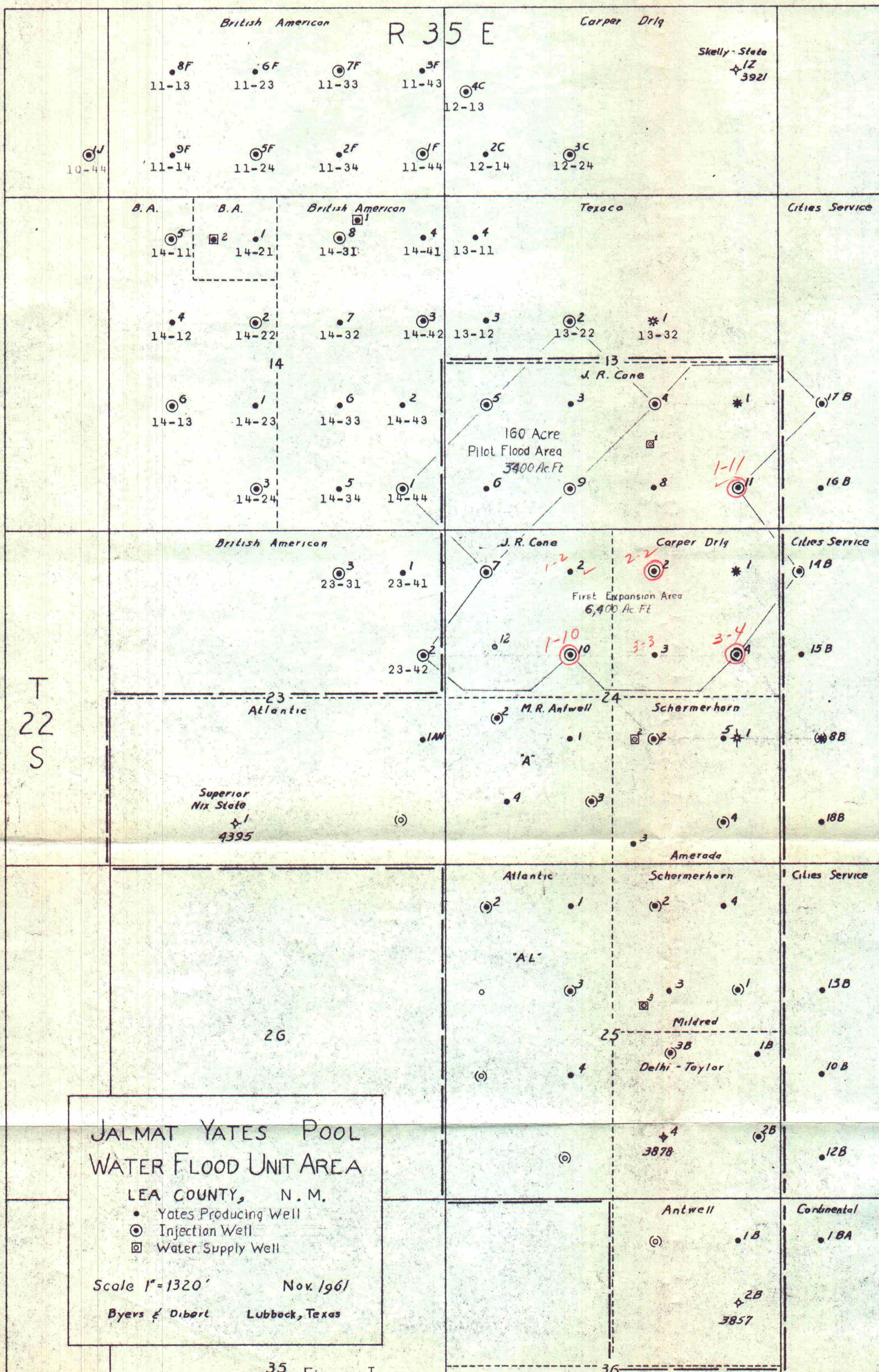

LARGE FORMAT
EXHIBIT HAS
BEEN REMOVED
AND IS LOCATED
IN THE NEXT FILE



STATE OF NEW MEXICO

STATE ENGINEER OFFICE

SANTA FE

S. E. REYNOLDS
STATE ENGINEER

September 16, 1964

ADDRESS CORRESPONDENCE TO:
STATE CAPITOL
SANTA FE, N. M.

7501

Mr. A. L. Porter, Jr.
Secretary-Director
Oil Conservation Commission
Santa Fe, New Mexico

Attn. Mr. Jim Kapteina

Dear Jim:

I have just received the application, which was submitted by Byers & Dibert on behalf of J. R. Cone, which seeks to expand their pilot waterflood in the Cone Jalmat Yates Pool in Sections 13 and 24, T. 22 S., R. 35 E., by converting said wells No. 1-11, 1-10, 2-2 and 3-4 to water injection service. Although, the Miscellaneous Notices states that water injection will be through 2-inch tubing with packer set 300 feet or more below the top of the cement in the 5½-inch casing string, I am still in the dark. No diagrammatic sketch of the wells is given. I have no idea of the depth of the casing setting, where the top of the cement in the 5½-inch casing string is, whether other casing strings were set and cemented. This is not sufficient information for the determination of whether a threat of contamination to the fresh waters which may exist in the area will occur. Therefore, the State Engineer cannot give a waiver on the conversion of these wells.

I will be glad to advise the Commission of the State Engineer's

position with regard to this application as soon as I have received and had an opportunity to examine the sketches required by the Oil Conservation Commission rules and regulations,

Yours truly ,

S. E. Re-nolan
State Engineer

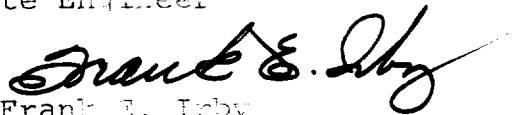
By: 
Frank E. Irby
Chief
Water Rights Div.

FEI/la
cc-F. H. Mennighausen
Byers & Gilbert

Reservoir Engineering
Property Management

Byers & Dibert

Engineering & Operating Company
Fourth Floor
Great Plains Life Bldg.
Lubbock, Texas

MAILED
SEP 21 1964

Telephone
Porter 2-1004

September 19, 1964

Mr. S. E. Reynolds
State Engineer
State of New Mexico

Att: Frank E. Irby
Water Rights Div.

Re: Cone Jalmat Yates Pool Unit
Expansion of Water Flood

Dear Sir:

Following your request as set out in your letter to Mr. A. L. Porter dated September 16, 1964, a copy of which was sent to us, we transmit herewith three copies of well diagrams.

The diagrams transmitted herewith pertain to the four wells in the subject unit which we plan to convert to water injection wells to serve the Yates sand reservoir. These sketches set out casing and cement programs conducted in each well as well as our plan for setting tubing and packer in each well for conduct of injected water to the Yates formation.

I hope that these data will serve your needs. If you do require additional information please call upon me.

Yours very truly

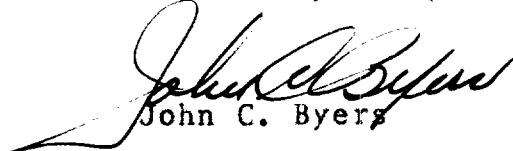
John C. Byers

cc: Mr. A. L. Porter

MAILED
64 SEP 22 AM 10



STATE OF NEW MEXICO

STATE ENGINEER OFFICE

SANTA FE

S. E. REYNOLDS
STATE ENGINEER

September 21, 1961

ADDRESS CORRESPONDENCE TO:
STATE CAPITOL
SANTA FE, N. M.

10501

Mr. A. L. Porter, Jr.
Secretary-Director
Oil Conservation Commission
Santa Fe, New Mexico

Attn: Mr. Jim Kapteina

Dear Jim:

I have received necessary information from Eben. G. Dibert concerning the expansion of the Cone Jalmat Yates Pool Waterflood. If the injection wells are completed in the manner shown on the diagrammatic sketches for the four individual wells, it appears that no threat of contamination to the fresh waters which may exist in the area will occur. Therefore, this office offers no objection to the granting of this application.

Yours truly,

S. E. Reynolds
State Engineer

By: *Frank E. Irby*
Frank E. Irby
Chief
Water Rights Div.

FEI/sa
cc-Syers G. Dibert
F. H. Hennighausen