

**P. O. BOX 3786
ODESSA, TEXAS**

PRODUCTION DEPARTMENT

Wm - 188
Dun Am 188

cc: New Mexico State Engineers Office, Santa Fe, New Mexico
Oil Conservation Commission, Artesia, New Mexico

WILLIAMS NUMBER 4
SE 4 OF NW 4 SECTION 25
T-18-N, R-26-E

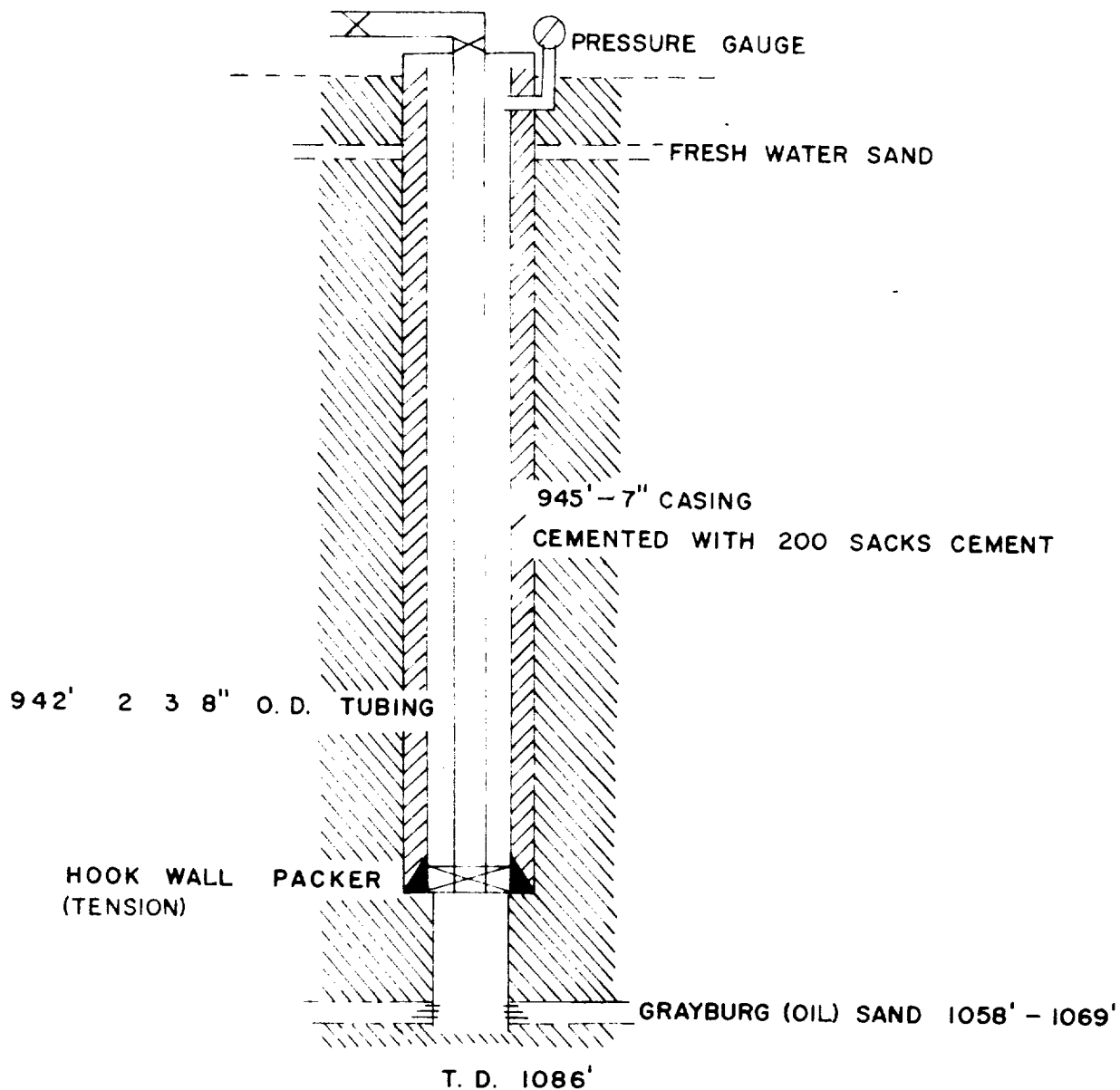

KEWANEE OIL COMPANY
DAYTON GRAYBURG FIELD
EDDY COUNTY, NEW MEXICO

EXHIBIT B
PROPOSED WATER INPUT
WELL

EXHIBIT C

WILLIAMS NUMBER 4

DRILLERS LOG

Depth		Formation
From	To	
0	80	Gyp and fine river sand
80	100	Water sand
100	130	Soft Gyp rock
130	208	Gyp with red streaks of Clay
208	835	Gyp rock, streaks of red sand and clay
835	947	Soft lime rock, streaks red sand
947	950	Hard gray lime rock
950	958	Gray lime
958	966	Gray lime
966	975	Hard gray lime
975	985	Dark gray lime
985	1000	Gray lime
1000	1022	Dark gray sandy lime
1022	1028	Gray sandy lime
1028	1040	Gray and brown lime
1040	1047	Mixed red sand and lime
1047	1052	Lime and red sand
1052	1058	Sand and red rock
1058	1060	Mixed sand
1060	1064	Sand - Oil show
1064	1069	Sand and lime
1069	1086	Gray lime
	1086	Total Depth

BEFORE THE NEW MEXICO OIL CONSERVATION COMMISSION

APPLICATION OF KEWANEE OIL COMPANY
FOR ADMINISTRATIVE APPROVAL FOR EXPANSION
OF WATERFLOOD PROJECT, EDDY COUNTY, N. M.

NO. _____

COMES NOW, Kewanee Oil Company and applies to the
New Mexico Oil Conservation Commission for administrative approval for expansion of a waterflood project, now in operation in the Dayton Grayburg Field, Eddy County, New Mexico, and in support of its application, states:

1. That the Applicant, Kewanee Oil Company, is the ^{17V0} owner and operator of the Williams lease comprising 320 acres, more or less, being the North One-half, (N/2), of Section 25, Township 18 South, Range 26 East, Eddy County, New Mexico. Applicant, Kewanee Oil Company, is also the owner and operator of other leases in the Dayton Grayburg Field, the McCall lease, comprising 80 acres, more or less, being the West One-half, (W/2), of the Southwest Quarter, (SW/4), of Section 24, and the Scripps lease comprising 40 acres, more or less, being the Northwest Quarter, (NW/4), of the Southwest Quarter, (SW/4), of Section 25, Township 25 North, Range 26 East, Eddy County, New Mexico.

2. That said leases are presently developed by six producing wells and one water injection well in the Dayton Grayburg Field, located in Unit M of Section 24 and Units B, C, D, F and L of Section 25.

3. That Kewanee Oil Company is presently injecting water into the Dayton Grayburg Field utilizing Williams Number 6, Unit B, of Section 25 as the water injection well. The present injection rate is 58 barrels of water per day at 800 psi surface pressure into Williams No. 6. Kewanee Oil Company proposes to convert Williams Number 4, Unit F, of Section 25, to water injection duty. The location of the existing wells is shown on the plat attached to this application and incorporated herein by reference.

4. That water injection into the Dayton Grayburg Field utilizing Williams Number 6 was originally authorized by Commission Order Number R-2720, entered in Case Number 3061.

5. That Kewanee Oil Company proposes to inject water through Williams Number 4 in addition to the original approved injection well, Williams Number 6, into the Premier Sand at a depth of 1058' in the Grayburg Formation of the Dayton Grayburg Field, and to produce oil from said field through the three producing wells on the Williams Lease, one well on the McCall Lease and one well on the Scripps Lease.

6. That Williams Number 4 has experienced response to water injection and is a direct offset to the present water injection well, Williams Number 6. Williams Number 4 is currently producing less than 0.25 barrels of oil per day and 4.0 barrels of water per day compared to a daily production of 1.65 barrels of oil and no water prior to response from water injection as evidenced by the forms C-120 attached to this application and incorporated herein by reference.

7. That in view of present low injection rate of 58 barrels of water per day into Williams Number 6, the approval of subject well for water injection is necessary to obtain a thorough and efficient sweep of oil by waterflood in a reasonable length of time.

8. That approval of subject application will prevent waste and protect correlative rights.

9. That if subject application is approved it will be subject to stated stipulations contained in letter dated June 3, 1964, from Mr. E. L. Porter, Jr., Secretary - Director to Mr. Richard S. Morris, of Seth, Montgomery, Federici and Andrews, as pertains to original approval for the Kewanee Dayton Grayburg Waterflood Project.

10. That anticipated volume of water injection into Williams Number 4 will be 150 barrels per day at maximum surface pressure of 800 psi. Water injected will be from the shallow Artesian Basin from a water supply well equipped in the area. The subject water injection well will be equipped to confine the injection water to the oil productive interval of the Premier Sand. The proposed completion method for Williams Number 4 is indicated in Exhibit B attached to this application and incorporated herein by reference.

WHEREFORE, the applicant, Kewanee Oil Company, requests that this application be approved by Administrative Procedure and that the Commission enter its Order approving the proposed expansion of the waterflood project.

NEW MEXICO
OIL CONSERVATION COMMISSION
MONTHLY INJECTION REPORT

Form O-120
(Revised 5-1-60)

MAIN OFFICE
1964
JUL 23
AH 800

Submit this report in triplicate to the District Office, Oil Conservation Commission.

COMPANY	Kewanee Oil Company	POOL	Dayton Grayburg
COUNTY	Eddy	MONTH	July

INJECTION WELLS

Lease	Well No.	Location				MCF Gas Injected	Cumulative Gas Inj.	Bbls Water Injected	Cumulative Water Inj.	Ave. Inj. Pressures
		UL	S	T	R					
Williams	6	B	25	18	26			2,905	2,905	1,200

Form C-120
(Revised 5-1-60)

MONTHLY INFECTION REPORT

COMPANY	Revenue Oil Company	POOL	Wynon Grayburg	2
COUNTY	2467	MONTH	August	19 64

INJECTION WELLS

Lease	Well No.	Location	MCF Gas Injected	Cumulative Gas Inj.	Bbls Water Injected	Cumulative Water Inj.	Ave. Inj. Pressures
		UL S T R					
Williams	6	B RS 1024			1,492	6,397	800
ILLEGIBLE							
TOTAL							

PRODUCING WELLS

[illegible]

PRODUCING WELLS OUTSIDE A PRORATED WATERFLOOD PROJECT AREA WHICH ARE PRODUCING INTO COMMON FACILITIES WITH WELLS INSIDE A PRORATED WATERFLOOD PROJECT AREA

[illegible]

NEW MEXICO
OIL CONSERVATION COMMISSION
MONTHLY INJECTION REPORT

Form C-120
(Revised 5-1-60)

Submit this report in triplicate to the District Office, Oil Conservation Commission.

COMPANY Keweenaw Oil Company POOL Dayton Grayburg
COUNTY Eddy MONTH September 19 64

INJECTION WELLS

Lease	Well No.	Location				MCF Gas Injected	Cumulative Gas Inj.	Bbls Water Injected	Cumulative Water Inj.	Ave. Inj. Pressures
		UL	S	T	R					
Williams	6	B	25	18	26			2,287	8,684	800
ILLEGIBLE										
TOTAL										

PRODUCING WELLS

Lease	Well No.	Location				Bbls. Oil Produced	MCF Gas Produced	Gor	Bbls Water Produced	% Water Produced
		UL	S	T	R					
Williams	3	B	25	18	26	9	5	556	0	0
Williams	4	F	25	18	26	17	9	529	125	80
Williams	5	C	25	18	26	8	4	500	290	97
TOTAL										

PRODUCING WELLS OUTSIDE A PRORATED WATERFLOOD PROJECT AREA WHICH ARE PRODUCING INTO COMMON FACILITIES WITH WELLS INSIDE A PRORATED WATERFLOOD PROJECT AREA

Lease	Well No.	Location				Date of Test	Length of Test	Barrels Produced	Barrels Per Day
		UL	S	T	R				
Williams	2	D	25	18	26	9-21-64	24	15	0.50

NEW MEXICO
OIL CONSERVATION COMMISSION
MONTHLY INJECTION REPORT

Form C-120
(Revised 5-1-60)

Submit this report in triplicate to the District Office, Oil Conservation Commission.

COMPANY Kernan Oil Company POOL Dayton Grayburg
COUNTY Eddy MONTH October 19 64

INJECTION WELLS

Lease	Well No.	Location				MCF Gas Injected	Cumulative Gas Inj.	Bbls Water Injected	Cumulative Water Inj.	Ave. Inj. Pressures
		UL	S	T	R					
Williams		B	25	18	26			1,808	10,492	690
TOTAL										

ILLEGIBLE

PRODUCING WELLS

Lease	Well No.	Location				Bbls. Oil Produced	MCF Gas Produced	Gor	Bbls Water Produced	% Water Produced
		UL	S	T	R					
Williams	3	B	25	18	26	4	4	900	0	0
	4	F	25	18	26	7	4	571	120	96.8
	5	C	25	18	26	7	4	571	250	97.3
TOTAL										

PRODUCING WELLS OUTSIDE A PRORATED WATERFLOOD PROJECT AREA WHICH ARE PRODUCING INTO COMMON FACILITIES WITH WELLS INSIDE A PRORATED WATERFLOOD PROJECT AREA

Lease	Well No.	Location				Date of Test	Length of Test	Barrels Produced	Barrels Per Day
		UL	S	T	R				
Williams	2	D	25	18	26	10-23-64	24 hours	3	0.097

I hereby certify that the above information is true and complete to the best of my knowledge.

REMARKS: _____ NAME Darryl C. Newell
TITLE District Engineer



STATE OF NEW MEXICO

STATE ENGINEER OFFICE

SANTA FE

S. E. REYNOLDS
STATE ENGINEER

December 1, 1964

ADDRESS CORRESPONDENCE TO:
STATE CAPITOL
SANTA FE, N. M.

87501

Mr. A. L. Porter, Jr.
Secretary-Director
Oil Conservation Commission
Santa Fe, New Mexico

Dear Mr. Porter:

Reference is made to the application of Kewanee Oil Company which seeks administrative approval for expansion of their Dayton Grayburg Waterflood by converting their Williams No. 4 well to water injection. Mr. Strickland states in his paragraph numbered 9. "That if subject application is approved it will be subject to stated stipulations contained in letter dated June 3, 1964, from Mr. A. L. Porter, Jr., Secretary-Director to Mr. Richard S. Morris, of Seth, Montgomery, Federici and Andrews, as pertains to original approval for the Kewanee Dayton Grayburg Waterflood Project."

In view of this statement of the provisions contained in your letter dated June 3, 1964(referred to in the statement) this office offers no objection to the granting of this application.

Yours truly,

S. E. Reynolds
State Engineer

FEI/ma
cc-Kewanee Oil Co.
F. H. Hennighausen

By: *Frank E. Irby*
Frank E. Irby
Chief
Water Rights Div.

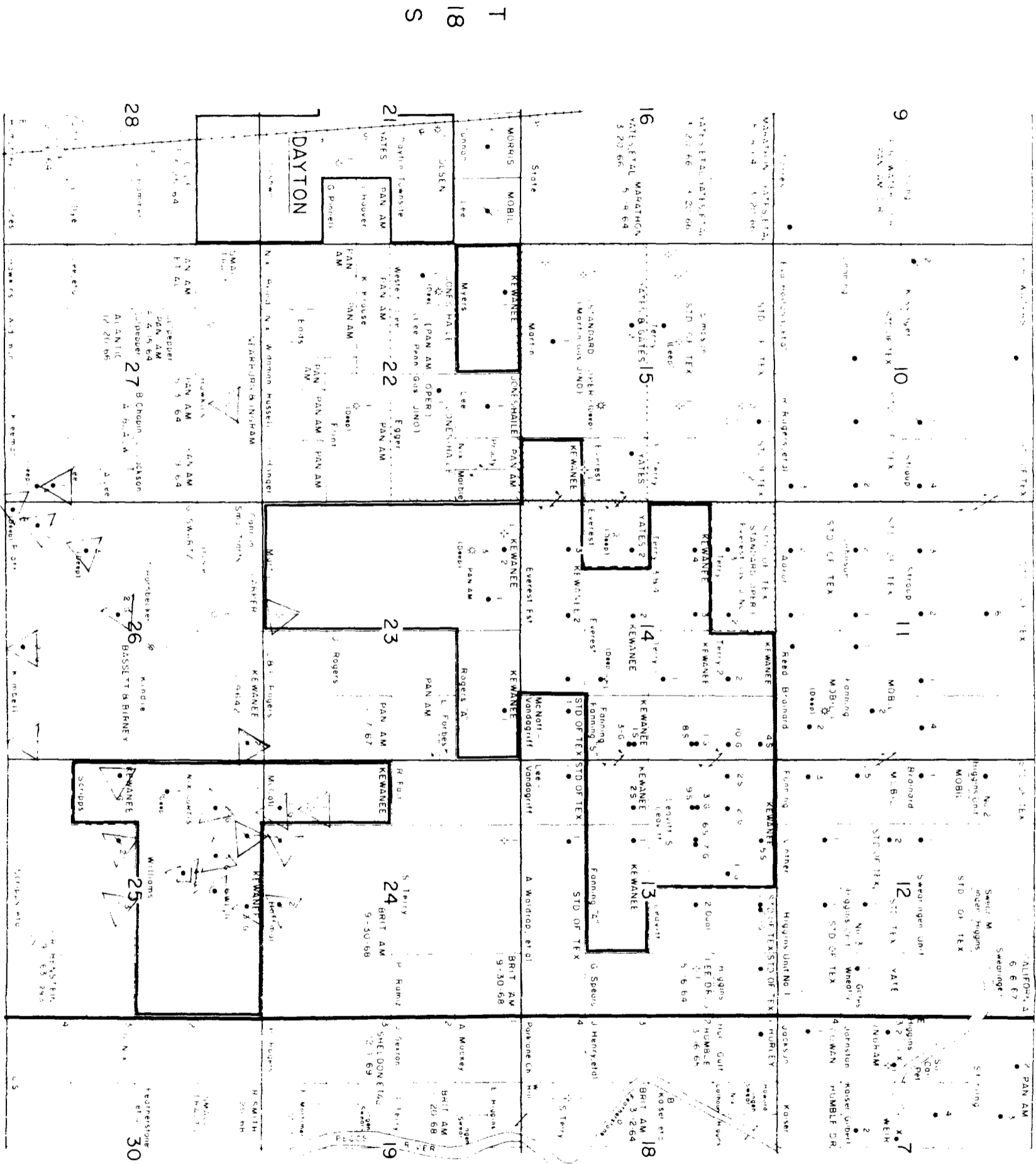

LEGEND

- — ACTIVE WATER INPUT WELL
- — PROPOSED WATER INPUT WELL

DAYTON GRAYBURG FIELD

LEAVITT AREA

WEST TEXAS	MAJAMAR
SCALE	1" = 1000'
DATE	12-20-64
FILE	W-64