

STATE OF NEW MEXICO
ENERGY, MINERALS and NATURAL
RESOURCES DEPARTMENTOil Conservation Div.
2040 Pacheco St.
Santa Fe, NM 87505FORM C-108
Revised 7-1-81**APPLICATION FOR AUTHORIZATION TO INJECT**

- I. PURPOSE: Secondary Recovery Pressure Maintenance X Disposal Storage
Application qualifies for administrative approval? X Yes No
- II. OPERATOR: Rhombus Energy Company
ADDRESS: 200 N. Loraine, Suite 1270, Midland, TX 79701
CONTACT PARTY: Greg Cielinski PHONE: (915) 683-8873
- III. WELL DATA: Complete the data required on the reverse side of this form for each well processed for injection. Additional sheets may be attached if necessary.
- IV. Is this an expansion of an existing project: Yes X No
If yes, give the Division order number authorizing the project _____
- V. Attach a map that identifies all wells and leases within two miles of any proposed injection well with a one-half mile radius circle drawn around each proposed injection well. This circle identifies the well's area of review.
- VI. Attach a tabulation of data on all wells of public record within the area of review which penetrate the proposed injection zone. Such data shall include a description of each well's type, construction, date drilled, location, depth, record of completion, and a schematic of any plugged well illustrating all plugging detail.
- VII. Attach data on the proposed operation, including: see attached page
1. Proposed average and maximum daily rate and volume of fluids to be injected;
 2. Whether the system is open or closed;
 3. Proposed average and maximum injection pressure;
 4. Sources and an appropriate analysis of injection fluid and compatibility with the receiving formation if other than reinjected produced water; and
 5. If injection is for disposal purposes into a zone not productive of oil or gas at or within one mile of the proposed well, attach a chemical analysis of the disposal zone formation water (may be measured or inferred from existing literature, studies, nearby wells, etc.).
- *VIII. Attach appropriate geological data on the injection zone including appropriate lithologic detail, geological name, thickness and depth. Give the geologic name, and depth to bottom of all underground sources of drinking water (aquifers containing waters with total dissolved solids concentrations of 10,000 mg/l or less) overlying the proposed injection zone as well as any such sources known to be immediately underlying the injection interval.
- IX. Describe the proposed stimulation program, if any.
- * X. Attach appropriate logging and test data on the well. (If well logs have been filed with the Division, they need not be resubmitted.)
- * XI. Attach a chemical analysis of fresh water from two or more fresh water wells (if available and producing) within one mile of any injection or disposal well showing location of wells and dates samples were taken.
- XII. Applicants for disposal wells must make an affirmative statement that they have examined available geologic and engineering data and find no evidence of open faults or any other hydrologic connection between the disposal zone and any underground source of drinking water.
- XIII. Applicants must complete the "Proof of Notice" section on the reverse side of this form.
- XIV. Certification: I hereby certify that the information submitted with this application is true and correct to the best of my knowledge and belief.
- NAME: Gregory D. Cielinski TITLE: President
- SIGNATURE: [Signature] DATE: April 24, 1996
- * If the information required under Sections VI, VIII, X, and XI above has been previously submitted, it need not be resubmitted. Please show the date and circumstance of the earlier submittal. Logging and Test Data was
filed by Amerada Hess when the well was originally completed.
- DISTRIBUTION: Original and one copy to Santa Fe with one copy to the appropriate District Office

INJECTION WELL DATA SHEET

Side 1

OPERATOR Rhombus Energy Company LEASE C. W. Robinson A

WELL NO. 2 1980' FSL 660' FEL SECTION 14 TOWNSHIP 11-S RANGE 32-E

FOOTAGE LOCATION

Schematic

Well Construction Data

Surface Casing

Size 13-3/8" @ 299' Cemented with 225 sx.

TOC Surface feet determined by circulated

Hole Size 17 - 1/2"

Intermediate Casing

Size 8-5/8" @ 3469' Cemented with 1500 sx.

TOC 1070' feet determined by Temperature Survey

Hole Size 12" and 11"

Long String

Size 5-1/2" @ 10,616' Cemented with 600 sx.

TOC 7880' feet determined by Temperature Survey

Hole Size 7-7/8"

Total Depth 10,616'

Injection Interval

10,616 feet to 10,660 feet Open Hole
(perforated or open-hole; indicate which)

INJECTION WELL DATA SHEET

Tubing Size 2-7/8" 6.5# lined with plastic set in a
Baker Model R packer at 10,520' feet
(type of internal coating)

Other type of tubing / casing seal if applicable _____

Other Data

1. Is this a new well drilled for Injection? Yes X No _____
If no, for what purpose was the well originally drilled? Oil Producer

2. Name of the Injection formation Devonian

3. Name of Field or Pool (if applicable) Moore, Devonian

4. Has the well ever been perforated in any other zone(s)? List all such perforated intervals and give plugging detail, i.e., sacks of cement or plug(s) used. NO

5. Give the names and depths of any over or underlying oil or gas zones (pools) in this area.

Moore Permo-Penn 8300-8600'

AHC C.W. ROBINSON A #2

14-11S-32E

Unit I 660' FEB, 1980' FS!

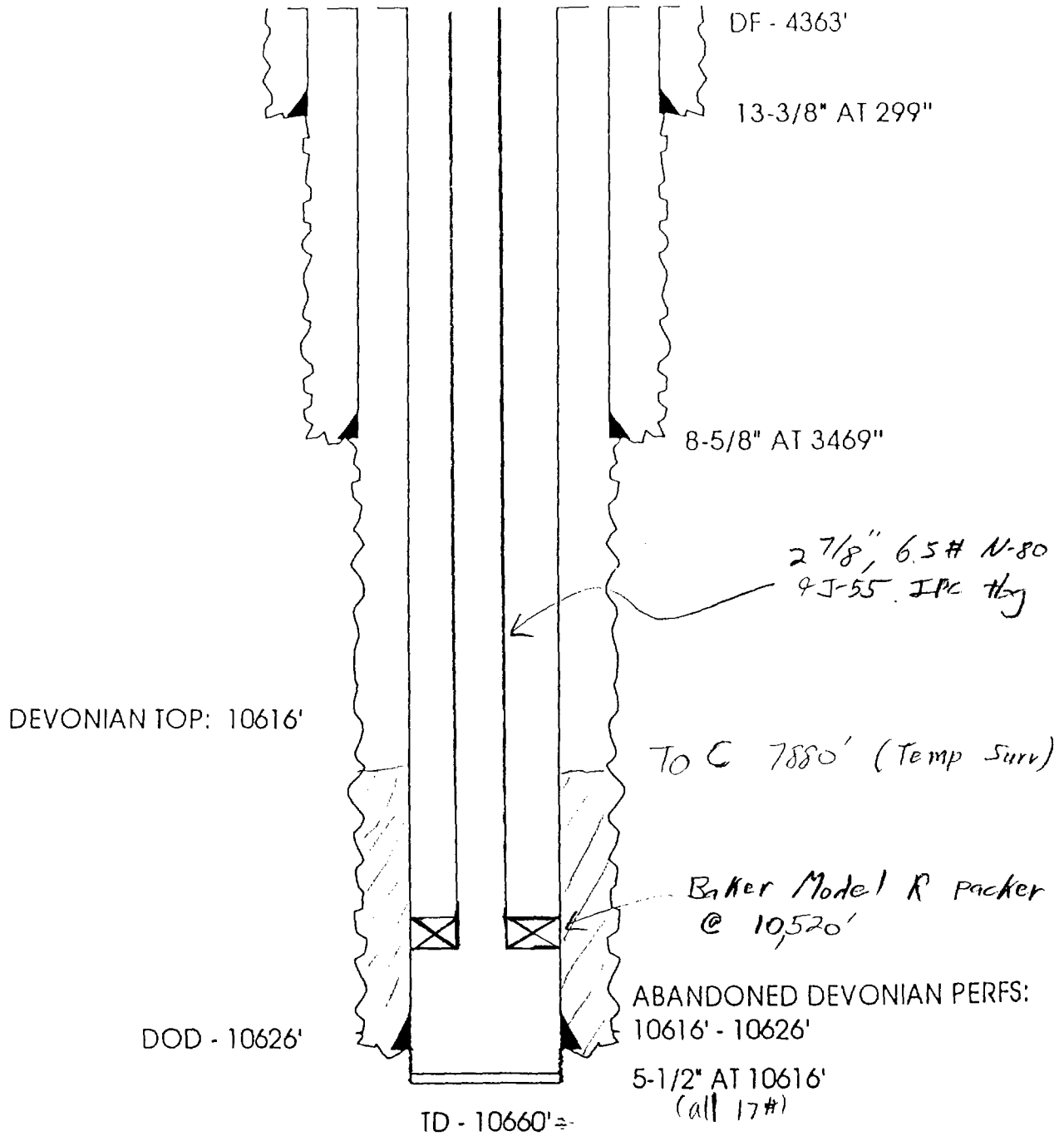

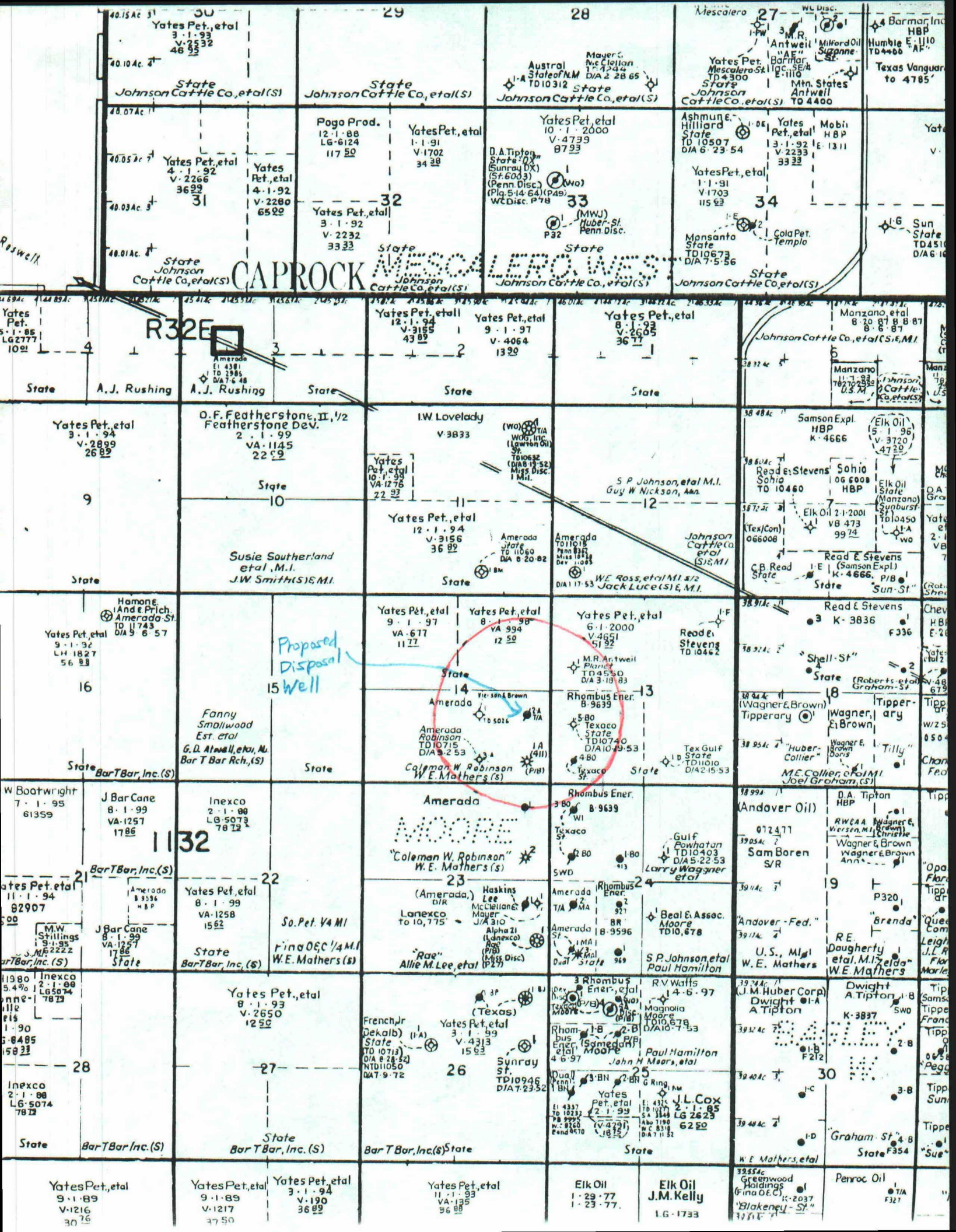

C. W. ROBINSON #1

Well Type: Producing Devonian Oil Well

Construction:

Casing: 13-3/8 35.62# @ 298' w/ 225 sx
8-5/8 24 & 32# @ 3434' w/ 1500sx
5-1/2 17# @ 10,591' w/ 350sx

Date Drilled: September 1952

Location: NE/4 NE/4, Sec. 23, T11-S, R-32-E, Lea County, New Mexico

Total Depth: 10,650'

Completion Record:

OH: 10603-650'

Zone: Devonian

Initial Potential: F 527 BOPD

C. W. ROBINSON A #1

Well Type: Producing Permo-Penn Gas Well

Construction: 13-3/8 @ 299' w/ 225 sx
8-5/8 @ 3460' w/ 1500 sx
5-1/2 @ 10,565' w/ 600 sx

Date Drilled: December 1952

Location: 660' FSL & 660' FEL, Sec 14, T-11-s, R-32-E, Lea County, New Mexico

Depth: TD 10,660' OH

Original Completion Record:

OH: 10,565'-10,660'

Zone: Devonian

Initial Potential: 1952: F 411 BO in 24 hrs.

Recompleted May 1988:

Perfs: 9150-62', 9203-32'

Zone: Permo-Penn

1988: F 16 BCPD 300 MCFD

C. W. ROBINSON A #3

Well Type: P & A Oil Well

Date Drilled: September 1953

Location: SW/4 SE/4, Sec 14, T-11-S, R-32-E, Lea County, New Mexico

Depth: TD 10,715'

Drilled & Abandoned

NEW MEXICO BO #4

Well Type: P & A Oil Well

Construction:

13-3/8 @ 316' w/ 350 sx, circ

8-5/8 @ 3515' w/ 2300 sx, circ

5-1/2 @10,630' w/ 450 sx, TOC 8535' by TS.

Date Drilled: February 1953

Location: 660' FSL, 659' FWL, Sec 13, T-11-S, R-32-E, Lea County, New Mexico

Depth: TD 10,630' (Deepened to 10,779' in March 1966)

Completion Record:

Perfs: 10,604-629', OH 10,630-779'

Zone: Devonian

Initial Potential: F 63 BO in 7 hrs.

NEW MEXICO BO STATE #5

Well Type: P & A Oil Well

Date Drilled: September 1953

Location: 1650' FSL, 660' FWL, Sec 13, T-11-S, R-32-E, Lea County, New Mexico

Depth: TD 10,680'

Drilled & Abandoned

Well Diagram After P.A.

N.M. 30" ST. No. 4

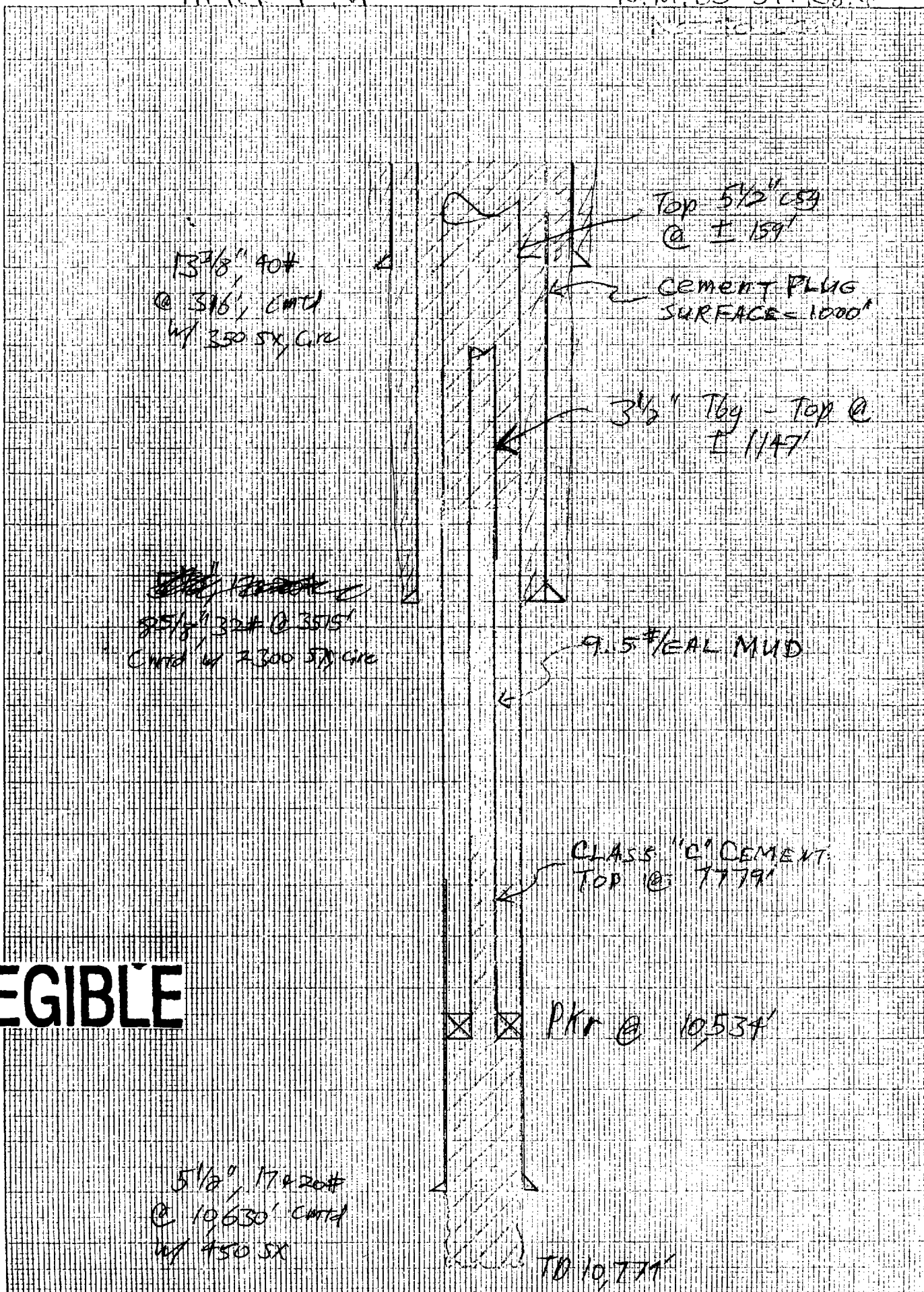

ILLEGIBLE

C. W. Robinson A #3

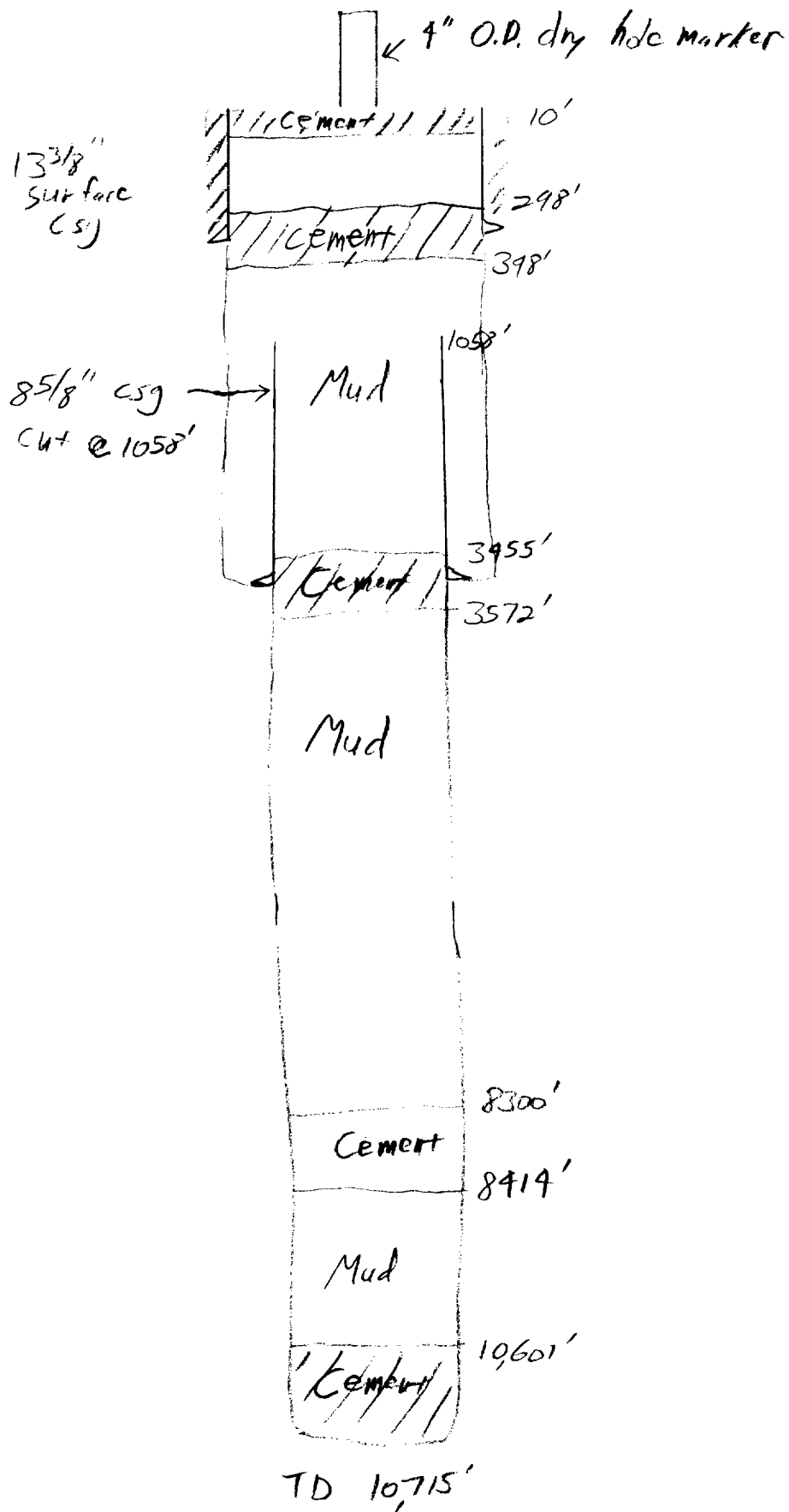

APPLICATION FOR AUTHORIZATION TO INJECT

Rhombus Energy Company
200 N. Loraine, Suite 1270
Midland, TX 79701

- VII. 1. Proposed average and maximum daily rate and volume of fluids to be injected: Average = 1900 BWPD, Max = 2500 BWPD
2. Closed System
3. Proposed average and maximum injection pressure: Average = 0, Maximum = 500 psi.
4. Reinjecting produced water only.
- VIII. Geologic data of injection zone: Devonian Formation
Lithology: Fractured, Vuggy Dolomite
Top of Devonian in the C. W. Robinson A #2: 10,616'
Approximate Devonian thickness in the Moore Field: 400'
- Source of underground water: Ogallala, 300'
- IX. Acidize w/ 5000 gal 15% NEFE HCl.
- XII. I have examined available geologic and engineering data and find no evidence of open faults or any other hydrologic connection between the disposal zone and any underground source of drinking water.



Gregory D. Cielinski

4-24-96
Date

Is your RETURN ADDRESS completed on the reverse side?

SENDER:

- Complete items 1 and/or 2 for additional services.
- Complete items 3, and 4a & b.
- Print your name and address on the reverse of this form so that we can return this card to you.
- Attach this form to the front of the mailpiece, or on the back if space does not permit.
- Write "Return Receipt Requested" on the mailpiece below the article number.
- The Return Receipt will show to whom the article was delivered and the date delivered.

I also wish to receive the following services (for an extra fee):

1. ☐ Addressee's Address
2. ☐ Restricted Delivery

Consult postmaster for fee.

3. Article Addressed to:

Mr. & Mrs. Ray Hilburn
P.O. Box 978
Tatum, NM 88267

4a. Article Number

Z-296-652-039

4b. Service Type

- | | |
|---|--|
| <input type="checkbox"/> Registered | <input type="checkbox"/> Insured |
| <input checked="" type="checkbox"/> Certified | <input type="checkbox"/> COD |
| <input type="checkbox"/> Express Mail | <input checked="" type="checkbox"/> Return Receipt for Merchandise |

7. Date of Delivery

4-19-96

5. Signature (Addressee)

8. Addressee's Address (Only if requested and fee is paid)

6. Signature (Agent)

Marcia Hilburn

PS Form 3811, December 1991

★U.S. GPO: 1992-323-402

DOMESTIC RETURN RECEIPT

Thank you for using Return Receipt Service.



Rhombus Energy Co.

200 N. Loraine, Suite 1270
Midland, TX 79701
(915) 683-8873

April 17, 1996

Mrs. & Mr. Ray Hilburn
P.O. Box 978
Tatum, NM 88267

RE: C. W. Robinson A #2
Lea County, New Mexico

Dear Mrs. & Mr. Hilburn:

This letter is to inform you as a land owner within one-half mile of the above referenced well, that Rhombus Energy Company, whose address is stated above, is planning to convert this well into a disposal well to dispose of produced water from the Moore Devonian field.

The well is located 1980' from the south line and 660' from the east line, in Section 14, T-11-S, R-32-E. The injection formation is going to be the Devonian at a depth of 10616-600'. The expected average injection rate is 1900 barrels per day, with a maximum of 2500 barrels per day. The expected average injection pressure is 0 psi, with a maximum of 500 psi.

If you have any objection to the proposed work, you have 15 days to file an objection with the Oil Conservation Division at 2040 South Pacheco St, Santa Fe, NM 87505.

If you have any other questions or concerns, please contact the undersigned or Greg Cielinski at the letterhead address.

Sincerely

Mabry Kniffen-Wingo
Administrative Assistant

Is your RETURN ADDRESS completed on the reverse side?

SENDER:

- Complete items 1 and/or 2 for additional services.
- Complete items 3, and 4a & b.
- Print your name and address on the reverse of this form so that we can return this card to you.
- Attach this form to the front of the mailpiece, or on the back if space does not permit.
- Write "Return Receipt Requested" on the mailpiece below the article number.
- The Return Receipt will show to whom the article was delivered and the date delivered.

I also wish to receive the following services (for an extra fee):

1. ☐ Addressee's Address
2. ☐ Restricted Delivery

Consult postmaster for fee.

3. Article Addressed to:

Amerada Hess Corporation
P.O. Drawer D
Monument, NM 88265

4a. Article Number

2-296-652-040

4b. Service Type

- | | |
|---|--|
| <input type="checkbox"/> Registered | <input type="checkbox"/> Insured |
| <input checked="" type="checkbox"/> Certified | <input type="checkbox"/> COD |
| <input type="checkbox"/> Express Mail | <input checked="" type="checkbox"/> Return Receipt for Merchandise |

7. Date of Delivery

4-19-96

5. Signature (Addressee)

[Signature]

6. Signature (Agent)

8. Addressee's Address (Only if requested and fee is paid)

PS Form 3811, December 1991

★U.S. GPO: 1992-323-402

DOMESTIC RETURN RECEIPT

Thank you for using Return Receipt Service.



Rhombus Energy Co.

200 N. Loraine, Suite 1270
Midland, TX 79701
(915) 683-8873

April 17, 1996

Amerada Hess Corporation
P.O. Drawer D
Monument, NM 88265

RE: C. W. Robinson A #2
Lea County, New Mexico

Dear Sirs:

This letter is to inform you as an operator within one-half mile of the above referenced well, that Rhombus Energy Company, whose address is stated above, is planning to convert this well into a disposal well to dispose of produced water from the Moore Devonian field.

The well is located 1980' from the south line and 660' from the east line, in Section 14, T-11-S, R-32-E. The injection formation is going to be the Devonian at a depth of 10616-600'. The expected average injection rate is 1900 barrels per day, with a maximum of 2500 barrels per day. The expected average injection pressure is 0 psi, with a maximum of 500 psi.

If you company have any objection to the proposed work, you have 15 days to file an objection with the Oil Conservation Division at 2040 South Pacheco St, Santa Fe, NM 87505.

If you have any other questions or concerns, please contact the undersigned or Greg Cielinski at the letterhead address.

Sincerely

Mabry Kniffen-Wingo
Administrative Assistant

AFFIDAVIT OF PUBLICATION

State of New Mexico,
County of Lea.

I, Kathi Bearden

Publisher

of the Hobbs Daily News-Sun, a daily newspaper published at Hobbs, New Mexico, do solemnly swear that the clipping attached hereto was published once a week in the regular and entire issue of said paper, and not a supplement thereof for a period.

of _____
1 weeks.

Beginning with the issue dated

April 21, 1996

and ending with the issue dated

April 21, 1996

Publisher

Sworn and subscribed to before

me this _____ day of

_____, 1996

Notary Public.

My Commission expires

March 24, 1998

(Seal)

This newspaper is duly qualified to publish legal notices or advertisements within the meaning of Section 3, Chapter 167, Laws of 1937, and payment of fees for said publication has been made.

LEGAL NOTICE

April 21, 1996

Rhombus Energy Company (200 N. Loraine, Suite 1270, Midland, TX 79701) proposes to convert the C. W. Robinson A#2 (1980' FLS & 660' FEL, Section 14, T-11-S, R-32-E) for the purpose of disposing produced water from the Moore Devonian field. Injection will be into the Devonian open hole interval from 16,616-600'. The maximum injection rate and pressure is 2500 BPD and 500 psi. Contact Greg Cielinski at (915) 683-8873 for any questions. Interested parties must file objections within 15 days to the Oil Conservation Division at 2040 S. Pacheco St. Santa Fe, NM 87505. #14507.