

APPLICATION FOR SURFACE COMMINGLING, OFF LEASE STORAGE, AND MEASUREMENT APPROVAL FOR THE PROPOSED GILA 12 FEDERAL NO. 1 IN THE NORTHWEST POKER LAKE DELAWARE, SEC. 12, T24S, R30E, EDDY COUNTY, NEW MEXICO (NM 82896) TO THE POKER LAKE 18 FEDERAL NO. 1 BATTERY LOCATED IN SEC. 18, T24S, R31E, EDDY COUNTY, NEW MEXICO, NORTHWEST POKER LAKE DELAWARE FIELD, (NM 89819).

TO: BUREAU OF LAND MANAGEMENT
P.O. BOX 1778
CARLSBAD, NEW MEXICO 88221-1778

MERIDIAN OIL INC. IS RESPECTFULLY REQUESTING APPROVAL TO COMBINE PRODUCTION FROM THE PROPOSED GILA 12 FEDERAL WELL NO.1 TO THE POKER LAKE 18 FEDERAL NO. 1 BATTERY. BOTH LEASES ARE PRODUCING FROM THE NORTHWEST POKER LAKE DELAWARE FIELD.

POKER LAKE '18' FEDERAL LEASE

NM 89819

<u>WELL NO.</u>	<u>LOC.</u>	<u>SEC.</u>	<u>TWP.</u>	<u>RNG.</u>	<u>FORMATION</u>
1	F	18	24S	31E	DELAWARE

GILA 12 FEDERAL LEASE

NM 82896

1 (PRO)	P	12	24S	31E	DELAWARE
---------	---	----	-----	-----	----------

PRODUCTION FROM THE WELLS INVOLVED IS AS FOLLOWS:

<u>WELL NAME AND NO.</u>	<u>BOPD</u>	<u>OIL GRAVITY</u>	<u>MCFPD</u>
POKER LAKE '18' FEDERAL # 1	18	42.0	20
GILA '12' FEDERAL # 1 (PRO)	50	42.0	70

PRODUCTION WILL BE INTO A COMMON TANK BATTERY LOCATED IN UNIT LETTER F, SEC. 18, T24S, R31E, EDDY COUNTY, NEW MEXICO. THERE ARE OTHER WELLS SCHEDULED TO BE DRILLED AND COMPLETED ON BOTH LEASES. THEREFORE, WE RESPECTFULLY REQUEST LEASE COMMINGLING APPROVAL FOR THE GILA '12' FEDERAL (NM 82896), NORTHWEST POKER LAKE AND THE POKER LAKE '18' FEDERAL LEASE (NM 89819), NORTHWEST POKER LAKE.

PRODUCTION WILL BE ALLOCATED BY WELL TESTS. GAS IS TO BE METERED.

MERIDIAN OIL INC. IS 100% WORKING INTEREST OWNER FOR BOTH LEASES.

THE PROPOSED COMMINGLING OF PRODUCTION IS IN THE INTEREST OF CONSERVATION AND WILL NOT RESULT IN REDUCED ROYALTY OR IMPROPER MEASUREMENT OF PRODUCTION.

THE PROPOSED COMMINGLING IS NECESSARY FOR CONTINUED OPERATION OF THE ABOVE REFERENCED FEDERAL LEASE.

WE UNDERSTAND THAT THE REQUESTED APPROVAL WILL NOT CONSTITUTE THE GRANTING OF ANY RIGHT OF WAY OR CONSTRUCTION RIGHTS NOT GRANTED BY THE LEASE INSTRUMENT. AND, WE WILL SUBMIT WITHIN 30 DAYS AN APPLICATION FOR RIGHT OF WAY APPROVAL TO THE BLM'S REALTY SECTION IN YOUR OFFICE IF WE HAVE NOT ALREADY DONE SO.

SIGNATURE:



NAME:

DONNA WILLIAMS

TITLE:

PRODUCTION ASSISTANT

DATE:

OCTOBER 21, 1994

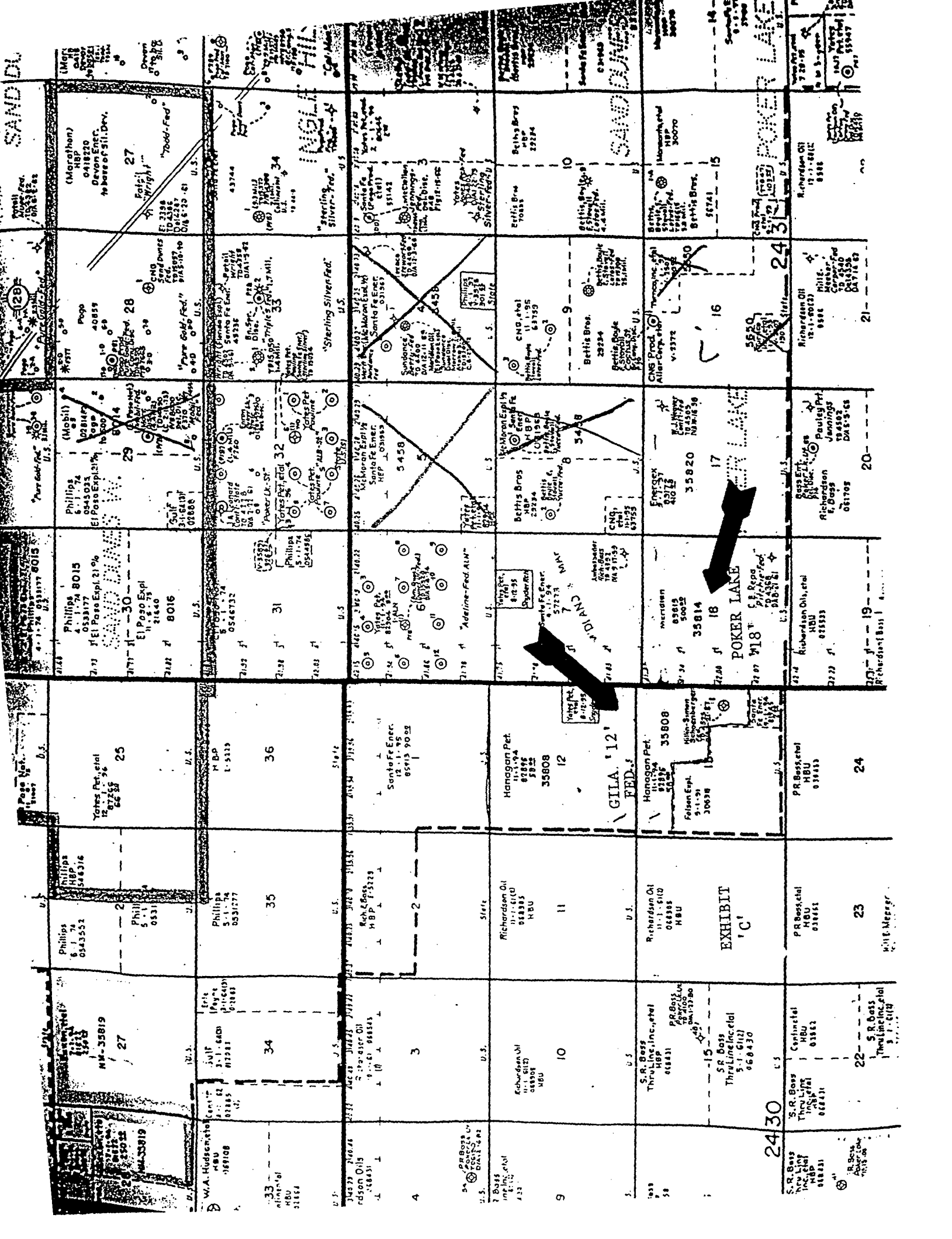

**MERIDIAN OIL INC.
GILA '12' FEDERAL LEASE
NM 82896
SEC. 12, T24S, R30E
EDDY COUNTY, NEW MEXICO
880 ACRES**

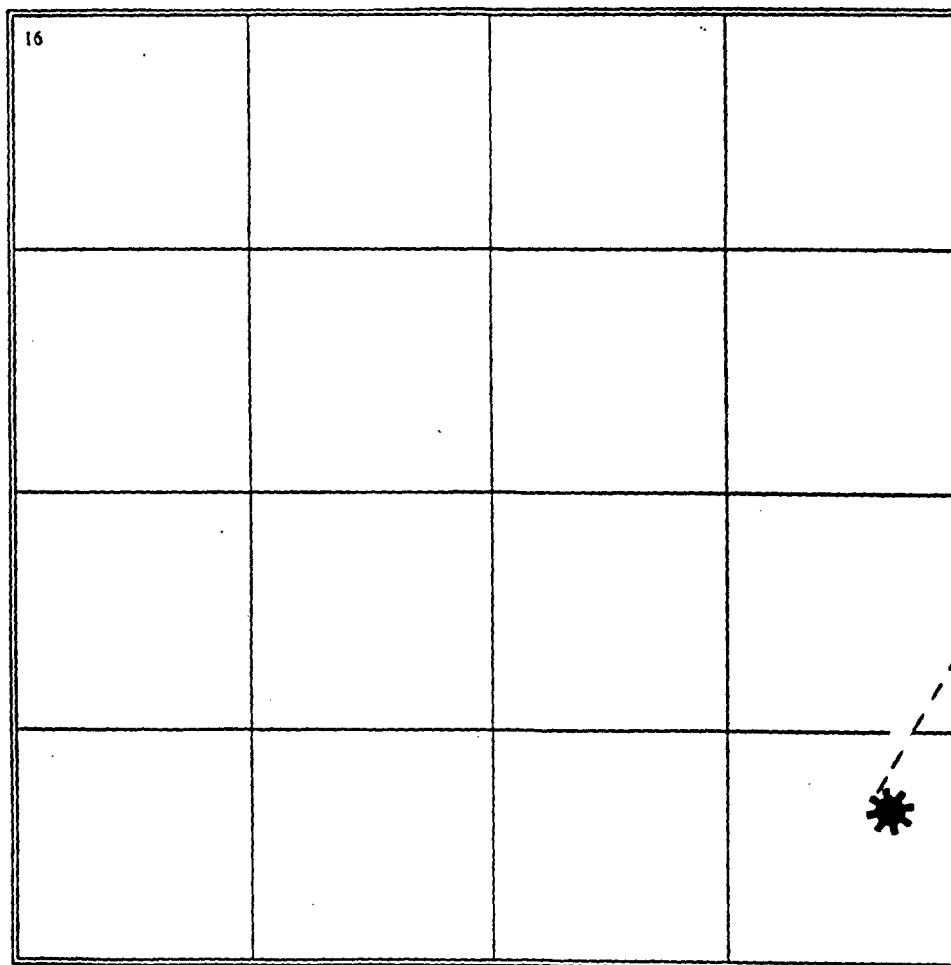

(Pro) Gila '12' Federal No. 1

MERIDIAN OIL INC.
POKER LAKE '18' FEDERAL LEASE
NM 89819
SEC. 18, T24S, R31E
EDDY COUNTY, NEW MEXICO
647.88 ACRES

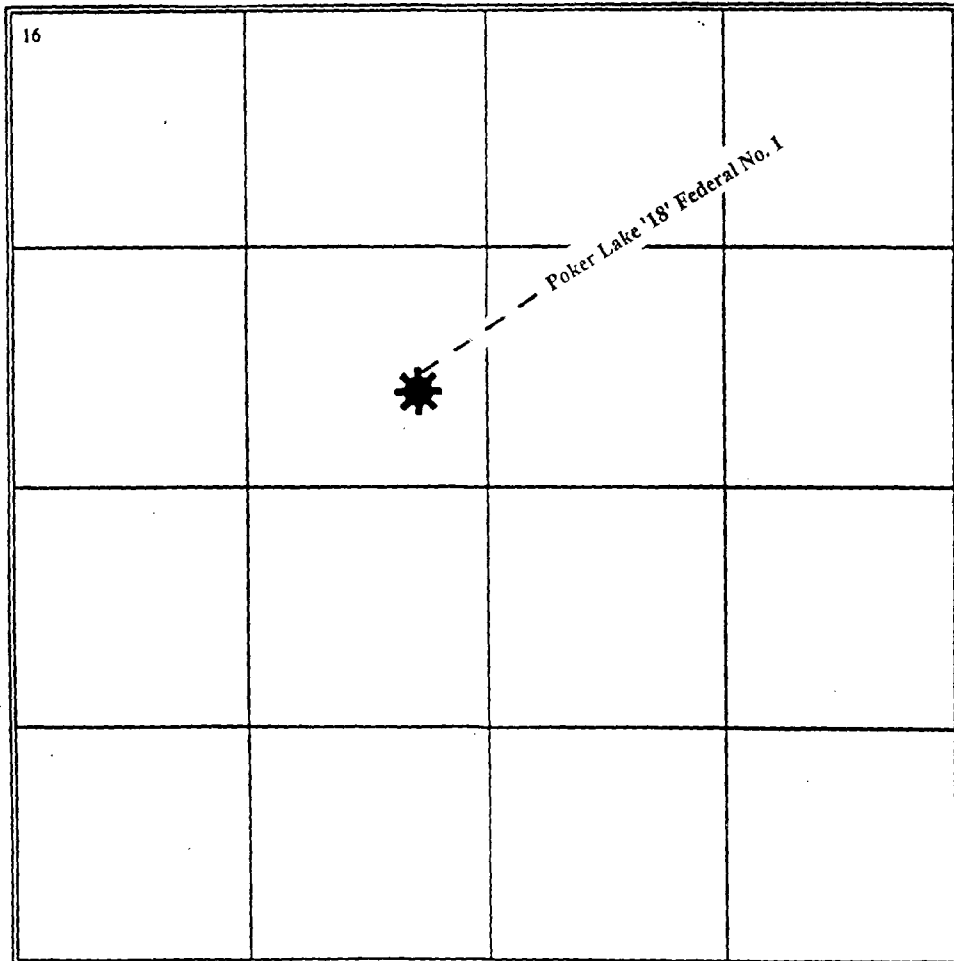

GILA "12" FEDERAL No. 1
800' FSL & 330' FEL
SEC. 12, T 24 S, R 30 E

S 89°55'41" E
294.47'
S 64°55'07" E
172.49'
S 77°37'45" E
789.70'
N 79°45'55" E
240.84'
S 79°00'53" E
330.73'
S 72°15'17" E
299.57'
26+20.58

S 79°00'53" E
330.73'

23+21.01

19+00.28

17+49.44

9+42.1

2+19.47

0+00.00

1851.72'

TE: N 5°34'54" E

172.49'

44+66.96

9+42.1

17+49.44

19+00.28

23+21.01

26+20.58

299.57'

330.73'

240.84'

789.70'

172.49'

294.47'

S 89°55'41" E

S 64°55'07" E

S 77°37'45" E

N 79°45'55" E

S 79°00'53" E

S 72°15'17" E

TE: N 5°34'54" E

172.49'

44+66.96

9+42.1

17+49.44

19+00.28

23+21.01

26+20.58

299.57'

330.73'

240.84'

789.70'

172.49'

294.47'

S 89°55'41" E

S 64°55'07" E

S 77°37'45" E

N 79°45'55" E

S 79°00'53" E

S 72°15'17" E

TE: N 5°34'54" E

172.49'

44+66.96

9+42.1

17+49.44

19+00.28

23+21.01

26+20.58

299.57'

330.73'

240.84'

789.70'

172.49'

294.47'

S 89°55'41" E

S 64°55'07" E

S 77°37'45" E

N 79°45'55" E

S 79°00'53" E

S 72°15'17" E

TE: N 5°34'54" E

172.49'

44+66.96

9+42.1

17+49.44

19+00.28

23+21.01

26+20.58

299.57'

330.73'

240.84'

789.70'

172.49'

294.47'

S 89°55'41" E

S 64°55'07" E

S 77°37'45" E

N 79°45'55" E

S 79°00'53" E

S 72°15'17" E

TE: N 5°34'54" E

172.49'

44+66.96

9+42.1

17+49.44

19+00.28

23+21.01

26+20.58

299.57'

330.73'

240.84'

789.70'

172.49'

294.47'

S 89°55'41" E

S 64°55'07" E

S 77°37'45" E

N 79°45'55" E

S 79°00'53" E

S 72°15'17" E

TE: N 5°34'54" E

172.49'

44+66.96

9+42.1

17+49.44

19+00.28

23+21.01

26+20.58

299.57'

330.73'

240.84'

789.70'

172.49'

294.47'

S 89°55'41" E

S 64°55'07" E

S 77°37'45" E

N 79°45'55" E

S 79°00'53" E

S 72°15'17" E

TE: N 5°34'54" E

172.49'

44+66.96

9+42.1

17+49.44

19+00.28

23+21.01

26+20.58

299.57'

330.73'

240.84'

789.70'

172.49'

294.47'

S 89°55'41" E

S 64°55'07" E

S 77°37'45" E

N 79°45'55" E

S 79°00'53" E

S 72°15'17" E

TE: N 5°34'54" E

172.49'

44+66.96

9+42.1

17+49.44

19+00.28

23+21.01

26+20.58

299.57'

330.73'

240.84'

789.70'

172.49'

294.47'

S 89°55'41" E

S 64°55'07" E

S 77°37'45" E

N 79°45'55" E

S 79°00'53" E

S 72°15'17" E

TE: N 5°34'54" E

172.49'

44+66.96

9+42.1

17+49.44

19+00.28

23+21.01

26+20.58

299.57'

330.73'

240.84'

789.70'

172.49'

294.47'

S 89°55'41" E

S 64°55'07" E

S 77°37'45" E

N 79°45'55" E

S 79°00'53" E

S 72°15'17" E

TE: N 5°34'54" E

172.49'

44+66.96

9+42.1

17+49.44

19+00.28

23+21.01

26+20.58

299.57'

330.73'

240.84'

789.70'

172.49'

294.47'

S 89°55'41" E

S 64°55'07" E

S 77°37'45" E

N 79°45'55" E

S 79°00'53" E

S 72°15'17" E

TE: N 5°34'54" E

172.49'

44+66.96

9+42.1

17+49.44

19+00.28

23+21.01

26+20.58

299.57'

330.73'

240.84'

789.70'

172.49'

294.47'

S 89°55'41" E

S 64°55'07" E

S 77°37'45" E

N 79°45'55" E

S 79°00'53" E

S 72°15'17" E

TE: N 5°34'54" E

172.49'

44+66.96

9+42.1

17+49.44

19+00.28

23+21.01

26+20.58

299.57'

330.73'

240.84'

789.70'

172.49'

294.47'

S 89°55'41" E

S 64°55'07" E

S 77°37'45" E

N 79°45'55" E

S 79°00'53" E

S 72°15'17" E

TE: N 5°34'54" E

172.49'

44+66.96

9+42.1

17+49.44

19+00.28

23+21.01

26+20.58

299.57'

330.73'

240.84'

789.70'

172.49'

294.47'

S 89°55'41" E

S 64°55'07" E

S 77°37'45" E

N 79°45'55" E

S 79°00'53" E

S 72°15'17" E

TE: N 5°34'54" E

172.49'

44+66.96

9+42.1

17+49.44

19+00.28

23+21.01

26+20.58

299.57'

330.73'

240.84'

789.70'

172.49'

294.47'

S 89°55'41" E

S 64°55'07" E

S 77°37'45" E

N 79°45'55" E

S 79°00'53" E

S 72°15'17" E

TE: N 5°34'54" E

172.49'

44+66.96

9+42.1

17+49.44

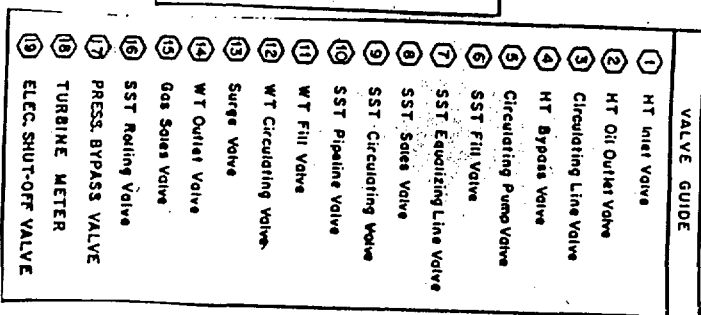

WATER LINE
OIL LINE
CIRCULATING LINE
GAS RISK LINE
POPOFF LINE

LOCATION OF SITE
SECURITY PLAN:
MERIDIAN OIL
3300 N. A ST.
BLDG 6
MIDLAND, TEXAS
79705

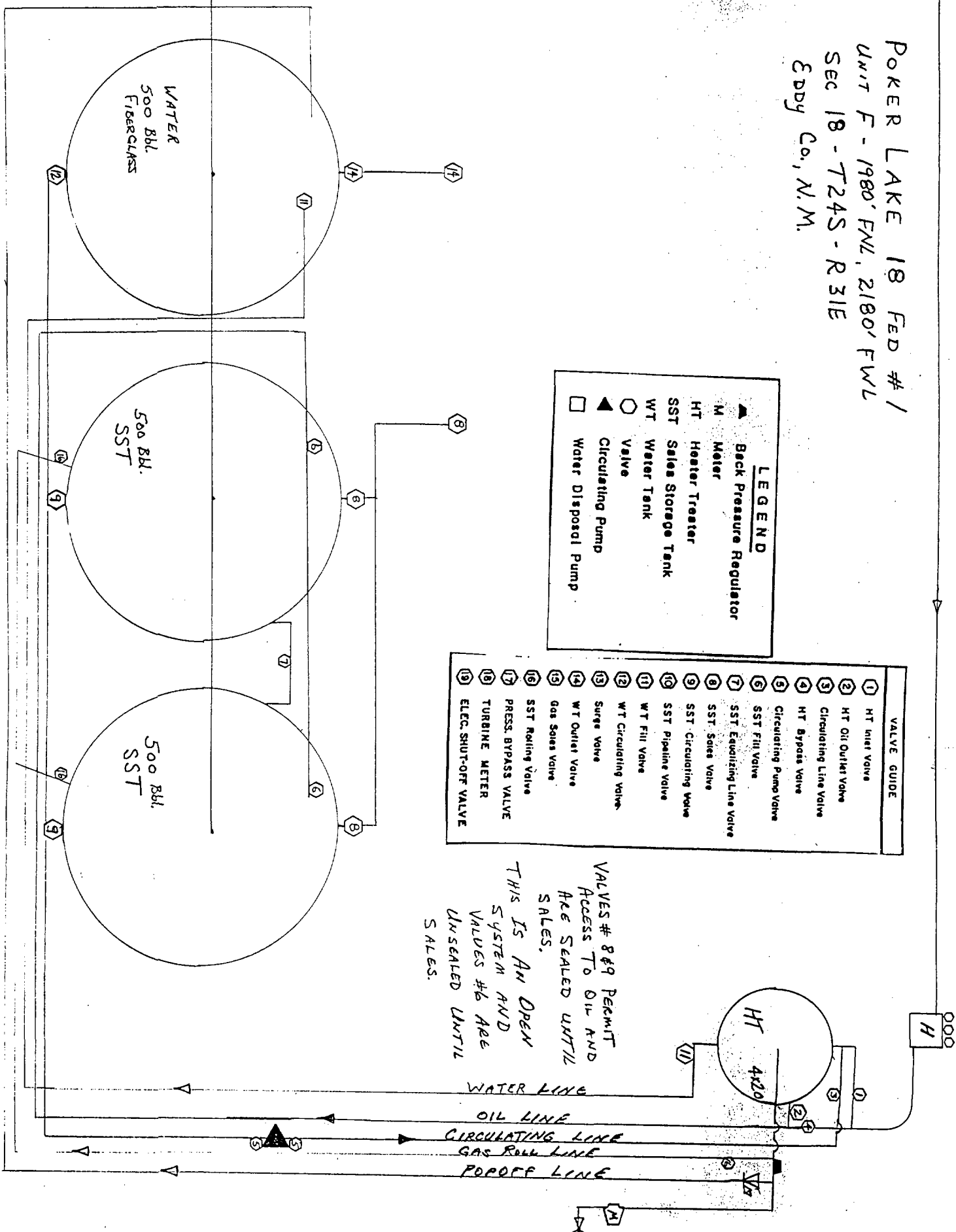

10/21/94
10:52

October 21, 1994

Mr. David Catanach
Oil Conservation Division
P.O. Box 2088
Santa Fe, New Mexico 87504

RE: Application for Off-Lease Storage
Poker Lake '18' Federal Lease (NM 89819)
(Pro) Gila '12' Federal Lease (NM 82896)
Eddy County, New Mexico

Mr. Catanach:

Meridian Oil Inc. respectfully requests approval to combine production from the above referenced leases into a common tank battery located on the Poker Lake '18' Federal Lease (NM 89819) located in Sec. 18, T24S, R31E, Eddy County, New Mexico.

POKER LAKE '18' FEDERAL LEASE

Poker Lake '18' Federal # 1

F, 1980' FNL & 2180' FWL

(PRO) GILA '12' FEDERAL LEASE

(Pro) Gila '12' Federal # 1

P, 800' FSL & 330' FEL

Due to future drilling on both leases, we are asking for lease commingling in the Northwest Poker Lake Delaware Field, Eddy County, New Mexico.

Proposed production is as follows:

<u>WELL NAME</u>	<u>BOPD</u>	<u>OIL GRAVITY</u>	<u>MCFPD</u>	<u>FORMATION</u>
Poker Lake '18' Federal # 1	20	40.6	25	Delaware

(Pro) Gila '12' Federal # 1

A map is enclosed showing the leases(s) and location of all wells that will contribute production to the proposed commingling/common storage facility.

The storage and measuring facility is located in the SE/NW of Sec. 18, T 24S, R31E, Eddy County, New Mexico. The oil production will be allocated by well tests. The gas will be metered at the Gila '12' Federal location prior to leaving the lease to the sales meter located at the Poker Lake '18' Federal battery.

Meridian owns 100% of both leases. This application is in the interest of conservation and in no way will reduce the quality of the hydrocarbon nor will result in improper measurement of production. The proposed commingling is necessary for continued operation of the above leases.

Please find attached a copy of the application submitted to the Bureau of Land Management.

Sincerely,

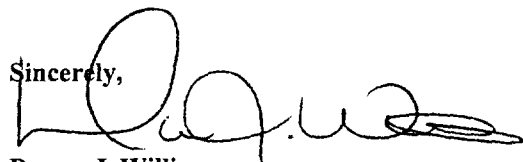

Donna J. Williams
Regulatory Assistant

UNITED STATES
DEPARTMENT OF THE INTERIOR
BUREAU OF LAND MANAGEMENT

CTB-401
NM OIL CONS. COMMISSION
FORM APPROVED
Drawer ~~DD~~ Bureau No. 1004-0135
Expires: ~~88210~~, 1993
5. Lease Designation and Serial No.

SUNDRY NOTICES AND REPORTS ON WELLS

Do not use this form for proposals to drill or to deepen or reentry to a different reservoir.
Use "APPLICATION FOR PERMIT - " for such proposals

SUBMIT IN TRIPLICATE

1. Type of Well

☒ Oil Well ☐ Gas Well ☐ Other

2. Name of Operator

MERIDIAN OIL INC.

3. Address and Telephone No.

P.O. Box 51810, Midland, TX 79710-1810 915-688-6943

4. Location of Well (Footage, Sec., T., R., M., or Survey Description)

SEC. 18, T24S, R31E

NM 89819

6. If Indian, Allottee or Tribe Name

7. If Unit or CA, Agreement Designation

8. Well Name and No.

POKER LAKE '18'
FEDERAL

9. API Well No.

10. Field and Pool, or exploratory Area

NORTHWEST POKER LAKE DEL

11. County or Parish, State

EDDY NM

12. CHECK APPROPRIATE BOX(s) TO INDICATE NATURE OF NOTICE, REPORT, OR OTHER DATA

TYPE OF SUBMISSION

- ☐ Notice of Intent
☒ Subsequent Report
☐ Final Abandonment Notice

TYPE OF ACTION

- ☐ Abandonment
☐ Recompletion
☐ Plugging Back
☐ Casing Repair
☐ Altering Casing
☐ Other COMMINGLING REQUEST
☐ Change of Plans
☐ New Construction
☐ Non-Routine Fracturing
☐ Water Shut-Off
☐ Conversion to Injection
☐ Dispose Water

(Note: Report results of multiple completion on Well Completion or Recompletion Report and Log form.)

13. Describe Proposed or Completed Operations (Clearly state all pertinent details, and give pertinent dates, including estimated date of starting any proposed work. If well is directionally drilled, give subsurface locations and measured and true vertical depths for all markers and zones pertinent to this work.)*

MERIDIAN OIL INC. RESPECTFULLY REQUEST APPROVAL TO COMMINGLE THE PRODUCTION FROM THE POKER LAKE '18' FEDERAL LEASE (NM 89819) WITH THE PROPOSED GILA '12' FEDERAL LEASE (NM 82896). WE ARE REQUESTING APPROVAL FOR SURFACE COMMINGLING, OFF LEASE STORAGE AND MEASUREMENT OF HYDROCARBON PRODUCTION FROM THE NORTHWEST POKER LAKE DELAWARE FIELD.



14. I hereby certify that the foregoing is true and correct

Signed [Signature]

Title PRODUCTION ASSISTANT

Date _____

(This space for Federal or State office use)

Approved by Orig. Signed by [Signature]

Title [Signature]

Date 12/1/94

Conditions of approval, if any:

Title 18 U.S.C. Section 1001, makes it a crime for any person knowingly and willfully to make to any department or agency of the United States any false, fictitious or fraudulent statements or representations as to any matter within its jurisdiction.

UNITED STATES
DEPARTMENT OF THE INTERIOR
BUREAU OF LAND MANAGEMENT

SUNDRY NOTICES AND REPORTS ON WELLS

Do not use this form for proposals to drill or to deepen or reentry to a different reservoir.
Use "APPLICATION FOR PERMIT - " for such proposals

SUBMIT IN TRIPLICATE

18-401
NM OIL CONS COMMISSION
Drawer DD
Antesita, NM 88210
FORM APPROVED
Budget Bureau No. 1004-0135
Expires: March 31, 1993

5. Lease Designation and Serial No.

NM 82896

6. If Indian, Allottee or Tribe Name

7. If Unit or CA, Agreement Designation

8. Well Name and No.

GILA 12 FEDERAL NO. 1

9. API Well No.

10. Field and Pool, or exploratory Area

NORTHWEST POKER LAKE

11. County or Parish, State

EDDY NM

1. Type of Well

☒ Oil Well ☐ Gas Well ☐ Other

2. Name of Operator

MERIDIAN OIL INC.

3. Address and Telephone No.

P.O. Box 51810, Midland, TX 79710-1810 915-688-6943

4. Location of Well (Footage, Sec., T., R., M., or Survey Description)

SEC. 12, T24S, R30E

12. CHECK APPROPRIATE BOX(s) TO INDICATE NATURE OF NOTICE, REPORT, OR OTHER DATA

TYPE OF SUBMISSION

- ☐ Notice of Intent
☒ Subsequent Report
☐ Final Abandonment Notice

TYPE OF ACTION

- ☐ Abandonment
☐ Recompletion
☐ Plugging Back
☐ Casing Repair
☐ Altering Casing
☒ Other COMMINGLING REQUEST
☐ Change of Plans
☐ New Construction
☐ Non-Routine Fracturing
☐ Water Shut-Off
☐ Conversion to Injection
☐ Dispose Water

(Note: Report results of multiple completion on Well Completion or Recompletion Report and Log form.)

13. Describe Proposed or Completed Operations (Clearly state all pertinent details, and give pertinent dates, including estimated date of starting any proposed work. If well is directionally drilled, give subsurface locations and measured and true vertical depths for all markers and zones pertinent to this work.)*

MERIDIAN OIL INC. RESPECTFULLY REQUEST APPROVAL TO COMMINGLING THE PRODUCTION FROM THE GILA 12 FEDERAL LEASE (NM82896) WITH THE POKER LAKE '18' FEDERAL LEASE (NM89810). WE ARE REQUESTING APPROVAL FOR SURFACE COMMINGLING, OFF LEASE STORAGE, AND MEASUREMENT OF HYDROCARBON PRODUCTION FROM THE NORTHWEST POKER LAKE DELAWARE FIELD.

RECEIVED

EB 23 1995

CON. DIV.
DIST. 2

14. I hereby certify that the foregoing is true and correct

Signed [Signature] Title REGULATORY ASSISTANT

Date 12/7/94

(This space for Federal or State office use)

Approved by Orig. Signed by Adam [Signature] Title [Signature]

Conditions of approval, if any:

Date 2/15/95

GENERAL INSTRUCTIONS

This form is designed for submitting proposals to perform certain well operations, and reports of such operations when completed, as indicated, on Federal and Indian lands pursuant to applicable Federal law and regulations, and, if approved or accepted by any State, on all lands in such State, pursuant to applicable State law and regulations. Any necessary special instructions concerning the use of this form and the number of copies to be submitted, particularly with regard to local area, or regional procedures and practices, either are shown below or will be issued by, or may be obtained from, the local Federal and/or State office.

SPECIFIC INSTRUCTIONS

Item 4 - If there are no applicable State requirements, locations on Federal or Indian land should be described in accordance with Federal requirements. Consult local State or Federal office for specific instructions.

Item 13 - Proposals to abandon a well and subsequent reports of abandonment should include such special information as is required by local Federal and/or State offices. In addition, such proposals and reports should include reasons for the abandonment; data on any former or present productive zones, or other zones with present significant fluid contents not sealed off by cement or otherwise; depths (top and bottom) and method of placement of cement plugs; mud or other material placed below, between and above plugs; amount, size, method of parting of any casing, liner or tubing pulled and the depth to top of any left in the hole; method of closing top of well; and date well site conditioned for final inspection looking to approval of the abandonment.

NOTICE

The Privacy Act of 1974 and the regulation in 43 CFR 2.48(d) provide that you be furnished the following information in connection with information required by this application.

AUTHORITY: 30 U.S.C. 181 et seq., 351 et. seq., 25 U.S.C. et. seq.; 43 CFR 3160.

PRINCIPAL PURPOSE - The information is to be used to evaluate, when appropriate, approve applications, and report completion of secondary well operation, on a Federal or Indian lease.

ROUTINE USES:

- (1) Evaluate the equipment and procedures used during the proposed or completed subsequent well operations.
- (2) Request and grant approval to perform those actions covered by 43 CFR 3162.3-2(2).
- (3) Analyze future applications to drill or modify operations in light of data obtained and methods used.
- (4)(5) Information from the record and/or the record will be transferred to appropriate Federal, State, local or foreign agencies, when relevant to civil, criminal or regulatory investigations or prosecutions.

EFFECT OF NOT PROVIDING INFORMATION - Filing of this notice and report and disclosure of the information is mandatory once an oil or gas well is drilled.

The Paperwork Reduction Act of 1980 (44 U.S.C. 3501 et seq.) requires us to inform you that:

This information is being collected in order to evaluate proposed and/or completed subsequent well operations on Federal or Indian oil and gas leases.

This information will be used to report subsequent operations once work is completed and when requested, to obtain approval for subsequent operations not previously authorized.

Response to this request is mandatory only for the specific types of activities specified in 43 CFR Part 3160.

BURDEN HOURS STATEMENT

Public reporting burden for this form is estimated to average 25 minutes per response, including the time for reviewing instructions, gathering and maintaining data, and completing and reviewing the form. Direct comments regarding the burden estimate or any other aspect of this form to U.S. Department of the Interior, Bureau of Land Management, (Alternate) Bureau Clearance Officer, (WO-771), 18 and C Streets, N.W., Washington, D.C. 20240, and the Office of Management and Budget, Paperwork Reduction Project (1004-0135), Washington, D.C. 20503.