

MARTIN YATES, III
1912 - 1985
FRANK W. YATES
1936 - 1986



105 SOUTH FOURTH STREET
ARTESIA, NEW MEXICO 88210
TELEPHONE (505) 748-1471

15-1000
15 22
S. P. YATES
CHAIRMAN OF THE BOARD
JOHN A. YATES
PRESIDENT
PEYTON YATES
EXECUTIVE VICE PRESIDENT
RANDY G. PATTERSON
SECRETARY
DENNIS G. KINSEY
TREASURER

January 6, 1994

New Mexico Oil Conservation Division
P. O. Box 2088
Santa Fe, NM 87504-2088

ATTENTION: Mr. William LeMay
Director

RE: Surface Commingling, Lease Commingling
and Off-Lease Storage
North Dagger Draw Upper Penn Pool
Eddy County, New Mexico

Dear Mr. LeMay:

Yates Petroleum Corporation respectfully requests administrative approval to commingle production from three wells into a common tank battery and to permit production from each well to be transported prior to measurement to another well for storage thereon. It is proposed to commingle the production from the following wells:

Thomas AJJ #3
1980' FSL & 1980' FEL (Unit J)
Section 8-T19S-R25E
Eddy County, New Mexico
Fee Lease

Roy AET #4
660' FSL & 1980' FEL (Unit O)
Section 8-T19S-R25E
Eddy County, New Mexico
Fee Lease

Warren ANW Federal #1
1980' FSL & 660' FWL (Unit L)
Section 9-T19S-R25E
Eddy County, New Mexico
NM-1372

The production from the three wells will be commingled into a common storage facility located on the Thomas AJJ #3 location. A map labeled Attachment I is enclosed for your information.

The purpose of this off-lease storage and surface commingling is to reduce operating costs for storage and treating and thereby extend the economic life of each well. Without approval for utilizing existing batteries on adjacent leases, it will become necessary to build separate facilities for each well. This will greatly increase costs and shorten the economic life of the well.

Off-Lease Storage, Etc.:

Page 2:

January 6, 1994

Because working interests for the proposed wells are different from the well where the proposed storage facilities are located, oil from each of the wells will be measured by positive displacement, temperature compensated metering equipment prior to surface commingling. Gas from the wells will also be metered separately. This metering will ensure that all production from each of the wells is equitably accounted for with no significant effect on your revenue. The production is the three wells will be from the same producing zone which is the Canyon.

In accordance with the Oil Conservation Division's Rules 303-B, 309-B and 309-C, the following diagrams and maps are submitted for your information.

Attachment II A diagram of the proposed measurement equipment, separators and storage tanks in accordance with the "Manual for Installation and Operation of Commingling Facilities".

Attachment III Notification of working interest owners of the proposal to commingle production

Attachment IV Notification to the Bureau of Land Management

Yates Petroleum Corporation appreciates your cooperation in this matter. If you should have any questions or need further information, please give me a call at 505-748-1471.

Thank you.

Sincerely,

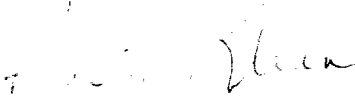

Rusty Klein
Production Clerk

rk

Enclosures

ATTACHMENT I

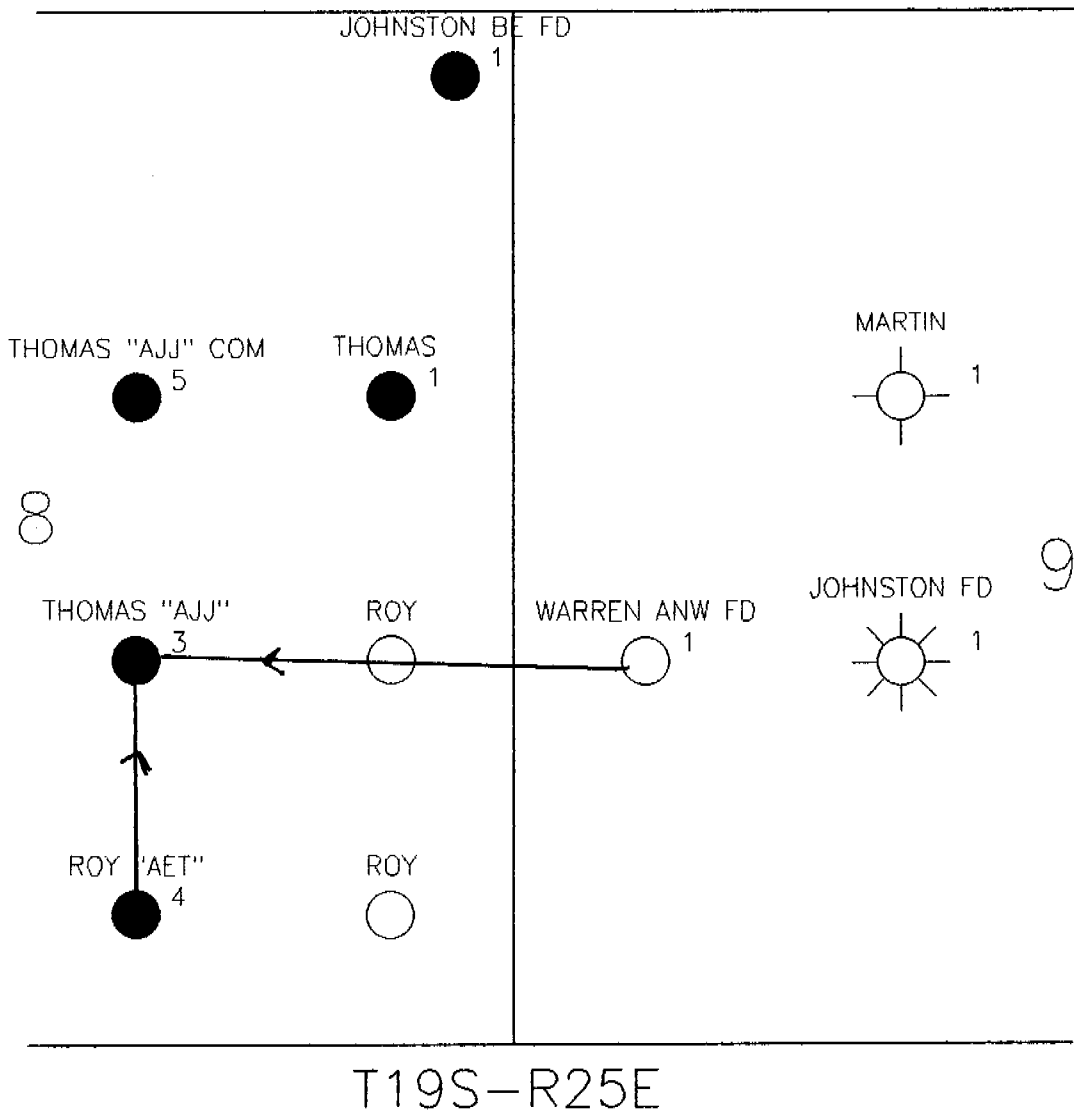

THOMAS AJJ Com BATT
 980' FSL 4-1980' FEE
 EC. 8-19 5-25 E.
 DDY County 11M
 FEE LEASE

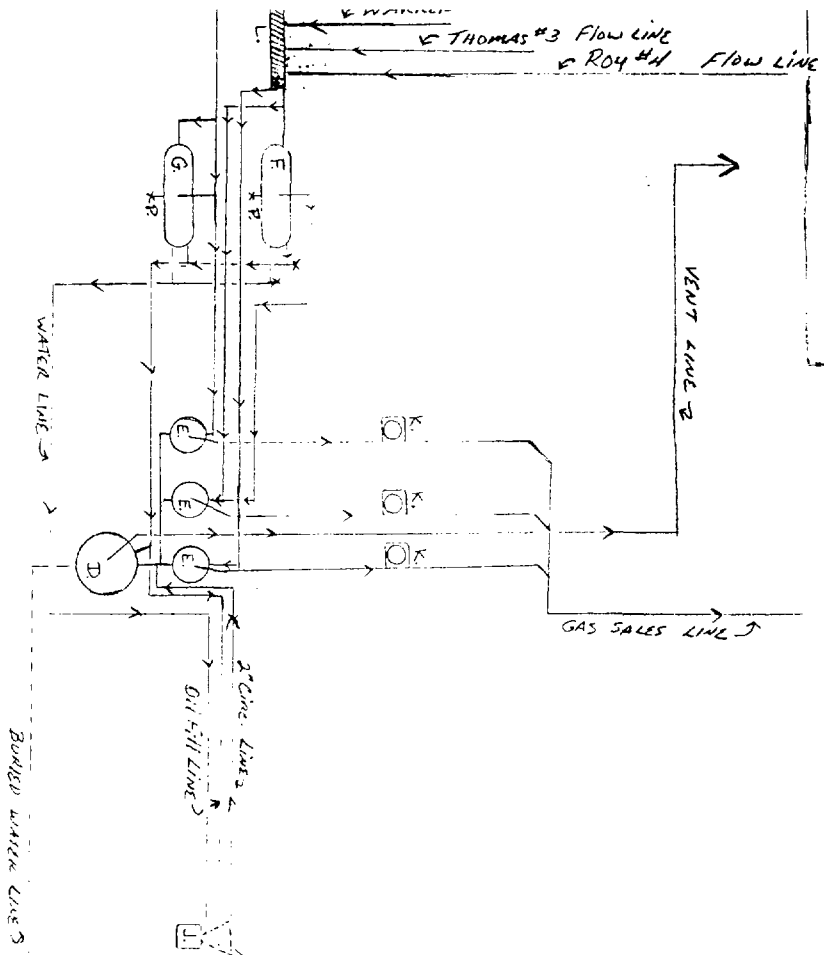

A. 500 BL. METAL STOCK TANKS	K. GAS SALES METER
B. 500 BL. FIBERGLASS WTR. TANK	L. Flow Line HEATER
C. 210 BL. FIBERGLASS ASTH. TANK	M. 3" Plug Valves closed w/
D. HEATER TREATMENT	N. 4" Plug Valve Sucks Closed
E. VERTICAL GAS SEPARATORS	O. 3" Plug valves open for tank H.
F. ROY #4 (TEST UNIT)	P. 3" Plug valves Sucks closed
G. HORIZONTAL 3-PHASE SEPARATOR	Q. TANK LEVEL GAUGES
H. HORIZONTAL 3-PHASE SEPARATOR	
I. LACT UNIT (OIL SALES)	
J. WATER PUMP	
K. 3" Plug Valve Sucks	

Wells Producing Into Battery:
 Thomas AJJ #3
 Roy AET #4
 Warren ANW Federal #1

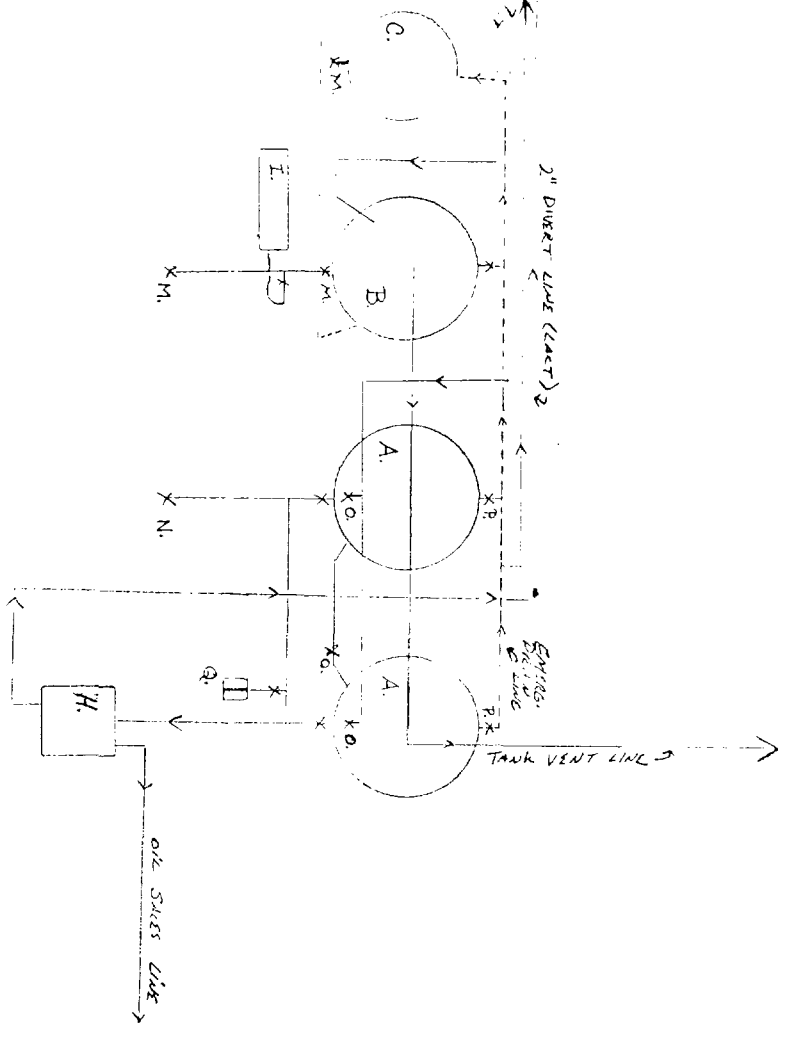

ATTACHMENT III

WORKING INTEREST AND ROYALTY INTEREST OWNERS

Thomas AJJ #3, Roy AET #4 and Warren ANW Federal #1

BY-Oil
Myco Industries, Inc.
Peggy A. Yates Estate
Yates Drilling Company
John A. Yates
Yates Petroleum Corporation
Estate of Martin Yates III
Estate of Lillie M. Yates
S. P. Yates
105 South Fourth Street
Artesia, NM 88210

Marshall & Winston
P. O. Box 50880
Midland, TX 79710-0880

Sterling M. Carter
P. O. Box 97
Winston, NM 87943

Cauhape Properties Partnership
P. O. Box 1304
Artesia, NM 88210

Shirley Childress
604 North Delaware Ave. #2
Roswell, NM 88201-2135

Lynn E. Desper
4601 Montano NW, Apt. 7
Albuquerque, NM 87120

Jessie Marie Gallivan
UNM of Carlsbad #0596094
P. O. Box 1689
Carlsbad, NM 88221-1689

Annabel Harris
1519 Vineyard Lane
Carlsbad, NM 88220

John T. Hinkle
P. O. Box 1793
Roswell, NM 88201

Charles E. Hinkle
Lonoak Route, Box 4
King City, CA 93930

Conoco, Inc.
P. O. Box 951063
Dallas, TX 75395-1063
Attn: Land Department

Bettianne Hinkle Bowen
1902 Ivanhoe Lane
Abilene, TX 79605

Michael Carter
1021 Plaza Drive
Granbury, TX 76048

James W. Chldress
P. O. Box 209
Roswell, NM 88201

Alfred Foy Curry, IV
1016 Alta Loma Circle
San Angelo, TX 76901

Sally A. Ellis
Sole & Separate Property
771 Crescent Drive
Boulder, CO 80303

Mary Ann Milner Glass
517 S. Adams Street
San Angelo, TX 76901-4501

R. R. Hinkle Company
P. O. Box 59
Roswell, NM 88202-0059

Cynthia Lackee, Trustee
For Kristin & Jenna Hinkle
Route 3, Box 519
Carmel, CA 93923

Lillian T. Hinkle
P. O. Box 2002
Roswell, NM 88201

ATTACHMENT III - CONTINUED

James Lisle Hinkle
P. O. Box 2002
Roswell, NM 88202

Howard & Betty Howell
Box 75
Lakewood, NM 88254

Hugh M. Kincaid
Queen Route
Carlsbad, NM 88220

Lou Ann Langford
404 E. 55th Street - Apt. 10B
New York, NY 10022-5137

Richard H. Landsheft, Jr.
2313 Jim Dent
El Paso, TX 79936

Claribel Y. Marshall
P. O. Box 1712
Roswell, NM 88202-1712

Palmer First National Bank & Trust Company - CANNOT NOTIFY
of Sarasota, Trustee
105 South Fourth Street
Artesia, NM 88210

Don Phillips & Associates
c/o Donald W. Newton
1416 Meeting House Lane
Knoxville, TN 37931

Gayle Glass Roche
P. O. Box 50248
Austin, TX 78763

Thelma Schaefer
906 Hermosa
Artesia, NM 88210

Mary Ann Glass Taylor
517 So. Adams Street
San Angelo, TX 76901

Gayle Turner
1211 Marshall Lane
Austin, TX 78703

Charles H. Coll
P. O. Box 1818
Roswell, NM 88202-1818

Richard M. Howell
Box 94
Lakewood, NM 88254

Hugh M. Kincaid
Trustee for Ella Lavada Swope Trust
Queen Route
Carlsbad, NM 88220

Jefferson M. Langford
P. O. Box 22205
Santa Fe, NM 87502

Robert Glass Langford
Route 3, Box 49
Lockhart, TX 78644

William Brian Landsheft
Route 6
15880 S. Peoria
Bixby, OK 74008

McQuiddy Comm. & Energy, Inc.
P. O. Box 2072
Roswell, NM 88201

Quetico Superior Foundation
220 South 6th Street
Minneapolis, MN 55402-1498

Allison Claire Saunders
P. O. Box 27391
Austin, TX 78755-2391

Kenna Carter Scott
Route 3, Box 329
Big Spring, TX 79720

Ray Neil Thomas
704 W. Riverside Drive
Carlsbad, NM 88220

Brooks Family O&G Mgt. Trust #2283
Nations Bank of Texas, N.A., Trustee
P. O. Box 2546
Ft. Worth, TX 76113-2546

James N. Coll
P. O. Box 1818
Roswell, NM 88202-1818

Jon F. Coll
P. O. Box 1818
Roswell, NM 88202-1818

Barbara Fasken, as her sole &
separate property
303 W. Wall Ave. - Suite 1900
Midland, TX 79701-5116

Everett R. Sharp
7042 Turtle Creek Lane
Dallas, TX 75205-1263

Max W. Coll II (DO NOT SEND CERTIFIED)
Route 9, Box 72F
Santa Fe, NM 87505

Estate of L. C. Johnston
3700 Renaissance Tower
1201 Elm Street
Dallas, TX 75270

T. J. Sivley
c/o Sunwest Bank of Albuquerque
Trust Minerals/Oil & Gas
P. O. Box 26900
Albuquerque, NM 87125-6900

Form 3160-5
(1990)

UNITED STATES
DEPARTMENT OF THE INTERIOR
BUREAU OF LAND MANAGEMENT

OPERATOR'S COPY

Budget Bureau No. 1004-0135
Expires: March 31, 1993

5. Lease Designation and Serial No.

NM-1372

6. If Indian, Allottee or Tribe Name

7. If Unit or CA, Agreement Designation

8. Well Name and No.

Warren ANW Federal #1

9. API Well No.

30-015-26748

10. Field and Pool, or Exploratory Area

North Dagger Draw Upper Penn

11. County or Parish, State

Eddy County, New Mexico

SUNDRY NOTICES AND REPORTS ON WELLS
Do not use this form for proposals to drill or to deepen or reentry to a different reservoir.
Use "APPLICATION FOR PERMIT--" for such proposals

SUBMIT IN TRIPLICATE

Type of Well

☒ Oil Well ☐ Gas Well ☐ Other

Name of Operator

YATES PETROLEUM CORPORATION (505) 748-1471

Address and Telephone No.

105 South 4th St., Artesia, NM 88210

Location of Well (Footage, Sec., T., R., M., or Survey Description)

1980' FSL & 660' FWL (Unit L) of Section 9-T19S-R25E

CHECK APPROPRIATE BOX(S) TO INDICATE NATURE OF NOTICE, REPORT, OR OTHER DATA

TYPE OF SUBMISSION

- ☒ Notice of Intent
☐ Subsequent Report
☐ Final Abandonment Notice

TYPE OF ACTION

- ☐ Abandonment
☐ Recompletion
☐ Plugging Back
☐ Casing Repair
☐ Altering Casing
☒ Other Off lease measurement, surface commingling & lease commingling
☐ Change of Plans
☐ New Construction
☐ Non-Routine Fracturing
☐ Water Shut-Off
☐ Conversion to Injection
☐ Dispose Water
(Note: Report results of multiple completion on Well Completion or Recompletion Report and Log form.)

Describe Proposed or Completed Operations (Clearly state all pertinent details, and give pertinent dates, including estimated date of starting any proposed work. If well is directionally drilled, give subsurface locations and measured and true vertical depths for all markers and zones pertinent to this work.)

Please see attached form for surface commingling, off lease storage and measurement for the following wells:

Thomas AJJ #3, 1980' FSL & 1980' FEL (Unit J) of Section 8-T19S-R25E, Eddy County, New Mexico
Roy AET #4, 660' FSL & 1980' FEL (Unit O) of Section 8-T19S-R25E, Eddy County, New Mexico
Warren ANW Federal #1, 1980' FSL & 660' FWL (Unit L) of Section 9-T19S-R25E, Eddy County, NM

Battery location is at the Thomas AJJ #3.

See attached maps and facility diagram.

I hereby certify that the foregoing is true and correct

Signed Lusty KleinTitle Production ClerkDate Jan. 6, 1994

(This space for Federal or State office use)

Approved by Joe J. LaraTitle PETROLEUM ENGINEERDate 1/20/94

18 U.S.C. Section 1001, makes it a crime for any person knowingly and willfully to make to any department or agency of the United States any false, fictitious or fraudulent statements or representations as to any matter within its jurisdiction.

See instructions on Reverse Side

CRA BLM FORMAT

APPLICATION FOR SURFACE COMMINGLING,
OFF LEASE STORAGE AND MEASUREMENT APPROVAL

This Format Should Be Attached To A Sundry Notice

To: Bureau of Land Management
P. O. Box 1778
Carlsbad, New Mexico 88221-1778

Yates Petroleum Corp. (Operator's Name) is requesting approval for surface commingling and off-lease storage and measurement of hydrocarbon production from the following formation(s) and well(s) on Federal Lease No. NM-1372 ; Lease Name: Warren ANW Federal

<u>Well No.</u>	<u>Loc.</u>	<u>Sec.</u>	<u>Twp.</u>	<u>Rng.</u>	<u>Formation</u>
<u>1</u>	<u>L</u>	<u>9</u>	<u>19S</u>	<u>25E</u>	<u>Canyon</u>
<u> </u>	<u> </u>	<u> </u>	<u> </u>	<u> </u>	<u> </u>
<u> </u>	<u> </u>	<u> </u>	<u> </u>	<u> </u>	<u> </u>
<u> </u>	<u> </u>	<u> </u>	<u> </u>	<u> </u>	<u> </u>

with hydrocarbon production from the following formation(s) and well(s) on two fee leases as follows: Thomas AJJ #3 and the Roy AET #4

<u>Well No.</u>	<u>Loc.</u>	<u>Sec.</u>	<u>Twp.</u>	<u>Rng.</u>	<u>Formation</u>
<u>3</u>	<u>J</u>	<u>8</u>	<u>19S</u>	<u>25E</u>	<u>Canyon</u>
<u>4</u>	<u>O</u>	<u>8</u>	<u>19S</u>	<u>25E</u>	<u>Canyon</u>
<u> </u>	<u> </u>	<u> </u>	<u> </u>	<u> </u>	<u> </u>

Production from the wells involved is as follows:

<u>Well Name and No.</u>	<u>BOPD</u>	<u>Oil Gravity</u>	<u>MCFPD</u>
<u>Thomas AJJ #3</u>	<u>40</u>	<u>43.4</u>	<u>48</u>
<u>Roy AET #4</u>	<u>127</u>	<u>43.4</u>	<u>134</u>
<u>Warren ANW Federal #1</u>	<u>N/A</u>	<u>N/A</u>	<u>N/A</u>
<u> </u>	<u> </u>	<u> </u>	<u> </u>
<u> </u>	<u> </u>	<u> </u>	<u> </u>
<u> </u>	<u> </u>	<u> </u>	<u> </u>

Continued ...

Continued:

The proposed operation is described in detail on the attached diagrams.

A map is enclosed showing the lease numbers and location of all leases and wells that will contribute production to the proposed commingling/common storage facility. All unitized/communitized areas, producing zones/pools are also clearly illustrated.

A schematic diagram is also attached which clearly identifies all equipment that will be utilized.

The storage and measuring facility is located at NW/4 SE/4 -1/4, Sec. 8, T 19 S, R 25 E, on lease No. fee lease Eddy County, New Mexico. BLM will be notified if there is any future change in the facility location.

Details of the proposed method for allocating production to contributing sources is as follows:

Oil from each of the wells will be measured by positive displacement, temperature compensated metering equipment prior to surface commingling. Gas will also be metered separately.

The working interest owners have been notified of the proposal.

The proposed commingling of production is in the interest of conservation and will not result in reduced royalty or improper measurement of production.

The proposed commingling is necessary for continued operation of the above referenced Federal leases.

We understand that the requested approval will not constitute the granting of any right-of-way or construction rights not granted by the lease instrument. And, we will submit within 30 days an application for right-of-way approval to the BLM's Realty Section in your office if we have not already done so.

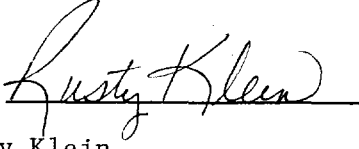
Signature: 

Name: Rusty Klein

Title: Production Clerk

Date: January 6, 1994

ATTACHMENT I

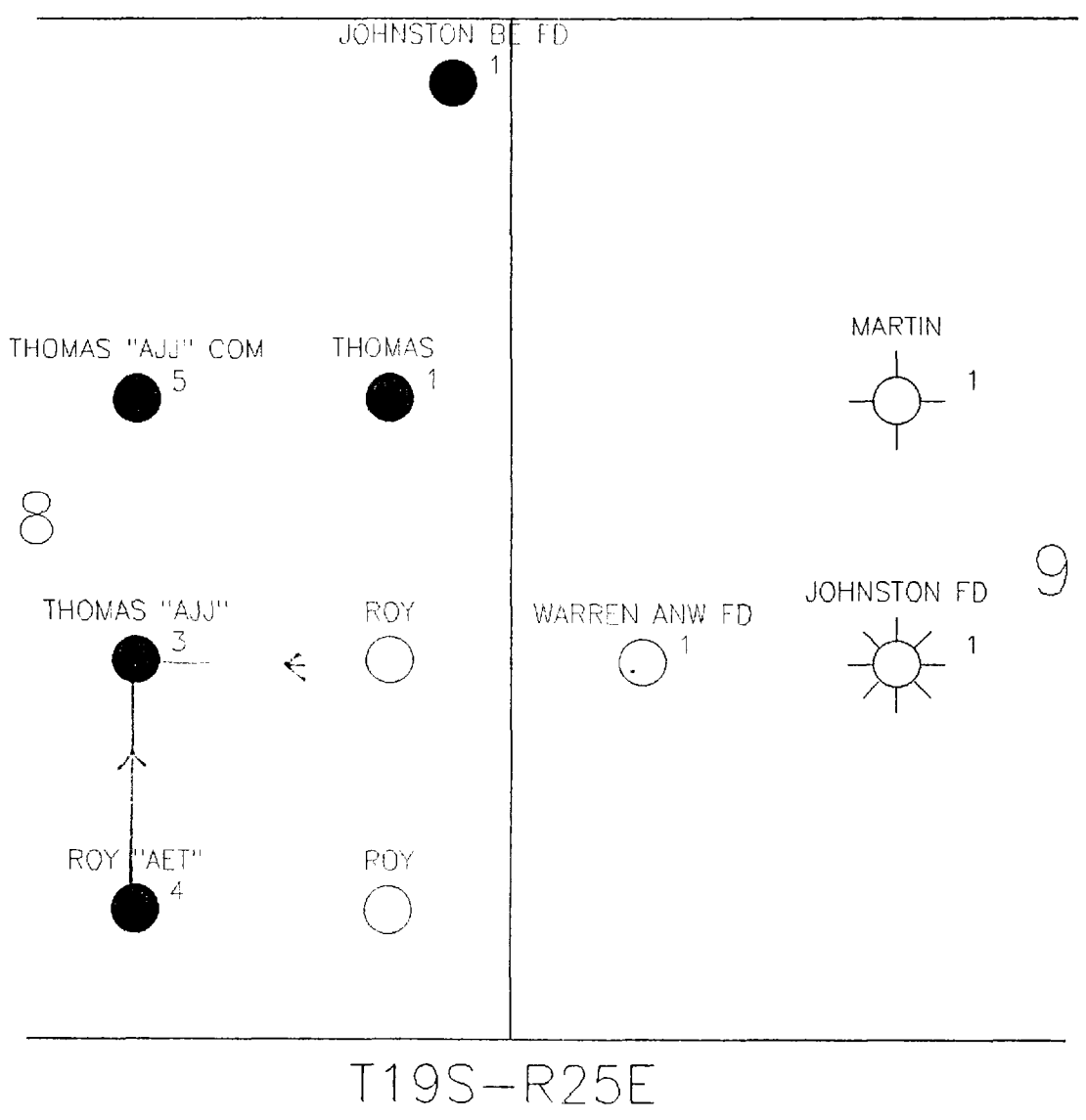

ONIAS AJS Com BATT.
PO' FSL 7/1980' FEE
S. 8-19 5-25 E.
By County Clerk
LEE LEASE

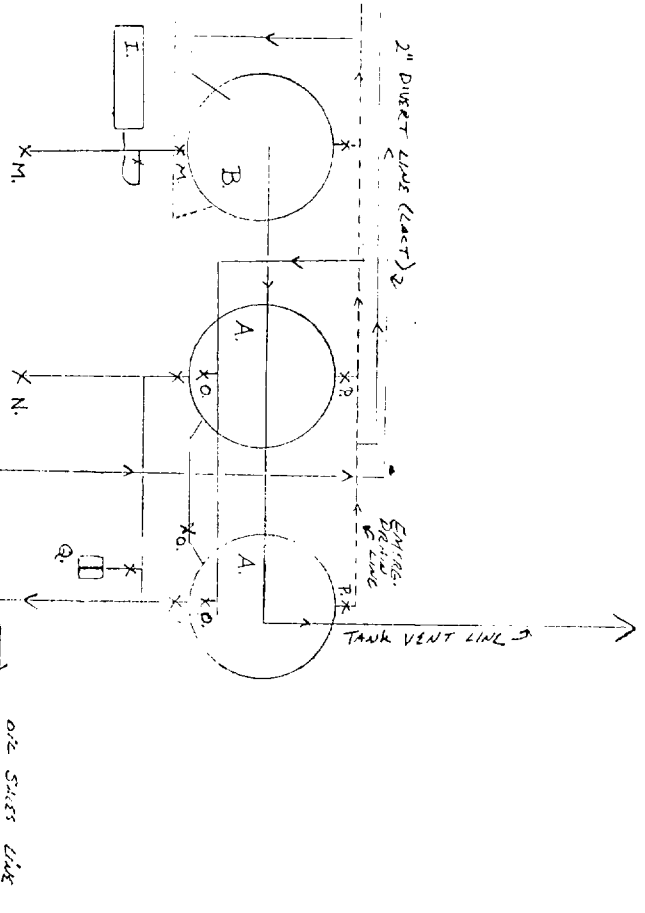
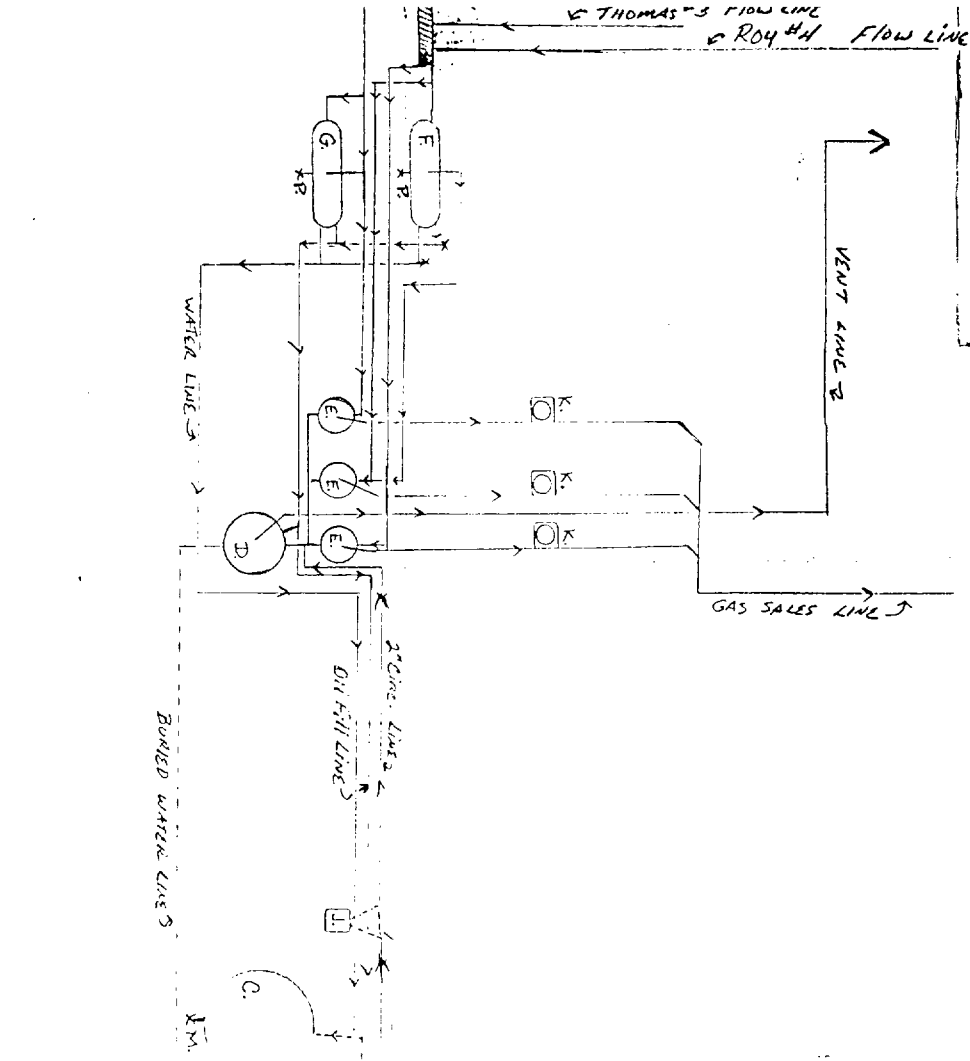

- | | |
|---------------------------------|--------------------------------------|
| A. 500 BL. METAL STOCK TANKS | K. GAS SALES METER |
| B. 500 BL. FIBREGLASS WTR. TANK | L. FLOW LINE HEATER |
| C. 210 BL. FIBREGLASS 65TH TANK | M. 3" Plug Valves closed w/ |
| D. HEATER TRANSFER | N. 4" Plug Valve Sdshd Closed |
| E. VERTICAL GAS SEPARATORS | O. 3" Plug valves open for tank fill |
| F. ROYAL (TEST UNIT) | P. 3" Plug valves scaled closed |
| G. HORIZONTAL 3-PHASE SEPARATOR | Q. TANK LEVEL GAUGES |
| H. MODULARITY 3-PHASE SEPARATOR | |
| I. WATER PUMP | |
| J. 30YR Circulating Pump | |

Wells Producing Into Battery:
Thomas AJJ #3
Roy AET #4
Warren ANW Federal #1

P 864 871 342



Certified Mail Receipt

No Insurance Coverage Provided
Do not use for International Mail
(See Reverse)

Sent to <i>Conoco, Inc.</i>	
Street & No. <i>P.O. Box 951063</i>	
P.O., State & ZIP Code <i>Dallas, TX 75395-1063</i>	
Postage <i>Hand Del.</i>	\$
Certified Fee	
Special Delivery Fee	
Restricted Delivery Fee	
Return Receipt Showing to Whom & Date Delivered	
Return Receipt Showing to Whom, Date, & Address of Delivery	
TOTAL Postage & Fees	\$
Postmark or Date <i>January 11, 1994</i> <i>Warren ANW #1</i>	

PS Form 3800, June 1990

Appropriate
Office
Case - 4 copies
Case - 3 copies

State of New Mexico
Energy, Minerals and Natural Resources Department

Form C-102
Revised 1-1-89

OIL CONSERVATION DIVISION

P.O. Box 2088
Santa Fe, New Mexico 87504-2088

DISTRICT I
P.O. Box 1980, Hobbs, NM 88240

DISTRICT II
P.O. Drawer DD, Artesia, NM 88210

DISTRICT III
1000 Rio Brazos Rd., Aztec, NM 87410

WELL LOCATION AND ACREAGE DEDICATION PLAT

All Distances must be from the outer boundaries of the section

Operator YATES PETROLEUM CORPORATION			Lease WARREN "ANW" FEDERAL		Well No. 1
Unit Letter L	Section 9	Township 19 SOUTH	Range 25 EAST	County EDDY COUNTY, NM	
Actual Footage Location of Well: 1980 feet from the SOUTH line and 660 feet from the WEST line					
Ground level Elev. 3528.	Producing Formation Cisco Canyon		Pool N. Dagger Draw Upper Penn	Dedicated Acreage: 160 Acres	

- Outline the acreage dedicated to the subject well by colored pencil or hachure marks on the plat below.
- If more than one lease is dedicated to the well, outline each and identify the ownership thereof (both as to working interest and royalty).
- If more than one lease of different ownership is dedicated to the well, have the interest of all owners been consolidated by communitization, unitization, force-pooling, etc.?
☐ Yes ☐ No If answer is "yes" type of consolidation _____
If answer is "no" list the owners and tract descriptions which have actually been consolidated. (Use reverse side of this form if necessary). _____
No allowable will be assigned to the well until all interests have been consolidated (by communitization, unitization, forced-pooling, or otherwise) or until a non-standard unit, eliminating such interest, has been approved by the Division.

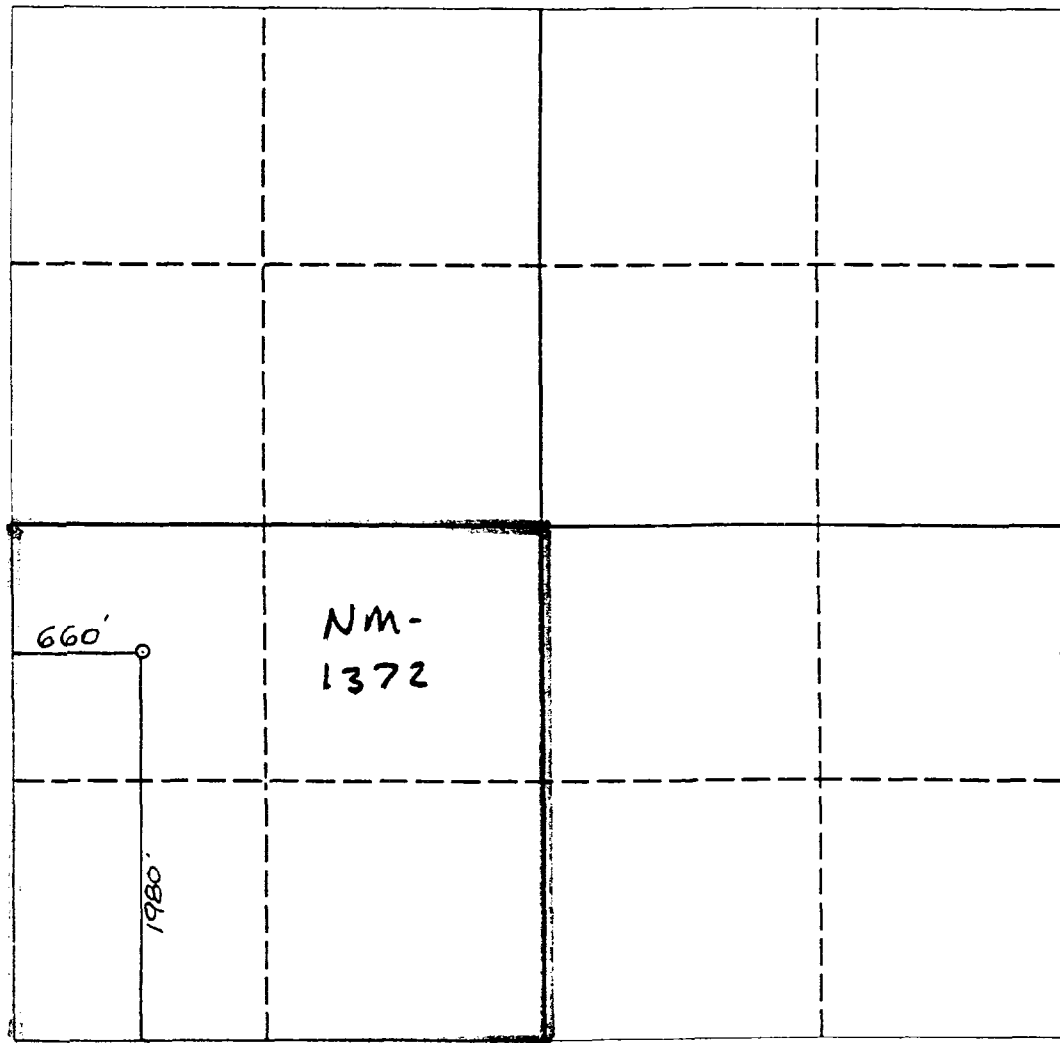

OPERATOR CERTIFICATION

I hereby certify that the information contained herein is true and complete to the best of my knowledge and belief.

Signature
Ken Bearden
Printed Name
Ken Bearden
Position
Landman
Company
Yates Pet. Corp.
Date
9-14-93

SURVEYOR CERTIFICATION

I hereby certify that the well location shown on this plat was plotted from field notes of actual surveys made by me or under my supervision, and that the same is true and correct to the best of my knowledge and belief.

Date Surveyed
SEPTEMBER 2, 1993
Signature & Seal of Professional Surveyor
Ken Bearden
Certificate No. **5412**
NEW MEXICO
REGISTERED PROFESSIONAL SURVEYOR
NM BEAPS NO. **5412**

0 330 660 990 1320 1650 1980 2310 2640 2000 1500 1000 500 0

Submit to Appropriate
District Office
State Lease - 4 copies
Fee Lease - 3 copies

State of New Mexico
Energy, Minerals and Natural Resources Department

Form C-102
Revised 1-1-89

OIL CONSERVATION DIVISION
P.O. Box 2088
Santa Fe, New Mexico 87504-2088

DISTRICT I
P.O. Box 1980, Hobbs, NM 88240

DISTRICT II
P.O. Drawer DD, Artesia, NM 88210

DISTRICT III
1000 Rio Brazos Rd., Aztec, NM 87410

WELL LOCATION AND ACREAGE DEDICATION PLAT
All Distances must be from the outer boundaries of the section

Operator YATES PETROLEUM CORPORATION			Lease THOMAS AJJ			Well No. 3		
Unit Letter J	Section 8	Township 19 SOUTH	Range 25 EAST		County EDDY COUNTY, N.M.			
Actual Footage Location of Well: 1980 feet from the SOUTH line and 1980 feet from the EAST line								
Ground level Elev. 3546.		Producing Formation Cisco Canyon		Pool N. Dagger Draw Upper Penn		Dedicated Acreage: 160 Acres		

- 1. Outline the acreage dedicated to the subject well by colored pencil or hachure marks on the plat below.
- 2. If more than one lease is dedicated to the well, outline each and identify the ownership thereof (both as to working interest and royalty).
- 3. If more than one lease of different ownership is dedicated to the well, have the interest of all owners been consolidated by communitization, unitization, force-pooling, etc?
☐ Yes ☐ No If answer is "yes" type of consolidation _____
If answer is "no" list the owners and tract descriptions which have actually been consolidated. (Use reverse side of this form if necessary).
No allowable will be assigned to the well until all interests have been consolidated (by communitization, unitization, forced-pooling, or otherwise) or until a non-standard unit, eliminating such interest, has been approved by the Division.

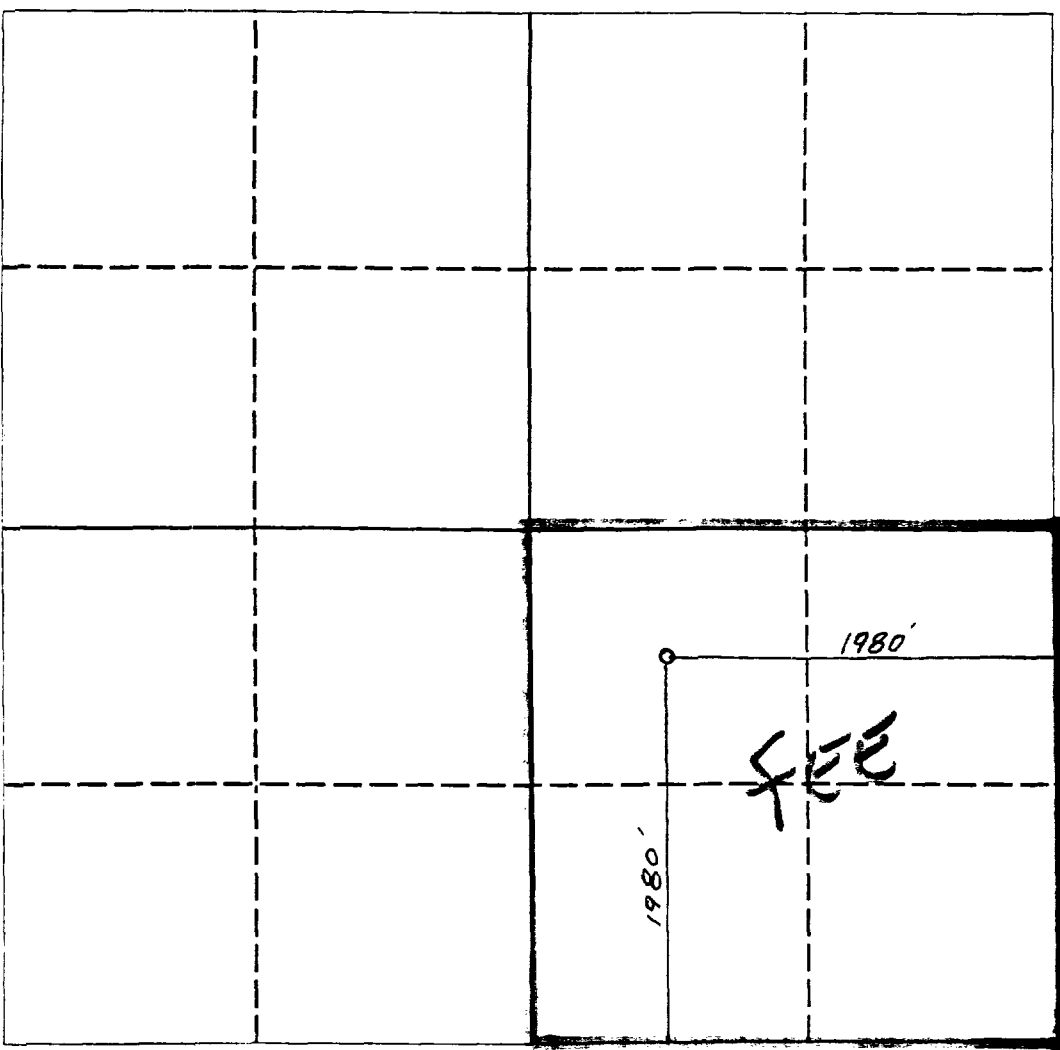

OPERATOR CERTIFICATION
I hereby certify that the information contained herein is true and complete to the best of my knowledge and belief.

Signature: *Ken Boardman*
Printed Name: **KEN BOARDMAN**
Position: **LANDMAN**
Company: **Yates Pet Corp.**
Date: **8-26-91**

SURVEYOR CERTIFICATION
I hereby certify that the well location shown on this plat was plotted from field notes of actual surveys made by me or under my supervision, and that the same is true and correct to the best of my knowledge and belief.

Date Surveyed: **AUGUST 22, 1991**
Signature & Seal of Professional Surveyor: *[Signature]*
Professional Surveyor Seal: **EDDY COUNTY NEW MEXICO 5412**
Certified by: **NO. 5412**
Professional Surveyor: **PROFESSIONAL SURVEYOR**

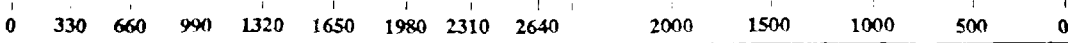

UNITED STATES
DEPARTMENT OF THE INTERIOR
BUREAU OF LAND MANAGEMENT

FORM APPROVED
Budget Bureau No. 1004-0135
Expires: March 31, 1993

SUNDRY NOTICES AND REPORTS ON WELLS

Do not use this form for proposals to drill or to deepen or reentry to a different reservoir.
Use "APPLICATION FOR PERMIT—" for such proposals

SUBMIT IN TRIPLICATE

Type of Well

☒ Oil Well ☐ Gas Well ☐ Other

Name of Operator

YATES PETROLEUM CORPORATION

(505) 748-1471

Address and Telephone No.

105 South 4th St., Artesia, NM 88210

Location of Well (Footage, Sec., T., R., M., or Survey Description)

1980' FSL & 660' FWL (Unit L) of Section 9-T19S-R25E

5. Lease Designation and Serial No.

NM-1372

6. If Indian, Allottee or Tribe Name

7. If Unit or CA, Agreement Designation

8. Well Name and No.

Warren ANW Federal #1

9. API Well No.

30-015-26748

10. Field and Pool, or Exploratory Area

North Dagger Draw Upper Penn

11. County or Parish, State

Eddy County, New Mexico

CHECK APPROPRIATE BOX(s) TO INDICATE NATURE OF NOTICE, REPORT, OR OTHER DATA

TYPE OF SUBMISSION

TYPE OF ACTION

- ☒ Notice of Intent
☐ Subsequent Report
☐ Final Abandonment Notice

- ☐ Abandonment
☐ Recompletion
☐ Plugging Back
☐ Casing Repair
☐ Altering Casing
☒ Other Off lease measurement, surface commingling & lease commingling

- ☐ Change of Plans
☐ New Construction
☐ Non-Routine Fracturing
☐ Water Shut-Off
☐ Conversion to Injection
☐ Dispose Water

(Note: Report results of multiple completion on Well Completion or Recompletion Report and Log form.)

Describe Proposed or Completed Operations (Clearly state all pertinent details, and give pertinent dates, including estimated date of starting any proposed work. If well is directionally drilled, give subsurface locations and measured and true vertical depths for all markers and zones pertinent to this work.)*

Please see attached form for surface commingling, off lease storage and measurement for the following wells:

Thomas AJJ #3, 1980' FSL & 1980' FEL (Unit J) of Section 8-T19S-R25E, Eddy County, New Mexico
Roy AET #4, 660' FSL & 1980' FEL (Unit O) of Section 8-T19S-R25E, Eddy County, New Mexico
Warren ANW Federal #1, 1980' FSL & 660' FWL (Unit L) of Section 9-T19S-R25E, Eddy County, NM

Battery location is at the Thomas AJJ #3.

See attached maps and facility diagram.

I hereby certify that the foregoing is true and correct

Signed Rusty Klien

Title Production Clerk

Date Jan. 6, 1994

(This space for Federal or State office use)

Approved by
Conditions of approval, if any:

Title

Date

18 U.S.C. Section 1001, makes it a crime for any person knowingly and willfully to make to any department or agency of the United States any false, fictitious or fraudulent statements or representations as to any matter within its jurisdiction.

*See Instruction on Reverse Side

P 083 921 307



**Receipt for
Certified Mail**

No Insurance Coverage Provided
Do not use for International Mail
(See Reverse)

Sent to <i>Marshall & Winston</i>	
Street and No. <i>P.O. Box 50880</i>	
P.O. State and ZIP Code <i>Midland, TX 79710-0880</i>	
Postage	\$
Certified Fee	
Special Delivery Fee	
Restricted Delivery Fee	
Return Receipt Showing to Whom & Date Delivered	
Return Receipt Showing to Whom, Date, and Addressee's Address	
TOTAL Postage & Fees	\$
Postmark or Date <i>January 11, 1993</i> <i>Warren ANW Jid #1</i>	

PS Form 3800, June 1991

P 083 921 308



**Receipt for
Certified Mail**

No Insurance Coverage Provided
Do not use for International Mail
(See Reverse)

Sent to <i>Bethianne Dunkle Bowen</i>	
Street and No. <i>1907 Quaker Lane</i>	
P.O. / State and ZIP Code <i>Whiteland, TX 79605</i>	
Postage	\$
Certified Fee	
Special Delivery Fee	
Restricted Delivery Fee	
Return Receipt Showing to Whom & Date Delivered	
Return Receipt Showing to Whom, Date, and Addressee's Address	
TOTAL Postage & Fees	\$
Postmark or Date <i>Jan. 11, 1994</i> <i>Warren ARW Jed #1</i>	

PS Form 3800, June 1991

P 083 921 309



**Receipt for
Certified Mail**

No Insurance Coverage Provided
Do not use for International Mail
(See Reverse)

Sent to <i>Stirling M. Carter</i>	
Street and No. <i>P.O. Box 97</i>	
P.O., State and ZIP Code <i>Winston, Nm 87943</i>	
Postage	\$
Certified Fee	
Special Delivery Fee	
Restricted Delivery Fee	
Return Receipt Showing to Whom & Date Delivered	
Return Receipt Showing to Whom, Date, and Addressee's Address	
TOTAL Postage & Fees	\$
Postmark or Date <i>January 11, 1994</i> <i>Warren ANW Jed #1</i>	

PS Form 3800, June 1991

P 083 921 310



**Receipt for
Certified Mail**

No Insurance Coverage Provided
Do not use for International Mail
(See Reverse)

Sent to <i>Michael Carter</i>	
Street and No <i>1021 Plaza Drive</i>	
City, State and ZIP Code <i>Granbury, TX 76048</i>	
Postage	\$
Certified Fee	
Special Delivery Fee	
Restricted Delivery Fee	
Return Receipt Showing to Whom & Date Delivered	
Return Receipt Showing to Whom, Date, and Addressee's Address	
TOTAL Postage & Fees	\$
Postmark or Date <i>January 11, 1994</i> <i>Warren ANW Sed #1</i>	

PS Form 3800, June 1991

P 083 921 311



**Receipt for
Certified Mail**

No Insurance Coverage Provided
Do not use for International Mail
(See Reverse)

Sent to <i>Canhase Properties Partnership</i>	
Street and No. <i>P.O. Box 1304</i>	
P.O., State and ZIP Code <i>Albama, NM 88210</i>	
Postage	\$
Certified Fee	
Special Delivery Fee	
Restricted Delivery Fee	
Return Receipt Showing to Whom & Date Delivered	
Return Receipt Showing to Whom, Date, and Addressee's Address	
TOTAL Postage & Fees	\$
Postmark or Date <i>January 11, 1994</i> <i>Warren ANW Jed #1</i>	

PS Form 3800, June 1991

P 083 921 312



**Receipt for
Certified Mail**

No Insurance Coverage Provided
Do not use for International Mail
(See Reverse)

Sent to	
James W. Childress	
Street and No.	
P.O. Box 209	
P.O., State and ZIP Code	
Roswell, NM 88201	
Postage	\$
Certified Fee	
Special Delivery Fee	
Restricted Delivery Fee	
Return Receipt Showing to Whom & Date Delivered	
Return Receipt Showing to Whom, Date, and Addressee's Address	
TOTAL Postage & Fees	\$
Postmark or Date	
January 11, 1993	
Warren AAW Jcd #1	

PS Form 3800, June 1991

P 083 921 313



**Receipt for
Certified Mail**

No Insurance Coverage Provided
Do not use for International Mail
(See Reverse)

Sent to •	
Shirley Chilavess	
Street and No.	
604 N. Delaware # 2	
P.O., State and ZIP Code	
Roswell, NM 88201-2135	
Postage	\$
Certified Fee	
Special Delivery Fee	
Restricted Delivery Fee	
Return Receipt Showing to Whom & Date Delivered	
Return Receipt Showing to Whom, Date, and Addressee's Address	
TOTAL Postage & Fees	\$
Postmark or Date	
January 11, 1994	
Warren ANW Fed #1	

PS Form 3800, June 1991

P 083 921 314



**Receipt for
Certified Mail**

No Insurance Coverage Provided
Do not use for International Mail
(See Reverse)

Sent to <i>Alfred Joy Curry, IV</i>	
Street and No. <i>1016 Alta Loma Circle</i>	
P.O., State and ZIP Code <i>San Angelo, TX 76901</i>	
Postage	\$
Certified Fee	
Special Delivery Fee	
Restricted Delivery Fee	
Return Receipt Showing to Whom & Date Delivered	
Return Receipt Showing to Whom, Date, and Addressee's Address	
TOTAL Postage & Fees	\$
Postmark or Date <i>January 11, 1994</i> <i>Warren ANW Fed #1</i>	

PS Form 3800, June 1991

P 083 921 315



**Receipt for
Certified Mail**

No Insurance Coverage Provided
Do not use for International Mail
(See Reverse)

Sent to <i>Lynn E. Desper</i>	
Street and No. <i>4601 Montana NW, Apt. 7</i>	
City, State and ZIP Code <i>Albuquerque, NM 87120</i>	
Postage	\$
Certified Fee	
Special Delivery Fee	
Restricted Delivery Fee	
Return Receipt Showing to Whom & Date Delivered	
Return Receipt Showing to Whom, Date, and Addressee's Address	
TOTAL Postage & Fees	\$
Postmark or Date <i>January 11, 1994</i> <i>Warren ANW Jed #1</i>	

PS Form 3800, June 1991

P 083 921 316



**Receipt for
Certified Mail**

No Insurance Coverage Provided
Do not use for International Mail
(See Reverse)

Sent to <i>Sally A. Ellis</i>	
Street and No. <i>771 Crescent Drive</i>	
P.O., State and ZIP Code <i>Boulder, CO 80303</i>	
Postage	\$
Certified Fee	
Special Delivery Fee	
Restricted Delivery Fee	
Return Receipt Showing to Whom & Date Delivered	
Return Receipt Showing to Whom, Date, and Addressee's Address	
TOTAL Postage & Fees	\$
Postmark or Date <i>January 11, 1994</i> <i>Warren ANW Fed #1</i>	

PS Form 3800, June 1991

P 083 921 317



**Receipt for
Certified Mail**

No Insurance Coverage Provided
Do not use for International Mail
(See Reverse)

Sender's Name <i>Jessie Marie Gallivan</i>	
Street and No. <i>W. N. Carlshad #0596099</i>	
P.O. Box <i>Box 1689</i>	
City, State and ZIP Code <i>Carlshad, NM 88221-1689</i>	
Postage	\$
Certified Fee	
Special Delivery Fee	
Restricted Delivery Fee	
Return Receipt Showing to Whom & Date Delivered	
Return Receipt Showing to Whom, Date, and Addressee's Address	
TOTAL Postage & Fees	\$
Postmark or Date <i>January 11, 1994</i>	
<i>Warren ANW Jdd #1</i>	

PS Form 3800, June 1991

P 083 921 318



**Receipt for
Certified Mail**

No Insurance Coverage Provided
Do not use for International Mail
(See Reverse)

Sent to <i>Mary Ann Milner Glass</i>	
Street and No. <i>517 Sp. Adams St.</i>	
P.O., State and ZIP Code <i>San Angelo, TX 76901-4501</i>	
Postage	\$
Certified Fee	
Special Delivery Fee	
Restricted Delivery Fee	
Return Receipt Showing to Whom & Date Delivered	
Return Receipt Showing to Whom, Date, and Addressee's Address	
TOTAL Postage & Fees	\$
Postmark or Date <i>January 11, 1994</i> <i>Warren ANW Fed #1</i>	

PS Form 3800, June 1991

P 083 921 319



**Receipt for
Certified Mail**

No Insurance Coverage Provided
Do not use for International Mail
(See Reverse)

Sent to <i>Annabel Harris</i>	
Street and No. <i>1519 Vineyard Lane</i>	
P.O., State, and ZIP Code <i>Carlsbad, NM 88220</i>	
Postage	\$
Certified Fee	
Special Delivery Fee	
Restricted Delivery Fee	
Return Receipt Showing to Whom & Date Delivered	
Return Receipt Showing to Whom, Date, and Addressee's Address	
TOTAL Postage & Fees	\$
Postmark or Date <i>January 11, 1994</i> <i>Warren Awarded #1</i>	

PS Form 3800, June 1991

P 083 921 320



**Receipt for
Certified Mail**

No Insurance Coverage Provided
Do not use for International Mail
(See Reverse)

Sent to <i>R.R. Dinkle Company</i>	
Street and No. <i>P.O. Box 59</i>	
P.O., State and ZIP Code <i>Roswell, NM 88202-0059</i>	
Postage	\$
Certified Fee	
Special Delivery Fee	
Restricted Delivery Fee	
Return Receipt Showing to Whom & Date Delivered	
Return Receipt Showing to Whom, Date, and Addressee's Address	
TOTAL Postage & Fees	\$
Postmark or Date <i>January 11, 1994</i> <i>Warren ANW Jed #1</i>	

PS Form 3800, June 1991

P 083 921 321



**Receipt for
Certified Mail**

No Insurance Coverage Provided
Do not use for International Mail
(See Reverse)

Sent to	
John T. Hinkle	
Street and No.	
P.O. Box 1793	
R.F.D., State and ZIP Code	
Roswell, NM 88201	
Postage	\$
Certified Fee	
Special Delivery Fee	
Restricted Delivery Fee	
Return Receipt Showing to Whom & Date Delivered	
Return Receipt Showing to Whom, Date, and Addressee's Address	
TOTAL Postage & Fees	\$
Postmark or Date	
January 11, 1994	
Warren ANW Jed #1	

PS Form 3800, June 1991

P 083 921 322



**Receipt for
Certified Mail**

No Insurance Coverage Provided
Do not use for International Mail
(See Reverse)

Sent to <i>Cynthia Lacker, Trustee</i>	
Street or P.O. Box <i>Post Office & General Delivery</i>	
City, State and ZIP Code <i>Route 3, Box 519</i> <i>Carmel, CA 93923</i>	
Postage	\$
Certified Fee	
Special Delivery Fee	
Restricted Delivery Fee	
Return Receipt Showing to Whom & Date Delivered	
Return Receipt Showing to Whom, Date, and Addressee's Address	
TOTAL Postage & Fees	\$
Postmark or Date <i>January 11, 1994</i> <i>Warren ANW Fed #1</i>	

PS Form 3800, June 1991

P 083 921 323



**Receipt for
Certified Mail**

No Insurance Coverage Provided
Do not use for International Mail
(See Reverse)

Sent to	
Charles E. Hentle	
Street and No.	
Bonnet Route, Box 4	
R.C., State and ZIP Code	
King City, CA 93930	
Postage	\$
Certified Fee	
Special Delivery Fee	
Restricted Delivery Fee	
Return Receipt Showing to Whom & Date Delivered	
Return Receipt Showing to Whom, Date, and Addressee's Address	
TOTAL Postage & Fees	\$
Postmark or Date	
January 11, 1994	
Warren ANW Fed #1	

PS Form 3800, June 1991

P 083 921 324



**Receipt for
Certified Mail**

No Insurance Coverage Provided
Do not use for International Mail
(See Reverse)

Sent to <i>William T. Hinkle</i>	
Street and No. <i>P.O. Box 2002</i>	
P.O., State and ZIP Code <i>Roswell, NM 88201</i>	
Postage	\$
Certified Fee	
Special Delivery Fee	
Restricted Delivery Fee	
Return Receipt Showing to Whom & Date Delivered	
Return Receipt Showing to Whom, Date, and Addressee's Address	
TOTAL Postage & Fees	\$
Postmark or Date <i>January 11, 1994</i> <i>Warren ANW JED #1</i>	

PS Form 3800, June 1991

P 083 921 325



**Receipt for
Certified Mail**

No Insurance Coverage Provided
Do not use for International Mail
(See Reverse)

Sent to <i>James Ruste Hinkle</i>	
Street and No. <i>P.O. Box 2002</i>	
City, State and ZIP Code <i>Roswell, NM 88202</i>	
Postage	\$
Certified Fee	
Special Delivery Fee	
Restricted Delivery Fee	
Return Receipt Showing to Whom & Date Delivered	
Return Receipt Showing to Whom, Date, and Addressee's Address	
TOTAL Postage & Fees	\$
Postmark or Date <i>January 11, 1994</i> <i>Warren AWA Fed #1</i>	

PS Form 3800, June 1991

P 083 921 326



**Receipt for
Certified Mail**

No Insurance Coverage Provided
Do not use for International Mail
(See Reverse)

Send to	
Richard M. Howell	
Street and No.	
Box 94	
P.O. State and ZIP Code	
Palewood, Nm 88254	
Postage	\$
Certified Fee	
Special Delivery Fee	
Restricted Delivery Fee	
Return Receipt Showing to Whom & Date Delivered	
Return Receipt Showing to Whom, Date, and Addressee's Address	
TOTAL Postage & Fees	\$
Postmark or Date	
January 11, 1994	
Warren AWW Jed #1	

PS Form 3800, June 1991

P 083 921 327



**Receipt for
Certified Mail**

No Insurance Coverage Provided
Do not use for International Mail
(See Reverse)

Sent to	
Howard E Betty Howard	
Street and No.	
Box 75	
(P.O.) State and ZIP Code	
Halewood, Nm 88254	
Postage	\$
Certified Fee	
Special Delivery Fee	
Restricted Delivery Fee	
Return Receipt Showing to Whom & Date Delivered	
Return Receipt Showing to Whom, Date, and Addressee's Address	
TOTAL Postage & Fees	\$
Postmark or Date	
January 11, 1994	
Warren AWW Jed #1	

PS Form 3800, June 1991

P 083 921 328



**Receipt for
Certified Mail**

No Insurance Coverage Provided
Do not use for International Mail
(See Reverse)

Sent to <i>Hugh M. Kincaid</i>	
Postnet and No. <i>Indistinct for L. Swope Indistinct</i>	
Post Office, State and ZIP Code <i>Queen Route</i>	
<i>Carlsbad, NM 88220</i>	
Postage	\$
Certified Fee	
Special Delivery Fee	
Restricted Delivery Fee	
Return Receipt Showing to Whom & Date Delivered	
Return Receipt Showing to Whom, Date, and Addressee's Address	
TOTAL Postage & Fees	\$
Postmark or Date <i>January 11, 1994</i>	
<i>Warren ANW Jed #1</i>	

PS Form 3800, June 1991

P 083 921 329



**Receipt for
Certified Mail**

No Insurance Coverage Provided
Do not use for International Mail
(See Reverse)

Sent to	
Hugh M. Kincaid	
Street and No.	
Sullen Route	
City, State, and ZIP Code	
Carlsbad, Nm 88220	
Postage	\$
Certified Fee	
Special Delivery Fee	
Restricted Delivery Fee	
Return Receipt Showing to Whom & Date Delivered	
Return Receipt Showing to Whom, Date, and Addressee's Address	
TOTAL Postage & Fees	\$
Postmark or Date	
January 11, 1994	
Warren ANW Jnd#	

PS Form 3800, June 1991

P 083 921 330



**Receipt for
Certified Mail**

No Insurance Coverage Provided
Do not use for International Mail
(See Reverse)

Sent to <i>Jefferson M. Langford</i>	
Street and No. <i>P.O. Box 22205</i>	
City, State and ZIP Code <i>Albuquerque, NM 87502</i>	
Postage	\$
Certified Fee	
Special Delivery Fee	
Restricted Delivery Fee	
Return Receipt Showing to Whom & Date Delivered	
Return Receipt Showing to Whom, Date, and Addressee's Address	
TOTAL Postage & Fees	\$
Postmark or Date <i>January 11, 1994</i> <i>Warren ANW Fed #1</i>	

PS Form 3800, June 1991

P 083 921 331



**Receipt for
Certified Mail**

No Insurance Coverage Provided
Do not use for International Mail
(See Reverse)

Sent to <i>Hou Ann Langford</i>	
Street and No. <i>404 E. 55th St.</i>	
City, State and ZIP Code <i>New York, NY 10022-5137</i>	
Postage	\$
Certified Fee	
Special Delivery Fee	
Restricted Delivery Fee	
Return Receipt Showing to Whom & Date Delivered	
Return Receipt Showing to Whom, Date, and Addressee's Address	
TOTAL Postage & Fees	\$
Postmark or Date <i>January 11, 1994</i> <i>Warren ANW Jed #1</i>	

PS Form 3800, June 1991

P 083 921 332



**Receipt for
Certified Mail**

No Insurance Coverage Provided
Do not use for International Mail
(See Reverse)

Sent to	
Robert Glass Langford	
Street and No.	
Route 3, Box 40	
City, State and ZIP Code	
Rockhart, TX 78644	
Postage	\$
Certified Fee	
Special Delivery Fee	
Restricted Delivery Fee	
Return Receipt Showing to Whom & Date Delivered	
Return Receipt Showing to Whom, Date, and Addressee's Address	
TOTAL Postage & Fees	\$
Postmark or Date	
January 11, 1994	
Warren ANW Jed #1	

PS Form 3800, June 1991

P 083 921 333



**Receipt for
Certified Mail**

No Insurance Coverage Provided
Do not use for International Mail
(See Reverse)

Sent to <i>Richard H. Landsheff, Jr.</i>	
Street and No. <i>2313 Cim Dent</i>	
City, State and ZIP Code <i>El Paso, TX 79936</i>	
Postage	\$
Certified Fee	
Special Delivery Fee	
Restricted Delivery Fee	
Return Receipt Showing to Whom & Date Delivered	
Return Receipt Showing to Whom, Date, and Addressee's Address	
TOTAL Postage & Fees	\$
Postmark or Date <i>January 11, 1993</i> <i>Warren ANW Fed #1</i>	

PS Form 3800, June 1991

P 083 921 334



**Receipt for
Certified Mail**

No Insurance Coverage Provided
Do not use for International Mail
(See Reverse)

Sent to <i>William Brian Hendricks</i>	
Postage and Fee <i>15880 S. Peoria</i>	
City, State and ZIP Code <i>Butte, OK 74008</i>	
Postage	\$
Certified Fee	
Special Delivery Fee	
Restricted Delivery Fee	
Return Receipt Showing to Whom & Date Delivered	
Return Receipt Showing to Whom, Date, and Addressee's Address	
TOTAL Postage & Fees	\$
Postmark or Date <i>January 11, 1994</i> <i>Warren ANW Fed #1</i>	

PS Form 3800, June 1991

P 083 921 335



**Receipt for
Certified Mail**

No Insurance Coverage Provided
Do not use for International Mail
(See Reverse)

Send to	
Charles Y. Marshall	
Street and No.	
P.O. Box 1712	
P.O., State and ZIP Code	
Roswell, Nm 88202-1712	
Postage	\$
Certified Fee	
Special Delivery Fee	
Restricted Delivery Fee	
Return Receipt Showing to Whom & Date Delivered	
Return Receipt Showing to Whom, Date, and Addressee's Address	
TOTAL Postage & Fees	\$
Postmark or Date	
January 11, 1993	
A Warren ANW Jcd #1	

PS Form 3800, June 1991

P 083 921 336



**Receipt for
Certified Mail**

No Insurance Coverage Provided
Do not use for International Mail
(See Reverse)

Sent to	
McQuiddy Comm & Energy Inc.	
Street and No.	
P.O. Box 2072	
City, State and ZIP Code	
Roswell, NM 88201	
Postage	\$
Certified Fee	
Special Delivery Fee	
Restricted Delivery Fee	
Return Receipt Showing to Whom & Date Delivered	
Return Receipt Showing to Whom, Date, and Addressee's Address	
TOTAL Postage & Fees	\$
Postmark or Date	
January 11, 1994	
Warren ANW Jed #1	

PS Form 3800, June 1991

P 083 921 337



**Receipt for
Certified Mail**

No Insurance Coverage Provided
Do not use for International Mail
(See Reverse)

Sent to <i>Don Phillips & Assoc.</i>	
Care of <i>Donald W. Newton</i>	
<i>1416 Meeting House Lane</i>	
R.O., State and ZIP Code <i>Knoxville, TN 37931</i>	
Postage	\$
Certified Fee	
Special Delivery Fee	
Restricted Delivery Fee	
Return Receipt Showing to Whom & Date Delivered	
Return Receipt Showing to Whom, Date, and Addressee's Address	
TOTAL Postage & Fees	\$
Postmark or Date <i>January 11, 1994</i> <i>Warren ADW Jed #1</i>	

PS Form 3800, June 1991

P 083 921 338



**Receipt for
Certified Mail**

No Insurance Coverage Provided
Do not use for International Mail
(See Reverse)

Sent to <i>Quebec Superior Foundation</i>	
Street and No. <i>220 S. 6th Street</i>	
City, State and ZIP Code <i>Minneapolis, MN 55402-1498</i>	
Postage	\$
Certified Fee	
Special Delivery Fee	
Restricted Delivery Fee	
Return Receipt Showing to Whom & Date Delivered	
Return Receipt Showing to Whom, Date, and Addressee's Address	
TOTAL Postage & Fees	\$
Postmark or Date <i>January 11, 1994</i> <i>Warren ANW Jed #1</i>	

PS Form 3800, June 1991

P 083 921 339



**Receipt for
Certified Mail**

No Insurance Coverage Provided
Do not use for International Mail
(See Reverse)

Sent to <i>Cayle Glass Roche</i>	
Street and No. <i>P.O. Box 50248</i>	
P.O., State and ZIP Code <i>Austin, TX 78763</i>	
Postage	\$
Certified Fee	
Special Delivery Fee	
Restricted Delivery Fee	
Return Receipt Showing to Whom & Date Delivered	
Return Receipt Showing to Whom, Date, and Addressee's Address	
TOTAL Postage & Fees	\$
Postmark or Date <i>January 11, 1994</i> <i>Warren ANWJed #1</i>	

PS Form 3800, June 1991

P 083 921 340



**Receipt for
Certified Mail**

No Insurance Coverage Provided
Do not use for International Mail
(See Reverse)

Sent to <i>Allison Claire Saunders</i>	
Street and No. <i>P.O. Box 27391</i>	
P.O., State and ZIP Code <i>Austin, TX 78755 2391</i>	
Postage	\$
Certified Fee	
Special Delivery Fee	
Restricted Delivery Fee	
Return Receipt Showing to Whom & Date Delivered	
Return Receipt Showing to Whom, Date, and Addressee's Address	
TOTAL Postage & Fees	\$
Postmark or Date <i>January 11, 1994</i> <i>Warren ANW Fed #1</i>	

PS Form 3800, June 1991

P 083 921 341



**Receipt for
Certified Mail**

No Insurance Coverage Provided
Do not use for International Mail
(See Reverse)

Sent to <i>Helma Schaefer</i>	
Street and No. <i>906 Hermosa</i>	
P.O., State and ZIP Code <i>Altesia, NM 88210</i>	
Postage	\$
Certified Fee	
Special Delivery Fee	
Restricted Delivery Fee	
Return Receipt Showing to Whom & Date Delivered	
Return Receipt Showing to Whom, Date, and Addressee's Address	
TOTAL Postage & Fees	\$
Postmark or Date <i>January 11, 1994</i> <i>Warren ANW Fed #1</i>	

PS Form 3800, June 1991

P 083 921 342



**Receipt for
Certified Mail**

No Insurance Coverage Provided
Do not use for International Mail
(See Reverse)

Sent to <i>Henna Carter Scott</i>	
Street and No. <i>Route 3, Box 329</i>	
P.O., State and ZIP Code <i>Big Spring, TX 79720</i>	
Postage	\$
Certified Fee	
Special Delivery Fee	
Restricted Delivery Fee	
Return Receipt Showing to Whom & Date Delivered	
Return Receipt Showing to Whom, Date, and Addressee's Address	
TOTAL Postage & Fees	\$
Postmark or Date <i>January 11, 1994</i> <i>Warren ANW Fed #1</i>	

PS Form 3800, June 1991

P 083 921 343



**Receipt for
Certified Mail**

No Insurance Coverage Provided
Do not use for International Mail
(See Reverse)

Sent to	
Marilyn Glass Taylor	
Street and No.	
517 So Adams Street	
P.O., State and ZIP Code	
San Angelo, TX 76901	
Postage	\$
Certified Fee	
Special Delivery Fee	
Restricted Delivery Fee	
Return Receipt Showing to Whom & Date Delivered	
Return Receipt Showing to Whom, Date, and Addressee's Address	
TOTAL Postage & Fees	\$
Postmark or Date	
January 11, 1994	
Warren ANW Jed #1	

PS Form 3800, June 1991

P 083 921 344



**Receipt for
Certified Mail**

No Insurance Coverage Provided
Do not use for International Mail
(See Reverse)

Sent to <i>Ray Neil Thomas</i>	
Street and No. <i>704 W. Riverside Drive</i>	
P.O., State and ZIP Code <i>Carlsbad, NM 88220</i>	
Postage	\$
Certified Fee	
Special Delivery Fee	
Restricted Delivery Fee	
Return Receipt Showing to Whom & Date Delivered	
Return Receipt Showing to Whom, Date, and Addressee's Address	
TOTAL Postage & Fees	\$
Postmark or Date <i>January 11, 1994</i> <i>Warren ANW 2ed #1</i>	

PS Form 3800, June 1991

P 083 921 345



**Receipt for
Certified Mail**

No Insurance Coverage Provided
Do not use for International Mail
(See Reverse)

Sent to <i>Gaye Turner</i>	
Street and No. <i>1211 Marshall Lane</i>	
P.O., State, and ZIP Code <i>Austin, TX 78703</i>	
Postage	\$
Certified Fee	
Special Delivery Fee	
Restricted Delivery Fee	
Return Receipt Showing to Whom & Date Delivered	
Return Receipt Showing to Whom, Date, and Addressee's Address	
TOTAL Postage & Fees	\$
Postmark or Date <i>January 11, 1994</i> <i>Warren ANW Fed #1</i>	

PS Form 3800, June 1991

P 083 921 346



**Receipt for
Certified Mail**

No Insurance Coverage Provided
Do not use for International Mail
(See Reverse)

Brooks Family OEG Mgt Trust 2008
Nations Bank of Texas, Trustee

Sheet and No.
P.O. Box 2546
P.O., State and ZIP Code
St. Worth, TX 76132-546

Postage	\$
Certified Fee	
Special Delivery Fee	
Restricted Delivery Fee	
Return Receipt Showing to Whom & Date Delivered	
Return Receipt Showing to Whom, Date, and Addressee's Address	
TOTAL Postage & Fees	\$

Postmark or Date
January 11, 1994
Warren ANW Fed #1

PS Form 3800, June 1991

P 083 921 347



**Receipt for
Certified Mail**

No Insurance Coverage Provided
Do not use for International Mail
(See Reverse)

Sent to <i>Charles H. Coll</i>	
Street and No. <i>P.O. Box 1818</i>	
P.O., State and ZIP Code <i>Roswell, Nm 88202-1818</i>	
Postage	\$
Certified Fee	
Special Delivery Fee	
Restricted Delivery Fee	
Return Receipt Showing to Whom & Date Delivered	
Return Receipt Showing to Whom, Date, and Addressee's Address	
TOTAL Postage & Fees	\$
Postmark or Date <i>January 11, 1994</i> <i>Warren ANW Fed #1</i>	

PS Form 3800, June 1991

P 083 921 348



**Receipt for
Certified Mail**

No Insurance Coverage Provided
Do not use for International Mail
(See Reverse)

Sent to <i>James N. Coel</i>	
Street and No. <i>P.O. Box 1818</i>	
P.O., State and ZIP Code <i>Reswell, NM 88222-1818</i>	
Postage	\$
Certified Fee	
Special Delivery Fee	
Restricted Delivery Fee	
Return Receipt Showing to Whom & Date Delivered	
Return Receipt Showing to Whom, Date, and Addressee's Address	
TOTAL Postage & Fees	\$
Postmark or Date <i>January 11, 1994</i> <i>Warren ANW Jed #1</i>	

PS Form 3800, June 1991

P 083 921 349



**Receipt for
Certified Mail**

No Insurance Coverage Provided
Do not use for International Mail
(See Reverse)

Sent to <i>Don F. Cell</i>	
Street and No. <i>P.O. Box 1818</i>	
City, State and ZIP Code <i>Roswell, NM 88202-1818</i>	
Postage	\$
Certified Fee	
Special Delivery Fee	
Restricted Delivery Fee	
Return Receipt Showing to Whom & Date Delivered	
Return Receipt Showing to Whom, Date, and Addressee's Address	
TOTAL Postage & Fees	\$
Postmark or Date <i>January 11, 1994</i> <i>Warren ARW Jed #1</i>	

PS Form 3800, June 1991

P 083 921 350



**Receipt for
Certified Mail**

No Insurance Coverage Provided
Do not use for International Mail
(See Reverse)

Sent to	
Barbara Josten, S.E.S. prop.	
Street and No.	
303 W. Wall Suite 1900	
P.O., State and ZIP Code	
Midland, TX 79701-5116	
Postage	\$
Certified Fee	
Special Delivery Fee	
Restricted Delivery Fee	
Return Receipt Showing to Whom & Date Delivered	
Return Receipt Showing to Whom, Date, and Addressee's Address	
TOTAL Postage & Fees	\$
Postmark or Date	
January 11, 1994	
Warren ANSWER #1	

PS Form 3800, June 1991

P 083 921 351



**Receipt for
Certified Mail**

No Insurance Coverage Provided
Do not use for International Mail
(See Reverse)

Sent to	
L. C. Johnston	
Street, Apt. No.	
300 Renaissance Tower	
201 Elm Street	
City, State and ZIP Code	
Dallas, TX 75220	
Postage	\$
Certified Fee	
Special Delivery Fee	
Restricted Delivery Fee	
Return Receipt Showing to Whom & Date Delivered	
Return Receipt Showing to Whom, Date, and Addressee's Address	
TOTAL Postage & Fees	\$
Postmark or Date	
January 11, 1998	
Warren A.W. Jod #1	

PS Form 3800, June 1991

P 083 921 352



**Receipt for
Certified Mail**

No Insurance Coverage Provided
Do not use for International Mail
(See Reverse)

Sent to	
Buerett R. Sharp	
Street and No.	
7042 Turtle Creek Lane	
City, State and ZIP Code	
Dallas, TX 75205-1263	
Postage	\$
Certified Fee	
Special Delivery Fee	
Restricted Delivery Fee	
Return Receipt Showing to Whom & Date Delivered	
Return Receipt Showing to Whom, Date, and Addressee's Address	
TOTAL Postage & Fees	\$
Postmark or Date	
January 11, 1994	
Warren ANW Sed #1	

PS Form 3800, June 1991

P 083 921 353



**Receipt for
Certified Mail**

No Insurance Coverage Provided
Do not use for International Mail
(See Reverse)

Sent by <i>T.J. Sullivan</i>	
To <i>C/O Southwest Bank of Albuquerque</i>	
Street or Post Office Box <i>Post Office Box 26900</i>	
City, State and ZIP Code <i>Albuquerque, NM 87225-6900</i>	
Postage	\$
Certified Fee	
Special Delivery Fee	
Restricted Delivery Fee	
Return Receipt Showing to Whom & Date Delivered	
Return Receipt Showing to Whom, Date, and Addressee's Address	
TOTAL Postage & Fees	\$
Postmark or Date <i>January 11, 1994</i>	
<i>Warren AWW Ted #1</i>	

PS Form 3800, June 1991