

dugan production corp.

January 4, 2002

FILED-PLC-173

JAN - 7 2002

Mr. David Catanach
New Mexico Oil Conservation Division
1220 South St. Francis Drive
Santa Fe, NM 87505

Mr. Pete Martinez
New Mexico State Land Office
P.O. Box 1148
Santa Fe, NM 87504-1148

Mr. Jim Lovato
Bureau of Land Management - Farmington Field Office
1235 La Plata Highway
Farmington, NM 87401

Re: Revised Gathering System Map
Dugan Production Corp.'s
Tabor Gas Gathering System (Com 1E CDP @ NENE 2, T-29N, R-14W)
San Juan County, New Mexico

Dear Mr. Catanach, Mr. Lovato, and Mr. Martinez,

Attached for your information and file is a revised copy of the map for Dugan's Tabor Gas Gathering System. This map was presented as Attachment No. 1 in our 10/31/01 application to consolidate the King and Tabor Gas Gathering Systems and also as Attachment No. 1 in our 8/14/01 application to add nine wells to the Tabor Gas Gathering System.

The revised map presents a change in the location of the gas line connecting Dugan's Beyond Petroleum Com No. 90 (API No. 30-045-30769, located in the NWSW (Unit L) of Section 26, T-30N, R-14W) to the gathering system. Initially, it was planned to install the line to the south and connect with the Tabor Gathering System near Dugan's Jiggs #1 well in the SWNW of Section 35, T-30N, R-14W. We currently plan to install the gas line to the north and connect to the Tabor Gas Gathering System in the NENW of Section 26, T-30N, R14W near Dugan's Jacobs #3 well. I've highlighted the new line section in blue. There are no other changes to the map.

Should you have any questions, please let me know.

Sincerely,

John D. Roe
Engineering Manager

JDR:sh

cc: NMOCD - Aztec

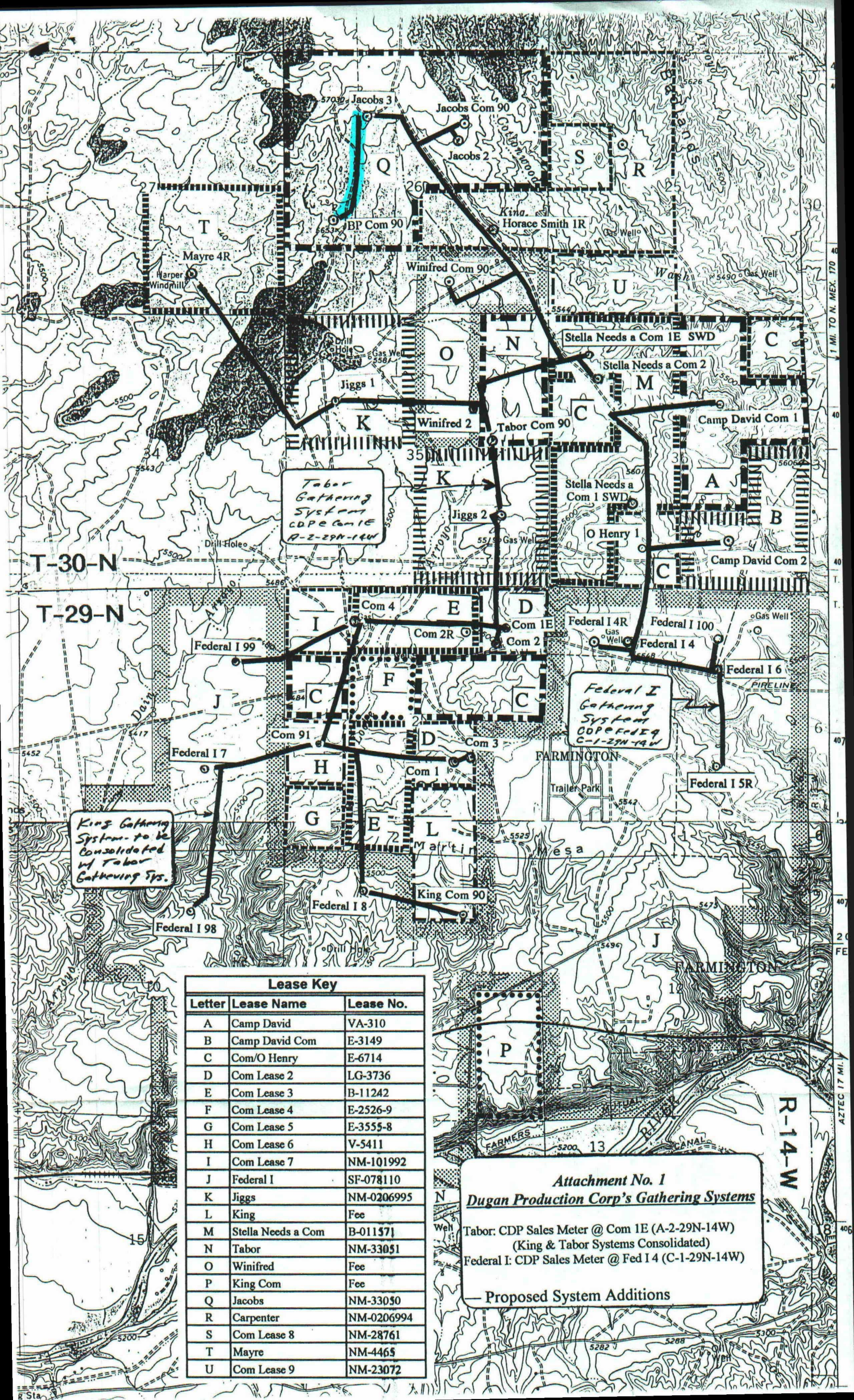

Tabor
Gathering
System
CDPE Com 1E
A-2-29N-14W

Federal I
Gathering
System
CDPE Fed I 4
C-1-29N-14W

King Gathering
System - to be
Consolidated
w/ Tabor
Gathering Sys.

Lease Key		
Letter	Lease Name	Lease No.
A	Camp David	VA-310
B	Camp David Com	E-3149
C	Com/O Henry	E-6714
D	Com Lease 2	LG-3736
E	Com Lease 3	B-11242
F	Com Lease 4	E-2526-9
G	Com Lease 5	E-3555-8
H	Com Lease 6	V-5411
I	Com Lease 7	NM-101992
J	Federal I	SF-078110
K	Jiggs	NM-0206995
L	King	Fee
M	Stella Needs a Com	B-011571
N	Tabor	NM-33051
O	Winifred	Fee
P	King Com	Fee
Q	Jacobs	NM-33050
R	Carpenter	NM-0206994
S	Com Lease 8	NM-28761
T	Mayre	NM-4465
U	Com Lease 9	NM-23072

Attachment No. 1
Dugan Production Corp's Gathering Systems

Tabor: CDP Sales Meter @ Com 1E (A-2-29N-14W)
(King & Tabor Systems Consolidated)
Federal I: CDP Sales Meter @ Fed I 4 (C-1-29N-14W)

— Proposed System Additions