

**OIL CONSERVATION COMMISSION**

P. O. BOX 2088

SANTA FE, NEW MEXICO 87501

March 5, 1968

**Midwest Oil Corporation  
1500 Wilco Building  
Midland, Texas**

**Attention: Mr. W. E. Wittenburg**

**Administrative Order OLS-60**

**Gentlemen:**

Reference is made to your recent application for an exception to Rule 309-A of the Commission Rules and Regulations to permit off-lease storage for your New Mexico "L" State Lease which comprises the W/2 of Section 2, Township 10 South, Range 33 East, Middle Lane Fermo Pennsylvanian Pool, Lea County, New Mexico. It is our understanding that the tank battery for this lease would be located in Unit 0 of Section 2 on your State "K" Lease.

Pursuant to the authority granted me by Rule 309-C of the Commission Rules and Regulations, Midwest Oil Corporation is hereby authorized off-lease storage as described above, provided that there shall be no inter-communication of the handling, separating, treating, or storage facilities designated to each lease.

Very truly yours,

**A. L. PORTER, Jr.  
Secretary-Director**

**ALP/DSH/esr**

**cc: Oil Conservation Commission (with enclosure) - Hobbs  
Oil & Gas Engineering Committee - Hobbs  
State Land Office - Santa Fe**

OIL CONSERVATION COMMISSION  
P. O. BOX 2088  
SANTA FE, NEW MEXICO 87501

Dear Sir,

Enclosed for the Commission  
are two copies of the  
report of the

Commission on the

Conservation of

Oil

Enclosed is also a copy of the report of the  
Commission on the Conservation of  
Oil. The report of the Commission  
on the Conservation of Oil is  
a report of the Commission on the  
Conservation of Oil. The report of the  
Commission on the Conservation of  
Oil is a report of the Commission  
on the Conservation of Oil. The  
report of the Commission on the  
Conservation of Oil is a report of  
the Commission on the Conservation  
of Oil. The report of the  
Commission on the Conservation of  
Oil is a report of the Commission  
on the Conservation of Oil.

Enclosed to the authority is a copy of the  
report of the Commission on the  
Conservation of Oil. The report of  
the Commission on the Conservation  
of Oil is a report of the  
Commission on the Conservation of  
Oil. The report of the Commission  
on the Conservation of Oil is a  
report of the Commission on the  
Conservation of Oil. The report of  
the Commission on the Conservation  
of Oil is a report of the  
Commission on the Conservation of  
Oil.

Very truly yours,

J. L. GORDON, JR.  
Secretary

Enclosure

Oil Conservation Commission (for  
information) - 10/1/54  
Oil Conservation Commission - 10/1/54  
Oil Conservation Commission - 10/1/54

5

# MIDWEST OIL CORPORATION

1500 WILCO BUILDING

MIDLAND, TEXAS

GENERAL OFFICES  
1700 BROADWAY  
DENVER 2, COLORADO

DIVISION OFFICE  
1200 CONTINENTAL NATIONAL  
BANK BUILDING  
FORT WORTH 2, TEXAS

November 28, 1967

Oil Conservation Commission  
P. O. Box 1980  
Hobbs, New Mexico

In Re: Exception to Rule 309-A  
Midwest Oil Corporation  
New Mexico "L" State #1  
Middle Lane (Permo Penn)  
Lea County, New Mexico

Gentlemen:

Midwest Oil Corporation hereby requests an exception to Rule 309-A to permit off-lease storage of production from our New Mexico "L" State #1 which will be drilled 1980' FWL & 1980' FSL of Sec. 2, T-10-S, R-33-E, Lea County, New Mexico.

Service Pipeline has requested that we locate the above mentioned storage at the same site as our New Mexico "K" State Battery; which is in SW/4 of SE/4 of Sec. 2, T-10-S, R-33-E, Lea County, New Mexico. These batteries will be separate and production will not be commingled.

The attached lease plat shows wells and producing formations as well as the proposed location for the off-lease storage.

If further information is needed please advise.

Yours very truly,

*W. E. Wittenburg*  
W. E. Wittenburg

WEW/jrs

Enclosure

cc: Commissioner of Public Lands

DEC 4 1967  
AM 8 39

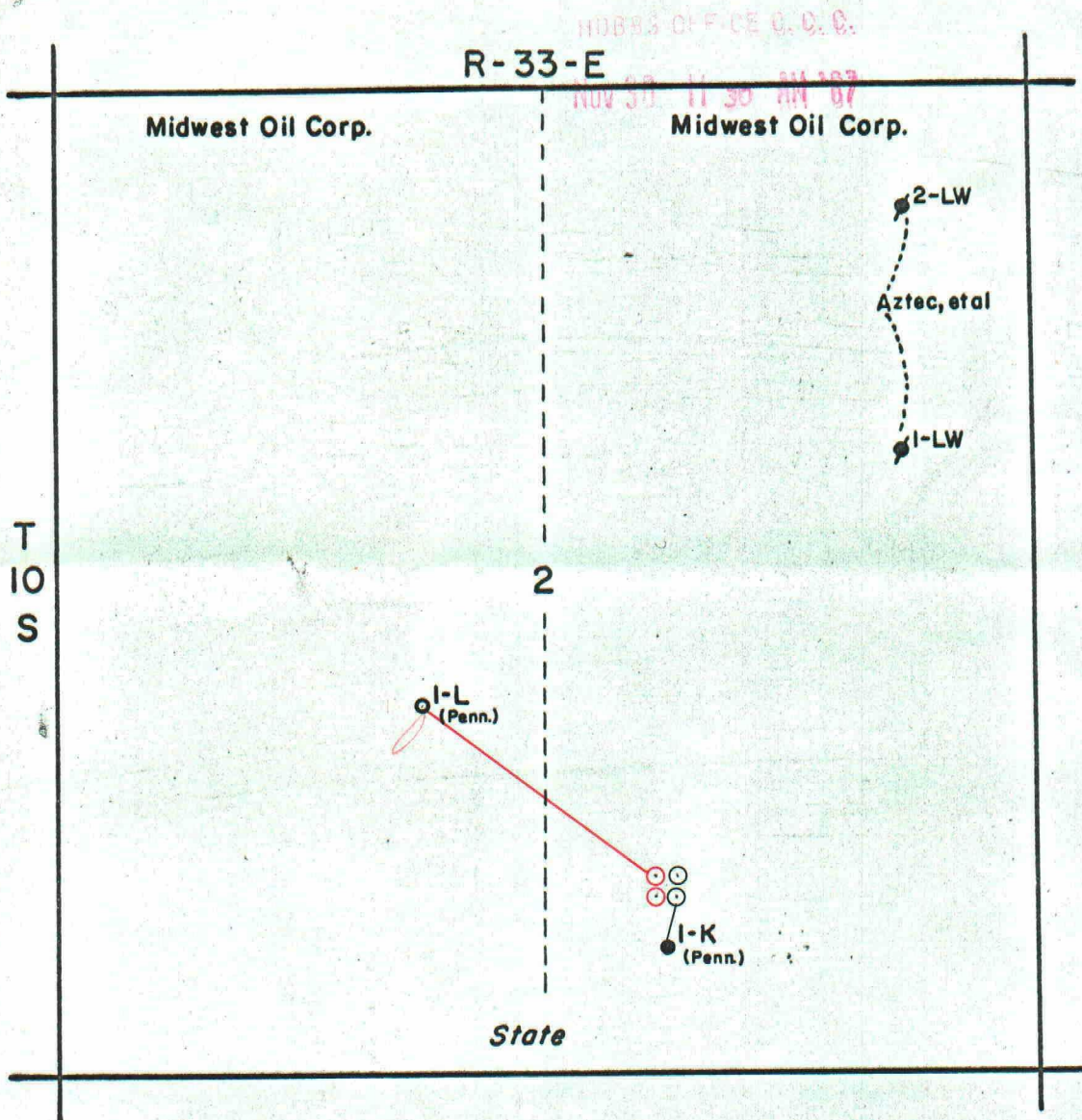

MIDWEST OIL CORPORATION  
MIDLAND, TEXAS

STATE "K" & "L" LEASES  
LEA COUNTY, NEW MEXICO

LOCATION OF WELLS  
AND TANK BATTERY

Scale: 1"=1000'

Nov. 27, 1967

N.F.G.

# State of New Mexico

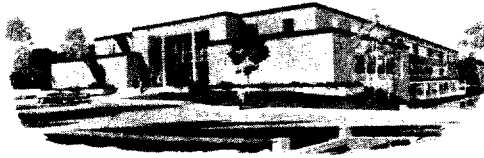

## Commissioner of Public Lands



GUYTON B. HAYS  
COMMISSIONER

P. O. BOX 1148  
SANTA FE, NEW MEXICO

December 7, 1967

Midwest Oil Corporation  
1500 Wilco Building  
Midland, Texas  
79701

Attention: Mr. W. E. Wittenburg

Gentlemen:

Re: Exception to Rule 309-A - Midwest Oil Corp, New Mex "L" State #1  
Middle Lane (Permo Penn) Lea County, New Mex

This will acknowledge your letter of November 28, requesting an exception to the captioned rule to permit off-lease storage of production from your New Mexico "L" State #1, which will be drilled 1980 ft. FWL & 1980 ft FSL of Sec. 2, T 10 S, R 33 E, Lea County, New Mexico.

Before we can proceed further with your request, it will be necessary that you submit a \$10.00 filing fee for this off-lease storage request. Upon receipt of the fee your application will be processed.

Very truly yours,

GUYTON B. HAYS  
Commissioner of Public Lands

MAIN OFFICE

By: *T. B.*  
TED BILBERRY, Director  
Oil and Gas Department

'67 DEC 8 AM 8 19

TB:jc:RM

cc: New Mexico Oil Conservation Commission  
P. O. Box 2088  
Santa Fe, New Mexico 87501

State of New Mexico

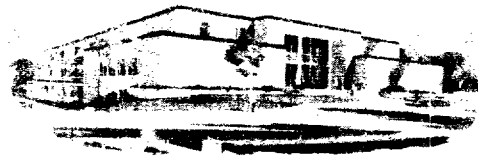

Commissioner of Public Lands



December 1, 1957

State of New Mexico  
Department of Public Lands

STATE OF NEW MEXICO  
COMMISSIONER OF PUBLIC LANDS

New Mexico Oil Corporation  
P.O. Box 2003  
Santa Fe, New Mexico 87501

Attest: W. A. Williams

Secretary

Re: Exception to Rule 302-A - New Mexico Oil Corporation  
Middle Lane (Pecos River) New Mexico

This will acknowledge your letter of November 20, requesting an exception to the  
and third rule to permit off-lease storage of production from your New Mexico  
state, which will be subject to Rule 302-A and Rule 302-B of the  
New Mexico Oil Corporation, New Mexico.

Since we can proceed further with your request, it will be necessary to pay  
and also a \$10.00 filing fee for this off-lease storage request. Upon receipt of the  
and your application will be processed.

Very truly yours,

GUYTON B. HAYS  
Commissioner of Public Lands

by:  
TED ELLERBY, Director  
Oil and Gas Department

15-68M

New Mexico Oil Corporation Commission  
P.O. Box 2003  
Santa Fe, New Mexico 87501

DEC 1 1957

# State of New Mexico

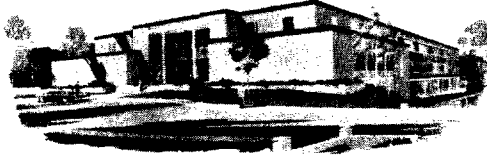

## Commissioner of Public Lands



GUYTON B. HAYS  
COMMISSIONER

P. O. BOX 1148  
SANTA FE, NEW MEXICO

December 15, 1967

Midwest Oil Corporation  
1500 Wilco Building  
Midland, Texas  
79701

Attention: Mr. W. E. Wittenburg

Gentlemen:

Re: Request by Midwest for Exception to Rule 309-A New Mex "L" State #1, Middle Lane (Permo Penn) Lea County, St of New Mex O&G Lease K-4105 - LOCO #7

Your request for exception to Rule 309-A to permit off-lease storage of production from your New Mexico "L" State #1 is hereby approved.

This does not include permission to commingle.

Receipt for your \$10.00 filing fee is enclosed.

Very truly yours,

GUYTON B. HAYS  
Commissioner of Public Lands

By: *Ted Bilberry*  
TED BILBERRY, Director  
Oil and Gas Department

TB:jc

cc: New Mex Oil Conservation Comm  
P. O. Box 2088  
Santa Fe, New Mex 87501

MAIN OFFICE  
'67 DEC 18 AM 8 32

State of New Mexico

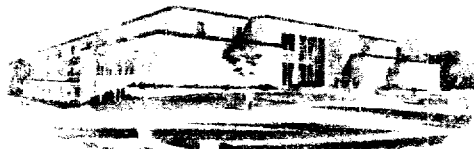

Commissioner of Public Lands



Department of the Interior

UNITED STATES DEPARTMENT OF THE INTERIOR

Mr. J. H. ...  
1515 ...  
...  
...

...

...

...

...

...

...

...

...

...

...

...

...

...

...

...

...

...