

Post Office Box 68
Hobbs, New Mexico

File: VES-175-400x541.111

**Subject: Application For Commingling
Fowler Lower Paddock Gas (Oil Rim)
and Fowler Blinbry Production
South Mattix Unit
Lea County, New Mexico**

Mr. A. L. Porter, Jr. (3)
Secretary-Director
New Mexico Oil Conservation Commission
Post Office Box 871
Santa Fe, New Mexico

Pan American Petroleum Corporation hereby submits application to commingle oil production from the South Mattix Unit Well No. 9, Fowler Lower Paddock Gas (Oil Rim), with that from the South Mattix Unit Wells No. 1, No. 3, No. 10, No. 13, and No. 14, Fowler Blinebry. The central battery, to be called the SMI Blinebry-Lower Paddock Gas (Oil Rim) Battery, will be located in Unit J, Section 15, Township 24 South, Range 37 East, Lea County, New Mexico.

1. Fowler Blinbry production from the South Mattix Unit is currently being produced into a common battery located at the site of the proposed commingling installation. The Fowler Blinbry and Fowler Lower Paddock Gas (Oil Rim) production will be separately metered and sampled prior to commingling.
2. A. O. Smith T-6 temperature compensated meters will be used to meter the production and will be proved monthly with a master meter.
3. The sample container shall be of sufficient volume to store the sample for eight (8) days. The BSW content will be obtained and recorded every eight (8) days.

ILLEGIBLE

Mr. A. L. Porter, Jr.
July 2, 1965
Page 2

4. Combination air-eliminator strainers will be used upstream of the samplers.
5. There will be no change in the commercial value of the commingled production.

<u>Well & Pool</u>	<u>Gravity</u>	<u>BOPD</u>
South Mattix Unit Nos. 1, 3, 10, 13, 14 Fowler Blinebry	38.9	167
South Mattix Unit No. 9 Fowler Lower Paddock Gas (Oil Rim)	38.0	30
Commingled	38.7	197

6. All parties owning an interest in the South Mattix Unit Lease have been notified of our intention to commingle production by certified mail. Shell Oil Company, purchaser of this production, has approved our plan to commingle.
7. A plot of the leases showing the location of the wells, the pool in which they are completed, and the location of the proposed battery site is attached.
8. A schematic diagram of the proposed installation is attached.

Yours very truly,

V. E. Staley
Area Superintendent

ILLEGIBLE

Attachments

MAILING LIST

The Atlantic Refining Company
P. O. Box 354
Dallas, Texas

Continental Oil Company
P. O. Box 5565 F
Dallas 22, Texas

Standard Oil Company of Texas
A Division of California Oil Company
P. O. Box 1249
Houston 1, Texas

United States Geological Survey
P. O. Drawer 1857
Roswell, New Mexico

Tenneco Oil Company
P. O. Box 1031
Midland, Texas

Firm Royalties, Inc.
700 General Petroleum Building
610 South Flower Street
Los Angeles 17, California

Annie Hughes Myers
700 General Petroleum Building
610 South Flower Street
Los Angeles 17, California

Annie May Kavanaugh
P. O. Box 423
Scooba, Mississippi

Florence Jack Mayo
2915 Hardy Street
Shreveport, Louisiana

W. M. Beauchamp
Ancillary Guardian of Estate
of William Howard Jack
N.C.M.
c/o District Court
Lovington, New Mexico

Mack Easley
P. O. Box 638
Hobbs, New Mexico

John Quinn
P. O. Box 2587
Hobbs, New Mexico

J. H. Daws
DeKalb, Mississippi

Lucille R. Jack
1520 14th Avenue
Meridian, Mississippi

Dorothy Mitchell Latady
Ancillary Executrix of the Estate
of Charles S. Mitchell, Deceased
Pascogoula, Mississippi

Shell Pipe Line Corporation
P. O. Box 1910
Midland, Texas

ILLEGIBLE

R-37-E

Approved Initial
Tubb Participating
Area

Recommended
Second Enlargement
of Tubb Participating Area

**SOUTH
MATTIX
UNIT**

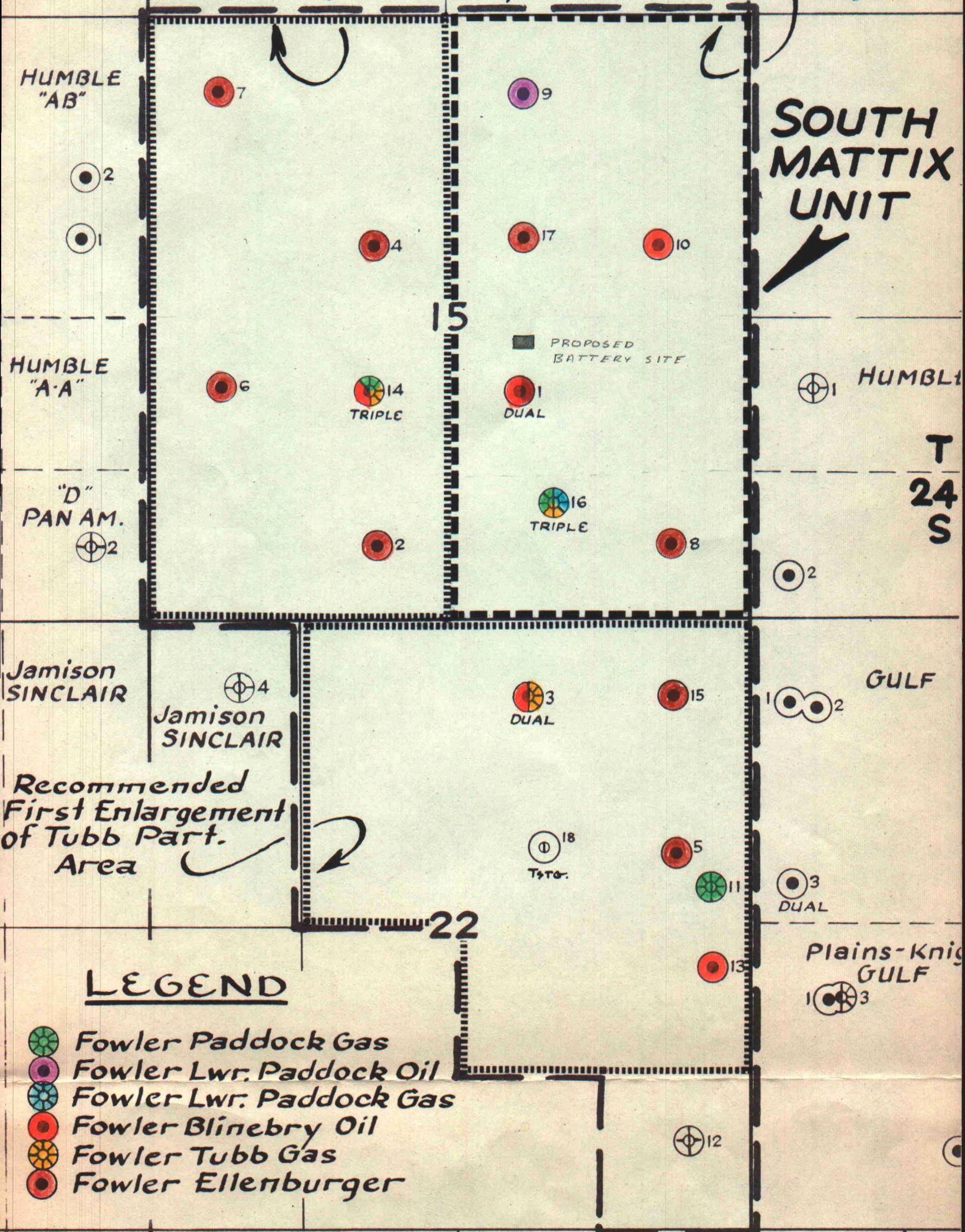

LEGEND

- Fowler Paddock Gas
- Fowler Lwr. Paddock Oil
- Fowler Lwr. Paddock Gas
- Fowler Blinebry Oil
- Fowler Tubb Gas
- Fowler Ellenburger

B. A.
Christmas
GULF

Lillie Knight
ADDISON

Pan American Petr. Corp.
South Mattix Unit
Lea Co, New Mex.
1" = 1000'

prepared 6/22/65

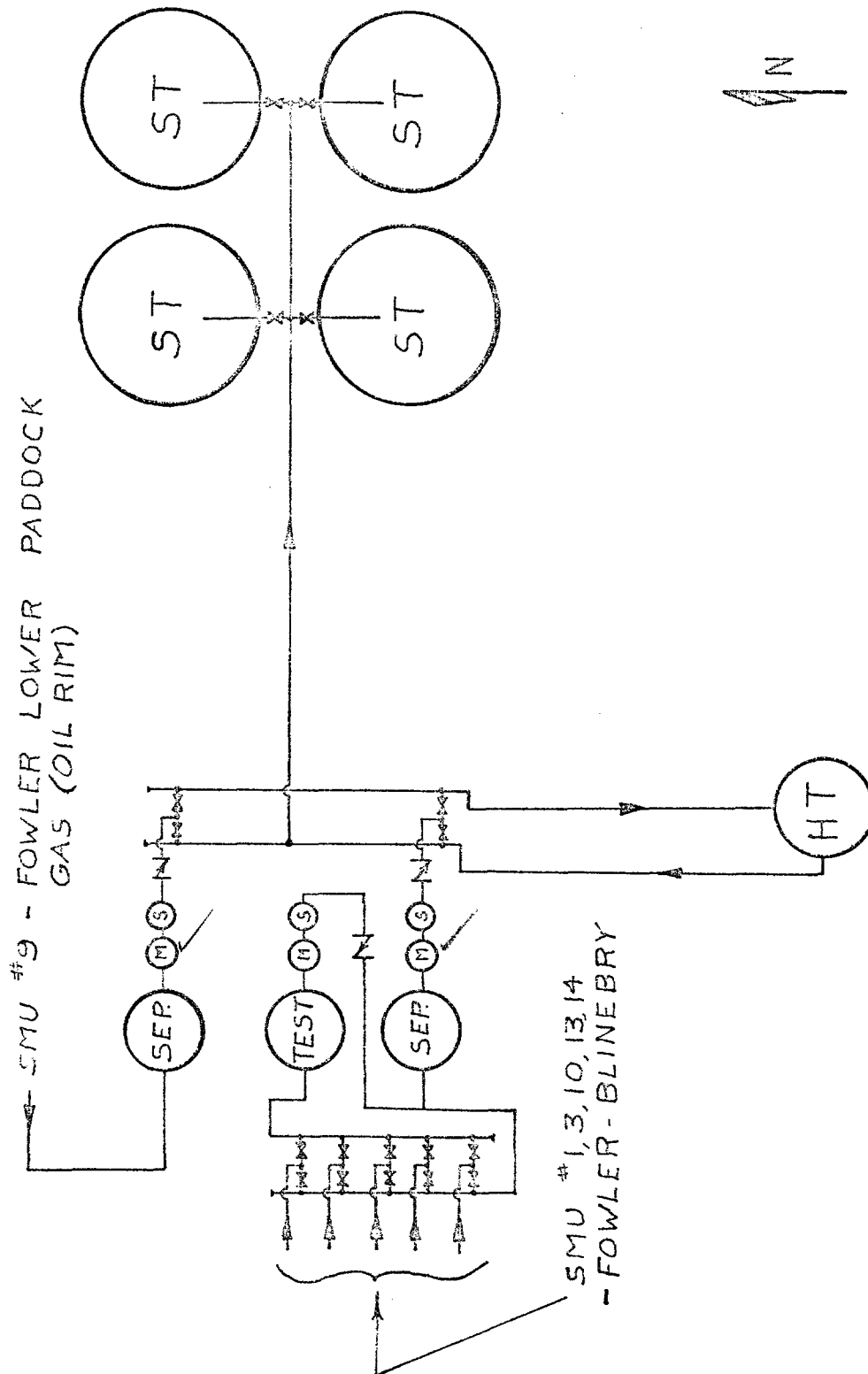

PAN AMERICAN PETROLEUM CORPORATION

PROPOSED SMU BLINEBRY-LOWER PADDOCK GAS (OIL RIM)

SCALE: NONE

DATE 6-8-65

DRG.

NO.

UNIT U SEC 15 T-24-S R-37-E LEA CO. N.M.

71074