

Charles B. Gillespie, Jr.

GEOLOGIST-OIL PRODUCER  
P. O. BOX 1179  
MIDLAND, TEXAS 79701

May 10, 1968

PC-350

In re: Exception to Rule 303 (A)  
Charles B. Gillespie, Jr. State "A" (K-90) Lease  
Sec. 3, T-11-S, R-33-E, North Bagley Field  
Lea County, New Mexico

*Held for Land Office approval  
(100-5/22/68)*

60 MAY 13 1968

Mr. A. L. Porter, Jr.  
Secretary-Director  
New Mexico Oil Conservation Commission  
Box 2088  
Santa Fe, New Mexico 87501

Dear Sir:

Please consider this a formal request for an administrative order granting an exception to Rule 303 (A) as concerns the above-described lease.

The ownership is common in the lease.

I would submit the following information as required under Rule 303 (B) of the New Mexico Oil Conservation Commission:

	Well #1	Well #2
	Upper Penn.	Lower Penn.
	Perf. 9552-60	Perf. 10,122-179
Gravity of Oil	46.0 - 46.5°	46.0 - 47.0°
Value	\$3.09/Bbl.	\$3.09/Bbl.
Volumes	182 BOPD Allowable	362 BOPD Allowable
Expected Gravity of Comingled Oil	46.5°	

The value of the co-mingled production will be the same as if they were produced separately, \$3.09 per barrel.

Attached you will find two plats showing the location of the wells and the proposed installation of the metering equipment.

A copy of this request has been sent this date to the Commissioner of Public Lands for his approval, and I will notify you as soon as consent or non-consent of my request has been received.

Your consideration of this request is appreciated.

Yours truly,

*Charles B. Gillespie, Jr.*  
Charles B. Gillespie, Jr.

CBG:e  
Encs.

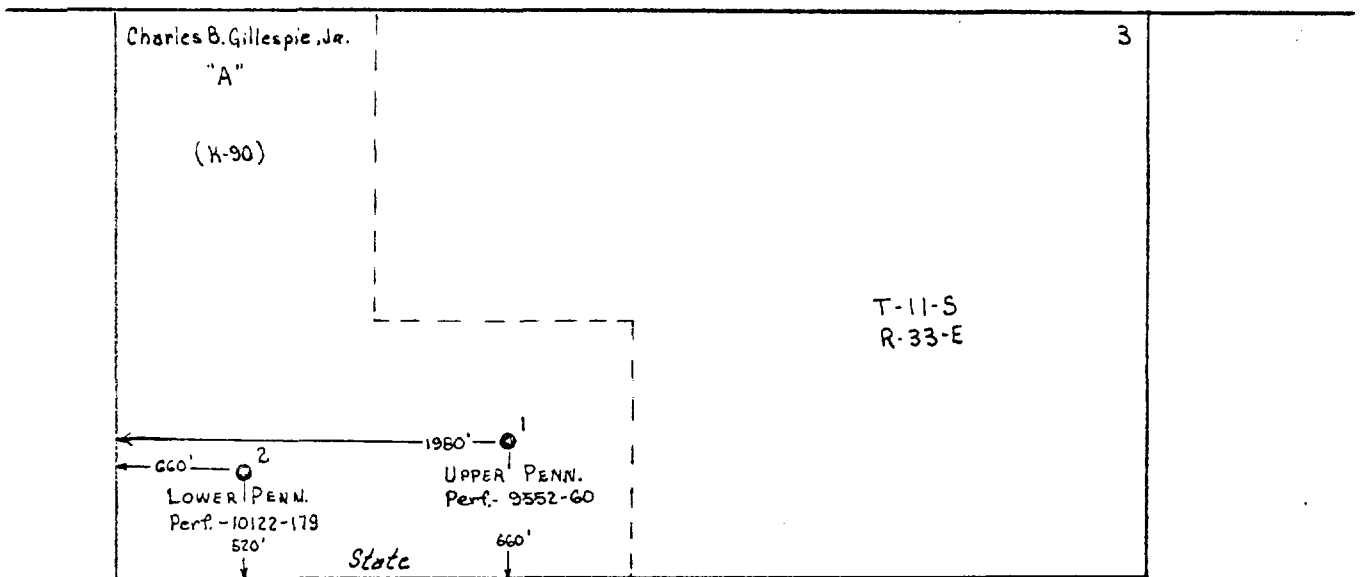

PLAT SHOWING WELL LOCATIONS AND  
POOL DESIGNATIONS -  
CHARLES B. GILLESPIE, JR. STATE "A" LSE  
(K-90)  
NORTH BAGLEY FIELD

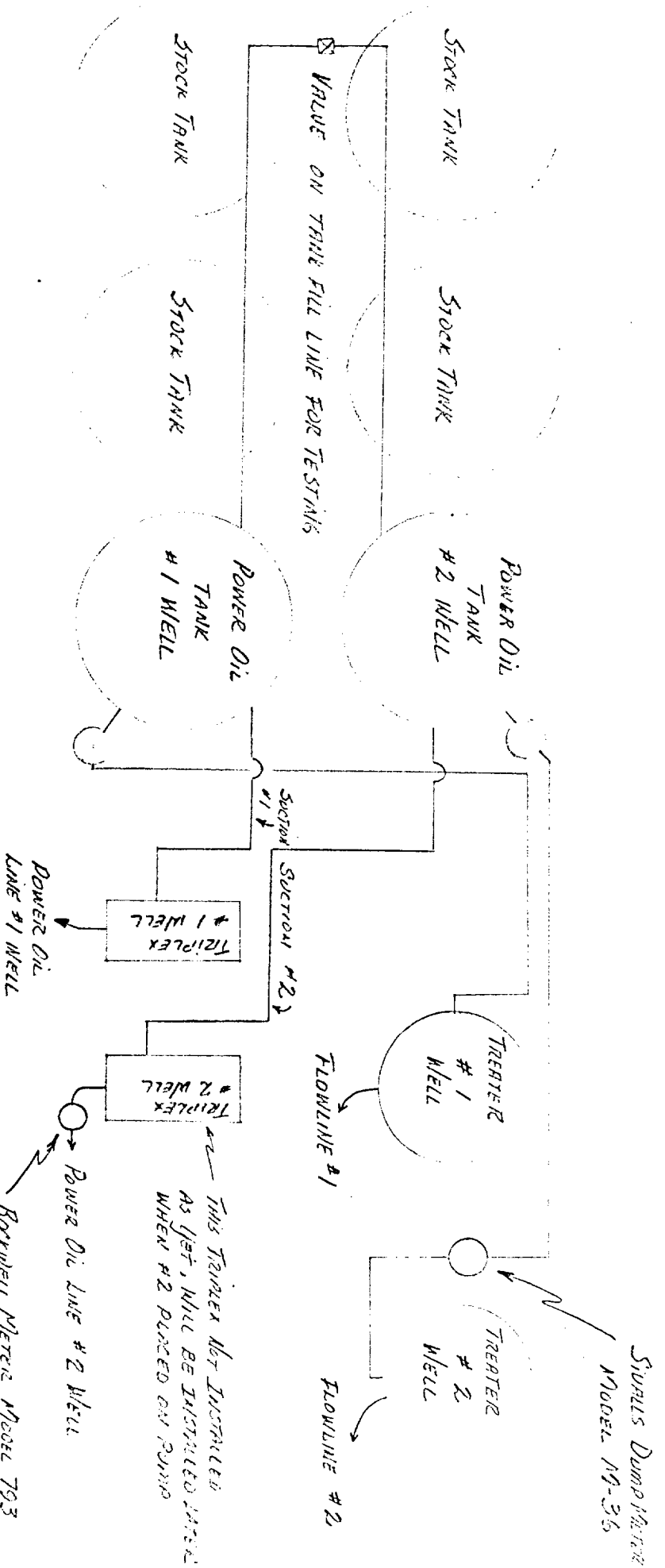

PRODUCED INSTALLATION - COMPLETED PRODUCTION  
 UNDER 3' LOWER PENAL  
 ANNUAL B. GILLESPIE, JR. STATE "A" USE (K-90)  
 NORTH BASLEY FIELD

PRODUCTION FROM #2 TO BE DERIVED  
 BY SUBTRACTING OUTPUT OF TRIPLEX  
 #2 WELL FROM TOTAL OUTPUT OF  
 TREATER #2 WELL  
 PRESENT PRODUCTION - WELL #2 IS  
 EXHAUSTING THROUGH TREATER FOR  
 #2 WELL

ROCKWELL Meter Model 793  
 (on Equipment)

# State of New Mexico



## Commissioner of Public Lands

GUYTON B. HAYS  
COMMISSIONER



P. O. BOX 1148  
SANTA FE, NEW MEXICO

May 22, 1968

Mr. Charles B. Gillespie, Jr.  
P. O. Box 1179  
Midland, Texas  
79701

Re: Request for Exception to Rule 303 (A)  
to Commingle Production from Wells  
Nos 1 & 2, Upper Penn & Lower Penn,  
Respectively, State of New Mex Oil & Gas  
Lease No. K-90; State "A", Sec.  
3, T 11 S, R 33 E, Bagley Field, Lea  
County, New Mexico - LOCO #19

Dear Mr. Gillespie:

Approval of your request to commingle production from the captioned wells, located on State of New Mexico Oil and Gas Lease No. K-90, is hereby approved by the Commissioner of Public Lands, with the reservation to withdraw said approval if, at any time in his discretion, he deems this operation to be adverse to the best interests of the State of New Mexico. The approval is granted subject to concurrence by the New Mexico Oil Conservation Commission.

Enclosed is receipt for the \$10.00 filing fee which you submitted.

Very truly yours,

GUYTON B. HAYS  
Commissioner of Public Lands

By:  
TED BILBERRY, Director  
Oil and Gas Department

TB:jc

cc: Oil Conservation Commission  
✓ P. O. Box 2088  
Santa Fe, New Mexico 87501

Oil and Gas Accounting Comm of New Mex  
P. O. Box 2308  
Santa Fe, New Mexico 87501

60 MAY 23 PM 1 00

DATE: 11-11-60  
BY: J. J. J.

5. 6. 8. 9. 10. 11. 12. 13. 14. 15. 16. 17. 18. 19. 20. 21. 22. 23. 24. 25. 26. 27. 28. 29. 30. 31. 32. 33. 34. 35. 36. 37. 38. 39. 40. 41. 42. 43. 44. 45. 46. 47. 48. 49. 50. 51. 52. 53. 54. 55. 56. 57. 58. 59. 60. 61. 62. 63. 64. 65. 66. 67. 68. 69. 70. 71. 72. 73. 74. 75. 76. 77. 78. 79. 80. 81. 82. 83. 84. 85. 86. 87. 88. 89. 90. 91. 92. 93. 94. 95. 96. 97. 98. 99. 100. 101. 102. 103. 104. 105. 106. 107. 108. 109. 110. 111. 112. 113. 114. 115. 116. 117. 118. 119. 120. 121. 122. 123. 124. 125. 126. 127. 128. 129. 130. 131. 132. 133. 134. 135. 136. 137. 138. 139. 140. 141. 142. 143. 144. 145. 146. 147. 148. 149. 150. 151. 152. 153. 154. 155. 156. 157. 158. 159. 160. 161. 162. 163. 164. 165. 166. 167. 168. 169. 170. 171. 172. 173. 174. 175. 176. 177. 178. 179. 180. 181. 182. 183. 184. 185. 186. 187. 188. 189. 190. 191. 192. 193. 194. 195. 196. 197. 198. 199. 200. 201. 202. 203. 204. 205. 206. 207. 208. 209. 210. 211. 212. 213. 214. 215. 216. 217. 218. 219. 220. 221. 222. 223. 224. 225. 226. 227. 228. 229. 230. 231. 232. 233. 234. 235. 236. 237. 238. 239. 240. 241. 242. 243. 244. 245. 246. 247. 248. 249. 250. 251. 252. 253. 254. 255. 256. 257. 258. 259. 260. 261. 262. 263. 264. 265. 266. 267. 268. 269. 270. 271. 272. 273. 274. 275. 276. 277. 278. 279. 280. 281. 282. 283. 284. 285. 286. 287. 288. 289. 290. 291. 292. 293. 294. 295. 296. 297. 298. 299. 300. 301. 302. 303. 304. 305. 306. 307. 308. 309. 310. 311. 312. 313. 314. 315. 316. 317. 318. 319. 320. 321. 322. 323. 324. 325. 326. 327. 328. 329. 330. 331. 332. 333. 334. 335. 336. 337. 338. 339. 340. 341. 342. 343. 344. 345. 346. 347. 348. 349. 350. 351. 352. 353. 354. 355. 356. 357. 358. 359. 360. 361. 362. 363. 364. 365. 366. 367. 368. 369. 370. 371. 372. 373. 374. 375. 376. 377. 378. 379. 380. 381. 382. 383. 384. 385. 386. 387. 388. 389. 390. 391. 392. 393. 394. 395. 396. 397. 398. 399. 400. 401. 402. 403. 404. 405. 406. 407. 408. 409. 410. 411. 412. 413. 414. 415. 416. 417. 418. 419. 420. 421. 422. 423. 424. 425. 426. 427. 428. 429. 430. 431. 432. 433. 434. 435. 436. 437. 438. 439. 440. 441. 442. 443. 444. 445. 446. 447. 448. 449. 450. 451. 452. 453. 454. 455. 456. 457. 458. 459. 460. 461. 462. 463. 464. 465. 466. 467. 468. 469. 470. 471. 472. 473. 474. 475. 476. 477. 478. 479. 480. 481. 482. 483. 484. 485. 486. 487. 488. 489. 490. 491. 492. 493. 494. 495. 496. 497. 498. 499. 500. 501. 502. 503. 504. 505. 506. 507. 508. 509. 510. 511. 512. 513. 514. 515. 516. 517. 518. 519. 520. 521. 522. 523. 524. 525. 526. 527. 528. 529. 530. 531. 532. 533. 534. 535. 536. 537. 538. 539. 540. 541. 542. 543. 544. 545. 546. 547. 548. 549. 550. 551. 552. 553. 554. 555. 556. 557. 558. 559. 560. 561. 562. 563. 564. 565. 566. 567. 568. 569. 570. 571. 572. 573. 574. 575. 576. 577. 578. 579. 580. 581. 582. 583. 584. 585. 586. 587. 588. 589. 590. 591. 592. 593. 594. 595. 596. 597. 598. 599. 600. 601. 602. 603. 604. 605. 606. 607. 608. 609. 610. 611. 612. 613. 614. 615. 616. 617. 618. 619. 620. 621. 622. 623. 624. 625. 626. 627. 628. 629. 630. 631. 632. 633. 634. 635. 636. 637. 638. 639. 640. 641. 642. 643. 644. 645. 646. 647. 648. 649. 650. 651. 652. 653. 654. 655. 656. 657. 658. 659. 660. 661. 662. 663. 664. 665. 666. 667. 668. 669. 670. 671. 672. 673. 674. 675. 676. 677. 678. 679. 680. 681. 682. 683. 684. 685. 686. 687. 688. 689. 690. 691. 692. 693. 694. 695. 696. 697. 698. 699. 700. 701. 702. 703. 704. 705. 706. 707. 708. 709. 710. 711. 712. 713. 714. 715. 716. 717. 718. 719. 720. 721. 722. 723. 724. 725. 726. 727. 728. 729. 730. 731. 732. 733. 734. 735. 736. 737. 738. 739. 740. 741. 742. 743. 744. 745. 746. 747. 748. 749. 750. 751. 752. 753. 754. 755. 756. 757. 758. 759. 760. 761. 762. 763. 764. 765. 766. 767. 768. 769. 770. 771. 772. 773. 774. 775. 776. 777. 778. 779. 780. 781. 782. 783. 784. 785. 786. 787. 788. 789. 790. 791. 792. 793. 794. 795. 796. 797. 798. 799. 800. 801. 802. 803. 804. 805. 806. 807. 808. 809. 810. 811. 812. 813. 814. 815. 816. 817. 818. 819. 820. 821. 822. 823. 824. 825. 826. 827. 828. 829. 830. 831. 832. 833. 834. 835. 836. 837. 838. 839. 840. 841. 842. 843. 84

[illegible]

0.0000000000000000  
 0.0000000000000000  
 0.0000000000000000  
 0.0000000000000000

2025 RELEASE UNDER E.O. 14176

[illegible]

Recreation may have a profit 60,018 and not concern a section.

1. 2000 21/03 21/03

STAFF, J. ROBERT  
1941-1942 - 1943-1944

Actual, VISUAL to  
prescribed and but not

—

NOTES: 1. The above information is for information only.  
2. The above information is for information only.  
3. The above information is for information only.

[illegible]