

114439337

NSL

6/6/01

MARTIN YATES, III
1912 - 1985
FRANK W. YATES
1936 - 1986



105 SOUTH FOURTH STREET
ARTESIA, NEW MEXICO 88210-2118
TELEPHONE (505) 748-1471

S. P. YATES
CHAIRMAN OF THE BOARD
JOHN A. YATES
PRESIDENT
PEYTON YATES
EXECUTIVE VICE PRESIDENT
RANDY G. PATTERSON
SECRETARY
DENNIS G. KINSEY
TREASURER

May 15, 2001

Mr. Michael Stogner
New Mexico Oil Conservation Division
2040 South Pacheco
Santa Fe, New Mexico 87508

MAY 17 2001

Re: Application for Unorthodox Location
Jasper "ARJ" Federal #2
Foor Ranch; Precambrian
Sec. 25, T8S-R26E
Chaves County, New Mexico

Dear Mr. Stogner:

Yates Petroleum Corporation respectfully requests administrative approval for an unorthodox Precambrian gas well. The proposed Jasper "ARJ" Federal #2 well is located on federal minerals, 760' FNL and 2240' FEL in Sec. 25, T8S-R26E. The well was surveyed and staked at this location because of the topography; there is drainage on the north, west and south side and archaeology to the east. This is also the best area to intersect the Ordovician dolomite which is anticipated to be structurally higher than the Ordovician in our Jasper "ARJ" #1 in the southeast quarter of this section the Penn Sands and the Abo Sands which are on a northwest to southeast trend that appear to have their greatest accumulation in this part of the section. The offset operator to the north has been notified of this application. The other offset leases are operated by Yates.

Yates Petroleum Corporation requests that this unorthodox location be administratively approved if no objections are received within 20 days.

Enclosed is a copy of form 3160-3, C-102, land plat and copy of notification to offset operators. Please call me at (505) 748-4376 if any other information is needed. Thank you.

Very truly yours,

YATES PETROLEUM CORPORATION

Pat Perez

Pat Perez
Permit Agent

/pp
Enclosures

OPERATOR'S COPY

Form 3160-3
(August 1999)

UNITED STATES
DEPARTMENT OF THE INTERIOR
BUREAU OF LAND MANAGEMENT

APPROVAL SUBJECT TO GENERAL REQUIREMENTS AND SPECIAL STIPULATIONS

OMB No. 1004-0136
Expires November 30, 2000

APPLICATION FOR PERMIT TO DRILL OR REENTER

1a. Type of Work: <input checked="" type="checkbox"/> DRILL <input type="checkbox"/> REENTER		5. Lease Serial No. NM-93184
b. Type of Well: <input type="checkbox"/> Oil Well <input checked="" type="checkbox"/> Gas Well <input type="checkbox"/> Other <input type="checkbox"/> Single Zone <input checked="" type="checkbox"/> Multiple Zone		6. If Indian, Allottee or Tribe Name Not Applicable
2. Name of Operator Yates Petroleum Corporation		7. If Unit or CA Agreement, Name and No. Not Applicable
3A. Address 105 South Fourth Street Artesia, New Mexico 88210	3b. Phone No. (include area code) (505) 748-1471	8. Lease Name and Well No. Jasper "ARJ" Federal #2
4. Location of Well (Report location clearly and in accordance with any State requirements. *) At surface 760' FNL and 2240' FEL At proposed prod. Zone same as above		9. API Well No. 30-005-63143
14. Distance in miles and direction from nearest town or post office* Approximately 30 miles Northeast of Roswell, New Mexico		10. Field and Pool, or Exploratory Foor Ranch; Precambrian 76730
15. Distance from proposed* location to nearest property or lease line, ft. (Also to nearest drig. unit line, if any)	16. No. of Acres in lease 800	11. Sec., T., R., M., or Bk. and Survey or Area Section 25, T8S-R26E
18. Distance from proposed location* to nearest well, drilling, completed, applied for, on this lease, ft.	19. Proposed Depth 6500'	12. County or Parish Chaves County
21. Elevations (Show whether DF, KDB, RT, GL, etc.) 3941'	22. Approximate date work will start* ASAP	13. State New Mexico
20. BLM/BIA Bond No. on file Nationwide Bond #NM-2811		
23. Estimated duration 30 Days		

24. Attachments

The following, completed in accordance with the requirements of Onshore Oil and Gas Order No. 1, shall be attached to this form:

- | | |
|--|---|
| 1. Well plat certified by a registered surveyor. | 4. Bond to cover the operations unless covered by an existing bond on file (see Item 20 above). |
| 2. A Drilling Plan. | 5. Operator certification. |
| 3. A Surface Use Plan (if the location is on National Forest System Lands, the SUPO shall be filed with the appropriate Forest Service Office. | 6. Such other site specific information and/or plans as may be required by the authorized office. |

25. Signature <i>Pat Perez</i>	Name (Printed/Typed) Pat Perez	Date 3/8/01
-----------------------------------	--	-----------------------

Title:

Regulatory Agent

Approved by (Signature) <i>Larry D. Bray</i>	Name (Printed/Typed) LARRY D. BRAY	Date APR 09 2001
---	--	----------------------------

Title Assistant Field Manager, Lands And Minerals	Office ROSWELL FIELD OFFICE	APPROVED FOR 1 YEAR
---	---------------------------------------	----------------------------

Application approval does not warrant or certify that the applicant holds legal or equitable title to those rights in the subject lease which would entitle the applicant to conduct operations thereon.

Conditions of approval, if any, are attached.

Title 18 U.S.C. Section 1001 and Title 43 U.S.C. Section 1212, make it a crime for any person knowingly and willfully to make to any department or agency of the United States any false, fictitious or fraudulent statements or representations as to any matter within its jurisdiction.

*(Instructions on reverse)

DISTRICT I
P.O. Box 1980, Hobbs, NM 88240

DISTRICT II
P.O. Drawer DD, Artesia, NM 88210

DISTRICT III
1000 Rio Brazos Rd., Aztec, NM 87410

State of New Mexico
Energy, Minerals and Natural Resources Department

Form C-102
Revised February 10, 1994
Instruction on back
Submit to Appropriate District Office
State Lease - 4 Copies
Fee Lease - 3 Copies

OIL CONSERVATION DIVISION

P.O. Box 2088
Santa Fe, New Mexico 87504-2088

☐ AMENDED REPORT

WELL LOCATION AND ACREAGE DEDICATION PLAT

API Number 30-005-63143	Pool Code	Pool Name Foor Ranch; Precambrian
Property Code	Property Name JASPER "ARJ" FEDERAL	Well Number 2
OGRID No. 025575	Operator Name YATES PETROLEUM CORPORATION	Elevation 3941

Surface Location

UL or lot No.	Section	Township	Range	Lot Idn	Feet from the	North/South line	Feet from the	East/West line	County
B	25	8S	26E		760	NORTH	2240	EAST	CHAVES

Bottom Hole Location If Different From Surface

UL or lot No.	Section	Township	Range	Lot Idn	Feet from the	North/South line	Feet from the	East/West line	County

Dedicated Acres 320.00	Joint or Infill	Consolidation Code	Order No.
---------------------------	-----------------	--------------------	-----------

NO ALLOWABLE WILL BE ASSIGNED TO THIS COMPLETION UNTIL ALL INTERESTS HAVE BEEN CONSOLIDATED
OR A NON-STANDARD UNIT HAS BEEN APPROVED BY THE DIVISION

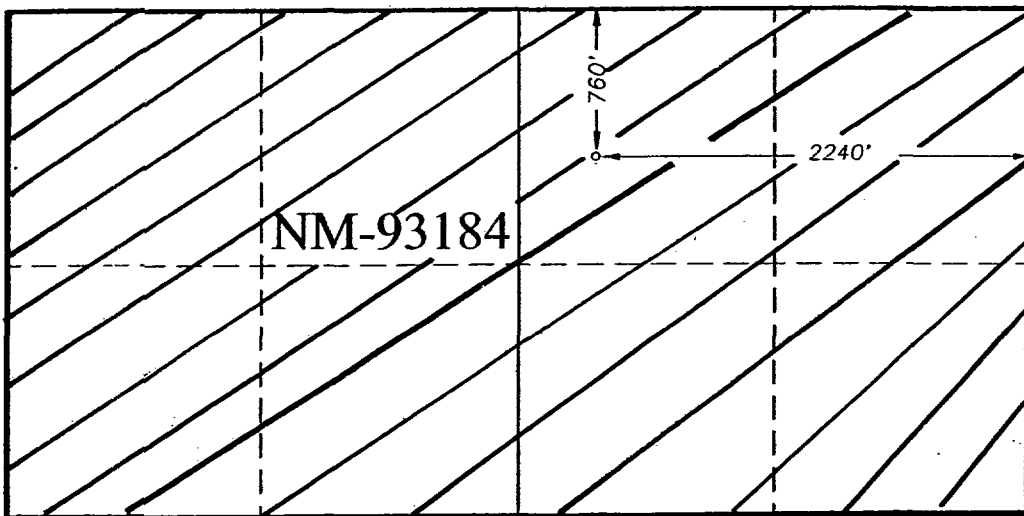

OPERATOR CERTIFICATION

I hereby certify the the information
contained herein is true and complete to the
best of my knowledge and belief.

Pat Perez
Signature

Pat Perez
Printed Name

Regulatory Agent
Title

3-8-01
Date

SURVEYOR CERTIFICATION

I hereby certify that the well location shown
on this plat was plotted from field notes of
actual surveys made by me or under my
supervision, and that the same is true and
correct to the best of my belief.

4/21/07
Date Surveyed
Signature
Professional Surveyor
Certificate No. 3640
JASPER 2-680 DISK #3
GENERAL SURVEYING COMPANY

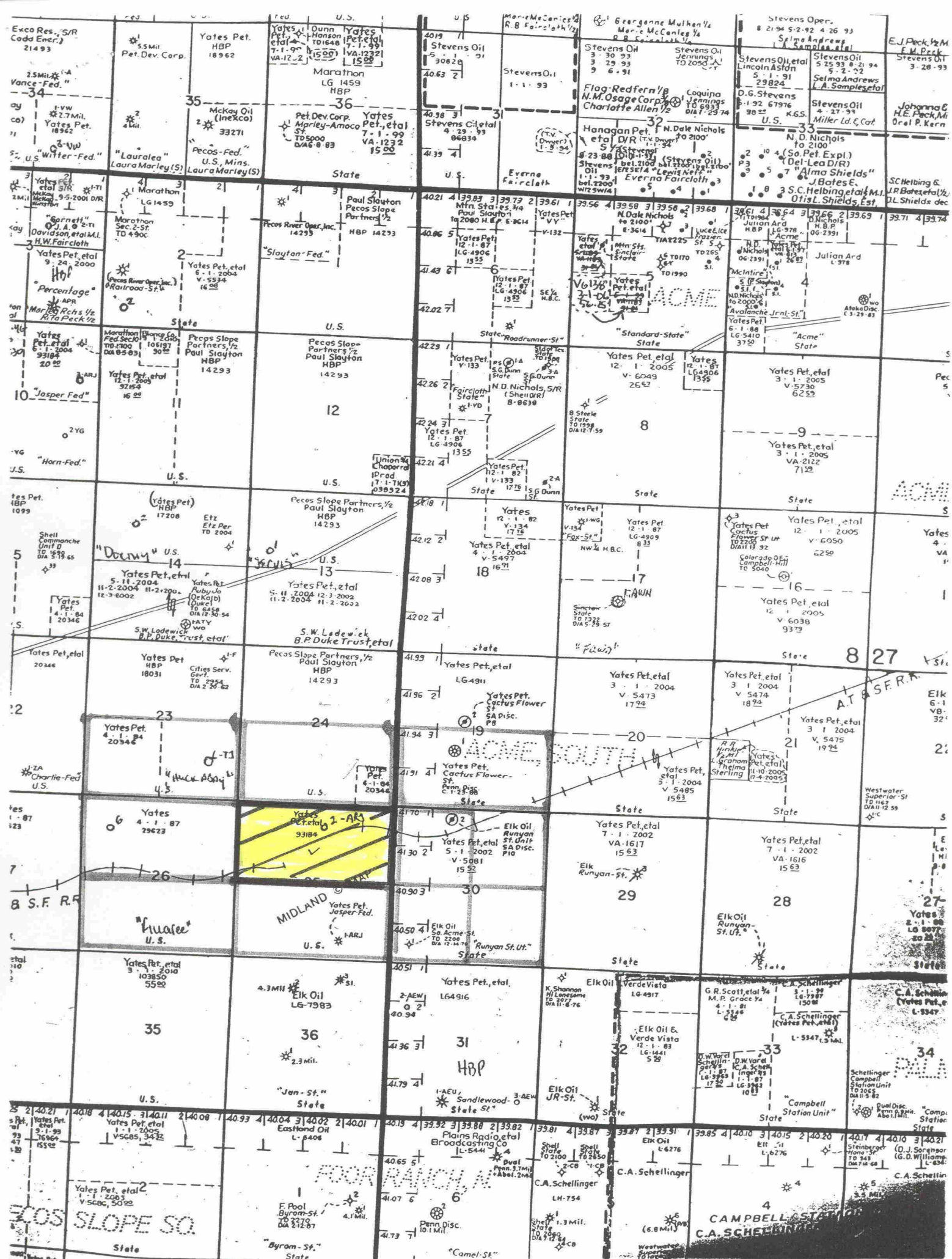

MARTIN YATES, III
1912 - 1985
FRANK W. YATES
1936 - 1986



105 SOUTH FOURTH STREET
ARTESIA, NEW MEXICO 88210-2118
TELEPHONE (505) 748-1471

S. P. YATES
CHAIRMAN OF THE BOARD
JOHN A. YATES
PRESIDENT
PEYTON YATES
EXECUTIVE VICE PRESIDENT
RANDY G. PATTERSON
SECRETARY
DENNIS G. KINSEY
TREASURER

May 17, 2001

MAY 21 2001

Mr. Michael Stogner
New Mexico Oil Conservation Division
2040 South Pacheco
Santa Fe, New Mexico 87508

Re: Application for Unorthodox Location
Jasper "ARJ" Federal #2
Foor Ranch; Precambrian
Sec. 25, T8S-R26E
Chaves County, New Mexico

Dear Mr. Stogner:

A letter requesting administrative approval for the captioned location was mailed to your office May 15, 2001. Attached for your records is a copy of the notification letter to the offset operator indicating there are no objections to this location.

Please advise if there are any further requirements. Thank you.

Very truly yours,

YATES PETROLEUM CORPORATION

Pat Perez
Regulatory Agent

/pp
Enclosure

MARTIN YATES, III
1912 - 1985
FRANK W. YATES
1936 - 1986



105 SOUTH FOURTH STREET
ARTESIA, NEW MEXICO 88210-2118
TELEPHONE (505) 748-1471

S. P. YATES
CHAIRMAN OF THE BOARD
JOHN A. YATES
PRESIDENT
PEYTON YATES
EXECUTIVE VICE PRESIDENT
RANDY G. PATTERSON
SECRETARY
DENNIS G. KINSEY
TREASURER

May 7, 2001

Pecos Slope Partners, L.P.
550 West Texas, Suite 720
Midland, Texas 79701

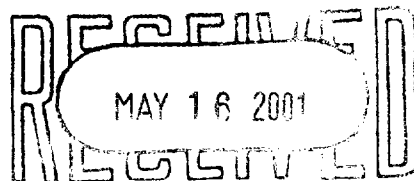

RE: Offset Operator Notification
Unorthodox Location
Jasper "ARJ" Fed. #2
Township 8 South, Range 26 East
Section 25: 760' FNL & 2240' FEL
Chaves County, New Mexico

Gentlemen:

Yates Petroleum Corporation plans to drill the captioned well at the unorthodox location described above. This location does not comply with the well spacing requirements set for the in NMOCD Rule 104.C(2)(b)(Revised 8/12/99).

If you have no objections to this unorthodox location, please signify your approval by signing one copy of this letter in the space provided below and returning same to the undersigned. Any objection must be filed in writing with the NMOCD within twenty (20) days from the date of this notice.

Very truly yours,

YATES PETROLEUM CORPORATION

Pat Perez
Regulatory Agent

PP/dc

Pecos Slope Partners, L.P.

By: Will Munch
Title: VP - Engr & Perm.
Date: 5-11-01

Stogner, Michael

From: Stogner, Michael
Sent: Tuesday, July 03, 2001 8:42 AM
To: Arrant, Bryan
Subject: Foor Ranch area

I need some help please. What is the vertical limits of the Foor Ranch-PrePermian Gas Pool (76730) created by R-7048 in 1982? I also show the name Foor Ranch-Pre Cambrian Gas Pool appears on two APD's in Section 25-T8S-R26E, what is this pool, when was it created, and where can I find it? Thanks.

CMD : ONGARD 07/02/01 17:14:00
OG6C101 C101-APPLICATION FOR PERMIT TO DRILL OGOMES -TPF4

OGRID Idn : 25575 API Well No: 30 5 63143 APD Status(A/C/P): A
Opr Name, Addr: YATES PETROLEUM CORPORATION Aprvl/Cncl Date : 04-09-2001
105 S 4TH ST
ARTESIA,NM 88210

Prop Idn: 21096 JASPER ARJ FEDERAL COM Well No: 2

	U/L	Sec	Township	Range	Lot	Idn	North/South	East/West
	---	---	-----	-----	-----	-----	-----	-----
Surface Locn :	B	25	08S	26E			FTG 760 F N	FTG 2240 F E
OCD U/L :	B		API County :	5				

Work typ(N/E/D/P/A) : N Well typ(O/G/M/I/S/W/C): G Cable/Rotary (C/R) : F
Lease typ(F/S/P/N/J/U/I): F Ground Level Elevation : 3941

State Lease No: Multiple Comp (S/M/C) : N
Prpsd Depth : 6500 Prpsd Frmtn : PRECAMBRIAN

E0009: Enter data to modify record

PF01 HELP	PF02	PF03 EXIT	PF04 GoTo	PF05	PF06 CONFIRM
PF07	PF08	PF09 PRINT	PF10 C102	PF11 HISTORY	PF12

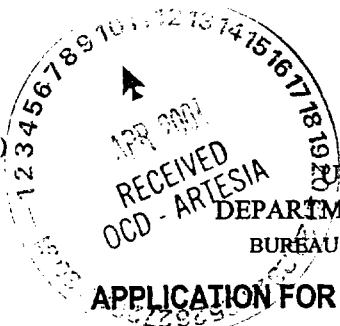

N. M. Oil Conservation Division
ARTESIA, N.M. 87003-1944

Extend IN

0
OMB No. 1004-0136
Expires November 30, 2000

UNITED STATES DEPARTMENT OF THE INTERIOR
BUREAU OF LAND MANAGEMENT
APPROVAL SUBJECT TO GENERAL REQUIREMENTS AND SPECIAL STIPULATIONS
APPLICATION FOR PERMIT TO DRILL OR REENTER

1a. Type of Work: ☒ DRILL ☐ REENTER

b. Type of Well: ☐ Oil Well ☒ Gas Well ☐ Other ☐ Single Zone ☒ Multiple Zone

2. Name of Operator
Yates Petroleum Corporation

3A. Address **105 South Fourth Street
Artesia, New Mexico 88210**

3b. Phone No. (include area code)
(505) 748-1471

4. Location of Well (Report location clearly and in accordance with any State requirements. *)

At surface **760' FNL and 2240' FEL**
At proposed prod. Zone **same as above**

14. Distance in miles and direction from nearest town or post office*
Approximately 30 miles Northeast of Roswell, New Mexico

15. Distance from proposed* location to nearest property or lease line, ft. (Also to nearest drig. unit line, if any)

16. No. of Acres in lease
800

17. Spacing Unit dedicated to this well
320

18. Distance from proposed location* to nearest well, drilling, completed, applied for, on this lease, ft.

19. Proposed Depth
6500'

20. BLM/BIA Bond No. on file
Nationwide Bond #NM-2811

21. Elevations (Show whether DF, KDB, RT, GL, etc.)
3941'

22. Approximate date work will start*
ASAP

23. Estimated duration
30 Days

24. Attachments

The following, completed in accordance with the requirements of Onshore Oil and Gas Order No. 1, shall be attached to this form:

1. Well plat certified by a registered surveyor.
2. A Drilling Plan.
3. A Surface Use Plan (if the location is on National Forest System Lands, the SUPO shall be filed with the appropriate Forest Service Office).
4. Bond to cover the operations unless covered by an existing bond on file (see Item 20 above).
5. Operator certification.
6. Such other site specific information and/or plans as may be required by the authorized office.

25. Signature *Pat Perez* Name (Printed/Typed) **Pat Perez** Date **3/8/01**

Title:

Regulatory Agent

Approved by (Signature) **/S/LARRY D. BRAY**

Name (Printed/Typed)
/S/LARRY D. BRAY

Date
APR 03 2001

Title
Assistant Field Manager,

Office
ROSWELL FIELD OFFICE

APPROVED FOR 1 YEAR

Application approval does not warrant or certify that the applicant holds legal or equitable title to those rights in the subject lease which would entitle the applicant to conduct operations thereon.

Conditions of approval, if any, are attached.

Title 18 U.S.C. Section 1001 and Title 43 U.S.C. Section 1212, make it a crime for any person knowingly and willfully to make to any department or agency of the United States any false, fictitious or fraudulent statements or representations as to any matter within its jurisdiction.

*(Instructions on reverse)

NSL

State of New Mexico

Energy, Minerals and Natural Resources Department

Form C-102

Revised February 10, 1994

Instruction on back

Submit to Appropriate District Office

State Lease - 4 Copies

Fee Lease - 3 Copies

OIL CONSERVATION DIVISION

P.O. Box 2088

Santa Fe, New Mexico 87504-2088

☐ AMENDED REPORT

WELL LOCATION AND ACREAGE DEDICATION PLAT

API Number 30-005-63143	Pool Code	Pool Name Foor Ranch; Precambrian
Property Code	Property Name JASPER "ARJ" FEDERAL	Well Number 2
OGRID No. 025575	Operator Name YATES PETROLEUM CORPORATION	Elevation 3941

Surface Location

UL or lot No. B	Section 25	Township 8S	Range 26E	Lot Idn	Feet from the 760	North/South line NORTH	Feet from the 2240	East/West line EAST	County CHAVES
--------------------	---------------	----------------	--------------	---------	----------------------	---------------------------	-----------------------	------------------------	------------------

Bottom Hole Location If Different From Surface

UL or lot No.	Section	Township	Range	Lot Idn	Feet from the	North/South line	Feet from the	East/West line	County
---------------	---------	----------	-------	---------	---------------	------------------	---------------	----------------	--------

Dedicated Acres 320.00	Joint or Infill	Consolidation Code	Order No.
---------------------------	-----------------	--------------------	-----------

NO ALLOWABLE WILL BE ASSIGNED TO THIS COMPLETION UNTIL ALL INTERESTS HAVE BEEN CONSOLIDATED
OR A NON-STANDARD UNIT HAS BEEN APPROVED BY THE DIVISION

NM-93184

OPERATOR CERTIFICATION

I hereby certify the the information
contained herein is true and complete to the
best of my knowledge and belief.

Pat Perez
Signature

Pat Perez
Printed Name

Regulatory Agent
Title

3-8-01
Date

SURVEYOR CERTIFICATION

I hereby certify that the well location shown
on this plat was plotted from field notes of
actual surveys made by me or under my
supervision, and that the same is true and
correct to the best of my belief.

4/21/07
Date Surveyed
Signature
Professional Surveyor
Certificate No. 3640
JASPER "ARJ" FEDERAL DISK #3
GENERAL SURVEYING COMPANY

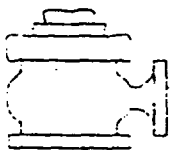

Yates Petroleum Corporation

BOP-2

Typical 2,000 psi Pressure System Schematic

Double Ram Preventer Stack

Yates Petroleum Corporation
Jasper "ARJ" Federal #2
760' FNL and 2240' FEL
Section 25, T8S-R26E
Chaves County, New Mexico
NM-83184
Exhibit C

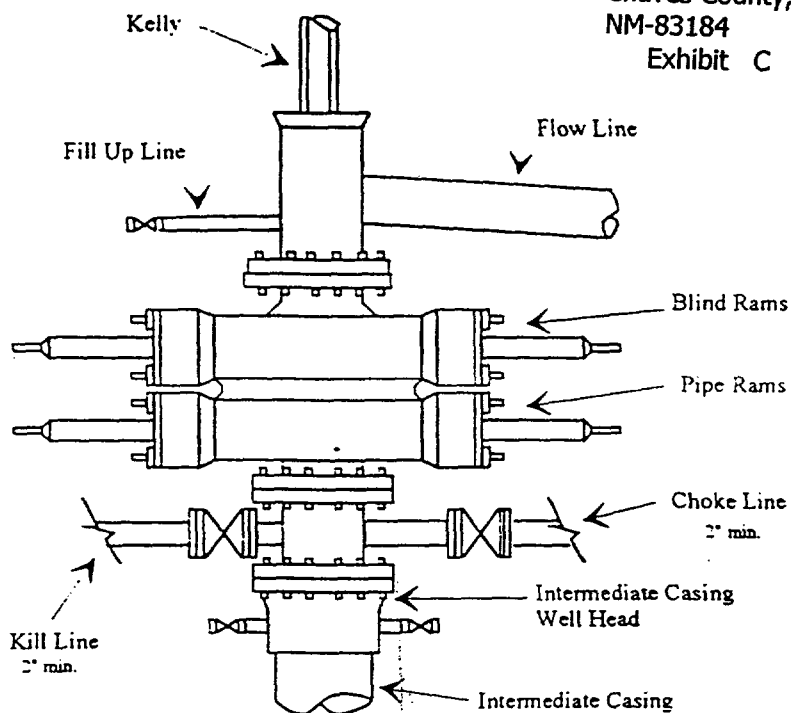

Typical 2,000 psi choke manifold assembly with at least these minimum features

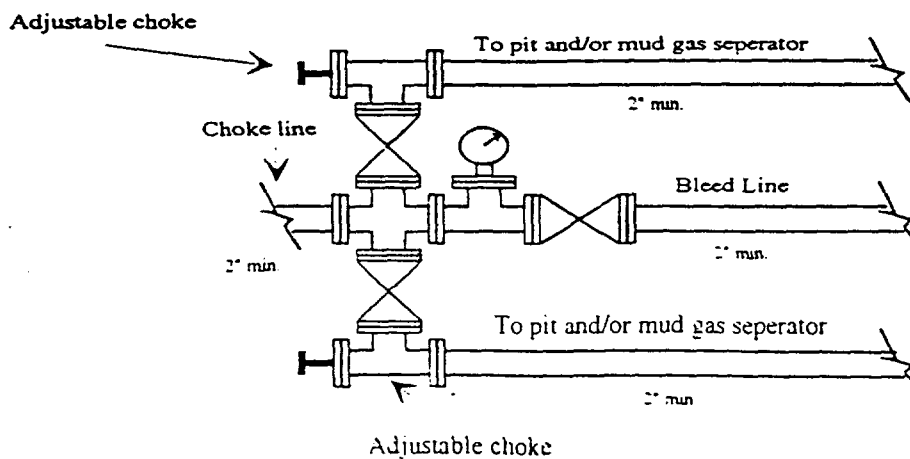

UNITED STATES
DEPARTMENT OF THE INTERIOR
BUREAU OF LAND MANAGEMENT

N.M. Oil Cons. Division

811 S. 1st Street
Artesia, NM 88210-2834

FORM APPROVED
Budget Bureau No. 1004-0135
Expires: March 31, 1993

SUNDRY NOTICES AND REPORTS ON WELLS

Do not use this form for proposals to drill or to deepen or reentry to a different reservoir.
Use "APPLICATION FOR PERMIT—" for such proposals

SUBMIT IN TRIPLICATE

1. Type of Well

☐ Oil Well ☒ Gas Well ☐ Other

2. Name of Operator

YATES PETROLEUM CORPORATION

3. Address and Telephone No.

105 South Fourth Street, Artesia, New Mexico 88210 (505) 748-1471

4. Location of Well (Footage, Sec., T., R., M., or Survey Description)

760' FNL and 2240' FEL
Section 25, T8S-R26E

5. Lease Designation and Serial No.

NM-93184

6. If Indian, Allottee or Tribe Name

7. If Unit or CA, Agreement Designation

8. Well Name and No.

Jasper ARJ Federal #2

9. API Well No.

30-005-63143

10. Field and Pool, or Exploratory Area

Foor Ranch Precambrian

11. County or Parish, State

Chaves County, New Mexico

12. CHECK APPROPRIATE BOX(s) TO INDICATE NATURE OF NOTICE, REPORT, OR OTHER DATA

TYPE OF SUBMISSION

- ☒ Notice of Intent
☐ Subsequent Report
☐ Final Abandonment Notice

TYPE OF ACTION

- ☐ Abandonment
☐ Recompletion
☐ Plugging Back
☐ Casing Repair
☐ Altering Casing
☒ Other- EXTEND APD

- ☐ Change of Plans
☐ New Construction
☐ Non-Routine Fracturing
☐ Water Shut-Off
☐ Conversion to Injection
☐ Dispose Water

(Note: Report results of multiple completion on Well Completion or Recompletion Report and Log form.)

13. Describe Proposed or Completed Operations (Clearly state all pertinent details, and give pertinent dates, including estimated date of starting any proposed work. If well is directionally drilled, give subsurface locations and measured and true vertical depths for all markers and zones pertinent to this work.)*

Yates Petroleum Corporation wishes to extend the captioned well's APD expiration date for one (1) year to July 11, 2000.

Thank you.

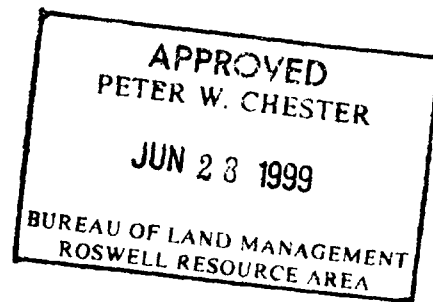

4. I hereby certify that the foregoing is true and correct

Signed [Signature] Title Regulatory Technician Date June 5, 1999

(This space for Federal or State office use)

Approved by _____ Title _____ Date _____
Conditions of approval, if any:

UNITED STATES
DEPARTMENT OF THE INTERIOR
BUREAU OF LAND MANAGEMENT

N.M. 3113. 1st
Artesia, NM

vision

210-2834

FORM APPROVED
Budget Bureau No. 1004-0135
Expires: March 31, 1993

SUNDRY NOTICES AND REPORTS ON WELLS

Do not use this form for proposals to drill or to deepen or reentry to a different reservoir.
Use "APPLICATION FOR PERMIT—" for such proposals

SUBMIT IN TRIPLICATE

1. Type of Well

☐ Oil Well ☒ Gas Well ☐ Other

2. Name of Operator

YATES PETROLEUM CORPORATION

3. Address and Telephone No.

105 South Fourth Street, Artesia, New Mexico 88210 (505) 748-1471

4. Location of Well (Footage, Sec., T., R., M., or Survey Description)

760' FNL and 2240' FEL
Section 25, T8S-R26E

5. Lease Designation and Serial No.
NM-93184

6. If Indian, Allottee or Tribe Name

7. If Unit or CA, Agreement Designation

8. Well Name and No.

Jasper ARJ Federal #2

9. API Well No.

30-005-63143

10. Field and Pool, or Exploratory Area

Foor Ranch Precambrian

11. County or Parish, State

Chaves County, New Mexico

12. CHECK APPROPRIATE BOX(s) TO INDICATE NATURE OF NOTICE, REPORT, OR OTHER DATA

TYPE OF SUBMISSION

- ☒ Notice of Intent
☐ Subsequent Report
☐ Final Abandonment Notice

TYPE OF ACTION

- ☐ Abandonment
☐ Recompletion
☐ Plugging Back
☐ Casing Repair
☐ Altering Casing
☒ Other EXTEND APD
☐ Change of Plans
☐ New Construction
☐ Non-Routine Fracturing
☐ Water Shut-Off
☐ Conversion to Injection
☐ Dispose Water

(Note: Report results of multiple completion on Well Completion or Recompletion Report and Log form.)

13. Describe Proposed or Completed Operations (Clearly state all pertinent details, and give pertinent dates, including estimated date of starting any proposed work. If well is directionally drilled, give subsurface locations and measured and true vertical depths for all markers and zones pertinent to this work.)

Yates Petroleum Corporation wishes to extend the captioned well's APD expiration date for one (1) year to July 11, 1999.

Thank you.

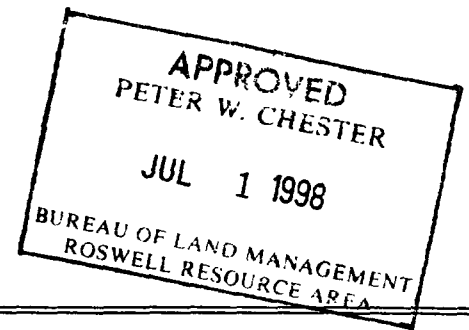

14. I hereby certify that the foregoing is true and correct

Signed

Title

Regulatory Technician

Date

June 2, 1998

(This space for Federal or State office use)

Approved by

Title

Date

Conditions of approval, if any:

UNITED STATES
DEPARTMENT OF THE INTERIOR
BUREAU OF LAND MANAGEMENT

APPLICATION FOR PERMIT TO DRILL OR DEEPEN

1a. TYPE OF WORK

DRILL ☒

DEEPEN ☐

b. TYPE OF WELL

OIL WELL ☐

GAS WELL ☒

OTHER ☐

SINGLE ZONE ☐

MULTIPLE ZONE ☐

2. NAME OF OPERATOR

YATES PETROLEUM CORPORATION

3. ADDRESS AND TELEPHONE NO.

105 South Fourth Street, Artesia, NM 88210 (505) 748-1471

4. LOCATION OF WELL (Report location clearly and in accordance with any State requirements.)*

At surface

760' FNL and 2240' FEL

At proposed prod. zone

Same

14. DISTANCE IN MILES AND DIRECTION FROM NEAREST TOWN OR POST OFFICE*

Approximately 30 miles Northeast of Roswell, New Mexico

15. DISTANCE FROM PROPOSED*

LOCATION TO NEAREST PROPERTY OR LEASE LINE, FT.
(Also to nearest drlg. unit line, if any)

18. DISTANCE FROM PROPOSED LOCATION*

TO NEAREST WELL, DRILLING, COMPLETED, OR APPLIED FOR, ON THIS LEASE, FT.

21. ELEVATIONS (Show whether DF, RT, GR, etc.)

3941' GR

23.

PROPOSED CASING AND CEMENTING PROGRAM

SIZE OF HOLE	GRADE SIZE OF CASING	WEIGHT PER FOOT	SETTING DEPTH	QUANTITY OF CEMENT
12 1/4"	8 5/8" J-55	24.0#	900'	500 sacks
5 1/2"	5 1/2" J-55	15.5#	TD	800 sacks

Yates Petroleum Corporation proposes to drill and test the Precambrian and intermediate formations. Approximately 900' of surface casing will be set and cement circulated. If commercial, production casing will be run and cemented with adequate cover, perforated and stimulated as needed for production.

MUD PROGRAM: FW Gel, Paper, LCM to 1000'; Brine to 4500'; Polyachrilamide 4500' to TD.

BOPE PROGRAM: BOPE will be nipples up on the 8 5/8" casing and tested daily for operational.

GAS NOT DEDICATED:

IN ABOVE SPACE DESCRIBE PROPOSED PROGRAM: If proposal is to deepen, give data on present productive zone and proposed new productive zone. If proposal is to drill or deepen directionally, give pertinent data on subsurface locations and measured and true vertical depths. Give blowout preventer program, if any.

24.

SIGNED

Clifton R. May

TITLE Regulatory Agent

DATE June 3, 1997

(This space for Federal or State office use)

PERMIT NO.

APPROVAL DATE

Application approval does not warrant or certify that the applicant holds legal or equitable title to those rights in the subject lease which would entitle the applicant to conduct operations thereon.

CONDITIONS OF APPROVAL, IF ANY:

APPROVED BY

TR Keegan

TITLE

Area Manager

DATE

7/11/97

*See Instructions On Reverse Side

DISTRICT I
Box 1980, Hobbs, NM 88240
DISTRICT II
Box 1980, Hobbs, NM 88240

State of New Mexico
Energy, Minerals and Natural Resources Department

Form C-102
Revised February 10, 1994
Instruction on back
Submit to Appropriate District Office
State Lease - 4 Copies
Fee Lease - 3 Copies

DISTRICT III
1000 Rio Brazos Rd., Aztec, NM 87410

OIL CONSERVATION DIVISION

P.O. Box 2088
Santa Fe, New Mexico 87504-2088

☐ AMENDED REPORT

WELL LOCATION AND ACREAGE DEDICATION PLAT

API Number	Pool Code	Pool Name WILDCAT PRECAMBRIAN
Property Code	Property Name JASPER "ARJ" FEDERAL	Well Number 2
OGRID No. 025575	Operator Name YATES PETROLEUM CORPORATION	Elevation 3941

Surface Location

UL or lot No. B	Section 25	Township 8S	Range 26E	Lot Idn	Feet from the 760	North/South line NORTH	Feet from the 2240	East/West line EAST	County CHAVES
---------------------------	----------------------	-----------------------	---------------------	---------	-----------------------------	----------------------------------	------------------------------	-------------------------------	-------------------------

Bottom Hole Location If Different From Surface

UL or lot No.	Section	Township	Range	Lot Idn	Feet from the	North/South line	Feet from the	East/West line	County
---------------	---------	----------	-------	---------	---------------	------------------	---------------	----------------	--------

Dedicated Acres 320	Joint or Infill	Consolidation Code	Order No.
-------------------------------	-----------------	--------------------	-----------

NO ALLOWABLE WILL BE ASSIGNED TO THIS COMPLETION UNTIL ALL INTERESTS HAVE BEEN CONSOLIDATED
OR A NON-STANDARD UNIT HAS BEEN APPROVED BY THE DIVISION

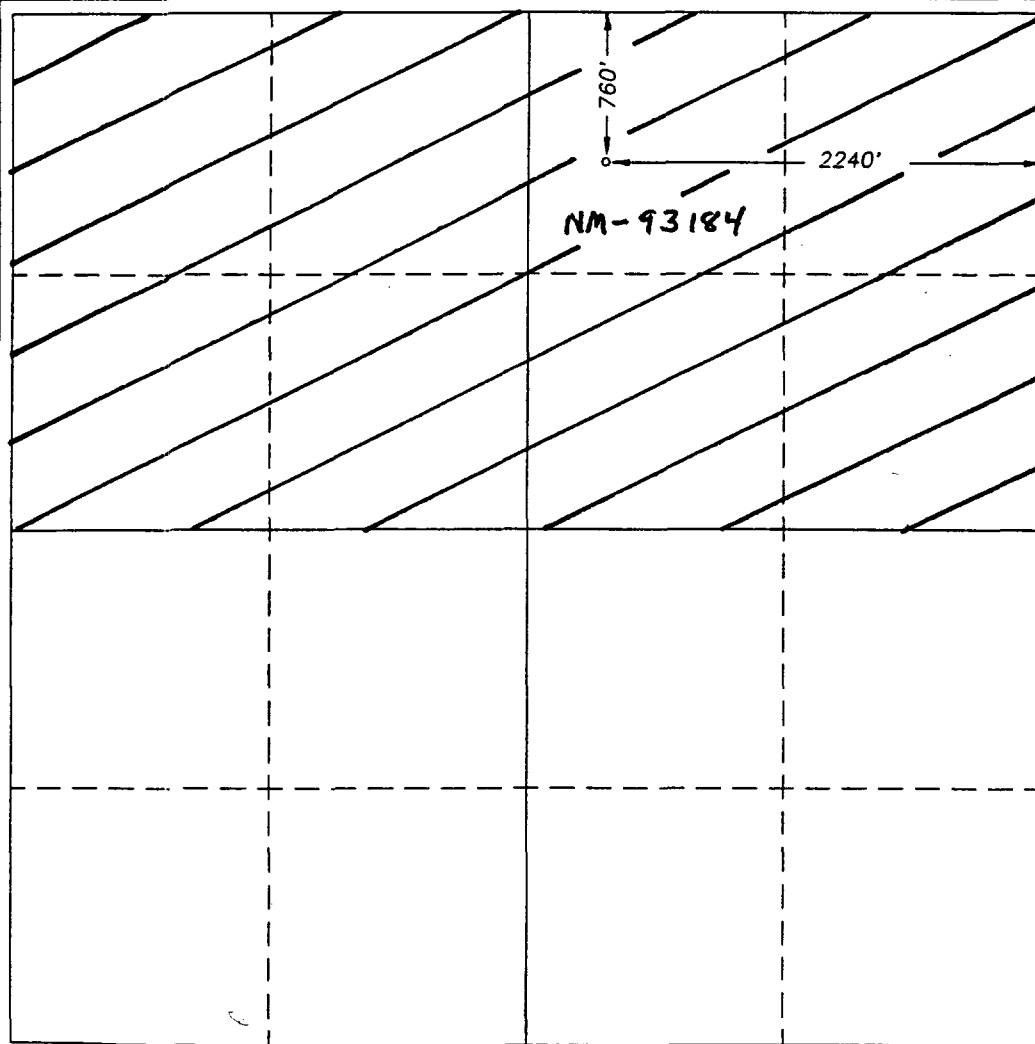

OPERATOR CERTIFICATION

I hereby certify the the information
contained herein is true and complete to the
best of my knowledge and belief.

Clifton R. May
Signature

Clifton R. May
Printed Name

Regulatory Agent
Title

June 3, 1997
Date

SURVEYOR CERTIFICATION

I hereby certify that the well location shown
on this plat was plotted from field notes of
actual surveys made by me or under my
supervision, and that the same is true and
correct to the best of my belief.

4/21/97
Date Surveyed
HERSCHELL JONES
Signature
Professional Surveyor
3640
Certificate No. **HERSCHELL JONES RLS 3640**
JASPER "ARJ" FEDERAL
DISK #3
GENERAL SURVEYING COMPANY

YATES PETROLEUM CORPORATION

TYPICAL 3,000 p.s.i. BLOWOUT PREVENTER SCHEMATIC

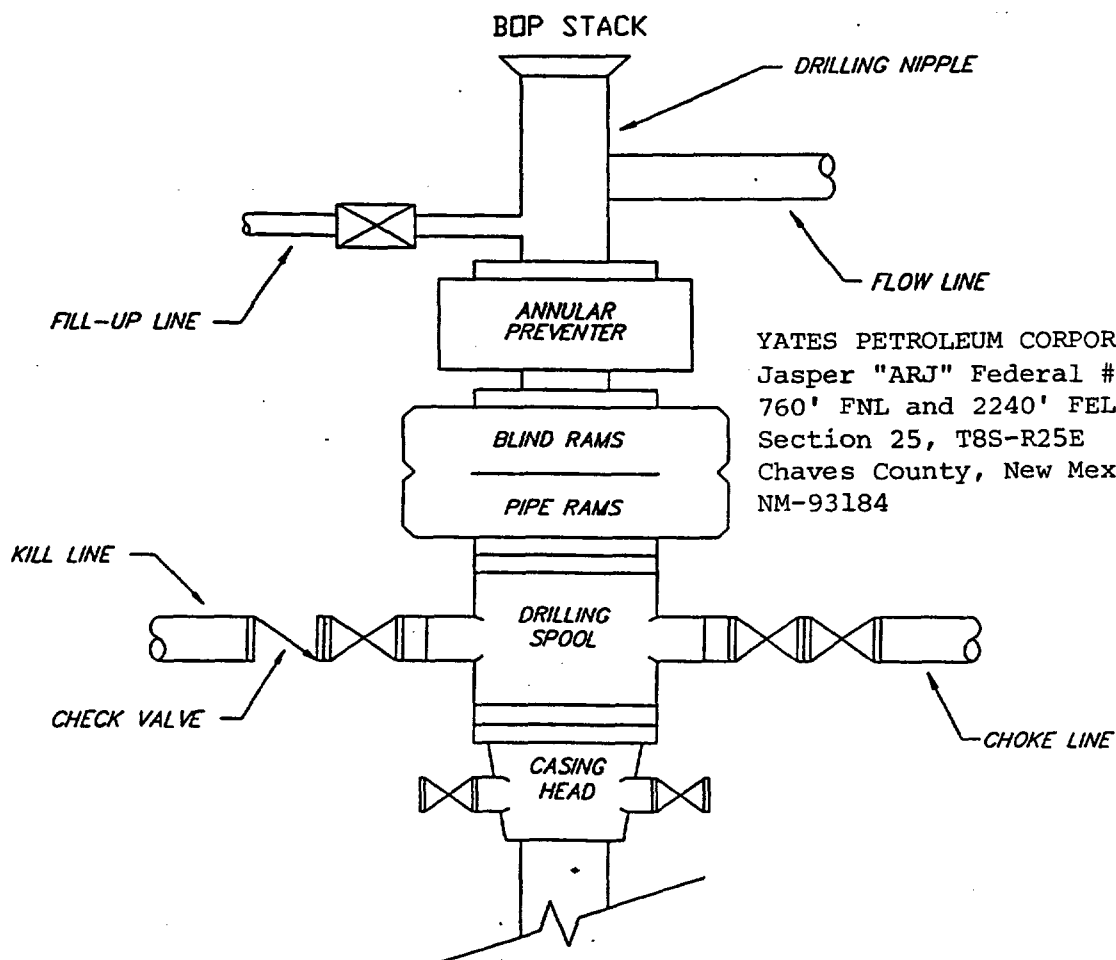

YATES PETROLEUM CORPORATION
Jasper "ARJ" Federal #2
760' FNL and 2240' FEL
Section 25, T8S-R25E
Chaves County, New Mexico
NM-93184

TYPICAL 3,000 p.s.i. CHOKE MANIFOLD SCHEMATIC

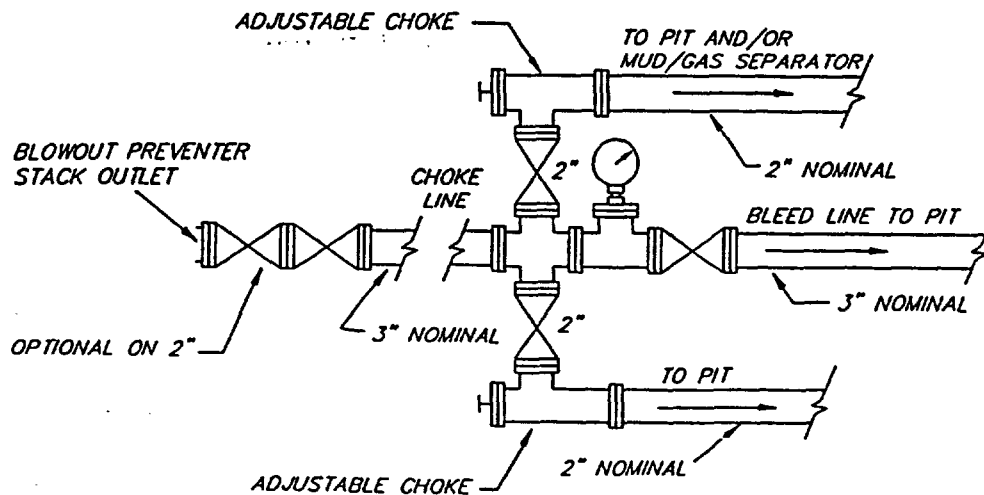

WRS COMPLETION REPORT			
COMPLETIONS	SEC 25 TWP 8S RGE 26E	PAGE 1	
30-T-0001 10/02/98	30-005-63143-0000		
NMEX	CHAVES	* 760FNL 2240FEL SEC	
STATE	COUNTY	FOOTAGE	SPOT
YATES PET			WD
OPERATOR		WELL CLASS INIT	FIN
2	JASPER 'ARJ' FEDERAL		
WELL NO.	LEASE NAME		
3941GR		WILDCAT	
OPER ELEV		FIELD/POOL/AREA	
		API 30-005-63143-0000	
	LEASE NO.	PERMIT OR WELL I.D. NO.	
	09/28/1998	ROTARY VERT	AB-LOC
SPUD DATE	COMP. DATE	TYPE TOOL	HOLE TYPE
6500 PR CMBRN			
PROJ. DEPTH	PROJ. FORM	CONTRACTOR	
DRILLERS T.D.	LOG T.D.	PLUG BACK TD	OLD T.D.
			FORM T.D.
LOCATION DESCRIPTION			
30 MI NE ROSWELL, NM			
1 MI W/1890 (SADR) OIL PROD IN UNNAMED FIELD			
DRILLING PROGRESS DETAILS			
	YATES PET		
	105 S 4TH ST		
	ARTESIA, NM 88210		
	505-748-1471		
06/09	LOC/1997/		
09/28	ABND LOC		
IC# 300057003297			

COPYRIGHT 1998



Petroleum Information /
Dwrights LLC

P/D-WRS-GET
Form No 187

CMD :
OG5SECT

ONGARD
INQUIRE LAND BY SECTION

07/02/01 17:13:26
OGOMES -TPF4
PAGE NO: 1

Sec : 25 Twp : 08S Rng : 26E Section Type : NORMAL

D 40.00	C 40.00	B 40.00	A 40.00
Federal owned	Federal owned	Federal owned A	Federal owned
E 40.00	F 40.00	G 40.00	H 40.00
Federal owned	Federal owned	Federal owned	Federal owned

PF01 HELP	PF02	PF03 EXIT	PF04 GoTo	PF05	PF06
PF07 BKWD	PF08 FWD	PF09 PRINT	PF10 SDIV	PF11	PF12

CMD :
OG5SECT

ONGARD
INQUIRE LAND BY SECTION

07/02/01 17:13:29
OGOMES -TPF4
PAGE NO: 2

Sec : 25 Twp : 08S Rng : 26E Section Type : NORMAL

L 40.00	K 40.00	J 40.00	I 40.00
Federal owned	Federal owned	Federal owned	Federal owned
M 40.00	N 40.00	O 40.00	P 40.00
Federal owned	Federal owned	Federal owned A	Federal owned

PF01 HELP
PF07 BKWD

PF02
PF08 FWD

PF03 EXIT
PF09 PRINT

PF04 GoTo
PF10 SDIV

PF05
PF11

PF06
PF12

County CHAVES

Pool FOOR RANCH - PrePermian GAS

TOWNSHIP

8 S

Range

26 E

NMPM

6	5	4	3	2	1	
7	8	9	10	11	12	
18	17	16	15	14	13	
19	20	21	22	23	24	
30	29	28	27	26	25	
31	32	33	34	35	36	

Ext: All Sec. 36 (A-9241, 7-31-90)

County CHAVES

Pool FOOR RANCH - PrePERMIAN GAS

TOWNSHIP 8 South, RANGE 27 East, NEW MEXICO PRINCIPAL MERIDIAN

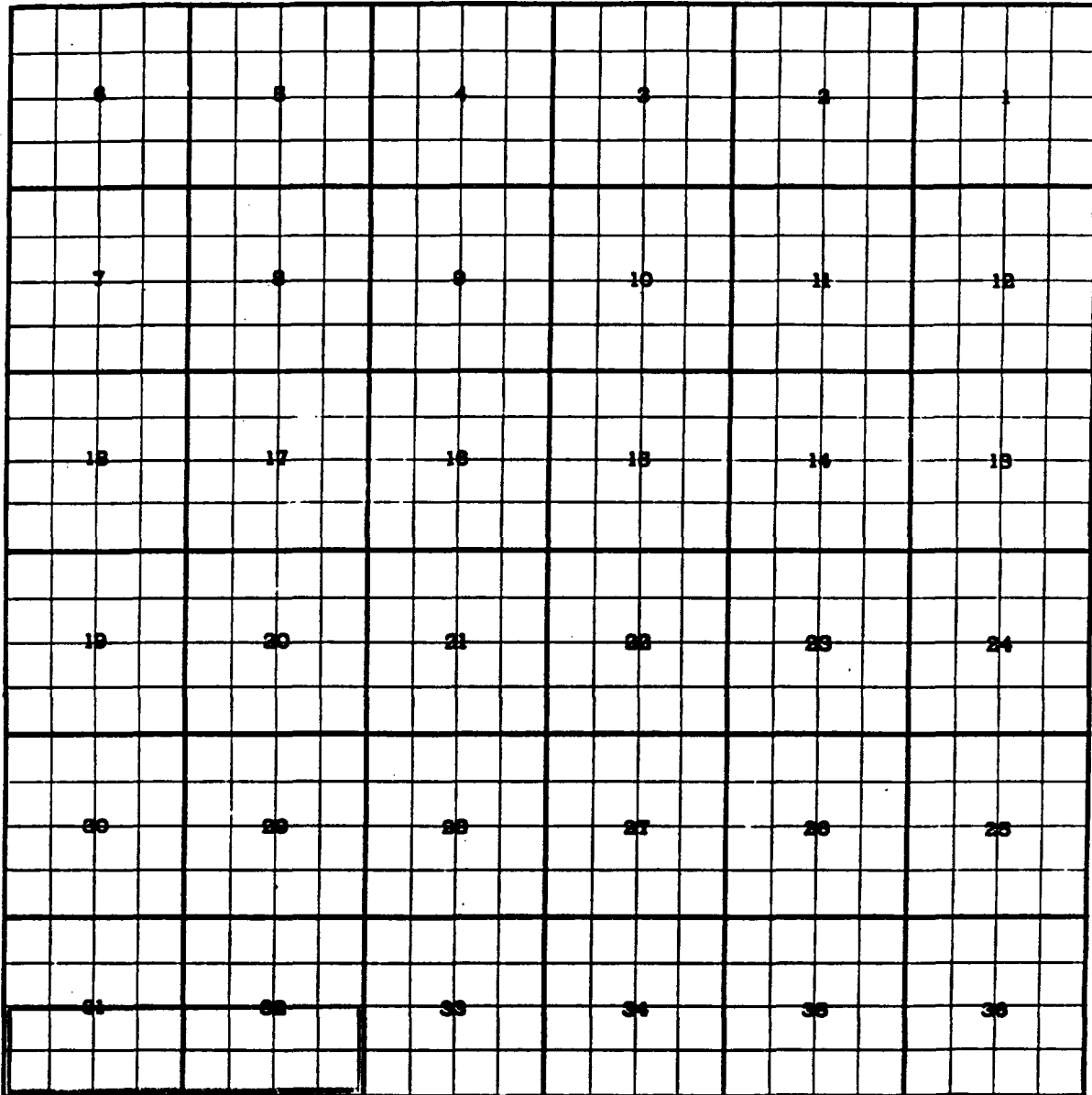

EXT: 5/2 SEC 31, 5/2 SEC 32 (R-9017, 11-1-89)

county Chaves Pool Foor Ranch-PrePermian Gas

TOWNSHIP 9 South

Range 26 East

NMPM

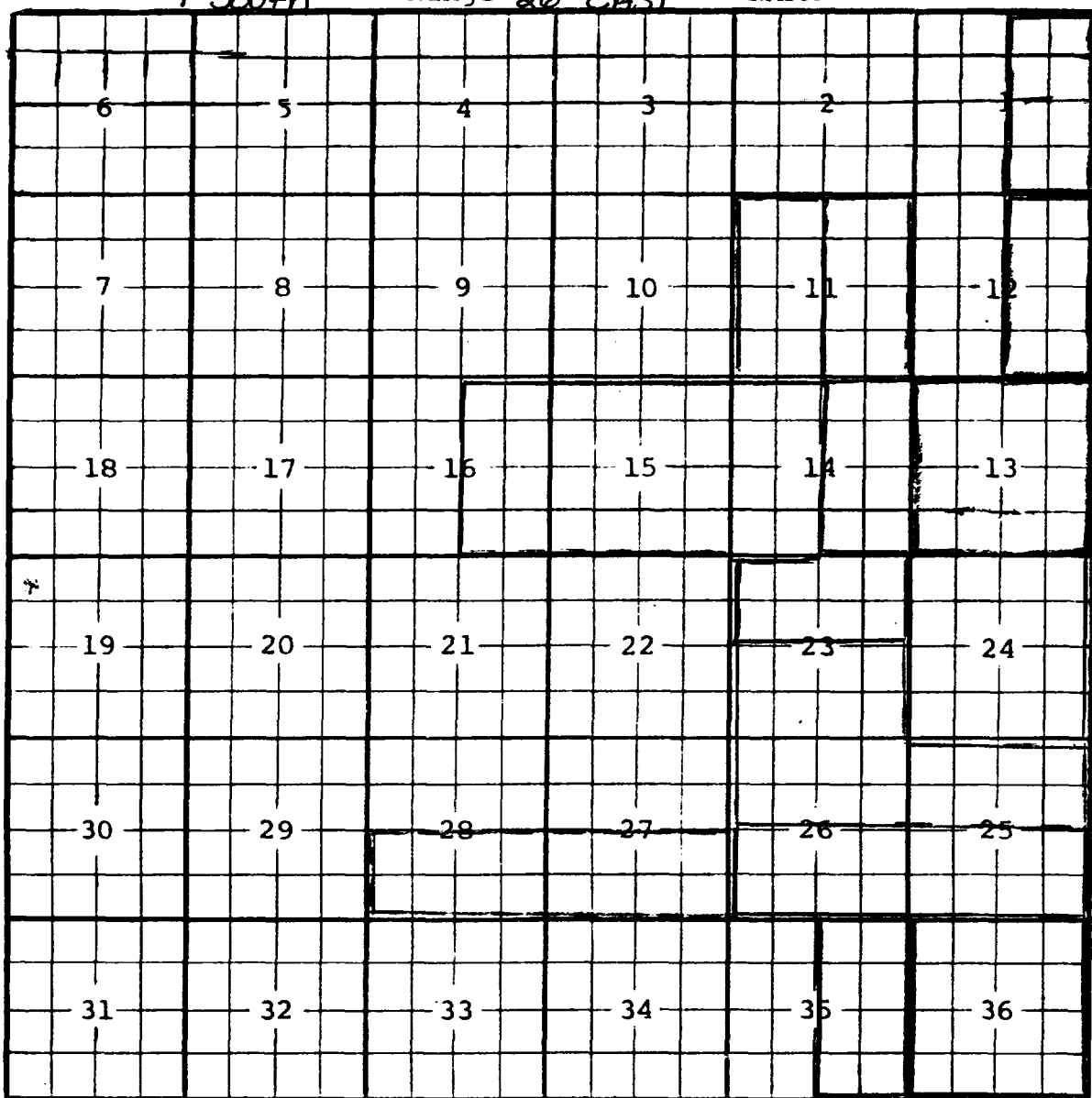

Description: Sec: 1 $\frac{E}{2}$, Sec: 12 $\frac{E}{2}$, Sec: 13 All (R-7048, 8-9-82)

Ext: $\frac{E}{2}$ Sec. 14 (R-7302, 6-14-83) Ext: $\frac{N}{2}$ Sec. 23 (R-7437, 2-6-84)

Ext: $\frac{W}{2}$ Sec. 14, All Sec. 15, $\frac{E}{2}$ Sec. 16 (R-7708, 10-25-84)

Ext: $\frac{E}{2}$ Sec. 11 (R-8592, 1/25/88) Ext: $\frac{W}{2}$ Sec. 11 (R-8665, 6/9/88)

Ext: $\frac{S}{2}$ Sec. 23, $\frac{N}{2}$ Sec. 25, $\frac{N}{2}$ Sec. 26 (R-8747, 9/19/88) Ext: $\frac{S}{2}$ Sec. 25, $\frac{S}{2}$

Sec. 26 (R-8827, 12-22-88) Ext: All Sec. 24 (R-8847, 1-10-89)

Ext: All Sec. 36 (R-8945, 5-31-89) Ext: $\frac{E}{2}$ Sec. 35 (R-8969, 8-1-89)

Ext: $\frac{S}{2}$ Sec. 27, $\frac{S}{2}$ Sec. 28 (R-9326, 11-7-90)

county Chaves Pool Foor Ranch-Ac Permian Gas

TOWNSHIP 9 South

Range 27 East

NMPM

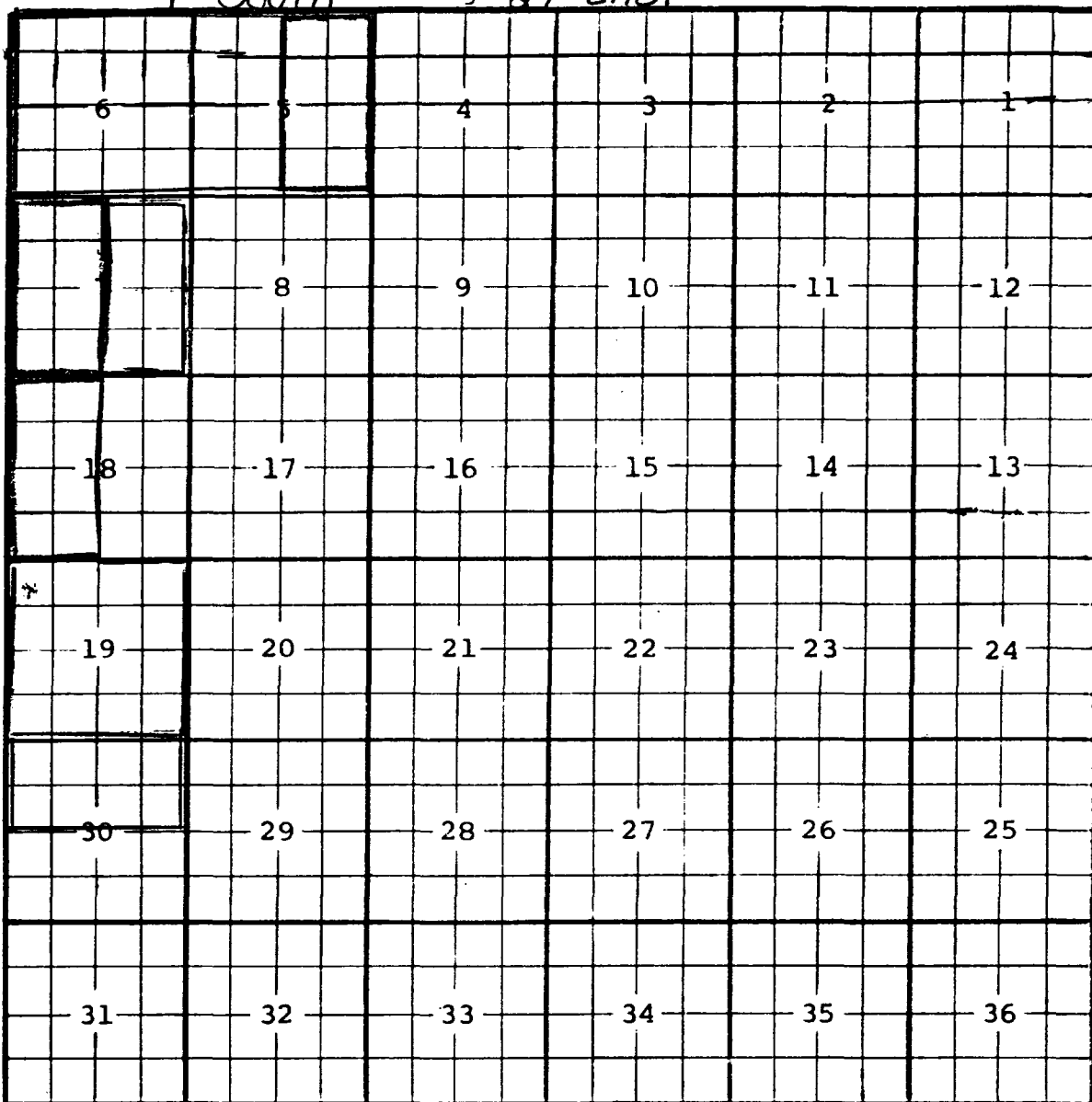

Description: Sec. 7 $\frac{W}{2}$, Sec. 18 $\frac{W}{2}$ (R-7048, 8-9-82)

Ext: All Sec. 19 (R-7302, 6-14-83), $\frac{E}{2}$ SEC 7 (R-8627, 4-1-88)

EXT: N/2 SEC 30 (R-8847, 1-10-89) EXT: W/2 SEC 5, All Sec 6 (R-9017, 11-1-89) EXT: $\frac{E}{2}$ SEC 5 (R-9096, 1-1-90)

County CHAVES

Pool FOOR RANCH-PREPERMIAN
GAS

TOWNSHIP 10 S, RANGE 26 East, NEW MEXICO PRINCIPAL MERIDIAN

6	5	4	3	2		
7	8	9	10	11	12	
13	17	18	15	14	13	
19	20	21	22	23	24	
26	29	28	27	26	25	
31	32	33	34	35	36	

EXT: N/2 SEC 1, (R 8969, 8-1-89)

Stogner, Michael

From: Arrant, Bryan
Sent: Tuesday, July 03, 2001 9:52 AM
To: Stogner, Michael
Subject: RE: Foor Ranch area

The Foor Ranch; Pre-Permian Gas Pool vertical limits cover the T/Cisco all the down to granite wash. I have not been able to find anything in writing about this pool as far as defining vertical limits, however I remember asking Mark Ashley about this one time and he informed me this was the case.

The APDs in 25-8-26 should be Undesignated Foor Ranch; Pre-Permian Gas.

The Pool code would be 76730.

From: Stogner, Michael
Sent: Tuesday, July 03, 2001 8:42 AM
To: Arrant, Bryan
Subject: Foor Ranch area

I need some help please. What is the vertical limits of the Foor Ranch-PrePermian Gas Pool (76730) created by R-7048 in 1982? I also show the name Foor Ranch-Pre Cambrian Gas Pool appears on two APD's in Section 25-T8S-R26E, what is this pool, when was it created, and where can I find it? Thanks.