



NEW MEXICO ENERGY, MINERALS and NATURAL RESOURCES DEPARTMENT

GARY E. JOHNSON
Governor
Jennifer A. Salisbury
Cabinet Secretary

October 16, 2001

Lori Wrotenbery
Director
Oil Conservation Division

Marathon Oil Company
P. O. Box 552
Midland, Texas 79702-0552
Attention: Tim Chase
TChase@MarathonOil.com

Administrative Order NSL-4653 (SD)

Dear Mr. Chase:

Reference is made to the following: (i) your application submitted to the New Mexico Oil Conservation Division ("Division") on September 14, 2001 (*application reference No. pKRV0-126054240*); and (ii) the records of the Division in Santa Fe, including the files in Division Case No. 752 and on Division Administrative Orders SD-94-2 and SD-94-2.1: all concerning Marathon Oil Company's ("Marathon") requests for an unorthodox Eumont infill gas well location within an existing non-standard 160-acre gas spacing and proration unit ("GPU") in the Eumont Gas Pool (76480) comprising the S/2 N/2 of Section 9, Township 20 South, Range 37 East, NMPM, Lea County, New Mexico.

The rules and procedures currently governing the Eumont Gas Pool include but are not necessarily limited to:

- (i) the "*Special Rules and Regulations for the Eumont Gas Pool*," as promulgated by Division Order No. R-8170, as amended;
- (ii) Division Rule 605.B;
- (iii) Division Rule 104.F, revised by Division Order No. R-11231, issued by the New Mexico Oil Conservation Commission in Case No. 12119 on August 12, 1999;
- (iv) Rule 1207.A (2); and
- (v) the amended Stipulated Declaratory Judgment of the First Judicial District Court in Santa Fe County, New Mexico issued on July 11, 2001 in Hartman vs. Oil Conservation Division, Cause No. D-0101-CV-9902927 ("Stipulated Declaratory Judgment").

By Division Order No. R-577, issued in Case No. 752 on October 4, 1954, as amended by

Division Order No. R-527-A on November 26, 1954, this 160-acre GPU was initially established for the W. H. Laughlin Well No. 3 (**API No. 30-025-06036**), located at a standard gas well location for this GPU 1980 feet from the North and East lines (Unit G) of Section 9.

As referenced by Division correspondence dated February 4, 1994 entitled "Administrative Order SD-94-2" the Division acknowledged the addition of the following described initial infill well at a standard gas well location for this GPU:

W. H. Laughlin Well No. 5 (**API No. 30-025-32380**, located 1980 feet from the North line and 710 feet from the East line (Unit H) of Section 9.

The most recent correspondence from the Division to address this GPU and the number of wells simultaneously dedicated to it was "Administrative Order SD-94-2.1", dated November 10, 1994, which acknowledged the addition of the W. H. Laughlin Well No. 6 (**API No. 30-025-32465**), located at a standard infill gas well location for this GPU 1980 feet from the North line and 2250 feet from the West line (Unit F) of Section 9.

It is our understanding that the subject well to be considered at this time is currently completed in the Monument-Tubb Pool at a standard oil well location within a standard 80-acre lay-down oil spacing and proration unit comprising the S/2 NW/4 of Section 9; however, it is to be plugged back and recompleted up-hole into the Eumont Gas Pool upon issuance of this order. Pursuant to Rule 2 (b) 4 of the Eumont special pool rules, this location is considered to be unorthodox for the subject 160-acre GPU.

By the authority granted me under the provisions of these rules, regulations, and directives, the following described well, located at an unorthodox Eumont infill gas well location in Section 9, is hereby approved:

**W. H. Laughlin Well No. 7
2310' FNL & 940' FWL (Unit E)
(API No. 30-025-33141).**

Also, Marathon is hereby authorized to simultaneously dedicate Eumont gas production from the W. H. Laughlin Wells No. 3, 5, 6, and 7. Furthermore, Marathon is permitted to produce the allowable assigned the subject 160-acre GPU from all four wells in any proportion

It is further ordered that all provisions applicable to the subject GPU in Division Orders No. R-527 and R-527-A and Division Administrative Orders SD-94-2 and SD-94-2.1, not in conflict with this order, shall remain in full force and affect until further notice.

Administrative Order NSL-4653(SD)
Marathon Oil Company
October 16, 2001
Page 3

Jurisdiction of this matter shall be further retained for the entry of any such subsequent orders, as the Division may deem necessary.

Sincerely,

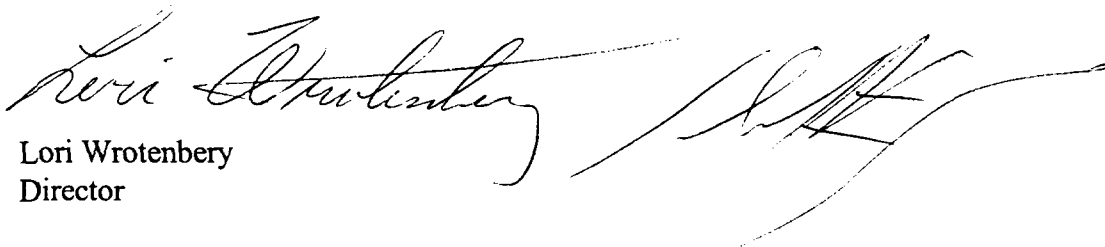
A handwritten signature in cursive script, appearing to read "Lori Wrotenbery", followed by a large, stylized flourish or second signature.

Lori Wrotenbery
Director

LW/MES/kv

cc: New Mexico Oil Conservation Division - Hobbs
File: SD-94-2
SD-94-2.1

DATE 9/14/01	ENGINEER MS	LOGGED IN KN	NSL(SD)	APP NO 126054240
-----------------	----------------	-----------------	---------	---------------------

ABOVE THIS LINE FOR DIVISION USE ONLY

NEW MEXICO OIL CONSERVATION DIVISION
- Engineering Bureau -
1220 South St. Francis Drive, Santa Fe, NM 87505



ADMINISTRATIVE APPLICATION CHECKLIST

THIS CHECKLIST IS MANDATORY FOR ALL ADMINISTRATIVE APPLICATIONS FOR EXCEPTIONS TO DIVISION RULES AND REGULATIONS WHICH REQUIRE PROCESSING AT THE DIVISION LEVEL IN SANTA FE

Application Acronyms:

[NSL-Non-Standard Location] [NSP-Non-Standard Proration Unit] [SD-Simultaneous Dedication]
[DHC-Downhole Commingling] [CTB-Lease Commingling] [PLC-Pool/Lease Commingling]
[PC-Pool Commingling] [OLS - Off-Lease Storage] [OLM-Off-Lease Measurement]
[WFX-Waterflood Expansion] [PMX-Pressure Maintenance Expansion]
[SWD-Salt Water Disposal] [IPI-Injection Pressure Increase]
[EOR-Qualified Enhanced Oil Recovery Certification] [PPR-Positive Production Response]

[1] TYPE OF APPLICATION - Check Those Which Apply for [A]

- [A] Location - Spacing Unit - Simultaneous Dedication**
☒ NSL ☐ NSP ☒ SD

Check One Only for [B] or [C]

- [B] Commingling - Storage - Measurement**
☐ DHC ☐ CTB ☐ PLC ☐ PC ☐ OLS ☐ OLM

- [C] Injection - Disposal - Pressure Increase - Enhanced Oil Recovery**
☐ WFX ☐ PMX ☐ SWD ☐ IPI ☐ EOR ☐ PPR

- [D] Other: Specify _____**

[2] NOTIFICATION REQUIRED TO: - Check Those Which Apply, or Does Not Apply

- [A]** ☐ Working, Royalty or Overriding Royalty Interest Owners
- [B]** ☒ Offset Operators, Leaseholders or Surface Owner
- [C]** ☐ Application is One Which Requires Published Legal Notice
- [D]** ☐ Notification and/or Concurrent Approval by BLM or SLO
U.S. Bureau of Land Management - Commissioner of Public Lands, State Land Office
- [E]** ☐ For all of the above, Proof of Notification or Publication is Attached, and/or,
- [F]** ☐ Waivers are Attached

[3] SUBMIT ACCURATE AND COMPLETE INFORMATION REQUIRED TO PROCESS THE TYPE OF APPLICATION INDICATED ABOVE.

[4] CERTIFICATION: I hereby certify that the information submitted with this application for administrative approval is **accurate** and **complete** to the best of my knowledge. I also understand that **no action** will be taken on this application until the required information and notifications are submitted to the Division.

Note: Statement must be completed by an individual with managerial and/or supervisory capacity.

<u>Tim L. Chase</u>	<u>[Signature]</u>	<u>Advanced Engineer Tech</u>	<u>9-7-01</u>
Print or Type Name	Signature	Title	Date
		<u>TChase@MarathonOil.com</u>	
		e-mail Address	

Southern Business Unit
Domestic Production



01 SEP 11 1991
P.O. Box 552
Midland, TX 79702-0552
Telephone 915/682-1626

September 7, 2001

**RE: Application to Simultaneously Dedicate
Eumont Gas Pool Production**

**RE: Request for Exception to Rule 104
Application for Non-Standard Gas Well Location
for the Eumont Gas Pool
W.H. Laughlin Well No. 7 (API 30-025-33141)
Unit Letter E, 2310' FNL & 940' FWL
Section 9, T-20-S, R-37-E
Lea County, New Mexico**

Mr. Michael Stogner
State of New Mexico
Oil Conservation Division
2040 South Pacheco
Santa Fe, New Mexico 87505

Dear Mr. Stogner:

Marathon Oil Company request administrative approval for a Non-Standard Gas Well Location in the Eumont Gas Pool for the W.H. Laughlin Well No. 7. This well has been a Monument (Tubb) oil producer since January, 1996 after the Blinbry zone tested unproductive.

We also respectfully request authorization to simultaneously dedicate this well to the non-standard Eumont Gas Proration Unit (Division Order No. R-527-A) which consists of ¹⁶⁰~~320~~ acres. This non-standard gas proration unit is comprised of the S/2 N/2 of Section 9, T-20-S, R-37-E, NMPM in Lea County, New Mexico.

Current Orders are:

Division Order No. R-527-A applies to the 160 acre non-standard gas proration unit.
Administrative Order No. SD-94-2.1 applies to the simultaneous dedication of the 160 acre non-standard gas proration unit.
Commission Order No. PC-979 (7-23-98) for downhole commingling applies to the subject well.

Upon approval to this application, the wells on this lease that will be simultaneously dedicated to this non-standard gas proration unit for the Eumont Gas Pool production are:

W.H. Laughlin Well No. 3	API No. 30-025-06036
W.H. Laughlin Well No. 5	API No. 30-025-32380
W.H. Laughlin Well No. 6	API No. 30-025-32465
W.H. Laughlin Well No. 7	API No. 30-025-33141

Attached is a form C-102 for the subject well. We have sent this same information to the offset operators. If you have any questions or have need of additional data, please contact me at (915) 687-8408 or e-mail me at TChase@MarathonOil.com.

Sincerely,

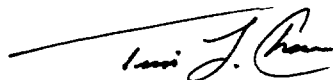
A handwritten signature in black ink, appearing to read "Tim L. Chase". The signature is fluid and cursive, with a long horizontal line extending from the left.

Tim L. Chase
Advanced Engineer Technician
Marathon Oil Company
Southern Business Unit

OFFSET OPERATORS
Lease NM - 297 – W.H. Laughlin
S/2 N/2 of Section 9, T-20-S, R-37-E, N.M.P.M.
Lea County, New Mexico
Monument Field

T-20-S, R-37-E

Section 8: Chevron USA Inc.
Attn: Ray Vaden
P.O. Box 1150
Midland, Texas 79702

Arch Petroleum, Inc.
801 Cherry Street, Suite 1040
Fort Worth, TX 76102-6810

Doyle Hartman
P.O. Box 10426
Midland, TX 79702-7426

Texaco Exploration & Production, Inc.
P.O. Box 3109
Midland, TX 79702-3109

Mid-Continent Energy Operating Company
100 W. 5th Street, Suite 450
Tulsa, OK 74103-4287

Amerada Hess Corporation
Production Operations – Onshore
P.O. Box 2040
Houston, TX 77252-2040

Section 9: Amerada Hess Corporation

Texaco Exploration & Production, Inc.

Section 10: Conoco, Inc.
600 North Dairy Ashford Drive
Houston, TX 77079-1175

Gruy Petroleum Management Company
1601 North Turner
Hobbs, NM 88240

Texaco Exploration & Production, Inc.

District I

1625 N. French Dr., Hobbs, NM 88240

District II

811 South First, Artesia, NM 88210

District III

1000 Rio Brazos Rd., Aztec, NM 87410

District IV

1220 S. St. Francis Dr., Santa Fe, NM 87505

State of New Mexico
Energy, Minerals & Natural Resources DepartmentOIL CONSERVATION DIVISION
1220 South St. Francis Dr.
Santa Fe, NM 87505Form C-102
Revised August 15, 2000
Submit to Appropriate District Office
State Lease - 4 Copies
Fee Lease - 3 Copies☐ AMENDED REPORT

WELL LOCATION AND ACREAGE DEDICATION PLAT

¹ API Number 30-025-33141		² Pool Code 76480		³ Pool Name Eumont (Yates, 7 Rivers, Queen)	
⁴ Property Code 6421		⁵ Property Name W.H. Laughlin			⁶ Well Number 7
⁷ OGRID No. 014021		⁸ Operator Name Marathon Oil Company			⁹ Elevation 3554'

¹⁰ Surface Location

UL or lot no.	Section	Township	Range	Lot Idn	Feet from the	North/South line	Feet from the	East/West line	County
E	9	20S	37E	-	2310	North	940	West	Lea

¹¹ Bottom Hole Location If Different From Surface

UL or lot no.	Section	Township	Range	Lot Idn	Feet from the	North/South line	Feet from the	East/West line	County

¹² Dedicated Acres 160	¹³ Joint or Infill Joint	¹⁴ Consolidation Code -	¹⁵ Order No. SD -94-2.1
--------------------------------------	--	---------------------------------------	---------------------------------------

NO ALLOWABLE WILL BE ASSIGNED TO THIS COMPLETION UNTIL ALL INTERESTS HAVE BEEN CONSOLIDATED OR A
NON-STANDARD UNIT HAS BEEN APPROVED BY THE DIVISION

				¹⁷ OPERATOR CERTIFICATION I hereby certify that the information contained herein is true and complete to the best of my knowledge and belief. Signature Tim L. Chase Printed Name Advanced Engineer Technician Title September 7, 2001 Date
				¹⁸ SURVEYOR CERTIFICATION I hereby certify that the well location shown on this plat was plotted from field notes of actual surveys made by me or under my supervision, and that the same is true and correct to the best of my belief. Date of Survey Signature and Seal of Professional Surveyor: Certificate Number John W. West 676 Ronald J. Eidson 3239 Gary L. Jones 7977

**Marathon Oil Company
W.H. Laughlin Lease
Lease NM - 296
Section 9, T-20-S, R-37-E
Lea County, New Mexico**

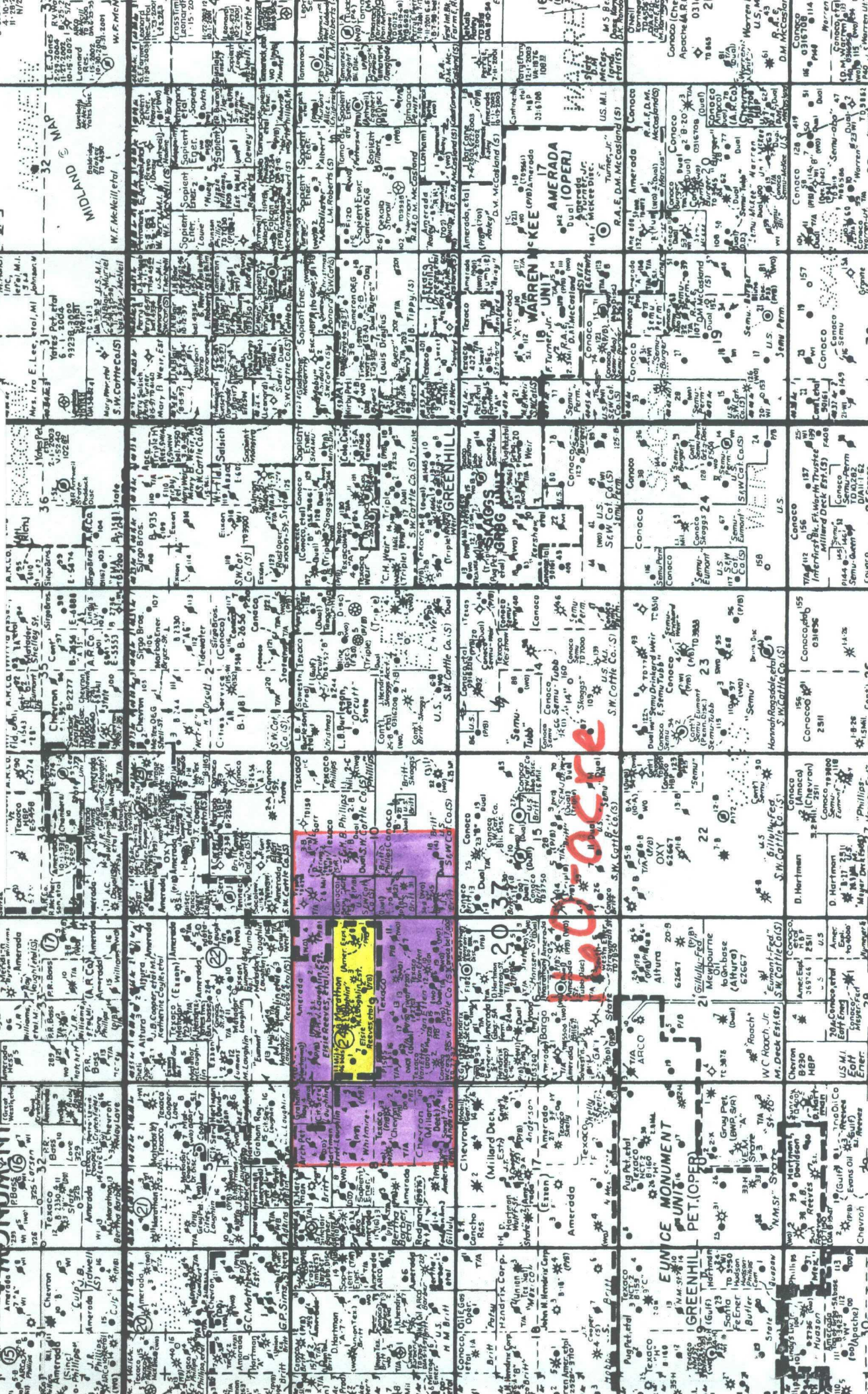

September 7, 2001

<<Company>>
<<Address>>
<<City, State Zip Code>>

**RE: Application to Simultaneously Dedicate
Eumont Gas Pool Production**

**RE: Request for Exception to Rule 104
Application for Non-Standard Gas Well Location
for the Eumont Gas Pool
W.H. Laughlin Well No. 7
Unit Letter E, 2310' FNL & 940' FWL
Section 9, T-20-S, R-37-E
Lea County, New Mexico**

Ladies and/or Gentlemen:

Marathon Oil Company has filed an application with the New Mexico Oil Conservation division for a non-standard gas well location and to simultaneously dedicate Eumont - Yates, 7 Rivers & Queen Pool Production to a 160 acre non-standard gas proration unit. Please find enclosed a copy of the application.

If you are in agreement and waive all objections to the simultaneously dedicated wells, please sign below and mail the original to the NMOCD in the enclosed addressed envelope. Also, please return one copy to Marathon at the letterhead address.

Sincerely,

Tim L. Chase
Advanced Engineer Technician

Enclosure

Agreed and accepted this _____ day of _____ 2001

by _____, as representative of

_____.



**Marathon
Oil Company**

P.O. Box 552
Midland, TX 79702-0552
Telephone 915/682-1626

September 7, 2001

Amerada Hess Corporation
Production Operations - Onshore
PO Box 2040
Houston, TX 77252-2040

RECEIVED
OCT 5 - 2001
OIL CONSERVATION
DIVISION

**RE: Application to Simultaneously Dedicate
Eumont Gas Pool Production**

**RE: Request for Exception to Rule 104
Application for Non-Standard Gas Well Location
for the Eumont Gas Pool
W.H. Laughlin Well No. 7
Unit Letter E, 2310' FNL & 940' FWL
Section 9, T-20-S, R-37-E
Lea County, New Mexico**

OCT - 5 2001

Ladies and/or Gentlemen:

Marathon Oil Company has filed an application with the New Mexico Oil Conservation division for a non-standard gas well location and to simultaneously dedicate Eumont - Yates, 7 Rivers & Queen Pool Production to a 160 acre non-standard gas proration unit. Please find enclosed a copy of the application.

If you are in agreement and waive all objections to the simultaneously dedicated wells, please sign below and mail the original to the NMOCD in the enclosed addressed envelope. Also, please return one copy to Marathon at the letterhead address.

Sincerely,

A handwritten signature in black ink, appearing to read 'Tim L. Chase'.

Tim L. Chase
Advanced Engineer Technician

Enclosure

Agreed and accepted this 1st day of October 2001

by Robert A. Harrison, as representative of
Amerada Hess Corporation

OFFSET OPERATORS
Lease NM - 297 – W.H. Laughlin
S/2 N/2 of Section 9, T-20-S, R-37-E, N.M.P.M.
Lea County, New Mexico
Monument Field

T-20-S, R-37-E

Section 8: Chevron USA Inc.
Attn: Ray Vaden
P.O. Box 1150
Midland, Texas 79702

Arch Petroleum, Inc.
801 Cherry Street, Suite 1040
Fort Worth, TX 76102-6810

Doyle Hartman
P.O. Box 10426
Midland, TX 79702-7426

Texaco Exploration & Production, Inc.
P.O. Box 3109
Midland, TX 79702-3109

Mid-Continent Energy Operating Company
100 W. 5th Street, Suite 450
Tulsa, OK 74103-4287

Amerada Hess Corporation
Production Operations – Onshore
P.O. Box 2040
Houston, TX 77252-2040

Section 9: Amerada Hess Corporation

Texaco Exploration & Production, Inc.

Section 10: Conoco, Inc.
600 North Dairy Ashford Drive
Houston, TX 77079-1175

Gruy Petroleum Management Company
1601 North Turner
Hobbs, NM 88240

Texaco Exploration & Production, Inc.

District I

1625 N. French Dr., Hobbs, NM 88240

District II

811 South First, Artesia, NM 88210

District III

1000 Rio Brazos Rd., Aztec, NM 87410

District IV

1220 S. St. Francis Dr., Santa Fe, NM 87505

State of New Mexico
Energy, Minerals & Natural Resources DepartmentOIL CONSERVATION DIVISION
1220 South St. Francis Dr
Santa Fe, NM 87505

Form C-102

Revised August 15, 2000

Submit to Appropriate District Office

State Lease - 4 Copies

Fee Lease - 3 Copies

☐ AMENDED REPORT

WELL LOCATION AND ACREAGE DEDICATION PLAT

¹ API Number 30-025-33141	² Pool Code 76480	³ Pool Name Eumont (Yates, 7 Rivers, Queen)
⁴ Property Code 6421	⁵ Property Name W.H. Laughlin	⁶ Well Number 7
⁷ OGRID No. 014021	⁸ Operator Name Marathon Oil Company	⁹ Elevation 3554'

¹⁰ Surface Location

UL or lot no. E	Section 9	Township 20S	Range 37E	Lot Idn -	Feet from the 2310	North/South line North	Feet from the 940	East/West line West	County Lea
--------------------	--------------	-----------------	--------------	--------------	-----------------------	---------------------------	----------------------	------------------------	---------------

¹¹ Bottom Hole Location If Different From Surface

UL or lot no.	Section	Township	Range	Lot Idn	Feet from the	North/South line	Feet from the	East/West line	County
---------------	---------	----------	-------	---------	---------------	------------------	---------------	----------------	--------

¹² Dedicated Acres 160	¹³ Joint or Infill Joint	¹⁴ Consolidation Code -	¹⁵ Order No. SD -94-2.1
--------------------------------------	--	---------------------------------------	---------------------------------------

NO ALLOWABLE WILL BE ASSIGNED TO THIS COMPLETION UNTIL ALL INTERESTS HAVE BEEN CONSOLIDATED OR A
NON-STANDARD UNIT HAS BEEN APPROVED BY THE DIVISION

				¹⁷ OPERATOR CERTIFICATION I hereby certify that the information contained herein is true and complete to the best of my knowledge and belief. Signature Tim L. Chase Printed Name Advanced Engineer Technician Title September 7, 2001 Date
				¹⁸ SURVEYOR CERTIFICATION I hereby certify that the well location shown on this plat was plotted from field notes of actual surveys made by me or under my supervision, and that the same is true and correct to the best of my belief.
				Date of Survey Signature and Seal of Professional Surveyor: Certificate Number John W. West 676 Ronald J. Eidson 3239 Gary L. Jones 7977

**Marathon Oil Company
W.H. Laughlin Lease
Lease NM - 296
Section 9, T-20-S, R-37-E
Lea County, New Mexico**

DATE IN	SUSPENSE	ENGINEER	LOGGED IN	TYPE	APP NO.
---------	----------	----------	-----------	------	---------

ABOVE THIS LINE FOR DIVISION USE ONLY

NEW MEXICO OIL CONSERVATION DIVISION
- Engineering Bureau -
 1220 South St. Francis Drive, Santa Fe, NM 87505



ADMINISTRATIVE APPLICATION CHECKLIST

THIS CHECKLIST IS MANDATORY FOR ALL ADMINISTRATIVE APPLICATIONS FOR EXCEPTIONS TO DIVISION RULES AND REGULATIONS WHICH REQUIRE PROCESSING AT THE DIVISION LEVEL IN SANTA FE

Application Acronyms:

[NSL-Non-Standard Location] [NSP-Non-Standard Proration Unit] [SD-Simultaneous Dedication]
[DHC-Downhole Commingling] [CTB-Lease Commingling] [PLC-Pool/Lease Commingling]
[PC-Pool Commingling] [OLS - Off-Lease Storage] [OLM-Off-Lease Measurement]
[WFX-Waterflood Expansion] [PMX-Pressure Maintenance Expansion]
[SWD-Salt Water Disposal] [IPI-Injection Pressure Increase]
[EOR-Qualified Enhanced Oil Recovery Certification] [PPR-Positive Production Response]

[1] **TYPE OF APPLICATION - Check Those Which Apply for [A]**

[A] Location - Spacing Unit - Simultaneous Dedication
☒ NSL ☐ NSP ☒ SD

Check One Only for [B] or [C]

[B] Commingling - Storage - Measurement
☐ DHC ☐ CTB ☐ PLC ☐ PC ☐ OLS ☐ OLM

[C] Injection - Disposal - Pressure Increase - Enhanced Oil Recovery
☐ WFX ☐ PMX ☐ SWD ☐ IPI ☐ EOR ☐ PPR

[D] Other: Specify _____

[2] **NOTIFICATION REQUIRED TO: - Check Those Which Apply, or Does Not Apply**

- [A] ☐ Working, Royalty or Overriding Royalty Interest Owners
- [B] ☒ Offset Operators, Leaseholders or Surface Owner
- [C] ☐ Application is One Which Requires Published Legal Notice
- [D] ☐ Notification and/or Concurrent Approval by BLM or SLO
U.S. Bureau of Land Management - Commissioner of Public Lands, State Land Office
- [E] ☐ For all of the above, Proof of Notification or Publication is Attached, and/or,
- [F] ☐ Waivers are Attached

[3] **SUBMIT ACCURATE AND COMPLETE INFORMATION REQUIRED TO PROCESS THE TYPE OF APPLICATION INDICATED ABOVE.**

[4] **CERTIFICATION:** I hereby certify that the information submitted with this application for administrative approval is **accurate** and **complete** to the best of my knowledge. I also understand that **no action** will be taken on this application until the required information and notifications are submitted to the Division.

Note: Statement must be completed by an individual with managerial and/or supervisory capacity.

Tim L. Chase Tim L. Chase Advanced Engineer Tech 9-7-01
 Print or Type Name Signature Title Date
Tchase@MarathonOil.com
 e-mail Address

Southern Business Unit
Domestic Production



P.O. Box 552
Midland, TX 79702-0552
Telephone 915/682-1626

September 7, 2001

Texaco Exploration & Production, Inc.
PO Box 3109
Midland, TX 79702-3109

OCT - 1 2001

**RE: Application to Simultaneously Dedicate
Eumont Gas Pool Production**

**RE: Request for Exception to Rule 104
Application for Non-Standard Gas Well Location
for the Eumont Gas Pool
W.H. Laughlin Well No. 7
Unit Letter E, 2310' FNL & 940' FWL
Section 9, T-20-S, R-37-E
Lea County, New Mexico**

Ladies and/or Gentlemen:

Marathon Oil Company has filed an application with the New Mexico Oil Conservation division for a non-standard gas well location and to simultaneously dedicate Eumont - Yates, 7 Rivers & Queen Pool Production to a 160 acre non-standard gas proration unit. Please find enclosed a copy of the application.

If you are in agreement and waive all objections to the simultaneously dedicated wells, please sign below and mail the original to the NMOCD in the enclosed addressed envelope. Also, please return one copy to Marathon at the letterhead address.

Sincerely,

A handwritten signature in black ink, appearing to read 'Tim L. Chase'.

Tim L. Chase
Advanced Engineer Technician

Enclosure

Agreed and accepted this 26th day of September 2001

by as representative of
Charles E. Sadler
Texaco Exploration and Production Inc.

OFFSET OPERATORS
Lease NM - 297 – W.H. Laughlin
S/2 N/2 of Section 9, T-20-S, R-37-E, N.M.P.M.
Lea County, New Mexico
Monument Field

T-20-S, R-37-E

Section 8: Chevron USA Inc.
Attn: Ray Vaden
P.O. Box 1150
Midland, Texas 79702

Arch Petroleum, Inc.
801 Cherry Street, Suite 1040
Fort Worth, TX 76102-6810

Doyle Hartman
P.O. Box 10426
Midland, TX 79702-7426

Texaco Exploration & Production, Inc.
P.O. Box 3109
Midland, TX 79702-3109

Mid-Continent Energy Operating Company
100 W. 5th Street, Suite 450
Tulsa, OK 74103-4287

Amerada Hess Corporation
Production Operations – Onshore
P.O. Box 2040
Houston, TX 77252-2040

Section 9: Amerada Hess Corporation

Texaco Exploration & Production, Inc.

Section 10: Conoco, Inc.
600 North Dairy Ashford Drive
Houston, TX 77079-1175

Gruy Petroleum Management Company
1601 North Turner
Hobbs, NM 88240

Texaco Exploration & Production, Inc.

District I

1625 N. French Dr., Hobbs, NM 88240

District II

811 South First, Artesia, NM 88210

District III

1000 Rio Brazos Rd., Aztec, NM 87410

District IV

1220 S. St. Francis Dr., Santa Fe, NM 87505

State of New Mexico
Energy, Minerals & Natural Resources DepartmentOIL CONSERVATION DIVISION
1220 South St. Francis Dr
Santa Fe, NM 87505Form C-102
Revised August 15, 2000Submit to Appropriate District Office
State Lease - 4 Copies
Fee Lease - 3 Copies☐ AMENDED REPORT

WELL LOCATION AND ACREAGE DEDICATION PLAT

¹ API Number 30-025-33141	² Pool Code 76480	³ Pool Name Eumont (Yates, 7 Rivers, Queen)
⁴ Property Code 6421	⁵ Property Name W.H. Laughlin	
⁷ OGRID No. 014021	⁸ Operator Name Marathon Oil Company	⁶ Well Number 7 ⁹ Elevation 3554'

¹⁰ Surface Location

UL or lot no. E	Section 9	Township 20S	Range 37E	Lot Idn -	Feet from the 2310	North/South line North	Feet from the 940	East/West line West	County Lea
--------------------	--------------	-----------------	--------------	--------------	-----------------------	---------------------------	----------------------	------------------------	---------------

¹¹ Bottom Hole Location If Different From Surface

UL or lot no.	Section	Township	Range	Lot Idn	Feet from the	North/South line	Feet from the	East/West line	County
¹² Dedicated Acres 160	¹³ Joint or Infill Joint	¹⁴ Consolidation Code -	¹⁵ Order No. SD -94-2.1						

NO ALLOWABLE WILL BE ASSIGNED TO THIS COMPLETION UNTIL ALL INTERESTS HAVE BEEN CONSOLIDATED OR A
NON-STANDARD UNIT HAS BEEN APPROVED BY THE DIVISION

	¹⁷ OPERATOR CERTIFICATION I hereby certify that the information contained herein is true and complete to the best of my knowledge and belief. Signature Tim L. Chase Printed Name Advanced Engineer Technician Title September 7, 2001 Date			
	¹⁸ SURVEYOR CERTIFICATION I hereby certify that the well location shown on this plat was plotted from field notes of actual surveys made by me or under my supervision, and that the same is true and correct to the best of my belief.			
	Date of Survey Signature and Seal of Professional Surveyor: Certificate Number John W. West 676 Ronald J. Eidson 3239 Gary L. Jones 7977			

Marathon Oil Company
W.H. Laughlin Lease
Lease NM - 296
Section 9, T-20-S, R-37-E
Lea County, New Mexico

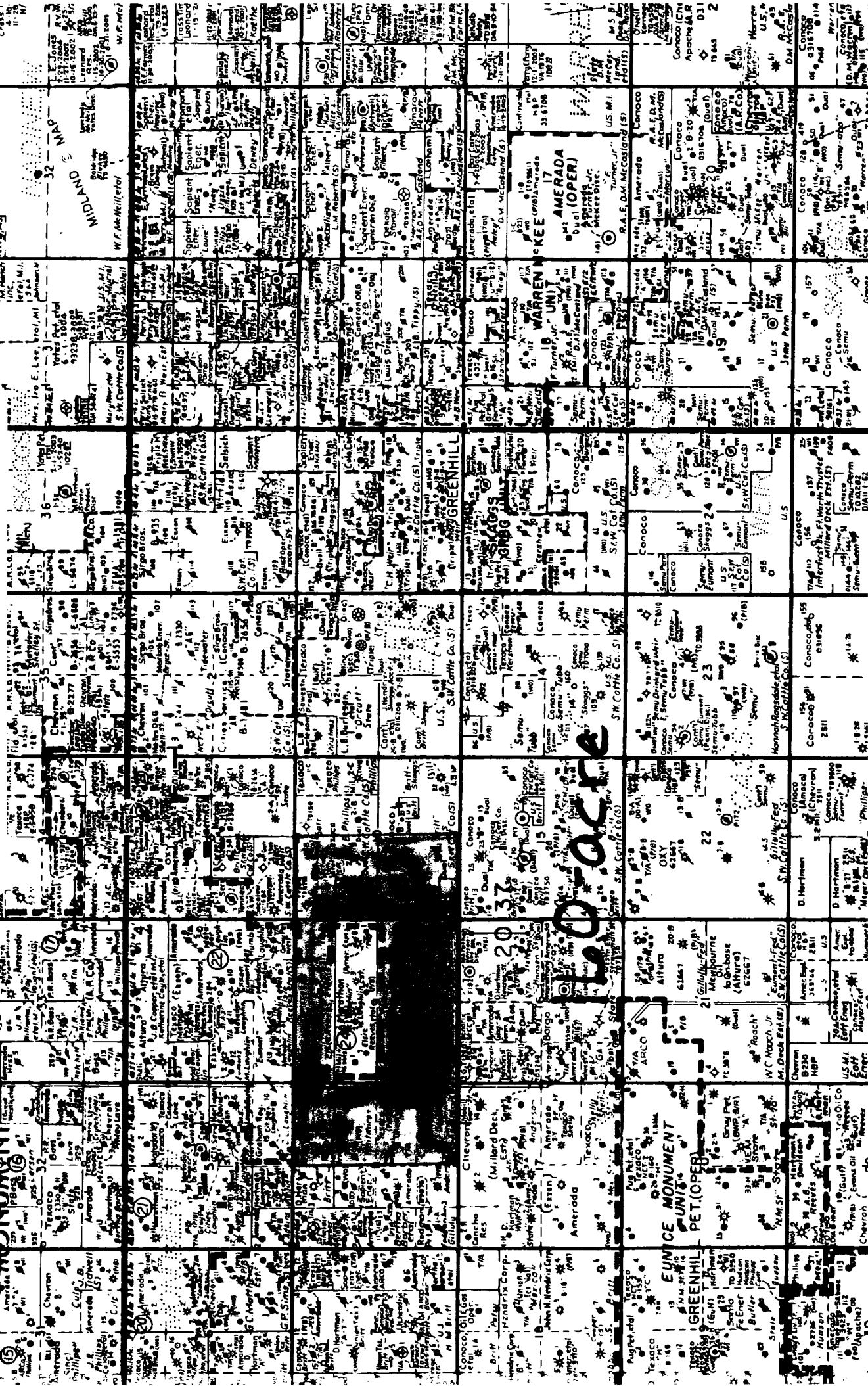

DATE IN	SUSPENSE	ENGINEER	LOGGED IN	TYPE	APP NO
---------	----------	----------	-----------	------	--------

ABOVE THIS LINE FOR DIVISION USE ONLY

NEW MEXICO OIL CONSERVATION DIVISION
- Engineering Bureau -
 1220 South St. Francis Drive, Santa Fe, NM 87505



ADMINISTRATIVE APPLICATION CHECKLIST

THIS CHECKLIST IS MANDATORY FOR ALL ADMINISTRATIVE APPLICATIONS FOR EXCEPTIONS TO DIVISION RULES AND REGULATIONS WHICH REQUIRE PROCESSING AT THE DIVISION LEVEL IN SANTA FE

Application Acronyms:

[NSL-Non-Standard Location] [NSP-Non-Standard Proration Unit] [SD-Simultaneous Dedication]
[DHC-Downhole Commingling] [CTB-Lease Commingling] [PLC-Pool/Lease Commingling]
[PC-Pool Commingling] [OLS - Off-Lease Storage] [OLM-Off-Lease Measurement]
[WFX-Waterflood Expansion] [PMX-Pressure Maintenance Expansion]
[SWD-Salt Water Disposal] [IPI-Injection Pressure Increase]
[EOR-Qualified Enhanced Oil Recovery Certification] [PPR-Positive Production Response]

- [1] **TYPE OF APPLICATION** - Check Those Which Apply for [A]
- [A] Location - Spacing Unit - Simultaneous Dedication
☒ NSL ☐ NSP ☒ SD
- Check One Only for [B] or [C]
- [B] Commingling - Storage - Measurement
☐ DHC ☐ CTB ☐ PLC ☐ PC ☐ OLS ☐ OLM
- [C] Injection - Disposal - Pressure Increase - Enhanced Oil Recovery
☐ WFX ☐ PMX ☐ SWD ☐ IPI ☐ EOR ☐ PPR
- [D] Other: Specify _____
- [2] **NOTIFICATION REQUIRED TO:** - Check Those Which Apply, or Does Not Apply
- [A] ☐ Working, Royalty or Overriding Royalty Interest Owners
- [B] ☒ Offset Operators, Leaseholders or Surface Owner
- [C] ☐ Application is One Which Requires Published Legal Notice
- [D] ☐ Notification and/or Concurrent Approval by BLM or SLO
U.S. Bureau of Land Management - Commissioner of Public Lands, State Land Office
- [E] ☐ For all of the above, Proof of Notification or Publication is Attached, and/or,
- [F] ☐ Waivers are Attached
- [3] **SUBMIT ACCURATE AND COMPLETE INFORMATION REQUIRED TO PROCESS THE TYPE OF APPLICATION INDICATED ABOVE.**

[4] **CERTIFICATION:** I hereby certify that the information submitted with this application for administrative approval is **accurate** and **complete** to the best of my knowledge. I also understand that **no action** will be taken on this application until the required information and notifications are submitted to the Division.

Note: Statement must be completed by an individual with managerial and/or supervisory capacity.

Jim L. Chase [Signature] Advanced Engineer Tech 9-7-01
 Print or Type Name Signature Title Date
TChase@MarathonOil.com
 e-mail Address

BEFORE THE OIL CONSERVATION COMMISSION
OF THE STATE OF NEW MEXICO

IN THE MATTER OF THE HEARING
CALLED BY THE OIL CONSERVATION
COMMISSION OF THE STATE OF NEW
MEXICO FOR THE PURPOSE OF CON-
SIDERING:

CASE NO. 752
Order No. R-527

THE APPLICATION OF THE OHIO OIL
COMPANY FOR AN ORDER GRANTING
APPROVAL OF AN EXCEPTION PURSUANT
TO RULE 7 (a) OF ORDER NO. R-370-A IN
ESTABLISHMENT OF AN UNORTHODOX GAS
PRORATION UNIT OF 160 CONTIGUOUS ACRES
CONSISTING OF S/2 N/2 OF SECTION 9, TOWN-
SHIP 20 SOUTH, RANGE 37 EAST, NMPM, LEA
COUNTY, NEW MEXICO, IN WHAT IS NOW
DELINEATED AS THE EUMONT GAS POOL UNDER
THE PROVISIONS OF ORDER NO. R-520.

ORDER OF THE COMMISSION

BY THE COMMISSION:

This cause came on for hearing at 9 o'clock a.m., on August 18, 1954, at Santa Fe, New Mexico, before the Oil Conservation Commission, hereinafter referred to as the "Commission".

NOW, on this 4th day of October, 1954, the Commission, a quorum being present, having considered the records and testimony adduced, and being fully advised in the premises;

FINDS:

(1) That due notice of the time and place of hearing and the purpose thereof having been given as required by law, the Commission has jurisdiction of this case and the subject matter thereof.

(2) That pursuant to provisions of Rule 7 (a) of Order No. R-370-A, and Order R-520, the Commission has power and authority to permit the formation of a gas proration unit consisting of other than a legal quarter section after notice and hearing by the Commission.

(3) That applicant, The Ohio Oil Company, is the owner of an oil and gas lease in Lea County, New Mexico the land consisting of other than a legal quarter section, and described as follows, to-wit:

TOWNSHIP 20 SOUTH, RANGE 37 EAST, NMPM
S/2 N/2 of Section 5

containing 160 acres, more or less.

Order No. R-527

(4) That applicant, The Ohio Oil Company, has a producing well on the aforesaid lease known as W. H. Laughlin No. 3 located 1980 feet from the North line and 1980 feet from the East line of Section 9, Township 20 South, Range 37 East.

(5) That the aforesaid well was completed and in production prior to January 1, 1954, the effective date of Order No. R-370-A, and is located within the limits of the pool heretofore delineated and designated as the Eumont Gas Pool.

(6) That it is impossible to pool applicant's said lease with adjoining acreage in Section 9 and that the owners of adjoining acreage in said section have not objected to the formation of the proposed proration unit of 160 acres.

(7) That unless a proration unit consisting of applicant's aforesaid acreage is permitted, applicant will be deprived of the opportunity to recover its just and equitable share of the natural gas in the Eumont Gas Pool.

(8) That creation of a proration unit consisting of the aforesaid acreage will not cause but will prevent waste, and will protect correlative rights.

IT IS THEREFORE ORDERED:

(1) That the application of The Ohio Oil Company for approval of an unorthodox proration unit consisting of the following described acreage

TOWNSHIP 20 SOUTH, RANGE 37 EAST, NMPM
S/2 N/2 Section 9

be and the same is hereby approved, and a proration unit consisting of aforesaid acreage is hereby created.

(2) That applicant's well, W. H. Laughlin No. 3, located in the SW/4 NE/4 of Section 9, Township 20 South, Range 37 East, NMPM, shall be granted an allowable in the proportion that the above described 160 acre unit bears to the standard or orthodox proration unit for said pool, all until further order of the Commission.

DONE at Santa Fe, New Mexico, the day and year hereinabove designated.

STATE OF NEW MEXICO
OIL CONSERVATION COMMISSION

EDWIN L. MECHEM, Chairman

E. S. WALKER, Member

W. B. MACEY, Secretary and Member

S E A L

BEFORE THE OIL CONSERVATION COMMISSION
OF THE STATE OF NEW MEXICO

IN THE MATTER OF THE HEARING
CALLED BY THE OIL CONSERVATION
COMMISSION OF THE STATE OF NEW
MEXICO FOR THE PURPOSE OF CON-
SIDERING:

CASE NO. 752
Order No. R-527-A

THE APPLICATION OF THE OHIO OIL
COMPANY FOR AN ORDER GRANTING
APPROVAL OF AN EXCEPTION PURSUANT
TO RULE 7 (a) OF ORDER NO. R-370-A IN
ESTABLISHMENT OF AN UNORTHODOX GAS
PRORATION UNIT OF 160 CONTIGUOUS ACRES
CONSISTING OF S/2 N/2 OF SECTION 9,
TOWNSHIP 20 SOUTH, RANGE 37 EAST, NMPM,
LEA COUNTY, NEW MEXICO, IN WHAT IS NOW
DELINEATED AS THE EUMONT GAS POOL UNDER
THE PROVISIONS OF ORDER NO. R-520.

NUNC PRO TUNC ORDER OF THE COMMISSION

BY THE COMMISSION:

This cause came on for hearing at 9 o'clock a.m. on August 18, 1954, at Santa Fe, New Mexico, before the Oil Conservation Commission, hereinafter referred to as the "Commission".

Thereafter, on the 4th day of October, 1954, the Commission entered its Order R-527 approving the unorthodox proration unit as prayed for in the said application.

NOW, on this 26th day of November, 1954, the Commission, a quorum being present, having considered the records and testimony adduced, having also considered more particularly certain portions of the record, and finding that certain matters which were omitted in Order R-527 should be expressly recited in this cause, it enters herewith its nunc pro tunc order supplementing and amending said Order R-527. The Commission, being fully advised in the premises;

FINDS:

(1) That due notice of the time and place of hearing and the purpose thereof having been given as required by law, the Commission has jurisdiction of this case and the subject matter thereof.

(2) That pursuant to provisions of Rule 7 (a) of Order No. R-370-A, and Order R-520, the Commission has power and authority to permit the formation of a gas proration unit consisting of other than a legal quarter section after notice and hearing by the Commission.

(3) That applicant, The Ohio Oil Company, is the owner of an oil and gas lease in Lea County, New Mexico the land consisting of other than a legal quarter section, and described as follows, to-wit:

Township 20 South, Range 37 East, NMPM
S/2 N/2 of Section 5

containing 160 acres more or less.

(4) That applicant, The Ohio Oil Company, has a producing well on the aforesaid lease known as W. H. Laughlin No. 3 located 1980 feet from the North line and 1980 feet from the East line of Section 9, Township 20 South, Range 37 East, and that applicant has declared that it desires to dually complete said well on the above described land instead of re-completing its W. H. Laughlin Well No. 4 thereon.

(5) That the aforesaid well No. 3 was completed in the Monument Oil Pool and was in production from that pool long prior to January 1, 1954, the effective date of Order R-370-A; that the said well is located within the boundaries of the pool heretofore delineated and designated as the Eumont Gas Pool; and that by Order No. DC-143 the Commission has heretofore authorized the dual completion of said well within the limits of the Eumont Gas Pool and the Monument Oil Pool.

(6) That it is impossible to pool applicant's said lease with adjoining acreage in Section 9 and that the owners of adjoining acreage in said section have not objected to the formation of the proposed proration unit of 160 acres.

(7) That unless a proration unit consisting of applicant's aforesaid acreage is permitted, applicant will be deprived of the opportunity to recover its just and equitable share of the natural gas in the Eumont Gas Pool.

(8) That creation of a proration unit consisting of the aforesaid acreage will not cause but will prevent waste, and will protect correlative rights.

IT IS THEREFORE ORDERED:

(1) That the application of The Ohio Oil Company for approval of an unorthodox proration unit consisting of the following described acreage:

Township 20 South, Range 37 East, NMPM
S/2 N/2 Section 9

be and the same is hereby approved, and a proration unit consisting of aforesaid acreage is hereby created.

(2) That in lieu of approval of re-completion of applicant's W. H. Laughlin Well No. 4, applicant is hereby authorized to dually complete its W. H. Laughlin Well No. 3 in accordance with and subject to the provisions of Order No. DC-143 entered by this Commission August 6, 1954, and that upon such dual completion the said W. H. Laughlin Well No. 3, located in the SW/4 NE/4 of Section 9, Township 20 South, Range 37 East, NMPM, shall be granted an allowable in the proportion that the above described 160 acre unit bears to the standard or orthodox proration unit for said pool, all until further order of the Commission.

DONE at Santa Fe, New Mexico, the day and year hereinabove designated.

STATE OF NEW MEXICO
OIL CONSERVATION COMMISSION
EDWIN L. MECHEM, Chairman
E. S. WALKER, Member
W. B. MACEY, Member and Secretary



STATE OF NEW MEXICO
ENERGY, MINERALS AND NATURAL RESOURCES DEPARTMENT
OIL CONSERVATION DIVISION



BRUCE KING
GOVERNOR

ANITA LOCKWOOD
CABINET SECRETARY

POST OFFICE BOX 2088
STATE LAND OFFICE BUILDING
SANTA FE, NEW MEXICO 87504
(505) 827-5800

February 4, 1994

Marathon Oil Company
P. O. Box 552
Midland, Texas 79702-0552

Attention: Meftah Tiss

Administrative Order SD-94-2

Dear Mr. Tiss:

Per your application dated December 31, 1993, you are hereby authorized to simultaneously dedicate Eumont Gas Pool production to the previously approved non-standard 160-acre gas spacing and proration unit comprising the S/2 N/2 of Section 9, Township 20 South, Range 37 East, NMPM, Lea County, New Mexico (Division Order No. R-527-A, dated October 4, 1954), from the existing W. H. Laughlin Well No. 3 (API No. 30-025-06036) located at a standard gas well location 1980 feet from the North and East lines (Unit G) of said Section 9 and from the proposed W. H. Laughlin Well No. 5 (API No. 30-025-32380) to be drilled at a standard gas well location 1980 feet from the North line and 710 feet from the East line (Unit H) of said Section 9.

Further, you are permitted to produce the allowable assigned said non-standard 160-acre unit from both wells in any proportion.

Sincerely,

A handwritten signature in black ink, appearing to read "William J. LeMay".

William J. LeMay
Director

WJL/MES/amg

cc: Oil Conservation Division - Hobbs



BRUCE KING
GOVERNOR

ANITA LOCKWOOD
CABINET SECRETARY

STATE OF NEW MEXICO
ENERGY, MINERALS AND NATURAL RESOURCES DEPARTMENT
OIL CONSERVATION DIVISION



2040 S. PACHECO
SANTA FE, NEW MEXICO 87507
(505) 827-7131

November 10, 1994

Marathon Oil Company
P. O. Box 552
Midland, Texas 79702-0552

Attention: L. N. Hoover

Administrative Order SD-94-2.1

Dear Mr. Hoover:

Reference is made to your application dated November 2, 1994. Marathon Oil Company ("Marathon") is hereby authorized to simultaneously dedicate Eumont Gas Pool production to the previously approved non-standard 160-acre gas spacing and proration unit ("GPU") comprising the S/2 N/2 of Section 9, Township 20 South, Range 37 East, NMPM, Lea County, New Mexico (Division Order No. R-527-A, dated October 4, 1954), from the following three wells:

- the existing W. H. Laughlin Well No. 3 (API No. 30-025-06036) located at a standard gas well location 1980 feet from the North and East lines (Unit G) of said Section 9;
- the existing W. H. Laughlin Well No. 5 (API No. 30-025-32380) located at a standard gas well location 1980 feet from the North line and 710 feet from the East line (Unit H) of said Section 9; and,
- from the proposed W. H. Laughlin Well No. 6 (API No. 30-025-32465) to be drilled at a standard Eumont gas well location 1980 feet from the North line and 2250 feet from and West line (Unit F) of said Section 9.

Administrative Order SD-94-2.1

Marathon Oil Company

November 10, 1994

Page 2

Further, Marathon is permitted to produce the allowable assigned said non-standard 160-acre GPU from all three wells in any proportion.

Sincerely,

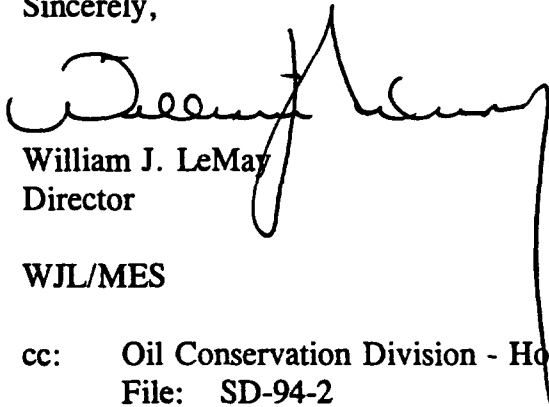
A handwritten signature in black ink, appearing to read 'William J. LeMay', with a long, sweeping horizontal stroke extending to the right.

William J. LeMay
Director

WJL/MES

cc: Oil Conservation Division - Hobbs
File: SD-94-2

CMD :
OG5SECT

ONGARD
INQUIRE LAND BY SECTION

10/16/01 12:58:21
OGOMES -TPKF
PAGE NO: 1

Sec : 09 Twp : 20S Rng : 37E Section Type : NORMAL

D 40.00 Fee owned U	C 40.00 Fee owned U A	B 40.00 Fee owned U A	A 40.00 Fee owned A
E 40.00 Fee owned U A A	F 40.00 Fee owned U A A A	G 40.00 Fee owned U P A	H 40.00 Fee owned U A A

PF01 HELP PF02 PF03 EXIT PF04 GoTo PF05 PF06
PF07 BKWD PF08 FWD PF09 PRINT PF10 SDIV PF11 PF12

CMD :
OG5SECT

ONGARD
INQUIRE LAND BY SECTION

10/16/01 12:58:27
OGOMES -TPKF
PAGE NO: 2

Sec : 09 Twp : 20S Rng : 37E Section Type : NORMAL

L 40.00	K 40.00	J 40.00	I 40.00
Fee owned	Fee owned	Fee owned	Fee owned
A A A	A A A	A A	A
M 40.00	N 40.00	O 40.00	P 40.00
Fee owned	Fee owned	Fee owned	Fee owned
A A A	A A	A A A	A

PF01 HELP
PF07 BKWD

PF02
PF08 FWD

PF03 EXIT
PF09 PRINT

PF04 GoTo
PF10 SDIV

PF05
PF11

PF06
PF12

CMD :
OG6IWCM

ONGARD
INQUIRE WELL COMPLETIONS

10/16/01 13:01:09
OGOMES -TPKF

API Well No : 30 25 33141 Eff Date : 01-11-1996 WC Status : A
Pool Idn : 47090 MONUMENT;TUBB
OGRID Idn : 14021 MARATHON OIL CO
Prop Idn : 6421 W H LAUGHLIN

Well No : 007
GL Elevation: 3554

	U/L	Sec	Township	Range	North/South	East/West	Prop/Act (P/A)
B.H. Locn	: E	9	20S	37E	FTG 2310 F N FTG	940 F W	A
Lot Identifier:							
Dedicated Acre:							80.00
Lease Type							: S
Type of consolidation							(Comm, Unit, Forced Pooling - C/U/F/O) :

M0025: Enter PF keys to scroll

PF01 HELP	PF02	PF03 EXIT	PF04 GoTo	PF05	PF06
PF07	PF08	PF09	PF10 NEXT-WC	PF11 HISTORY	PF12 NXTREC

well to be recompleted

CMD : ONGARD 10/16/01 12:59:45
OG6IWCM INQUIRE WELL COMPLETIONS OGOMES -TPKF

API Well No : 30 25 6036 Eff Date : 01-01-1900 WC Status : A
Pool Idn : 76480 EUMONT;YATES-7 RVRS-QUEEN (PRO GAS)
OGRID Idn : 14021 MARATHON OIL CO
Prop Idn : 6421 W H LAUGHLIN

Well No : 003
GL Elevation: 3543

	U/L	Sec	Township	Range	North/South	East/West	Prop/Act (P/A)
	---	---	-----	-----	-----	-----	-----
B.H. Locn : G	9	20S	37E	FTG 1980 F N	FTG 1980 F E	A	
Lot Identifier:							
Dedicated Acre:	160.00						
Lease Type : P							
Type of consolidation (Comm, Unit, Forced Pooling - C/U/F/O) :							

E6317: No more recs. for this api well no.

PF01 HELP	PF02	PF03 EXIT	PF04 GoTo	PF05	PF06
PF07	PF08	PF09	PF10 NEXT-WC	PF11 HISTORY	PF12 NXTREC

CMD : ONGARD 10/16/01 12:59:51
OG6ACRE C102-DEDICATE ACREAGE OGOMES -TPKF
Page No : 1

API Well No : 30 25 6036 Eff Date : 04-30-1991
Pool Idn : 76480 EUMONT;YATES-7 RVRs-QUEEN (PRO GAS)
Prop Idn : 6421 W H LAUGHLIN Well No : 003
Spacing Unit : 37552 OCD Order : Simultaneous Dedication:
Sect/Twp/Rng : Acreage : 160.00 Revised C102? (Y/N) :
Dedicated Land:

S	Base	U/L	Sec	Twp	Rng	Acreage	L/W	Ownership	Lot	Idn
	E	9	20S	37E	40.00	N	FE			
	F	9	20S	37E	40.00	N	FE			
	G	9	20S	37E	40.00	N	FE			
	H	9	20S	37E	40.00	N	FE			

E0005: Enter data to modify or PF keys to scroll

PF01 HELP	PF02	PF03 EXIT	PF04 GoTo	PF05	PF06 CONFIRM
PF07 BKWD	PF08 FWD	PF09	PF10 LAND	PF11 NXTSEC	PF12 RECONF

CMD : ONGARD 10/16/01 13:00:00
 OG6IPRD INQUIRE PRODUCTION BY POOL/WELL OGOMES -TPKF
 Page No: 1

OGRID Identifier : 14021 MARATHON OIL CO
 Pool Identifier : 76480 EUMONT;YATES-7 RVRS-QUEEN (PRO GAS)
 API Well No : 30 25 6036 Report Period - From : 01 2000 To : 07 2001

API Well No	Property Name	Prodn. Days MM/YY Prod	Production Volumes Gas Oil Water	Well Stat
30 25 6036	W H LAUGHLIN	01 00 31	2076	F
30 25 6036	W H LAUGHLIN	02 00 29	1636	F
30 25 6036	W H LAUGHLIN	03 00 31	1636	F
30 25 6036	W H LAUGHLIN	04 00 30	1539	F
30 25 6036	W H LAUGHLIN	05 00 31	1246	F
30 25 6036	W H LAUGHLIN	06 00 30	1442	F
30 25 6036	W H LAUGHLIN	07 00 31	1458	F

Reporting Period Total (Gas, Oil) :

M0025: Enter PF keys to scroll

PF01 HELP	PF02	PF03 EXIT	PF04 GoTo	PF05	PF06 CONFIRM
PF07 BKWD	PF08 FWD	PF09	PF10 NXTPOOL	PF11 NXTOGD	PF12

CMD : ONGARD 10/16/01 13:00:03
 OG6IPRD INQUIRE PRODUCTION BY POOL/WELL OGOMES -TPKF
 Page No: 2

OGRID Identifier : 14021 MARATHON OIL CO
 Pool Identifier : 76480 EUMONT;YATES-7 RVRS-QUEEN (PRO GAS)
 API Well No : 30 25 6036 Report Period - From : 01 2000 To : 07 2001

API Well No	Property Name	Prod. Days		Production Volumes			Well Stat
		MM/YY	Prod	Gas	Oil	Water	
30 25 6036	W H LAUGHLIN	08 00	31	1350			F
30 25 6036	W H LAUGHLIN	09 00	30	1281			F
30 25 6036	W H LAUGHLIN	10 00	31	1358			F
30 25 6036	W H LAUGHLIN	11 00	30	1271			F
30 25 6036	W H LAUGHLIN	12 00	31	1154			F
30 25 6036	W H LAUGHLIN	01 01	31	1127			F
30 25 6036	W H LAUGHLIN	02 01	28	780			F

Reporting Period Total (Gas, Oil) :

E0049: User may continue scrolling.

PF01 HELP PF02 PF03 EXIT PF04 GoTo PF05 PF06 CONFIRM
 PF07 BKWD PF08 FWD PF09 PF10 NXTPOOL PF11 NXTOGD PF12

CMD : ONGARD 10/16/01 13:00:05
OG6IPRD INQUIRE PRODUCTION BY POOL/WELL OGOMES -TPKF
Page No: 3

OGRID Identifier : 14021 MARATHON OIL CO
Pool Identifier : 76480 EUMONT;YATES-7 RVRS-QUEEN (PRO GAS)
API Well No : 30 25 6036 Report Period - From : 01 2000 To : 07 2001

API Well No	Property Name	Prodn. Days MM/YY Prod	Production Volumes Gas Oil Water	Well Stat
30 25 6036 W H LAUGHLIN		03 01 31	95	F
30 25 6036 W H LAUGHLIN		04 01 30	90	F
30 25 6036 W H LAUGHLIN		05 01 31	93	F
30 25 6036 W H LAUGHLIN		06 01 30	133	F
30 25 6036 W H LAUGHLIN		07 01 31	93	F

Reporting Period Total (Gas, Oil) : 19858

E0049: User may continue scrolling.

PF01 HELP PF02 PF03 EXIT PF04 GoTo PF05 PF06 CONFIRM
PF07 BKWD PF08 FWD PF09 PF10 NXTPOOL PF11 NXTOGD PF12

CMD : ONGARD 10/16/01 12:59:04
OG6IWCM INQUIRE WELL COMPLETIONS OGOMES -TPKF

API Well No : 30 25 32465 Eff Date : 03-22-1994 WC Status : A
Pool Idn : 76480 EUMONT;YATES-7 RVRS-QUEEN (PRO GAS)
OGRID Idn : 14021 MARATHON OIL CO
Prop Idn : 6421 W H LAUGHLIN

Well No : 006
GL Elevation: 3544

	U/L	Sec	Township	Range	North/South	East/West	Prop/Act (P/A)
	---	---	-----	-----	-----	-----	-----
B.H. Locn : F	9	20S	37E	FTG 1980 F N	FTG 2250 F W	A	
Lot Identifier:							
Dedicated Acre: 160.00							
Lease Type : P							
Type of consolidation (Comm, Unit, Forced Pooling - C/U/F/O) :							

M0025: Enter PF keys to scroll

PF01 HELP	PF02	PF03 EXIT	PF04 GoTo	PF05	PF06
PF07	PF08	PF09	PF10 NEXT-WC	PF11 HISTORY	PF12 NXTREC

CMD : ONGARD 10/16/01 12:59:12
OG6ACRE C102-DEDICATE ACREAGE OGOMES -TPKF
Page No : 1

API Well No : 30 25 32465 Eff Date : 03-22-1994
Pool Idn : 76480 EUMONT;YATES-7 RVRs-QUEEN (PRO GAS)
Prop Idn : 6421 W H LAUGHLIN Well No : 006
Spacing Unit : 38764 OCD Order : Simultaneous Dedication:
Sect/Twp/Rng : Acreage : 160.00 Revised C102? (Y/N) :
Dedicated Land:

S	Base	U/L	Sec	Twp	Rng	Acreage	L/W	Ownership	Lot	Idn
	E	9	20S	37E	40.00	N	FE			
	F	9	20S	37E	40.00	N	FE			
	G	9	20S	37E	40.00	N	FE			
	H	9	20S	37E	40.00	N	FE			

E0005: Enter data to modify or PF keys to scroll

PF01 HELP	PF02	PF03 EXIT	PF04 GoTo	PF05	PF06 CONFIRM
PF07 BKWD	PF08 FWD	PF09	PF10 LAND	PF11 NXTSEC	PF12 RECONF

CMD : ONGARD 10/16/01 12:59:22
 OG6IPRD INQUIRE PRODUCTION BY POOL/WELL OGOMES -TPKF
 Page No: 1

OGRID Identifier : 14021 MARATHON OIL CO
 Pool Identifier : 76480 EUMONT;YATES-7 RVRS-QUEEN (PRO GAS)
 API Well No : 30 25 32465 Report Period - From : 01 2000 To : 07 2001

API Well No	Property Name	Prod. Days		Production Volumes			Well Stat
		MM/YY	Prod	Gas	Oil	Water	
30 25 32465	W H LAUGHLIN	01 00					S
30 25 32465	W H LAUGHLIN	02 00					S
30 25 32465	W H LAUGHLIN	03 00					S
30 25 32465	W H LAUGHLIN	04 00					S
30 25 32465	W H LAUGHLIN	05 00					S
30 25 32465	W H LAUGHLIN	06 00					S
30 25 32465	W H LAUGHLIN	07 00	17	1366			F

Reporting Period Total (Gas, Oil) :

M0025: Enter PF keys to scroll

PF01 HELP PF02 PF03 EXIT PF04 GoTo PF05 PF06 CONFIRM
 PF07 BKWD PF08 FWD PF09 PF10 NXTPOOL PF11 NXTOGD PF12

CMD : ONGARD 10/16/01 12:59:27
 OG6IPRD INQUIRE PRODUCTION BY POOL/WELL OGOMES -TPKF
 Page No: 2

OGRID Identifier : 14021 MARATHON OIL CO
 Pool Identifier : 76480 EUMONT;YATES-7 RVRS-QUEEN (PRO GAS)
 API Well No : 30 25 32465 Report Period - From : 01 2000 To : 07 2001

API Well No	Property Name	Prod. Days		Production Volumes			Well
		MM/YY	Prod	Gas	Oil	Water	
30 25 32465 W H LAUGHLIN		08 00	31	1691			F
30 25 32465 W H LAUGHLIN		09 00	30	1193			F
30 25 32465 W H LAUGHLIN		10 00	31	1067			F
30 25 32465 W H LAUGHLIN		11 00	30	592			F
30 25 32465 W H LAUGHLIN		12 00	31	255			F
30 25 32465 W H LAUGHLIN		01 01	31	62			F
30 25 32465 W H LAUGHLIN		02 01	28	9			F

Reporting Period Total (Gas, Oil) :

E0049: User may continue scrolling.

PF01 HELP PF02 PF03 EXIT PF04 GoTo PF05 PF06 CONFIRM
 PF07 BKWD PF08 FWD PF09 PF10 NXTPOOL PF11 NXTOGD PF12

CMD : ONGARD 10/16/01 12:59:33
 OG6IPRD INQUIRE PRODUCTION BY POOL/WELL OGOMES -TPKF
 Page No: 3

OGRID Identifier : 14021 MARATHON OIL CO
 Pool Identifier : 76480 EUMONT;YATES-7 RVRS-QUEEN (PRO GAS)
 API Well No : 30 25 32465 Report Period - From : 01 2000 To : 07 2001

API Well No	Property Name	Prodn. Days		Production Volumes			Well
		MM/YY	Prod	Gas	Oil	Water	
30 25 32465 W H LAUGHLIN		03 01	31	202			F
30 25 32465 W H LAUGHLIN		04 01	30	403			F
30 25 32465 W H LAUGHLIN		05 01	31	357			F
30 25 32465 W H LAUGHLIN		06 01	30	263			F
30 25 32465 W H LAUGHLIN		07 01	31	306			F

Reporting Period Total (Gas, Oil) : 7766

E0049: User may continue scrolling.

PF01 HELP PF02 PF03 EXIT PF04 GoTo PF05 PF06 CONFIRM
 PF07 BKWD PF08 FWD PF09 PF10 NXTPOOL PF11 NXTOGD PF12

CMD : ONGARD
OG6IWCM INQUIRE WELL COMPLETIONS

10/16/01 13:00:23
OGOMES -TPKF

API Well No : 30 25 32380 Eff Date : 02-14-1994 WC Status : A
Pool Idn : 76480 EUMONT;YATES-7 RVRS-QUEEN (PRO GAS)
OGRID Idn : 14021 MARATHON OIL CO
Prop Idn : 6421 W H LAUGHLIN

Well No : 005
GL Elevation: 3542

	U/L	Sec	Township	Range	North/South	East/West	Prop/Act (P/A)
B.H. Locn	: H	9	20S	37E	FTG 1980 F N FTG	710 F E	A

Lot Identifier:

Dedicated Acre: 160.00

Lease Type : P

Type of consolidation (Comm, Unit, Forced Pooling - C/U/F/O) :

M0025: Enter PF keys to scroll

PF01 HELP	PF02	PF03 EXIT	PF04 GoTo	PF05	PF06
PF07	PF08	PF09	PF10 NEXT-WC	PF11 HISTORY	PF12 NXTREC

CMD : ONGARD 10/16/01 13:00:27
 OG6ACRE C102-DEDICATE ACREAGE OGOMES -TPKF
 Page No : 1

API Well No : 30 25 32380 Eff Date : 03-22-1994
 Pool Idn : 76480 EUMONT;YATES-7 RVRS-QUEEN (PRO GAS)
 Prop Idn : 6421 W H LAUGHLIN Well No : 005
 Spacing Unit : 38764 OCD Order : Simultaneous Dedication:
 Sect/Twp/Rng : Acreage : 160.00 Revised C102? (Y/N) :
 Dedicated Land:

S	Base	U/L	Sec	Twp	Rng	Acreage	L/W	Ownership	Lot	Idn
	E	9	20S	37E	40.00	N	FE			
	F	9	20S	37E	40.00	N	FE			
	G	9	20S	37E	40.00	N	FE			
	H	9	20S	37E	40.00	N	FE			

E0005: Enter data to modify or PF keys to scroll

PF01 HELP PF02 PF03 EXIT PF04 GoTo PF05 PF06 CONFIRM
 PF07 BKWD PF08 FWD PF09 PF10 LAND PF11 NXTSEC PF12 RECONF

CMD : ONGARD 10/16/01 13:00:37
 OG6IPRD INQUIRE PRODUCTION BY POOL/WELL OGOMES -TPKF
 Page No: 1

OGRID Identifier : 14021 MARATHON OIL CO
 Pool Identifier : 76480 EUMONT;YATES-7 RVRS-QUEEN (PRO GAS)
 API Well No : 30 25 32380 Report Period - From : 01 2000 To : 07 2001

API Well No			Property Name		Prod. Days		Production Volumes			Well
					MM/YY	Prod	Gas	Oil	Water	Stat
30	25	32380	W	H	LAUGHLIN	01 00	31	832		F
30	25	32380	W	H	LAUGHLIN	02 00	29	650		F
30	25	32380	W	H	LAUGHLIN	03 00	31	694		F
30	25	32380	W	H	LAUGHLIN	04 00	30	654		F
30	25	32380	W	H	LAUGHLIN	05 00	31	512		F
30	25	32380	W	H	LAUGHLIN	06 00	30	589		F
30	25	32380	W	H	LAUGHLIN	07 00	31	599		F

Reporting Period Total (Gas, Oil) :

M0025: Enter PF keys to scroll

PF01 HELP PF02 PF03 EXIT PF04 GoTo PF05 PF06 CONFIRM
 PF07 BKWD PF08 FWD PF09 PF10 NXTPOOL PF11 NXTOGD PF12

CMD : ONGARD 10/16/01 13:00:40
OG6IPRD INQUIRE PRODUCTION BY POOL/WELL OGOMES -TPKF
Page No: 2

OGRID Identifier : 14021 MARATHON OIL CO
Pool Identifier : 76480 EUMONT;YATES-7 RVRS-QUEEN (PRO GAS)
API Well No : 30 25 32380 Report Period - From : 01 2000 To : 07 2001

API Well No	Property Name	Prodn. MM/YY	Days Prod	Production Volumes Gas	Oil	Water	Well Stat
30 25 32380	W H LAUGHLIN	08 00	31	554			F
30 25 32380	W H LAUGHLIN	09 00	30	669			F
30 25 32380	W H LAUGHLIN	10 00	31	699			F
30 25 32380	W H LAUGHLIN	11 00	30	642			F
30 25 32380	W H LAUGHLIN	12 00	31	636			F
30 25 32380	W H LAUGHLIN	01 01	31	676			F
30 25 32380	W H LAUGHLIN	02 01	28	607			F

Reporting Period Total (Gas, Oil) :

E0049: User may continue scrolling.

PF01 HELP PF02 PF03 EXIT PF04 GoTo PF05 PF06 CONFIRM
PF07 BKWD PF08 FWD PF09 PF10 NXTPOOL PF11 NXTOGD PF12

CMD : ONGARD 10/16/01 13:00:43
OG6IPRD INQUIRE PRODUCTION BY POOL/WELL OGOMES -TPKF
Page No: 3

OGRID Identifier : 14021 MARATHON OIL CO
Pool Identifier : 76480 EUMONT;YATES-7 RVRS-QUEEN (PRO GAS)
API Well No : 30 25 32380 Report Period - From : 01 2000 To : 07 2001

API Well No	Property Name	Prodn. Days		Production Volumes			Well
		MM/YY	Prod	Gas	Oil	Water	
30 25 32380	W H LAUGHLIN	03 01	31	857			F
30 25 32380	W H LAUGHLIN	04 01	30	825			F
30 25 32380	W H LAUGHLIN	05 01	31	872			F
30 25 32380	W H LAUGHLIN	06 01	30	702			F
30 25 32380	W H LAUGHLIN	07 01	31	924			F

Reporting Period Total (Gas, Oil) : 13193

E0049: User may continue scrolling.

PF01 HELP PF02 PF03 EXIT PF04 GoTo PF05 PF06 CONFIRM
PF07 BKWD PF08 FWD PF09 PF10 NXTPOOL PF11 NXTOGD PF12

126054240

New Mexico Oil Conservation Division---Engineering Bureau
Administrative Application Process Documentation

Date Application Received: 9-14-01

Date of Preliminary Review: 10-16-01
(Note: Must be within 10-days of received date)

Results: Application Complete Application Incomplete

Date Incomplete Letter Sent: NA

Deadline to Submit Requested Information: NA

Phone Call Date: NA
(Note: Only applies if requested data is not submitted within the 7-day deadline)

Phone Log Completed? Yes No

Date Application Processed: 10-16-01

Date Application Returned: _____
(Note: Only as a last resort & only after repeated attempts by the Division to obtain the necessary information to process the application)