

cc-ore - Hobbs
3/4/57
MAIN OFFICE
CONTINENTAL OIL COMPANY

NSP-363
Dw 4/1/57
Roswell, New Mexico
March 5, 1957

New Mexico Oil Conservation Commission
Box 871
Santa Fe, New Mexico

Attention: Mr. A. L. Porter, Jr. Re: Continental Oil Company
Application for 160-
acre NSP unit for its
Sholes B-19 No. 2 in
Section 19, T25S, R37E,
Jalmat Pool, Lea County,
New Mexico.

Gentlemen:

Continental Oil Company respectfully requests adminis-
trative approval under the provisions of Rule 5 (a) of the
Special Rules and Regulations for the Jalmat Gas Pool of Order
No. R-520 for a non-standard gas proration unit consisting of
160 acres for its Sholes B-19 No. 2 well located 990 feet from
the North line and 2310 feet from the West line of Section 19,
Township 25 South, Range 37 East, Lea County, New Mexico in the
Jalmat gas pool.

The unit is proposed to consist of the E/2 NW/4, W/2
NE/4 of Section 19, Township 25 South, Range 37 East.

In support of this request we should like to point
out that the proposed unit conforms with the requirements of
said Rule 5 (a) in all respects as follows:

1. Said unit consists of contiguous quarter-quarter
sections (and/or lots).
2. Said unit lies wholly within a single governmental
section.
3. The entire proposed unit may be reasonably presumed
to be productive of gas.
4. The length or width of said unit does not exceed
5,280 feet.
5. Copies of this application have been furnished by
registered mail to all offset operators and all
operators within 1,500 feet of said well.

A plat is attached hereto showing to the best of our
knowledge and belief the proposed unit, the location of the
well, and the offset ownership.

In view of the facts set out herein it is respectfully
requested that the Commission enter an order approving the

New Mexico Oil Conservation Commission
Page 2

non-standard gas proration unit for Continental Oil Company's
Sholes B-19 No. 2 well as described above.



R. L. ADAMS
Division Superintendent
of Production
New Mexico Division

Copies by Registered Mail to:

✓ Ralph Lowe Oil Company
Box 832
Midland Tower Bldg.
Midland, Texas

✓ R. Olsen
Drawer Z
Jal, New Mexico

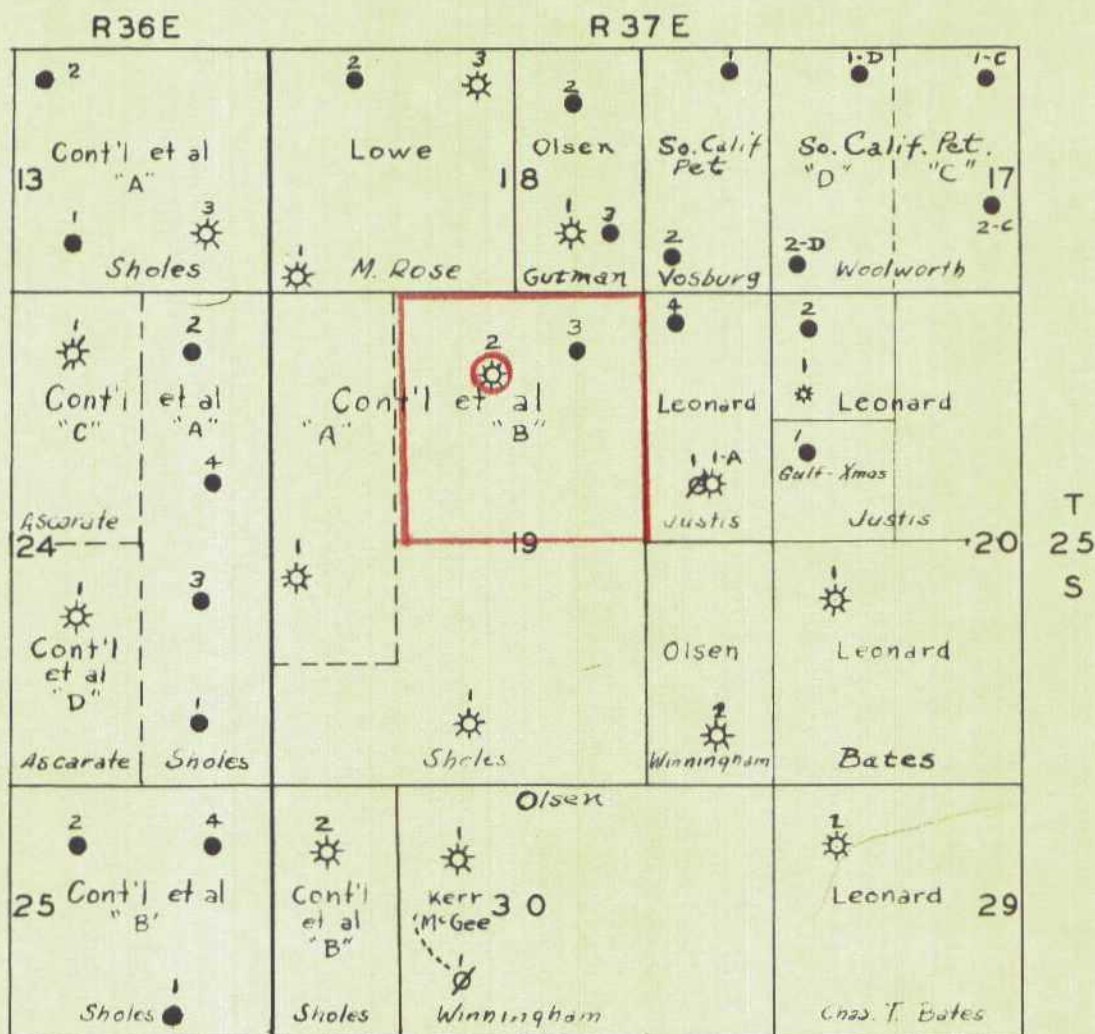
✓ Leonard Oil Company
J. P. White Building
Box 708
Roswell, New Mexico



CONTINENTAL OIL COMPANY

SHOLES A-19 & B-19 LEASES
SURROUNDING LEASEHOLDINGS AND WELLS

SCALE: 1" = 2000'
EUNICE, N.M.

1/13/57

New Mexico Oil Conservation Commission

STATE OF NEW MEXICO)
) ss.
COUNTY OF CHAVES)

R. L. Adams, being first duly sworn on behalf of the applicant in the above application, says: That he is the Division Superintendent, of applicant, and as such is authorized to make said application; that he has read the foregoing application, knows the contents thereof, and that the same are true as he is reliably informed and believes.

R. L. Adams
(Signature)

Subscribed and sworn to before me this 5th day of March, 1958.

Louis B. Houston
Notary Public

My Commission Expires:
May 25, 1960