

MAIN OFFICE **THE TEXAS COMPANY**

TEXACO PETROLEUM PRODUCTS



DOMESTIC PRODUCING DEPARTMENT  
FORT WORTH DIVISION

P. O. Box 352  
Midland, Texas  
November 7, 1958

APPLICATION OF THE TEXAS COMPANY  
FOR APPROVAL OF A NON-STANDARD  
GAS PRORATION UNIT

Jalmat (Gas Pool)  
Lea County, New Mexico

New Mexico Oil Conservation Commission  
P. O. Box 871  
Santa Fe, New Mexico

Gentlemen:

The Texas Company hereby makes application for administrative approval of a 40-acre non-standard gas proration unit comprising the SW/4 of the NW/4 of Section 30, T-24-S, R-37-E, Lea County, New Mexico, to be assigned to its C. C. Fristoe "b" (NCT-3) Well No. 1, and in support thereof states the following:

1. The Texas Company is owner and operator of the C. C. Fristoe "b" (NCT-3) Well No. 1, located 660 feet from the West line and 1980 feet from the North line of Section 30, T-24-S, R-37-E, Lea County, New Mexico. The attached plat shows the subject 160-acre C. C. Fristoe "b" (NCT-3) Lease and all offset operators.
2. The C. C. Fristoe "b" (NCT-3) Well No. 1 was classified as a Jalmat (Oil) well with a one barrel per day allowable as a result of a gas-oil ratio of 123,500 cubic feet per barrel until September 1, 1958, at which time the oil allowable was cancelled due to excessive gas-oil ratio. The well produces from an open hole interval from 2828 feet to 3180 feet in the Yates formation which is within the vertical limits of the Jalmat Gas Pool.
3. There are presently four other wells producing on the subject lease, three in the Jalmat (Oil) Pool and one in the Langlie-Mattix Pool. Since the completion interval in the subject well includes the producing intervals of the three Jalmat (Oil) Pool wells, it is therefore proposed to assign the SW/4 of the NW/4 of Section 30, comprising 40 acres, to the C. C. Fristoe "b" (NCT-3) Well No. 1 for gas proration purposes.
4. The proposed non-standard gas proration unit meets with the requirements in Rule 5 (b) of Order No. R-520 in that:

*Due Dec 10, 1958*  
**NSP-453**  
*(waiting on...)*

55.32  
25.00  
80.32

November 7, 1958

- a. The non-standard gas proration unit consists of contiguous quarter-quarter sections and/or lots.
- b. The non-standard gas proration unit lies wholly within a single governmental section.
- c. The entire non-standard gas proration unit may reasonably be presumed to be productive of gas.
- d. The length or width of the non-standard gas proration unit does not exceed 5280 feet.
- e. All operators owning interests within 1500 feet of the proposed gas well and all offset operators to the lease have submitted letters of waiver, one copy each of which is attached.

Based on the facts recited above, The Texas Company respectfully requests that the New Mexico Oil Conservation Commission approve administratively the non-standard gas proration unit described above.

Yours very truly,

THE TEXAS COMPANY



J. G. Blevins, Jr.  
Asst. Dist. Supt.

LMF:JM

Attachments

STATE OF TEXAS     )  
                              )  
COUNTY OF MIDLAND )

Before me, the undersigned authority, on this the 7th day of November, personally appeared J. G. Blevins, Jr., known to me to be the person whose name is subscribed to this instrument, who after being by me duly sworn on oath, states that he has knowledge of all the facts stated above and that the same is a true and correct statement of the facts therein recited.



J. G. Blevins, Jr.

Subscribed and sworn to before me on this 7th day of November, 1958.

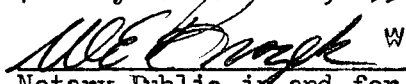

W. E. BROZEK  
Notary Public in and for  
Midland County, Texas

Southern Calif. Pet.

Amerada Pet.  
Box 312  
Midland, Tex.

Cities Service  
Box 97  
Hobbs, N.M.

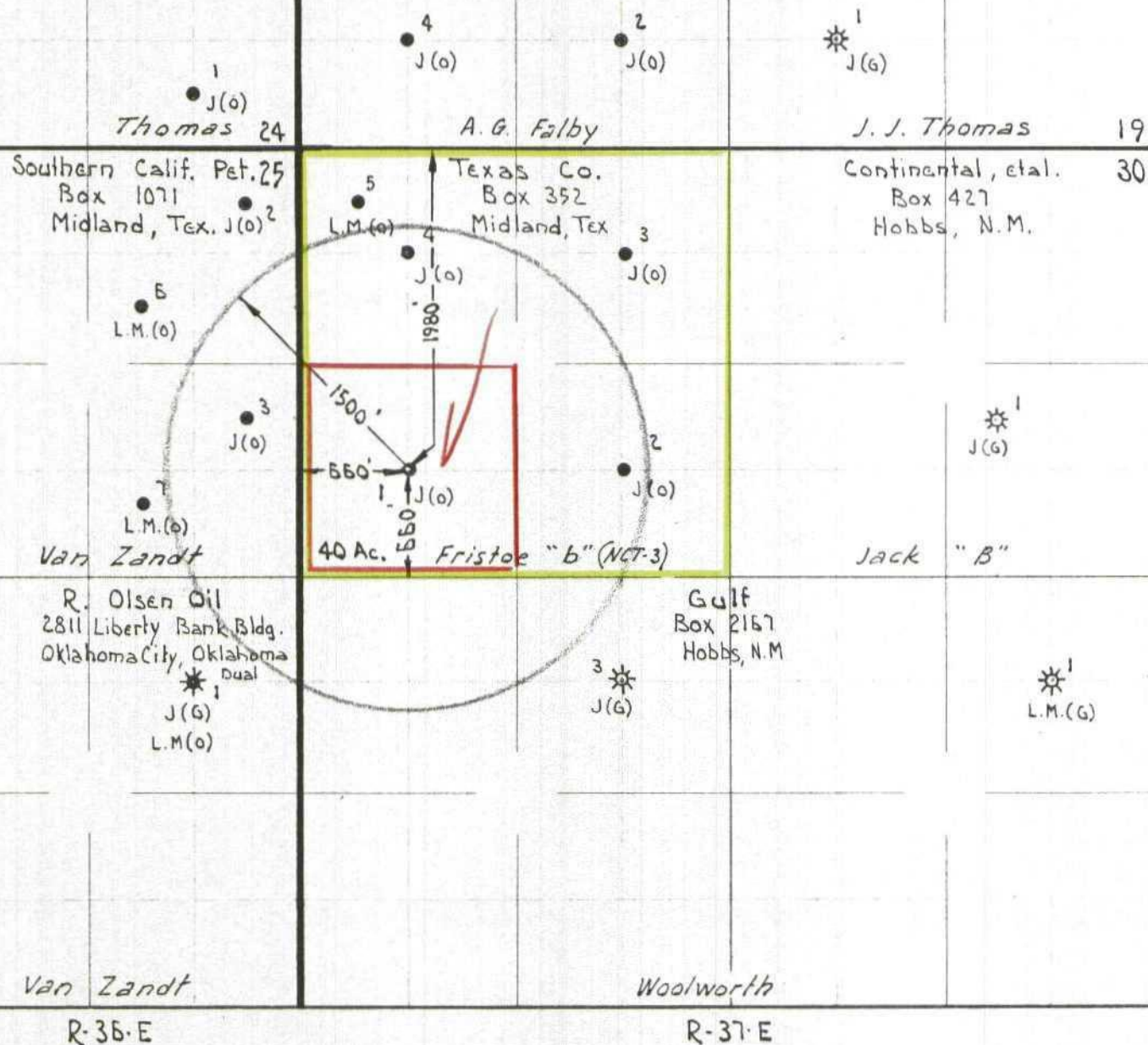

LEGEND

L.M.(O)-LANGLIE MATTIX OIL FIELD  
L.M.(G)-LANGLIE MATTIX GAS FIELD  
J.(O)-JALMAT OIL FIELD  
J.(G)-JALMAT GAS FIELD  
— PROPOSED PRORATION UNIT LINES  
— LEASE LINES

LEA COUNTY, NEW MEXICO  
SCALE: 1" = 1000'



PETROLEUM AND ITS PRODUCTS

ROSWELL DISTRICT

W. A. SHELLSHEAR  
District Manager

E. S. GREAR  
District Exploration Manager

M. I. TAYLOR  
District Production Manager

G. A. PRICE  
District Services Manager

# GULF OIL CORPORATION

P. O. DRAWER 669 — ROSWELL, NEW MEXICO

FORT WORTH  
PRODUCTION DIVISION

September 29, 1958

The Texas Company  
Post Office Box 352  
Midland, Texas

Gentlemen:

This is to advise that Gulf Oil Corporation has been given due notice that you have made application for permission to establish a non-standard proration unit in the Jalmat Gas Pool. It is understood that this non-standard proration unit will be assigned to your C. C. Fristoe "b" (NCT-3) Well No. 1, which is located 660' FWL and 1,980' FNL of Section 30, T-24-S, R-37-E, Lea County, New Mexico.

We hereby waive any objection to the granting of permission to establish the non-standard gas unit encompassing the following acreage:

40 acres consisting of the SW/4 of the NW/4  
of Section 30, T-24-S, R-37-E, Lea County,  
New Mexico.

Executed this 29th day of September, 1958.

Yours very truly,

GULF OIL CORPORATION,

By: W. A. Shellshear

District Manager



# CONTINENTAL OIL COMPANY

FAIR BUILDING  
FORT WORTH 2, TEXAS

H. L. JOHNSTON  
REGIONAL MANAGER OF PRODUCTION  
SOUTHWESTERN REGION

November 4, 1958

New Mexico Oil Conservation Commission  
107 Mabry Hall  
Capitol Building  
Santa Fe, New Mexico

Attention: Mr. A. L. Porter, Jr., Secretary and Director  
Gentlemen:

Continental Oil Company has been notified of The Texas Company's application for a 40-acre non-standard gas proration unit comprising the SW/4 of the NW/4 of Section 30, T-24-S, R-37-E, Lea County, New Mexico, to be assigned to its C. C. Fristoe "b" (NCT-3) No. 1.

You are respectfully advised that Continental Oil Company hereby waives notice and hearing on the application described above.

Yours very truly,

HLJ-SL

The Texas Company  
P. O. Box 352  
Midland, Texas

Gentlemen:

We, the undersigned, as an offset operator to your C. C. Fristoe "b" (NCT-3) Well No. 1 located in Section 30, Township 24-S, Range 37-E, Lea County, New Mexico, have no objection to the formation of a 40-acre non-standard gas proration unit for the subject well in the Jalmat (Gas) Pool, the 40-acres to consist of the SW/4 of the NW/4 of Section 30, T-24-S, R-37-E, Lea County, New Mexico.

Chen Oil Co.  
By L. Chen, Pres.  
Company  
10 - 21 - 58  
Date

The Texas Company  
P. O. Box 352  
Midland, Texas

Gentlemen:

We, the undersigned, as an offset operator to your C. C. Fristoe "b" (NCT-3) Well No. 1 located in Section 30, Township 24-S, Range 37-E, Lea County, New Mexico, have no objection to the formation of a 40-acre non-standard gas proration unit for the subject well in the Jalmat (Gas) Pool, the 40-acres to consist of the SW/4 of the NW/4 of Section 30, T-24-S, R-37-E, Lea County, New Mexico.

A. S. Christie

AMERADA PETROLEUM CORPORATION  
Company

October 1, 1958  
Date

The Texas Company  
P. O. Box 352  
Midland, Texas

Gentlemen:

We, the undersigned, as an offset operator to your C. C. Fristoe "b" (NCT-3) Well No. 1 located in Section 30, Township 24-S, Range 37-E, Lea County, New Mexico, have no objection to the formation of a 40-acre non-standard gas proration unit for the subject well in the Jalmat (Gas) Pool, the 40-acres to consist of the SW/4 of the NW/4 of Section 30, T-24-S, R-37-E, Lea County, New Mexico.

Jawarner  
So. Calif. Petrol. Corp.  
Company  
9-23-58  
Date



The Texas Company  
P. O. Box 352  
Midland, Texas

Gentlemen:

We, the undersigned, as an offset operator to your C. C. Fristoe "b" (NCT-3) Well No. 1 located in Section 30, Township 24-S, Range 37-E, Lea County, New Mexico, have no objection to the formation of a 40-acre non-standard gas proration unit for the subject well in the Jalmat (Gas) Pool, the 40-acres to consist of the SW/4 of the NW/4 of Section 30, T-24-S, R-37-E, Lea County, New Mexico.

CITIES SERVICE OIL COMPANY

  
Company Division Supt.

September 22, 1958

Date