

MAIN OFFICE OCC

1960 OCT 3 PM 1:25

*Due
now 3*

OLSEN OILS, INC.

BOX 691

JAL. NEW MEXICO

September 30, 1960

MAIN OFFICE OCC

1960 OCT 3 PM 1:25

*NSP-532
(Waiting period)*

Secretary-Director
New Mexico Oil Conservation Commission
Post Office Box 871
Santa Fe, New Mexico

Dear Sir:

Olsen Oils, Incorporated requests approval of a non-standard gas proration unit of 80 acres consisting of the E/2 NW/4 of Section 30, T 25S, R 37E, Lea County, New Mexico, on which is located the Winningham #1.

Olsen Oils, Incorporated warrants that the non-standard gas proration unit consists of contiguous quarter-quarter sections lying wholly within a single governmental section and further warrants that the non-standard gas proration unit is productive of gas and that the length or width of the non-standard gas proration unit does not exceed 5280 feet.

The above unit is decreased by 80 acres due to the fact that Winningham #1 will not make its current assigned allowable and further rework is deemed uneconomical.

By copy of this letter all offset operators within Section 30, T 25S, R 37E and within 1500 feet of subject well are notified of the company's request for a non-standard gas proration unit.

Very truly yours,

OLSEN OILS, INCORPORATED

Dewey Watson

Dewey Watson
Engineer

DW/ce

cc: New Mexico Oil Conservation Commission
Post Office Box 871
Santa Fe, New Mexico

Continental Oil Company
Post Office Box 427
Hobbs, New Mexico

Olsen-Blount Oil Company
2811 Liberty National Bank
Oklahoma City, Oklahoma

Leonard Oil Company
Post Office Box 872
Roswell, New Mexico

NEW MEXICO OIL CONSERVATION COMMISSION
WELL LOCATION AND ACREAGE DEDICATION PLAT

FORM C-128
Revised 5/1/57

SEE INSTRUCTIONS FOR COMPLETING THIS FORM ON THE REVERSE SIDE

SECTION A

Operator Olsen Oils, Inc.			Lease Winningham		Well No. 1
Unit Letter C	Section 30	Township 25S	Range 37E	County Lea	
Actual Footage Location of Well: 1980 feet from the West line and 660 feet from the North line					
Ground Level Elev. Not Available	Producing Formation Yates		Pool Jalmat		Dedicated Acreage: 80 Acres

1. Is the Operator the only owner in the dedicated acreage outlined on the plat below? YES ☒ NO ____ . ("Owner" means the person who has the right to drill into and to produce from any pool and to appropriate the production either for himself or for himself and another. (65-3-29 (e) NMSA 1935 Comp.)
2. If the answer to question one is "no," have the interests of all the owners been consolidated by communitization agreement or otherwise? YES ____ NO ____ . If answer is "yes," Type of Consolidation _____
3. If the answer to question two is "no," list all the owners and their respective interests below:

Owner	Land Description

SECTION B

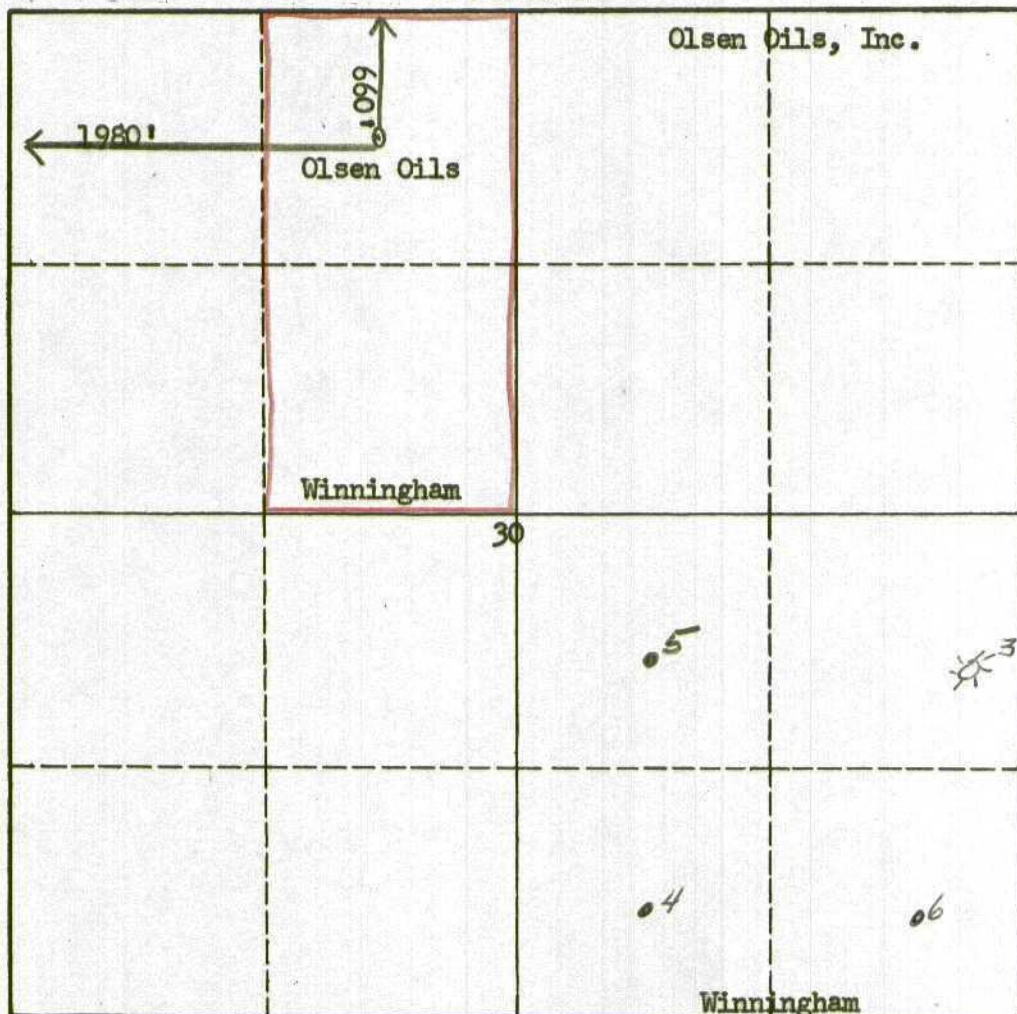

CERTIFICATION

I hereby certify that the information in SECTION A above is true and complete to the best of my knowledge and belief.

Name	<i>Dwain Watson</i>
Position	Engineer
Company	Olsen Oils, Inc.
Date	9-19-60

I hereby certify that the well location shown on the plat in SECTION B was plotted from field notes of actual surveys made by me or under my supervision, and that the same is true and correct to the best of my knowledge and belief.

See Original Plat

Date Surveyed	
Registered Professional Engineer and/or Land Surveyor	
Certificate No.	