

Gulf Oil Corporation

1911 OFFICE BCC
ROSWELL PRODUCTION DISTRICT

W. A. Shellishear
DISTRICT MANAGER
F. O. Mortlock
DISTRICT EXPLORATION
MANAGER
M. I. Taylor
DISTRICT PRODUCTION
MANAGER
H. C. Vivian
DISTRICT SERVICES MANAGER

1962 APR 23 AM 5:20

April 19, 1962

NSP 598
30 days
P. O. Drawer 1938
Roswell, New Mexico
see - May 21

Oil Conservation Commission
State of New Mexico
Post Office Box 871
Santa Fe, New Mexico

Re: Application of Gulf Oil Corporation for the Approval of a
Non-Standard 160-Acre Gas Proration Unit, Blinebry Gas
Pool, Lea County, New Mexico

Gentlemen:

Gulf Oil Corporation respectfully requests administrative approval of a Non-Standard 160-Acre Blinebry Gas Proration Unit covering the N/2 SW/4, SE/4 NW/4 and SW/4 NE/4 of Section 31-22S-38E, Lea County, New Mexico. This non-standard unit is to be attributed to the Scarborough Estate Well No. 4. In support of this application the following facts are submitted:

- (1) Applicant's Scarborough Estate Well No. 4, located 1,980 feet from the north line and 1,980 feet from the west line of Section 31, is completed in the Blinebry Gas Pool and is assigned a Non-Standard 120-Acre Gas Proration Unit covering the N/2 SW/4 and the SE/4 NW/4 by Administrative Order NSP-575 dated October 30, 1961.
- (2) The SW/4 NE/4 of this Section 31 is now dedicated to the Scarborough Estate Well No. 3 by Administrative Order NSP-563 dated August 31, 1961. The Scarborough Estate Well No. 2, located in the SE/4 NE/4, is being dually completed in the Blinebry Oil and an application has been submitted to attribute only the NE/4 SE/4 to Well No. 3. In order to have contiguous quarter-quarter sections attributed to a gas proration unit it is proposed to dedicate the SW/4 NE/4 to the Scarborough Estate Well No. 4 thereby increasing the existing 120-Acre Non-Standard Unit to a 160-Acre Non-Standard Unit.
- (3) The proposed Non-Standard Gas Proration Unit consists of contiguous quarter-quarter sections, but does not lie wholly within a single governmental quarter section.
- (4) The entire Non-Standard Proration Unit is reasonably presumed to be gas productive in the Blinebry Gas Pool.
- (5) The length does exceed 2,640 feet.



April 19, 1962

- (6) All offset operators in the quarter sections in which the proposed Non-Standard Unit is located and within 1,500 feet of the Unit Well have been furnished a copy of this application.

Respectfully submitted,

GULF OIL CORPORATION

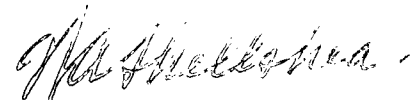

W. A. Shellshear

JHH:bc

cc: New Mexico Oil Conservation Commission
Post Office Box 2045
Hobbs, New Mexico

Texaco Inc.
Post Office Box 3109
Midland, Texas

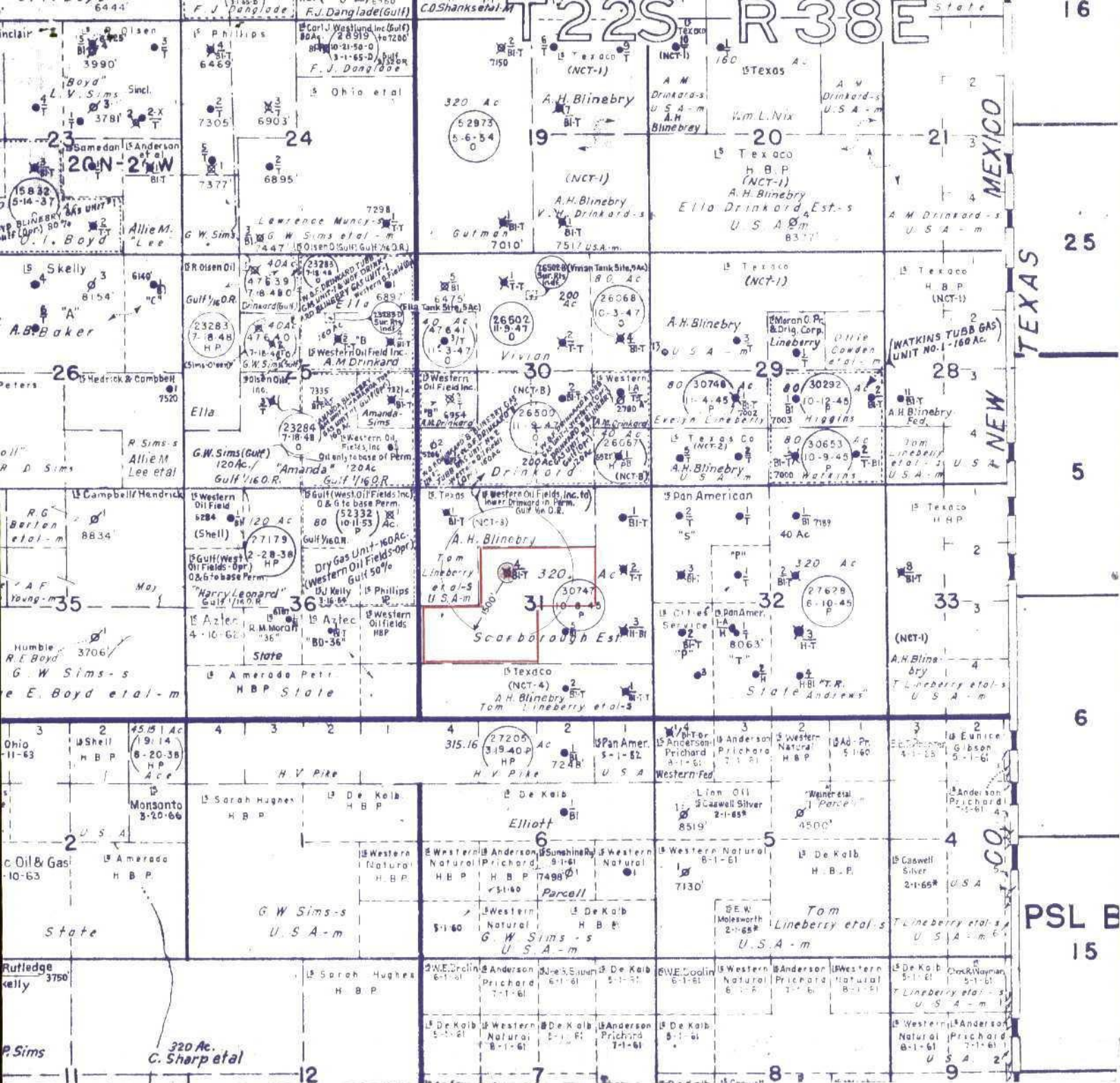

LEASE PLAT

SCARBOROUGH ESTATE LEASE BLINEBRY GAS POOL

Lea County, New Mexico

- LEGEND -

Proposed Non-Standard Unit

Pertinent Well

Gulf Oil Corporation