

OIL CONSERVATION COMMISSION

P. O. BOX 871

SANTA FE, NEW MEXICO

November 2, 1964

C  
O  
P  
Y  
Gulf Oil Corporation  
P. O. Drawer 1938  
Roswell, New Mexico

Attention: Mr. M. I. Taylor

Administrative Order NSP-695

Gentlemen:

Reference is made to your application for approval of a 240-acre non-standard gas proration unit in the Jalmat Gas Pool consisting of the following acreage:

LEA COUNTY, NEW MEXICO  
TOWNSHIP 22 SOUTH, RANGE 36 EAST, NMPM  
Section 4: SW/4 and W/2 NW/4

It is understood that this unit is to be dedicated to your J. F. Janda (NCT-F) Well No. 7, located 1980 feet from the South line and 1980 feet from the West line of said Section 4.

By authority granted me under the provisions of Order No. R-1670, as amended, governing the Jalmat Gas Pool, you are hereby authorized to operate the above-described acreage as a non-standard gas proration unit, with allowable to be assigned thereto in accordance with the pool rules, based upon the unit size of 240 acres.

This administrative order will not be effective until this office has received a notice of disconnection for your J. F. Janda (NCT-F) Well No. 5, located in the SW/4 NW/4 of said Section 4.

Very truly yours,

A. L. PORTER, Jr.  
Secretary-Director

ALP/JMD/esr

cc: Oil Conservation Commission - Hobbs  
Oil & Gas Engineering Committee - Hobbs  
Proration Department, OCC - Santa Fe

# Gulf Oil Corporation

ROSWELL PRODUCTION DISTRICT

October 28, 1964

F. O. Drawer 1928  
Roswell, New Mexico 88201 OCC

\*64 OCT 29 AM 8 08

*NSP-695  
now  
effective date a notice  
of this application is  
filed for J. F. Janda  
(NCT-F) will no  
longer*

Oil Conservation Commission  
State of New Mexico  
Post Office Box 2088  
Santa Fe, New Mexico 87501

Re: Application of Gulf Oil Corporation for Administrative Approval  
of a 240-Acre Non-Standard Gas Proration Unit, Lea County,  
New Mexico

Gentlemen:

Gulf Oil Corporation respectfully requests Administrative approval of a 240-acre non-standard gas proration unit in the Jalmat Gas Pool, covering the SW/4 and W/2 NW/4 Section 4-22S-36E, Lea County, New Mexico. This non-standard unit is to be attributed to the J. F. Janda (NCT-F) Well No. 7 located 1,980 feet from the south and west lines of this Section 4. The attached plat shows this non-standard unit outlined in red.

In support of this application, the following facts are submitted:

- (1) Applicant's J. F. Janda (NCT-F) Well No. 7 is dually completed in the South Eunice Oil and Jalmat Gas Pools. Order No. R-1770 approved three non-standard gas proration units, one of which was a 160-acre unit covering the SW/4 of Section 4, to be attributed to the J. F. Janda (NCT-F) Well No. 7.
- (2) Applicant's J. F. Janda (NCT-F) Well No. 5 located in the SW/4 NW/4 of Section 4 was dually completed in the Jalmat and South Eunice Oil Pools; however, has recently been reclassified from a Jalmat Oil Well to a Jalmat Gas Well. The Jalmat gas zone will be shut-in and since there are now no Jalmat oil wells in the W/2 NW/4 it is proposed to attribute this 80 acres to Well No. 7 to form the non-standard 240-acre gas proration unit.
- (3) The proposed non-standard gas proration unit consists of contiguous quarter-quarter sections or lots.
- (4) The proposed non-standard gas proration unit lies wholly within a single governmental section.
- (5) The entire non-standard unit is reasonably presumed to be gas productive in the Jalmat Gas Pool.



October 28, 1964

- (6) The length or width of the proposed non-standard unit does not exceed 5,280 feet.
- (7) Applicant owns all the leasehold interest in the section in which the proposed non-standard unit is located and within 1,500 feet of the unit well.

Respectfully submitted,

GULF OIL CORPORATION

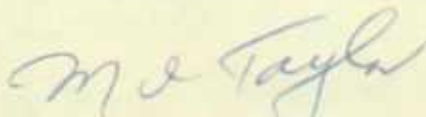

M. I. Taylor

Attachment  
JHH:dch

cc: New Mexico Oil Conservation Commission  
Post Office Box 1980  
Hobbs, New Mexico 88240

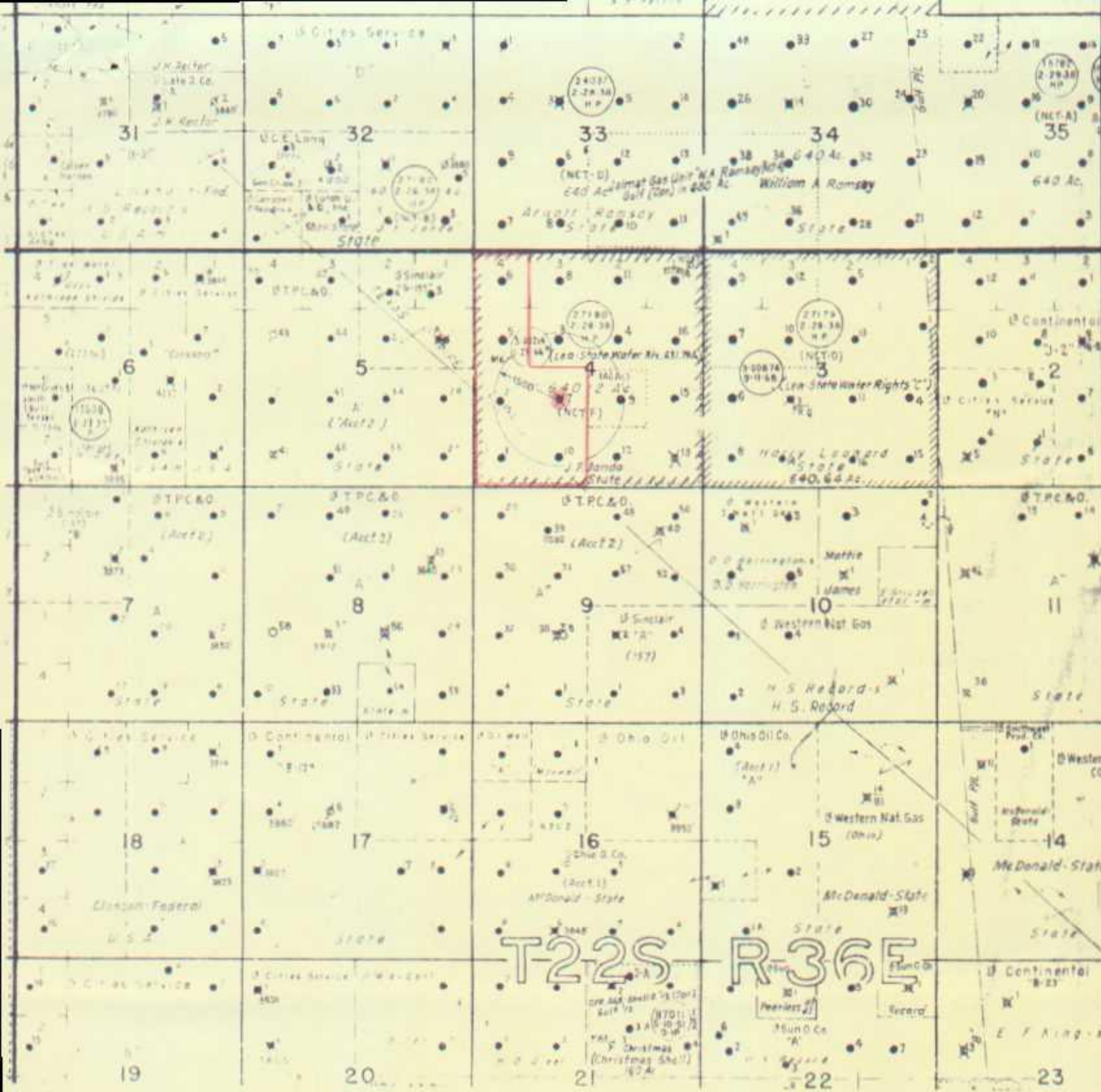

PLAT

J. F. JANDA (NCT-F) LEASE  
 JALMAT GAS POOL  
 Lea County, New Mexico

- LEGEND -

Proposed Non-Standard Unit

Pertinent Well

GULF OIL CORPORATION ROSWELL DISTRICT