

Atlantic Richfield Company

North American Producing Division  
Permian District  
Post Office Box 1610  
Midland, Texas 79701  
Telephone 915 682 8631

W. P. Tomlinson  
District Engineer - West Area

May 18, 1971

New Mexico Oil Conservation Commission  
P. O. Box 2038  
Santa Fe, New Mexico

Attn: Mr. A. L. Porter

Re: Non-Standard Proration Unit  
W. H. Turner No. 1  
Blinebry Gas Pool  
Sec. 29, T-21S, R-37E  
Lea County, New Mexico

Gentlemen:

Atlantic Richfield respectfully requests administrative approval under the provisions of Order R-1670, Rule 29, for a 120-acre non-standard gas proration unit in the Blinebry Gas Pool. The subject unit will comprise the E/2, SW/4, and the NW/4, SW/4 of Section 29, T-21S, R-37E, as shown on the attached plat. Two wells in the unit area produce from the Blinebry Gas Pool. The H. S. Turner No. 3 is a marginal Blinebry gas well located 660' FSL and 1980' FWL of Section 29, currently assigned an 80-acre non-standard gas proration unit comprising the E/2, SW/4 of Section 29, and known as the Turner Gas Com. The W. H. Turner No. 1, located 2310' FSL and 990' FWL of Section 29, is a former Blinebry oil well, reclassified to gas on December 1, 1970, because of an excessively high gas-oil ratio. The well is awaiting connection to the El Paso gathering system and assignment of a provisional 40-acre allowable based upon the NW/4, SW/4 of Section 29. We request the assignment of allowables equivalent to the volume of gas allocated to a single 120-acre proration unit, as set forth in Rule 29, and propose, as operator, to determine the proportion of allowable to be produced by each well in the unit.

Attached are amended copies of Form C-102 for the W. H. Turner No. 1 and H. S. Turner No. 3 wells. Copies of this application have been submitted to the offset operators listed below.

Yours very truly,

*W. P. Tomlinson*  
W. P. Tomlinson

WPT/agp

cc: AKOCO, Box 1410, Fort Worth, Texas ✓  
Gulf Oil Corporation, Box 1150, Midland, Texas 79701 ✓  
Marathon Oil Corp., Box 552, Midland, Texas 79701 ✓  
Mobil Oil Corporation, Box 933, Midland, Texas 79701 ✓  
Skelly Oil Company, Box 1351, Midland, Texas 79701 ✓  
Sunray DX, Box 1416, Roswell, New Mexico 88201 ✓  
Texaco, Inc., Box 728, Hobbs, New Mexico ✓



91 MAY 24 PM 1 25

*NSP  
Dedicated to two  
wells  
issue 6-23-71  
R-1670*

*Blinebry Gas Pool*

L.G. Warlick

J.W. Perry  
"Hardy"

Federal

D.C. Hardy

Tidewater

D.C. Hardy

Texaco

D.C. Hardy

Socony Mobil

Sunray

Linam

Sunray  
"A"

V.M. Henderson

D.C. Hardy

D.C. Hardy

McDonald O

Gulf  
NCT-B

Arco

Marathon

W.H. Turner

W.H. Turner

Arco

Pan Amer

H.T. Mattern

H.T. Mattern

H.S. Turner

W.H. Turner

Gulf

Skelly  
"K"

Gulf

State

Amerada  
"A"

H.T. Mattern

State

Sohio

Amerada

Southern Pet Expl.

Joyce Pruitt

T 21 S

R 37 E

NEW MEXICO OIL CONSERVATION COMMISSION  
WELL LOCATION AND ACREAGE DEDICATION PLAT AMENDED

Form C-102  
Supersedes C-128  
Effective 1-1-65

All distances must be from the outer boundaries of the Section.

Operator <b>Atlantic Richfield Company</b>			Lease <b>H. S. Turner</b>		Well No. <b>3</b>
Unit Letter <b>N</b>	Section <b>29</b>	Township <b>21-S</b>	Range <b>37-E</b>	County <b>Lea</b>	
Actual Footage Location of Well: <b>660</b> feet from the <b>South</b> line and <b>1980</b> feet from the <b>West</b> line.					
Ground Level Elev:	Producing Formation <b>Blinebry</b>	Pool <b>Blinebry Gas Pool</b>		Dedicated Acreage: <b>120</b> Acres	

1. Outline the acreage dedicated to the subject well by colored pencil or hachure marks on the plat below.
2. If more than one lease is dedicated to the well, outline each and identify the ownership thereof (both as to working interest and royalty).
3. If more than one lease of different ownership is dedicated to the well, have the interests of all owners been consolidated by communitization, unitization, force-pooling, etc?

☐ Yes ☐ No If answer is "yes," type of consolidation \_\_\_\_\_

If answer is "no," list the owners and tract descriptions which have actually been consolidated. (Use reverse side of this form if necessary.) \_\_\_\_\_

No allowable will be assigned to the well until all interests have been consolidated (by communitization, unitization, forced-pooling, or otherwise) or until a non-standard unit, eliminating such interests, has been approved by the Commission.

R-37E

T  
21  
E

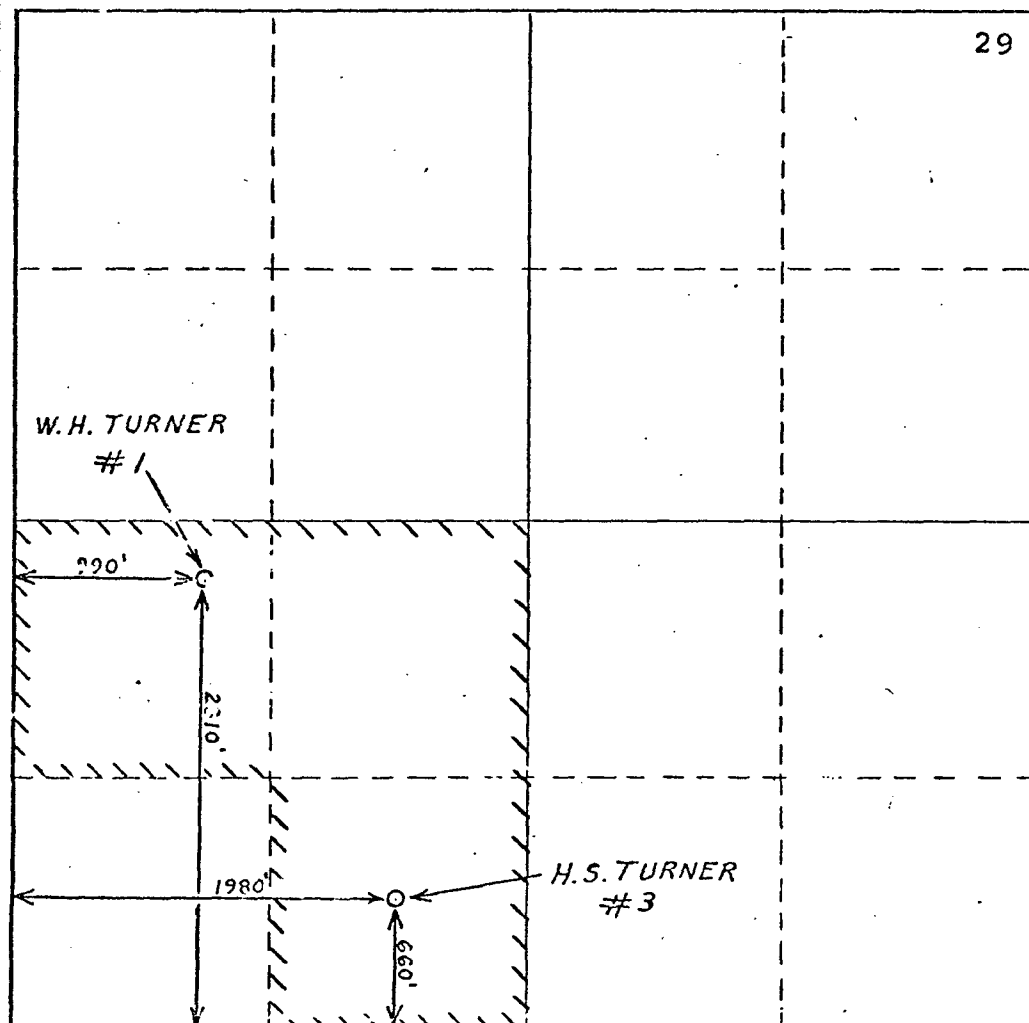

**CERTIFICATION**

I hereby certify that the information contained herein is true and complete to the best of my knowledge and belief.

*W. H. Turner*

Name

Position

Company

Date

I hereby certify that the well location shown on this plat was plotted from field notes of actual surveys made by me or under my supervision, and that the same is true and correct to the best of my knowledge and belief.

Date Surveyed

Registered Professional Engineer and/or Land Surveyor

Certificate No.

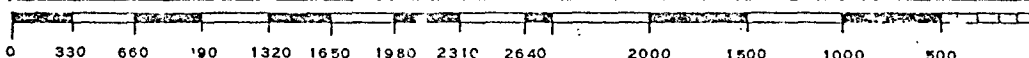



*[Handwritten signature]*

**Amoco Production Company**

Oil and Gas Building  
P.O. Box 1410  
Fort Worth, Texas 76101

June 3, 1971

D. L. Ray  
Division Engineer

File: DRC-298-986.510.1

Subject: Atlantic Richfield Company's  
Request for a Non-Standard  
Proration Unit, W. H. Turner  
Well No. 1, Blinebry Gas Pool  
Lea County, New Mexico

New Mexico Oil Conservation Commission  
P. O. Box 2088  
Santa Fe, New Mexico 87501

Gentlemen:

Amoco Production Company, as an offset operator, has been advised of Atlantic Richfield Company's request for a 120-acre non-standard gas proration unit for their W. H. Turner No. 1 in the Blinebry Gas Pool. The subject unit will comprise the E/2 SW/4 and the NW/4 SW/4 of Section 29 T-21-S R-37-E, Lea County, New Mexico. The W. H. Turner No. 1 is located 2310' FSL and 990' FWL of Section 29. The H. S. Turner No. 3 is also producing gas and is located 660' FSL and 1980' FWL of Section 29, and is currently assigned an 80-acre non-standard gas proration unit comprising the E/2 SW/4 of Section 29. We understand Atlantic Richfield is requesting the assignment of allowables equivalent to the volume of gas allocated to a single 120-acre proration unit and the operator is to determine the proportion of allowable to be produced by each well in the unit.

Amoco Production Company hereby waives notice of hearing to this request.

Yours very truly,

*D. L. Ray*

CDB:jn

cc: Atlantic Richfield Company  
Post Office Box 1610  
Midland, Texas 79701

AtlanticRichfieldCompany

North American Producing Division  
Permian District  
Post Office Box 1610  
Midland, Texas 79701  
Telephone 915 682 8631

W. P. Tomlinson  
District Engineer — West Area



71 JUN 25 PM 1 19

June 24, 1971

Mr. George Hatch  
New Mexico Oil Conservation Commission  
Santa Fe, New Mexico

Dear Mr. Hatch:

Attached, is the designation of unit covering our W. H. Turner and H. S. Turner leases located in the southwest quarter of Section 29, T-21-S, R-37-E, covering the pooling of your acreage for gas production from the Tubb and Blinbry formations. We are submitting this at your request pertaining to our application for a non-standard pro-ration unit for the W. H. Turner #1.

If we may be of further assistance, please let us know.

Very truly yours,

S. W. Barton

SWB/ec

Att.

MAIN OFFICE

DESIGNATION OF UNIT

71 JUN 25 PM 1 10

STATE OF NEW MEXICO  
COUNTY OF LEA

KNOW ALL MEN BY THESE PRESENTS:

That Sinclair Oil & Gas Company, a Maine corporation, the owner of oil and gas leases described hereinafter, in accordance with the terms and provisions of such leases, or amendments thereto, hereby executes this Unit Designation.

The oil and gas leases described below insofar as they cover the gas and associated liquid hydrocarbons in and under and that may be produced from the Tubb and Ministry Formations in the 160 acre tract designated hereinafter are hereby pooled and combined into a unit of 160 acres for the production of gas and associated liquid hydrocarbons from said formations, said tract being described as follows, to-wit:

Southeast Quarter (SW $\frac{1}{4}$ ) of Section 39, Township 21-South, Range 37-East, N. M. P. M., Lea County, New Mexico.

Said oil and gas leases being the following, insofar as they cover said 160 acre tract, or part thereof, to-wit:

1. Lease dated October 3, 1935 from William H. Turner and wife, Hazel S. Turner, lessors, to Repollo Oil Company, lessee, of record in Book 18, page 636, Lease Records, Lea County, New Mexico.
2. Lease dated October 12, 1935 from Robert C. Withers and wife, Ella E. Withers, to Repollo Oil Company, recorded in Book 18, page 627, Lease Records, Lea County, New Mexico.
3. Lease dated October 9, 1935 from Annie L. Christman and husband, E. A. Christman, and Wayne Cowden and wife, Ollie Cowden, lessors, to Repollo Oil Company, lessee, of record in Book 18, page 630, Lease Records, Lea County, New Mexico.
4. Lease dated December 14, 1935 from R. R. Jones and wife, Emma S. Jones, lessors, to Repollo Oil Company, lessee, of record in Book 36, page 574, Lease Records, Lea County, New Mexico.
5. Lease dated October 12, 1935 from Eva Venzburg, a widow, lessor, to Repollo Oil Company, lessee, of record in Book 18, page 619, Lease Records, Lea County, New Mexico.
6. Lease dated December 14, 1935 from Little E. Jones, lessor, to Repollo Oil Company, lessee, of record in Book 26, page 546, Lease Records, Lea County, New Mexico.
7. Lease dated October 12, 1935 from Humble Oil & Refining Company, a corporation, lessor, to Repollo Oil Company, lessee, of record in Book 18, page 634, Oil and Gas Records, Lea County, New Mexico.

WITNESSED this the 15 day of October, 1937.

SINCLAIR OIL & GAS COMPANY

BY

VICE-PRESIDENT

APPROVED:

RECORDED BOOK 137

STATE OF TEXAS

COUNTY OF HILL

The foregoing instrument was acknowledged before me  
this \_\_\_\_\_ day of \_\_\_\_\_, 1957, by \_\_\_\_\_, Vice-President  
of \_\_\_\_\_ OIL & GAS COMPANY, a Texas corporation, on behalf  
of said corporation.

Notary Public in and for  
Hill County, Texas

My commission expires \_\_\_\_\_