

*NSP issue - 7-11-71*

# Gulf Oil Company - U.S.

C. D. Borland  
AREA PRODUCTION MANAGER

HOBBS PRODUCTION AREA

June 8, 1971

**RECEIVED**

P. O. Box 670  
Hobbs, New Mexico 88240

JUN 1 1971

CONSERVATION

New Mexico Oil Conservation Commission  
P. O. Box 2088  
Santa Fe, New Mexico 87501

Re: Application of Gulf Oil Corporation for a Non-Standard 40-Acre Gas Proration Unit, Jalmat Gas Pool, Lea Co., New Mexico.

Gentlemen:

*Please read carefully*

Administrative approval is requested for a Non-Standard 40-Acre Jalmat Gas Proration Unit covering the SW/4, SW/4, Section 16, 25-S, 37-E, to be dedicated to our Arnott-Ramsay (NCT-E) well No. 3. In support of this application the following facts are submitted:

1. Subject well, located 615' FSL & 705' FWL, Section 16, 25-S, 37-E, is being re-classified, effective July 1, 1971 as a Jalmat Gas well, due to Gas-Oil ratio in excess of 100,000 cubic feet of gas per barrel of oil.
2. Applicant's well No. 2, located 660' FSL & 1980' FEL, Section 16, 25-S, 37-E, Jalmat Gas Pool has a Non-Standard Gas Proration unit of 280 acres, consisting of the SE/4, N/2 SW/4, SE/4, SW/4, Section 16, 25-S, 37-E.
3. The Proposed Non-Standard Gas Proration Unit consists of a quarter-quarter section within a single governmental quarter section.
4. The entire Non-Standard Unit is reasonable presumed to be gas productive in the Jalmat Gas Pool.
5. All Operators within 1500 feet of the Unit well have been furnished a copy of this application.

Your early consideration will be appreciated.

Yours truly,

*C. D. Borland*  
C. D. BORLAND

lwd:

cc: New Mexico Oil Conservation Commission  
Hobbs, New Mexico.  
Tidewater Oil Company, Box 249, Hobbs, N. M.  
Tenneco Oil Company, Box 1031, Midland, Texas  
Union Texas Petroleum Company, 1300 Wilco Bldg.,  
Midland, Texas



R 37 E

T  
25  
S

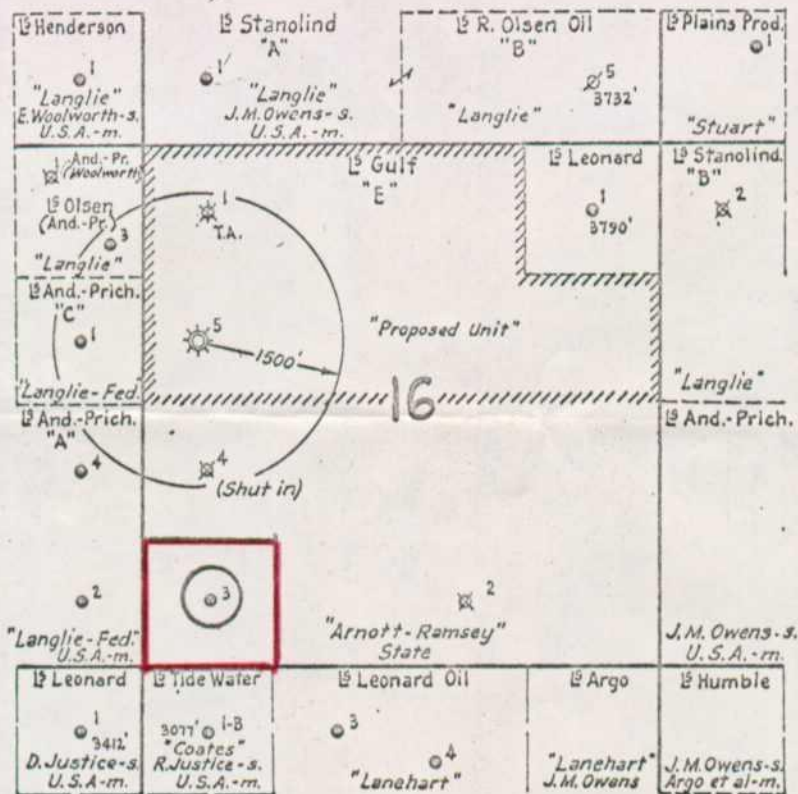

GULF OIL CORPORATION

Scale 1" = 2,000'

Gulf - Arnott-Ramsay "E" Lease

**NEW MEXICO OIL CONSERVATION COMMISSION  
WELL LOCATION AND ACREAGE DEDICATION PLAT**

Form C-102  
Supersedes C-128  
Effective 1-1-65

All distances must be from the outer boundaries of the Section.

Operator <b>Gulf Oil Corporation</b>			Lease <b>Arnott-Ramsay (NCT-E) No.</b>		Well No. <b>3</b>
Unit Letter <b>M</b>	Section <b>16</b>	Township <b>25S</b>	Range <b>37E</b>	County <b>Lea</b>	
Actual Footage Location of Well: <b>615</b> feet from the <b>south</b> line and <b>705</b> feet from the <b>west</b> line					
Ground Level Elev. <b>3095'</b>	Producing Formation <b>Jalmat Gas</b>		Pool <b>Jalmat Gas</b>		Dedicated Acreage: <b>40</b> Acres

1. Outline the acreage dedicated to the subject well by colored pencil or hachure marks on the plat below.
2. If more than one lease is dedicated to the well, outline each and identify the ownership thereof (both as to working interest and royalty).
3. If more than one lease of different ownership is dedicated to the well, have the interests of all owners been consolidated by communitization, unitization, force-pooling, etc?

☐ Yes ☐ No If answer is "yes," type of consolidation \_\_\_\_\_

If answer is "no," list the owners and tract descriptions which have actually been consolidated. (Use reverse side of this form if necessary.) \_\_\_\_\_

No allowable will be assigned to the well until all interests have been consolidated (by communitization, unitization, forced-pooling, or otherwise) or until a non-standard unit, eliminating such interests, has been approved by the Commission.

<div style="border: 1px solid black; padding: 10px;"> <p><b>NSP-842</b></p> </div>	<p><b>CERTIFICATION</b></p> <p><i>I hereby certify that the information contained herein is true and complete to the best of my knowledge and belief.</i></p>	
	<p>Name <b>ORIGINAL SIGNED BY</b> <b>C. D. BORLAND</b></p> <p>Position <b>Area Production Manager</b></p> <p>Company <b>Gulf Oil Corporation</b></p> <p>Date <b>July 14, 1971</b></p> <p><i>I hereby certify that the well location shown on this plat was plotted from field notes of actual surveys made by me or under my supervision, and that the same is true and correct to the best of my knowledge and belief.</i></p> <p>Date Surveyed _____</p> <p>Registered Professional Engineer and/or Land Surveyor _____</p> <p>Certificate No. _____</p>	



71SP-842

RECEIVED

JUL 15 1971

OIL CONSERVATION COMM.  
HOBBS, N. M.