

*from NSP-877  
date 4-17-72*  
**Getty Oil Company**

*will have two wells on the unit. make it effective the date well no. 2 is shut-in*  
~~Southern Division~~ **NORTH AMERICAN EXPLORATION AND PRODUCTION**

**P. O. Box 249**

**Hobbs, New Mexico 88240**

**March 14, 1972**

**State of New Mexico  
Oil Conservation Commission  
P. O. Box 2088  
Santa Fe, New Mexico 87501**

**Attn: Mr. Dan Nutter**

**Re: 120 Acre Non-Standard Gas Proration Unit  
Percy Hardy Wells Nos. 1 (Unit "P") and  
3 (Unit "N")  
Section 17, T-21-S, R-37-E  
Lea County, New Mexico**

**Gentlemen:**

The Percy Hardy Wells Nos. 1 and 3 were reclassified to Blinebry Gas Wells effective January 1, 1972 in order to comply with provisions of Order No. 1670 pertaining to the Blinebry Gas Pool. Getty Oil Company requests that a 120 Acre Non-Standard Gas Unit be assigned to these Wells Nos. 1 and 3 located in Proration Units "P" and "N" of Section 17. This 120 acres being S/2 of SE/4 and SE/4 of SW/4 of Section 17, T-21-S, R-37-E, Lea County, New Mexico.

On May 26, 1958, Administrative Order No. R-1176 (Case No. 1426) was approved for the above requested 120 Acre Non-Standard Gas Proration Unit after a Hearing on May 6, 1958. We request Administrative Approval of this 120 acres being reassigned to our Percy Hardy Wells Nos. 1 and 3. Our Percy Hardy Well No. 2, a Blinebry Oil Well in Proration Unit "O", will be shut-in upon your approval of the subject gas proration unit.

All offset operators have been notified by mail.

Very truly yours,  
GETTY OIL COMPANY

*C. L. Wade*  
C. L. Wade  
Area Superintendent

SDS/bh

CC: NMOCC, Hobbs, New Mexico 88240  
Amerada Hess Corp. Drawer 817, Seminole, Texas 79360  
Atlantic Richfield Oil Company, Box 1710, Hobbs, New Mexico 88240  
Campbell and Hendrick, Box 401, Midland, Texas 79701  
Continental Oil Company, Box 460, Hobbs, New Mexico 88240  
Hunt, N. B., 29th Floor, 1401 Elm, Dallas, Texas 75202  
Perry, J. W. Box 401, Midland, Texas 79701  
Sohio Petroleum Company, Box 3167, Midland, Texas 79701  
Sun Oil Company, Box 1861, Midland, Texas 79701

**NEW MEXICO OIL CONSERVATION COMMISSION  
WELL LOCATION AND ACREAGE DEDICATION PLAT**

Form C-102  
Supersedes C-128  
Effective 10-65

All distances must be from the outer boundaries of the Section.

Operator <b>GETTY OIL COMPANY</b>			Lessee <b>PERCY HARDY</b>			Well No. <b>1 AND 3</b>
Unit Letter <b>N and P</b>	Section <b>17</b>	Township <b>21-S</b>	Range <b>37-E</b>	County <b>LEA</b>		
Actual Footage Location of Well: No. 1: 660' FSL & 660' PNL; No. 3: 660' FSL & 1980' FWL						
feet from the		line and		feet from the		line
Ground Level Elev. <b>3,467' &amp; 3,499'</b>		Producing Formation <b>BLINEBRY</b>		Pool <b>BLINEBRY GAS</b>		Dedicated Acreage <b>120</b> Acres

1. Outline the acreage dedicated to the subject well by colored pencil or hachure marks on the plat below.
2. If more than one lease is dedicated to the well, outline each and identify the ownership thereof (both as to working interest and royalty).
3. If more than one lease of different ownership is dedicated to the well, have the interests of all owners been consolidated by communitization, unitization, force-pooling, etc?

☐ Yes ☒ No If answer is "yes," type of consolidation \_\_\_\_\_

If answer is "no," list the owners and tract descriptions which have actually been consolidated. (Use reverse side of this form if necessary.) \_\_\_\_\_

No allowable will be assigned to the well until all interests have been consolidated (by communitization, unitization, forced-pooling, or otherwise) or until a non-standard unit, eliminating such interests, has been approved by the Commission.

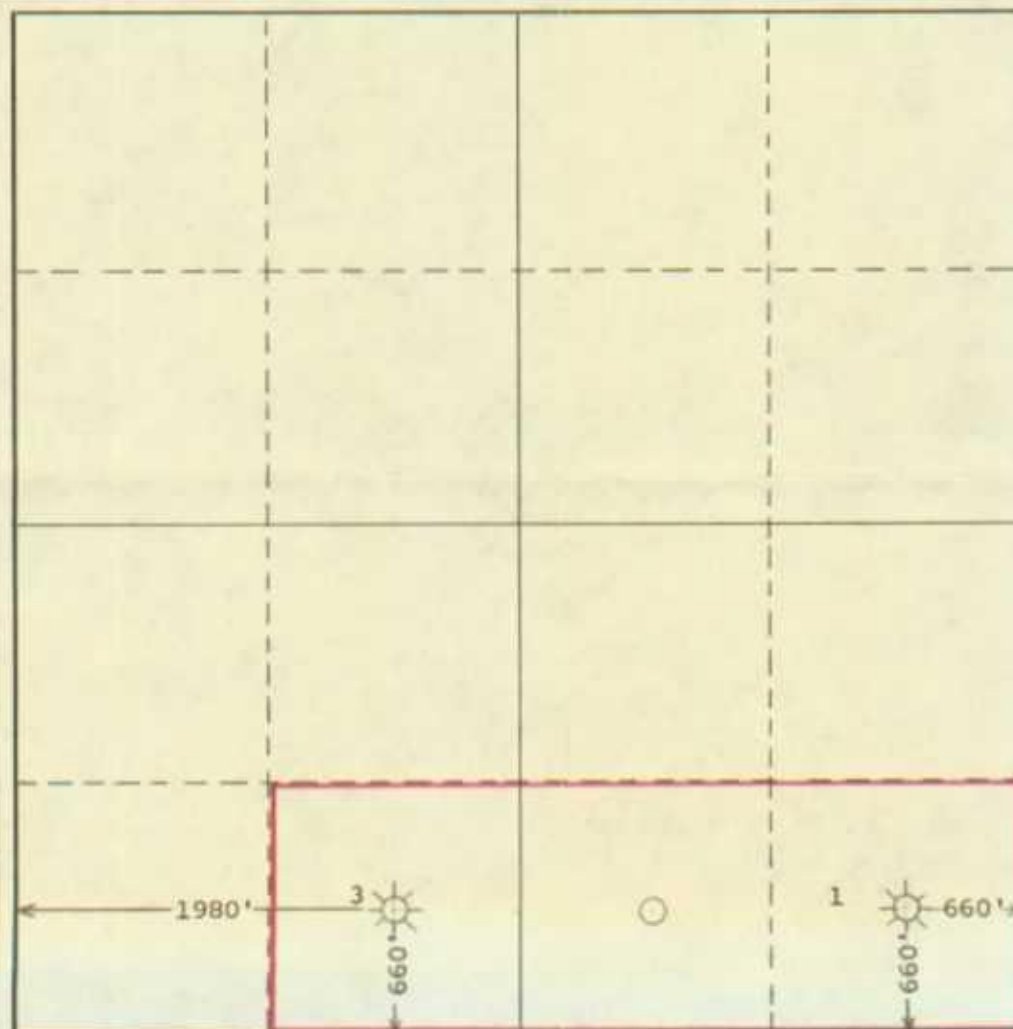

**CERTIFICATION**

*I hereby certify that the information contained herein is true and complete to the best of my knowledge and belief.*

Name

**C. L. Wade**

Position

**Area Superintendent**

Company

**GETTY OIL COMPANY**

Date

**MARCH 14, 1972**

*I hereby certify that the well location shown on this plat was plotted from field notes of actual surveys made by me or under my supervision, and that the same is true and correct to the best of my knowledge and belief.*

Date Surveyed

Registered Professional Engineer and/or Land Surveyor

Certificate No.

0 330 660 990 1320 1650 1980 2310 2640 2000 1600 1200 800 0

RECEIVED  
MAR 16 1972  
CONSERVATION COMM.

RANGE 37 EAST

SECTION 7

SECTION 8

SECTION 9

SECTION 18

SECTION 17

SECTION 16

PEERY

SUN

CONT'L.

AMERADA

WEATHERLY

LOCKHART

"DA"

GETTY

SUNRAY



LOCKHART

P. HARDY

STATE

SUNRAY

CAMPBELL AND  
HENDRICK

SINCLAIR HUNT, ET AL

ELLIOTT

LEE

YORK

MITTIE WEATHERLY

SECTION 19

SECTION 20

SECTION 21

GETTY OIL COMPANY  
PERCY HARDY LEASE  
BLINEBRY POOL  
LEA COUNTY, NEW MEXICO